

|               |  |
|---------------|--|
| DATE          |  |
| BY            |  |
| FINAL SURVEY  |  |
| NOTED         |  |
| PLOTTED       |  |
| TEMPLATE      |  |
| AREAS CHECKED |  |
| NO.           |  |

|                 |  |
|-----------------|--|
| DATE            |  |
| BY              |  |
| ORIGINAL SURVEY |  |
| NOTED           |  |
| PLOTTED         |  |
| TEMPLATE        |  |
| AREAS CHECKED   |  |
| NO.             |  |

FILE PATH = p:\388039\p\m\asc\com\line\local\p\w\c\0\0\Documents\01\Americas\Transportation\60269938\_Circle\Phase\1\000\_CDD\006\_Roadway\Sheets\60w28-SHT-XS-RampNW.dgn

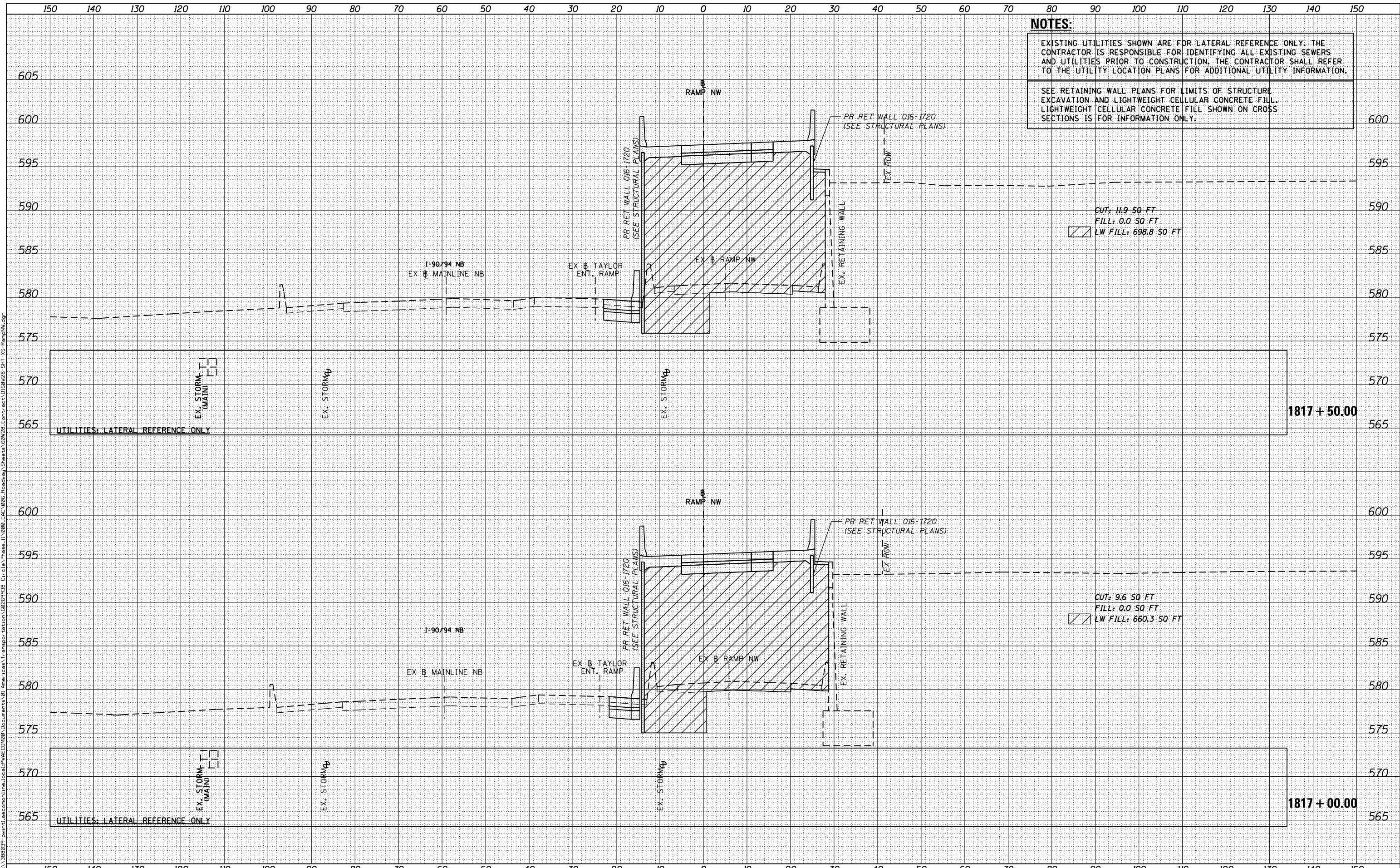

**NOTES:**  
 EXISTING UTILITIES SHOWN ARE FOR LATERAL REFERENCE ONLY. THE CONTRACTOR IS RESPONSIBLE FOR IDENTIFYING ALL EXISTING SEWERS AND UTILITIES PRIOR TO CONSTRUCTION. THE CONTRACTOR SHALL REFER TO THE UTILITY LOCATION PLANS FOR ADDITIONAL UTILITY INFORMATION.  
 SEE RETAINING WALL PLANS FOR LIMITS OF STRUCTURE EXCAVATION AND LIGHTWEIGHT CELLULAR CONCRETE FILL. LIGHTWEIGHT CELLULAR CONCRETE FILL SHOWN ON CROSS SECTIONS IS FOR INFORMATION ONLY.



D160w28-SHT-XS-RampNW.dgn  
 USER NAME = maronik  
 PLOT SCALE = 10.0000' / in.  
 PLOT DATE = 4/25/2014

DESIGNED - NMM / AJP  
 DRAWN - NMM / AJP  
 CHECKED - K&R  
 DATE - 04/28/14

REVISED -  
 REVISED -  
 REVISED -  
 REVISED -

STATE OF ILLINOIS  
 DEPARTMENT OF TRANSPORTATION

CROSS SECTIONS  
 RAMP NW

SCALE: 1:5V,1:10H SHEET 17 OF 51 SHEETS STA. 1817+00.00 TO STA. 1817+50.00

| F.A.I. RTE. | SECTION   | COUNTY | TOTAL SHEETS       | SHEET NO. |
|-------------|-----------|--------|--------------------|-----------|
| 90/94/290   | 2013-010R | COOK   | 747                | 662       |
|             |           |        | CONTRACT NO. 60W28 |           |

ILLINOIS FED. AID PROJECT