

NOTES:
 EXISTING UTILITIES SHOWN ARE FOR LATERAL REFERENCE ONLY. THE CONTRACTOR IS RESPONSIBLE FOR IDENTIFYING ALL EXISTING SEWERS AND UTILITIES PRIOR TO CONSTRUCTION. THE CONTRACTOR SHALL REFER TO THE UTILITY LOCATION PLANS FOR ADDITIONAL UTILITY INFORMATION.

| | |
|--------------|---------------|
| DATE | |
| BY | |
| FINAL SURVEY | SURVEYED |
| NOTE BOOK | PLOTTED |
| NO. | TEMPLATE |
| | AREAS CHECKED |

| | |
|-----------------|---------------|
| DATE | |
| BY | |
| ORIGINAL SURVEY | SURVEYED |
| NOTE BOOK | PLOTTED |
| NO. | TEMPLATE |
| | AREAS CHECKED |

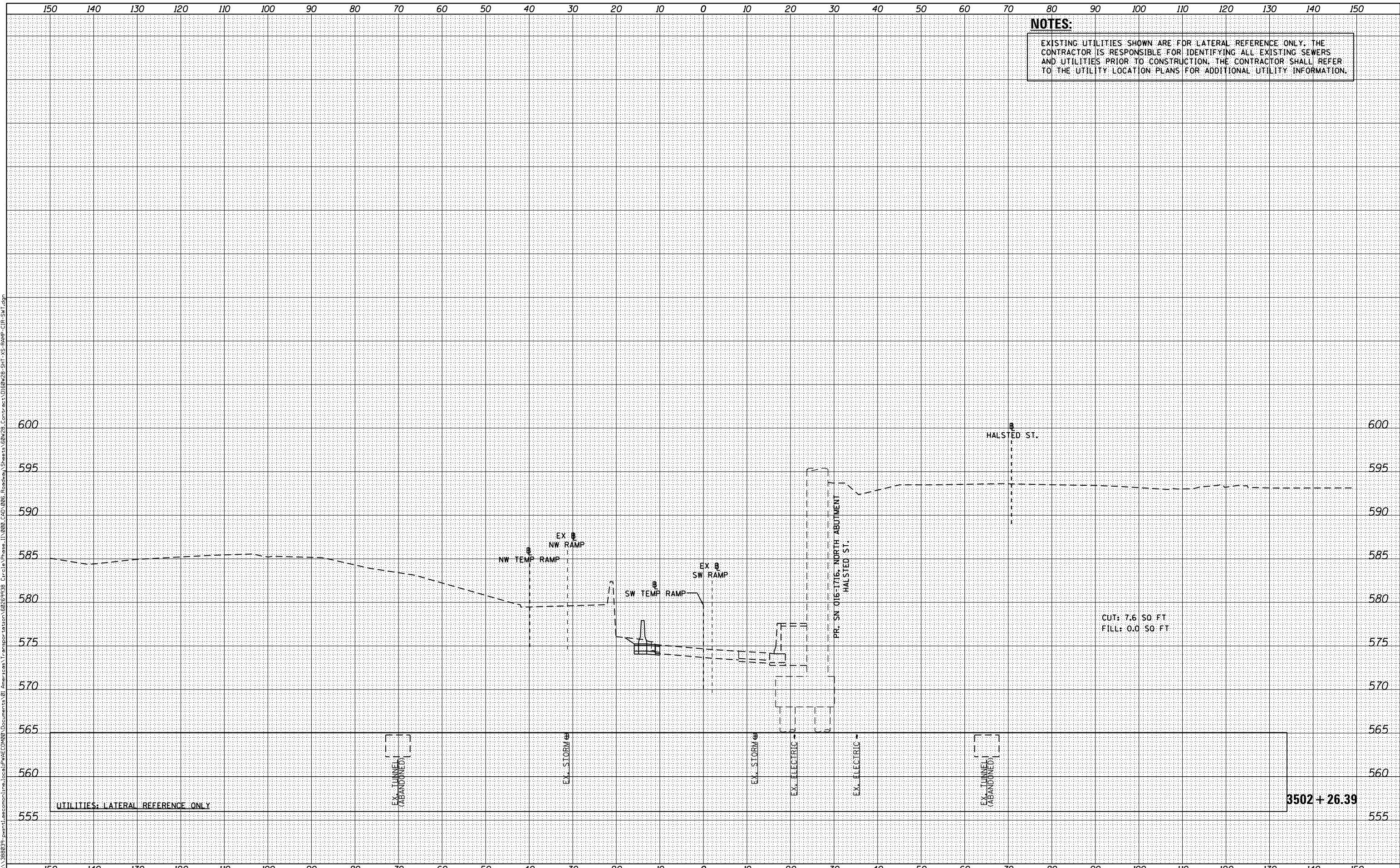

FILE PATH = p:\38803\p\1\ascom\line\local\p\AEC\DWG\Documents\01_Americas\Transportation\62629938_Circle Phase II\000_CDD_006_Roadway\Sheets\60W28_Contract\0160W28-SHT-XS-RAMP-CIR-SWT.dgn



D160W28-SHT-XS-RAMP-CIR-SWT.dgn
 USER NAME = maronik
 PLOT SCALE = 10.0000' / in.
 PLOT DATE = 4/25/2014

DESIGNED - NWM / AJP
 DRAWN - NWM / AJP
 CHECKED - KAM
 DATE - 04/28/14

REVISED -
 REVISED -
 REVISED -
 REVISED -

STATE OF ILLINOIS
 DEPARTMENT OF TRANSPORTATION

CROSS SECTIONS
 RAMP SW (TEMP)

SCALE: 1:5V, 1:10H SHEET 4 OF 19 SHEETS STA. 3502+26.39 TO STA. 3502+26.39

| F.A.I. RTE. | SECTION | COUNTY | TOTAL SHEETS | SHEET NO. |
|--------------------|-----------|--------|---------------------------|-----------|
| 90/94/290 | 2013-010R | COOK | 747 | 716 |
| CONTRACT NO. 60W28 | | | ILLINOIS FED. AID PROJECT | |