

STATE OF ILLINOIS
DEPARTMENT OF TRANSPORTATION

F.A.P. RTE.	SECTION	COUNTY	TOTAL SHEETS	SHEET NO.
327	14-12RS-2	CLINTON	8	1
		ILLINOIS	CONTRACT NO. 76M76	

D-98-090-19



INDEX OF SHEETS

- 1 COVER SHEET
- 2 HIGHWAY STANDARDS, GENERAL NOTES, & COMMITMENTS
- 3 SUMMARY OF QUANTITIES
- 4-5 TYPICAL SECTIONS
- 6 SCHEDULES OF QUANTITIES
- 7 LOCATION MAP & ALIGNMENT DETAIL
- 8 DETAILS

**PROPOSED
HIGHWAY PLANS**

FAP ROUTE 327 (US 50)
SECTION 14-12RS-2
PROJECT NHPP-XDAR(838)
RESURFACING - SMART
CLINTON COUNTY

C-98-109-19

TRAFFIC DATA

FROM 0.2 MILES WEST OF IL 160 TO SUGAR CREEK OVERFLOW

2019 ADT = 8300 (ACTUAL)
2039 ADT = 10100 (ESTIMATE)
SU = 3.0% MU = 7.2%

FUNCTIONAL CLASSIFICATION

OTHER ARTERIAL

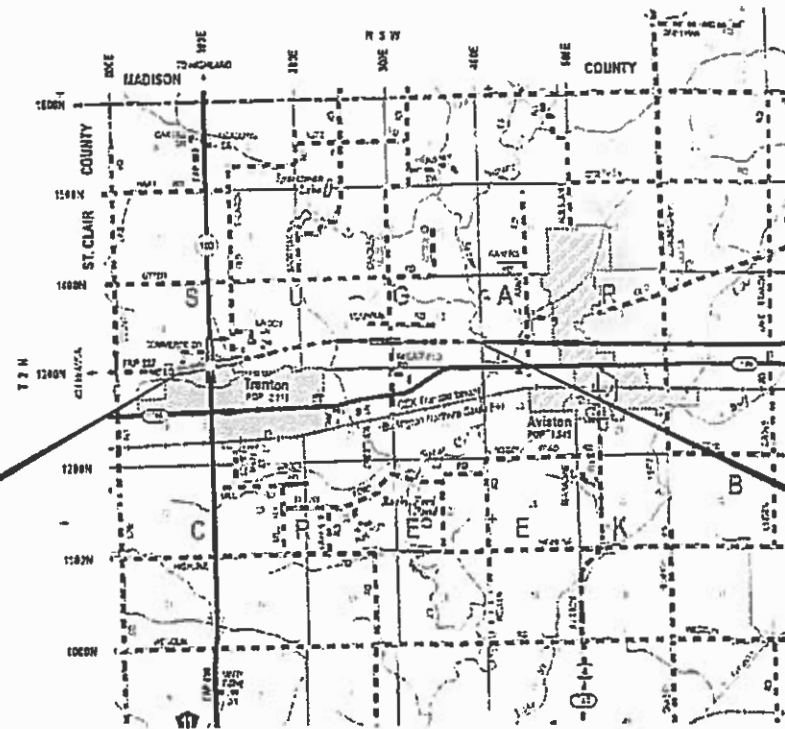

BEGIN IMPROVEMENTS
STATION 2592+90
LAT: 38.6124°
LONG: -89.6914°

END IMPROVEMENTS
STATION 2766+28
LAT: 38.6160°
LONG: -89.6311°

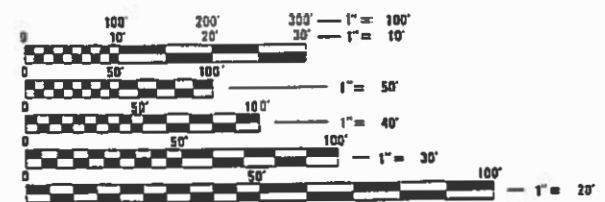

FULL SIZE PLANS HAVE BEEN PREPARED USING STANDARD ENGINEERING SCALES. REDUCED SIZED PLANS WILL NOT CONFORM TO STANDARD SCALES. IN MAKING MEASUREMENTS ON REDUCED PLANS, THE ABOVE SCALES MAY BE USED.

J.U.L.I.E.
JOINT UTILITY LOCATION INFORMATION FOR EXCAVATORS
1-800-892-0123
OR 811

PROJECT ENGINEER: TIM PADGETT (618) 346-3325
PROJECT MANAGER: PHIL FREIMUTH (618) 346-3194

CONTRACT NO. 76M76

GROSS LENGTH = 17,338.00 FT. = 3.284 MILE
NET LENGTH = 17,338.00 FT. = 3.284 MILE

STATE OF ILLINOIS
DEPARTMENT OF TRANSPORTATION

SUBMITTED June 3 20 19
Kath Roberts
REGIONAL ENGINEER

June 14 20 19
E.A. Etk
ENGINEER OF DESIGN AND ENVIRONMENT

June 14 20 19
Paul C. [Signature]
DIRECTOR OF HIGHWAYS PROJECT IMPLEMENTATION

PRINTED BY THE AUTHORITY
OF THE STATE OF ILLINOIS

HIGHWAY STANDARDS

000001-07	STANDARD SYMBOLS, ABBREVIATIONS AND PATTERNS
001006	DECIMAL OF AN INCH AND OF A FOOT
420001-09	PAVEMENT JOINTS
442201-03	CLASS C AND D PATCHES
701001-02	OFF-RD OPERATIONS, 2L, 2W, MORE THAN 15' AWAY
701006-05	OFF-RD OPERATIONS, 2L, 2W, 15' TO 24" FROM PAVEMENT EDGE
701011-04	OFF-RD MOVING OPERATIONS, 2L, 2W, DAY ONLY
701101-05	OFF-RD OPERATIONS, MULTILANE, 15' TO 24" FROM PAVEMENT EDGE
701106-02	OFF-RD OPERATIONS, MULTILANE, MORE THAN 15' AWAY
701201-05	LANE CLOSURE, 2L, 2W, DAY ONLY, FOR SPEEDS ≥ 45 MPH
701301-04	LANE CLOSURE, 2L, 2W, SHORT TIME OPERATION
701306-04	LANE CLOSURE, 2L, 2W, SLOW MOVING OPERATIONS DAY ONLY, FOR SPEEDS ≥ 45 MPH
701311-03	LANE CLOSURE, 2L, 2W MOVING OPERATIONS - DAY ONLY
701336-07	LANE CLOSURE, 2L, 2W, WORK AREAS IN SERIES, FOR SPEEDS ≥ 45 MPH
701411-09	LANE CLOSURE, MULTILANE, AT ENTRANCE OR EXIT RAMP, FOR SPEEDS ≥ 45 MPH
701421-08	LANE CLOSURE, MULTILANE, DAY OPERATIONS ONLY, FOR SPEEDS ≥ 45 MPH TO 55 MPH
701426-09	LANE CLOSURE, MULTILANE, INTERMITTENT OR MOVING OPER., FOR SPEEDS ≥ 45 MPH
701901-08	TRAFFIC CONTROL DEVICES
780001-05	TYPICAL PAVEMENT MARKINGS
781001-04	TYPICAL APPLICATIONS RAISED REFLECTIVE PAVEMENT MARKERS

GENERAL NOTES

- ILLINOIS STATE LAW REQUIRES A 48-HOUR NOTICE BE GIVEN TO UTILITIES BEFORE DIGGING. FIELD MARKING OF FACILITIES MAY BE OBTAINED BY CONTACTING J.U.L.I.E. OR FOR NON-MEMBERS, THE UTILITY COMPANY DIRECTLY. AGENCIES KNOWN TO HAVE FACILITIES WITHIN THE PROJECT AREA ARE AS FOLLOWS:

UTILITY	ABOVE GROUND	BELOW GROUND
* AMEREN ILLINOIS (GAS & ELECTRIC)	X	X
* AT&T ILLINOIS (COMMUNICATIONS)	X	X
* VILLAGE OF AVISTON (WATER & SANITARY SEWER)		X
* CHARTER COMMUNICATIONS, INC. (CABLE TV)	X	X
* CLINTON COUNTY ELECTRIC COOPERATIVE, INC. (ELECTRIC)	X	X
* CITY OF TRENTON (WATER & SANITARY SEWER)		X
* TRI-TOWNSHIP WATER DISTRICT (WATER)		X

MEMBERS OF J.U.L.I.E. CALL TOLL FREE (800) 892-0123 OR 811 AND ARE INDICATED BY *. NON-J.U.L.I.E. MEMBERS MUST BE NOTIFIED INDIVIDUALLY.

- ALL AREAS DISTURBED FOR ANY REASON OTHER THAN PROPOSED ON PLANS AND SCHEDULES SHALL BE PERMANENTLY SEEDED AND MULCHED AS DIRECTED BY THE ENGINEER. ALL AREAS DISTURBED BY THE CONTRACTOR OUTSIDE THE PROPOSED CONSTRUCTION LIMITS SHALL BE SEEDED AT THE CONTRACTOR'S EXPENSE.
- THE CONTRACTOR AND THE ENGINEER SHALL BE AWARE THAT NO SURVEY WAS PERFORMED FOR THIS PROJECT. THE STATIONING, TOPOGRAPHY, AND QUANTITIES SHOWN IN THE PLANS WERE CREATED USING MICROFILM AND FIELD MEASUREMENTS. ALL SHALL BE ASSUMED TO BE APPROXIMATE. THE CONTRACTOR SHALL VERIFY DIMENSIONS AND CONDITIONS IN THE FIELD PRIOR TO CONSTRUCTION AND ORDERING OF MATERIALS.
- THE THICKNESS OF HOT-MIX ASPHALT SURFACE MIXTURES SHOWN ON THE PLANS IS THE NOMINAL THICKNESS. DEVIATIONS MAY OCCUR DUE TO IRREGULARITIES IN THE EXISTING SURFACE OR BASE ON WHICH THE BITUMINOUS MIXTURE IS PLACED.
- AN ESTIMATED QUANTITY OF 5,488 TONS OF CUTTINGS FROM THE HOT-MIX ASPHALT SURFACE REMOVAL OPERATION IS ANTICIPATED.
- MTD CAN OPERATE IN AN UNLOADED CONDITION ON SN 014-2458, SN 014-2456, SN 014-2457, SN 014-2460, SN 014-2461, SN 014-0049, AND SN 014-2008.
- NO OVERNIGHT LANE CLOSURES WILL BE PERMITTED.
- ALL PATCHING ON THIS PROJECT SHALL BE COMPLETED PRIOR TO HMA SURFACE REMOVAL.
- THE PROPOSED PAVEMENT MARKING SHALL MATCH THE LOCATIONS OF THE EXISTING PAVEMENT MARKING, AS DIRECTED BY THE ENGINEER.
- IF THE SURFACE REMOVAL ON THIS PROJECT PRODUCES A MILLED EDGE ANYWHERE GREATER THAN 1.5 INCHES BETWEEN ADJACENT OPEN LANES OF TRAFFIC, ONE OF THE FOLLOWING SHALL APPLY:
 - THE CONTRACTOR SHALL ORGANIZE THE WORK TO AVOID THE MILLED EDGE.
 - THE CONTRACTOR SHALL CONSTRUCT A TEMPORARY HOT MIX ASPHALT WEDGE ALONG THE MILLED EDGE.
 - THE CONTRACTOR SHALL CONSTRUCT A MILLED SLOPED EDGE (MINIMUM 1:3) ALONG THE MILLED EDGE.
- THE COST OF THIS WORK SHALL BE INCLUDED IN THE COST PER SQUARE YARD FOR HOT-MIX ASPHALT SURFACE REMOVAL OF THE DEPTH SPECIFIED.
- IF SURVEY MONUMENTS ARE FOUND, THEIR RELOCATION, ADJUSTMENT, OR PRESERVATION WILL BE PAID FOR ACCORDING TO ARTICLE 109.04(b), AS DETERMINED BY THE ENGINEER.
- THE FOLLOWING MIXTURE REQUIREMENTS ARE APPLICABLE FOR THIS PROJECT:

MIXTURE USE	SURFACE	PATCHING
AC/PG	PG 64-22	PG 64-22
RAP % (MAX)	SEE SPECIAL PROVISION	SEE SPECIAL PROVISION
DESIGN AIR VOIDS	4.0% @ Ndes=70	4.0% @ Ndes=70
MIX COMPOSITION (Gradation)	IL 9.5	IL 19.0
FRICTION AGG	MIXTURE "D"	MIXTURE "B"
QUALITY MGMT PROGRAM	QCP	QC/QA

PLAN QUANTITIES FOR HMA ITEMS ARE CALCULATED USING A UNIT WEIGHT OF 112 LB/SQ YD/IN.

COMMITMENTS

NONE

MODEL: Default
FILE: \\hpc1\p\hpc\room\dat\illinois.gov\PHWDOT\Documents\DOT_Offices\Illin\ct 8\Projects\ID07\6M76\CADD\ba\CAD\sheet\ID07\6M76-shc-gen\make.dgn

USER NAME = freimthpd	DESIGNED -	REVISED -
	DRAWN -	REVISED -
PLOT SCALE = 100.0000 ' / in.	CHECKED -	REVISED -
PLOT DATE = 6/1/2019	DATE -	REVISED -

**STATE OF ILLINOIS
DEPARTMENT OF TRANSPORTATION**

HIGHWAY STANDARDS, GENERAL NOTES, & COMMITMENTS

SCALE: N.T.S. SHEET 1 OF 1 SHEETS STA. TO STA.

F.A.P. RTE.	SECTION	COUNTY	TOTAL SHEETS	SHEET NO.
327	14-12RS-2	CLINTON	8	2
CONTRACT NO. 76M76				
		ILLINOIS	FED. AID PROJECT	

CODE NO.	ITEM	UNIT	TOTAL QUANTITY	CONSTR. CODE	
				80% FED 20% STATE	
				ROADWAY 0005	RURAL
40600290	BITUMINOUS MATERIALS (TACK COAT)	POUND	29401.6	29401.6	
40600982	HOT-MIX ASPHALT SURFACE REMOVAL - BUTT JOINT	SQ YD	83	83	
40600990	TEMPORARY RAMP	SQ YD	368	368	
40603340	HOT-MIX ASPHALT SURFACE COURSE, MIX "D", N70	TON	5488	5488	
44000155	HOT-MIX ASPHALT SURFACE REMOVAL, 1 1/2"	SQ YD	65254	65254	
44201777	CLASS D PATCHES, TYPE II, 11 INCH	SQ YD	15	15	
44201781	CLASS D PATCHES, TYPE III, 11 INCH	SQ YD	46	46	
44201783	CLASS D PATCHES, TYPE IV, 11 INCH	SQ YD	261	261	
67000400	ENGINEER'S FIELD OFFICE, TYPE A	CAL MO	2	2	
67100100	MOBILIZATION	L SUM	1	1	
70100310	TRAFFIC CONTROL AND PROTECTION, STANDARD 701421	L SUM	1	1	
70100420	TRAFFIC CONTROL AND PROTECTION, STANDARD 701411	EACH	4	4	
70100450	TRAFFIC CONTROL AND PROTECTION, STANDARD 701201	L SUM	1	1	
70100460	TRAFFIC CONTROL AND PROTECTION, STANDARD 701306	L SUM	1	1	
70100600	TRAFFIC CONTROL AND PROTECTION, STANDARD 701336	L SUM	1	1	
70300100	SHORT TERM PAVEMENT MARKING	FOOT	13387	13387	

CODE NO.	ITEM	UNIT	TOTAL QUANTITY	CONSTR. CODE	
				80% FED 20% STATE	
				ROADWAY 0005	RURAL
70300150	SHORT TERM PAVEMENT MARKING REMOVAL	SQ FT	1487	1487	
70300210	TEMPORARY PAVEMENT MARKING LETTERS AND SYMBOLS	SQ FT	63	63	
70300220	TEMPORARY PAVEMENT MARKING - LINE 4"	FOOT	57203	57203	
70300250	TEMPORARY PAVEMENT MARKING - LINE 8"	FOOT	980	980	
70300260	TEMPORARY PAVEMENT MARKING - LINE 12"	FOOT	648	648	
* 78000100	THERMOPLASTIC PAVEMENT MARKING - LETTERS AND SYMBOLS	SQ FT	63	63	
* 78000200	THERMOPLASTIC PAVEMENT MARKING - LINE 4"	FOOT	57203	57203	
* 78000500	THERMOPLASTIC PAVEMENT MARKING - LINE 8"	FOOT	980	980	
* 78000600	THERMOPLASTIC PAVEMENT MARKING - LINE 12"	FOOT	648	648	
* 78100100	RAISED REFLECTIVE PAVEMENT MARKER	EACH	424	424	
78300200	RAISED REFLECTIVE PAVEMENT MARKER REMOVAL	EACH	424	424	
X7030005	TEMPORARY PAVEMENT MARKING REMOVAL	SQ FT	20430	20430	
Z0033700	LONGITUDINAL JOINT SEALANT	FOOT	22479	22479	
Z0034105	MATERIAL TRANSFER DEVICE	TON	5488	5488	
Ø Z0076600	TRAINEES	HOUR	500	500	
Ø Z0076604	TRAINEES TRAINING PROGRAM GRADUATE	HOUR	500	500	

* SPECIALTY ITEM Ø 0042

STATE OF ILLINOIS
DEPARTMENT OF TRANSPORTATION

SUMMARY OF QUANTITIES

USER NAME = freimuthpd	DESIGNED -	REVISED -
	DRAWN -	REVISED -
PLOT SCALE = 100.0000' / in.	CHECKED -	REVISED -
PLOT DATE = 6/3/2019	DATE -	REVISED -

F.A.P. RTE.	SECTION	COUNTY	TOTAL SHEETS	SHEET NO.
327	14-12RS-2	CLINTON	8	3
CONTRACT NO. 76M76				
SCALE: N.T.S.	SHEET 1	OF 1	SHEETS	STA. TO STA.
ILLINOIS FED. AID PROJECT				

MODEL: Default
FILE: \\nrcs-pix\pub\room\dat\illinois.gov\PIWDOT\Documents\DOT_Offices\District_8\Projects\076M76\CADD\08a\CAD\Sheets\076M76-sh-500.dgn

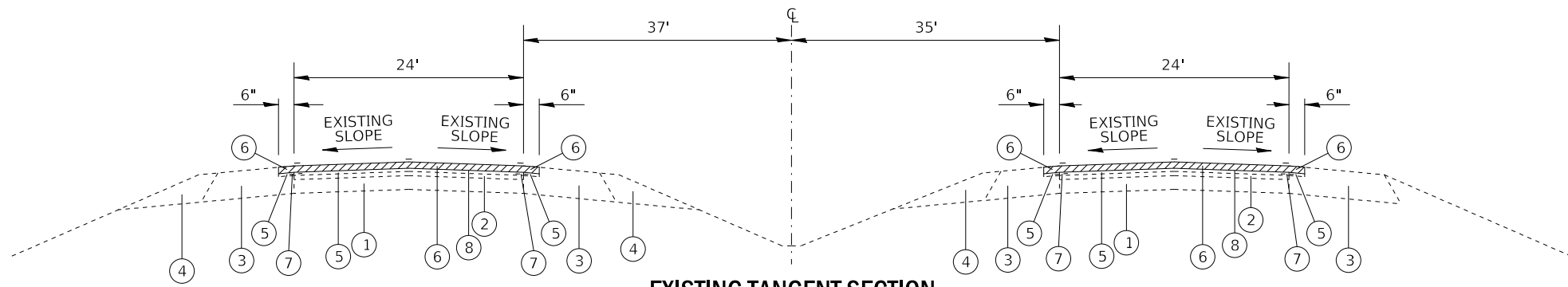

EXISTING TANGENT SECTION
STA. 2592+90.00 TO STA. 2634+43.04

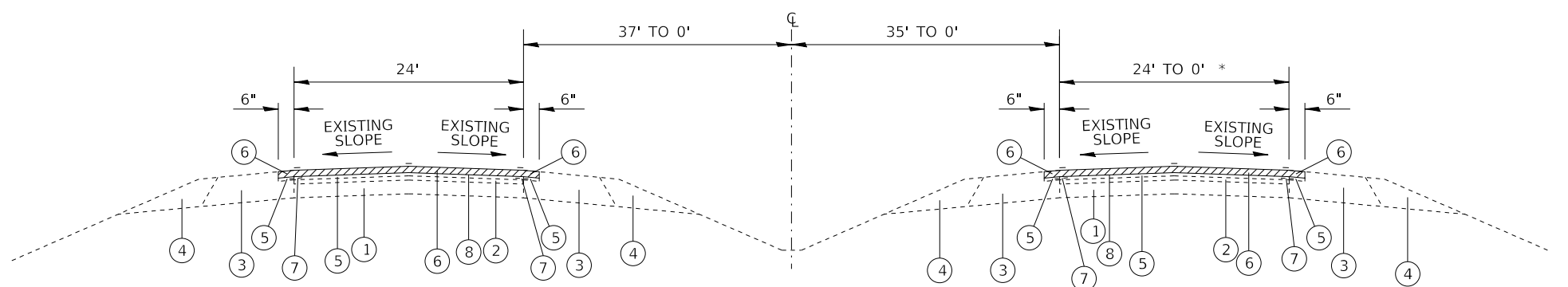

EXISTING TANGENT SECTION
STA. 2634+43.04 TO STA. 2646+56.76

* EASTBOUND TRANSITION ALIGNMENT
STA. 0+00.00 TO STA. 12+18.74

LEGEND

- ① EXISTING HOT-MIX ASPHALT BASE COURSE 8"
- ② EXISTING HOT-MIX ASPHALT SURFACE COURSE 3-1/4"
- ③ EXISTING HOT-MIX ASPHALT SHOULDER 8"
- ④ EXISTING AGGREGATE SHOULDERS, TYPE B
- ⑤ EXISTING LEVELING BINDER (MACHINE METHOD), N90 - 3/4"
- ⑥ EXISTING POLYMERIZED HOT-MIX ASPHALT SURFACE COURSE, MIX D, N90 - 1-1/2"
- ⑦ EXISTING STRIP REFLECTIVE CRACK CONTROL
- ⑧ PROPOSED HOT-MIX ASPHALT SURFACE REMOVAL, 1-1/2"
- ⑨ PROPOSED BITUMINOUS MATERIALS (TACK COAT)
- ⑩ PROPOSED LONGITUDINAL JOINT SEALANT
- ⑪ PROPOSED HOT-MIX ASPHALT SURFACE COURSE, MIX D, N70 - 1-1/2"
- ⑫ PROPOSED THERMOPLASTIC PAVEMENT MARKINGS

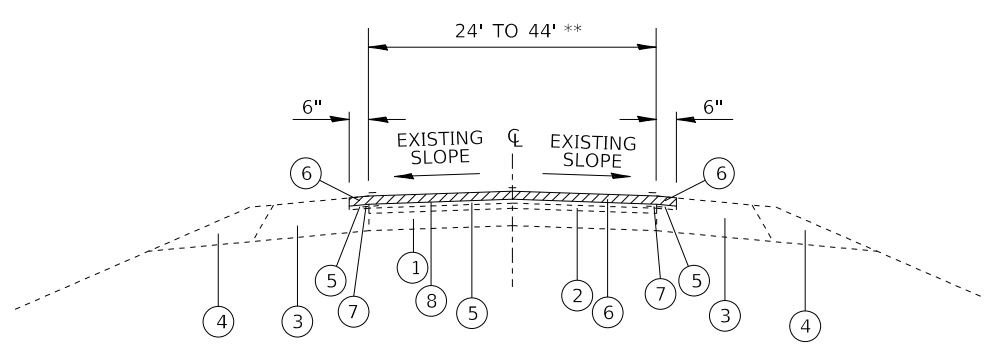

EXISTING TANGENT SECTION

**
STA. 2646+56.76 TO STA. 2701+22.55 (24' WIDE)
STA. 2701+22.55 TO STA. 2706+72.55 (TAPER FROM 24' TO 44')
STA. 2706+72.55 TO STA. 2717+36.87 (44' WIDE)
STA. 2717+36.87 TO STA. 2722+86.87 (TAPER FROM 44' TO 24')
STA. 2722+86.87 TO STA. 2766+28.00 (24' WIDE)

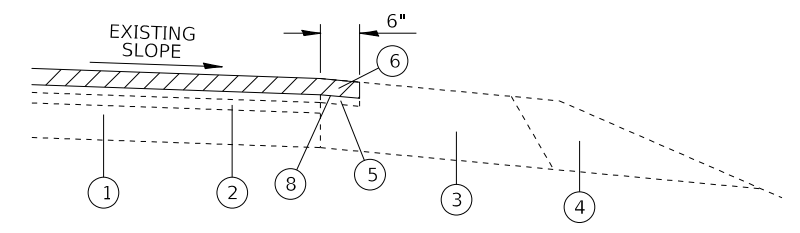

TYPICAL EDGE OF PAVEMENT/SHOULDER DETAIL

MODEL: Default
FILE: \\nrc\p\pub\p\room\da\illinois.gov\PHWDOT\Documents\DOT_Offices\District_8\Projects\ID276M76\CADD\Drawings\ID276M76-shc-sy\plan.dgn

USER NAME = freimuthpd	DESIGNED -	REVISED -
	DRAWN -	REVISED -
PLOT SCALE = 20.0000' / in.	CHECKED -	REVISED -
PLOT DATE = 6/1/2019	DATE -	REVISED -

**STATE OF ILLINOIS
DEPARTMENT OF TRANSPORTATION**

TYPICAL SECTIONS			
SCALE: N.T.S.	SHEET 1	OF 2 SHEETS	STA. TO STA.

F.A.P. RTE.	SECTION	COUNTY	TOTAL SHEETS	SHEET NO.
327	14-12RS-2	CLINTON	8	4
CONTRACT NO. 76M76			ILLINOIS FED. AID PROJECT	

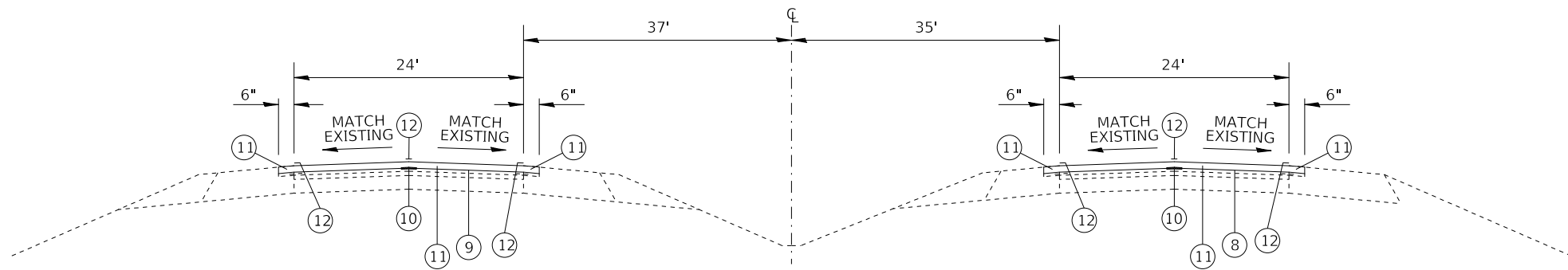

PROPOSED TANGENT SECTION

STA. 2592+90.00 TO STA. 2634+43.04

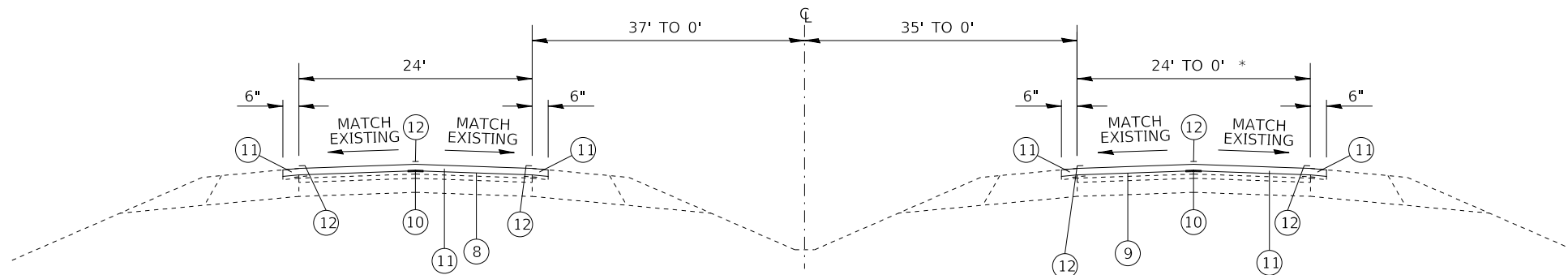

PROPOSED TANGENT SECTION

STA. 2634+43.04 TO STA. 2646+56.76

* EASTBOUND TRANSITION ALIGNMENT
STA. 0+00.00 TO STA. 12+18.74

LEGEND

- ① EXISTING HOT-MIX ASPHALT BASE COURSE 8"
- ② EXISTING HOT-MIX ASPHALT SURFACE COURSE 3-1/4"
- ③ EXISTING HOT-MIX ASPHALT SHOULDER 8"
- ④ EXISTING AGGREGATE SHOULDERS, TYPE B
- ⑤ EXISTING LEVELING BINDER (MACHINE METHOD), N90 - 3/4"
- ⑥ EXISTING POLYMERIZED HOT-MIX ASPHALT SURFACE COURSE, MIX D, N90 - 1-1/2"
- ⑦ EXISTING STRIP REFLECTIVE CRACK CONTROL
- ⑧ PROPOSED HOT-MIX ASPHALT SURFACE REMOVAL, 1-1/2"
- ⑨ PROPOSED BITUMINOUS MATERIALS (TACK COAT)
- ⑩ PROPOSED LONGITUDINAL JOINT SEALANT
- ⑪ PROPOSED HOT-MIX ASPHALT SURFACE COURSE, MIX D, N70 - 1-1/2"
- ⑫ PROPOSED THERMOPLASTIC PAVEMENT MARKINGS

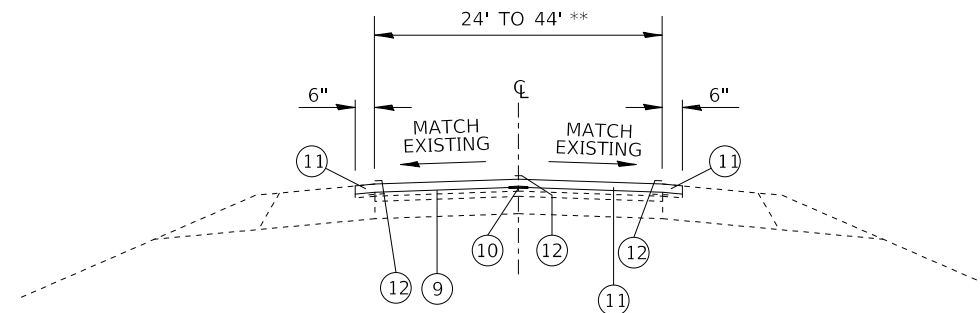

PROPOSED TANGENT SECTION

STA. 2646+56.76 TO STA. 2701+22.55 (24' WIDE)
 STA. 2701+22.55 TO STA. 2706+72.55 (TAPER FROM 24' TO 44')
 STA. 2706+72.55 TO STA. 2717+36.87 (44' WIDE)
 STA. 2717+36.87 TO STA. 2722+86.87 (TAPER FROM 44' TO 24')
 STA. 2722+86.87 TO STA. 2766+28.00 (24' WIDE)

**

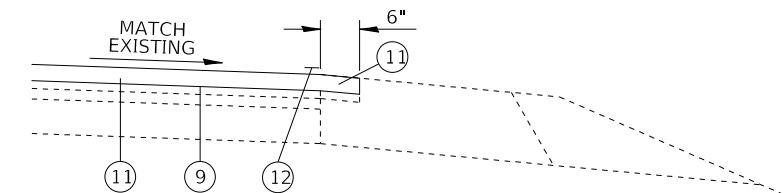

TYPICAL EDGE OF PAVEMENT/SHOULDER DETAIL

MODEL: Default
 FILE: \\nrc\p\pub\p\room\dat\illinois.gov\PHWDOT\Documents\DOT_Offices\District_8\Projects\ID276M76\CADD\Drawings\ID276M76-shc-sypl\pl\al.dgn

USER NAME = freimthpd	DESIGNED -	REVISED -
	DRAWN -	REVISED -
PLOT SCALE = 20.0000' / in.	CHECKED -	REVISED -
PLOT DATE = 6/1/2019	DATE -	REVISED -

**STATE OF ILLINOIS
DEPARTMENT OF TRANSPORTATION**

TYPICAL SECTIONS

SCALE: N.T.S. SHEET 2 OF 2 SHEETS STA. TO STA.

F.A.P. RTE.	SECTION	COUNTY	TOTAL SHEETS	SHEET NO.
327	14-12RS-2	CLINTON	8	5
CONTRACT NO. 76M76				
ILLINOIS FED. AID PROJECT				

MAINLINE PAVEMENT SCHEDULE								
LOCATION				HMA SURFACE REMOVAL - BUTT	HMA SURFACE REMOVAL - 1 1/2"	BITUMINOUS MATERIALS (TACK COAT)	HOT-MIX ASPHALT SURFACE COURSE, MIX "D", N70	LONGITUDINAL JOINT SEALANT
STA.	TO	STA.	EB/WB	SQ YD	SQ YD	POUND	TON	FOOT
US 50								
2592+90.00	TO	2593+00.00	EB	27.78		12.5	2.3	10.0
2593+00.00	TO	2634+43.04	EB		11508.4	5178.8	966.7	4143.0
0+00.00	TO	6+71.89	EB		1493.1	671.9	125.4	671.9
6+71.89	TO	9+02.69	EB		384.7	173.1	32.3	
9+02.69	TO	12+18.74	EB		263.4	118.5	22.1	316.1
2592+90.00	TO	2593+00.00	WB	27.78		12.5	2.3	10.0
2593+00.00	TO	2646+56.76	WB		14879.9	6696.0	1249.9	5356.8
2646+56.76	TO	2701+22.55	EB/WB		15182.7	6832.2	1275.4	5465.8
2701+22.55	TO	2702+72.55	EB/WB		450.0	202.5	37.8	150.0
2702+72.55	TO	2706+72.55	EB/WB		1644.4	740.0	138.1	400.0
2706+72.55	TO	2717+36.87	EB/WB		5321.6	2394.7	447.0	1064.3
2717+36.87	TO	2721+36.87	EB/WB		1644.4	740.0	138.1	400.0
2721+36.87	TO	2722+86.87	EB/WB		450.0	202.5	37.8	150.0
2722+86.87	TO	2766+18.00	EB/WB		12030.9	5413.9	1010.6	4331.1
2766+18.00	TO	2766+28.00	EB/WB	27.78		12.5	2.3	10.0
TOTAL				83	65254	29401.6	5488	22479

CLASS D PATCHES							
STATION	LOCATION	LENGTH	WIDTH	AREA	11"		
					TYPE II	TYPE III	TYPE IV
	EB/WB	FEET	FEET	SQ YD	SQ YD	SQ YD	SQ YD
US 50							
2650+29	WB	60	6	40.0			40.0
2665+61	EB	15	12	20.0		20.0	
2684+93	EB	60	12	80.0			80.0
2700+51	EB	20	12	26.7			26.7
2705+58	WB	20	12	26.7			26.7
2706+79	EB	15	12	20.0		20.0	
2713+18	WB	8	15	13.3	13.3		
2750+61	WB	20	12	26.7			26.7
2760+06	WB	20	12	26.7			26.7
SUBTOTAL					13.3	40.0	226.7
ANTICIPATED FAILURES (15%)					2.0	6.0	34.0
TOTAL					15	46	261

PAVEMENT MARKING SCHEDULE														
LOCATION					LENGTH	THERMOPLASTIC PAVEMENT MARKING					TEMPORARY PAVEMENT MARKING REMOVAL	SHORT TERM PAVEMENT MARKING (3 APPLICATIONS)	SHORT TERM PAVEMENT MARKING REMOVAL (FINAL SURFACE ONLY)	
STA.	TO	STA.	EB/WB	FOOT		4" YELLOW SKIP DASH	4" YELLOW SOLID	4" WHITE SKIP DASH	4" WHITE SOLID	8" WHITE SOLID				12" YELLOW DIAGONAL
					FOOT	FOOT	FOOT	FOOT	FOOT	FOOT	SQ FT	SQ FT	FOOT	SQ FT
US 50														
2592+90	TO	2614+65	EB	2175.0		2175	543.8	2175				1631.3	1115.2	123.9
2614+65	TO	2618+40	EB	375.0		375	93.8		375			406.3	192.3	21.4
2618+40	TO	2626+90	EB	850.0		850	212.5					354.2	435.8	48.4
2626+90	TO	2632+33	EB	543.0		543	135.8	543				407.3	278.4	30.9
2632+33	TO	2634+43	EB	210.0		210		210				140.0	50.4	5.6
0+00	TO	9+03	EB	903.0		903		903				602.0	216.7	24.1
9+03	TO	12+19	EB	316.0		316		316				105.3	75.8	8.4
2592+90	TO	2595+75	WB	285.0		285	71.3		285			308.8	146.1	16.2
2595+75	TO	2617+70	WB	2195.0		2195	548.8	2195				1646.3	1125.4	125.0
2617+70	TO	2620+90	WB	320.0		320	80.0		320			346.7	164.1	18.2
2620+90	TO	2623+90	WB	300.0		300	75.0					125.0	153.8	17.1
2623+90	TO	2643+40	WB	1950.0		1950	487.5	1950				1462.5	999.8	111.1
2643+40	TO	2645+30	WB	190.0		190		190				190.0	149.2	16.6
2645+30	TO	2646+56	WB	126.0	31.5	126		126				94.5	99.0	11.0
2646+56	TO	2654+23	EB/WB	767.0	191.8	767		1534				830.9	602.4	66.9
2654+23	TO	2697+72	EB/WB	4349.0	1087.3	4349		8698				3261.8	2229.9	247.8
2697+72	TO	2702+72	EB/WB	500.0	125.0	500		1000				541.7	392.7	43.6
2702+72	TO	2706+72	EB/WB	400.0		1600		800		156		955.9	532.4	59.2
2706+72	TO	2709+42	EB/WB	270.0		1080	67.5	540		122		684.9	359.3	39.9
2709+42	TO	2711+22	EB/WB	180.0		720		540		34	31.2	485.2	288.7	32.1
2711+22	TO	2711+72	EB/WB	50.0		200		50		11		94.7	80.2	8.9
2711+72	TO	2712+37	EB/WB	65.0										
2712+37	TO	2712+87	EB/WB	50.0		200		50		11		94.7	80.2	8.9
2712+87	TO	2714+67	EB/WB	180.0		720		540		34	31.2	485.2	288.7	32.1
2714+67	TO	2717+37	EB/WB	270.0		1080	67.5	540		122		684.9	359.3	39.9
2717+37	TO	2721+37	EB/WB	400.0		1600		800		156		955.9	532.4	59.2
2721+37	TO	2726+37	EB/WB	500.0	125.0	500		1000				541.7	392.7	43.6
2726+37	TO	2766+28	EB/WB	3991.0	997.8			7982				2993.3	2046.3	227.4
SUBTOTAL					2558.3	19579	2383.3	32682	980	647	62.4	20430.5	13387.3	1487.5
TOTAL							57203		980	648	63	20430	13387	1487

RAISED REFLECTIVE PAVEMENT MARKERS											
LOCATION				LENGTH	RAISED REFLECTIVE PAVEMENT MARKER REMOVAL			RAISED REFLECTIVE PAVEMENT MARKER			
STATION	TO	STATION	EB/WB		FOOT	ONE-WAY CRYSTAL	ONE-WAY AMBER	TWO-WAY AMBER	ONE-WAY CRYSTAL	ONE-WAY AMBER	TWO-WAY AMBER
					EACH	EACH	EACH	EACH	EACH	EACH	
US 50											
2592+90	TO	2632+33	EB	3943	49			49			
0+00	TO	12+19	EB	1219	61			61			
2592+90	TO	2617+70	WB	2480	31			31			
2617+70	TO	2620+90	WB	320	12			12			
2620+90	TO	2643+40	WB	2250	28			28			
2643+40	TO	2645+30	WB	190		5			5		
2645+30	TO	2702+72	EB/WB	5742			72			72	
2702+72	TO	2709+42	EB/WB	670		34			34		
2709+42	TO	2711+72	EB/WB	230	6	15		6	15		
2711+72	TO	2712+37	EB/WB	65							
2712+37	TO	2714+67	EB/WB	230	6	15		6	15		
2714+67	TO	2721+37	EB/WB	670		34			34		
2721+37	TO	2766+28	EB/WB	4491			56			56	
SUBTOTAL						193	103	128	193	103	128
TOTAL							424			424	

TEMPORARY RAMP SCHEDULE					
LOCATION		TEMP RAMP 1.5"			TEMPORARY RAMP
STATION	DESCRIPTION	LENGTH (FT)	WIDTH (FT)	AREA (SY)	
US 50					
2592+90.00	EB BEGIN PROJECT	5.00	25.00	13.9	13.9
2592+90.00	WB BEGIN PROJECT	5.00	25.00	13.9	13.9
2618+42.00	EB ON RAMP (IL 160)	2.00	850.00	188.9	188.9
2620+82.00	WB OFF RAMP (IL 160)	2.00	300.00	66.7	66.7
2712+03.83	NB CRACKERNECK RD	2.00	160.00	35.6	35.6
2712+03.83	SB CRACKERNECK RD	2.00	160.00	35.6	35.6
2766+28.08	END PROJECT	5.00	25.00	13.9	13.9
TOTAL					368

1. PROVIDE 2' TEMPORARY RAMP AT RAMPS AND SIDEROADS.

MODEL: Default
FILE: \\nrc\p\project\room\dat\illinois\gov\p\w\dot\Documents\DOT_Offices\Illinois\DOT\Projects\10276\76M76\ch-schedule.dgn

USER NAME = freimuthpd	DESIGNED -	REVISED -
	DRAWN -	REVISED -
PLOT SCALE = 100.0000' / in.	CHECKED -	REVISED -
PLOT DATE = 6/1/2019	DATE -	REVISED -

STATE OF ILLINOIS
DEPARTMENT OF TRANSPORTATION

SCHEDULES OF QUANTITIES

SCALE: N.T.S. SHEET 1 OF 1 SHEETS STA. TO STA.

F.A.P. RTE.	SECTION	COUNTY	TOTAL SHEETS	SHEET NO.
327	14-12RS-2	CLINTON	8	6
CONTRACT NO. 76M76				
ILLINOIS FED. AID PROJECT				

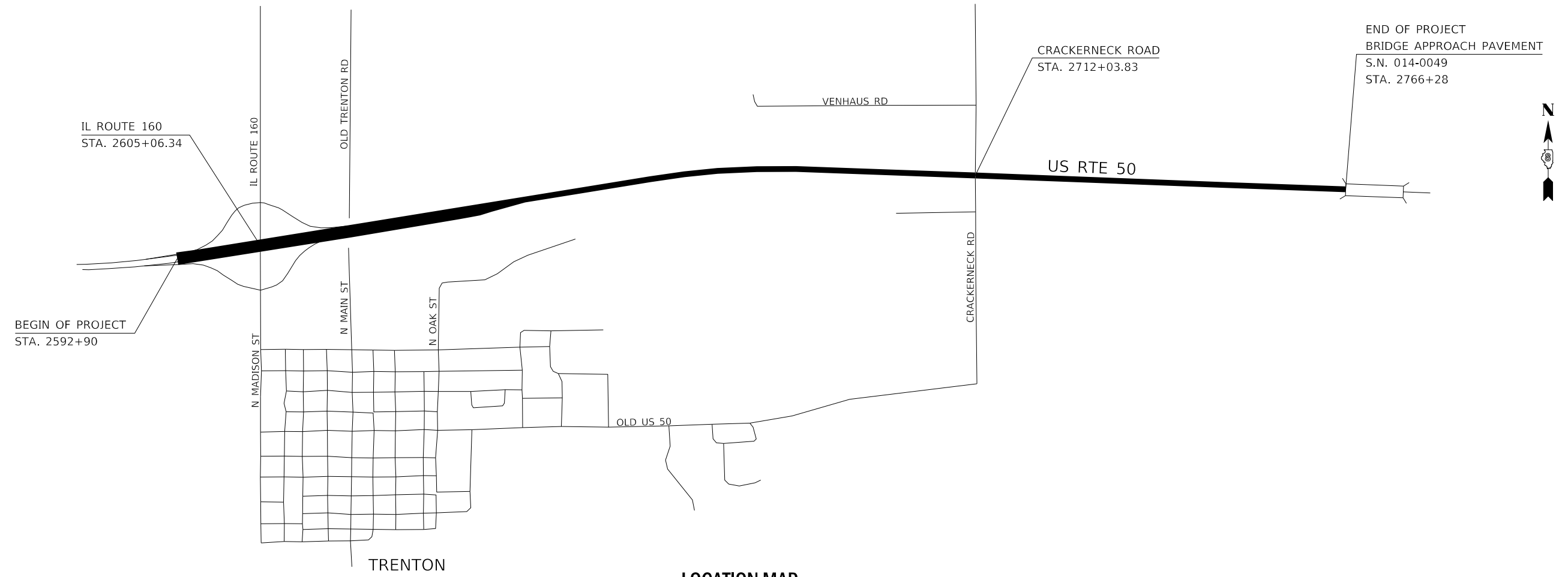

LOCATION MAP
NOT TO SCALE

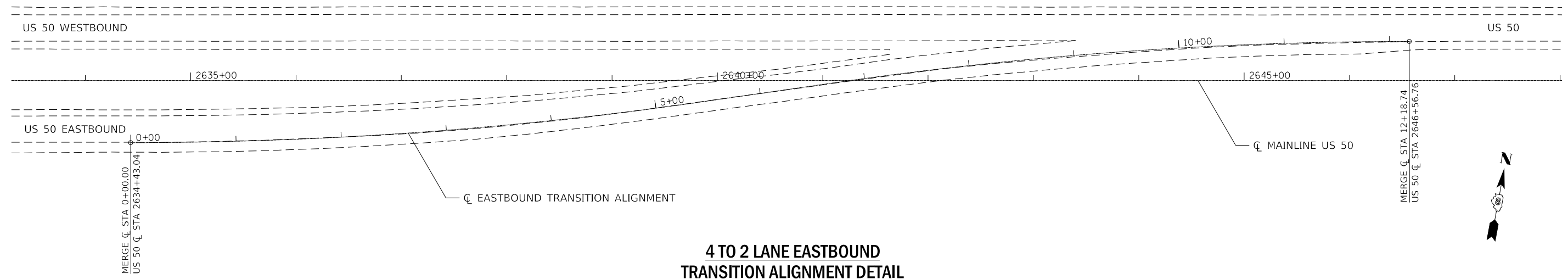

**4 TO 2 LANE EASTBOUND
TRANSITION ALIGNMENT DETAIL**
NOT TO SCALE

MODEL: Default
 FILE: \\nrc-pix\pub\room.d\illinois.gov\PIWIDOT\Documents\DOT_Offices\Dir\ctc @Projects\0776M76\CADD\03a\CADD\sheets\0776M76-shc-ctb.dgn

USER NAME = freimthpd	DESIGNED -	REVISED -
	DRAWN -	REVISED -
PLOT SCALE = 100,0000' / in.	CHECKED -	REVISED -
PLOT DATE = 6/1/2019	DATE -	REVISED -

**STATE OF ILLINOIS
DEPARTMENT OF TRANSPORTATION**

LOCATION MAP & ALIGNMENT DETAIL			
SCALE: N.T.S.	SHEET 1	OF 1 SHEETS	STA. TO STA.

F.A.P. RTE.	SECTION	COUNTY	TOTAL SHEETS	SHEET NO.
327	14-12RS-2	CLINTON	8	7
CONTRACT NO. 76M76				
ILLINOIS FED. AID PROJECT				

