

INDEX OF SHEETS

- 1. COVER SHEET
- 2. GENERAL NOTES
- 3-4. SUMMARY OF QUANTITIES
- 5. TYPICAL SECTION
- 6-7. SCHEDULES
- 8. TRAFFIC CONTROL AND PROTECTION, STANDARD 701400 (SPECIAL)
- 9. PAVEMENT MARKING
- 10-11. CLASS A PATCHING DETAILS

STANDARDS

- 000001-06 STANDARD SYMBOLS, ABBREVIATIONS AND PATTERNS
- 001001-02 AREAS OF REINFORCEMENT BARS
- 001006 DECIMAL OF AN INCH AND OF A FOOT
- 701101-05 OFF-ROAD OPERATIONS MULTILANE, 15' (4.5 m) TO 24" (600 mm) FROM PAVEMENT EDGE
- 701401-09 LANE CLOSURE, FREEWAY/EXPRESSWAY
- 701426-08 LANE CLOSURE, MULTILANE INTERMITTENT OR MOVING OPERATION, FOR SPEEDS ≥ 45 MPH
- 701428-01 TRAFFIC CONTROL SETUP AND REMOVAL FREEWAY/EXPRESSWAY
- 701901-05 TRAFFIC CONTROL DEVICES
- 701411-09 LANE CLOSURE, MULTILANE, AT ENTRANCE OR EXIT RAMP, FOR SPEEDS ≥ 45 MPH

**STATE OF ILLINOIS
DEPARTMENT OF TRANSPORTATION
DIVISION OF HIGHWAYS**

**PROPOSED
HIGHWAY PLANS**

**FAI ROUTE 39 (I-39)
SECTION D3 PATCHING 2017-10
CRC PAVEMENT PATCHING
LASALLE COUNTY
C-93-078-16**

F.A.I. RITE	SECTION	COUNTY	TOTAL SHEETS	SHEET NO.
39	D3 PATCHING 2017-10	LASALLE	11	1
		ILLINOIS	CONTRACT NO. 66F44	

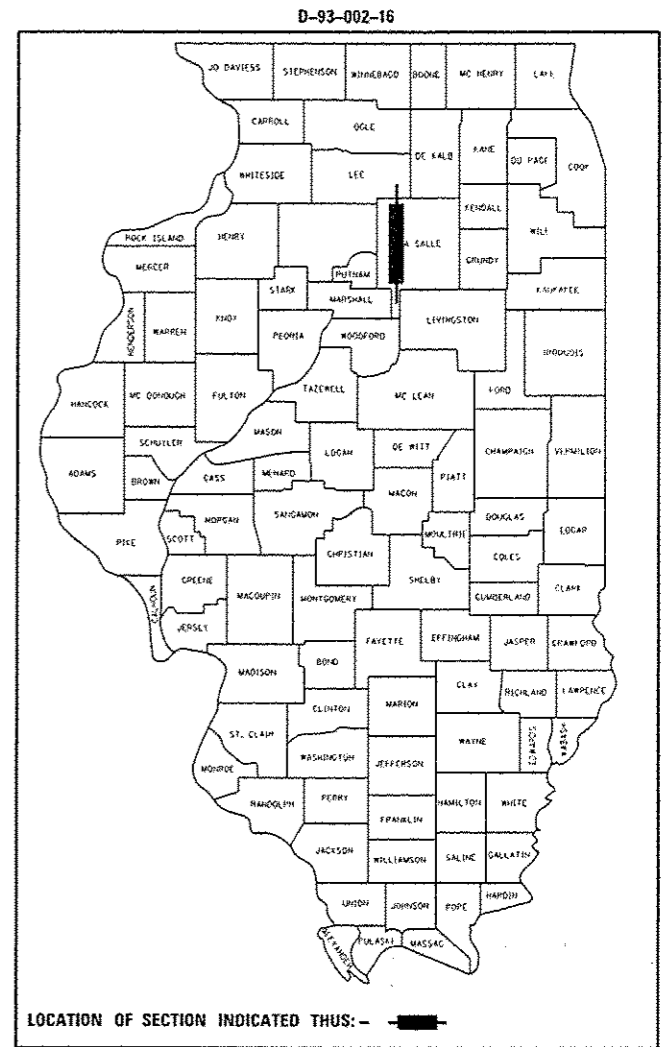

FUNCTIONAL CLASSIFICATION
RURAL - INTERSTATE
F.A.I. ROUTE 39 (I-39)
2015 ADT = 19400
P.V = 41.14% S.U. = 13.92% M.U. = 44.94%

STATE OF ILLINOIS
DEPARTMENT OF TRANSPORTATION
DIVISION OF HIGHWAYS

SUBMITTED May 19 2016
Paul Costello
DEPUTY DIRECTOR OF HIGHWAYS, REGION ENGINEER

July 1 2016
Maureen M. Addis, P.E.
ENGINEER OF DESIGN AND ENVIRONMENT

July 1 2016
Cher Cowan, P.E.
DIRECTOR OF HIGHWAYS, CHIEF ENGINEER

**PRINTED BY THE AUTHORITY
OF THE STATE OF ILLINOIS**

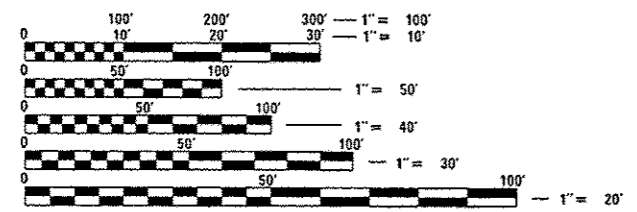

FULL SIZE PLANS HAVE BEEN PREPARED USING STANDARD ENGINEERING SCALES. REDUCED SIZED PLANS WILL NOT CONFORM TO STANDARD SCALES. IN MAKING MEASUREMENTS ON REDUCED PLANS, THE ABOVE SCALES MAY BE USED.

J.U.L.I.E.
JOINT UTILITY LOCATION INFORMATION FOR EXCAVATION
1-800-892-0123
OR 811

PROJECT ENGINEER: JOE KANNEL P.E.
UNIT CHIEF: RON WOODSHANK

CONTRACT NO. 66F44

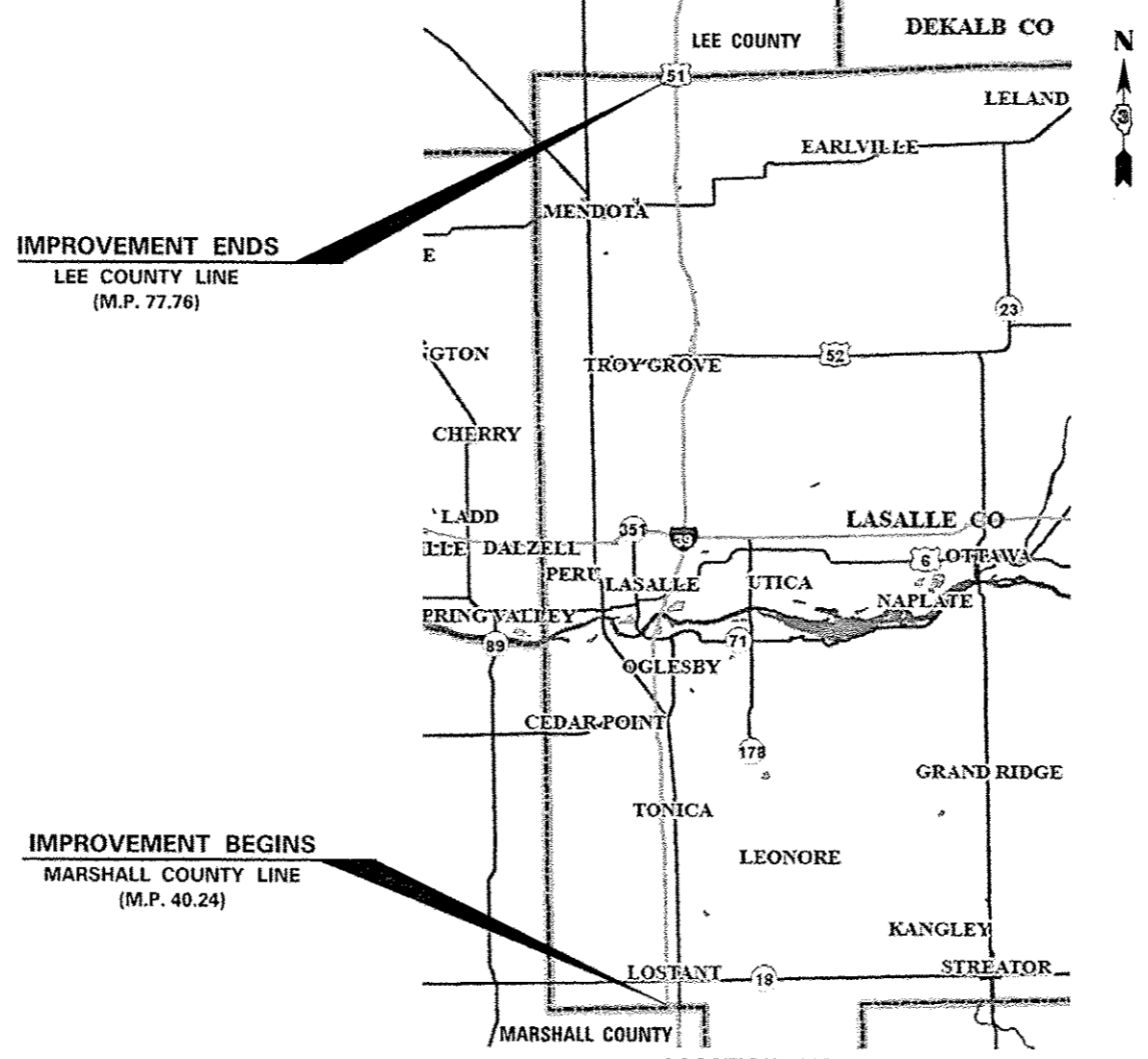

LOCATION MAP
NOT TO SCALE
GROSS LENGTH = 198106 FT. = 37.52 MI.
NET LENGTH = 844 FT. = 0.16 MI.

GENERAL NOTES

COMMITMENTS

PLAN DIMENSIONS AND DETAILS RELATIVE TO EXISTING PLANS ARE SUBJECT TO NOMINAL CONSTRUCTION VARIATIONS. THE CONTRACTOR SHALL FIELD VERIFY EXISTING DIMENSIONS AND DETAILS AFFECTING NEW CONSTRUCTION AND MAKE NECESSARY APPROVED ADJUSTMENTS PRIOR TO CONSTRUCTION OR ORDERING OF MATERIALS. SUCH VARIATIONS SHALL NOT BE CAUSE FOR ADDITIONAL COMPENSATION FOR A CHANGE IN SCOPE OF WORK; HOWEVER, THE CONTRACTOR WILL BE PAID FOR THE QUANTITY ACTUALLY FURNISHED AT THE UNIT PRICE BID FOR THE WORK.

ON EXISTING PAVEMENT WHICH MAY BE SUPERELEVATED. THE NEW CONCRETE PAVEMENT SHALL BE BUILT WITH THE SAME SUPERELEVATION UNLESS NEW SUPERELEVATION RATES ARE GIVEN ON THE PLANS.

ANY REFERENCE TO A STANDARD IN THESE PLANS SHALL BE INTERPRETED TO MEAN THE EDITION AS INDICATED BY THE SUBNUMBER SHOWN IN THE LIST OF STANDARDS OR THE COPY INCLUDED IN THESE PLANS.

THE CONTRACTOR SHALL CONTACT JULIE AT LEAST 48 HOURS PRIOR TO EXCAVATION TO DETERMINE WHICH UTILITIES ARE IN THE AREA.

ALL EXCAVATED MATERIAL, WHICH INCLUDES DIGGING OR GRADING OF ANY SOIL OR FILL MATERIAL, WITH THE EXCEPTION OF AGGREGATE FILLS, MUST BE INCORPORATED WITHIN THE IDOT RIGHT OF WAY DUE TO ENVIRONMENTAL DOCUMENTATION REQUIREMENTS.

STATE OF ILLINOIS
DEPARTMENT OF TRANSPORTATION
DISTRICT THREE
AS BUILT INFORMATION

SUPERVISING CONSTRUCTION FIELD ENGINEER

RESIDENT ENGINEER / TECHNICIAN

START & END DATES
OF CONSTRUCTION:

INSPECTORS:

DATE: May 19, 2016

PREPARED BY: Tom Beavin
DISTRICT STUDIES & PLANS ENGINEER

EXAMINED BY: Keith K. Jung
DISTRICT CONSTRUCTION ENGINEER

Wayne Phillips
DISTRICT MATERIALS ENGINEER

Tom Hupre
DISTRICT OPERATIONS ENGINEER

FILE NAME : p:\N\08468100\TEG\Illinois\p\100740	USER NAME : woodshark	DESIGNED - RW	REVISED -	STATE OF ILLINOIS DEPARTMENT OF TRANSPORTATION	GENERAL NOTES	F.A.I. RTE.	SECTION	COUNTY	TOTAL SHEETS	SHEET NO.	
	PROJECT: 100740 District 3 Projects	DRAWN: 08/06/16 RW-shk-detailed.dgn	REVISED -			39	D3 PATCHING 2017-10	LASALLE	11	2	
	PLOT SCALE: 100,0000 / 10	CHECKED - TP	REVISED -			CONTRACT NO. 66F44					
	PLOT DATE: 5/16/2016	DATE: 4/6/2016	REVISED -			SCALE:	SHEET NO. 1 OF 1 SHEETS	STA.	TO STA.	ILLINOIS	

CODE NO.	ITEM	UNIT	TOTAL QUANTITY	CONSTR. CODE
				CONT. MAINT.
				100% STATE
				ROADWAY
				0005
				RURAL
44200553	CLASS A PATCHES, TYPE II, 10 INCH	SQ YD	232	232
44200557	CLASS A PATCHES, TYPE III, 10 INCH	SQ YD	224	224
44200559	CLASS A PATCHES, TYPE IV, 10 INCH	SQ YD	507	507
44213000	PATCHING REINFORCEMENT	SQ YD	963	963
44213200	SAW CUTS	FOOT	3865	3865
44213204	TIE BARS 3/4"	EACH	1502	1502
67100100	MOBILIZATION	LSUM	1	1
70100420	TRAFFIC CONTROL AND PROTECTION, STANDARD 701411	EACH	40	40
70103815	TRAFFIC CONTROL SURVEILLANCE	CAL DA	7	7
70106800	CHANGEABLE MESSAGE SIGN	CAL MO	1	1
* 78008210	POLYUREA PAVEMENT MARKING TYPE I - LINE 4"	FOOT	947	947
* 78008230	POLYUREA PAVEMENT MARKING TYPE I - LINE 6"	FOOT	580	580
X0326880	MESSAGE BOARD VEHICLE DRIVER	HOURL	70	70
X0326907	PORTABLE, VEHICLE MOUNTED, CHANGEABLE MESSAGE SIGN	CAL MO	1	1

14 *SPECIALITY ITEMS

FILE NAME : p:\11\08469\INTEC\illinois.gov\PWID01\0	USER NAME : woodshankr1	DESIGNED - RW	REVISED -	STATE OF ILLINOIS DEPARTMENT OF TRANSPORTATION	SUMMARY OF QUANTITIES	F.A.I. RYE.	SECTION	COUNTY	TOTAL SHEETS	SHEET NO.	
	Comments: 1001 - Of Files\District 3\Projects\036	DRAWN Data: 0366 RW	REVISED -			39	03 PATCHING 2017-10	LASALLE	11	3	
	PLOT SCALE = 100.0000 / in.	CHECKED - TP	REVISED -			CONTRACT NO. 66F44					
	PLOT DATE : 3/18/2016	DATE - 4/6/2016	REVISED -			SCALE:	SHEET NO. 1 OF 2 SHEETS	STA.	TO STA.	[ILLINOIS]	

CODE NO.	ITEM	UNIT	TOTAL QUANTITY	CONSTR. CODE
				CONT. MAINT.
				100% STATE
				ROADWAY
				0005
				RURAL
X7010410	SPEED DISPLAY TRAILER	CAL MO	1	1
X7010805	TRAFFIC CONTROL AND PROTECTION, STANDARD 701401 (SPECIAL)	LSUM	1	1

2

SCHEDULE - CLASS A PATCHING
NORTHBOUND LANES

LOCATION	PASSING LANE FEET	PASSING LANE					DRIVING LANE FEET	DRIVING LANE				
		CLASS A TYPE II 10"		PATCH REINF. SQ YD	SAW CUTS FOOT	TIE BARS 3/4" EACH		CLASS A TYPE II 10"		PATCH REINF. SQ YD	SAW CUTS FOOT	TIE BARS 3/4" EACH
MILE POST		SO YD	SO YD						SO YD			
40.4	35		47	47	141	41						
41.0					0		6	8		8	54	24
47.3					0		80	0	107	107	276	64
47.8					0		40	0	53	53	156	44
48.5					0		10	13		13	66	24
56.4	6	8		8	48	24						
57.8							130	0	87	87	296	89
61.3							6	8		8	48	24
65.9							6	8		8	48	24
66.0							6	8		8	48	24
68.4							8	11		11	52	24
68.5							40	0	27	27	116	44
70.7							80	0	53	53	196	64
70.7							6	8		8	48	24
72.1							80	0	53	53	196	64
74.4							6	8		8	48	24
76.4							120	0	80	80	276	84
SUBTOTALS	41	8	47	55	189	65	624	72	460	532	1924	645

NORTHBOUND PATCHING TOTALS

CLASS A		PATCH REINF. SQ YD	SAW CUTS FOOT	TIE BARS 3/4" EACH
TYPE II 10"	TYPE IV 10"			
SO YD	SO YD	SO YD	FOOT	EACH
80	507	587	2113	710

SCHEDULE - PAVEMENT MARKING
NORTHBOUND

LOCATION	POLYUREA PAVEMENT MARKING LINE 4"		POLYUREA PAVEMENT MARKING LINE 6"
	FEET		FEET
MILE POST	YELLOW	WHITE	WHITE
40.4	35		10
41.0		6	10
47.3		80	20
47.8		40	10
48.5		10	10
56.4	6		10
57.8		130	40
61.3		6	10
65.9		6	10
66.0		6	10
68.4		8	10
68.5		40	10
70.7		80	20
70.7		6	10
72.1		80	20
74.4		6	10
76.4		120	30
SUBTOTAL	41	624	
NB TOTALS	665		250

**STATE OF ILLINOIS
DEPARTMENT OF TRANSPORTATION**

**PAVEMENT PATCHING SCHEDULES
NORTHBOUND**

F.A.I. RTE.	SECTION	COUNTY	TOTAL SHEETS	SHEET NO.
39	D3 PATCHING 2017-10	LASALLE	11	6
			CONTRACT NO. 66F44	
[ILLINOIS]				

SCALE: SHEET NO. 1 OF 3 SHEETS STA. TO STA.

FILE NAME:	USER NAME: woodthorpe1	DESIGNED: RW	REVISED:
\\p1\B084E81D\INTEC\illinois.gov\p1\001\Documents\1001_Districts\District 2\Projects\038	DRAWN: Date\0360\RW\shl-ds\shl.dgn	CHECKED: TP	REVISED:
	PLOT SCALE: = 100.0000 / in.	DATE: 4/6/2016	REVISED:
	PLOT DATE: 5/16/2016		

SCHEDULE - CLASS A PATCHING
SOUTHBOUND LANES

LOCATION MILE POST	PASSING LANE FEET	PASSING LANE					DRIVING LANE FEET	DRIVING LANE				
		CLASS A		PATCH REINF.	SAW CUTS	TIE BARS 3/4"		CLASS A		PATCH REINF.	SAW CUTS	TIE BARS 3/4"
		TYPE II 10"	TYPE III 10"					TYPE II 10"	TYPE III 10"			
		SQ YD	SQ YD	SQ YD	FOOT	EACH		SQ YD	SQ YD	SQ YD	FOOT	EACH
76.8							6	8		8	48	24
76.0							6	8		8	48	24
74.4							12		16	16	60	24
74.1							12		16	16	60	24
73.9							6	8		8	48	24
73.3	6	8		8	48	24						
72.6							12		16	16	60	24
72.0							12		16	16	60	24
71.2							12		16	16	60	24
71.2	6	8		8	48	24						
71.0							6	8		8	48	24
70.9							12		16	16	60	24
70.1							6	8		8	48	24
70.0	6	8		8	48	24		0				
68.7							6	8		8	48	24
68.7	6	8		8	48	24						
68.4							12		16	16	60	24
67.2							12		16	16	60	24
66.4							6	8		8	48	24
65.9							6	8		8	48	24
65.3							12		16	16	60	24
60.0							12		16	16	60	24
54.5	6	8		8	48	24						
54.4	6	8		8	48	24						
54.1							6	8		8	48	24
51.4							6	8		8	48	24
47.1							12		16	16	60	24
44.7	12		16	16	60	24						
44.5							6	8		8	48	24
43.0	6	8	0	8	48	24						
42.5							6	8		8	48	24
40.8	12		16	16	60	24						
40.6	12		16	16	60	24						
SUBTOTALS	78	56	48	104	516	240	204	96	176	272	1236	552

SOUTHBOUND PATCHING TOTALS

CLASS A		PATCH REINF.	SAW CUTS	TIE BARS 3/4"
TYPE II 10"	TYPE III 10"			
SQ YD	SQ YD	SQ YD	FOOT	EACH
152	224	376	1752	792

SCHEDULE - PAVEMENT MARKING
SOUTHBOUND

LOCATION MILE POST	POLYUREA PAVEMENT MARKING TYPE I LINE 4"		POLYUREA PAVEMENT MARKING TYPE I LINE 6"
	FEET		FEET
	YELLOW	WHITE	WHITE
76.8		6	10
76.0		6	10
74.4		12	10
74.1		12	10
73.9		6	10
73.3	6		10
72.6		12	10
72.0		12	10
71.2		12	10
71.2	6		10
71.0		6	10
70.9		12	10
70.1		6	10
70.0	6		10
68.7		6	10
68.7	6		10
68.4		12	10
67.2		12	10
66.4		6	10
65.9		6	10
65.3		12	10
60.0		12	10
54.5	6		10
54.4	6		10
54.1		6	10
51.4		6	10
47.1		12	10
44.7	12		10
44.5		6	10
43.0	6		10
42.5		6	10
40.8	12		10
40.6	12		10
SUBTOTAL	78	204	
SB TOTALS	282		330

STATE OF ILLINOIS
DEPARTMENT OF TRANSPORTATION

PAVEMENT PATCHING SCHEDULES
SOUTHBOUND

F.A.I. RTE.	SECTION	COUNTY	TOTAL SHEETS	SHEET NO.
39	D3 PATCHING 2017-10	LASALLE	11	7
ILLINOIS			CONTRACT NO. 66F44	

FILE NAME :	USER NAME :	DESIGNED -	REVISED -
\\p01\l0846\BID\ITC\Illinois\gov\PK100T\Documents\100T_Districts\District_3\Projects\036\DRAWNData\0360\RW\shl-details.dgn	woodshenk1	RW	
PLOT SCALE :	PLOT DATE :	CHECKED -	REVISED -
100:1=1	5/10/2016	TP	
		DATE -	REVISED -
		4/6/2016	

SCALE: SHEET NO. 2 OF 3 SHEETS STA. TO STA.

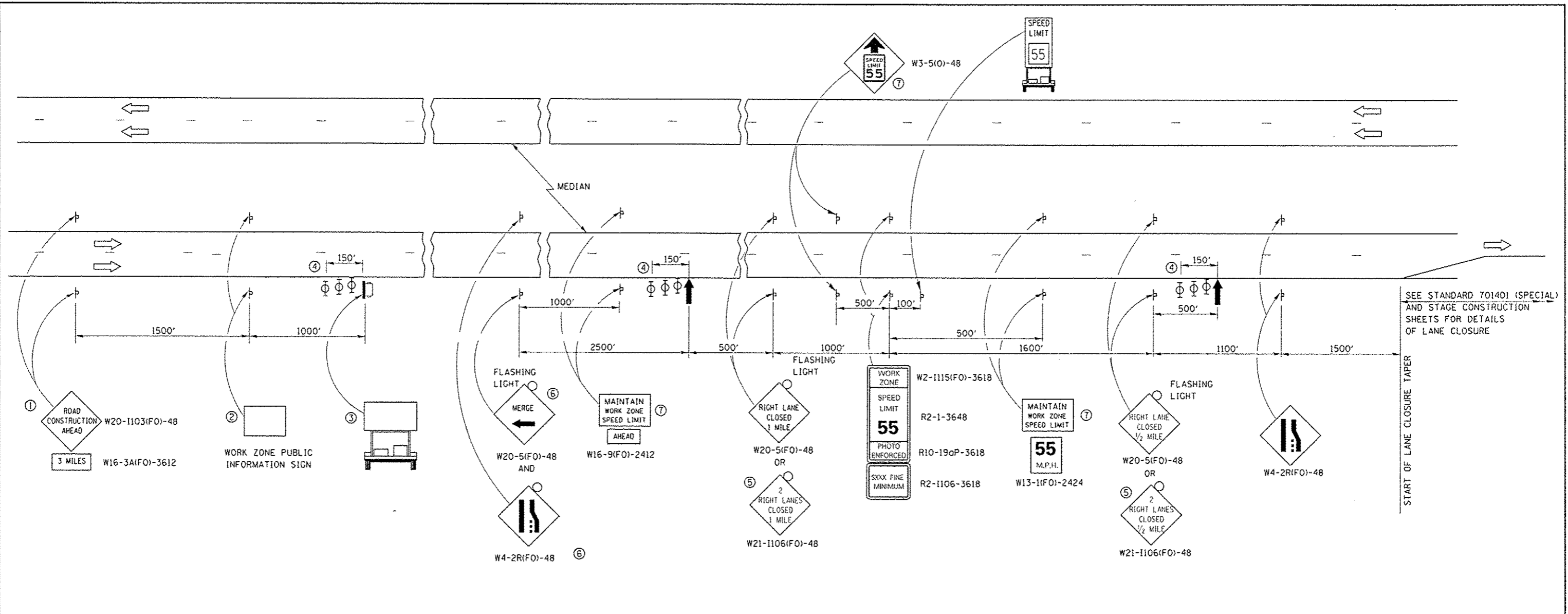

SEE STANDARD 701401 (SPECIAL) AND STAGE CONSTRUCTION SHEETS FOR DETAILS OF LANE CLOSURE

- ① THE ROAD CONSTRUCTION AHEAD SIGN SHALL BE LOCATED 3 MILES IN ADVANCE OF THE PROJECT LIMITS.
- ② THE MESSAGE AND SIZE OF THE WORK ZONE PUBLIC INFORMATION SIGN SHALL BE AS SPECIFIED BY THE DEPARTMENT.
- ③ TO BE PLACED IN THE MEDIAN WHEN FEASIBLE. THE MESSAGE BOARD SHALL BE USED TO DISPLAY STATUS OF LANES WITHIN THE PROJECT. THE PRIMARY MESSAGES SHALL BE:
"RIGHT LANE CLOSED" / " X MILES AHEAD"
"LEFT LANE CLOSED" / " X MILES AHEAD"
"ALL LANES OPEN"
- ④ THREE, TYPE II BARRICADES, DRUMS, OR VERTICAL BARRICADES AT 50' CENTERS.
- ⑤ THIS SIGN SHALL BE USED WHEN 2 LANES ARE CLOSED.
- ⑥ WHEN THE LEFT LANE IS CLOSED, SWITCH THESE TWO SIGNS AND THE DIRECTION OF THE MERGE ARROW.
- ⑦ THIS SIGN SHALL ONLY BE USED IF THE EXISTING SPEED LIMIT IS GREATER THAN 65 MPH.

- ⑦ 48"x36" FLUORESCENT ORANGE SIGN WITH BLACK LETTERS.
48"
- | | |
|-------------|----|
| MAINTAIN | 8" |
| WORK ZONE | 6" |
| SPEED LIMIT | 6" |
- ↑ ARROW BOARD
 - PORTABLE CHANGEABLE MESSAGE SIGN
 - ⊞ SIGN
 - ⊞ TYPE II BARRICADE, DRUM, OR VERTICAL BARRICADE WITH MONODIRECTIONAL FLASHING LIGHT
 - LANE DROP ARROW - SEE STANDARD 780001
 - ⊞ SPEED DISPLAY TRAILER

GENERAL NOTE:

THIS STANDARD IS USED WHERE AT ANY TIME A LANE IS CLOSED ON A FREEWAY/EXPRESSWAY.

WHEN THE LEFT LANE IS CLOSED, LEFT LANE CLOSED SIGNS SHALL BE SUBSTITUTED FOR THE RIGHT LANE CLOSED SIGNS.

THE FIRST TWO SIGNS AND THE MESSAGE BOARD ARE STATIONARY. THE OTHER SIGNS AND ARROWBOARDS SHALL BE MOVED AS NECESSARY TO MAINTAIN THE REQUIRED DISTANCE FROM THE START OF THE LANE CLOSURE TAPER(S).

SEE SPECIAL PROVISIONS.

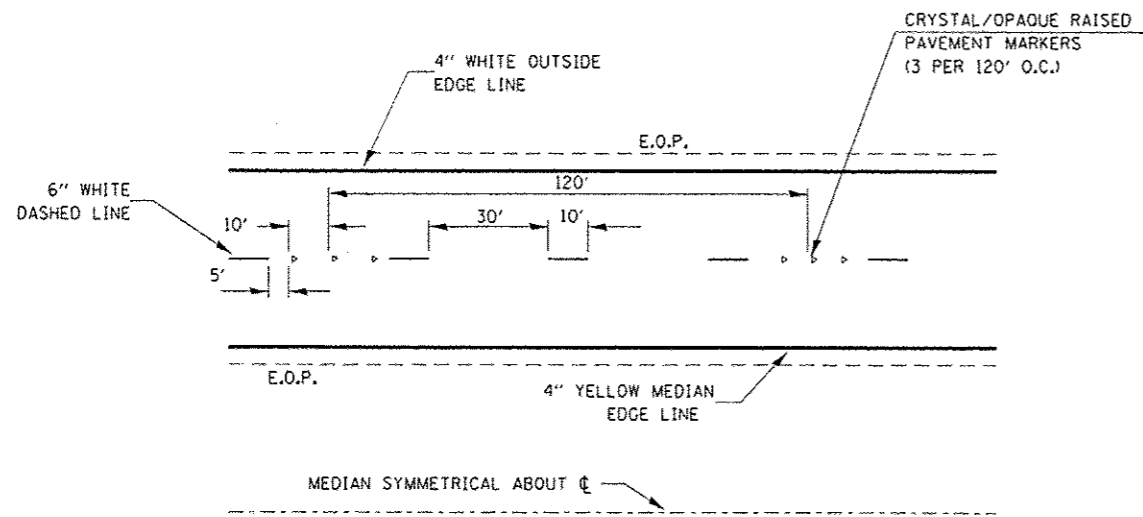

TYPICAL PAVEMENT MARKINGS

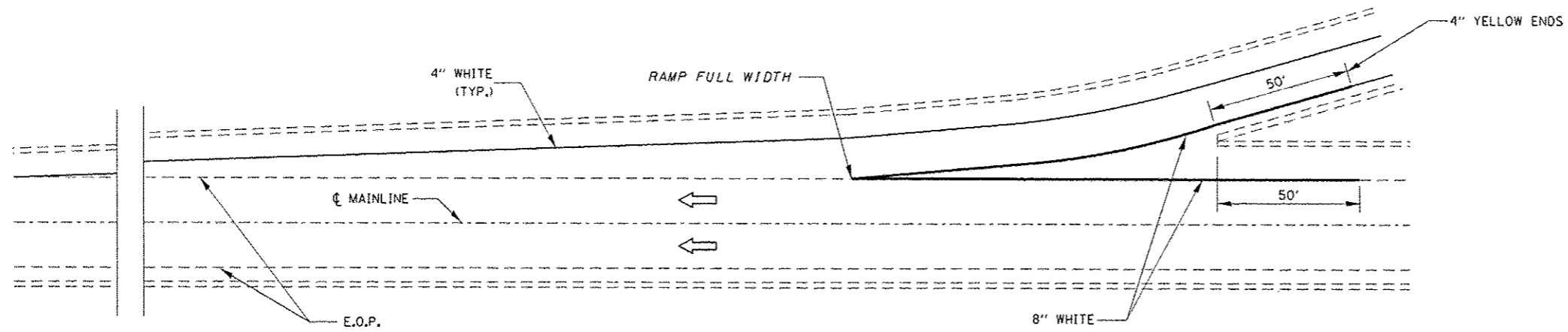

TYPICAL PAVEMENT MARKING FOR ENTRANCE RAMP TERMINALS

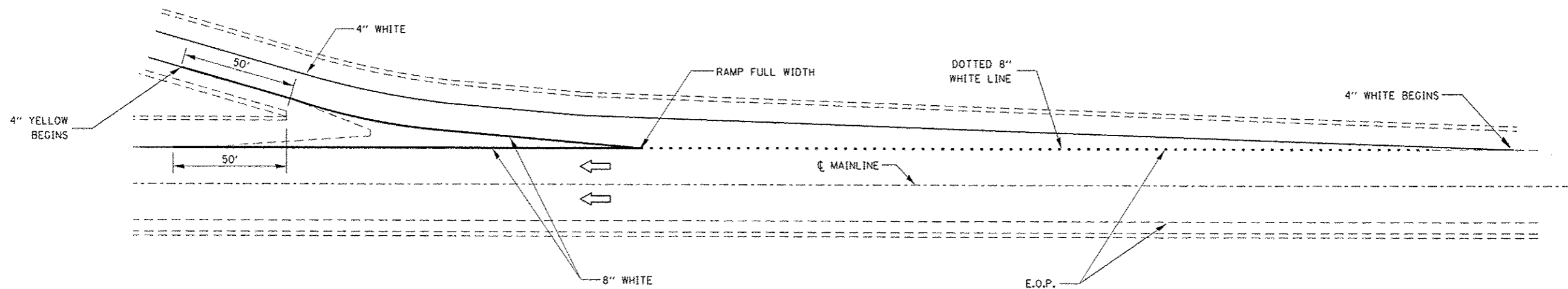

TYPICAL PAVEMENT MARKINGS FOR EXIT RAMP TERMINALS

FILE NAME :	USER NAME :	DESIGNED :	REVISED :	STATE OF ILLINOIS DEPARTMENT OF TRANSPORTATION	PAVEMENT MARKING DETAILS	F.A.I. RTE:	SECTION	COUNTY	TOTAL SHEETS	SHEET NO.	
part: IL084EBIDWTCIllinois.govPW0001-Do	Documents\DOT Office\District 3\Projects\030	DRAWN:	REVISED :			39	D3 PATCHING 2017-10	LASALLE	11	9	
		CHECKED :	REVISED :			CONTRACT NO. 66F44					
		DATE :	REVISED :			ILLINOIS					
				SCALE:	SHEET NO. 1 OF 1 SHEETS	STA.	TO STA.				

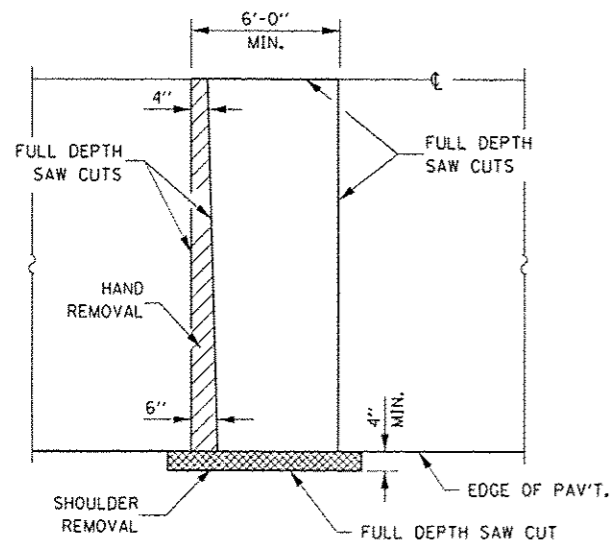

PAVEMENT SAWING DETAIL

(HMA SHOULDER)

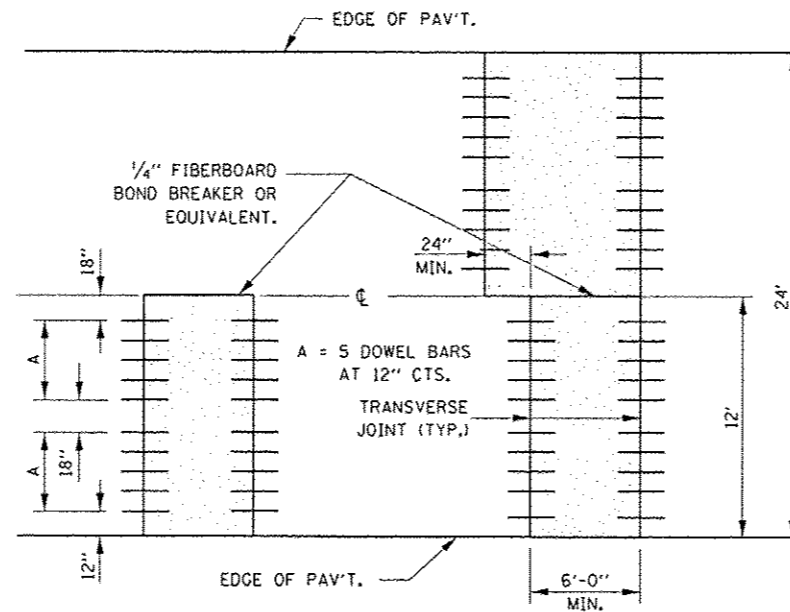

12' WIDE LANES

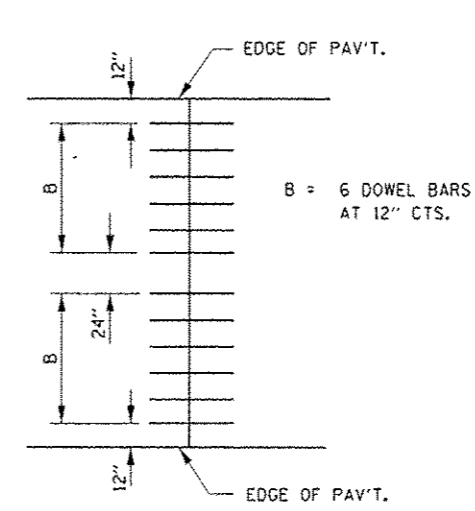

14' WIDE RAMP

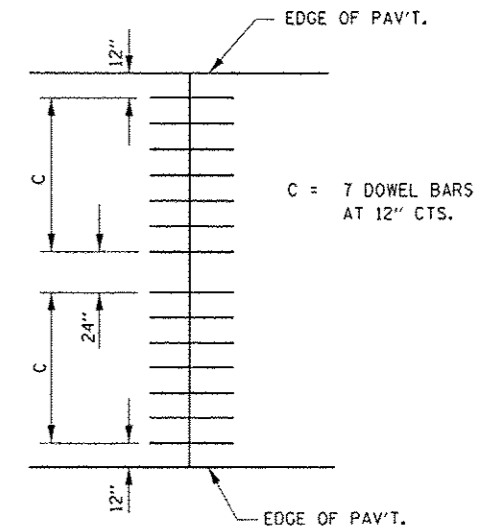

16' WIDE RAMP

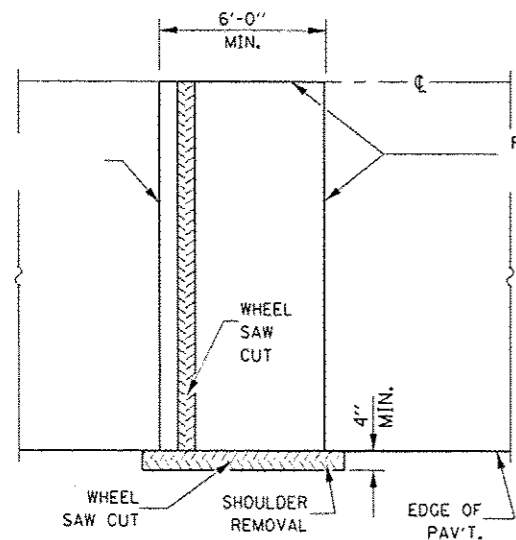

ALTERNATE SAWING DETAIL

(HMA SHOULDER)

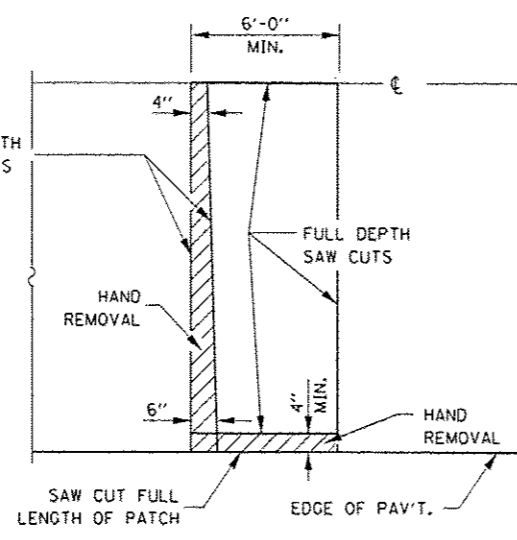

PAVEMENT SAWING DETAIL

(PCC SHOULDER)

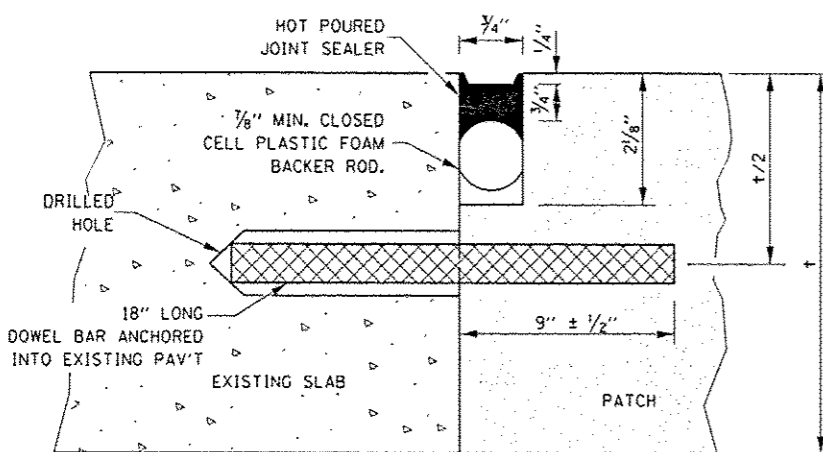

TRANSVERSE JOINT

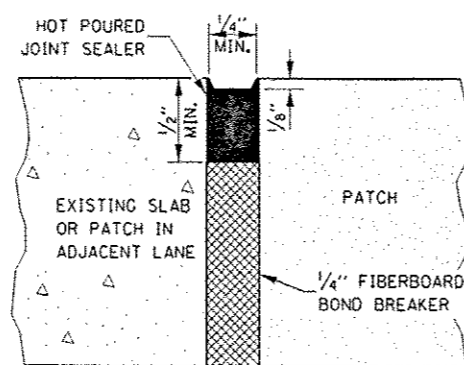

CENTERLINE JOINT

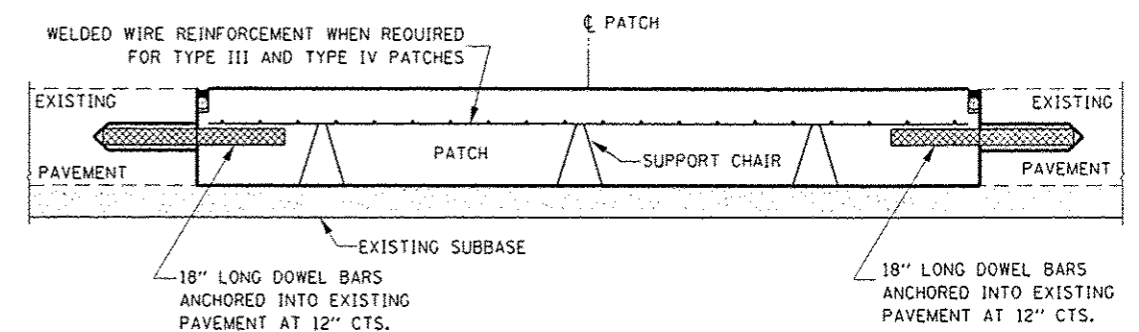

PATCHING WITHOUT HMA OVERLAY

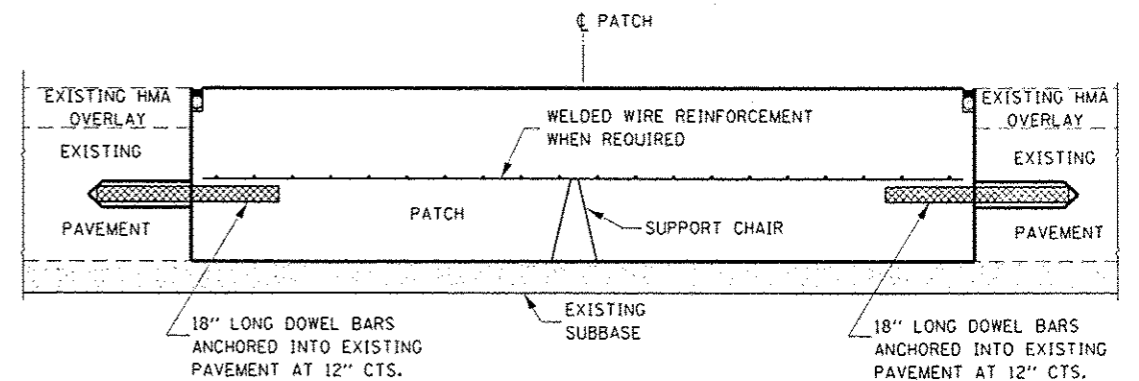

PATCHING WITH HMA OVERLAY

DOWEL BAR TABLE		
PAVEMENT THICKNESS	DOWEL BAR DIAMETER	HOLE DIAMETER
8" OR GREATER	1 1/2"	1 5/8"
7" THRU 7.99"	1 1/4"	1 3/8"
LESS THAN 7"	1"	1 1/8"

GENERAL NOTES

THE TRANSVERSE JOINTS FOR CLASS B PATCHES SHALL ALIGN WITH JOINTS OR CRACKS IN THE ADJACENT LANE WHENEVER POSSIBLE.
SEE STANDARD 420701 FOR DETAILS OF PAVEMENT WELDED WIRE REINFORCEMENT.

FILE NAME: \\ms11001\0ffices\District 3\Projects\0366\Drawings\0366RW.dwg	DESIGNED - RW	REVISED -
USER NAME: woodthorpe	DRAWN - RW	REVISED -
PLOT SCALE: 1/8" = 1'-0"	CHECKED - TP	REVISED -
PLOT DATE: 5/16/2016	DATE - 4/6/2016	REVISED -

STATE OF ILLINOIS
DEPARTMENT OF TRANSPORTATION

CLASS B PATCHING DETAILS

SCALE: SHEET NO. 1 OF 2 SHEETS STA. TO STA.

F.A.I. RTE.	SECTION	COUNTY	TOTAL SHEETS NO.
03	PATCHING 2017-10	LASALLE	11
FED. ROAD DIST. NO.		ILLINOIS FED. AID PROJECT	CONTRACT NO. 66F44

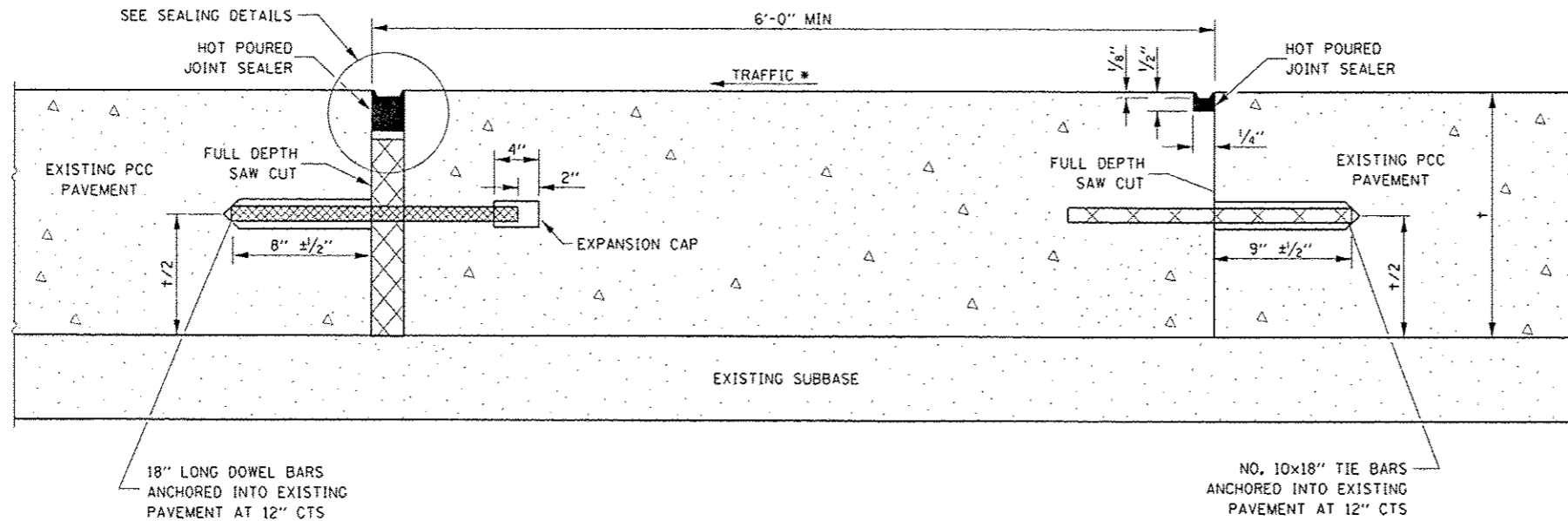

METHOD I
(WITHOUT HMA OVERLAY)

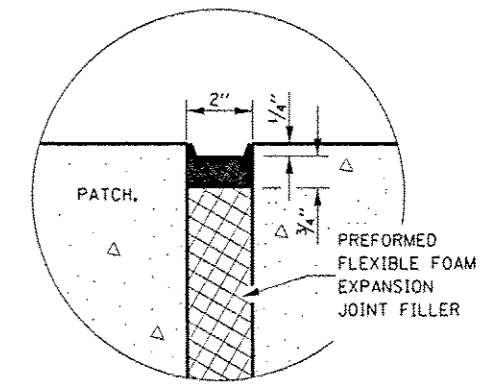

SEALING DETAIL

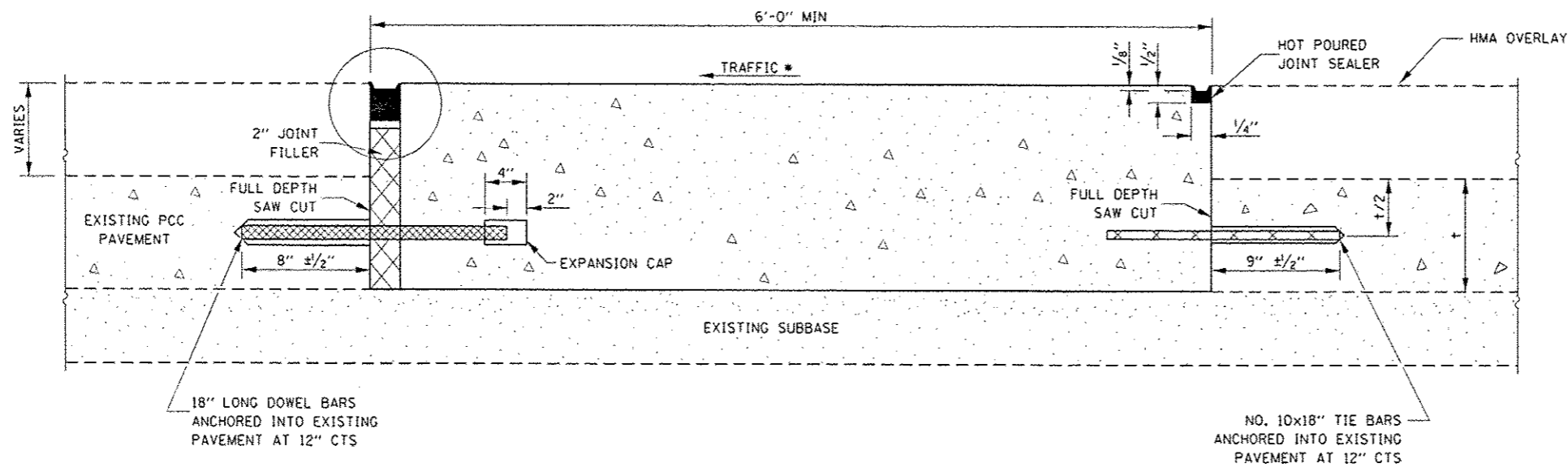

METHOD II
(WITH HMA OVERLAY)

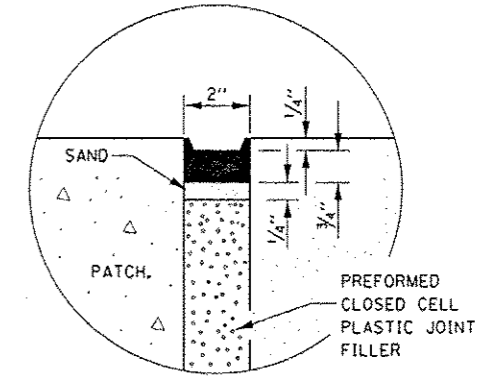

SEALING DETAIL

NOTE

* WHEN RE-ESTABLISHING A TRANSVERSE EXPANSION JOINT ON A TWO-WAY ROAD, REVERSE THE ORIENTATION OF THE DOWEL BARS WITH RESPECT TO TRAFFIC FOR ONE OF THE PATCHES SUCH THAT THE JOINT WILL BE CONTINUOUS ACROSS BOTH LANES.

FILE NAME: \\P01\B04\B04\INTEC\Illinois\go-PM\DOT\Documents\DOT Offices\District 3\Projects\020\DRAWING\0368\RW\ht-details.dgn	USER NAME: wondshank1	DESIGNED: RW	REVISED:	STATE OF ILLINOIS DEPARTMENT OF TRANSPORTATION	CLASS B PATCHING DETAILS	F.A.I. RTE.	SECTION	COUNTY	TOTAL SHEETS	SHEET NO.
PLOT SCALE: 1/8" = 1'-0"	CHECKED: TP	REVISED:	D3 PATCHING 2017-10			LASALLE	11	11		
PLOT DATE: 5/16/2016	DATE: 4/6/2016	REVISED:	CONTRACT NO. 66F44			ILLINOIS FED. AID PROJECT				
						SCALE:	SHEET NO. 2 OF 2 SHEETS	STA. TO STA.		