

STATE OF ILLINOIS  
DEPARTMENT OF TRANSPORTATION  
DIVISION OF HIGHWAYS

**PROPOSED  
HIGHWAY PLANS**

VARIOUS ROUTES  
SECTION DIST 8 GUARDRAIL 2017-3  
GUARDRAIL REPAIRS  
VARIOUS COUNTY  
PROJECT ACHSIP-000V(076)  
C-98-038-16

F.A. RTE.	SECTION	COUNTY	TOTAL SHEETS	SHEET NO.
VARIOUS	DIST 8 GUARDRAIL 2017-3	VARIOUS	11	1
		ILLINOIS	CONTRACT NO. 76J59	

FOR INDEX OF SHEETS, SEE SHEET NO. 2

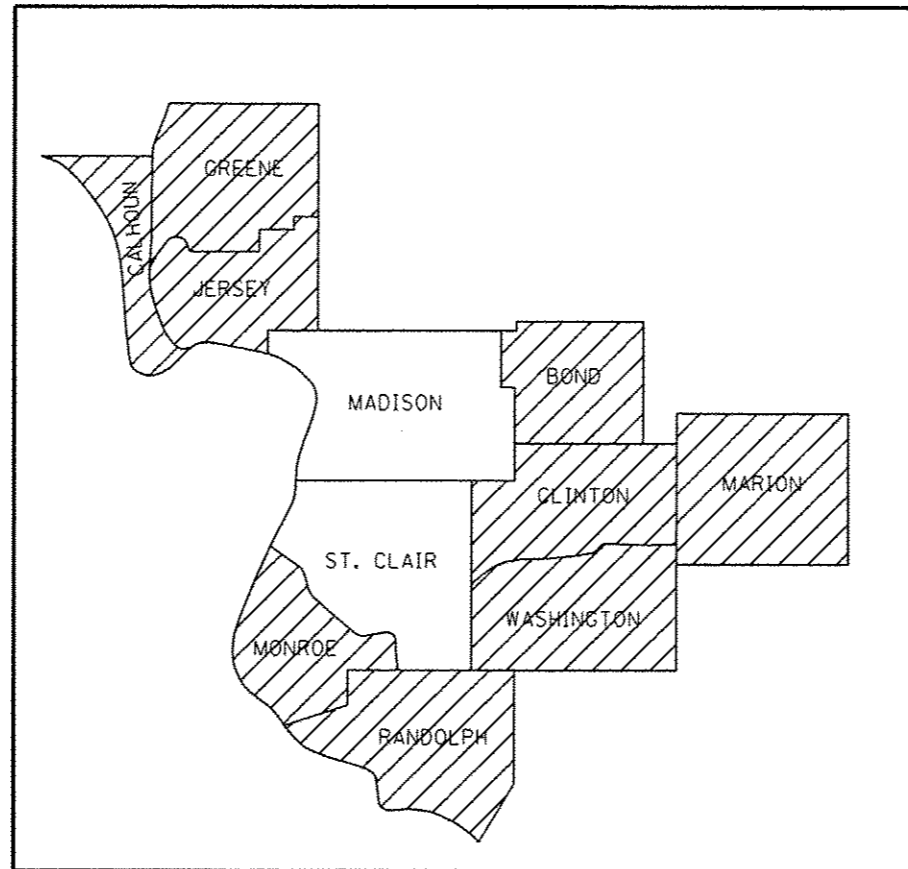

NOT TO SCALE

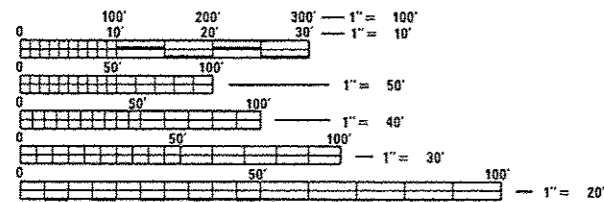

FULL SIZE PLANS HAVE BEEN PREPARED USING STANDARD ENGINEERING SCALES. REDUCED SIZED PLANS WILL NOT CONFORM TO STANDARD SCALES. IN MAKING MEASUREMENTS ON REDUCED PLANS, THE ABOVE SCALES MAY BE USED.

J.U.L.I.E.  
JOINT UTILITY LOCATION INFORMATION FOR EXCAVATION  
1-800-892-0123  
OR 811

PROJECT ENGINEER: HERVE GELIN (618) 346-3179  
PROJECT MANAGER: BILLIE OWEN (618) 346-3329

CONTRACT NO. 76J59

STATE OF ILLINOIS  
DEPARTMENT OF TRANSPORTATION  
DIVISION OF HIGHWAYS

SUBMITTED May 5 2016  
Jeffrey Z. K...  
REGIONAL ENGINEER

July 1 2016  
Mahmoud M. Addis P.E.  
ENGINEER OF DESIGN AND ENVIRONMENT

July 1 2016  
Osman P.E.  
DIRECTOR OF HIGHWAYS, CHIEF ENGINEER

**PRINTED BY THE AUTHORITY  
OF THE STATE OF ILLINOIS**

**INDEX OF SHEETS**

- 1. COVER SHEET
- 2. INDEX OF SHEETS, HIGHWAY STANDARDS, GENERAL NOTES, AND COMMITMENTS
- 3. SUMMARY OF QUANTITIES
- 4. SCHEDULES
- 5.-10. GUARDRAIL DETAILS
- 11. BRIDGE RAIL DETAILS

**HIGHWAY STANDARDS**

000001-06	701101-05
630001-10	701106-02
630101-09	701201-04
630301-06	701400-08
631011-09	701421-07
631031-14	701456-03
635001-02	701501-06
701001-02	701601-09
701006-05	701606-10
701011-04	701901-05

**COMMITMENTS**

NONE

**GENERAL NOTES**

- 1. ALL WORK IS TO BE REPLACED IN KIND OR AS INDICATED ON THE CONTRACT PLANS AND PROVISIONS.
- 2. NO MATERIAL SHALL BE LEFT ON OR NEAR THE ROADWAY DURING NON-WORKING HOURS.
- 3. ANY NECESSARY TRAFFIC CONTROL WILL BE PROVIDED BY THE CONTRACTOR; APPROPRIATE STANDARDS ARE LISTED IN THE PLANS AND CONTRACT DOCUMENTS.
- 4. ALL REFLECTORS SHALL BE PLACED AT THE DISCRETION OF THE ENGINEER. COST OF REFLECTORS TO BE INCLUDED IN THE GUARDRAIL PAY ITEMS.
- 5. ILLINOIS STATE LAW REQUIRES A 48-HOUR NOTICE TO BE GIVEN TO UTILITIES BEFORE DIGGING. FIELD MARKING OF FACILITIES MAY BE OBTAINED BY CONTACTING J.U.L.I.E. (PHONE 800-892-0123) OR FOR NON-MEMBERS, THE UTILITY COMPANY DIRECTLY.
- 6. WHEN NO WORK IS BEING PERFORMED, THE FLAGGERS WILL NOT BE REQUIRED. IF THE FLAGGERS ARE NOT PRESENT, THE FLAGGER SIGNS SHALL BE REMOVED OR COVERED.
- 7. PRIOR TO ORDERING ANY MATERIALS, THE CONTRACTOR SHALL CONFIRM THE TYPES AND SPECIFIC MANUFACTURER FOR THE GUARDRAIL.
- 8. NO OVERNIGHT LANE CLOSURES WILL BE ALLOWED.
- 9. ARTICLE 701.20 OF THE STANDARD SPECIFICATIONS DISCUSSES AN ADJUSTED UNIT PRICE. NO ADJUSTMENTS SHALL BE MADE TO THE TRAFFIC CONTROL PAY ITEMS FOR THIS CONTRACT.
- 10. THE DEPARTMENT STRONGLY ENCOURAGES THE PRIME CONTRACTOR AND THEIR SUB-CONTRACTORS TO HIRE MINORITY, WOMEN AND DISADVANTAGED INDIVIDUALS FROM ITS FEDERALLY FUNDED HIGHWAY CONSTRUCTION CAREERS TRAINING PROGRAM (HCCTP) TO HELP MEET WORKFORCE AND TRAINEE GOALS. THIS PROGRAM IS TRAINING MINORITIES, WOMEN AND DISADVANTAGED INDIVIDUALS IN HIGHWAY CONSTRUCTION-RELATED SKILLS, E.G., MATH FOR THE TRADES, JOB READINESS, TECHNICAL SKILLS COURSEWORK (CARPENTRY, CONCRETE FLATWORK, BLUEPRINT READING, SITE PLANS, SITE WORK, TOOLS USE, ETC.) AND OSHA 10 HOUR CERTIFICATION, TO PREPARE THEM FOR A CAREER IN THE HIGHWAY CONSTRUCTION TRADES. GRADUATES ARE WELL-TRAINED AND READY TO BECOME PRODUCTIVE ENTRY-LEVEL CONSTRUCTION WORKERS. CONTACT THE DISTRICT EEO OFFICE AT 618-346-3360 AND OR THE HCCTP COORDINATOR AT 618-874-6528 TO LEARN MORE ABOUT THE PROGRAM AND FOR ASSISTANCE IN MEETING WORKFORCE AND TRAINEE GOALS.

FILE NAME = p:\2016\EB\INTEG\illinois.gov\PI001\Documents\DOT\Office\District B\Projects\0875-01\Drawings\CA0\sheet\0876J59-ent-gend.dwg	USER NAME = DintelmanJN	DESIGNED -	REVISED -	STATE OF ILLINOIS DEPARTMENT OF TRANSPORTATION	INDEX OF SHEETS, HIGHWAY STANDARDS, GENERAL NOTES AND COMMITMENTS	F.A. RTE.	SECTION	COUNTY	TOTAL SHEETS	SHEET NO.
	PLOT SCALE = 100.0000' / 1" / 1" / 1"	CHECKED -	REVISED -			VARIOUS	DIST B GUARDRAIL 2017-3	VARIOUS	11	2
Default	PLOT DATE = 5/6/2016	DATE -	REVISED -	SCALE: NONE	SHEET OF SHEETS	STA.	TO STA.	ILLINOIS FED. AID PROJECT		





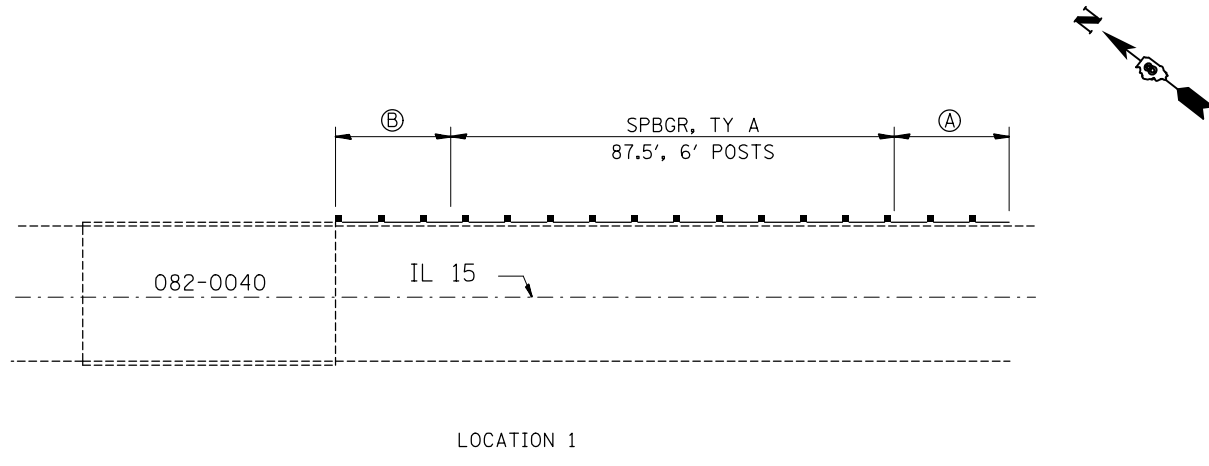

NOT TO SCALE

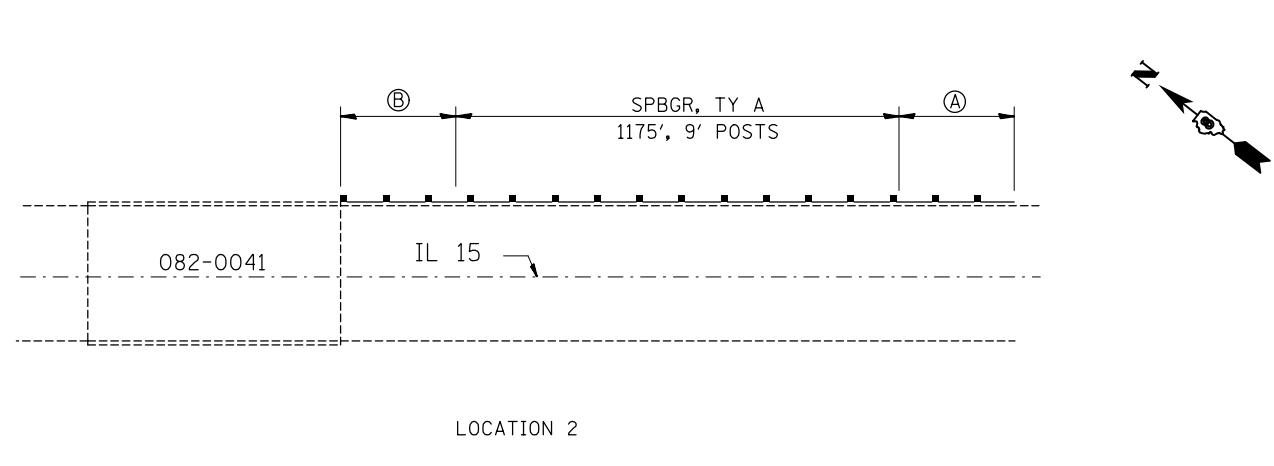

NOT TO SCALE

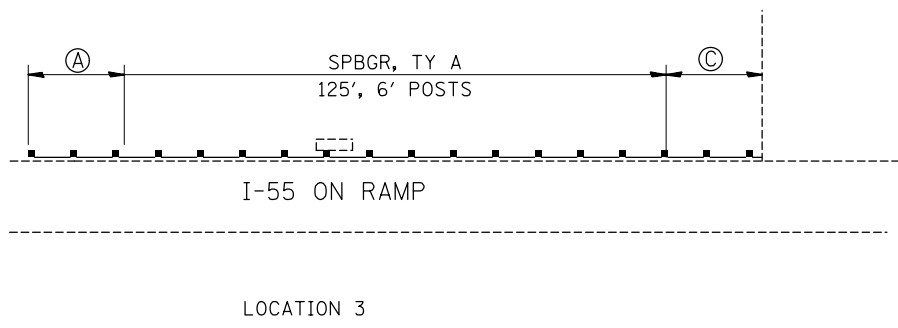

NOT TO SCALE

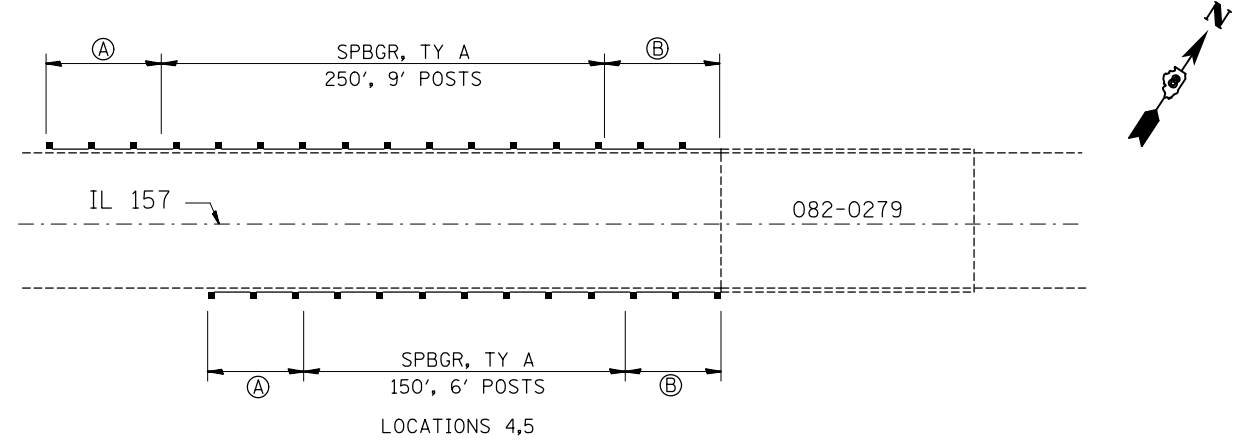

NOT TO SCALE

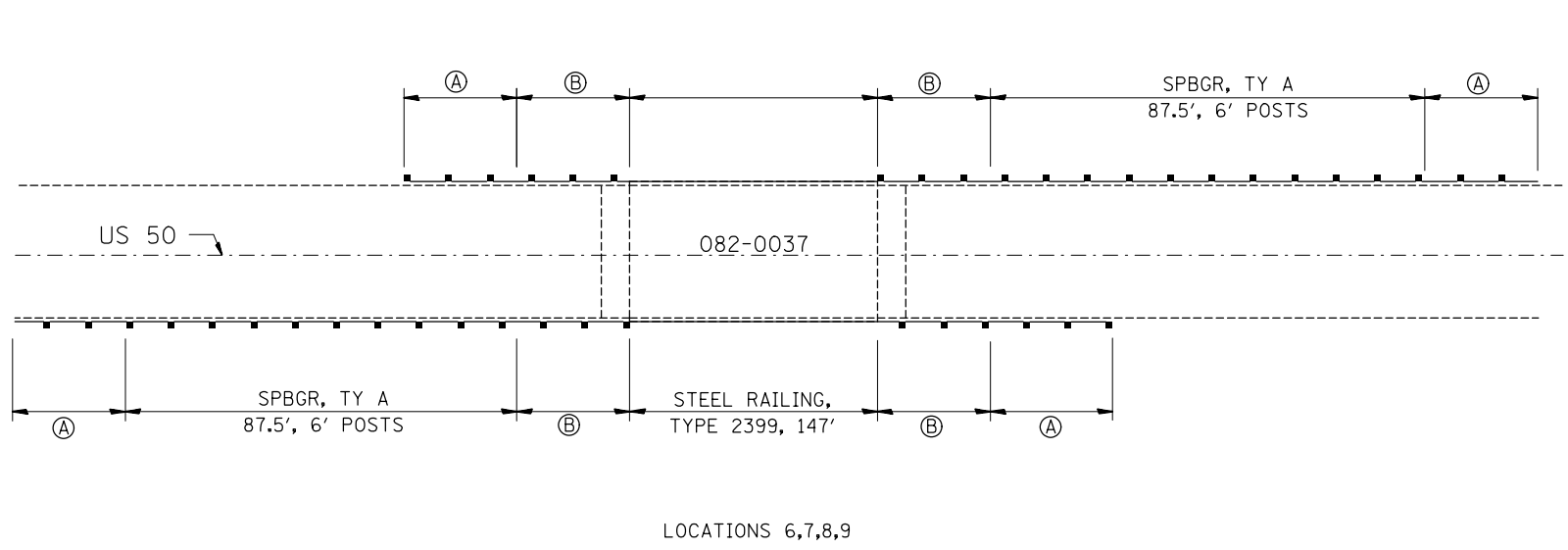

NOT TO SCALE



- Ⓐ = TRAFFIC BARRIER TERM. TYPE 1 SPECIAL (TANGENT)
- Ⓑ = TRAFFIC BARRIER TERM. TYPE 6
- Ⓒ = TRAFFIC BARRIER TERM. TYPE 6A
- Ⓓ = TRAFFIC BARRIER TERM. TYPE 2

FILE NAME =	USER NAME = DintelmanJN	DESIGNED -	REVISED -	<b>STATE OF ILLINOIS DEPARTMENT OF TRANSPORTATION</b>	<b>GUARDRAIL DETAILS ST. CLAIR COUNTY</b>			F.A. RTE.	SECTION	COUNTY	TOTAL SHEETS	SHEET NO.
et:\pwork\pwork\dintelmanj\1\0475869\0876J59-sht-details.dgn	DRAWN -	REVISED -	REVISED -					DIST 8 GUARDRAIL 2017-3	VARIOUS	11	5	
PLOT SCALE = 100.0000' / 1in.	CHECKED -	REVISED -	REVISED -		CONTRACT NO. 76J59			FED. ROAD DIST. NO.	ILLINOIS FED. AID PROJECT			
PLOT DATE = 6/14/2016	DATE -	REVISED -	REVISED -		SCALE:	SHEET NO.	OF SHEETS	STA.	TO STA.			

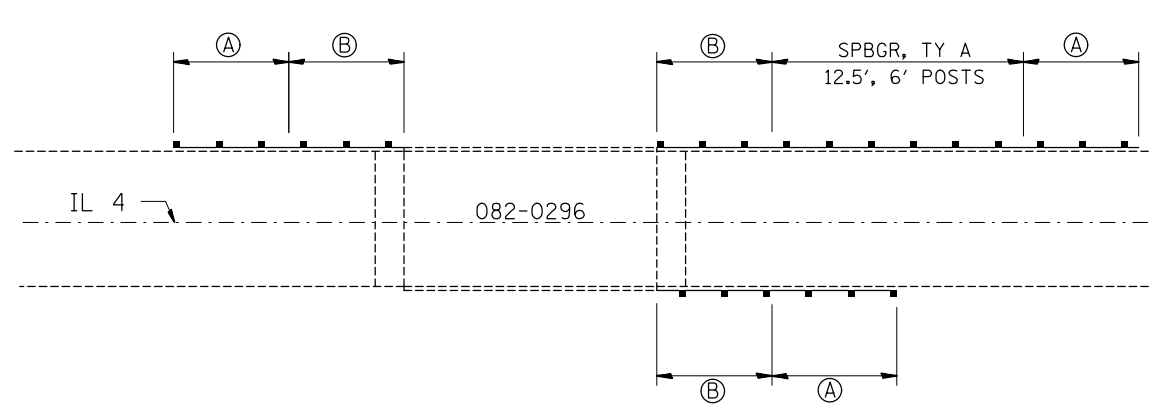

NOT TO SCALE

LOCATIONS 10,11,12

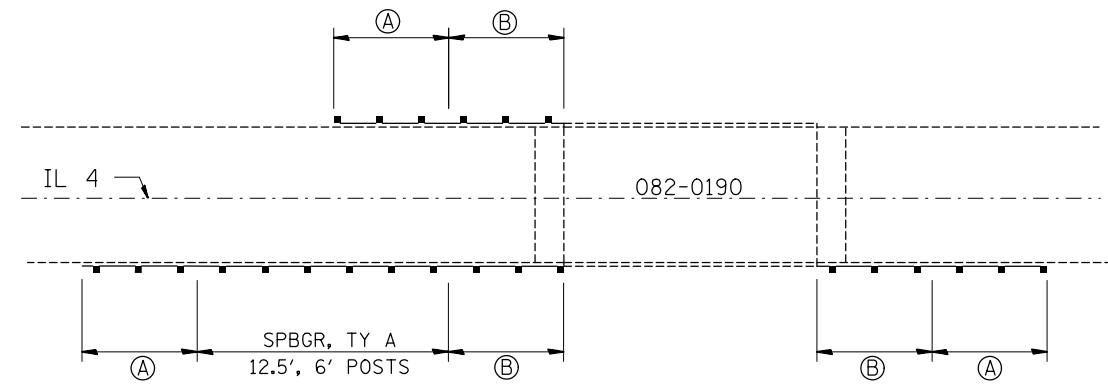

NOT TO SCALE

LOCATIONS 13,14,15

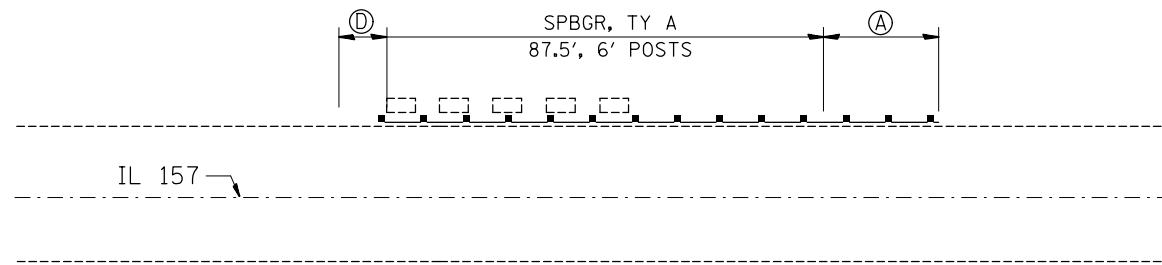

NOT TO SCALE

LOCATION 16

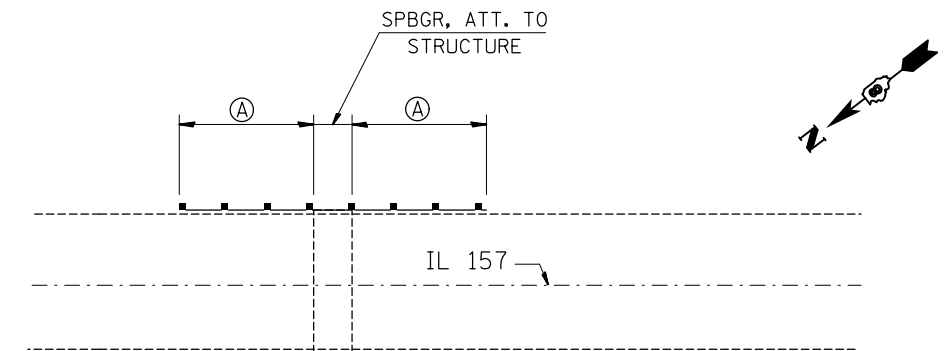

NOT TO SCALE

LOCATIONS 17,18,19,20,21,22,23,24,25,26

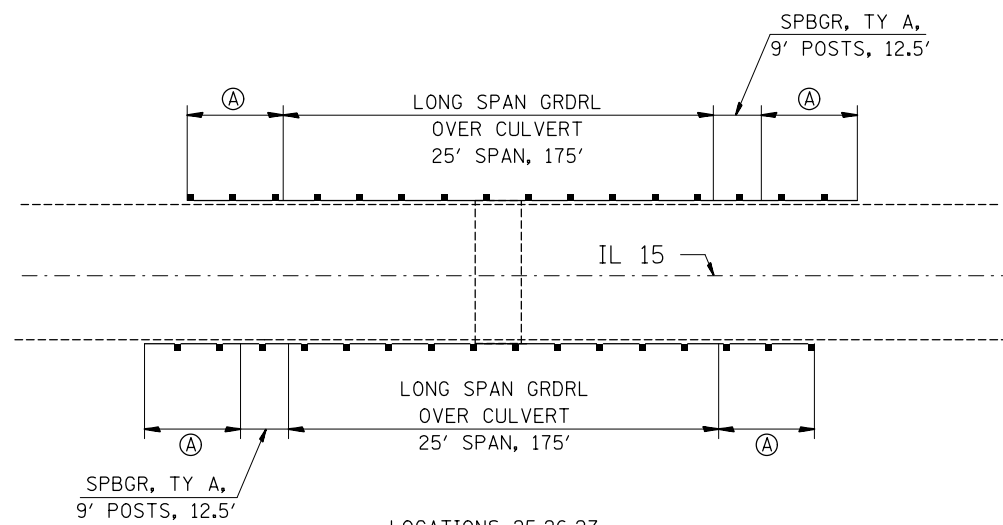

NOT TO SCALE

LOCATIONS 25,26,27

- Ⓐ = TRAFFIC BARRIER TERM. TYPE 1 SPECIAL (TANGENT)
- Ⓑ = TRAFFIC BARRIER TERM. TYPE 6
- Ⓒ = TRAFFIC BARRIER TERM. TYPE 6A
- Ⓓ = TRAFFIC BARRIER TERM. TYPE 2

FILE NAME =	USER NAME = DintelmanJN	DESIGNED -	REVISED -
et:\pwork\pwork\pwork\dintelmanj\1\0475869\0876J59-sht-details.dgn		DRAWN -	REVISED -
	PLOT SCALE = 100.0000' / 1in.	CHECKED -	REVISED -
	PLOT DATE = 6/14/2016	DATE -	REVISED -

STATE OF ILLINOIS  
DEPARTMENT OF TRANSPORTATION

GUARDRAIL DETAILS  
ST. CLAIR COUNTY

SCALE: SHEET NO. OF SHEETS STA. TO STA.

F.A. RTE.	SECTION	COUNTY	TOTAL SHEETS	SHEET NO.
	DIST 8 GUARDRAIL 2017-3	VARIOUS	11	6
CONTRACT NO. 76J59				
FED. ROAD DIST. NO.		ILLINOIS FED. AID PROJECT		

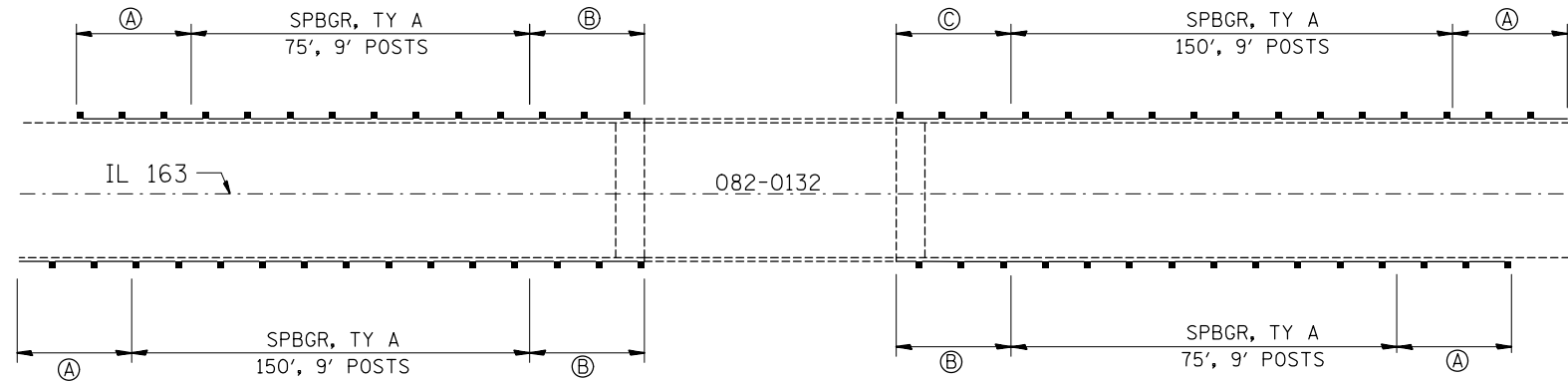

LOCATIONS 28,29,30,31



- Ⓐ = TRAFFIC BARRIER TERM. TYPE 1 SPECIAL (TANGENT)
- Ⓑ = TRAFFIC BARRIER TERM. TYPE 6
- Ⓒ = TRAFFIC BARRIER TERM. TYPE 6A
- Ⓓ = TRAFFIC BARRIER TERM. TYPE 2

FILE NAME =	USER NAME = DintelmanJN	DESIGNED -	REVISED -	<b>STATE OF ILLINOIS DEPARTMENT OF TRANSPORTATION</b>	<b>GUARDRAIL DETAILS ST. CLAIR COUNTY</b>			F.A. RTE.	SECTION	COUNTY	TOTAL SHEETS	SHEET NO.
et:\pwork\pwork\pwork\dintelmanjnl\d0475869	0876J59-sht-details.dgn	DRAWN -	REVISED -					DIST 8 GUARDRAIL 2017-3	VARIOUS	11	7	
	PLOT SCALE = 100.0000' / in.	CHECKED -	REVISED -		SCALE:      SHEET NO.    OF    SHEETS    STA.            TO STA.			CONTRACT NO. 76J59				
	PLOT DATE = 6/14/2016	DATE -	REVISED -		FED. ROAD DIST. NO.		ILLINOIS FED. AID PROJECT					

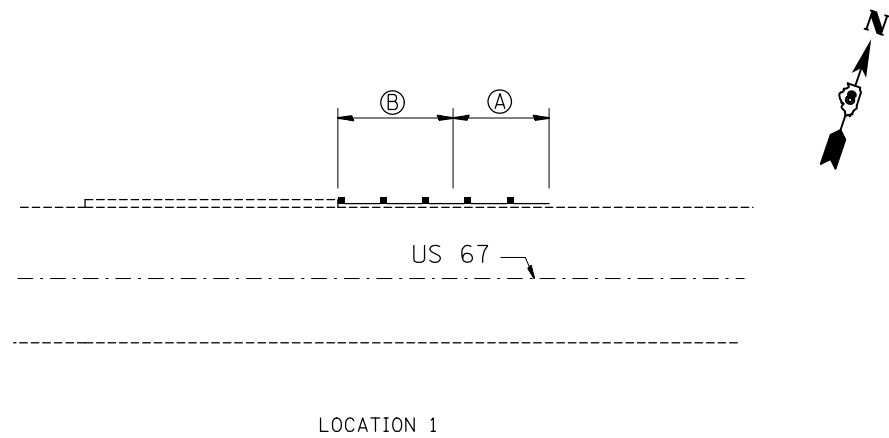

NOT TO SCALE

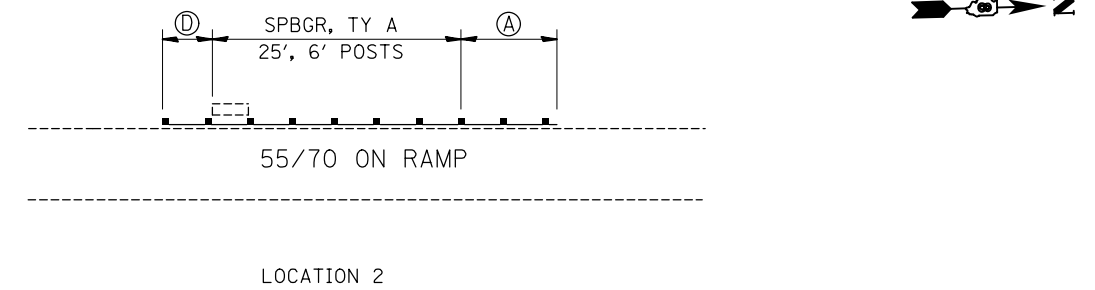

NOT TO SCALE

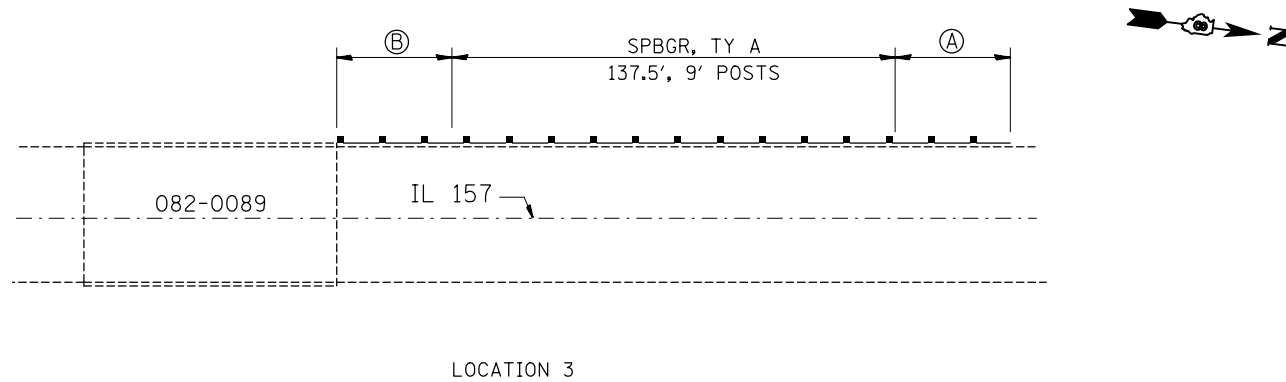

NOT TO SCALE

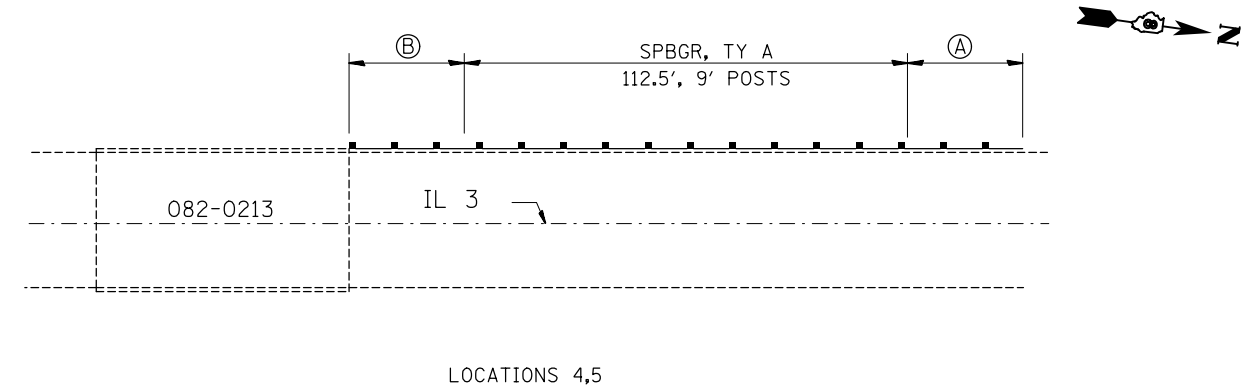

NOT TO SCALE

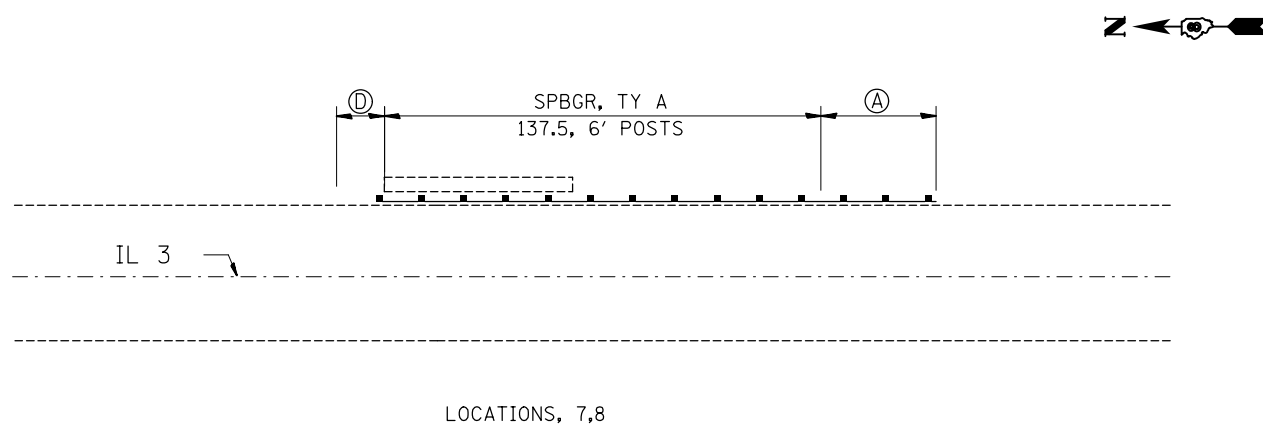

NOT TO SCALE

- Ⓐ = TRAFFIC BARRIER TERM. TYPE 1 SPECIAL (TANGENT)
- Ⓑ = TRAFFIC BARRIER TERM. TYPE 6
- Ⓒ = TRAFFIC BARRIER TERM. TYPE 6A
- Ⓓ = TRAFFIC BARRIER TERM. TYPE 2

FILE NAME =	USER NAME = DintelmanJN	DESIGNED -	REVISED -
et:\pwork\pwork\pwork\dintelmanjnl\d0475869\0876J59-shd-details.dgn		DRAWN -	REVISED -
	PLOT SCALE = 100.0000' / in.	CHECKED -	REVISED -
	PLOT DATE = 6/14/2016	DATE -	REVISED -

STATE OF ILLINOIS  
DEPARTMENT OF TRANSPORTATION

GUARDRAIL DETAILS  
MADISON COUNTY

SCALE: SHEET NO. OF SHEETS STA. TO STA.

F.A. RTE.	SECTION	COUNTY	TOTAL SHEETS	SHEET NO.
	DIST 8 GUARDRAIL 2017-3		11	8
FED. ROAD DIST. NO. ILLINOIS FED. AID PROJECT			CONTRACT NO. 76J59	



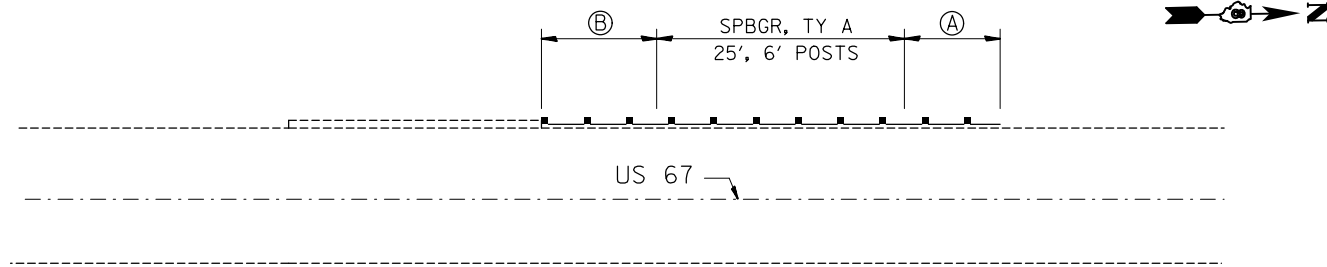

LOCATIONS, 9,10

NOT TO SCALE

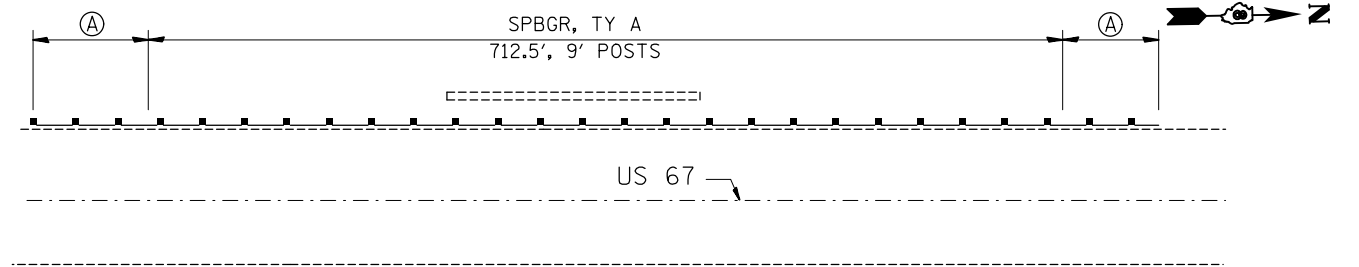

LOCATION 11

NOT TO SCALE

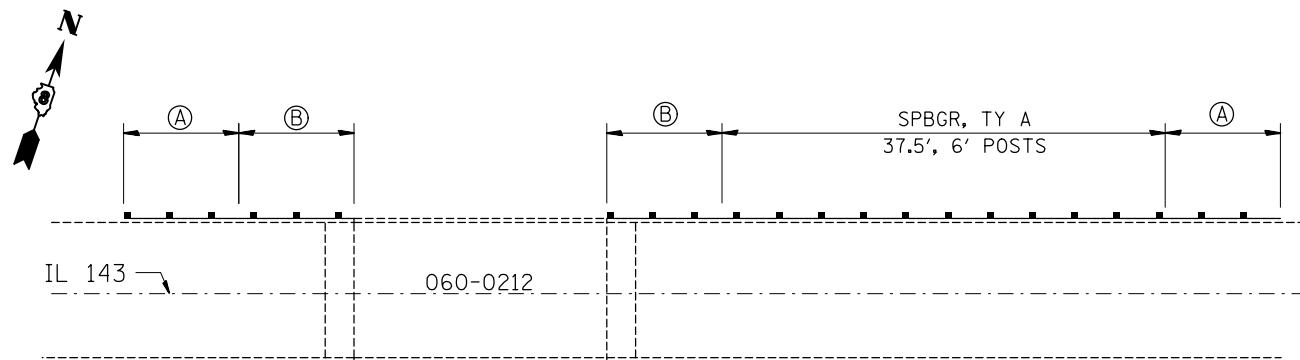

LOCATIONS 12,13

NOT TO SCALE

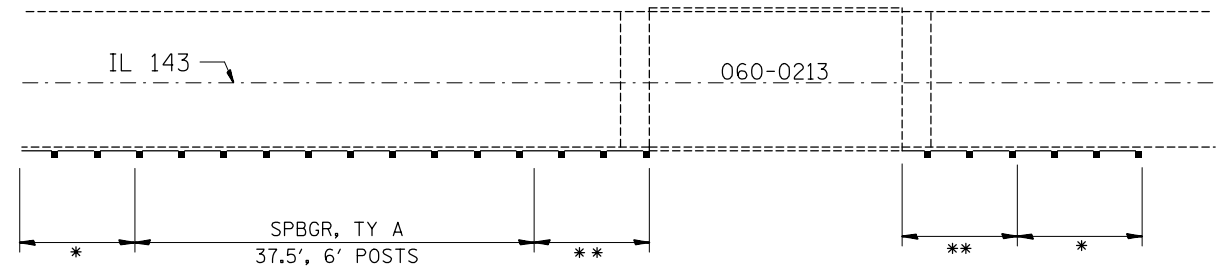

LOCATIONS 14,15

NOT TO SCALE

- Ⓐ = TRAFFIC BARRIER TERM. TYPE 1 SPECIAL (TANGENT)
- Ⓑ = TRAFFIC BARRIER TERM. TYPE 6
- Ⓒ = TRAFFIC BARRIER TERM. TYPE 6A
- Ⓓ = TRAFFIC BARRIER TERM. TYPE 2

FILE NAME =	USER NAME = DintelmanJN	DESIGNED -	REVISED -
et:\pw\work\p\dot\dintelmanjn\1\2016\76j59-sht-details.dgn	0876J59-sht-details.dgn	DRAWN -	REVISED -
	PLOT SCALE = 100.0000' / in.	CHECKED -	REVISED -
	PLOT DATE = 6/14/2016	DATE -	REVISED -

**STATE OF ILLINOIS  
DEPARTMENT OF TRANSPORTATION**

**GUARDRAIL DETAILS  
MADISON COUNTY**

SCALE: SHEET NO. OF SHEETS STA. TO STA.

F.A. RTE.	SECTION	COUNTY	TOTAL SHEETS	SHEET NO.
DIST 8 GUARDRAIL 2017-3	VARIOUS	11	9	
CONTRACT NO. 76J59				
FED. ROAD DIST. NO. ILLINOIS FED. AID PROJECT				

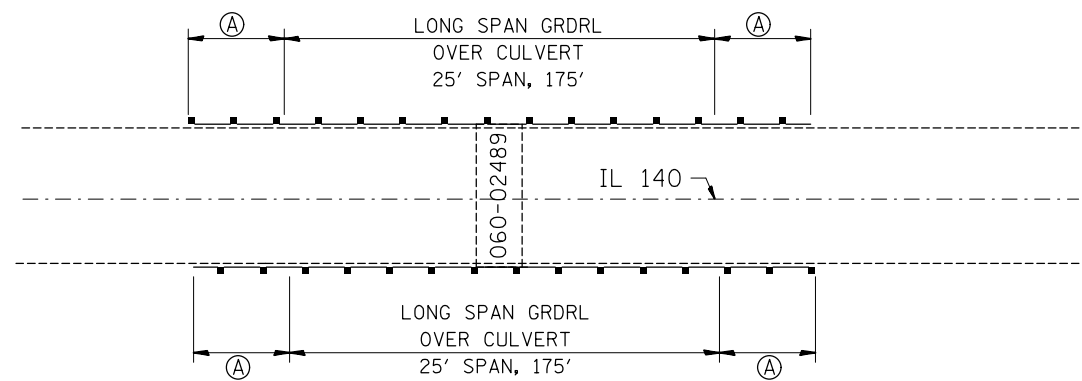

NOT TO SCALE

LOCATIONS 16,17,18,19

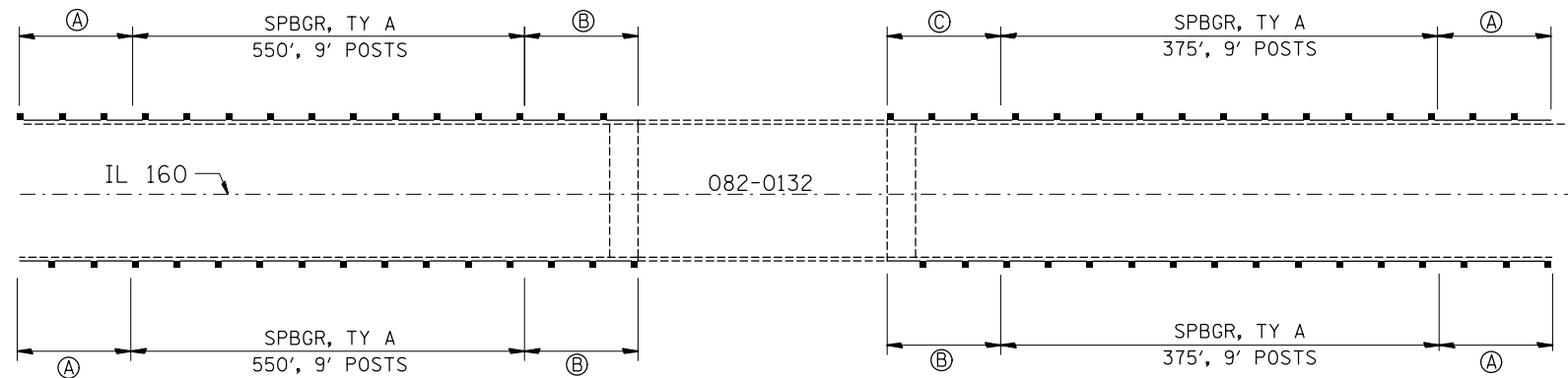

LOCATIONS 20,21,22,23

NOT TO SCALE

- Ⓐ = TRAFFIC BARRIER TERM. TYPE 1 SPECIAL (TANGENT)
- Ⓑ = TRAFFIC BARRIER TERM. TYPE 6
- Ⓒ = TRAFFIC BARRIER TERM. TYPE 6A
- Ⓓ = TRAFFIC BARRIER TERM. TYPE 2

FILE NAME =	USER NAME = DntelmerJN	DESIGNED -	REVISED -
et:\pw\work\p\dot\dntelmerjnl\d0475869\0876J59-sht-details.dgn		DRAWN -	REVISED -
	PLOT SCALE = 100.0000' / in.	CHECKED -	REVISED -
	PLOT DATE = 6/14/2016	DATE -	REVISED -

STATE OF ILLINOIS  
DEPARTMENT OF TRANSPORTATION

GUARDRAIL DETAILS  
ST. CLAIR COUNTY

SCALE: \_\_\_\_\_ SHEET NO. \_\_\_\_ OF \_\_\_\_ SHEETS STA. \_\_\_\_\_ TO STA. \_\_\_\_\_

F.A. RTE.	SECTION	COUNTY	TOTAL SHEETS	SHEET NO.
	DIST 8 GUARDRAIL 2017-3	VARIOUS	11	10
FED. ROAD DIST. NO. _ ILLINOIS FED. AID PROJECT			CONTRACT NO. 76J59	

