

STATE OF ILLINOIS
DEPARTMENT OF TRANSPORTATION
DIVISION OF HIGHWAYS

F.A.I. RTE.	SECTION	COUNTY	TOTAL SHEETS	SHEET NO.
157/64	(41-3,41-3-1)L-1	JEFFERSON	18	1
		ILLINOIS	CONTRACT NO. 78507	

FOR INDEX OF SHEETS, SEE SHEET NO. 3

ADT 38,380(2016)
MU 12,340
SU 2,090
PV 23,950

**PROPOSED
HIGHWAY PLANS**

I-57/64 ROUTE (FAI 57/FAI 64)
SECTION (41-3,41-3-1)L-1
PROJECT ACNHPP-000V(075)
LIGHTING REPAIR
JEFFERSON COUNTY

C-99-006-16

EQUATION STATIONS:
NONE

OMISSIONS:
NONE

TOWNSHIPS:
SHILOH

SPEED LIMIT:
70 MPH

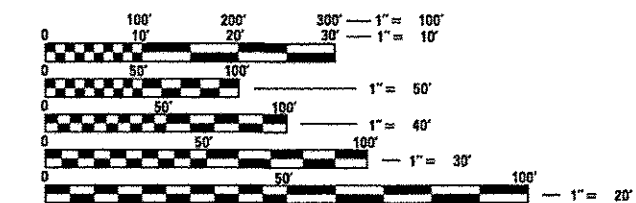
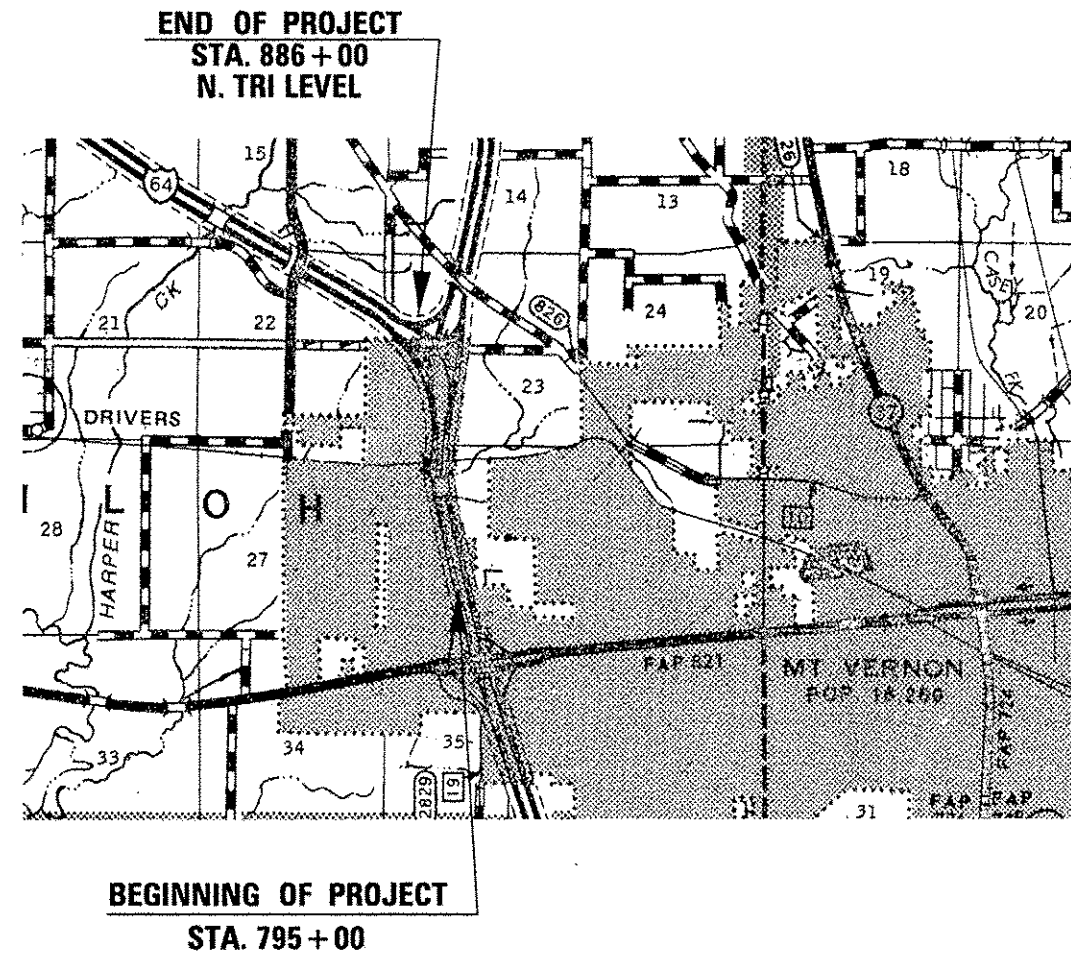
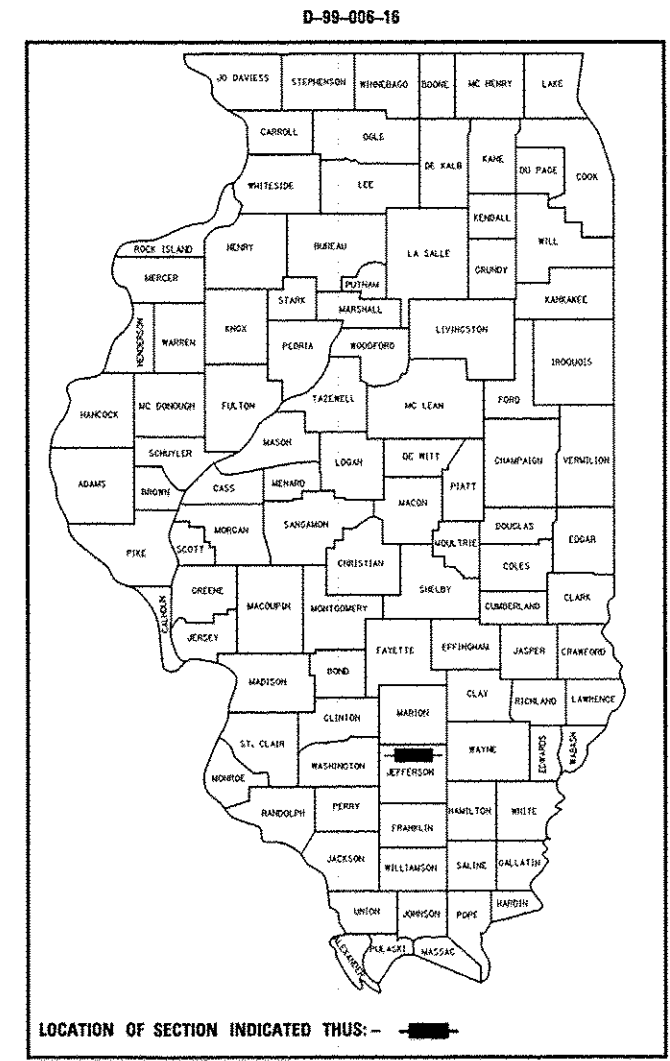

FULL SIZE PLANS HAVE BEEN PREPARED USING STANDARD ENGINEERING SCALES. REDUCED SIZED PLANS WILL NOT CONFORM TO STANDARD SCALES. IN MAKING MEASUREMENTS ON REDUCED PLANS, THE ABOVE SCALES MAY BE USED.

J.U.L.I.E.
JOINT UTILITY LOCATION INFORMATION FOR EXCAVATION
1-800-892-0123
OR 811

PROJECT ENGINEER CHARLES STEIN (618) 351-5210
PROJECT DESIGNER AESHA JACKSON (618) 351-5215

CONTRACT NO. 78507

GROSS LENGTH = 11195.7 FT. = 2.12 MILE
NET LENGTH = 11195.7 FT. = 2.12 MILE

STATE OF ILLINOIS
DEPARTMENT OF TRANSPORTATION
DIVISION OF HIGHWAYS

SUBMITTED May 5 2015
Jeffrey L. Keim
REGION FIVE ENGINEER

July 1 2016
Maureen M. Addis, P.E.
ENGINEER OF DESIGN AND ENVIRONMENT

July 1 2016
Annelle [Signature]
DIRECTOR OF PROGRAM DEVELOPMENT

**PRINTED BY THE AUTHORITY
OF THE STATE OF ILLINOIS**

SUMMARY OF QUANTITIES

COUNTY:	Jefferson County (081)
ROUTE:	157/164
FUNDING:	90%FED 10% STATE
LOCATION:	URBAN
TOTAL QUANTITY	ROADWAY 0021

CODE NUMBER	ITEM DESCRIPTION	UNIT	TOTAL QUANTITY	ROADWAY 0021
67100100	MOBILIZATION	LSUM	1	1
70100700	TRAFFIC CONTROL AND PROTECTION, STANDARD 701406	LSUM	1	1
70100825	TRAFFIC CONTROL AND PROTECTION, STANDARD 701456	LSUM	1	1
80400100	ELECTRIC SERVICE INSTALLATION	EACH	2	2
81028750	UNDERGROUND CONDUIT, COILABLE NONMETALLIC CONDUIT, 2" DIA.	FOOT	850	850
81300550	JUNCTION BOX, STAINLESS STEEL, ATTACHED TO STRUCTURE, 12" X 12" X 6"	EACH	8	8
81603000	UNIT DUCT, 600V, 2-1C NO.8, 1/C NO.8 GROUND, (XLP-TYPE USE), 3/4" DIA. POLYETHYLENE	FOOT	8050	8050
81603030	UNIT DUCT, 600V, 2-1C NO.4, 1/C NO.6 GROUND, (XLP-TYPE USE), 1" DIA. POLYETHYLENE	FOOT	2200	2200
81603040	UNIT DUCT, 600V, 2-1C NO.6, 1/C NO.8 GROUND, (XLP-TYPE USE), 1" DIA. POLYETHYLENE	FOOT	19000	19000
81702120	ELECTRIC CABLE IN CONDUIT, 600V (XLP-TYPE USE) 1/C NO. 8	FOOT	160	160
81702130	ELECTRIC CABLE IN CONDUIT, 600V (XLP-TYPE USE) 1/C NO. 6	FOOT	480	480
81702140	ELECTRIC CABLE IN CONDUIT, 600V (XLP-TYPE USE) 1/C NO. 4	FOOT	320	320
82500360	LIGHTING CONTROLLER, BASE MOUNTED, 480VOLT, 100AMP	EACH	2	2
83004600	LIGHT POLE, ALUMINUM, 50 FT. M.H., 15 FT. DAVIT ARM	EACH	92	92

SUMMARY OF QUANTITIES - CONT

COUNTY:	Jefferson County (081)
ROUTE:	I57/I64
FUNDING:	90%FED 10%STATE
LOCATION:	URBAN
TOTAL QUANTITY	ROADWAY 0021

CODE NUMBER	ITEM DESCRIPTION	UNIT	TOTAL QUANTITY	ROADWAY 0021
83600357	LIGHT POLE FOUNDATION, METAL, 15" BOLT CIRCLE, 8" X 8'	EACH	92	92
83800650	BREAKAWAY DEVICE, COUPLING WITH STAINLESS STEEL SCREEN	EACH	368	368
84200500	REMOVAL OF LIGHTING UNIT, SALVAGE	EACH	66	66
84200804	REMOVAL OF POLE FOUNDATION	EACH	66	66
84500110	REMOVAL OF LIGHTING CONTROLLER	EACH	2	2
84500120	REMOVAL OF ELECTRIC SERVICE INSTALLATION	EACH	2	2
84500130	REMOVAL OF LIGHTING CONTROLLER FOUNDATION	EACH	2	2
X0326492	REMOVAL OF EXISTING SIGN LIGHTING UNIT AND SALVAGE	EACH	10	10
X1400113	LUMINAIRE, LED, HORIZONTAL MOUNT, MEDIUM WATTAGE	EACH	92	92
X7010410	SPEED DISPLAY TRAILER	CAL MO	1	1
X8110458	CONDUIT ATTACHED TO STRUCTURE, 2" DIA., STAINLESS STEEL	FOOT	300	300

NOTES

ALL SIGN LUMINAIRES IN PROJECT LIMITS SHALL BE REMOVED AS PER SPECIAL PROVISION AND AS DIRECTED BY THE ENGINEER.

ALL LIGHT POLES ARE SET BACK 20 FT FROM ACTIVE LANE (WHITE STRIPE) UNLESS OTHERWISE NOTED.

WHERE GUARDRAIL IS PRESENT, LIGHT POLES ARE SET BACK 5 FT BEHIND GUARDRAIL.

UNIT DUCT IS ② UNLESS OTHERWISE NOTED.

FOR BRIDGE CROSSING CONDUIT SEE HIGHWAY STANDARD 812001.

DUCT TYPES

- ① UNIT DUCT, 600V, 2-IC NO. 4, 1/C NO. 6 GROUND (XLP-TYPE USE) 1" DIA. POLYETHYLENE
- ② UNIT DUCT, 600V, 2-IC NO. 6, 1/C NO. 8 GROUND (XLP-TYPE USE) 1" DIA. POLYETHYLENE
- ③ UNIT DUCT, 600V, 2-IC NO. 8, 1/C NO. 8 GROUND (XLP-TYPE USE) 3/4" DIA. POLYETHYLENE

ROUTE I-57/64 INTERCHANGE
LUMINAIRE PERFORMANCE TABLE

GIVEN CONDITIONS

ROADWAY DATA	PAVEMENT WIDTH	7.3 m (24 FT.)
	NUMBER OF LANES	2
	I. E. S. SURFACE CLASSIFICATION	R3
	Q-ZERO VALUE	.07
LIGHT POLE DATA	MOUNTING HEIGHT	50 FT.
	MAST ARM LENGTH	15 FT.
	POLE SET-BACK FROM EOP	20 FT.
LUMINAIRE DATA	LAMP TYPE	LED
	LAMP LUMENS	20,000 (MIN.)
	I. E. S. VERTICAL DISTRIBUTION	MEDIUM
	BUG RATING	U=0
	I. E. S. LATERAL DISTRIBUTION	TYPE III
	LUMEN DEPRECIATION	0.90
	DIRT DEPRECIATION	0.80
	EQUIPMENT FACTOR	0.95
	TOTAL LIGHT LOSS FACTOR	0.684
LAYOUT DATA	SPACING	100 m (330 FT)
	CONFIGURATION	SINGLE SIDED

NOTE:

1. VARIATIONS FROM THE ABOVE SPECIFIED I. E. S. DISTRIBUTION PATTERN MAY BE REQUESTED AND ACCEPTANCE OF VARIATIONS WILL BE SUBJECT TO REVIEW BY THE ENGINEER BASED ON HOW WELL THE PERFORMANCE REQUIREMENTS ARE MET.
2. A LUMEN DEPRECIATION VALUE GREATER THAN 0.90 FOR LED LIGHT SOURCES SHALL BE BASED UPON I. E. S. LM-80 OR I. E. S. LM-84 AND I. E. S. TM-21 TEST REPORTS.

PERFORMANCE REQUIREMENTS : THESE PERFORMANCE REQUIREMENTS SHALL BE THE MINIMUM ACCEPTABLE STANDARDS OF PHOTOMETRIC PERFORMANCE FOR THE LUMINAIRE, BASED ON THE GIVEN CONDITIONS LISTED ABOVE.

LUMINANCE	AVERAGE LUMINANCE, L_{AVE}	0.4 Cd/m ² (MIN)
	UNIFORMITY RATIO, L_{AVE} / L_{MIN}	3.5:1 (MAX)
	UNIFORMITY RATIO, L_{MAX} / L_{MIN}	6.0:1 (MAX)
	MAX. VEILING LUMINANCE RATIO, L_v / L_{AVE}	0.5:1 (MAX)

REMOVAL LEGEND

- EXISTING LIGHTING UNIT TO BE REMOVED
- EXISTING CONTROLLER TO BE REMOVED
- EXISTING SERVICE TO BE REMOVED

PROPOSED ITEMS LEGEND

- PROPOSED LIGHTING UNIT, 50' ALUMINUM POLE, 15 FT. DAVIT ARM, HORIZONTAL MOUNT LED, M-3-FULL CUTOFF, INSTALLED ON METAL FOUNDATIONS WITH BREAKWAY COUPLING DEVICES AND STAINLESS STEEL SCREEN.
- PROPOSED UNIT DUCT, SIZED AS NOTED
- PROPOSED UNDERGROUND CONDUIT, COILABLE NON-METALIC, 2 IN. DIA., LENGTH AS NOTED
- PROPOSED LIGHTING CONTROLLER, BASE MOUNTED, 480V, 100A
- JUNCTION BOX, STAINLESS STEEL, ATTACHED TO STRUCTURE 300x300x150 (12"x12"x6")
- ELECTRIC CABLE IN CONDUIT, 600V (XLP-TYPE USE), SIZE AS NOTED.
- PROPOSED ELECTRIC SERVICE INSTALLATION 240/480V 1 PHASE 3 WIRE.

FILE NAME =	USER NAME = jacksonc	DESIGNED -	REVISED -	STATE OF ILLINOIS DEPARTMENT OF TRANSPORTATION	I-57/64 TRI-LEVEL INTERCHANGE LIGHTING PLANS	F.A.I. RE.	SECTION	COUNTY	TOTAL SHEETS	SHEET NO.	
						157/64	(41-3,41-3-1)L-1	JEFFERSON	18	6	
						CONTRACT NO. 78276					
Default	PLOT DATE = 6/24/2016	DATE -	REVISED -			SCALE:	SHEET OF SHEETS	STA.	TO STA.	ILLINOIS FED. AID PROJECT	

NOTE:

1) ALL LIGHT POLES ARE SETBACK
20 FT FROM ACTIVE LANE (WHITE STRIPE)
UNLESS OTHERWISE NOTED.

2) UNIT DUCT IS ② UNLESS OTHERWISE NOTED.

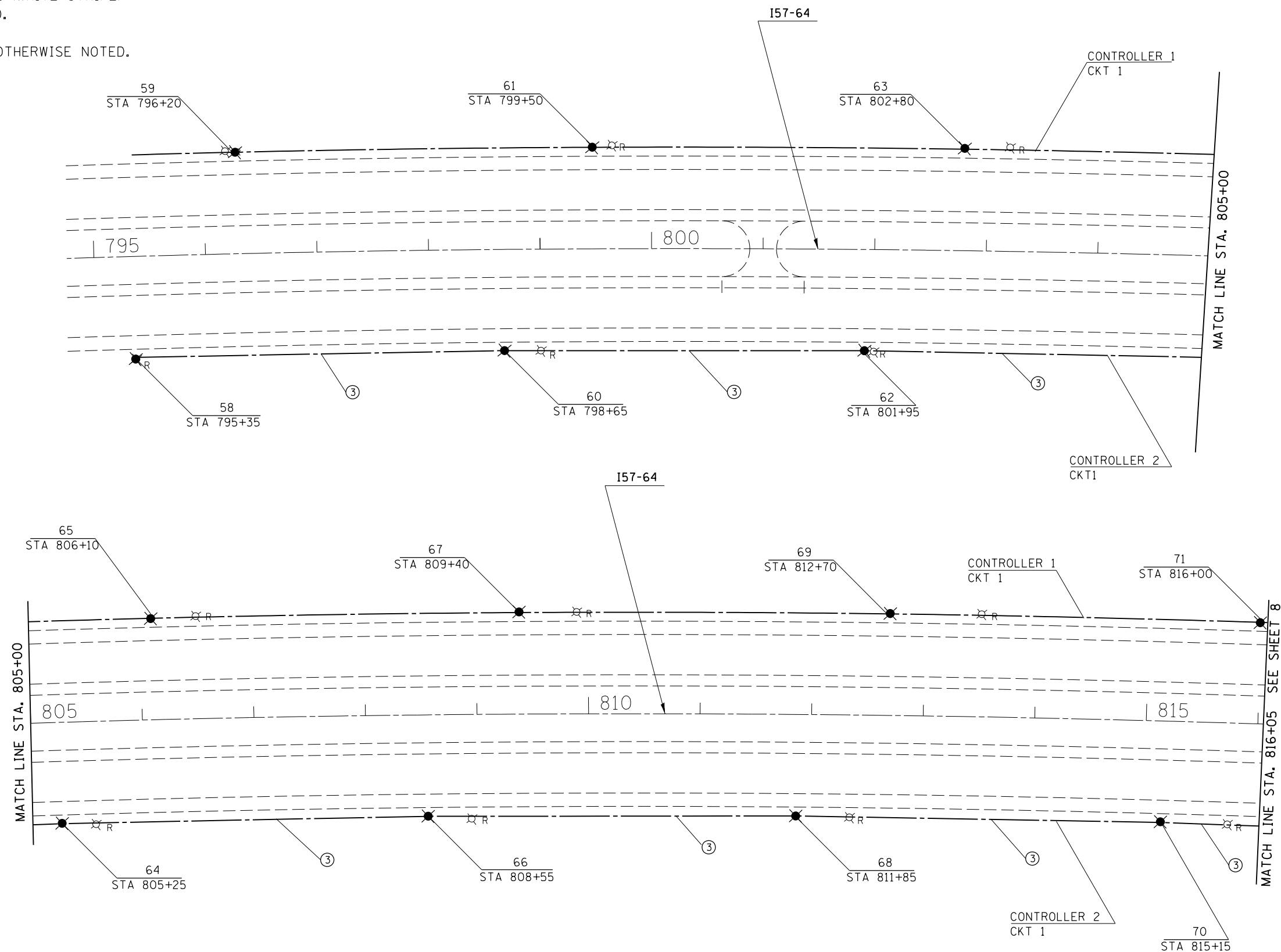
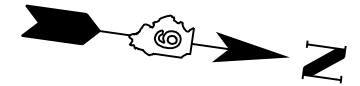

② UNIT DUCT, 600V, 2-1C NO. 6, 1/C NO. 8 GROUND, (XLP-TYPE USE), 1" DIA. POLYETHYLENE.

③ UNIT DUCT, 600V, 2-1C NO. 8, 1/C NO. 8 GROUND, (XLP-TYPE USE), 3/4" DIA. POLYETHYLENE.

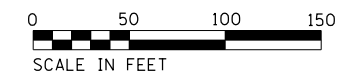

FILE NAME =	USER NAME = jacksonc	DESIGNED -	REVISED -	STATE OF ILLINOIS DEPARTMENT OF TRANSPORTATION	I-57/64 TRI-LEVEL INTERCHANGE LIGHTING PLANS			F.A.I. RE.	SECTION	COUNTY	TOTAL SHEETS	SHEET NO.
pw:\IL\084EBIDINTEG.illinois.gov\PI\DOT\Documents\DOT Offices\District 9\Projects\78507\Drawings\CAD\Sheets\Lighting sheets.dgn		DRAWN -	REVISED -					I57/64	(41-3,41-3-1L-1	JEFFERSON	18	7
Default	PLOT SCALE = 100.0000' / in.	CHECKED -	REVISED -					CONTRACT NO. 78507				
	PLOT DATE = 5/5/2016	DATE -	REVISED -					ILLINOIS FED. AID PROJECT				
				SCALE:	SHEET	OF	SHEETS	STA.	TO	STA.		

NOTE:

- 1) ALL LIGHT POLES ARE SETBACK
20 FT FROM ACTIVE LANE (WHITE STRIPE)
UNLESS OTHERWISE NOTED.
- 2) UNIT DUCT IS ② UNLESS OTHERWISE NOTED.
- 3) WHERE GUARDRAIL IS PRESENT LIGHT POLES
ARE SETBACK 5 FT BEHIND GUARDRAIL.
- 4) FOR BRIDGE CROSSING CONDUIT DETAILS SEE HIGHWAY STANDARD
812001.
- 5) REMOVE CONDUIT AND JUNCTION BOXES ATTACHED TO STRUCTURE
PER ARTICLE 842.03.

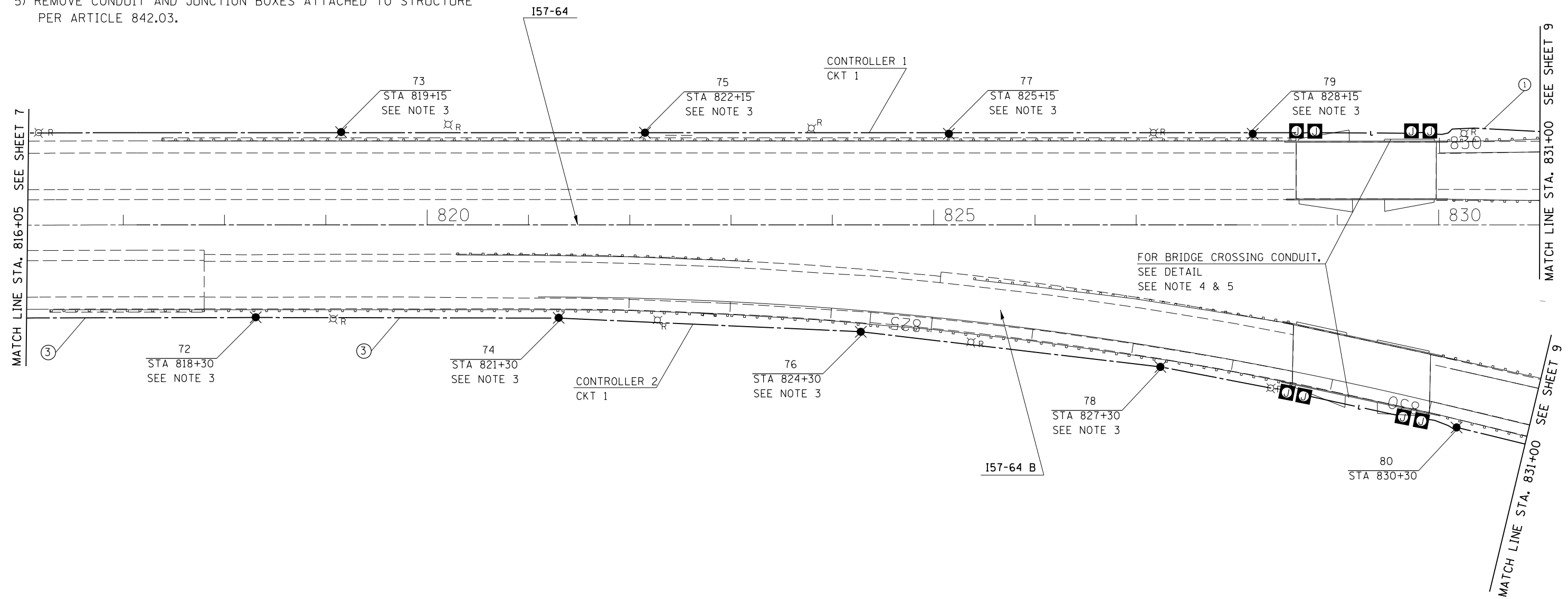
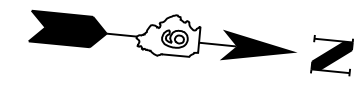

- ① UNIT DUCT, 600V, 2-1C NO. 4, 1/C NO.6 GROUND, (XLP-TYPE USE), 1" DIA. POLYETHYLENE.
- ② UNIT DUCT, 600V, 2-1C NO. 6, 1/C NO.8 GROUND, (XLP-TYPE USE), 1" DIA. POLYETHYLENE.
- ③ UNIT DUCT, 600V, 2-1C NO. 8, 1/C NO.8 GROUND, (XLP-TYPE USE), 3/4" DIA. POLYETHYLENE.



FILE NAME =	USER NAME = jacksonc	DESIGNED -	REVISED -	STATE OF ILLINOIS DEPARTMENT OF TRANSPORTATION	I-57/64 TRI-LEVEL INTERCHANGE LIGHTING PLANS			F.A.I. RTE.	SECTION	COUNTY	TOTAL SHEETS	SHEET NO.
pw:\IL\084EBIDINTEG.illinois.gov\PIWIDOT\Documents\IDOT Offices\District 9\Projects\78507\Drawings\CAD\Sheets\Lighting sheets.dgn	PLLOT SCALE = 100.0000' / in.	CHECKED -	REVISED -					I57/64	(41-3,41-3-1L-1	JEFFERSON	18	8
Default	PLLOT DATE = 5/5/2016	DATE -	REVISED -		SCALE: 50 SHEET 02 OF 10 SHEETS STA. 816+00 TO STA. 831+00			CONTRACT NO. 78507				
					ILLINOIS FED. AID PROJECT							

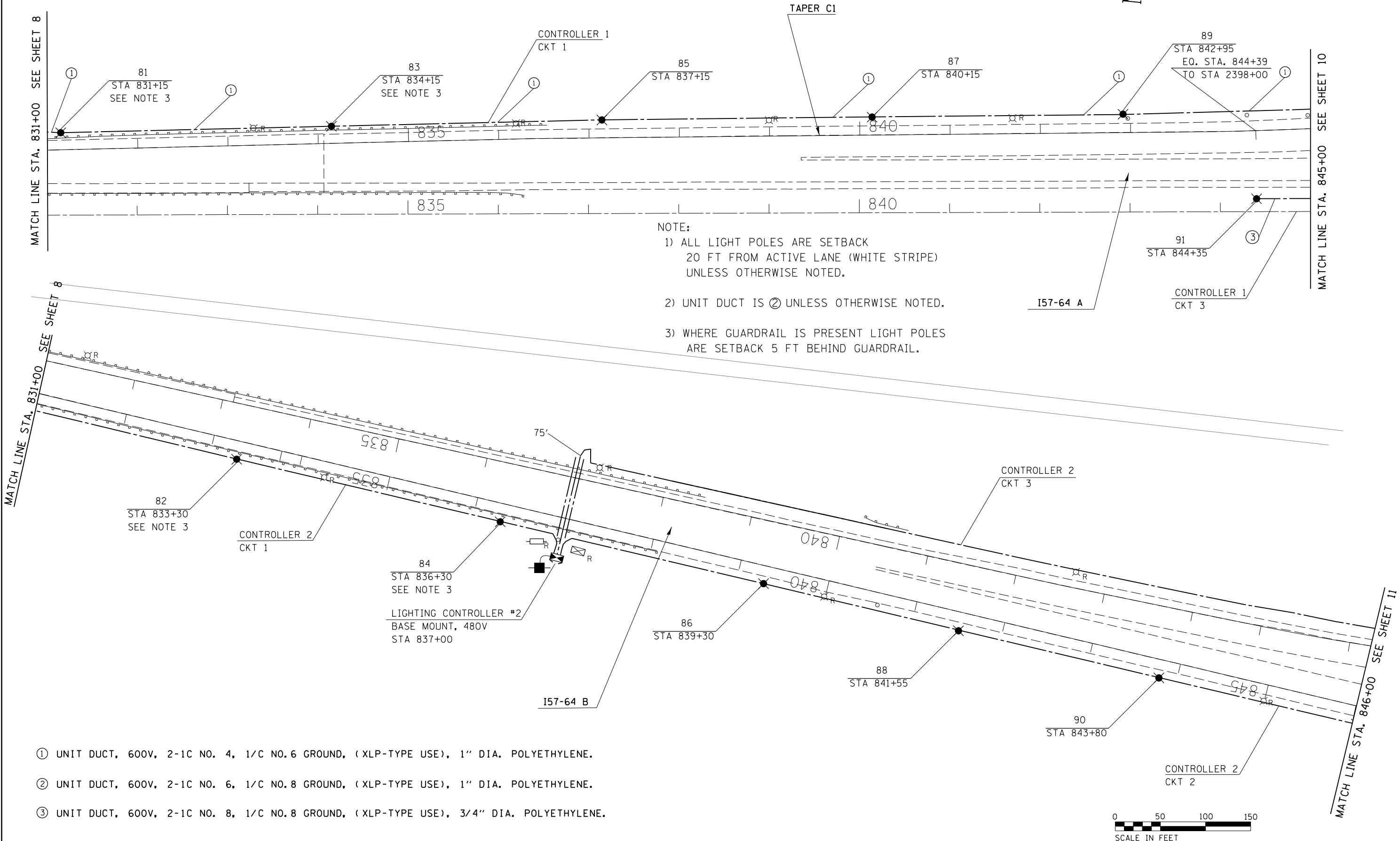
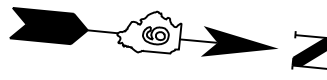

NOTE:
 1) ALL LIGHT POLES ARE SETBACK
 20 FT FROM ACTIVE LANE (WHITE STRIPE)
 UNLESS OTHERWISE NOTED.
 2) UNIT DUCT IS ② UNLESS OTHERWISE NOTED.
 3) WHERE GUARDRAIL IS PRESENT LIGHT POLES
 ARE SETBACK 5 FT BEHIND GUARDRAIL.

- ① UNIT DUCT, 600V, 2-1C NO. 4, 1/C NO. 6 GROUND, (XLP-TYPE USE), 1" DIA. POLYETHYLENE.
- ② UNIT DUCT, 600V, 2-1C NO. 6, 1/C NO. 8 GROUND, (XLP-TYPE USE), 1" DIA. POLYETHYLENE.
- ③ UNIT DUCT, 600V, 2-1C NO. 8, 1/C NO. 8 GROUND, (XLP-TYPE USE), 3/4" DIA. POLYETHYLENE.

FILE NAME =	USER NAME = jacksonc	DESIGNED -	REVISED -
p:\11\084EBIDINTEG.illinois.gov\PI\DOT\Documents\DOT Offices\District 9\Projects\78507\Drawings\CAD\Sheets\Lighting sheets.dgn		DRAWN -	REVISED -
Default	PLOT SCALE = 100.0000' / in.	CHECKED -	REVISED -
	PLOT DATE = 6/24/2016	DATE -	REVISED -

**STATE OF ILLINOIS
 DEPARTMENT OF TRANSPORTATION**

I-57/64 TRI-LEVEL INTERCHANGE LIGHTING PLANS			
SCALE: 50	SHEET	OF SHEETS	STA. TO STA.

F.A.I. RTE. 157/64	SECTION (41-3,41-3-1L-1)	COUNTY JEFFERSON	TOTAL SHEETS 18	SHEET NO. 9
CONTRACT NO. 78507				
ILLINOIS FED. AID PROJECT				

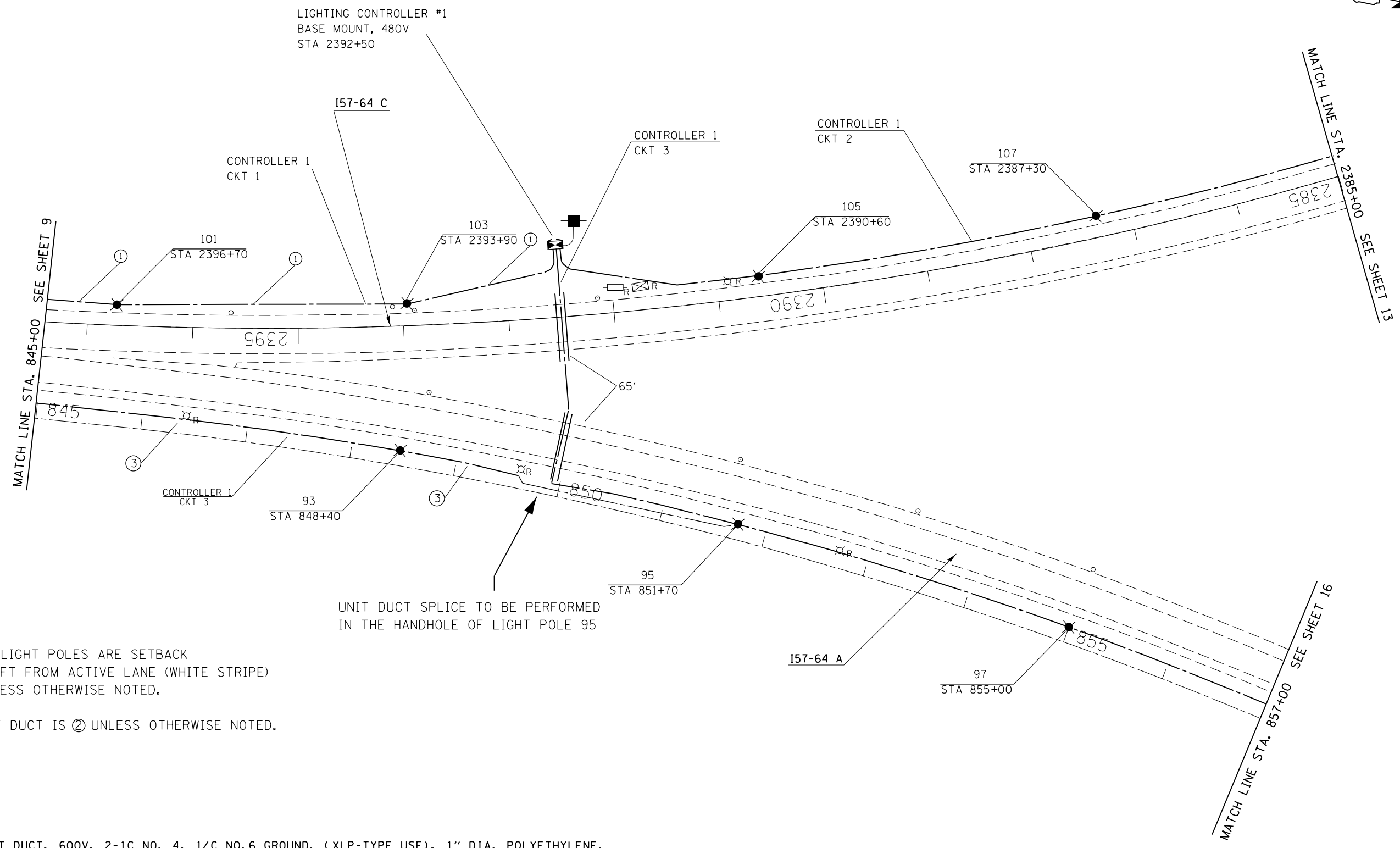
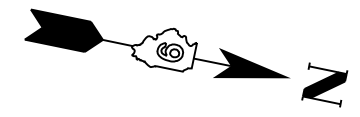

NOTE:

- 1) ALL LIGHT POLES ARE SETBACK 20 FT FROM ACTIVE LANE (WHITE STRIPE) UNLESS OTHERWISE NOTED.
- 2) UNIT DUCT IS ② UNLESS OTHERWISE NOTED.

- ① UNIT DUCT, 600V, 2-1C NO. 4, 1/C NO.6 GROUND, (XLP-TYPE USE), 1" DIA. POLYETHYLENE.
- ② UNIT DUCT, 600V, 2-1C NO. 6, 1/C NO.8 GROUND, (XLP-TYPE USE), 1" DIA. POLYETHYLENE.
- ③ UNIT DUCT, 600V, 2-1C NO. 8, 1/C NO.8 GROUND, (XLP-TYPE USE), 3/4" DIA. POLYETHYLENE.

UNIT DUCT SPLICE TO BE PERFORMED IN THE HANDHOLE OF LIGHT POLE 95

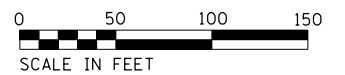

FILE NAME =	USER NAME = jacksonc	DESIGNED -	REVISED -	STATE OF ILLINOIS DEPARTMENT OF TRANSPORTATION	I-57/64 TRI-LEVEL INTERCHANGE LIGHTING PLANS			F.A.I. R.T.E.	SECTION	COUNTY	TOTAL SHEETS	SHEET NO.
Default	PLOT DATE = 6/24/2016	DATE -	REVISED -					157/64	(41-3,41-3-1L-1)	JEFFERSON	18	10
					SCALE: 50 SHEET 04 OF 10 SHEETS STA. 845+00 TO STA. 857+00			CONTRACT NO. 78507				
					ILLINOIS FED. AID PROJECT							

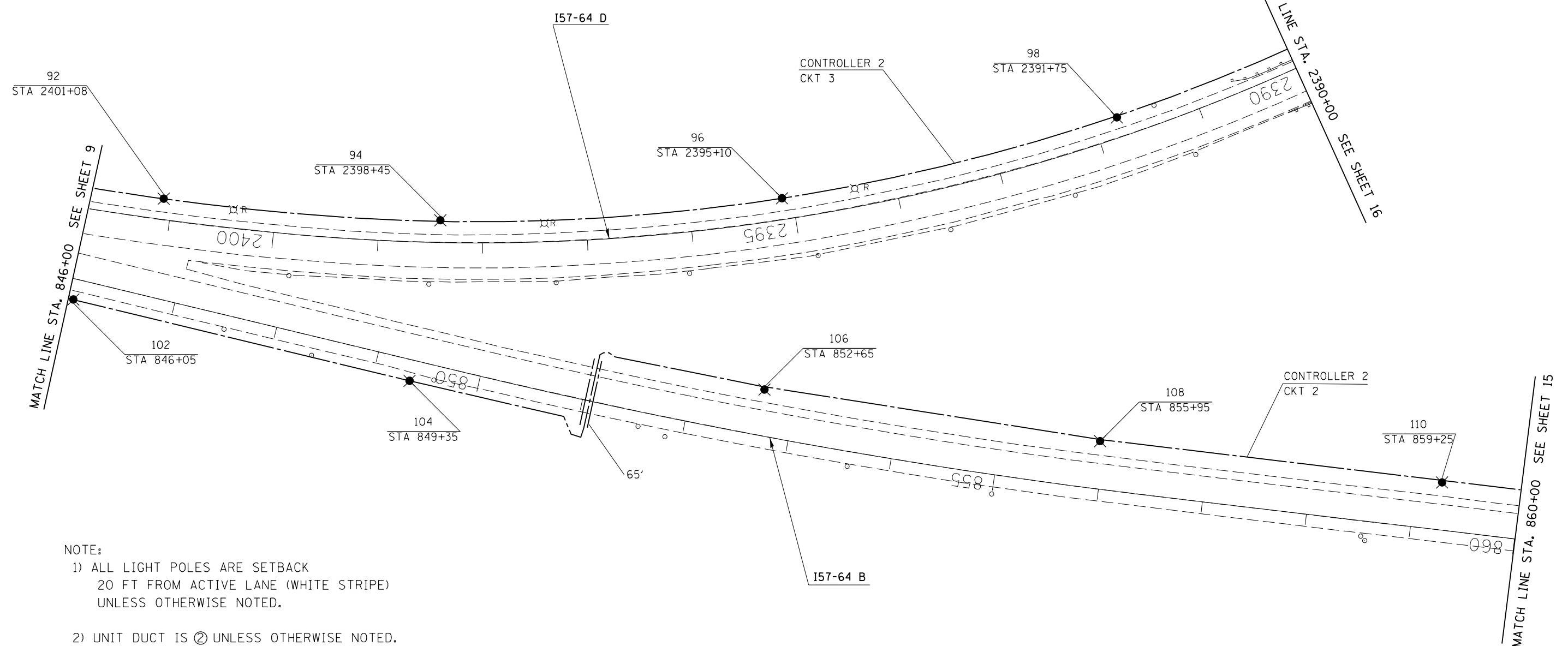
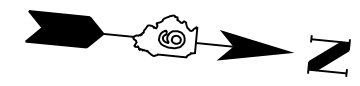

NOTE:
 1) ALL LIGHT POLES ARE SETBACK
 20 FT FROM ACTIVE LANE (WHITE STRIPE)
 UNLESS OTHERWISE NOTED.
 2) UNIT DUCT IS ② UNLESS OTHERWISE NOTED.

② UNIT DUCT, 600V, 2-1C NO. 6, 1/C NO. 8 GROUND, (XLP-TYPE USE), 1" DIA. POLYETHYLENE.

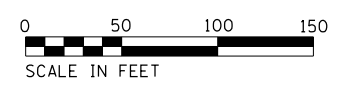

FILE NAME =	USER NAME = jacksonc	DESIGNED -	REVISED -	STATE OF ILLINOIS DEPARTMENT OF TRANSPORTATION	I-57/64 TRI-LEVEL INTERCHANGE LIGHTING PLANS			F.A.I. RTE.	SECTION	COUNTY	TOTAL SHEETS	SHEET NO.
pw:\IL\084EBIDINTEG\illinois.gov\PIDOT\Documents\IDOT Offices\District 9\Projects\78507\Drawings\CAD\sheets\Lighting sheets.dgn	PLotted	CHECKED -	REVISED -					157/64	(41-3,41-3-1)L-1	JEFFERSON	18	11
Default	PLOT SCALE = 100.0000' / in.	DATE -	REVISED -		CONTRACT NO. 78507			ILLINOIS FED. AID PROJECT				
	PLOT DATE = 5/5/2016				SCALE: 50	SHEET 05 OF 10 SHEETS	STA. 846+00 TO STA. 860+00					

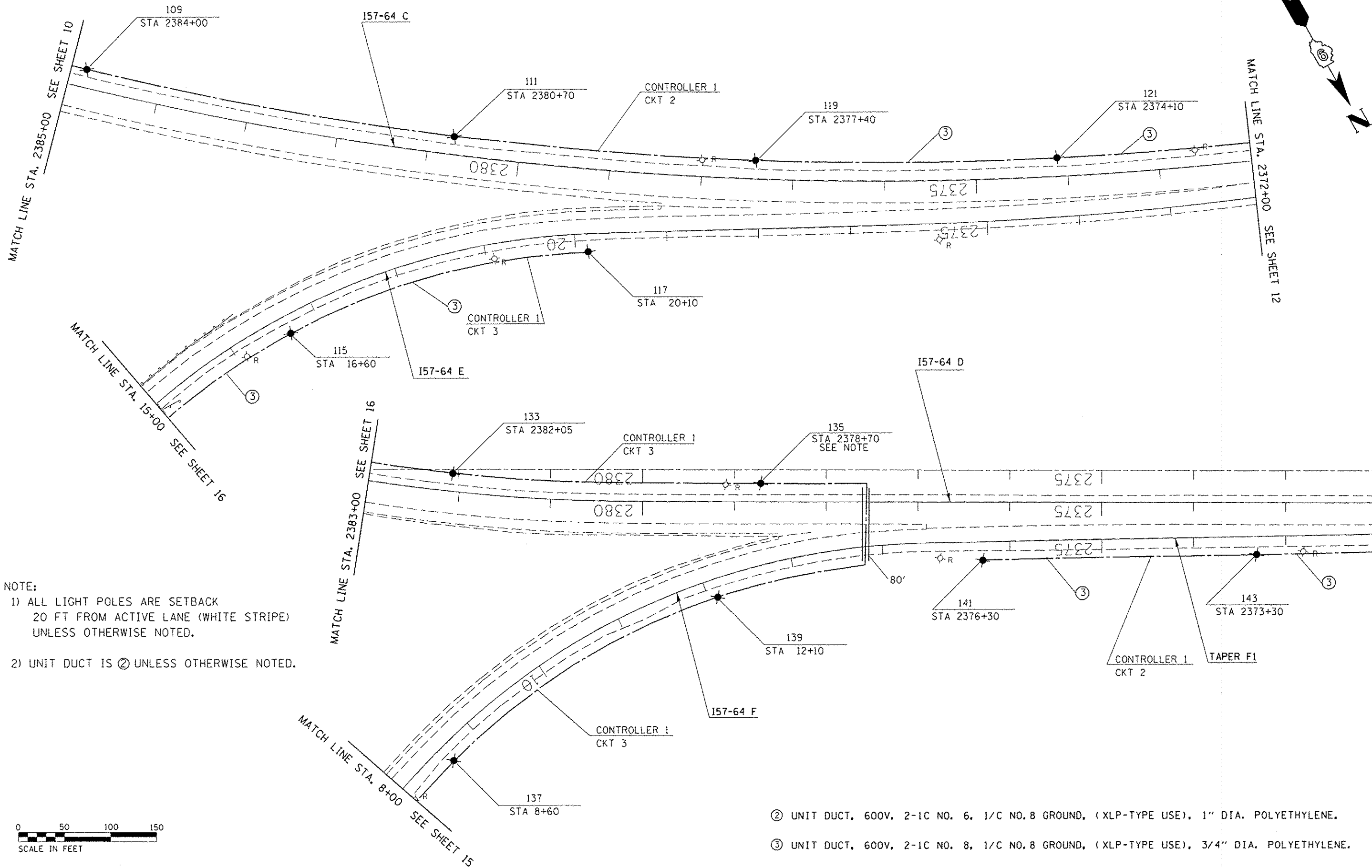

NOTE:
 1) ALL LIGHT POLES ARE SETBACK 20 FT FROM ACTIVE LANE (WHITE STRIPE) UNLESS OTHERWISE NOTED.
 2) UNIT DUCT IS ② UNLESS OTHERWISE NOTED.

- ② UNIT DUCT, 600V, 2-1C NO. 6, 1/C NO.8 GROUND, (XLP-TYPE USE), 1" DIA. POLYETHYLENE.
- ③ UNIT DUCT, 600V, 2-1C NO. 8, 1/C NO.8 GROUND, (XLP-TYPE USE), 3/4" DIA. POLYETHYLENE.

FILE NAME : p:\110846\BID\INTEG.illinois.gov\PI\DOT\Documents\DOT Offices\District 9\Projects\7050\DRAWING\CAD\Sheets\Lighting sheets.dgn	USER NAME : jacksong	DESIGNED -	REVISED -	STATE OF ILLINOIS DEPARTMENT OF TRANSPORTATION	I-57/64 TRI-LEVEL INTERCHANGE LIGHTING PLANS			F.A.I. RTE. 157/64	SECTION (41-3.41-3-11L-1)	COUNTY JEFFERSON	TOTAL SHEETS 18	SHEET NO. 13
PLOT SCALE : 1/8" = 1'-0"	CHECKED -	REVISED -	REVISED -		SCALE: 50	SHEET 07 OF 10 SHEETS	STA. 2372+00 TO STA. 2385+00	ILLINOIS FED. AID PROJECT				
Default	PLOT DATE : 6/24/2016	DATE -	REVISED -									
CONTRACT NO. 78507												

- NOTE:
- 1) ALL LIGHT POLES ARE SETBACK 20 FT FROM ACTIVE LANE (WHITE STRIPE) UNLESS OTHERWISE NOTED.
 - 2) UNIT DUCT IS ② UNLESS OTHERWISE NOTED.
 - 3) WHERE GUARDRAIL IS PRESENT LIGHT POLES ARE SETBACK 5 FT BEHIND GUARDRAIL.

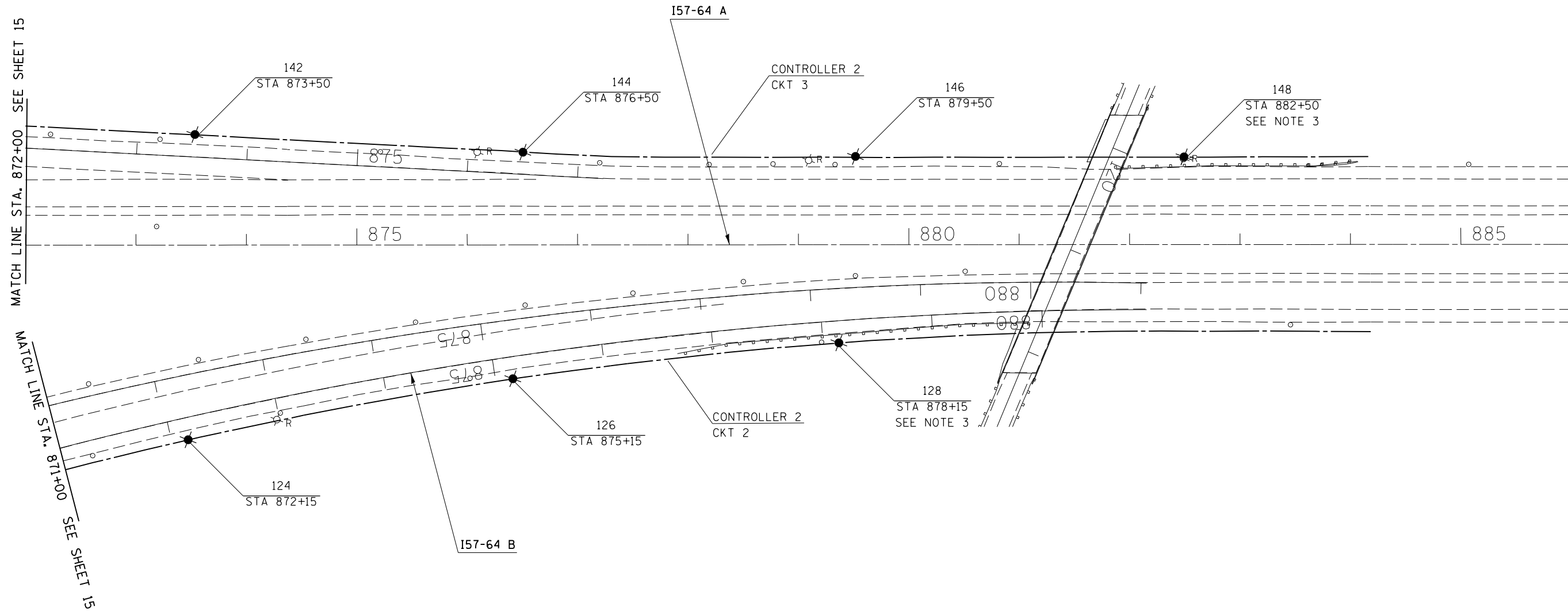
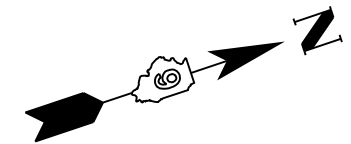

② UNIT DUCT, 600V, 2-1C NO. 6, 1/C NO. 8 GROUND, (XLP-TYPE USE), 1" DIA. POLYETHYLENE.



FILE NAME =	USER NAME = jacksonc	DESIGNED -	REVISED -	STATE OF ILLINOIS DEPARTMENT OF TRANSPORTATION	I-57/64 TRI-LEVEL INTERCHANGE LIGHTING PLANS			F.A.I. RTE.	SECTION	COUNTY	TOTAL SHEETS	SHEET NO.
pw:\IL\084EBIDINTEG.illinois.gov\PIWIDOT\Documents\IDOT Offices\District 9\Projects\78507\Drawings\CAD\Sheets\Lighting sheets.dgn	PLOT SCALE = 100.0000' / in.	CHECKED -	REVISED -					I57/64	(41-3,41-3-1L-1)	JEFFERSON	18	14
Default	PLOT DATE = 5/5/2016	DATE -	REVISED -		SCALE: 50 SHEET 10 OF 10 SHEETS STA. 871+00 TO STA. 886+00			CONTRACT NO. 78507				
										ILLINOIS FED. AID PROJECT		

NOTE:

- 1) ALL LIGHT POLES ARE SETBACK 20 FT FROM ACTIVE LANE (WHITE STRIPE) UNLESS OTHERWISE NOTED.
- 2) UNIT DUCT IS ② UNLESS OTHERWISE NOTED.

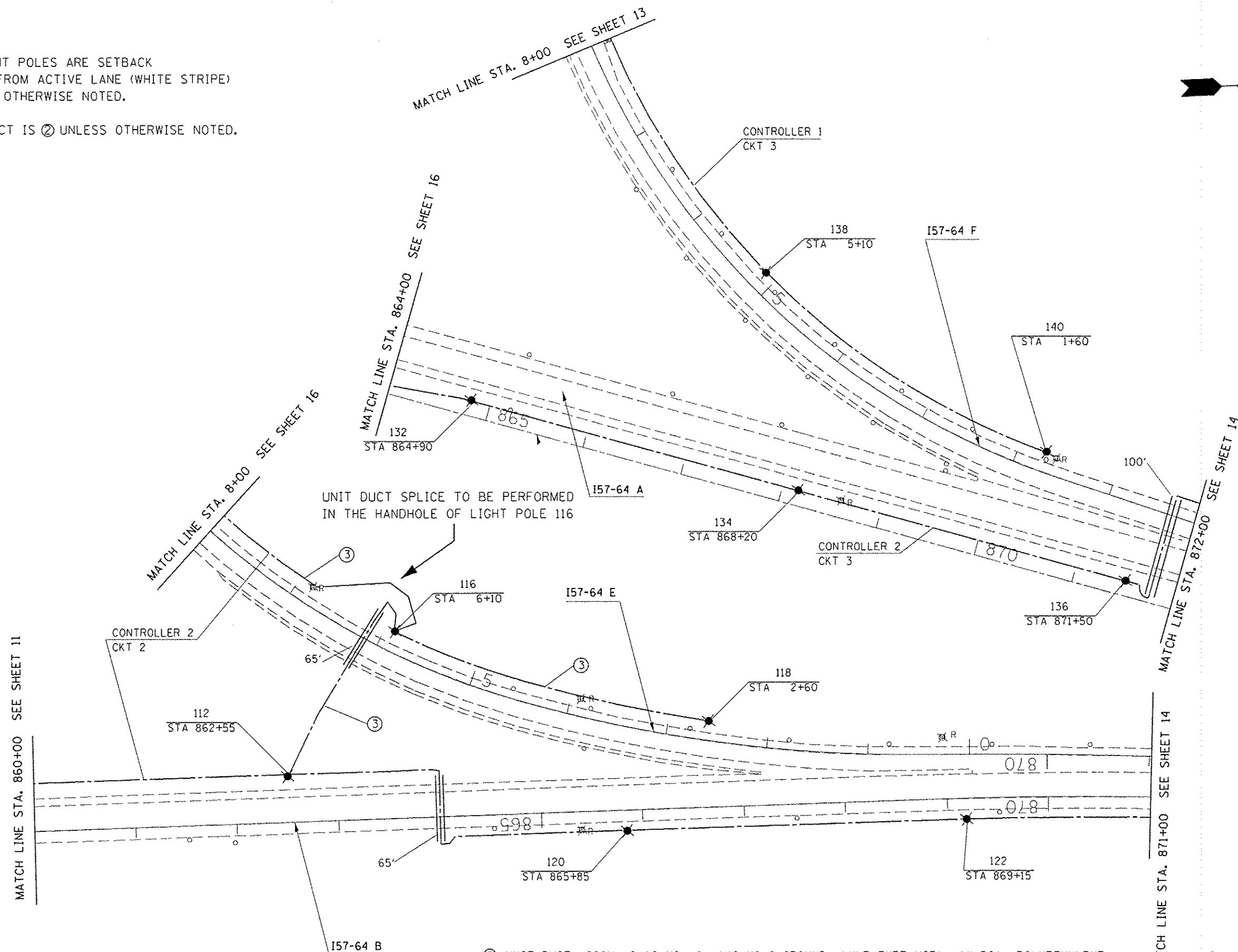

- ② UNIT DUCT, 600V, 2-1C NO. 6, 1/C NO.8 GROUND, (XLP-TYPE USE), 1" DIA. POLYETHYLENE.
- ③ UNIT DUCT, 600V, 2-1C NO. 8, 1/C NO.8 GROUND, (XLP-TYPE USE), 3/4" DIA. POLYETHYLENE.

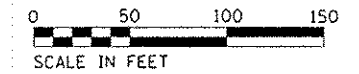

FILE NAME :	USER NAME : jackson	DESIGNED -	REVISED -	STATE OF ILLINOIS DEPARTMENT OF TRANSPORTATION	I-57/64 TRI-LEVEL INTERCHANGE LIGHTING PLANS	F.A.I. RTE.	SECTION	COUNTY	TOTAL SHEETS	SHEET NO.	
\\IL0846810\BTEG\Illinois.gov\PWIDOT\Documents\1001 Offices\District 9\Projects\7850\DRAWN\CA0\sheet\Lighting_sheets.dgn		CHECKED -	REVISED -			157/64	141-3,41-3-1L-1	JEFFERSON	18	15	
PLOT SCALE = 100.0000 "/td> <td></td> <td>DATE -</td> <td>REVISED -</td> <td colspan="2" style="text-align: center;">SCALE: 50 SHEET 09 OF 10 SHEETS STA. TO STA.</td> <td colspan="4" style="text-align: center;">CONTRACT NO. 78507</td>		DATE -	REVISED -			SCALE: 50 SHEET 09 OF 10 SHEETS STA. TO STA.		CONTRACT NO. 78507			
PLOT DATE = 6/24/2016						ILLINOIS FED. AID PROJECT					

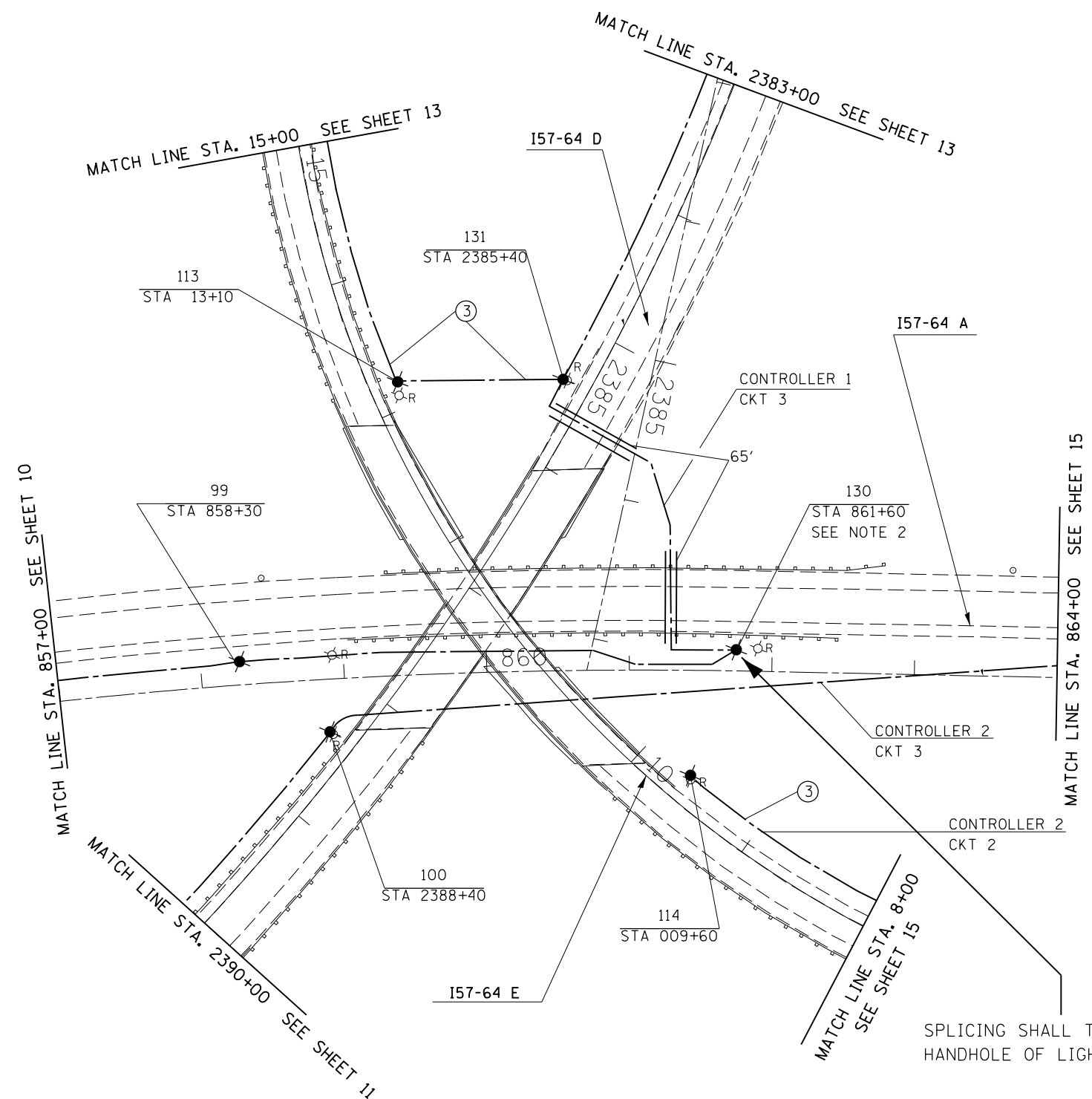
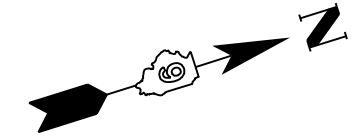

- NOTES:
1. LIGHT POLE ARE SETBACK 20 FT FROM EDGE OF TRAVELED PAVEMENT.
 2. WHERE GUARDRAIL IS PRESENT LIGHT POLES ARE SETBACK 5 FT. BEHIND GUARDRAIL.
 3. UNIT DUCT IS ② UNLESS OTHERWISE NOTED.

SPLICING SHALL TAKE PLACE IN THE HANDHOLE OF LIGHT POLE 130

- ② UNIT DUCT, 600V, 2-1C NO. 6, 1/C NO.8 GROUND, (XLP-TYPE USE), 1" DIA. POLYETHYLENE.
- ③ UNIT DUCT, 600V, 2-1C NO. 8, 1/C NO.8 GROUND, (XLP-TYPE USE), 3/4" DIA. POLYETHYLENE.

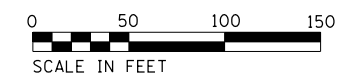

FILE NAME =	USER NAME = jacksonec	DESIGNED -	REVISED -	STATE OF ILLINOIS DEPARTMENT OF TRANSPORTATION	I-57/64 TRI-LEVEL INTERCHANGE LIGHTING PLANS			F.A.I. RTE.	SECTION	COUNTY	TOTAL SHEETS	SHEET NO.
pw:\IL\084EBIDINTEG.illinois.gov\PIWIDOT\Documents\IDOT Offices\District 9\Projects\78507\CAD\Drawings\Lighting sheets.dgn	PLOT SCALE = 100.0000' / in.	CHECKED -	REVISED -					I57/64	(41-3,41-3-1L-1)	JEFFERSON	18	16
Default	PLOT DATE = 6/24/2016	DATE -	REVISED -		SCALE: 50 SHEET 06 OF 10 SHEETS STA. 857+00 TO STA. 864+00			CONTRACT NO. 78507				
					ILLINOIS FED. AID PROJECT							

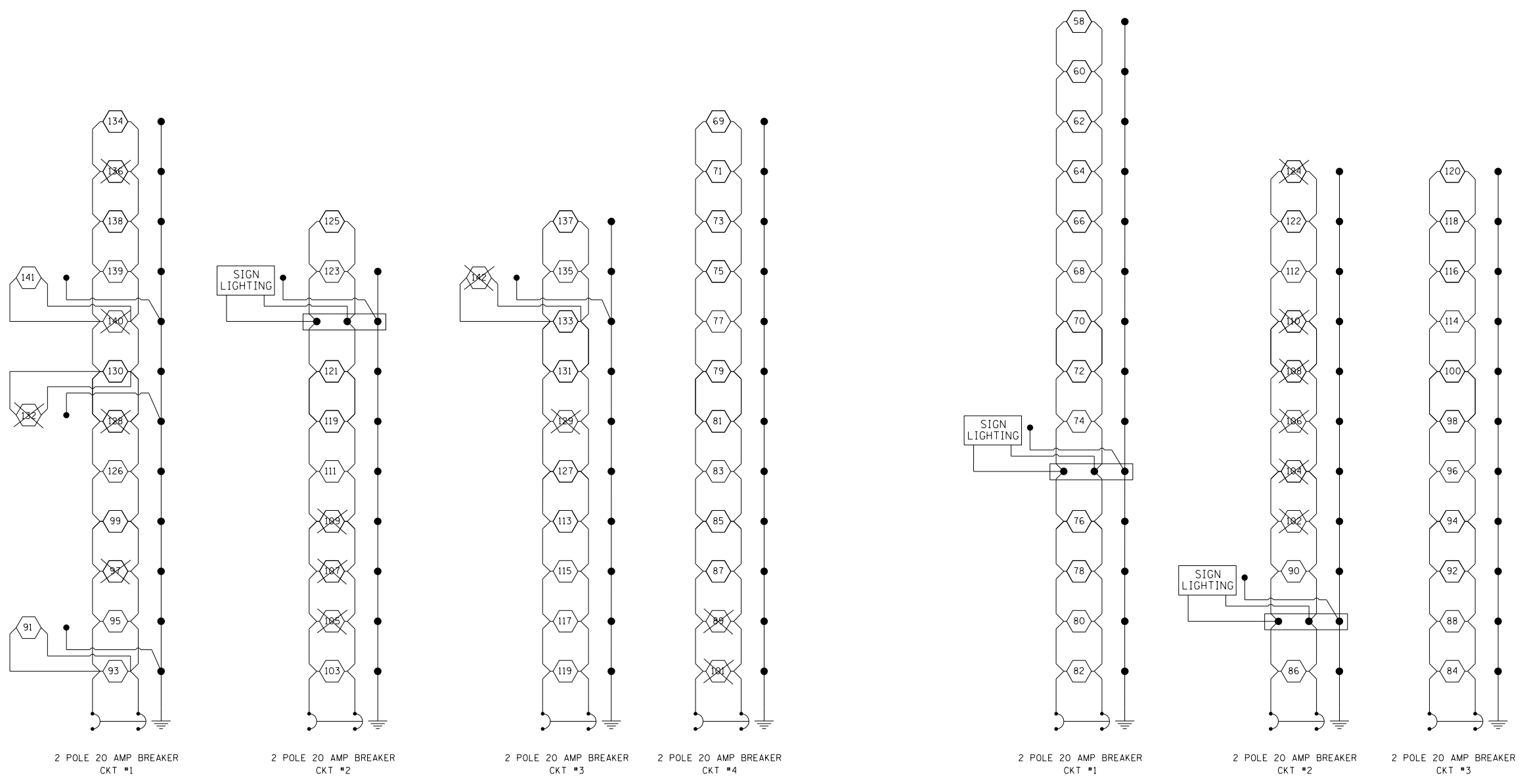
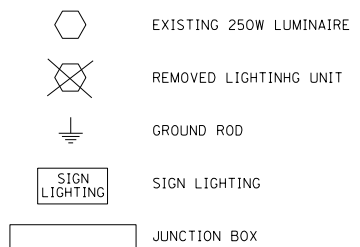

WIRING DIAGRAMS
EXISTING LIGHTING
CONTROLLER #1

WIRING DIAGRAMS
EXISTING LIGHTING
CONTROLLER #2

FILE NAME =	USER NAME = jacksonec	DESIGNED -	REVISED -	STATE OF ILLINOIS DEPARTMENT OF TRANSPORTATION	I-57/64 TRI-LEVEL INTERCHANGE EXISTING LIGHTING WIRING DIAGRAMS			F.A.I RTE.	SECTION	COUNTY	TOTAL SHEETS	SHEET NO.	
p:\11\084EBIDINTEG.illinois.gov\PIWIDOT\Documents\IDOT Offices\District 9\Projects\78507\Drawings\CAD\Sheets\Lighting sheets.dgn		DRAWN -	REVISED -		SCALE: NTS	SHEET 01 OF 02 SHEETS	STA. N/A	TO STA. N/A	157/64	(41-3,41-3-1L-1	JEFFERSON	18	17
Default	PLOT SCALE = 100.0000' / in.	CHECKED -	REVISED -					CONTRACT NO. 78507			ILLINOIS FED. AID PROJECT		
	PLOT DATE = 5/5/2016	DATE -	REVISED -										

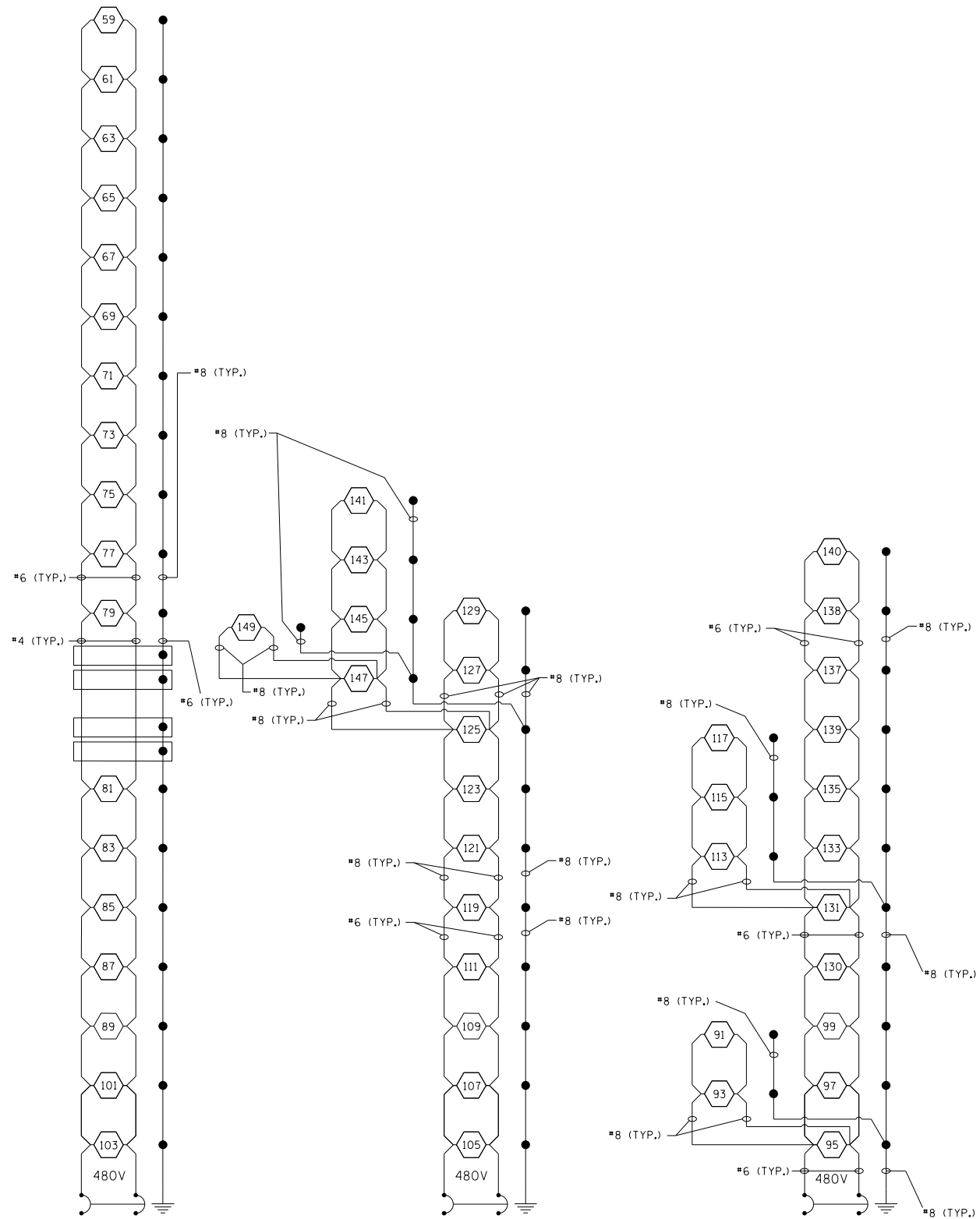

2 POLE 20 AMP BREAKER CKT #1 2 POLE 20 AMP BREAKER CKT #2 2 POLE 20 AMP BREAKER CKT #3

WIRING DIAGRAMS
PROPOSED LIGHTING
CONTROLLER #1

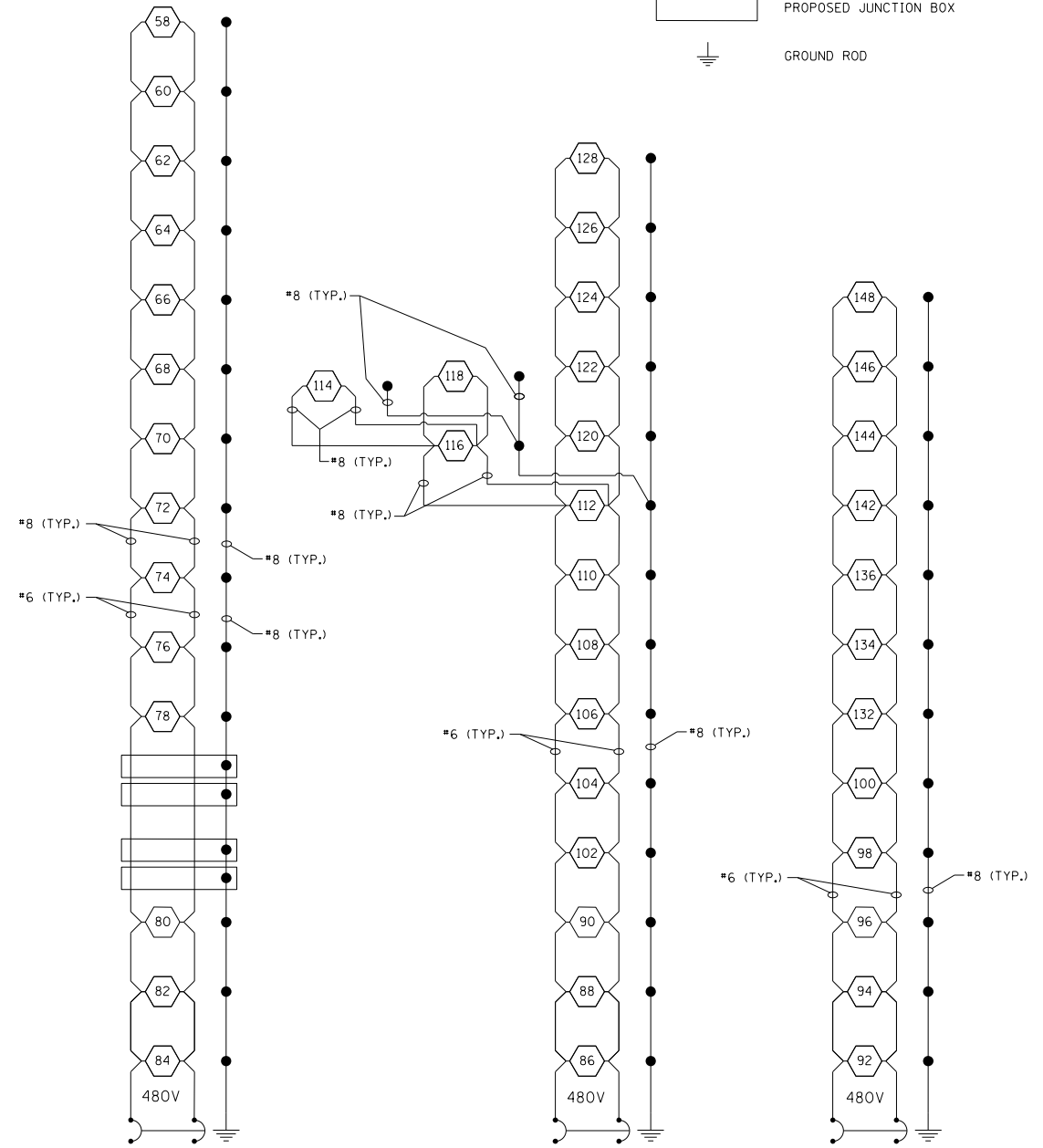

2 POLE 20 AMP BREAKER CKT #1 2 POLE 20 AMP BREAKER CKT #2 2 POLE 20 AMP BREAKER CKT #3

WIRING DIAGRAMS
PROPOSED LIGHTING
CONTROLLER #2

NOTES:
1. ALL NECESSARY REVISIONS TO THE WIRING SHOWN ON THIS SHEET SHALL BE MADE AT NO ADDITIONAL COST TO THE DEPARTMENT AND TO THE SATISFACTION OF THE ENGINEER.

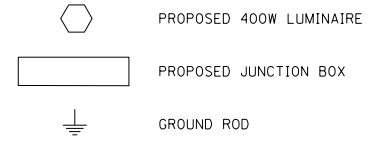

FILE NAME =	USER NAME = jacksonc	DESIGNED -	REVISED -
p:\11\084EBIDINTEG.illinois.gov\PIWIDOT\Documents\DOT Offices\District 9\Projects\78507\Drawings\CAD\Sheets\Lighting sheets.dgn		DRAWN -	REVISED -
Default	PLOT SCALE = 100.0000' / in.	CHECKED -	REVISED -
	PLOT DATE = 5/5/2016	DATE -	REVISED -

**STATE OF ILLINOIS
DEPARTMENT OF TRANSPORTATION**

I-57/64 TRI-LEVEL INTERCHANGE PROP LIGHTING WIRING DIAGRAM			
SCALE: NTS	SHEET 2 OF 2 SHEETS	STA. N/A	TO STA. N/A

F.A.I. RE. 157/64	SECTION (41-3,41-3-1L-1)	COUNTY JEFFERSON	TOTAL SHEETS 18	SHEET NO. 18
CONTRACT NO. 78507				
ILLINOIS FED. AID PROJECT				