

F.A.P. RTE.	SECTION	COUNTY	TOTAL SHEETS	SHEET NO.
866	4N-1	LAKE	165	35
STA.		TO STA.		
FED. ROAD DIST. NO.		ILLINOIS FED. AID PROJECT		

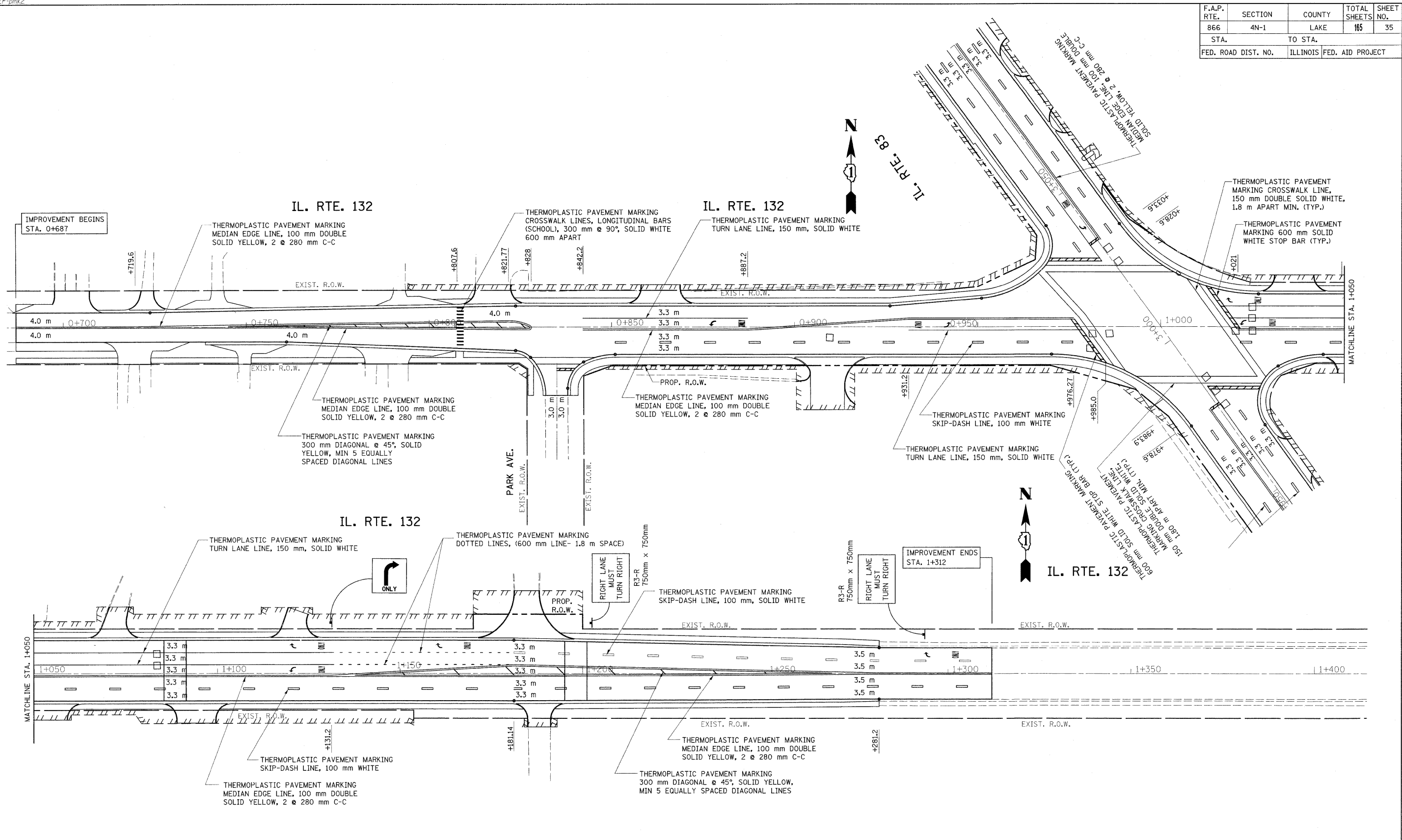

- NOTES:**
1. ALL DIMENSIONS ARE TO THE EDGE OF PAVEMENT OR LANE.
 2. ALL FINAL PAVEMENT MARKINGS ARE THERMOPLASTIC.
 3. FOR PAVEMENT MARKING DETAILS SEE SPECIAL DETAIL SHEETS FOR "DISTRICT ONE PAVEMENT MARKINGS".
 4. FOR DETAILS AND SYMBOLS OF RAISED REFLECTIVE PAVEMENT MARKERS, SEE SPECIAL DETAIL SHEETS FOR "DISTRICT ONE TYPICAL APPLICATIONS RAISED REFLECTIVE PAVEMENT MARKERS (SNOW PLOW RESISTANT)". DUAL ONE WAY CRYSTAL MARKERS SHALL BE USED ON SKIP-DASH LANE LINES.

REVISIONS	
NAME	DATE

ILLINOIS DEPARTMENT OF TRANSPORTATION
**IL. RTE. 83 (MILWAUKEE AVE.)
 @ IL. RTE. 132 (GRAND AVE.)**
PROPOSED PAVEMENT MARKING PLAN

SCALE: 1:500
 DATE 2/8/2010

DRAWN BY
 CHECKED BY