

F.A. RTE.	SECTION	COUNTY	TOTAL SHEETS	SHEET NO.
866	4N-1	LAKE	165	94
STA. 3 + 065		TO STA. 3 + 160		
FED. ROAD DIST. NO.		ILLINOIS FED. AID PROJECT		

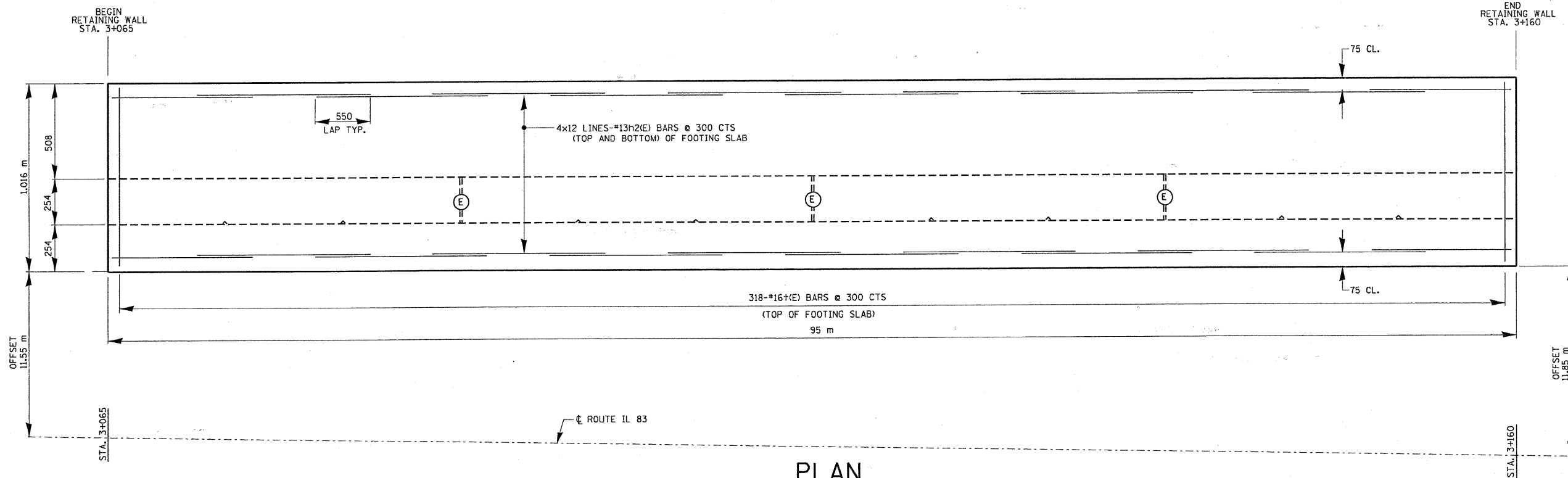
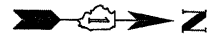

PLAN
(SHOWING FOOTING REINFORCEMENT)

BILL OF MATERIALS

BAR	NO.	SIZE	LENGTH (m)	SHAPE
h(E)	28	#13	8.470	—
h1(E)	56	#13	8.145	—
h2(E)	96	#13	8.458	—
n(E)	324	#13	2.848	L
n4(E)	324	#13	1.339	J
t(E)	318	#16	916	—
REINFORCEMENT BARS, EPOXY COATED			KG	3300
CONCRETE STRUCTURES			CU. M.	78
PARAPET RAILING			M	95
STRUCTURE EXCAVATION			CU. M.	210
CONCRETE GUTTER, TYPE B			M	95

GENERAL NOTES:

- ALL ELEVATIONS ARE IN METERS.
- ALL DIMENSIONS ARE IN mm EXCEPT AS NOTED.
- BACK FILLING SHALL BE PERFORMED IN ACCORDANCE WITH ARTICLE 502.10 OF STANDARD SPECIFICATIONS FOR ROAD AND BRIDGE CONSTRUCTION, ADOPTED JANUARY 1, 2002.
- USE CLASS SI CONCRETE.
- MINIMUM CLEAR COVER 50mm. EXCEPT AS NOTED.
- REINFORCEMENT BARS DESIGNATED (E) SHALL BE EPOXY COATED.
- BARS INDICATED THUS 4x12-#13 etc. INDICATES 4 LINES OF BARS WITH 12 LENGTHS PER LINE.
- MINIMUM BAR LAP #13 BARS 550 mm
- REINFORCEMENT BARS SHALL CONFORM TO THE REQUIREMENTS OF AASHTO M 31M, M 42M OR 53M GRADE 400.
- ALL EXPOSED CONCRETE EDGES SHALL BE CHAMFERED 20 mm EXCEPT AS NOTED.

SCOPE OF WORK:

- PERFORM STRUCTURE EXCAVATION
- INSTALL RETAINING WALL
- INSTALL CURB GUTTER
- INSTALL RAILING

DESIGN SPECIFICATIONS:

1996 AASHTO STANDARD SPECIFICATIONS FOR HIGHWAY BRIDGES, INCLUDING 1997, 1998, 1999 & 2000 INTERIMS

LOADING:

EQUIVALENT FLUID LATERAL SOIL PRESSURE = 6.3 kPa/m

DESIGN STRESSES:

$f'_c = 24 \text{ MPa}$
 $f_y = 400 \text{ MPa (Reinf.)}$
 $f_y = 250 \text{ KPa (M270 M GRADE 250)}$

LEGEND:

- (E) = EXPANSION JOINT
- (C) = CONSTRUCTION JOINT
- B.F. = BACK FACE
- F.F. = FRONT FACE

REVISIONS	
NAME	DATE

ILLINOIS DEPARTMENT OF TRANSPORTATION
 IL 83 (MILWAUKEE AVENUE)
 AT IL 132 (GRAND AVENUE)
 RETAINING WALL- PLAN FOOTING
 STA. 3+065 - STA. 3+160
 S.N. 049-W030
 SCALE: NONE
 DATE: AUGUST, 2003
 DRAWN BY: MVT
 CHECKED BY: R.S.S.

Tue Aug 12 07:27:44 2003
 c:\projects\struct\il83\1132.m32 LV=1-63
 DISTRICT ONE - DESIGN
 PLAN PREPARATION ENGINEER JOHN FORTMANN / RUSS SINHA (847) 705-4209 / ATTENTION MARK V. TINIAKOS (847) 705-4266