

F.A.U. RTE.	SECTION	COUNTY	TOTAL SHEETS	SHEET NO.
0383	113 X-RS-3	WILL	15	1
FED. ROAD DIST. NO. 1		ILLINOIS	CONTRACT NO. 60K53	

**STATE OF ILLINOIS
DEPARTMENT OF TRANSPORTATION
DIVISION OF HIGHWAYS**

**PROPOSED
HIGHWAY PLANS**

**F.A.U. ROUTE 0383 / COAL CITY ROAD
ILL 113 (DIVISION STREET) TO ILL 53
SECTION: 113 X-RS-3
RESURFACING
PROJECT: ACM-0383(007)
WILL COUNTY
C-91-522-10**

FOR INDEX OF SHEETS, SEE SHEET NO. 2

PROJECT IS LOCATED IN THE CITIES OF WILMINGTON AND BRAIDWOOD

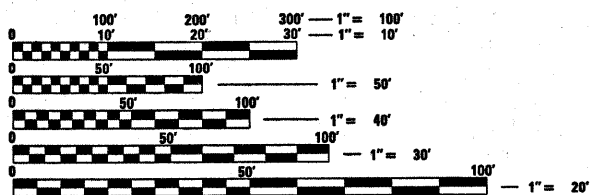

FULL SIZE PLANS HAVE BEEN PREPARED USING STANDARD ENGINEERING SCALES. REDUCED SIZED PLANS WILL NOT CONFORM TO STANDARD SCALES. IN MAKING MEASUREMENTS ON REDUCED PLANS, THE ABOVE SCALES MAY BE USED.

J.U.L.I.E.
JOINT UTILITY LOCATION INFORMATION FOR EXCAVATION
1-800-892-0123
OR 811

PROJECT ENGINEER: DAN WILGREEN (847) 705-4240
PROJECT MANAGER: KEN ENG

CONTRACT NO. 60K53

D-91-522-10

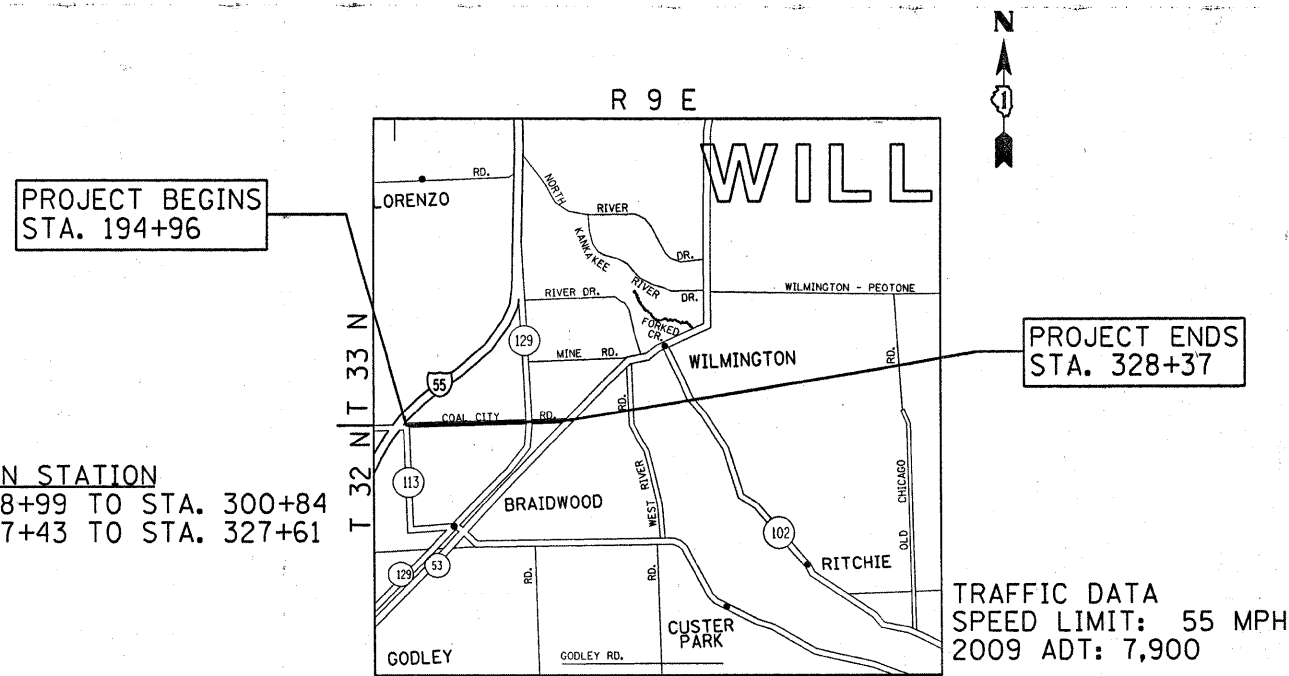

OMISSION STATION
STA. 298+99 TO STA. 300+84
STA. 327+43 TO STA. 327+61

TRAFFIC DATA
SPEED LIMIT: 55 MPH
2009 ADT: 7,900

WILMINGTON & REED TOWNSHIP

GROSS LENGTH OF PROJECT = 13,341 FEET (2.53 MILES)
NET LENGTH OF PROJECT = 13,138 FEET (2.49 MILES)

STATE OF ILLINOIS
DEPARTMENT OF TRANSPORTATION
DIVISION OF HIGHWAYS

SUBMITTED APRIL 28, 2010

Diana M. O'Keefe
DEPUTY DIRECTOR OF HIGHWAYS, REGION ENGINEER

June 05 2010
Scott E. Stitt, P.E./a
acting ENGINEER OF DESIGN AND ENVIRONMENT

June 05 2010
Christine M. Reed/a
DIRECTOR OF HIGHWAYS, CHIEF ENGINEER

**PRINTED BY THE AUTHORITY
OF THE STATE OF ILLINOIS**

INDEX OF SHEETS

SHEET NO.

DESCRIPTION

STATE STANDARDS

GENERAL NOTES:

- 1 TITLE SHEET
- 2 INDEX OF SHEETS, STATE STANDARDS, AND GENERAL NOTES
- 3 SUMMARY OF QUANTITIES
- 4 TYPICAL SECTIONS
- 5-9 ROADWAY & PAVEMENT MARKING PLANS
- 10 PAVEMENT PATCHING FOR HOT-MIX ASPHALT SURFACED PAVEMENT (BD-22)
- 11 BUTT JOINT AND HOT-MIX ASPHALT TAPER DETAILS (BD-32)
- 12 TRAFFIC CONTROL AND PROTECTION FOR SIDES ROADS, INTERSECTIONS AND DRIVEWAYS (TC-10)
- 13 TYPICAL APPLICATIONS RAISED REFLECTIVE PAVEMENT MARKERS (SNOW PLOW RESISTANT) (TC-11)
- 14 DISTRICT ONE TYPICAL PAVEMENT MARKINGS (TC-13)
- 15 ARTERIAL ROAD INFORMATION SIGNING (TC-22)

- 000001-05 STANDARD SYMBOLS, ABBREVIATIONS, AND PATTERNS
- 442201-03 CLASS C AND D PATCHES
- 701201-03 LANE CLOSURE, 2L, 2W, DAY ONLY, FOR SPEEDS ≥ 45 MPH
- 701306-02 LANE CLOSURE, 2L, 2W, SLOW MOVING OPERATIONS DAY ONLY, FOR SPEEDS ≥ 45 MPH
- 701311-03 LANE CLOSURE 2L, 2W MOVING OPERATIONS-DAY ONLY FOR SPEEDS ≥ 45 MPH
- 701901-01 TRAFFIC CONTROL DEVICES
- 780001-02 TYPICAL PAVEMENT MARKINGS

BEFORE STARTING ANY EXCAVATION, THE CONTRACTOR SHALL CALL "JULIE" AT 800-892-0123 OR 811 FOR FIELD LOCATIONS OF BURIED ELECTRIC, TELEPHONE AND GAS FACILITIES. (48 HOUR NOTIFICATION IS REQUIRED)

THE CONTRACTOR SHALL COORDINATE CONSTRUCTION ACTIVITIES WITH UTILITY COMPANIES AND THE CITIES OF WILMINGTON AND BRAIDWOOD.

THE CONTRACTOR WILL NOT BE ALLOWED TO SET UP A YARD OR FIELD OFFICE ON STATE PROPERTY WITHOUT WRITTEN PERMISSION FROM THE DEPARTMENT.

ALL HOT-MIX ASPHALT PAVEMENT PATCHING SHALL BE CLASS D.

BUTT JOINTS WILL BE INSTALLED AT THE ENDS OF ALL RESURFACING (WHERE RESURFACING MEETS EXISTING PAVEMENT), IN ACCORDANCE WITH THE "BUTT JOINT AND HMA TAPER DETAILS" SHEET INCLUDED IN THE PLANS, UNLESS OTHERWISE SPECIFIED.

WHEN MILLED PAVEMENT IS OPEN TO TRAFFIC THE MAXIMUM GRADE DIFFERENTIAL BETWEEN PASSES OF THE MILLING MACHINE SHALL NOT EXCEED 1 1/2 INCHES (40MM) WHERE THE SPEED LIMIT IS 45 MPH (80KM/H) OR LESS AND 1 INCH (25 MM) WHERE THE SPEED LIMIT IS GREATER THAN 45 MPH (80 KM/H), WITH WRITTEN APPROVAL FROM THE ENGINEER, A MAXIMUM GRADE DIFFERENTIAL OF 3 INCHES (75 MM) MAY BE ALLOWED IF THE EDGE OF THE MILLING IS SLOPED A MINIMUM 1:3 (V:H).

10 FEET (3 METER) TRANSITION SHALL BE USED TO MATCH PROPOSED CURB AND GUTTER TO EXISTING CURB AND GUTTERS IN THE FIELD, UNLESS OTHERWISE SHOWN. THE TRANSITION SHALL BE PAID FOR AT THE CONTRACT UNIT PRICE FOR THE PROPOSED ITEMS OF WORK SPECIFIED.

THE RESIDENT ENGINEER SHALL VERIFY THE LOCATIONS OF ALL EXISTING PAVEMENT MARKINGS PRIOR TO MILLING OR RESURFACING.

ALL PAVEMENT MARKINGS SHALL BE PLACED THROUGHOUT THE IMPROVEMENT ACCORDING TO DISTRICT 1 TYPICAL PAVEMENT MARKING.

TWO WEEKS PRIOR TO PLACING PERMANENT PAVEMENT MARKINGS, CONTACT CORA MATHIS, AREA TRAFFIC FIELD ENGINEER AT (815) 485-6475.

RAISED REFLECTIVE PAVEMENT MARKERS SHALL BE PLACED THROUGHOUT THE IMPROVEMENT ACCORDING TO THE DISTRICT STANDARDS AS NOTED IN THE DETAIL.

THE UNIT WEIGHT (CONVERSION FACTOR) QUOTED IS FOR THE ESTIMATING PLAN QUANTITIES ONLY. ACTUAL QUANTITIES TO FULFILL CONTRACT REQUIREMENTS WILL BE DETERMINED BASED ON UNIT WEIGHT OF APPROVED MIX DESIGN, PLAN DIMENSIONS, AND DENSITY LIMITATIONS. MAXIMUM PAYMENT WILL BE COMPUTED BASED ON WEIGHT AVERAGE DENSITIES OF THE IN-PLACE MIXTURE.

THE RESIDENT ENGINEER SHALL CONTACT THE TRAFFIC CONTROL SUPERVISOR AT (847) 705-4470 A MINIMUM OF 72 HOURS PRIOR TO THE PLACEMENT OF ANY TEMPORARY TRAFFIC CONTROL DEVICES.

BEFORE BEGINNING ANY WORK, THE CONTRACTOR SHALL RETAIN AND RECORD FOR FUTURE REFERENCE, ALL EXISTING PAVEMENT MARKING LINES (AND RAISED REFLECTIVE MARKINGS) IN ORDER THAT THESE LOCATIONS CAN BE RE-ESTABLISHED FOR STRIPING. EXACT LOCATIONS OF ALL PAVEMENT MARKINGS SHALL BE AS DIRECTED BY THE ENGINEER.

FILE NAME =	USER NAME = obreuh	DESIGNED -	REVISED -	STATE OF ILLINOIS DEPARTMENT OF TRANSPORTATION	COAL CITY RD. FROM ILL 113/DIVISION ST. TO ILL 53 INDEX OF SHEETS STATE STANDARDS AND GENERAL NOTES	F.A.U. RTE. 0383	SECTION 113 X-RS-3	COUNTY WILL	TOTAL SHEETS 15	SHEET NO. 2		
ct:\pw_work\pwidot\obreuh\0195053\015210-Design.dgn	PLOT SCALE = 50.0000' / IN.	DRAWN -	REVISED -			SCALE: 1" = 50'	SHEET NO. OF SHEETS STA.	TO STA.	CONTRACT NO. 60K53			
	PLOT DATE = 4/26/2010	CHECKED -	REVISED -			FED. ROAD DIST. NO. 1 ILLINOIS FED. AID PROJECT						
		DATE -	REVISED -									

SUMMARY OF QUANTITIES			CONSTRUCTION TYPE CODE						SUMMARY OF QUANTITIES			CONSTRUCTION TYPE CODE							
CODE NO	ITEM	UNIT	URBAN TOTAL QUANTITIES	1000-2A 80% FED. 20% STATE						CODE NO	ITEM	UNIT	TOTAL QUANTITIES	1000-2A					
20201006	GRADING AND SHAPING SHOULDERS	UNIT	255	255															
40600200	BITUMINOUS MATERIALS (PRIME COAT)	TON	25	25															
40600300	AGGREGATE (PRIME COAT)	TON	127	127															
40600400	MIXTURE FOR CRACKS, JOINTS, AND FLANGEWAYS	TON	47	47															
40600826	POLYMERIZED LEVELING BINDER (MACHINE METHOD), IL-4, 75, N50	TON	1301	1301															
40600895	CONSTRUCTING TEST STRIP	EACH	1	1															
40600982	HOT-MIX ASPHALT SURFACE REMOVAL - BUTT JOINT	SO YD	173	173															
40603340	HOT-MIX ASPHALT SURFACE COURSE, MIX "D", N70	TON	2650	2650															
44000158	HOT-MIX ASPHALT SURFACE REMOVAL, 2 1/4"	SO YD	31542	31542															
44201753	CLASS D PATCHES, TYPE II, 9 INCH	SO YD	448	448															
44201757	CLASS D PATCHES, TYPE III, 9 INCH	SO YD	60	60															
44201759	CLASS D PATCHES, TYPE IV, 9 INCH	SO YD	1056	1056															
48102100	AGGREGATE WEDGE SHOULDER, TYPE B	TON	1018	1018															
67000400	ENGINEER'S FIELD OFFICE, TYPE A	CAL MO	6	6															
67100100	MOBILIZATION	L SUM	1	1															
70100450	TRAFFIC CONTROL AND PROTECTION, STANDARD 701201	L SUM	1	1															
70100460	TRAFFIC CONTROL AND PROTECTION, STANDARD 701306	L SUM	1	1															
70300100	SHORT-TERM PAVEMENT MARKING	FOOT	3629	3629															
70300210	TEMPORARY PAVEMENT MARKING - LETTERS AND SYMBOLS	SO FT	122.0	122.0															
70300220	TEMPORARY PAVEMENT MARKING - LINE 4"	FOOT	30127	30127															
70300280	TEMPORARY PAVEMENT MARKING - LINE 24"	FOOT	42.0	42.0															
70301000	WORK ZONE PAVEMENT MARKING REMOVAL	SO FT	403	403															
* 78000100	THERMOPLASTIC PAVEMENT MARKING - LETTERS AND SYMBOLS	SO FT	122.0	122.0															
* 78000200	THERMOPLASTIC PAVEMENT MARKING - LINE 4"	FOOT	30127	30127															
* 78000650	THERMOPLASTIC PAVEMENT MARKING - LINE 24"	FOOT	42.0	42.0															
* 78100100	RAISED REFLECTIVE PAVEMENT MARKER	EACH	185	185															
78300200	RAISED REFLECTIVE PAVEMENT MARKER REMOVAL	EACH	148	148															
X0322256	TEMPORARY INFORMATION SIGNING	SO FT	51.4	51.4															
Z0048665	RAILROAD PROTECTIVE LIABILITY INSURANCE	L SUM	1.0	1.0															

* SPECIALTY ITEMS

FILE NAME =	USER NAME = abreuah	DESIGNED -	REVISED -	STATE OF ILLINOIS DEPARTMENT OF TRANSPORTATION	COAL CITY RD. FROM ILL 113 / DIVISION ST. TO ILL 53 SUMMARY OF QUANTITIES	F.A.U. RTE.	SECTION	COUNTY	TOTAL SHEETS	SHEET NO.
c:\pwork\pwork\DOT\ABREUAH\0195053\01952210-Desig.dwg	DRAWN -	REVISED -	0383			113 X-RS-3	WILL	15	3	
PLOT SCALE = 50,0000' / IN.	CHECKED -	REVISED -	CONTRACT NO. 60K53							
PLOT DATE = 4/30/2010	DATE -	REVISED -	SCALE:			SHEET NO.	OF SHEETS	STA.	TO STA.	FED. ROAD DIST. NO. 1 ILLINOIS FED. AID PROJECT

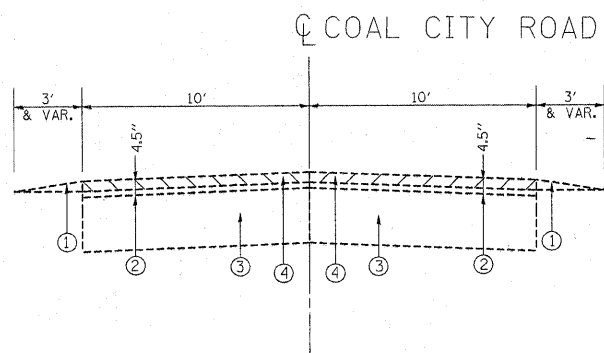

EXISTING TYPICAL SECTION
COAL CITY RD.
STA. 194+96 TO STA. 298+99
STA. 300+84 TO STA. 327+43
STA. 327+61 TO STA. 328+37

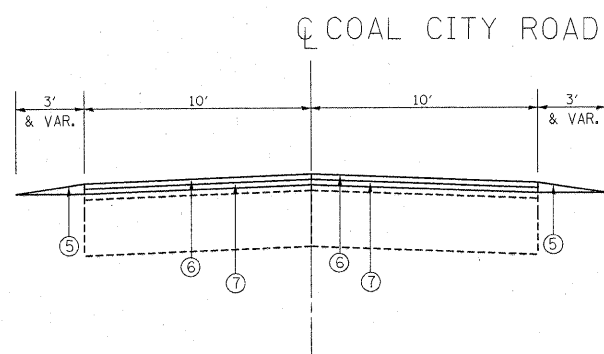

PROPOSED TYPICAL SECTION
COAL CITY RD.
STA. 194+96 TO STA. 298+99
STA. 300+84 TO STA. 327+43
STA. 327+61 TO STA. 328+37

LEGEND:

- ① EXISTING AGGREGATE SHOULDER
- ② EXISTING HOT-MIX ASPHALT OVERLAY, ±4.5"
- ③ EXISTING PCC PAVEMENT ±7"
- ④ PROPOSED HOT-MIX ASPHALT SURFACE REMOVAL, 2 1/4"
- ⑤ PROPOSED AGGREGATE WEDGE SHOULDER, TYPE B
- ⑥ PROPOSED HOT-MIX ASPHALT SURFACE COURSE, MIX "D", N70, (IL 9.5 mm); 1 1/2 "
- ⑦ PROPOSED POLYMERIZED LEVELING BINDER (MACHINE METHOD), IL-4.75, N50; 3/4"

* NOTE: CONTRACTOR SHALL MILL FIRST
ACCORDING TO STD. BD-22

HOT-MIX ASPHALT MIXTURE REQUIREMENTS	
MIXTURE TYPE	AIR VOIDS
RESURFACING	
HOT-MIX ASPHALT SURFACE COURSE, MIX "D", N70 (IL 9.5 mm)	4% @ 70 GYR
POLYMERIZED LEVELING BINDER (MACHINE METHOD), IL-4.75, N50	4% @ 50 GYR
PATCHING	
CLASS D PATCHES (HMA BINDER IL-19 mm)	4% @ 70 GYR

THE UNIT WEIGHT USED TO CALCULATE ALL HMA SURFACE MIXTURE QUANTITIES IS 112 LB/ SQ YD./IN.

THE "AC TYPE" FOR POLYMERIZED HMA MIXES SHALL BE "SBS/SBR PG 70-22" AND FOR NON-POLYMERIZED HMA THE "AC TYPE" SHALL BE "PG 64 -22" UNLESS MODIFIED BY DISTRICT ONE SPECIAL PROVISIONS. FOR "PERCENT OF RAP" SEE DISTRICT ONE SPECIAL PROVISIONS.

FILE NAME =	USER NAME = abreuh	DESIGNED -	REVISED -	STATE OF ILLINOIS DEPARTMENT OF TRANSPORTATION	COAL CITY ROAD (FROM ILL 113 /DIVISION ST. TO ILL 53) TYPICAL SECTIONS	F.A.U. RTE.	SECTION	COUNTY	TOTAL SHEETS	SHEET NO.
es:\pw_work\VPWIDOT\ABREUAH\0195053\0152210-Design.dgn	DRAWN -	REVISED -	0383			113 X-RS-3	WILL	15	4	
PLOT SCALE = 50,000 ' / IN.	CHECKED -	REVISED -	CONTRACT NO. 60K53							
PLOT DATE = 4/30/2010	DATE -	REVISED -	ILLINOIS FED. AID PROJECT							
					SCALE:	SHEET NO. OF SHEETS		STA. TO STA.		

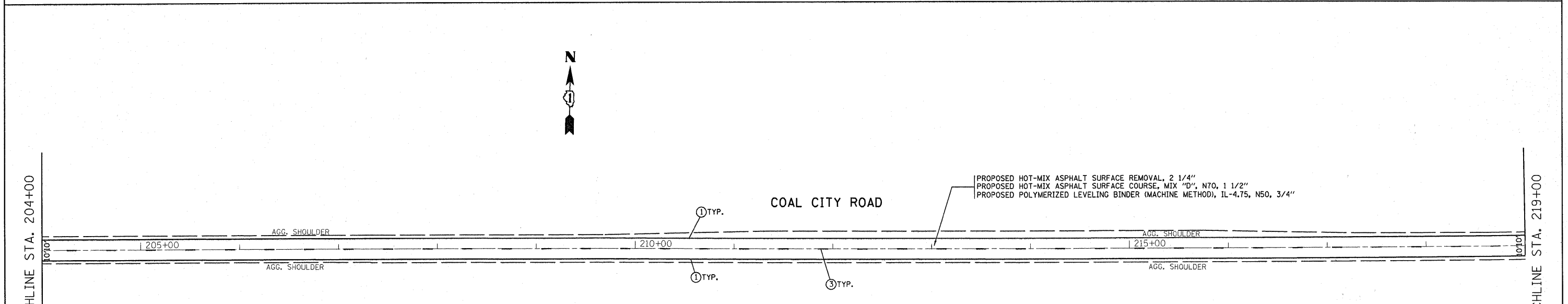
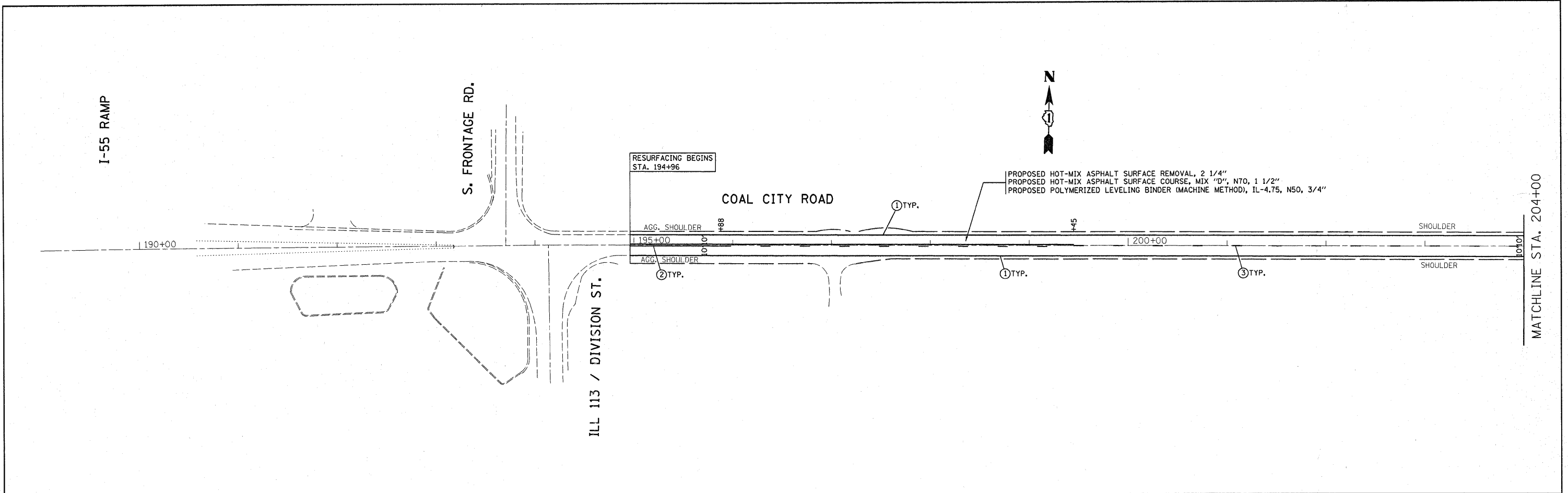

- LEGEND**
- ① THERMOPLASTIC PAVEMENT MARKING
EDGE LINE, 4" SOLID WHITE
 - ② THERMOPLASTIC PAVEMENT MARKING
4" SOLID DOUBLE YELLOW
 - ③ THERMOPLASTIC PAVEMENT MARKING
4" YELLOW SKIP DASH CENTER LINE
 - ④ THERMOPLASTIC PAVEMENT MARKING
4" YELLOW SKIP DASH CENTER LINE &
4" SOLID YELLOW NO PASSING LINE
 - ⑤ THERMOPLASTIC PAVEMENT MARKING
24" WHITE STOP BAR
 - ⑥ THERMOPLASTIC PAVEMENT MARKING
LETTER & SYMBOLS

FILE NAME =	USER NAME = abreuah	DESIGNED -	REVISED -	STATE OF ILLINOIS DEPARTMENT OF TRANSPORTATION	COAL CITY ROAD FROM ILL 113 / DIVISION ST. TO ILL 53 ROADWAY & PAVEMENT MARKING PLAN			F.A.U. RTE.	SECTION	COUNTY	TOTAL SHEETS	SHEET NO.
ct:\pwwork\pwidot\ABREUAH\0195253\0152210-sht-plen.dgn	PLOT SCALE = 50.0000' / IN.	DRAWN -	REVISED -					0383	113 X-RS-3	WILL	15	5
PLOT DATE = 4/26/2010	DATE -	CHECKED -	REVISED -		SCALE: SHEET NO. OF SHEETS STA. TO STA.			CONTRACT NO. 60K53				
ILLINOIS FED. AID PROJECT												

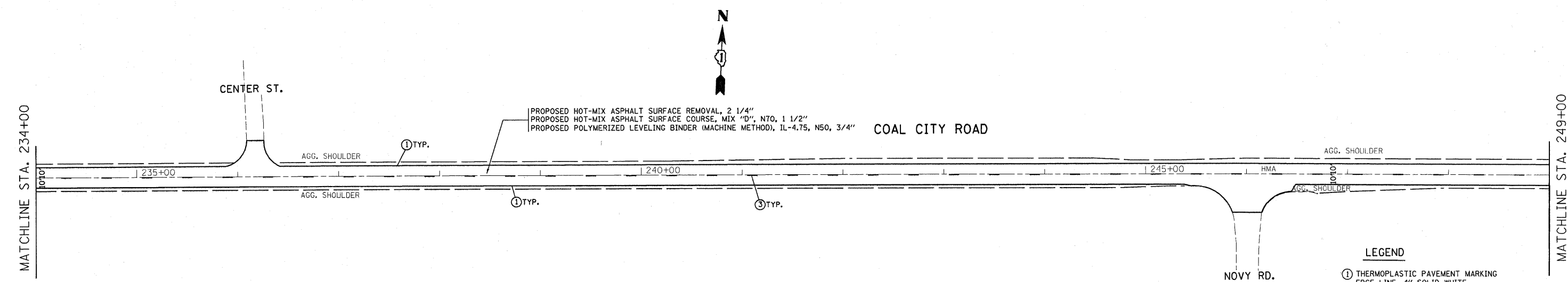
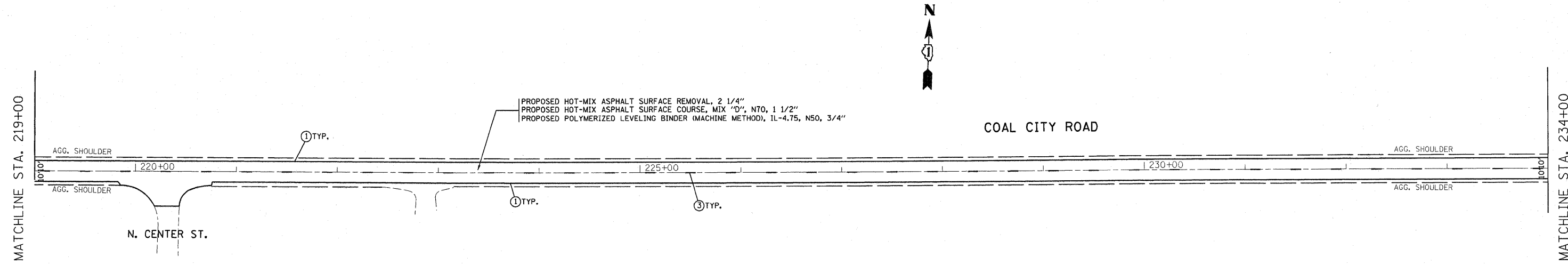

- LEGEND**
- ① THERMOPLASTIC PAVEMENT MARKING
EDGE LINE, 4" SOLID WHITE
 - ② THERMOPLASTIC PAVEMENT MARKING
4" SOLID DOUBLE YELLOW
 - ③ THERMOPLASTIC PAVEMENT MARKING
4" YELLOW SKIP DASH CENTER LINE
 - ④ THERMOPLASTIC PAVEMENT MARKING
4" YELLOW SKIP DASH CENTER LINE &
4" SOLID YELLOW NO PASSING LINE
 - ⑤ THERMOPLASTIC PAVEMENT MARKING
24" WHITE STOP BAR
 - ⑥ THERMOPLASTIC PAVEMENT MARKING
LETTER & SYMBOLS

FILE NAME =	USER NAME = obreuah	DESIGNED -	REVISED -	STATE OF ILLINOIS DEPARTMENT OF TRANSPORTATION	COAL CITY ROAD FROM ILL 113 /DIVISION ST. TO ILL 53 ROADWAY & PAVEMENT MARKING PLAN	F.A.U. RTE.	SECTION	COUNTY	TOTAL SHEETS	SHEET NO.	
c:\pwwork\pwwid01\ABREUAH\d0195053\0152	210-shr-plen.dgn	DRAWN -	REVISED -			0383	113 X-RS-3	WILL	15	6	
	PLOT SCALE = 50.0000' / IN.	CHECKED -	REVISED -			CONTRACT NO. 60K53					
	PLOT DATE = 4/26/2010	DATE -	REVISED -			ILLINOIS FED. AID PROJECT					
					SCALE:	SHEET NO. OF SHEETS		STA. TO STA.			

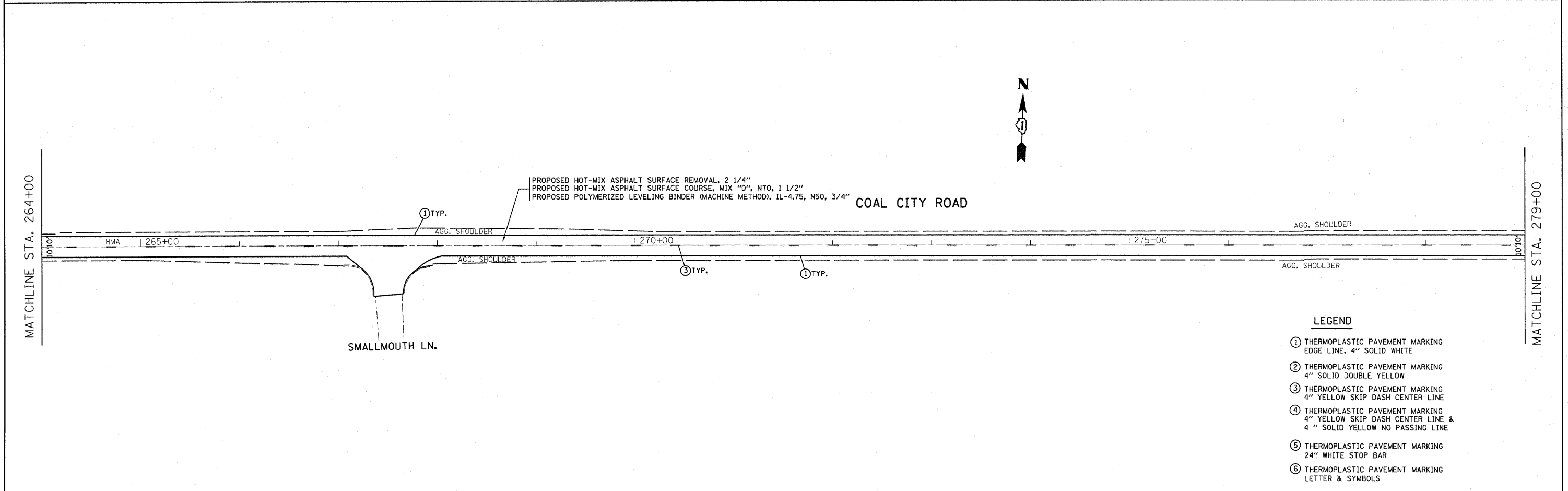
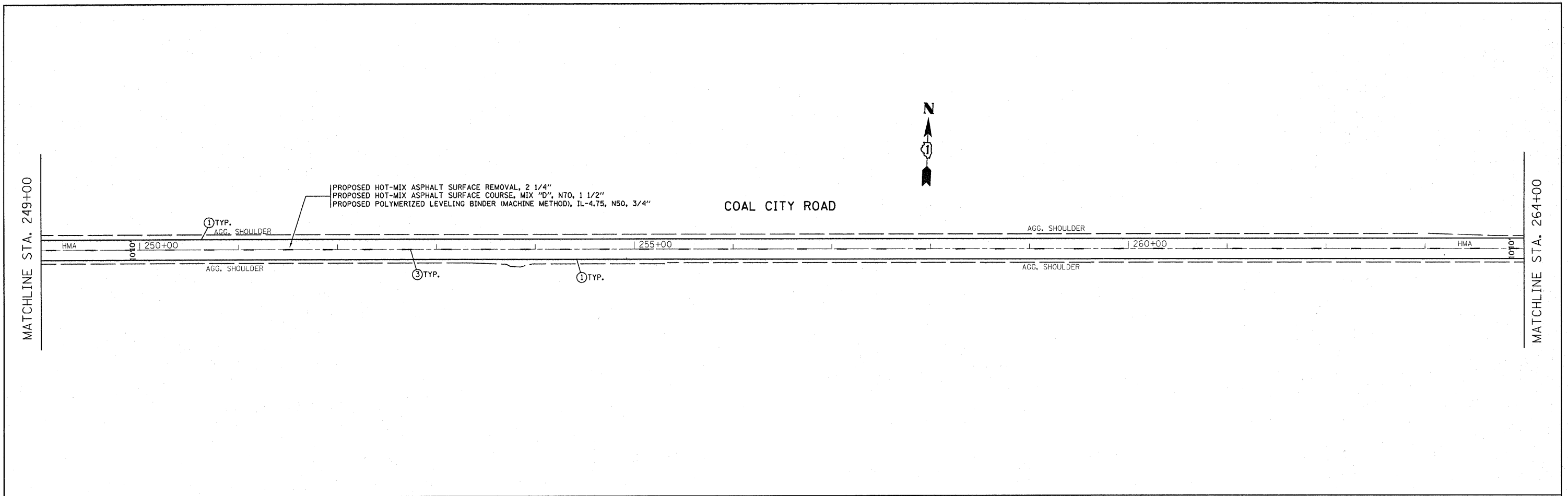

- LEGEND**
- ① THERMOPLASTIC PAVEMENT MARKING
EDGE LINE, 4" SOLID WHITE
 - ② THERMOPLASTIC PAVEMENT MARKING
4" SOLID DOUBLE YELLOW
 - ③ THERMOPLASTIC PAVEMENT MARKING
4" YELLOW SKIP DASH CENTER LINE
 - ④ THERMOPLASTIC PAVEMENT MARKING
4" YELLOW SKIP DASH CENTER LINE &
4" SOLID YELLOW NO PASSING LINE
 - ⑤ THERMOPLASTIC PAVEMENT MARKING
24" WHITE STOP BAR
 - ⑥ THERMOPLASTIC PAVEMENT MARKING
LETTER & SYMBOLS

FILE NAME =	USER NAME = abreuah	DESIGNED -	REVISED -	STATE OF ILLINOIS DEPARTMENT OF TRANSPORTATION	COAL CITY ROAD FROM ILL 113 /DIVISION ST. TO ILL 53 ROADWAY & PAVEMENT MARKING PLAN				F.A.U. RTE.	SECTION	COUNTY	TOTAL SHEETS	SHEET NO.
ca:\pw_work\PWIDOT\ABREUAH\0195053\015210-shr-plen.dgn	DRAWN -	REVISED -	REVISED -						0383	113 X-RS-3	WILL	15	7
PLOT SCALE = 50.0000' / IN.	CHECKED -	REVISED -	REVISED -		CONTRACT NO. 60K53								
PLOT DATE = 4/26/2010	DATE -	REVISED -	REVISED -		ILLINOIS FED. AID PROJECT								

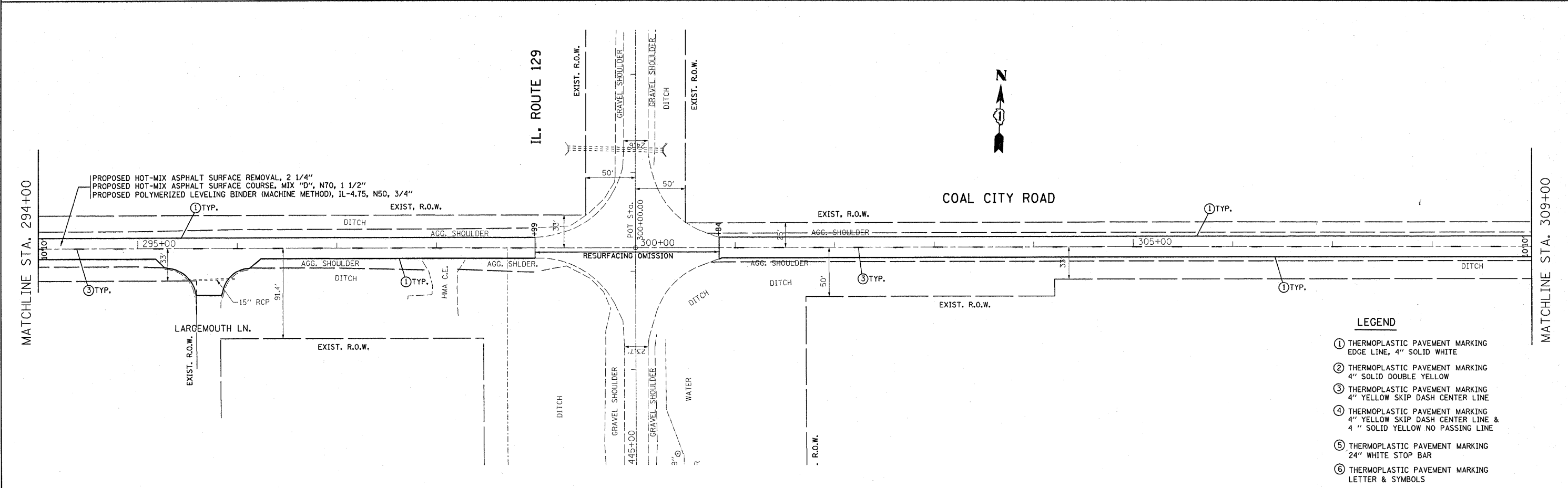
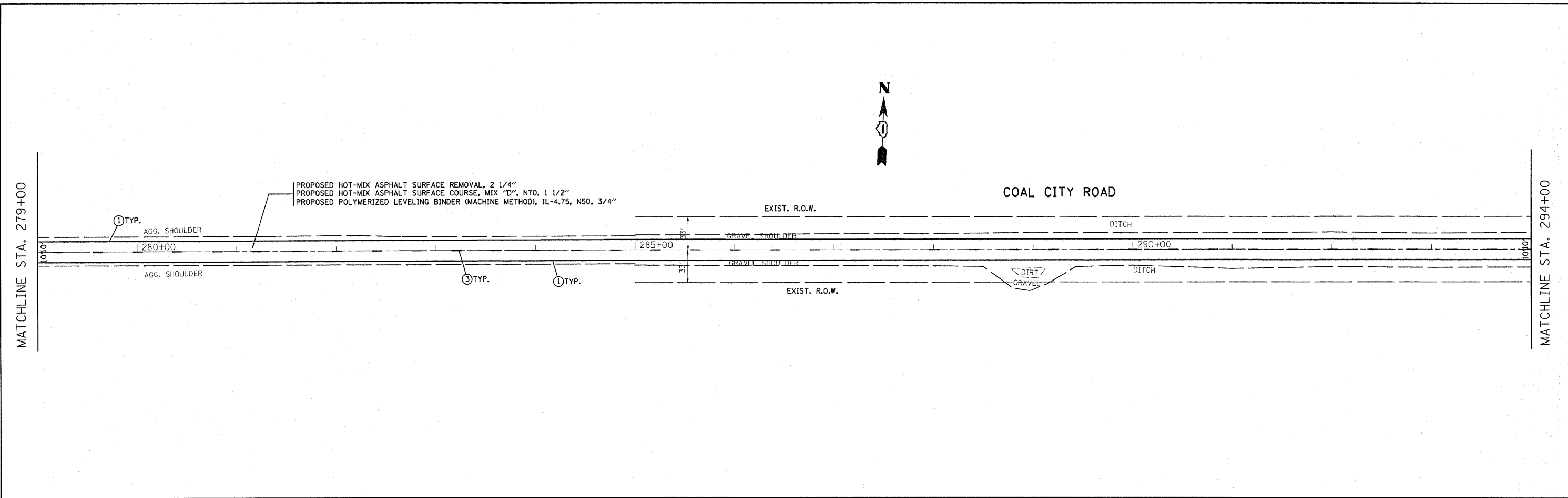

- LEGEND**
- ① THERMOPLASTIC PAVEMENT MARKING
EDGE LINE, 4" SOLID WHITE
 - ② THERMOPLASTIC PAVEMENT MARKING
4" SOLID DOUBLE YELLOW
 - ③ THERMOPLASTIC PAVEMENT MARKING
4" YELLOW SKIP DASH CENTER LINE
 - ④ THERMOPLASTIC PAVEMENT MARKING
4" YELLOW SKIP DASH CENTER LINE &
4" SOLID YELLOW NO PASSING LINE
 - ⑤ THERMOPLASTIC PAVEMENT MARKING
24" WHITE STOP BAR
 - ⑥ THERMOPLASTIC PAVEMENT MARKING
LETTER & SYMBOLS

FILE NAME =	USER NAME = abreuah	DESIGNED -	REVISED -	STATE OF ILLINOIS DEPARTMENT OF TRANSPORTATION	COAL CITY ROAD FROM ILL 113 /DIVISION ST. TO ILL 53 ROADWAY & PAVEMENT MARKING PLAN				F.A.U. RTE.	SECTION	COUNTY	TOTAL SHEETS	SHEET NO.
c:\pwork\PW\DOT\ABREUAH\d0195053\015210-att-plan.dgn	DRAWN -	REVISED -	REVISED -						0383	113 X-RS-3	WILL	15	8
	PLOT SCALE = 50,0000 ' / IN.	CHECKED -	REVISED -		SCALE: SHEET NO. OF SHEETS STA. TO STA.				CONTRACT NO. 60K53				
	PLOT DATE = 4/26/2010	DATE -	REVISED -		ILLINOIS FED. AID PROJECT								

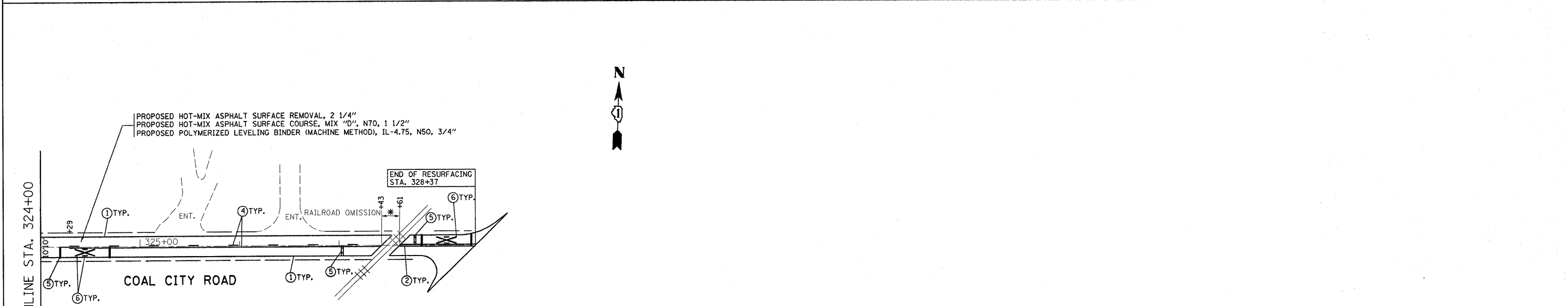
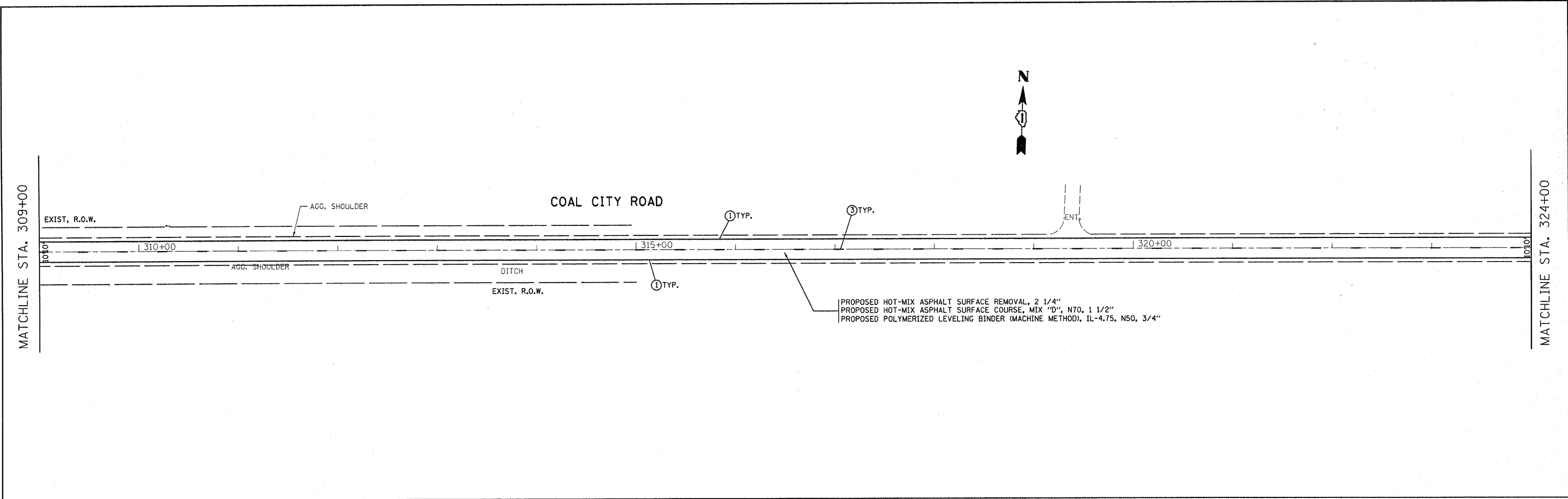

* NOTE:
CONTRACTOR SHALL RESURFACE ALL THE WAY
UP TO RAILROAD SIDE PANELS.

LEGEND

- ① THERMOPLASTIC PAVEMENT MARKING
EDGE LINE, 4" SOLID WHITE
- ② THERMOPLASTIC PAVEMENT MARKING
4" SOLID DOUBLE YELLOW
- ③ THERMOPLASTIC PAVEMENT MARKING
4" YELLOW SKIP DASH CENTER LINE
- ④ THERMOPLASTIC PAVEMENT MARKING
4" YELLOW SKIP DASH CENTER LINE &
4 " SOLID YELLOW NO PASSING LINE
- ⑤ THERMOPLASTIC PAVEMENT MARKING
24" WHITE STOP BAR
- ⑥ THERMOPLASTIC PAVEMENT MARKING
LETTER & SYMBOLS

FILE NAME =	USER NAME = abreuah	DESIGNED -	REVISED -	STATE OF ILLINOIS DEPARTMENT OF TRANSPORTATION	COAL CITY ROAD FROM ILL 113 /DIVISION ST. TO ILL 53 ROADWAY & PAVEMENT MARKING PLAN			F.A.U. RTE.	SECTION	COUNTY	TOTAL SHEETS	SHEET NO.
ct\pw_work\PWIDOT\ABREUAH\d0195053\0152210-shr-plan.dgn	210-shr-plan.dgn	DRAWN -	REVISED -					0383	113 X-RS-3	WILL	15	9
PLOT SCALE = 50.0000' / IN.		CHECKED -	REVISED -		SCALE: SHEET NO. OF SHEETS STA. TO STA.			CONTRACT NO. 60K53				
PLOT DATE = 4/26/2010		DATE -	REVISED -		ILLINOIS FED. AID PROJECT							

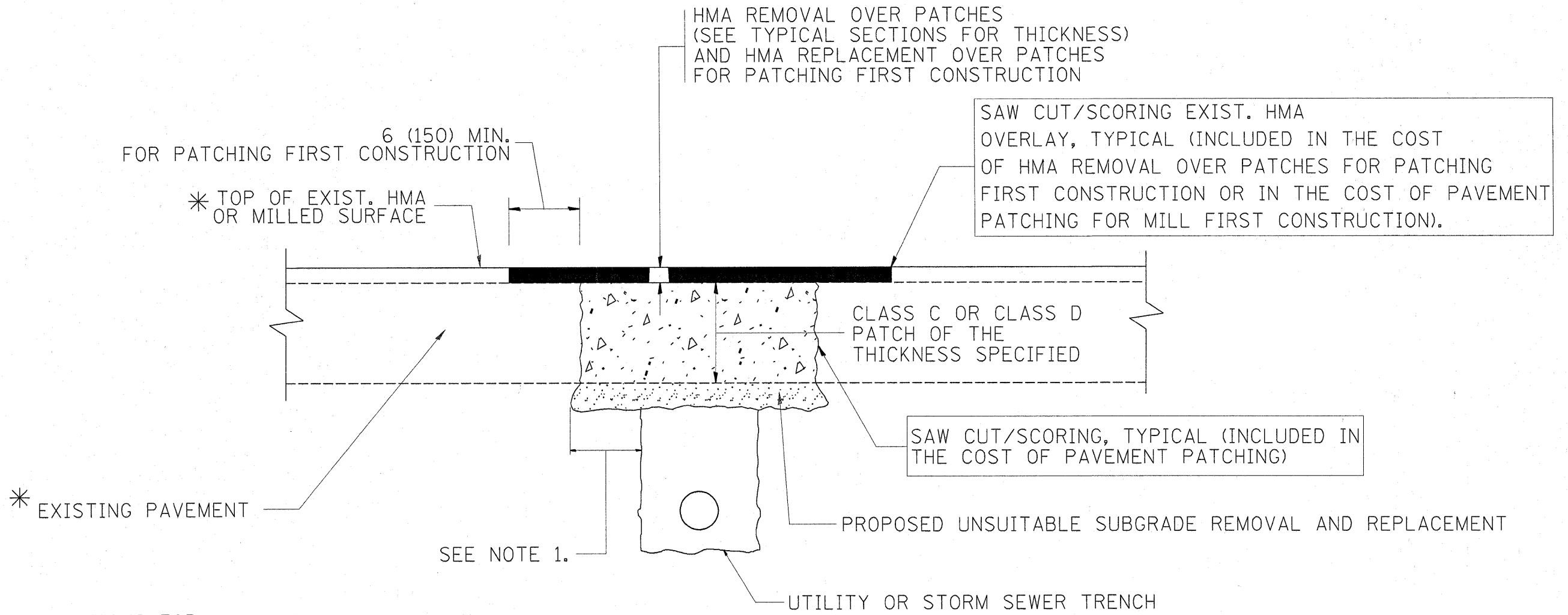

* SEE TYPICAL SECTIONS FOR THICKNESS AND MATERIALS

NOTES:

1. THE WIDTH OF THE FULL DEPTH PATCH OVER A TRENCH SHALL BE 12 (300) WIDER ON EACH SIDE OF THE TRENCH.
2. FOR METHOD OF MEASUREMENT AND BASIS OF PAYMENT, SEE RECURRING SPECIAL PROVISION "PATCHING WITH HOT-MIX ASPHALT OVERLAY REMOVAL".

SEQUENCE OF CONSTRUCTION (PATCHING FIRST)

1. REMOVE THE EXISTING HMA MATERIAL OVER THE AREA TO BE PATCHED.
2. REMOVE AND REPLACE WITH CLASS C OR D PATCH.
3. REPLACE HMA MATERIAL OVER THE AREA TO BE PATCHED.

SEQUENCE OF CONSTRUCTION (MILLING FIRST)

1. MILL HMA FIRST IF THERE IS AT LEAST 4 1/2 INCHES OR MORE OF HMA MATERIAL ON TOP OF THE EXISTING PAVEMENT OR IF THE PAVEMENT IS FULL DEPTH HMA. A MINIMUM OF 2 INCHES OF HMA MATERIAL SHALL BE IN PLACE AFTER MILLING.
2. REMOVE AND REPLACE WITH FULL DEPTH CLASS D PATCHES TO TOP OF MILLED SURFACE.

ALL DIMENSIONS ARE IN INCHES (MILLIMETERS) UNLESS OTHERWISE SHOWN.

FILE NAME =	USER NAME = abreuah	DESIGNED - R. SHAH	REVISED - A. ABBAS 04-27-98	STATE OF ILLINOIS DEPARTMENT OF TRANSPORTATION	PAVEMENT PATCHING FOR HMA SURFACED PAVEMENT			F.A.U. RTE.	SECTION	COUNTY	TOTAL SHEETS	SHEET NO.
es:\pw_work\PMIDOT\ABREUAH\0195053\Dist\td.dgn		DRAWN -	REVISED - R. BORO 01-01-07		0383	113 X-RS-3	WILL	15	10			
PLOT SCALE = 50,0000 ' / IN.		CHECKED -	REVISED - R. BORO 09-04-07		BD400-04 (BD-22)			CONTRACT NO. 60K53				
PLOT DATE = 4/26/2010		DATE - 10-25-94	REVISED - K. ENG 10-27-08		SCALE: NONE	SHEET NO. 1 OF 1 SHEETS	STA. TO STA.	FED. ROAD DIST. NO. 1 ILLINOIS FED. AID PROJECT				

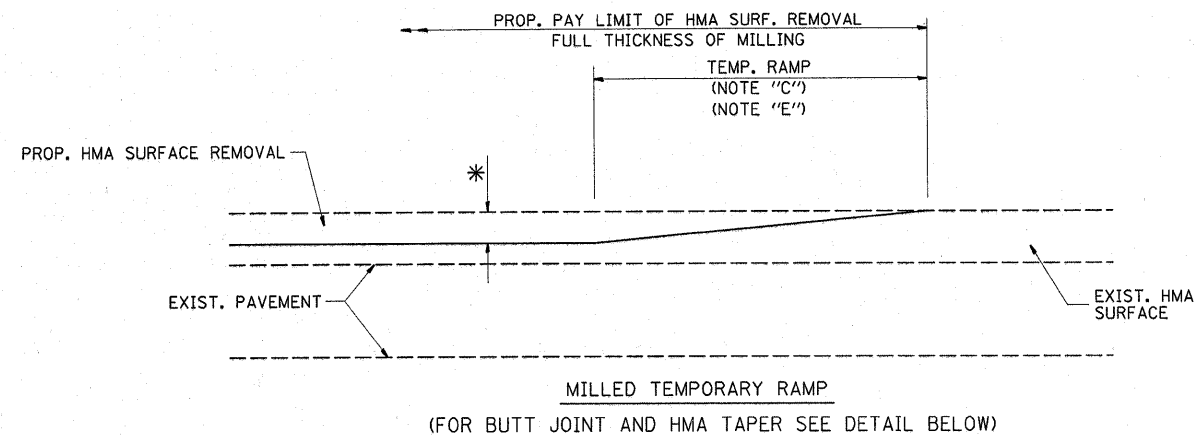

OPTION 1

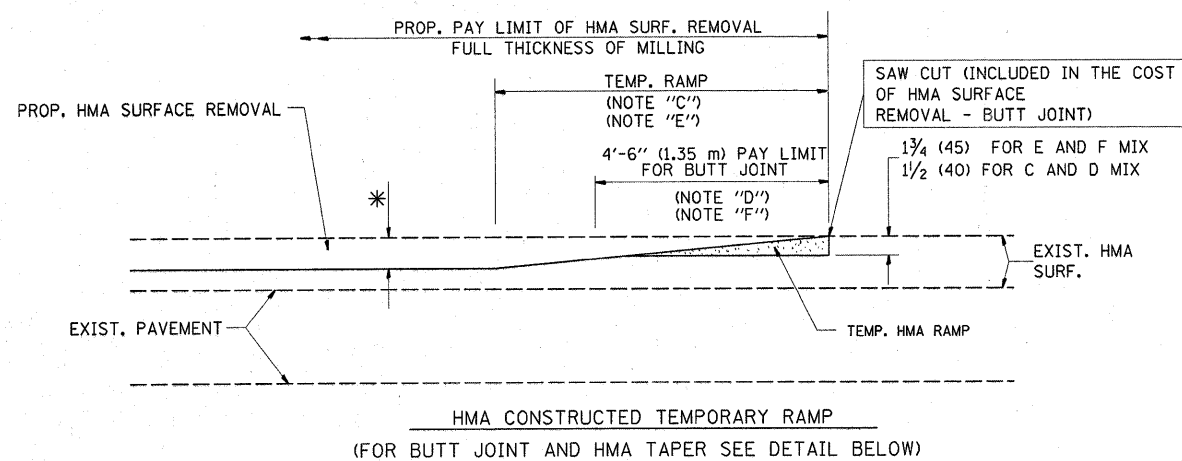

OPTION 2
TYPICAL TEMPORARY RAMP

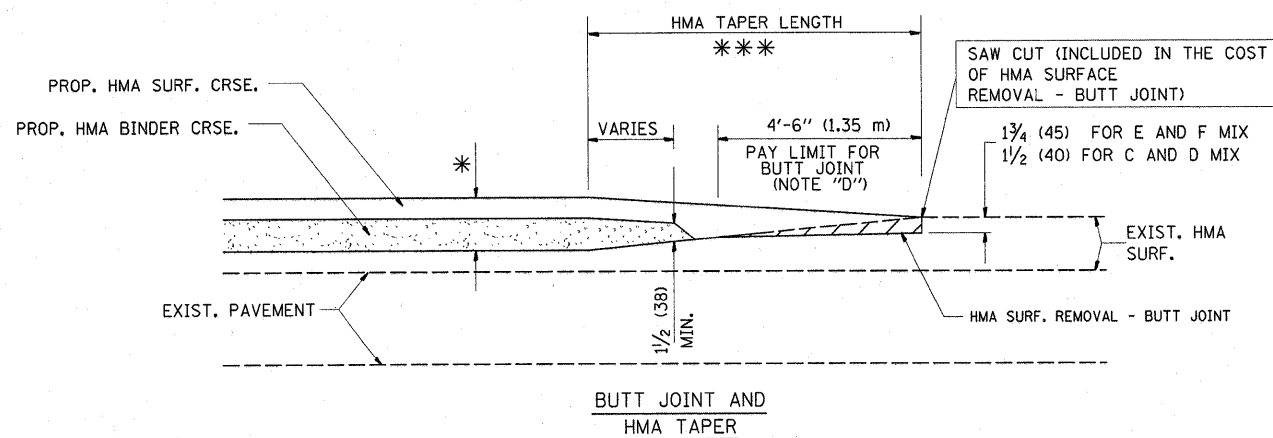

TYPICAL BUTT JOINT AND HMA TAPER
FOR MILLING AND RESURFACING

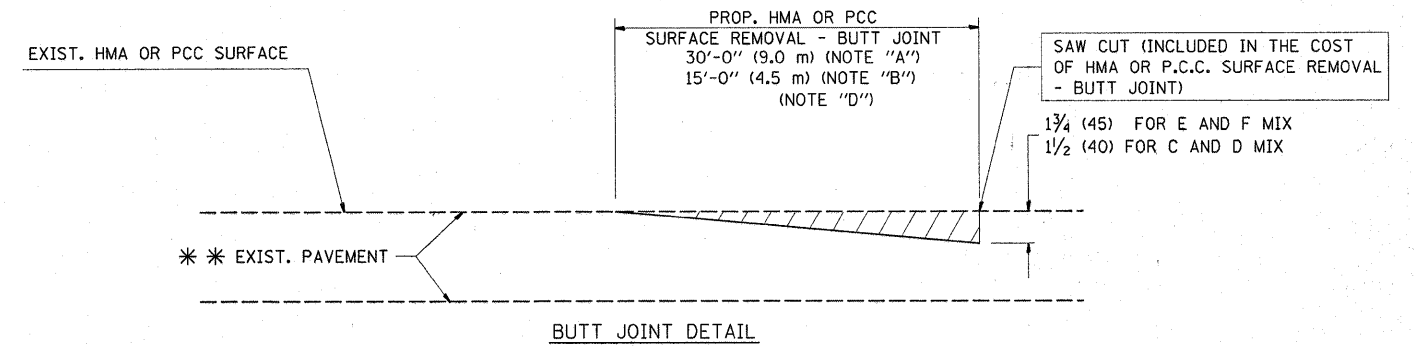

BUTT JOINT DETAIL

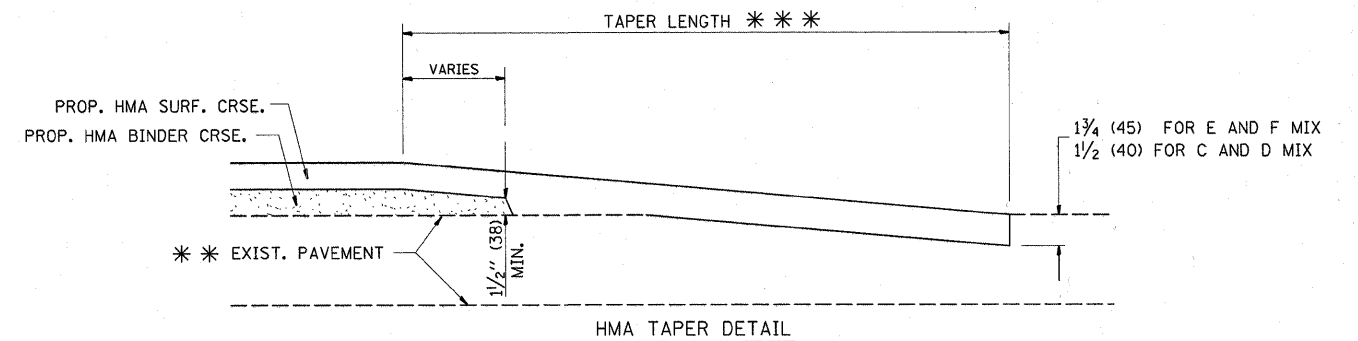

HMA TAPER DETAIL

TYPICAL BUTT JOINT AND HMA TAPER
FOR RESURFACING ONLY

** PC CONCRETE, HMA OR HMA RESURFACED PAVEMENT.

NOTES

- A: MAINLINE ROADWAYS AND MAJOR SIDE ROADS.
- B: MINOR SIDE ROADS.
- C: THE TEMP. RAMP SHALL BE CONSTRUCTED IMMEDIATELY UPON REMOVAL OF THE EXISTING HMA SURFACE.
- D: THE BUTT JOINT SHALL BE CONSTRUCTED IMMEDIATELY PRIOR TO PLACING THE PROPOSED HMA COURSES.
- E: TAPER THE TEMP. RAMP AT A RATE OF 3'-0" (900 mm) PER 1 INCH (25 mm) OF MILLING THICKNESS.
- F: INSTALLATION AND REMOVAL OF THE 4'-6" (1,35 m) TEMP. RAMP IS INCLUDED IN COST OF HMA SURFACE REMOVAL - BUTT JOINT
- G: SEE ARTICLE 406.08 AND 406.14 OF THE STANDARD SPECIFICATIONS FOR "HMA AND/OR PCC SURFACE REMOVAL, BUTT JOINT".
- * SEE TYPICAL SECTIONS FOR MILLING THICKNESS.
- ** 20'-0" (6.1 m) PER 1 (25) RESURFACING (NOTE "A")
10'-0" (3.0 m) PER 1 (25) RESURFACING (NOTE "B")

BASIS OF PAYMENT:

THE BUTT JOINT WILL BE PAID FOR AT THE CONTRACT UNIT PRICE PER SQUARE YARD (SQUARE METER) FOR "HOT-MIX ASPHALT SURFACE REMOVAL - BUTT JOINT" OR FOR "PORTLAND CEMENT CONCRETE SURFACE REMOVAL - BUTT JOINT".

ALL DIMENSIONS ARE IN INCHES (MILLIMETERS) UNLESS OTHERWISE SHOWN.

FILE NAME =	USER NAME = abreuah	DESIGNED - M. DE YONG	REVISED - R. SHAH 10-25-94
ca:\pwork\PIWIDOT\ABREUAH\0195053\Dis\td.dgn		DRAWN -	REVISED - A. ABBAS 03-21-97
	PLOT SCALE = 50,0000 ' / IN.	CHECKED -	REVISED - M. GOMEZ 04-06-01
	PLOT DATE = 4/26/2010	DATE - 06-13-90	REVISED - R. BORO 01-01-07

STATE OF ILLINOIS
DEPARTMENT OF TRANSPORTATION

BUTT JOINT AND
HMA TAPER DETAILS

F.A.U. RTE.	SECTION	COUNTY	TOTAL SHEETS	SHEET NO.
0383	113 X-RS-3	WILL	15	11
BD400-05 BD32			CONTRACT NO. 60K53	
FED. ROAD DIST. NO. 1 ILLINOIS FED. AID PROJECT				

SCALE: NONE SHEET NO. 1 OF 1 SHEETS STA. TO STA.

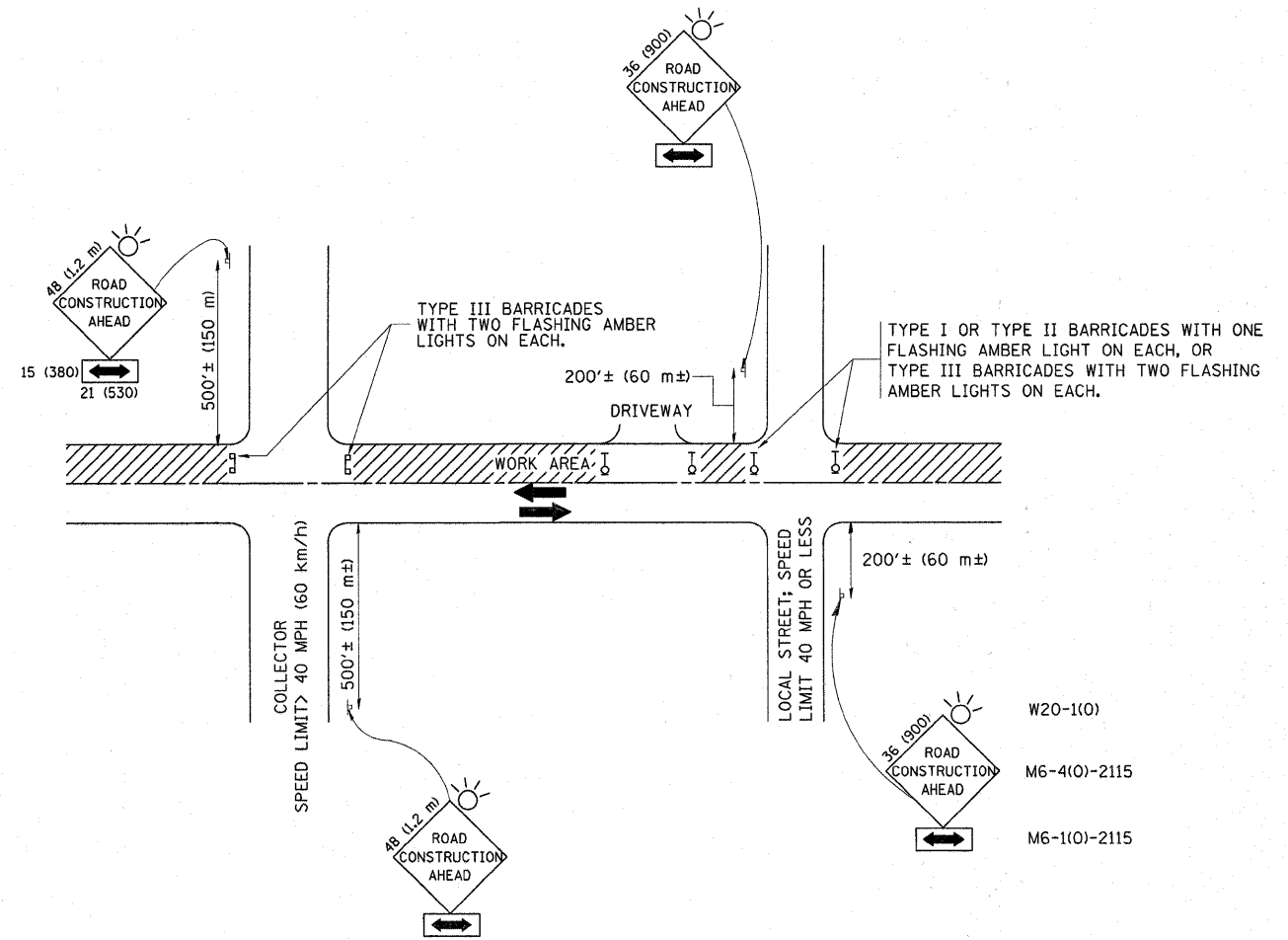

TRAFFIC CONTROL AND PROTECTION FOR SIDE ROADS, INTERSECTIONS, AND DRIVEWAYS

NOTES:

A. FOR NO LANE RESTRICTION ON THE SIDE ROAD OR DRIVEWAYS

1. SIDE ROAD WITH A SPEED LIMIT OF 40 MPH (60 km/h) OR LESS AS SHOWN ON THE DRAWING AND AS DIRECTED BY THE ENGINEER:

a) ONE ROAD CONSTRUCTION AHEAD SIGN 36 x 36 (900x900) WITH A FLASHER AND FLAG MOUNTED ON IT APPROXIMATELY 200' (60 m) IN ADVANCE OF THE MAIN ROUTE.

b) THE CLOSED PORTION OF THE MAIN ROUTE SHALL BE PROTECTED BY BLOCKING WITH TYPE I, TYPE II OR TYPE III BARRICADES, 1/3 OF THE CROSS SECTION OF THE CLOSED PORTION.

2. SIDE ROAD WITH A SPEED LIMIT GREATER THAN 40 MPH (60 km/h) AS SHOWN ON THE DRAWING AND AS DIRECTED BY THE ENGINEER:

a) ONE ROAD CONSTRUCTION AHEAD SIGN 48 x 48 (1.2 m x 1.2 m) WITH A FLASHER MOUNTED ON IT APPROXIMATELY 500' (150 m) IN ADVANCE OF THE MAIN ROUTE.

b) THE CLOSED PORTION OF THE MAIN ROUTE SHALL BE PROTECTED BY BLOCKING WITH TYPE III BARRICADES, 1/2 OF THE CROSS SECTION OF THE CLOSED PORTION.

3. WHEN THE SIDE ROAD LIES BETWEEN THE BEGINNING OF THE MAINLINE SIGNING AND THE WORK ZONE, A SINGLE HEADED ARROW (M6-1) SHALL BE USED IN LIEU OF THE DOUBLE HEADED ARROW (M6-4).

B. FOR A LANE CLOSURE ON A SIDE ROAD OR DRIVEWAY:

USE APPLICABLE PORTIONS OF THE TYPICAL APPLICATION OF TRAFFIC CONTROL DEVICES (STD. 701501, STD. 701606 OR THE APPROPRIATE STANDARD). THE SPACING OF SIGNS AND BARRICADES SHALL BE ADJUSTED FOR FIELD CONDITIONS AS DIRECTED BY THE ENGINEER. THE DIRECTIONAL ARROW SHALL BE COVERED OR REMOVED WHEN NO LONGER CONSISTENT WITH THE SIDE ROAD LANE CLOSURE.

C. ADVANCE WARNING SIGNS ARE TO BE OMITTED ON DRIVEWAY UNLESS OTHERWISE NOTED.

D. THE TRAFFIC CONTROL AND PROTECTION FOR SIDE ROADS, INTERSECTIONS, AND DRIVEWAYS SHALL BE INCIDENTAL TO THE COST OF SPECIFIED TRAFFIC CONTROL STANDARDS OR ITEMS.

All dimensions are in millimeters (Inches) unless otherwise shown.

FILE NAME =	USER NAME = abreuah	DESIGNED - LHA	REVISED - J. OBERLE 10-18-95
c:\pw_work\PMIDOT\ABREUAH\d0195053\01.st	std.dgn	DRAWN -	REVISED - A. HOUSEH 03-06-96
	PLOT SCALE = 50,0000 ' / IN.	CHECKED -	REVISED - A. HOUSEH 10-15-96
	PLOT DATE = 4/26/2010	DATE - 06-89	REVISED - T. RAMMACHER 01-06-00

STATE OF ILLINOIS
DEPARTMENT OF TRANSPORTATION

TRAFFIC CONTROL AND PROTECTION FOR
SIDE ROADS, INTERSECTIONS, AND DRIVEWAYS

SCALE: NONE SHEET NO. 1 OF 1 SHEETS STA. TO STA.

F.A.U. RTE.	SECTION	COUNTY	TOTAL SHEETS	SHEET NO.
0383	113 X-RS-3	WILL	15	12
TC-10			CONTRACT NO. 60K53	
FED. ROAD DIST. NO. 1 ILLINOIS FED. AID PROJECT				

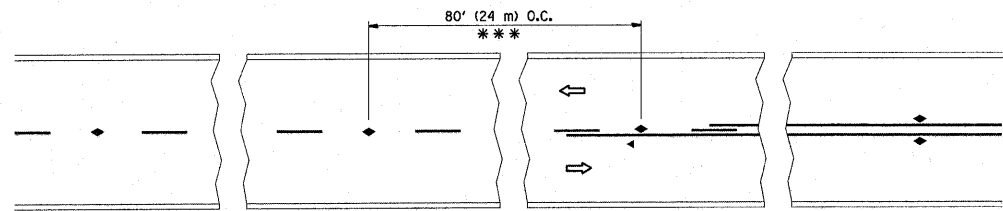

*** REDUCE TO 40' (12 m) O.C. ON CURVES WITH POSTED OR ADVISORY SPEED 45 M.P.H. (70 km/h) OR LESS.

TWO-LANE/TWO-WAY

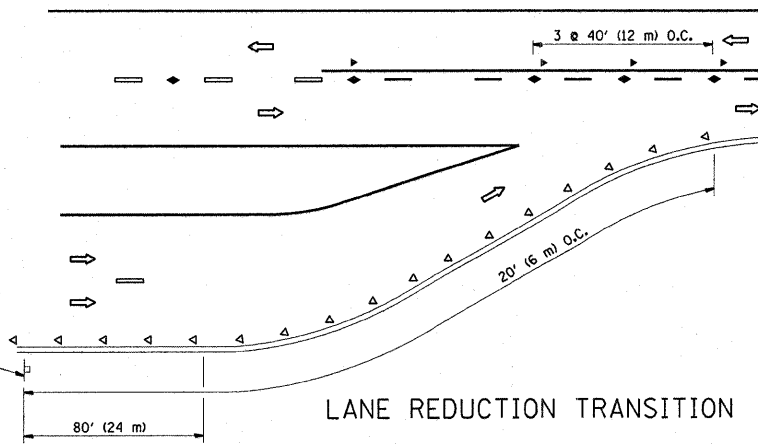

LANE REDUCTION TRANSITION

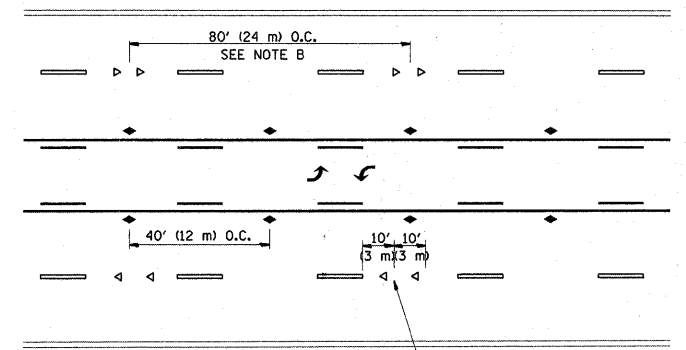

TWO-WAY LEFT TURN

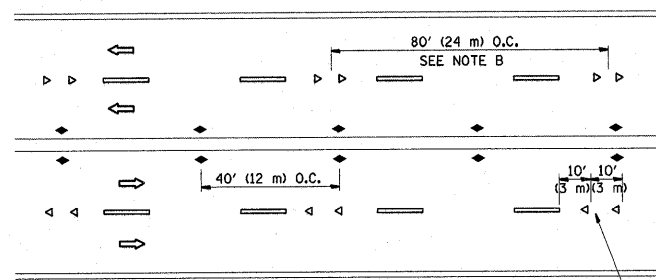

MULTI-LANE/UNDIVIDED

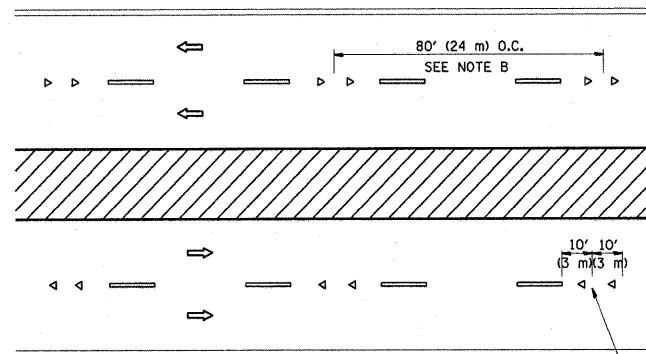

MULTI-LANE/DIVIDED

GENERAL NOTES

1. MARKERS USED WITH DASHED LINES SHALL BE CENTERED IN THE GAP BETWEEN SEGMENTS.
2. MARKERS USED ADJACENT TO SOLID LINES SHALL BE OFFSET 2 TO 3 (50 TO 75) TOWARD TRAFFIC AS SHOWN.
3. MARKERS THROUGH TANGENTS LESS THAN 500' (150 m) IN LENGTH BETWEEN CURVES SHALL BE INSTALLED AT THE LESSER OF THE TWO CURVE SPACINGS.

SYMBOLS

- YELLOW STRIPE
- WHITE STRIPE
- ◀ ONE-WAY AMBER MARKER
- ◀ ONE-WAY CRYSTAL MARKER (W/O)
- ◆ TWO-WAY AMBER MARKER

LANE MARKER NOTES

- A. USE DOUBLE LANE LINE MARKERS SPACED AS SHOWN.
- B. REDUCE TO 40' (12 m) O.C. ON CURVES WHERE ADVISORY SPEEDS ARE 10 M.P.H. (20 km/h) LOWER THAN POSTED SPEEDS.

DESIGN NOTES

1. DOUBLE LANE LINE MARKERS SHALL BE USED UNLESS SPECIFIED OTHERWISE.
2. EXCEPT AS SHOWN ON THE LANE REDUCTION TRANSITION AND FREEWAY EXIT RAMP DETAIL, MARKERS ARE NOT TO BE SPECIFIED ON RIGHT EDGE LINES.
3. THE EXACT MARKER LIMITS, SPACING, AND COLOR SHOULD BE INCLUDED IN THE PLANS.
4. MARKERS SHOULD NOT BE USED ALONGSIDE CURBS EXCEPT FOR EXTREMELY SHORT SECTIONS OF CURBS WHERE NOT MORE THAN TWO MARKERS WOULD BE INVOLVED.

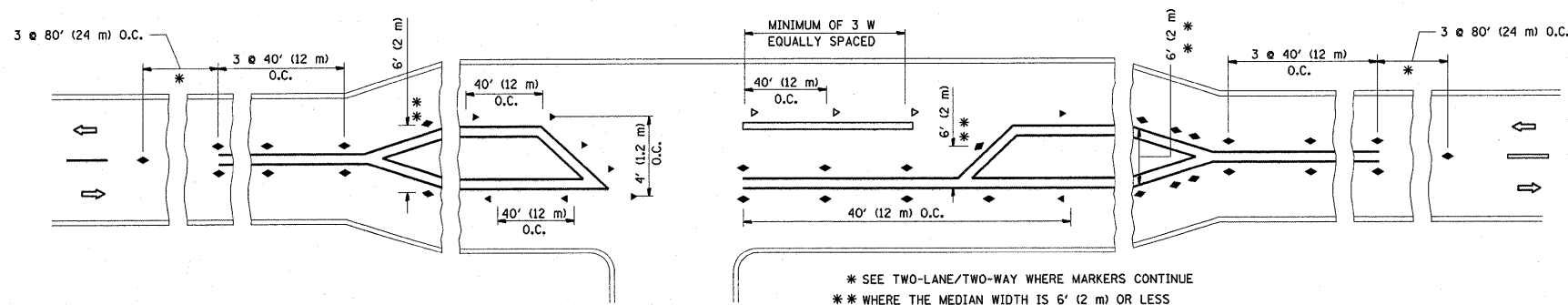

LEFT TURN

* SEE TWO-LANE/TWO-WAY WHERE MARKERS CONTINUE
 ** WHERE THE MEDIAN WIDTH IS 6' (2 m) OR LESS USE TWO-WAY MARKERS.

All dimensions are in inches (millimeters) unless otherwise shown.

FILE NAME = c:\pw_work\pwidot\ABREUAH\d0195053\01st.dgn	USER NAME = abreuah	DESIGNED -	REVISED - T. RAMMACHER 09-19-94	STATE OF ILLINOIS DEPARTMENT OF TRANSPORTATION	TYPICAL APPLICATIONS RAISED REFLECTIVE PAVEMENT MARKERS (SNOW-PLOW RESISTANT)			F.A.U. RTE.	SECTION	COUNTY	TOTAL SHEETS	SHEET NO.
	PLOT SCALE = 50.0000' / IN.	CHECKED -	REVISED - T. RAMMACHER 03-12-99		0383	113 X-RS-3	WILL	15	13			
PLOT DATE = 4/26/2010	DATE -	REVISED - C. JUCIUS 09-09-09		SCALE: NONE	SHEET NO. 1 OF 1 SHEETS	STA. TO STA.	FED. ROAD DIST. NO. 1 ILLINOIS FED. AID PROJECT					

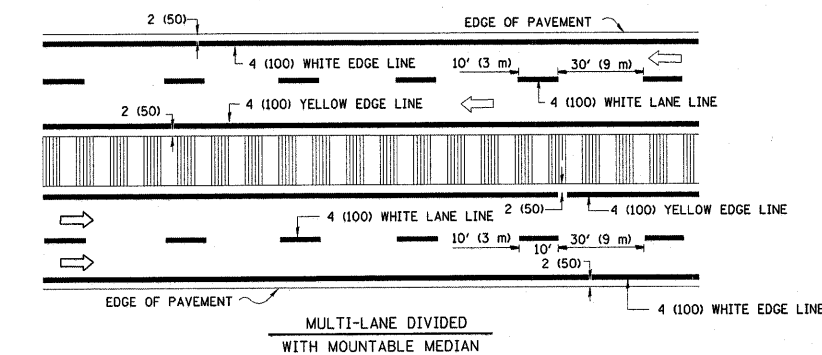
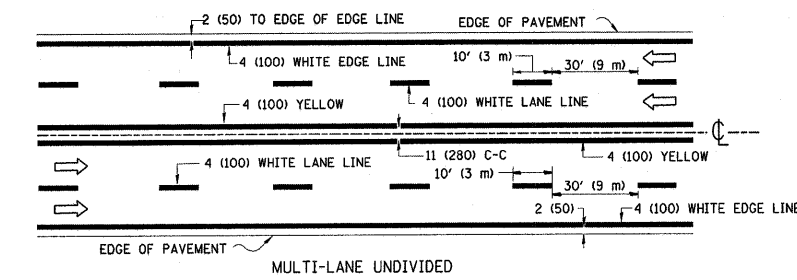
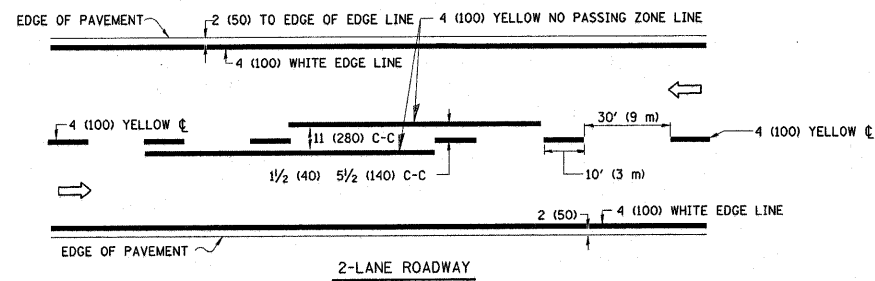

NOTE: MEDIANS WITH BARRIER CURB DO NOT REQUIRE AN EDGE LINE

TYPICAL LANE AND EDGE LINE MARKING

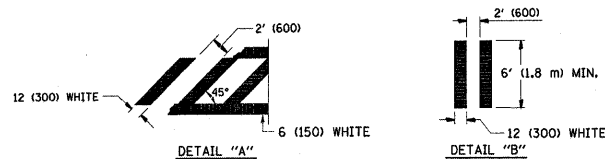
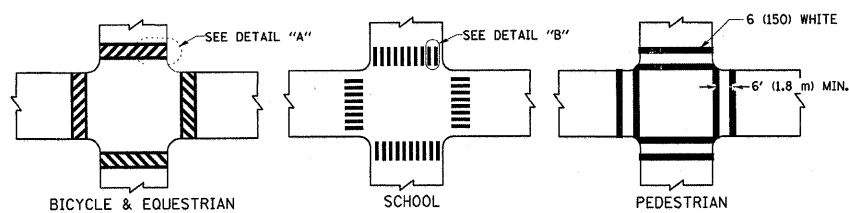

TYPICAL CROSSWALK MARKING

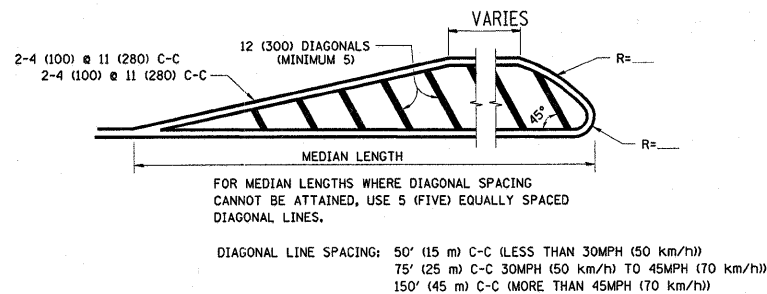
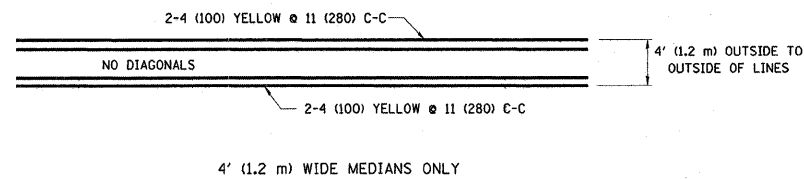

MEDIANS OVER 4' (1.2 m) WIDE

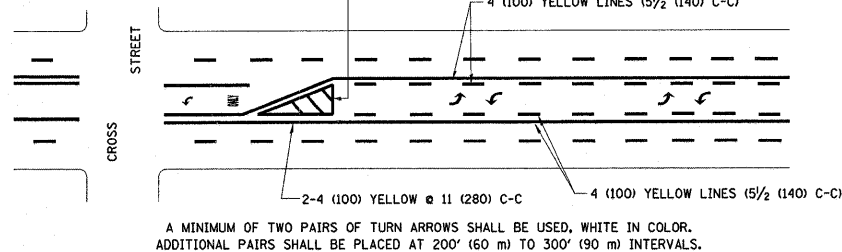

MEDIAN WITH TWO-WAY LEFT TURN LANE

TYPICAL PAINTED MEDIAN MARKING

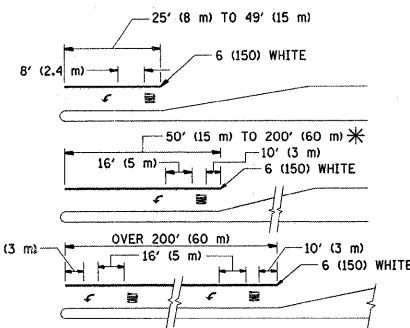

FULL SIZE LETTERS 8' (2.4 m) AND ARROWS SHALL BE USED. AREA = 15.6 SQ. FT. (1.5 m²) ONLY AREA = 20.8 SQ. FT. (1.9 m²)

* TURN LANES IN EXCESS OF 400' (120 m) IN LENGTH MAY HAVE AN ADDITIONAL SET OF ARROW - "ONLY" INSTALLED MIDWAY BETWEEN THE OTHER TWO SETS OF ARROW - "ONLY".

TYPICAL LEFT (OR RIGHT) TURN LANE

TYPICAL TURN LANE MARKING

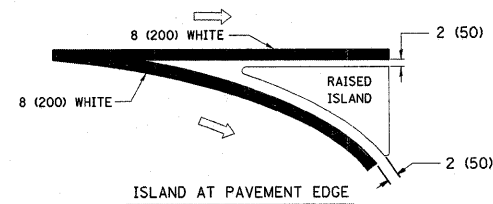
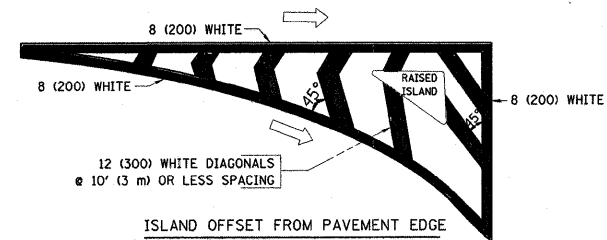

TYPICAL ISLAND MARKING

TYPE OF MARKING	WIDTH OF LINE	PATTERN	COLOR	SPACING / REMARKS
CENTERLINE ON 2 LANE PAVEMENT	4 (100)	SKIP-DASH	YELLOW	10' (3 m) LINE WITH 30' (9 m) SPACE
CENTERLINE ON MULTI-LANE UNDIVIDED PAVEMENT	2 @ 4 (100)	SOLID	YELLOW	11 (280) C-C
NO PASSING ZONE LINES: FOR ONE DIRECTION FOR BOTH DIRECTIONS	4 (100) 2 @ 4 (100)	SOLID SOLID	YELLOW YELLOW	5 1/2 (140) C-C FROM SKIP-DASH CENTERLINE 11 (280) C-C OMIT SKIP-DASH CENTERLINE BETWEEN
LANE LINES	4 (100) 5 (125) ON FREEWAYS	SKIP-DASH SKIP-DASH	WHITE WHITE	10' (3 m) LINE WITH 30' (9 m) SPACE
DOTTED LINES (EXTENSIONS OF CENTER, LANE OR TURN LANE MARKINGS)	SAME AS LINE BEING EXTENDED	SKIP-DASH	SAME AS LINE BEING EXTENDED	2' (600) LINE WITH 6' (1.8 m) SPACE
EDGE LINES	4 (100)	SOLID	YELLOW-LEFT WHITE-RIGHT	OUTLINE MOUNTABLE MEDIANS IN YELLOW; EDGE LINES ARE NOT USED NEXT TO BARRIER CURB
TURN LANE MARKINGS	6 (150) LINE; FULL SIZE LETTERS & SYMBOLS (8' (2.4m))	SOLID	WHITE	SEE TYPICAL TURN LANE MARKING DETAIL
TWO WAY LEFT TURN MARKING	2 @ 4 (100) EACH DIRECTION 8' (2.4m) LEFT ARROW	SKIP-DASH AND SOLID IN PAIRS	YELLOW WHITE	10' (3 m) LINE WITH 30' (9 m) SPACE FOR SKIP-DASH; 5 1/2 (140) C-C BETWEEN SOLID LINE AND SKIP-DASH LINE SEE TYPICAL TWO-WAY LEFT TURN MARKING DETAIL
CROSSWALK LINES (PEDESTRIAN) A. DIAGONALS (BIKE & EQUESTRIAN) B. LONGITUDINAL BARS (SCHOOL)	2 @ 6 (150) 12 (300) @ 45° 12 (300) @ 90°	SOLID SOLID SOLID	WHITE WHITE WHITE	NOT LESS THAN 6' (1.8 m) APART 2' (600) APART SEE TYPICAL CROSSWALK MARKING DETAILS.
STOP LINES	24 (600)	SOLID	WHITE	PLACE 4' (1.2 m) IN ADVANCE OF AND PARALLEL TO CROSSWALK, IF PRESENT. OTHERWISE, PLACE AT DESIRED STOPPING POINT. PARALLEL TO CROSSROAD CENTERLINE, WHERE POSSIBLE
PAINTED MEDIANS	2 @ 4 (100) WITH 12 (300) DIAGONALS @ 45° NO DIAGONALS USED FOR 4' (1.2 m) WIDE MEDIANS	SOLID	YELLOW: TWO WAY TRAFFIC WHITE: ONE WAY TRAFFIC	11 (280) C-C FOR THE DOUBLE LINE SEE TYPICAL PAINTED MEDIAN MARKING.
GORE MARKING AND CHANNELIZING LINES	8 (200) WITH 12 (300) DIAGONALS @ 45°	SOLID	WHITE	DIAGONALS: 15' (4.5 m) C-C (LESS THAN 30MPH (50 km/h)) 20' (6 m) C-C (30MPH (50 km/h) TO 45MPH (70 km/h)) 30' (9 m) C-C (OVER 45MPH (70 km/h))
RAILROAD CROSSING	24 (600) TRANSVERSE LINES; "RR" IS 8' (1.8 m) LETTERS; 16 (400) LINE FOR "X"	SOLID	WHITE	SEE STATE STANDARD 780001 AREA OF: "R"=3.6 SQ. FT. (0.33 m ²) EACH "X"=54.0 SQ. FT. (5.0 m ²)
SHOULDER DIAGONALS	12 (300) @ 45°	SOLID	WHITE - RIGHT YELLOW - LEFT	50' (15 m) C-C (LESS THAN 30MPH (50 km/h)) 75' (25 m) C-C (30 MPH (50 km/h) TO 45MPH (70 km/h)) 150' (45 m) C-C (OVER 45MPH (70 km/h))

FOR FURTHER DETAILS ON PAVEMENT MARKING REFER TO STANDARD SPECIFICATIONS FOR ROAD AND BRIDGE CONSTRUCTION AND STATE STANDARD 780001.

All dimensions are in inches (millimeters) unless otherwise shown.

FILE NAME =	USER NAME = abreuah	DESIGNED - EVERS	REVISED - T. RAMMACHER 10-27-94
ci:\pwwork\pwwid01\ABREUAH\d0195053\Drawings\td.dgn		DRAWN -	REVISED - C. JUCIUS 09-09-09
PLOT SCALE = 50.0000' / IN.		CHECKED -	REVISED -
PLOT DATE = 4/26/2010		DATE - 03-19-90	REVISED -

**STATE OF ILLINOIS
DEPARTMENT OF TRANSPORTATION**

DISTRICT ONE			
TYPICAL PAVEMENT MARKINGS			
SCALE: NONE	SHEET NO. 1 OF 1 SHEETS	STA.	TO STA.

F.A.U. RTE.	SECTION	COUNTY	TOTAL SHEETS	SHEET NO.
0383	113 X-RS-3	WILL	15	14
TC-13			CONTRACT NO. 60K53	
FED. ROAD DIST. NO. 1 ILLINOIS FED. AID PROJECT				

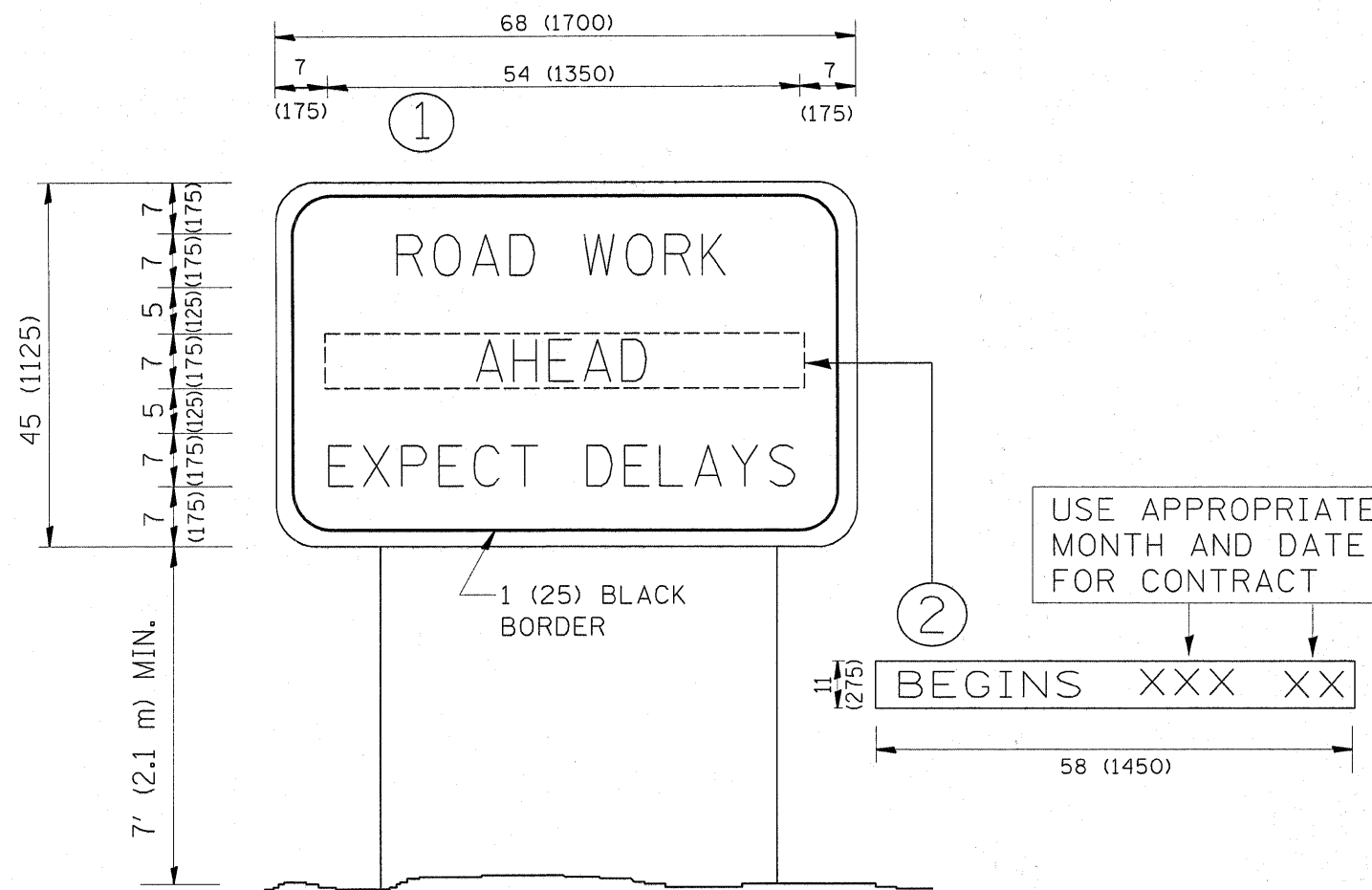

NOTES:

1. USE BLACK LETTERING ON ORANGE BACKGROUND.
2. ERECT SIGNS IN ADVANCE OF THE LOCATION FOR THE "ROAD CONSTRUCTION AHEAD" SIGN AT LOCATIONS AS DIRECTED BY THE ENGINEER.
3. ERECT SIGN ① WITH INSTALLED PANEL ② ONE WEEK PRIOR TO THE START OF CONSTRUCTION.
4. REMOVE PANEL ② SOON AFTER THE START OF CONSTRUCTION.
5. SEE SPECIAL PROVISION FOR "TEMPORARY INFORMATION SIGNING" FOR ADDITIONAL INFORMATION.
6. ONE SIGN ASSEMBLY EQUALS 25.70 SQ. FT. (2.3 SQ. M.)
7. SHALL BE PAID FOR AS TEMPORARY INFORMATION SIGNING.

ALL DIMENSIONS ARE IN INCHES (MILLIMETERS) UNLESS OTHERWISE SHOWN.

FILE NAME =	USER NAME = abreuah	DESIGNED -	REVISED - R. MIRS 09-15-97	STATE OF ILLINOIS DEPARTMENT OF TRANSPORTATION	ARTERIAL ROAD INFORMATION SIGN		F.A.U. RTE.	SECTION	COUNTY	TOTAL SHEETS	SHEET NO.
es:\pw\work\PIWIDOT\ABREUAH\d0195053\Dist\td.dgn	DRAWN -	REVISED - R. MIRS 12-11-97	0383		113 X-RS-3	WILL	15	15			
PLOT SCALE = 50.0000 ' / IN.	CHECKED -	REVISED - T. RAMMACHER 02-02-99	TC-22		CONTRACT NO. 60K53						
PLOT DATE = 4/26/2010	DATE -	REVISED - C. JUCIUS 01-31-07	SCALE: NONE		SHEET NO. 1 OF 1 SHEETS	STA.	TO STA.	FED. ROAD DIST. NO. 1 ILLINOIS FED. AID PROJECT			