

	PAVEMENT REMOVAL	TREE REMOVAL (6 TO 15 UNITS DIA.)	182 UNITS
	DRIVEWAY REMOVAL	TREE REMOVAL (OVER 15 UNITS DIA.)	110 UNITS
		TREE REMOVAL	0.083 ACRES

TREES LESS THAN 6" DIAMETER SHALL BE CONSIDERED AS CLEARING ITEM AS PER SECTION 201 OF STANDARD SPECIFICATION.

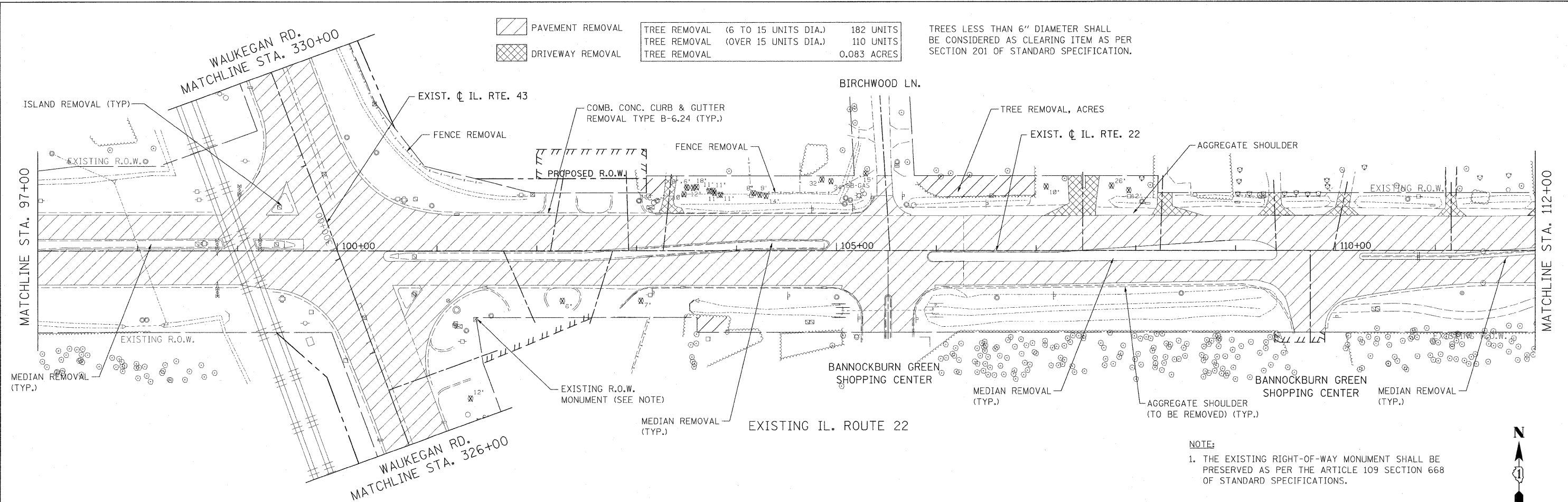

NOTE:
1. THE EXISTING RIGHT-OF-WAY MONUMENT SHALL BE PRESERVED AS PER THE ARTICLE 109 SECTION 668 OF STANDARD SPECIFICATIONS.

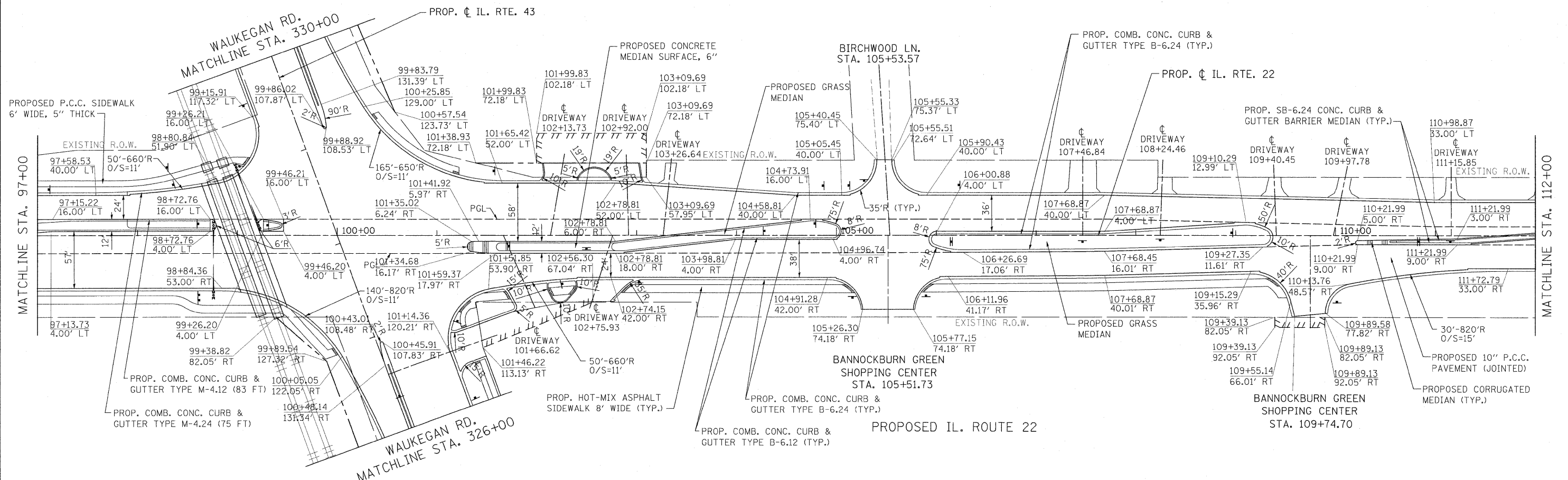

FILE NAME = W:\ILRTE22\2009 REVISIONS\Tree Removal	USER NAME = #USER# Contract\CADD Sheets\DI68L41-shr-plnprf.dgn	DESIGNED - LP	REVISED -	STATE OF ILLINOIS DEPARTMENT OF TRANSPORTATION	IL. ROUTE 22 TREE REMOVAL PLANS		F.A.P. RTE. 337	SECTION 2010-062-DTR	COUNTY LAKE	TOTAL SHEETS 56	SHEET NO. 14	
PLOT SCALE = #SCALE#	CHECKED - JP	REVISOR -	REVISOR -		SCALE: 1"=50'	SHEET NO. 14 OF 56 SHEETS	STA. 97+00.00 TO STA. 112+00.00	CONTRACT NO. 60L41		ILLINOIS FED. AID PROJECT		
PLOT DATE = 5/13/2010	DATE - 05/14/2010	REVISOR -	REVISOR -									