

STATE OF ILLINOIS
DEPARTMENT OF TRANSPORTATION

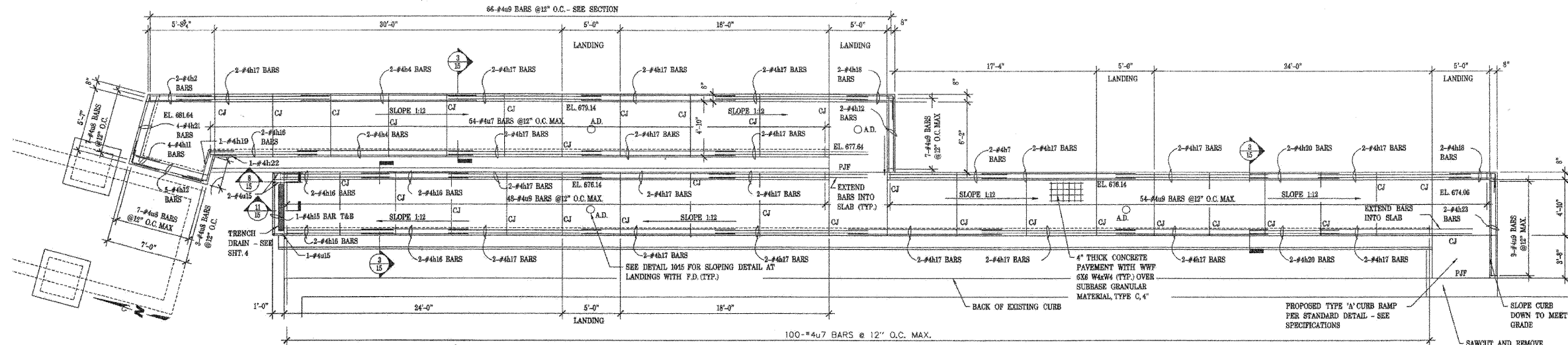

1 RAMP PLAN
15 SCALE: 1/4" = 1'-0"

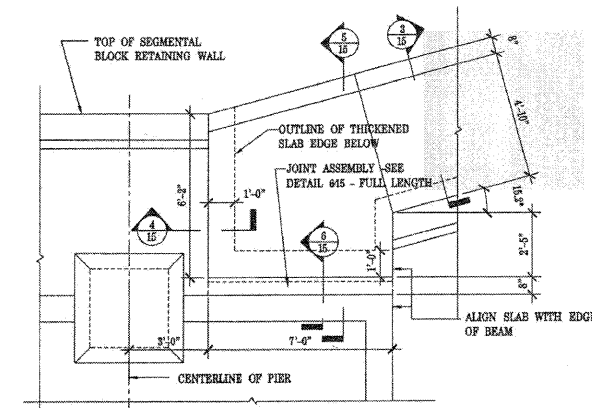

2 ENLARGED PLAN OF TOP RAMP LANDING
15 SCALE: 1/4" = 1'-0"

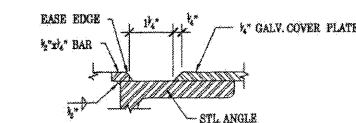

9 COVER PLATE DETAIL
15 SCALE: 1/4" = 1'-0"

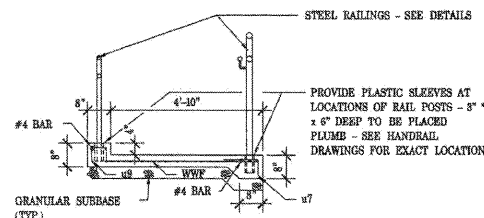

3 TYPICAL RAMP SECTION
15 SCALE: 1/4" = 1'-0"

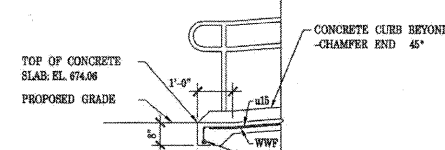

8 SECTION THROUGH BOTTOM LANDING
15 SCALE: 1/4" = 1'-0"

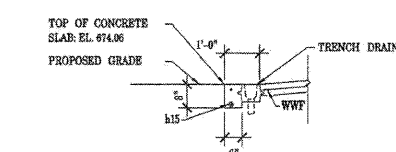

11 SECTION THROUGH TRENCH DRAIN
15 SCALE: 1/4" = 1'-0"

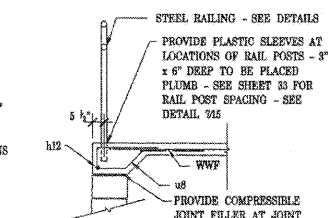

4 SECTION THROUGH COPING
15 SCALE: 1/4" = 1'-0"

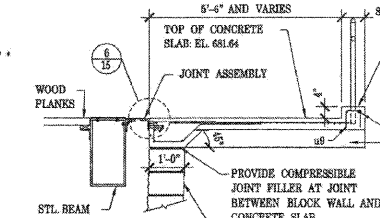

5 SECTION THROUGH TOP LANDING
15 SCALE: 1/4" = 1'-0"

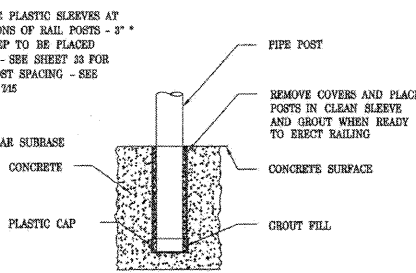

7 PIPE SLEEVE DETAIL (TYPICAL)
15 SCALE: 1/4" = 1'-0"

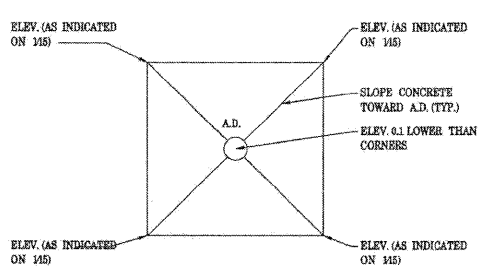

10 PLAN OF TYPICAL LANDING
15 SCALE: 1/4" = 1'-0"

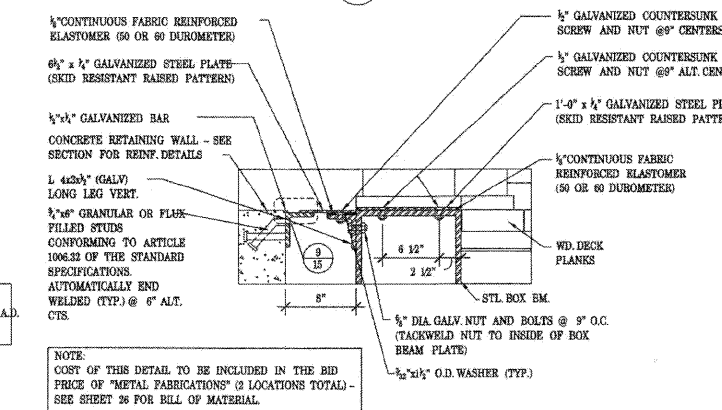

6 SECTION THROUGH TOP LANDING
15 SCALE: 1/4" = 1'-0"

- NOTES:
- COST OF CURB RAMP AS SHOWN IN DETAIL 145 AT SOUTH END OF RAMP, TO BE INCLUDED IN BID PRICE OF "CONCRETE STRUCTURES"
 - COST OF SAWCUT AND PARTIAL REMOVAL OF CURB AND CUTTER AND REPLACEMENT WITH DEPRESSION CURB TO BE INCLUDED IN BID PRICE OF "CONCRETE STRUCTURES"
 - SEE SHEET 23 FOR RAIL POST SPACING FOR PLACEMENT OF PIPE SLEEVES AS SHOWN IN DETAIL 745. COST OF SUPPLY AND PLACING OF PLASTIC PIPESLEEVES TO BE INCLUDED IN THE BID PRICE OF "CONCRETE STRUCTURES" COORDINATE PIPE SLEEVE SELECTION AND PLACEMENT WITH STEEL RAILING MANUFACTURER.
 - "PJP" INDICATES 1/2" PREFORMED JOINT FILLER FULL DEPTH AND WIDTH - COST TO BE INCLUDED IN BID PRICE FOR "CONCRETE STRUCTURES"
 - SEE SHEET 16 FOR REBAR DETAILS AND BILL OF MATERIAL
 - "CF" INDICATES 1/2" DEEP SAWCUT CONTROL JOINT, SAWN AT 4 TO 24 HOURS. COST TO BE INCLUDED IN BID PRICE FOR "CONCRETE STRUCTURES"

FOR INFORMATION ONLY

...Old dwg\08050-infor.dgn 12/14/2009 10:07:58 AM

FOR INFORMATION ONLY
STRUCTURE NO. 049-6159

McDonough Associates Inc.
Engineers / Architects
130 East Randolph Street Chicago, Illinois 60601

SHEET NO. S-19 SHEETS S-25	F.A.U. RTE.	SECTION	COUNTY	TOTAL SHEETS	SHEET NO.
	1257	08-00083-00-BT	LAKE	51	39
SN 049-6159			CONTRACT NO. 63450		
FED. ROAD DIST. NO. 1 ILLINOIS FED. AID PROJECT					