

STATE OF ILLINOIS  
DEPARTMENT OF TRANSPORTATION

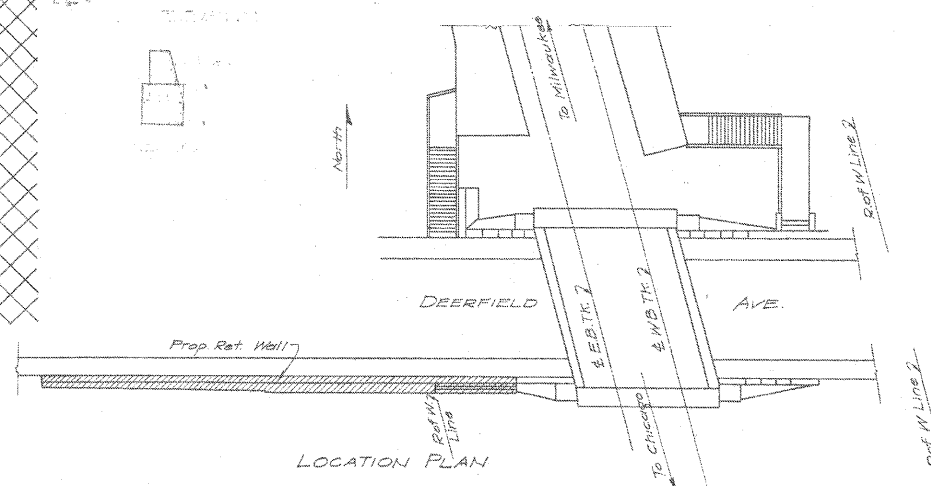
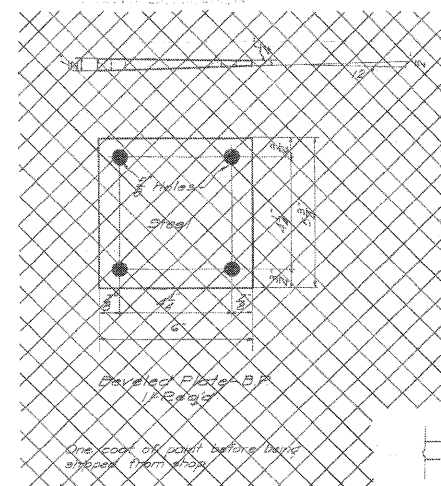
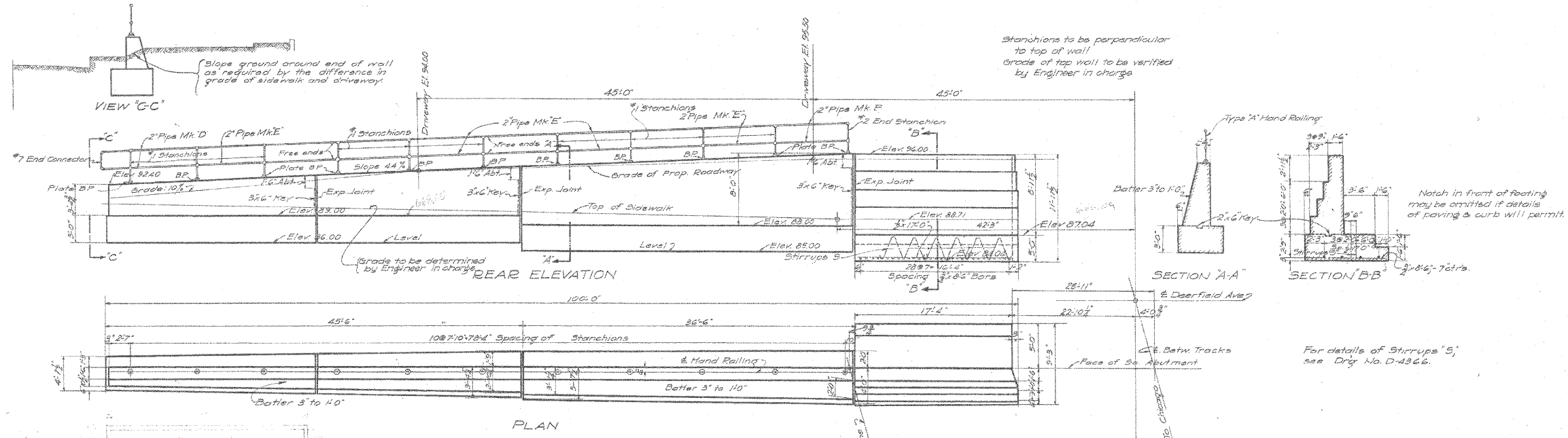

BILL OF MATERIAL FOR HAND RAILING

No.	Mark	Description
2	D	2x14" Standard Pipe, Plain ends
8	E	2x18 1/2" Standard Pipe, Plain ends
2	F	2x7 7/8" Standard Pipe, Plain ends
10	"1	Main Stanchions" Drg. D-5800
7	"7	End Connector, Drg. D-5800
38		3/8 x 3/8 Soft Steel Rivets
44		3/4 x 10" Anchor Bolts, Hex. Nuts Drg. D-5801
1	"2	End Stanchion Drg. D-5800

For Railing for Slab see Drg. D-4367.

A.F.E. 2356

5 of 5  
A. 56  
P. 23

**C.M. & ST. R.R.Y.**  
ENGINEERING DEPARTMENT

**A-118 2** DEERFIELD AVE SUBWAY  
Dearfield, Illinois

**SOUTH WEST RETAINING WALL**

Chicago, Nov. 27, 1914  
Corrected

Approved: *[Signature]*  
Chief Engineer

Eng. of Design

FOR INFORMATION ONLY  
STRUCTURE NO. 049-6159

**McDonough Associates Inc.**  
Engineers / Architects  
130 East Randolph Street Chicago, Illinois 60601

SHEET NO. S-25 SHEETS S-25	F.A.U. RTE. 1257	SECTION 08-00083-00-BT	COUNTY LAKE	TOTAL SHEETS 51	SHEET NO. 45
	SN 049-6159		CONTRACT NO. 63450		
FED. ROAD DIST. NO. 1 ILLINOIS FED. AID PROJECT					