

QUANTITY  
4 (100) LINE = 64.1 ft. (19.7 m)  
21.1 sq. ft. (1.97 sq. m)

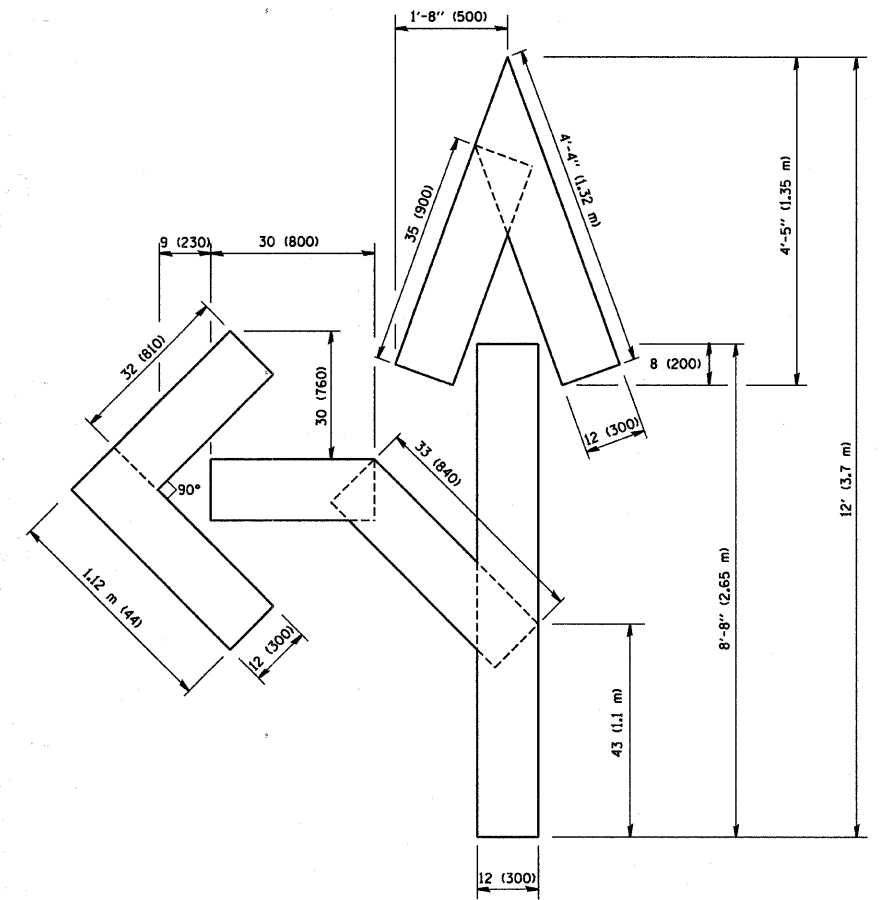

QUANTITY  
4 (100) LINE = 82.5 ft. (25.3 m)  
27.5 sq. ft. (2.53 sq. m)

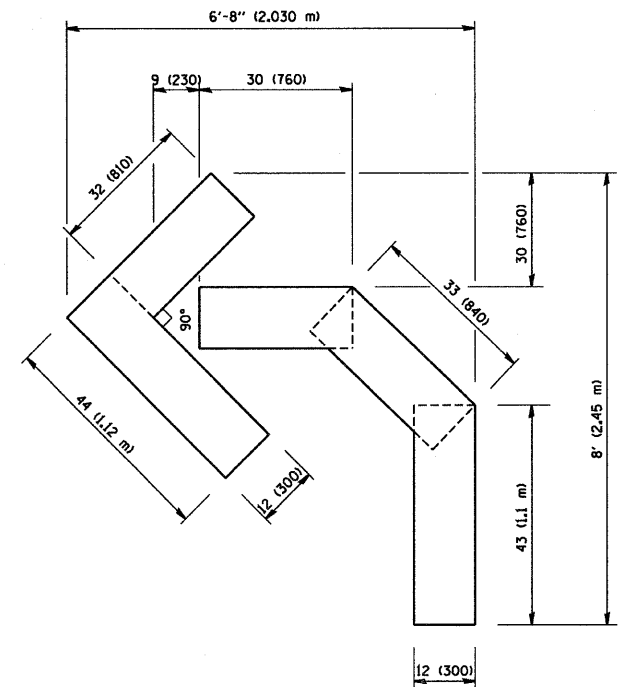

QUANTITY  
4 (100) LINE = 45.5 ft. (13.9 m)  
15.2 sq. ft. (1.39 sq. m)

All dimensions are in inches (millimeters) unless otherwise shown.

FILE NAME = W:\diststd\22x34\col16.dgn	USER NAME = geglienobt	DESIGNED - DRAWN -	REVISED -T. RAMMACHER 06-05-96 REVISED -T. RAMMACHER 11-04-97	<b>STATE OF ILLINOIS DEPARTMENT OF TRANSPORTATION</b>	<b>PAVEMENT MARKING LETTERS AND SYMBOLS FOR TRAFFIC STAGING</b>			F.A.U. RTE. 1342	SECTION 10-00036-00-RS	COUNTY KANE	TOTAL SHEETS 21	SHEET NO. 19
PLOT SCALE = 50.0000' / IN.		CHECKED -	REVISED -T. RAMMACHER 03-02-98		SCALE: NONE	SHEET NO. 1	OF 1 SHEETS	STA.	TO STA.	TC-16 CONTRACT NO. 63469		
PLOT DATE = 1/4/2000		DATE = 09-18-94	REVISED -E. GOMEZ 08-28-00		FED. ROAD DIST. NO. 1 ILLINOIS FED. AID PROJECT ARA-9003 (608)							
C-91-437-10												