

STATE OF ILLINOIS  
DEPARTMENT OF TRANSPORTATION  
DIVISION OF HIGHWAYS

**PLANS FOR PROPOSED  
FEDERAL AID HIGHWAY**

**FAU 1599 / ( WENTWORTH/ATLANTIC AVENUE )  
142ND STREET (FAU 1599) TO 144TH STREET (FAU 1601)  
LOCAL AGENCY PAVEMENT PRESERVATION  
STREET RESURFACING  
PROJECT: ARA-9003(606)  
SECTION NO.: 10-00120-00-RS  
JOB NO.: C-91-428-10  
VILLAGE OF RIVERDALE  
COOK COUNTY**

F. A. D. NO.	SECTION	COUNTY	TOTAL SHEETS	SHEET NO.
1599	10-00120-00-RS	COOK	12	1
STA.		TO STA.		
FED. ROAD DIST. NO. 1		ILLINOIS	FED. AID PROJECT ARA-9003(606)	

CONTRACT #63473

**INDEX OF SHEETS**

- COVER SHEET
- SUMMARY OF QUANTITIES & GENERAL NOTES
- TYPICAL CROSS SECTIONS
- PAVEMENT PLAN
- PAVEMENT MARKING PLAN
- TC-10 - TRAFFIC CONTROL AND PROTECTION FOR SIDE ROADS, INTERSECTIONS, AND DRIVEWAYS
- TC-13 - DISTRICT ONE TYPICAL PAVEMENT MARKINGS
- BD-24 - CURB OR CURB AND GUTTER REMOVAL AND REPLACEMENT
- BD-32 - BUTT JOINT AND HMA TAPER DETAIL
- TS-07 - DISTRICT 1 - DETECTOR LOOP INSTALLATION DETAILS FOR ROADWAY RESURFACING
- BD-01 - DRIVEWAY DETAILS - DISTANCE BETWEEN R.O.W. AND FACE OF CURB & EDGE OF SHOULDER >=15'(4.5m)
- BD-22 - PAVEMENT PATCHING FOR HMA SURFACED PAVEMENT

**IDOT HIGHWAY STANDARDS**

- 000001-05 STANDARD STANDARDS, ABBREVIATIONS AND PATTERNS
- 424001-05 CURB RAMPS FOR SIDEWALK
- 442201-03 CLASS C AND D PATCHES
- 606001-04 CONCRETE CURB TYPE B AND COMBINATION CONCRETE CURB & GUTTER
- 701501-05 URBAN LANE CLOSURE, 2L, 2W, UNDIVIDED
- 701701-06 URBAN LANE CLOSURE, MULTILANE INTERSECTION
- 701801-04 LANE CLOSURE, MULTILANE, 1W OR 2W, CROSSWALK OR SIDEWALK CLOSURE,
- 701901-01 TRAFFIC CONTROL DEVICES
- 780001-02 TYPICAL PAVEMENT MARKINGS

**FAU 1599 - ATLANTIC AVENUE TO WENTWORTH AVENUE  
DESIGN DESIGNATION - COLLECTOR  
ADT=3,000 (2009)  
POSTED SPEED LIMIT = 25 MPH  
DESIGN SPEED = 25 MPH**

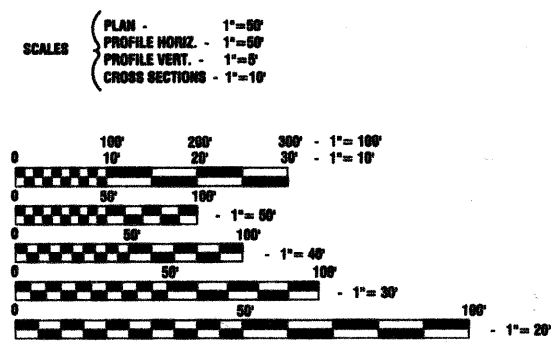

FULL SIZE PLANS HAVE BEEN PREPARED USING STANDARD ENGINEERING SCALES, REDUCED SIZED PLANS WILL NOT CONFORM TO STANDARD SCALES, IN MAKING MEASUREMENTS ON REDUCED PLANS, THE ABOVE SCALES MAY BE USED.

**J. U. L. I. E.  
JOINT UTILITY LOCATION INFORMATION FOR EXCAVATION  
1 - 800 - 892 - 0123 or 811**

**CONTRACT NO. 63473**

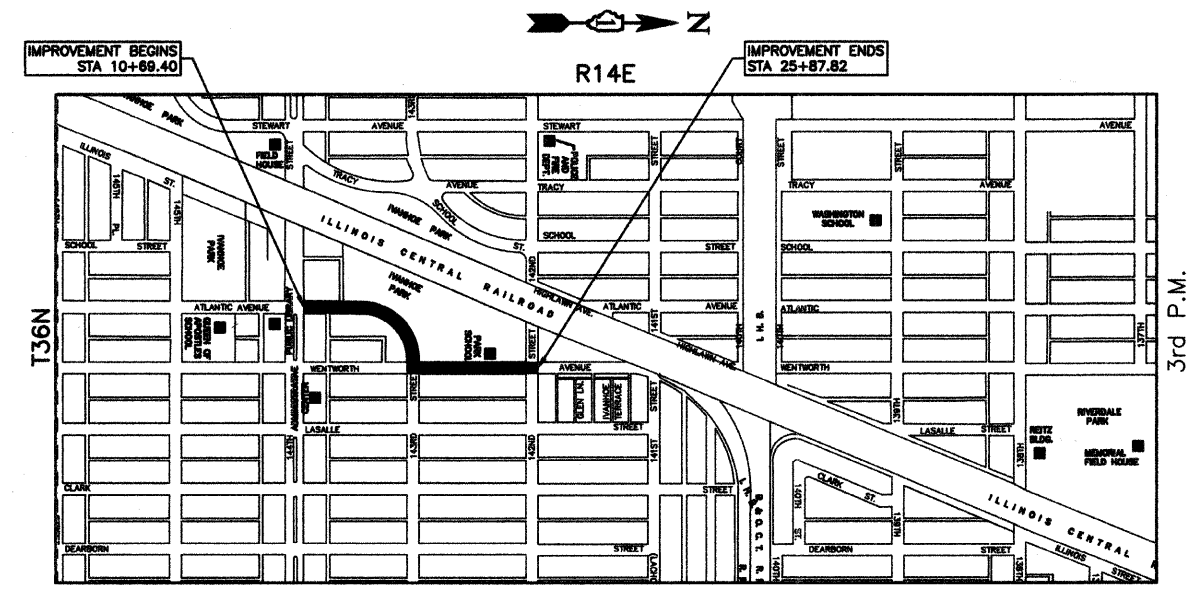
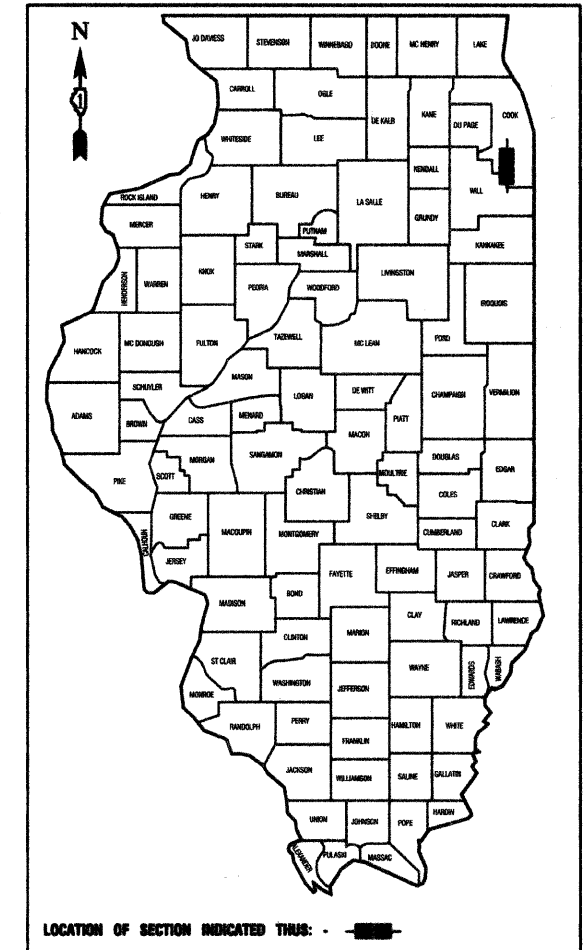

THORNTON TOWNSHIP

**LOCATION MAP**

- INDICATES PROPOSED IMPROVEMENT  
GROSS LENGTH= 1,518.42 FEET = 0.288 MILES  
NET LENGTH= 1,518.42 FEET = 0.288 MILES

STATE OF ILLINOIS DEPARTMENT OF TRANSPORTATION  
DIVISION OF HIGHWAYS

Approved: 4/26/2010  
*[Signature]*  
Mayor, Village of Riverdale

Passed: MAY 27, 2010  
*[Signature]* *[Signature]*  
District 1 Engineer of Local Roads & Streets

Released for Bid Based on Limited Review: MAY 27, 2010  
*[Signature]*  
Deputy Director of Highways, Region 1 Engineer

PRINTED BY THE AUTHORITY OF THE STATE OF ILLINOIS

PREPARED BY OR UNDER THE DIRECT SUPERVISION OF:  
*[Signature]*  
4/27/2010

62-5718 REGISTERED PROFESSIONAL ENGINEER  
STATE OF ILLINOIS  
LICENSE EXPIRES: 11/30/11

I.D.O.T. FIELD ENGINEER: MELCHOR MANGOBA 847-705-4408  
CONSULTANTS: ROBINSON ENGINEERING, LTD. 708-331-6700  
CONTACT ENGINEER: JEFF KOZA