

SIGN ASSEMBLIES

| | | | |
|---------------------------------|---------------------------------|---------------------------------|---------------------------------|
| ALTERNATE M4-1 30x15 | ALTERNATE M4-1 30x15 | ALTERNATE M4-1 30x15 | ALTERNATE M4-1 30x15 |
| NORTH M3-4 30x15 | SOUTH M3-2 30x15 | NORTH M3-4 30x15 | SOUTH M3-2 30x15 |
| WESTERN AVENUE SPECIAL 30x24 | WESTERN AVENUE SPECIAL 30x24 | WESTERN AVENUE SPECIAL 30x24 | WESTERN AVENUE SPECIAL 30x24 |
| M6-3 21x15 | M6-3 21x15 | M6-1 21x15 | M6-1 21x15 |
| 1 | 2 | 3 | 4 |
| | | | |
| ALTERNATE M4-1 30x15 | ALTERNATE M4-1 30x15 | ALTERNATE M4-1 30x15 | ALTERNATE M4-1 30x15 |
| NORTH M3-4 30x15 | SOUTH M3-2 30x15 | NORTH M3-4 30x15 | SOUTH M3-2 30x15 |
| WESTERN AVENUE SPECIAL 30x24 | WESTERN AVENUE SPECIAL 30x24 | WESTERN AVENUE SPECIAL 30x24 | WESTERN AVENUE SPECIAL 30x24 |
| M6-1 21x15 | M6-1 21x15 | M5-1 (RIGHT) 21x15 | M5-1 (RIGHT) 21x15 |
| 5 | 6 | 7 | 8 |
| | | | |
| ALTERNATE M4-1 30x15 | ALTERNATE M4-1 30x15 | ALTERNATE M4-1 30x15 | ALTERNATE M4-1 30x15 |
| NORTH M3-4 30x15 | SOUTH M3-2 30x15 | NORTH M3-4 30x15 | SOUTH M3-2 30x15 |
| WESTERN AVENUE SPECIAL 30x24 | WESTERN AVENUE SPECIAL 30x24 | WESTERN AVENUE SPECIAL 30x24 | WESTERN AVENUE SPECIAL 30x24 |
| M5-1 (LEFT) 21x15 | M5-1 (LEFT) 21x15 | END M4-8B 24x12 | END M4-8B 24x12 |
| 9 | 10 | 11 | 12 |

| | | | |
|-----------------------------------------|-----------------------------------------------|-------------------------------|--------------------------------|
| ROAD CLOSED AHEAD W20-3 48x48 | ROAD CLOSED TO THRU TRAFFIC R11-4 60x30 | ROAD CLOSED R11-2 48x30 | DETOUR AHEAD W20-3 48x48 |
| 14 | 15 | 16 | |
| | | | |
| WESTERN AVE SPECIAL 42x15 | | | |
| USE ALTERNATE ROUTE SPECIAL 42x24 | | | |
| 13 | | | |

* FLASHING WARNING BEACON

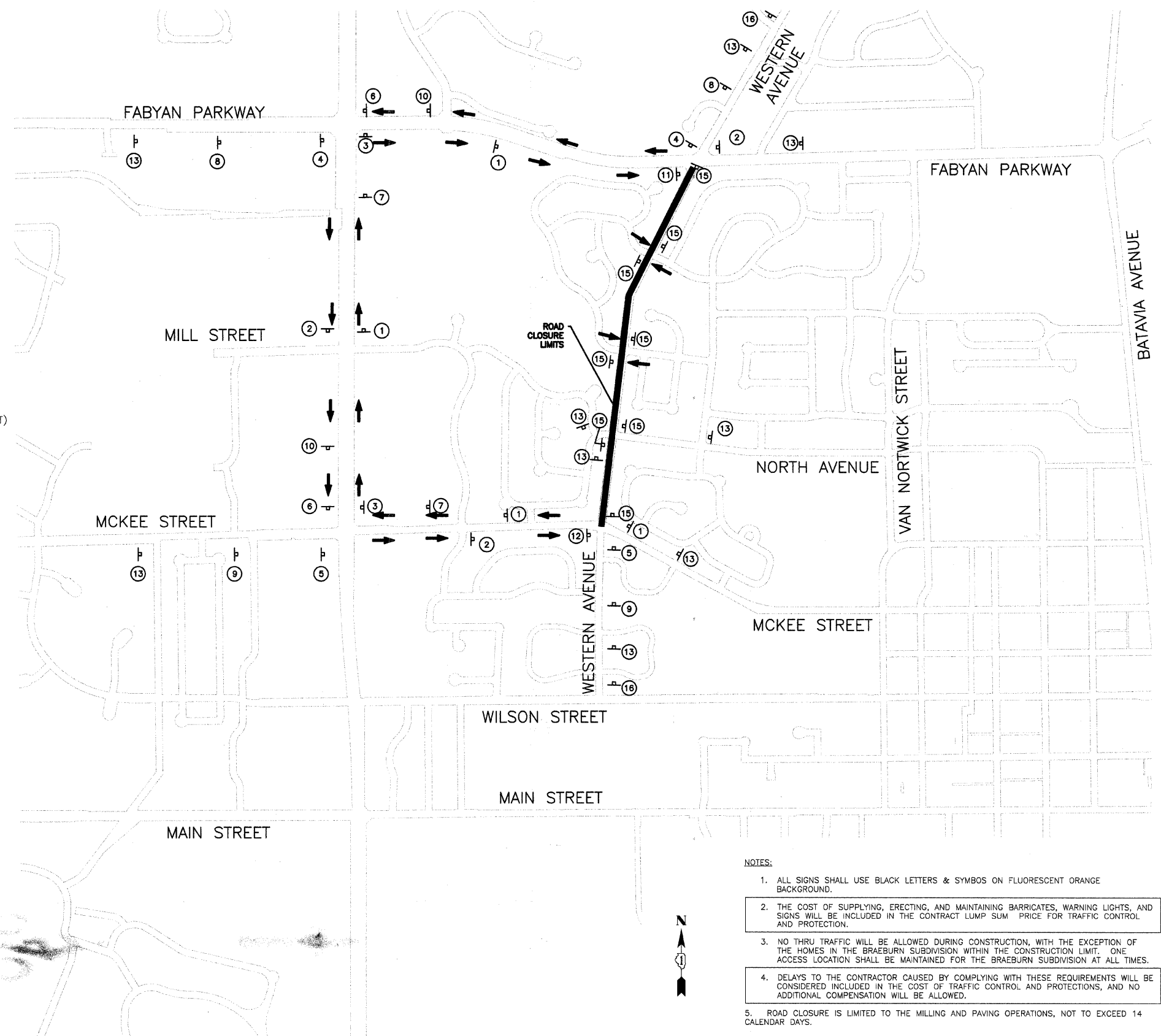

- NOTES:
- ALL SIGNS SHALL USE BLACK LETTERS & SYMBOLS ON FLUORESCENT ORANGE BACKGROUND.
 - THE COST OF SUPPLYING, ERECTING, AND MAINTAINING BARRICADES, WARNING LIGHTS, AND SIGNS WILL BE INCLUDED IN THE CONTRACT LUMP SUM PRICE FOR TRAFFIC CONTROL AND PROTECTION.
 - NO THRU TRAFFIC WILL BE ALLOWED DURING CONSTRUCTION, WITH THE EXCEPTION OF THE HOMES IN THE BRAEBURN SUBDIVISION WITHIN THE CONSTRUCTION LIMIT. ONE ACCESS LOCATION SHALL BE MAINTAINED FOR THE BRAEBURN SUBDIVISION AT ALL TIMES.
 - DELAYS TO THE CONTRACTOR CAUSED BY COMPLYING WITH THESE REQUIREMENTS WILL BE CONSIDERED INCLUDED IN THE COST OF TRAFFIC CONTROL AND PROTECTIONS, AND NO ADDITIONAL COMPENSATION WILL BE ALLOWED.
 - ROAD CLOSURE IS LIMITED TO THE MILLING AND PAVING OPERATIONS, NOT TO EXCEED 14 CALENDAR DAYS.

| | | | | | | | | | | | | | |
|-------------|-------------|------------------|-------------------------------|---------------------------------------------------|-------------------------------------|-------------|--------------|--------------------|---------|----------|------------------|--------------|---|
| FILE NAME = | USER NAME = | DESIGNED -- KRY | REVISED -- 4/5/2010 PER IDOT | STATE OF ILLINOIS DEPARTMENT OF TRANSPORTATION | WESTERN AVENUE LAPP DETOUR PLANS | | | F.A.U. RTE. | SECTION | COUNTY | TOTAL SHEETS | SHEET NO. | |
| | | DRAWN -- KRY | REVISED -- 4/17/2010 PER IDOT | | SCALE: N.T.S. | SHEET NO. 5 | OF 16 SHEETS | STA. | TO STA. | ILLINOIS | FED. AID PROJECT | 16 | 7 |
| | | CHECKED -- NAB | REVISED -- | | | | | | | | | | |
| | | DATE -- 4/7/2010 | REVISED -- | | | | | | | | | | |
| | | | | | | | | CONTRACT NO. 63476 | | | | | |