

QUANTITY
 4 (100) LINE = 64.1 ft. (19.7 m)
 21.1 sq. ft. (1.97 sq. m)

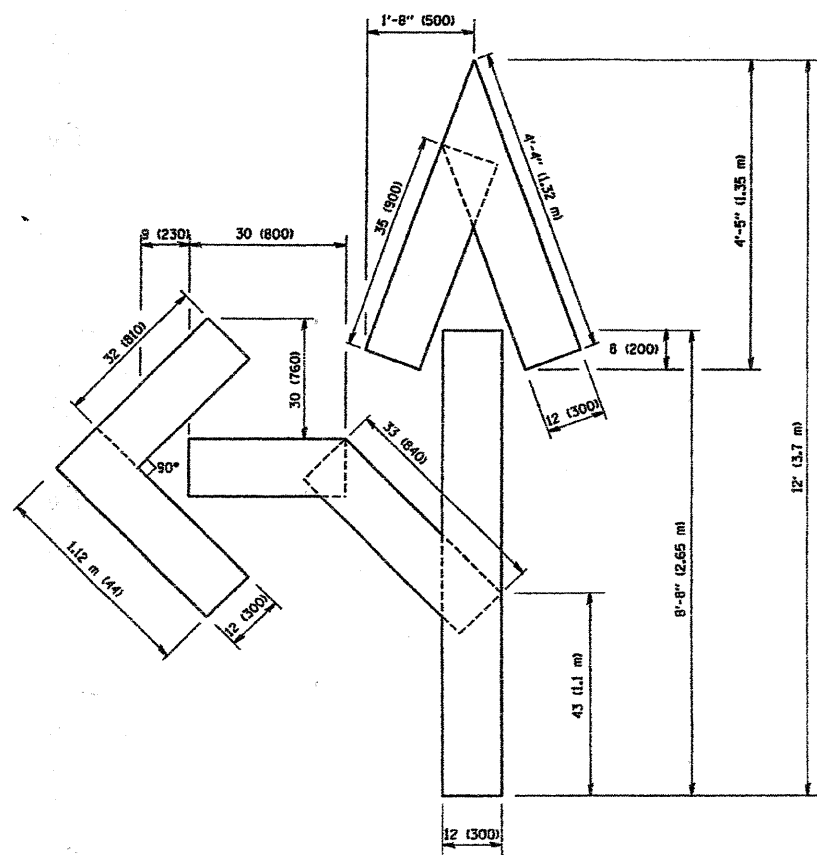

QUANTITY
 4 (100) LINE = 82.5 ft. (25.3 m)
 27.5 sq. ft. (2.53 sq. m)

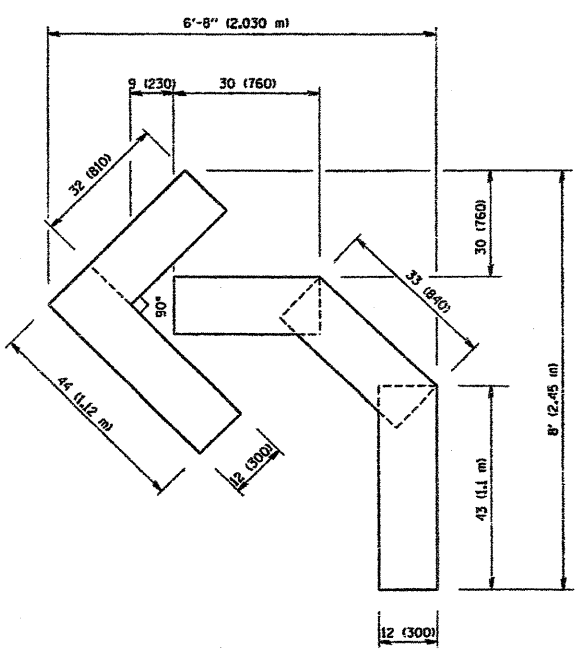

QUANTITY
 4 (100) LINE = 45.5 ft. (13.9 m)
 15.2 sq. ft. (1.39 sq. m)

All dimensions are in inches (millimeters) unless otherwise shown.

CITY OF GENEVA KANE COUNTY, ILLINOIS	DESIGNED - CEO	REVISED -	STATE OF ILLINOIS DEPARTMENT OF TRANSPORTATION ANDERSON BLVD LAPP IMPROVEMENTS	PAVEMENT MARKING LETTERS AND SYMBOLS FOR TRAFFIC STAGING		F.A.U. RTE.	SECTION	COUNTY	TOTAL SHEETS	SHEET NO.
	DRAWN - HL PM	REVISED -		SCALE: _____	JOB NO. C-91-545-10	1678	10-00111-00-RS	KANE	22	19
	CHECKED - PB	REVISED -		STA. 0+00 TO STA. 34+22		FED. ROAD DIST. NO. C-91-545-10	ILLINOIS	FED. AID PROJECT ARA-9003(679)	CONTRACT NO. 63478	
	DATE - APRIL 2010	REVISED -								