

SURVEYED BY DATE
 PLOTTED BY DATE
 CHECKED BY DATE
 PLAN NOTE BOOK NO. PAID FILE NAME
 PROFILE SURVEYED BY DATE
 PLOTTED BY DATE
 CHECKED BY DATE
 STRUCTURE NOTATION CHRD
 NOTE BOOK NO.

CHRISTOPHER B. BURKE ENGINEERING LTD.
 9575 West Higgins Road, Suite 600
 Rosemont, Illinois 60018
 (847) 823-0500

CONSTRUCTION NOTES:

- ① REMOVE EXISTING SIGNAL HEAD, 1-FACE, 3-SECTION, OPTICALLY PROGRAMMED, BRACKET MOUNTED. REPLACE WITH NEW SIGNAL HEAD, L.E.D., 1-FACE, 3-SECTION, OPTICALLY PROGRAMMED, BRACKET MOUNTED. RE-USE ALL EXISTING CABLES.
- ② REMOVE EXISTING SIGNAL HEAD, 1-FACE, 3-SECTION, OPTICALLY PROGRAMMED, MAST ARM MOUNTED. REPLACE WITH NEW SIGNAL HEAD, L.E.D., 1-FACE, 3-SECTION, OPTICALLY PROGRAMMED, MAST ARM MOUNTED. RE-USE ALL EXISTING CABLES.
- ③ REMOVE EXISTING SIGNAL HEAD, 2-FACE, 3-SECTION, 1-3 SECTION OPTICALLY PROGRAMMED AND 1-3 SECTION BRACKET MOUNTED. REPLACE WITH NEW SIGNAL HEAD, L.E.D., 1-FACE, 3-SECTION, OPTICALLY PROGRAMMED AND 1-3 SECTION, BRACKET MOUNTED. RE-USE EXISTING CABLE
- ④ REMOVE EXISTING PEDESTRIAN SIGNAL HEAD, 1-FACE AND PUSHBUTTON. REPLACE WITH NEW PEDESTRIAN SIGNAL HEAD, L.E.D., 1-FACE, WITH COUNTDOWN TIMER AND NEW PEDESTRIAN PUSHBUTTON. RE-USE ALL EXISTING CABLES.
- ⑤ REMOVE EXISTING PEDESTRIAN SIGNAL HEAD, 2-FACE AND PUSHBUTTONS. REPLACE WITH NEW PEDESTRIAN SIGNAL HEAD, L.E.D., 2-FACE WITH COUNTDOWN TIMER AND NEW PEDESTRIAN PUSHBUTTON. RE-USE ALL EXISTING CABLES.
- ⑥ INSTALL UNINTERRUPTIBLE POWER SUPPLY (UPS). INSTALL 5" P.C.C. SIDEWALK PAD.
- ⑦ ALL EXISTING CONFIRMATION BEACONS SHALL BE RETROFITTED WITH LED INDICATIONS. THIS WORK SHALL BE INCLUDED IN THE COST FOR THE PAY ITEM: UNINTERRUPTIBLE POWER SUPPLY.
- ⑧ THE TRAFFIC SIGNAL CONTROLLER SHALL BE NTCIP COMPATIBLE.

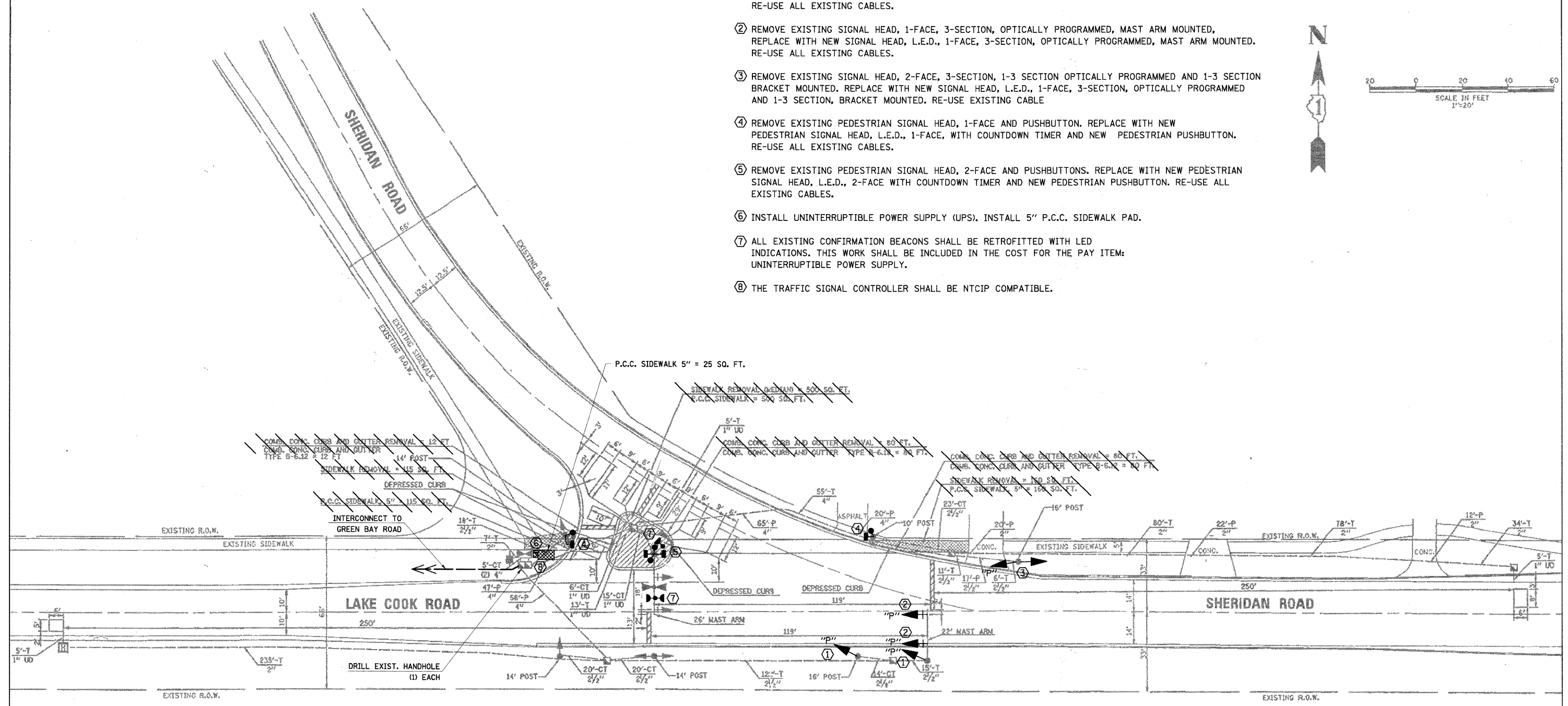

THE FOLLOWING ITEMS SHALL BE REMOVED BY THE CONTRACTOR AND SHALL BE DISPOSED OF BY THEM OUTSIDE THE RIGHT-OF-WAY AT THEIR EXPENSE. THE SALVAGE VALUE OF THE REMOVED EQUIPMENT SHALL BE REFLECTED IN THE CONTRACT BID PRICE.

- | | | |
|---|------|--|
| 5 | EACH | SIGNAL HEAD, 1-FACE, 3-SECTION, OPTICALLY PROGRAMMED |
| 1 | EACH | SIGNAL HEAD, 2-FACE, 3-SECTION |
| 2 | EACH | PEDESTRIAN SIGNAL HEAD, 1-FACE |
| 1 | EACH | PEDESTRIAN SIGNAL HEAD, 2-FACE |
| 4 | EACH | PEDESTRIAN PUSH-BUTTON |
| 1 | EACH | CONTROLLER |

NOTE:
 THE TRAFFIC SIGNAL CONTROLLER EQUIPMENT FOR THIS PROJECT SHALL BE "EAGLE" TO MATCH THE EXISTING ADJACENT SYSTEM.

| | | | | | | | | | | |
|--|-----------------------|----------------|--------------------|---|---|---------------------------|---------|--------|--------------|-----------|
| FILE NAME = N:\LCD01\090407\Traffic\150.LCRD-Sheridan.dgn | USER NAME = FBARISO | DESIGNED - ABR | REVISED - | STATE OF ILLINOIS DEPARTMENT OF TRANSPORTATION | TRAFFIC SIGNAL MODERNIZATION PLAN LAKE COOK ROAD AND SHERIDAN ROAD | F.A.P. RTE. | SECTION | COUNTY | TOTAL SHEETS | SHEET NO. |
| PLOT SCALE = NOT TO SCALE | CHECKED - MJT | REVISED - | 06-00924-00-TL | | | LAKE | 76 | 21 | | |
| PLOT DATE = 5/3/2010 | DATE - APRIL 30, 2010 | REVISED - | CONTRACT NO. 63485 | | | | | | | |
| SCALE: NOT TO SCALE SHEET NO. OF SHEETS STA. -- TO STA. -- | | | | | | ILLINOIS FED. AID PROJECT | | | | |