

DRAINAGE DETAILS

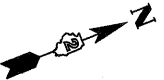

PLAN	SURVEYED	BY	DATE
	PLOTTED		
	GRADES CHECKED		
	STRUCTURE NOTATIONS CHECKED		
	NOTE BOOK NO.		
	CADD FILE NAME		

PROFILE	SURVEYED	BY	DATE
	PLOTTED		
	GRADES CHECKED		
	STRUCTURE NOTATIONS CHECKED		
	NOTE BOOK NO.		
	CADD FILE NAME		

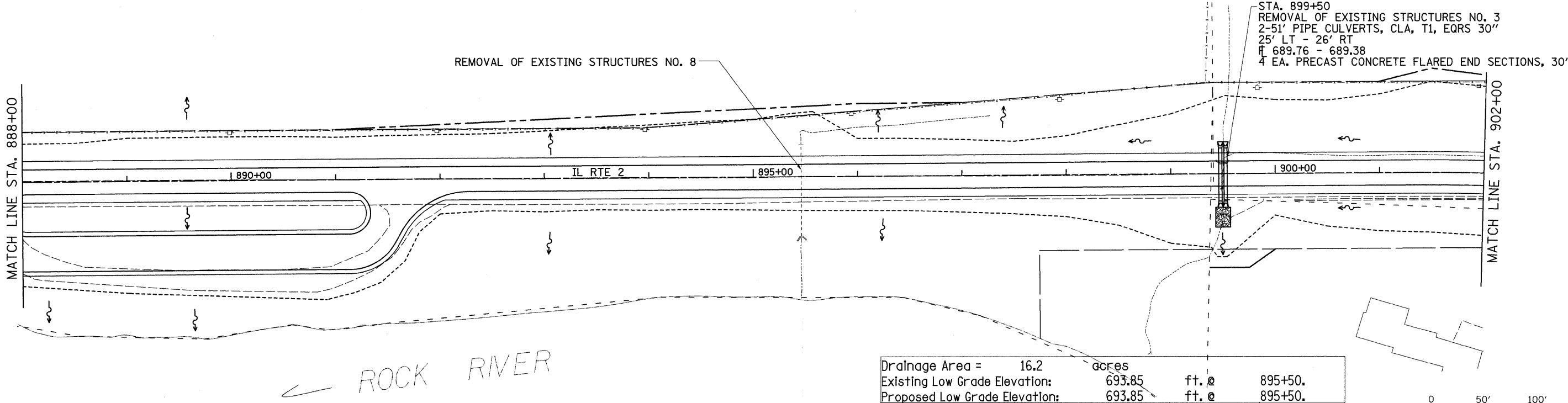

Drainage Area = 16.2 acres				
Existing Low Grade Elevation: 693.85 ft. @ 895+50.				
Proposed Low Grade Elevation: 693.85 ft. @ 895+50.				
Flood	Frequency Year	Discharge cfs	Headwater Existing	Elev. (ft) Proposed
Ten-Year Design Base	10 50 100	36 49 57	694.72 695.83 696.69	691.87 692.35 692.79
OVT (E)	1	23	693.85	
OVT (P)	344	73		693.96
10-Year Velocity through Existing Culvert =			8.1 fps	
10-Year Velocity through Proposed Culvert =			6.2 fps	

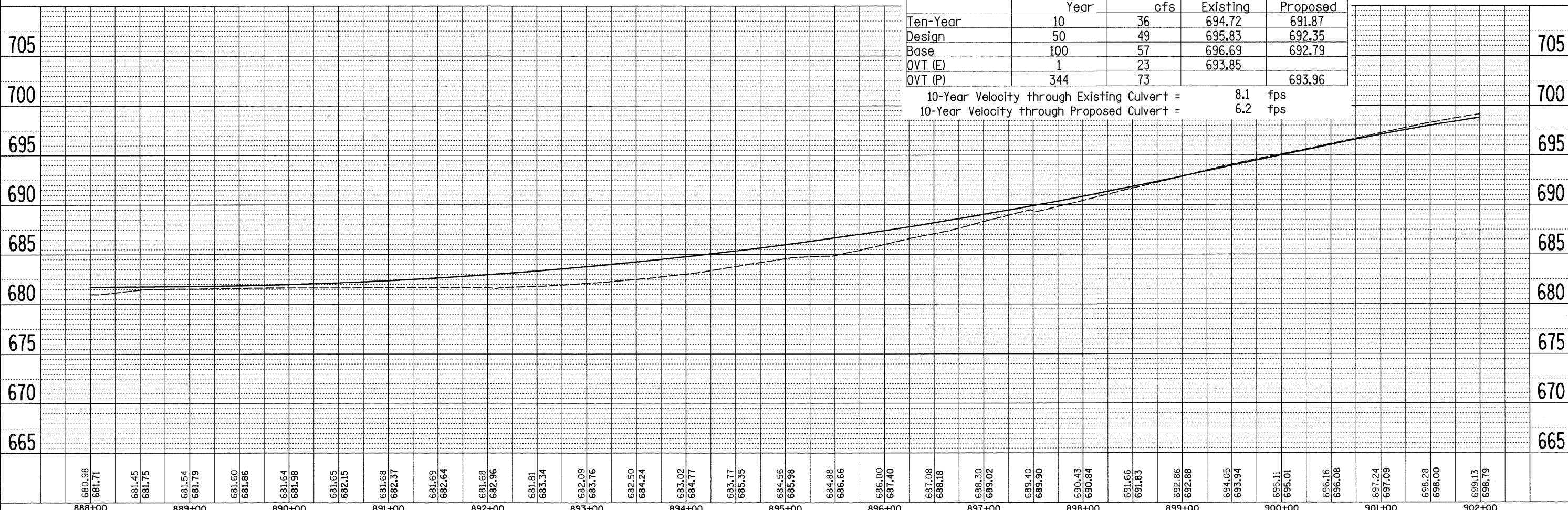

FILE NAME =	USER NAME = grantpm	DESIGNED -	REVISED -	STATE OF ILLINOIS DEPARTMENT OF TRANSPORTATION	DRAINAGE DETAILS	F.A.P. RTE. 742	SECTION 37R-4	COUNTY OGLE	TOTAL SHEETS 867	SHEET NO. 338
CONTRACT NO. 64E17	SCALE:	SHEET NO. OF SHEETS	STA. TO STA.			FED. ROAD DIST. NO.	ILLINOIS FED. AID PROJECT			
PLOT SCALE = 50,0000' / IN.	CHECKED -	REVISED -								
PLOT DATE = Tue Mar 30 10:33:47 2010	DATE -	REVISED -								