

DRAINAGE DETAILS

NOTES:
 INLET SPECIAL NO. 5 OFFSETS ARE MEASURED TO TOP BACK OF CURB.
 INLET T9 F&G & INLET, SPECIAL OFFSETS ARE MEASURED TO WEIR LOCATION.
 FLOW LINE OFFSET IS MEASURED AT END OF FES. PIPE LENGTH IS MEASURED 6' LESS THAN FES OFFSET.

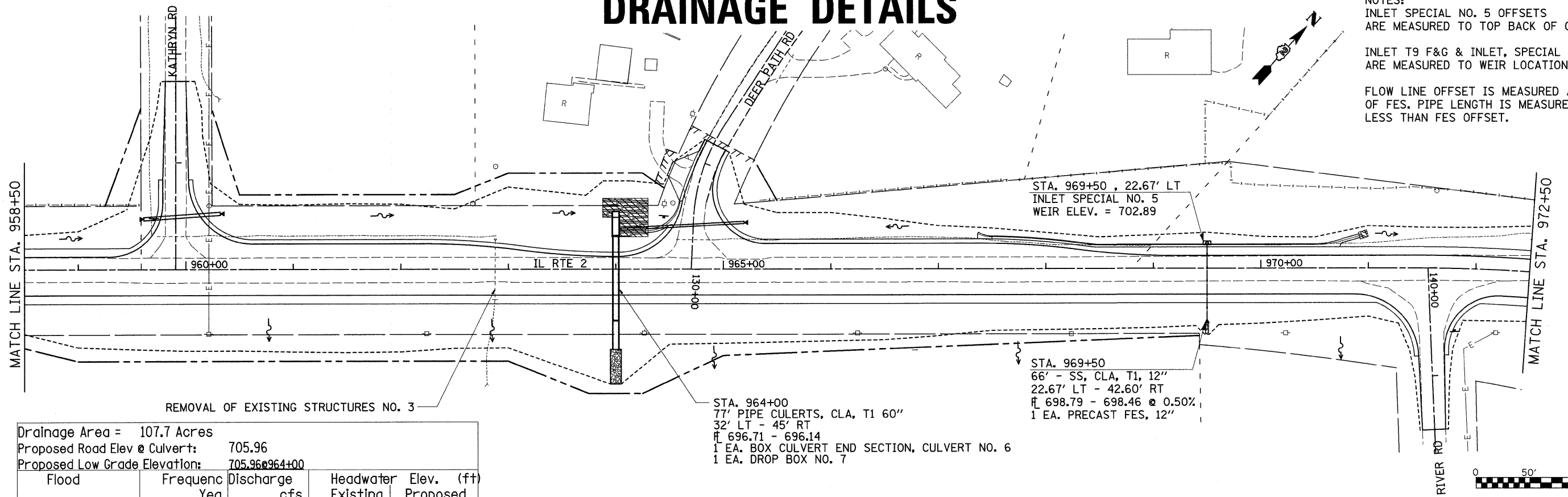

REMOVAL OF EXISTING STRUCTURES NO. 3

STA. 964+00
 77' PIPE CULVERTS, CLA, T1 60"
 32' LT - 45' RT
 H 696.71 - 696.14
 1 EA. BOX CULVERT END SECTION, CULVERT NO. 6
 1 EA. DROP BOX NO. 7

STA. 969+50, 22.67' LT
 INLET SPECIAL NO. 5
 WEIR ELEV. = 702.89

STA. 969+50
 66' - SS, CLA, T1, 12"
 22.67' LT - 42.60' RT
 H 698.79 - 698.46 @ 0.50%
 1 EA. PRECAST FES, 12"

Drainage Area = 107.7 Acres				
Proposed Road Elev @ Culvert: 705.96				
Proposed Low Grade Elevation: 705.96 @ 964+00				
Flood	Frequenc Yea	Discharge cfs	Headwater Existing	Elev. (ft) Proposed
Exist. Overtoppin	<1	28	698.93 *	
Ten-Year	10	70	699.41	700.38
Design	50	97	699.50	701.29
Base	100	110	699.55	701.70
Max Calc.	500	155		703.78

10-Year Velocity through Existing Culvert = 34.7 fps
 10-Year Velocity through Proposed Culvert = 9.9 fps

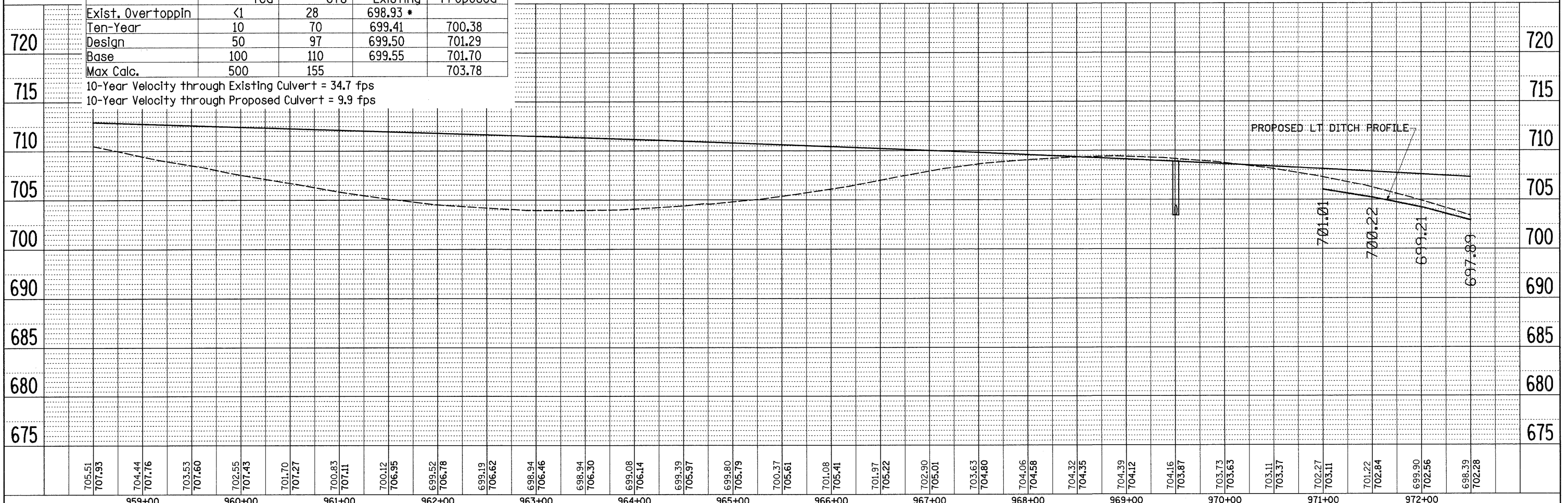

FILE NAME =	USER NAME = grantpm	DESIGNED -	REVISED -	STATE OF ILLINOIS DEPARTMENT OF TRANSPORTATION	DRAINAGE DETAILS	F.A.P. SECTION	COUNTY	TOTAL SHEETS	SHEET NO.	
ca:\p\w\k\p\WIDOT\GRANTPM\dms31213\dr2\dgn		DRAWN -	REVISED -			742	37R-4	OGLE	867	343
PLOT SCALE = 50.0000' / IN.		CHECKED -	REVISED -			CONTRACT NO. 64E17				
PLOT DATE = Tue Mar 30 10:33:52 2010		DATE -	REVISED -			FED. ROAD DIST. NO. ILLINOIS FED. AID PROJECT				

PLAN	SURVEYED	BY	DATE
	PLOTTED		
	CHECKED		
	REVISIONS		
	NO. OF MAY CHECKED		
	CADD FILE NAME		
	NO.		

PROFILE	SURVEYED	BY	DATE
	PLOTTED		
	CHECKED		
	REVISIONS		
	NO. OF MAY CHECKED		
	CADD FILE NAME		
	NO.		