

**INDEX OF SHEETS**

1. COVER SHEET
2. GENERAL NOTES, HIGHWAY STANDARDS, COMMENTS, AND SUMMARY OF QUANTITIES
3. RIGHT OF WAY PLAN
4. GENERAL PLAN AND ELEVATION
5. EXISTING SCOUR COUNTERMEASURES
6. EXISTING SCOUR COUNTERMEASURES REMOVAL
7. PROPOSED SCOUR COUNTERMEASURES OVERVIEW
8. - 10. PROPOSED SCOUR COUNTERMEASURES PARTIAL PLAN
11. EROSION CONTROL PLAN
12. TREE REMOVAL PLAN
13. SCOUR COUNTERMEASURES DETAILS
14. - 16. HYDRAULIC CROSS SECTIONS

**STATE OF ILLINOIS**  
**DEPARTMENT OF TRANSPORTATION**  
**DIVISION OF HIGHWAYS**

**PROPOSED**  
**HIGHWAY PLANS**

**F.A.P ROUTE 646 (IL 40)**  
**SECTION (122BR-1) I**

**D3 SCOUR MITIGATION 2009**  
**BUREAU COUNTY**

C93-001-10

F.A.P. RTE.	SECTION	COUNTY	TOTAL SHEETS	SHEET NO.
646	(122BR-1) I	BUREAU	16	1
		ILLINOIS	CONTRACT NO. 66826	

P93-040-08  
D93-011-10

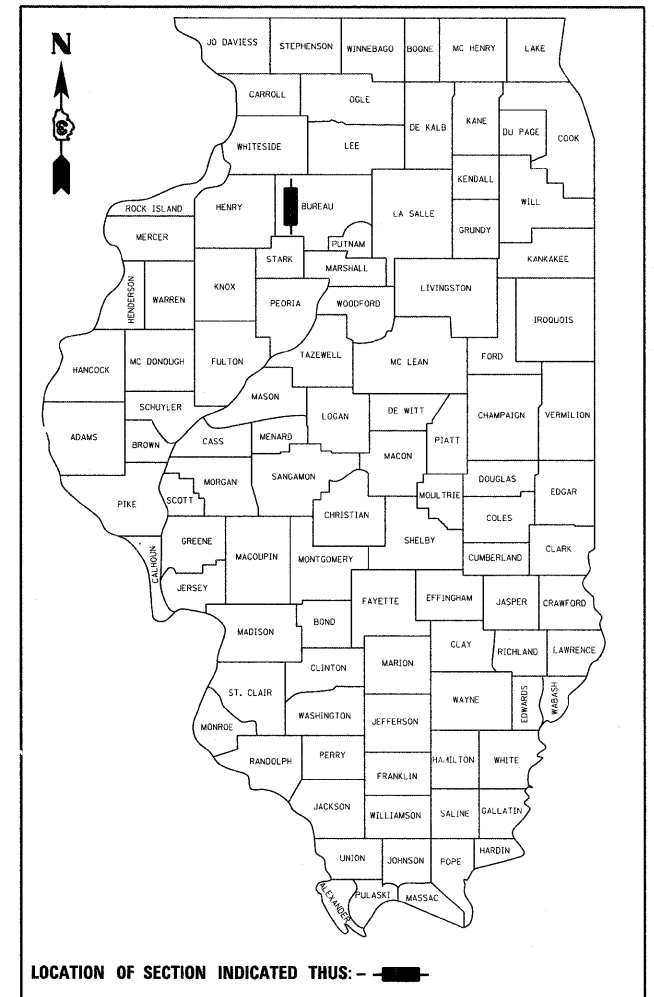

ADT = 1800  
ROUTE DESIGNATION: RURAL MINOR ARTERIAL

SCOUR MITIGATION AT STRUCTURE  
CARRYING ILLINOIS ROUTE 40 OVER  
COAL CREEK (SN 006-0145)

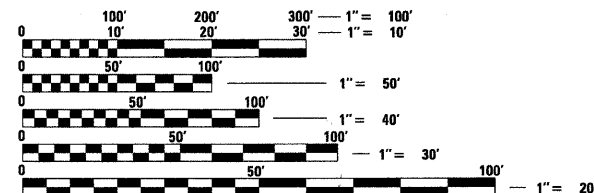
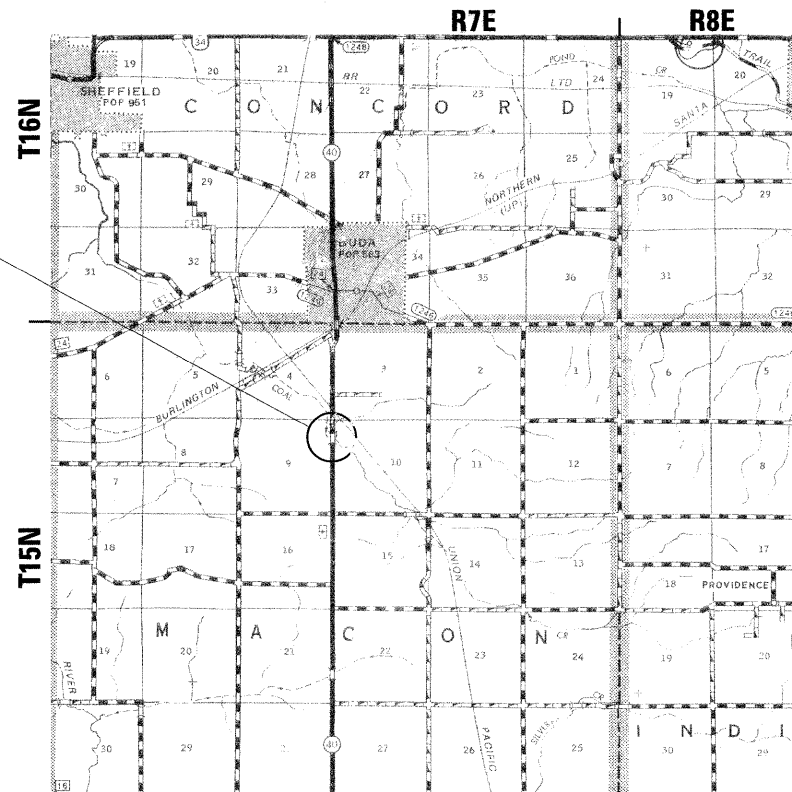

FULL SIZE PLANS HAVE BEEN PREPARED USING STANDARD ENGINEERING SCALES. REDUCED SIZED PLANS WILL NOT CONFORM TO STANDARD SCALES. IN MAKING MEASUREMENTS ON REDUCED PLANS, THE ABOVE SCALES MAY BE USED.

J.U.L.I.E.  
JOINT UTILITY LOCATION INFORMATION FOR EXCAVATION  
1-800-892-0123  
OR 811

DISTRICT 3 NO. (815) 434-6131  
PROJECT ENGINEER: STEVE FERGUSON  
PROJECT MANAGER: SCOTT FERGUSON  
TOWNSHIP(S): MACON  
CONTRACT NO. 66826

WILLIAM C. BOBT  
062-050971  
REGISTERED  
PROFESSIONAL  
ENGINEER  
OF  
ILLINOIS  
Exp. 11/30/2011  
William C. Bobt  
03/29/2010

STATE OF ILLINOIS  
DEPARTMENT OF TRANSPORTATION  
DIVISION OF HIGHWAYS

SUBMITTED 4/16 20 10

Steve E. Ferguson  
DEPUTY DIRECTOR OF HIGHWAYS, REGION ENGINEER

June 25 20 10

Scott E. Stitt P.E. /a  
acting ENGINEER OF DESIGN AND ENVIRONMENT

June 25 20 10

Christine M. Reed /a  
DIRECTOR OF HIGHWAYS, CHIEF ENGINEER

**PRINTED BY THE AUTHORITY**  
**OF THE STATE OF ILLINOIS**

**STANDARDS**

- 000001-05 STANDARD SYMBOLS, ABBREVIATIONS, AND PATTERNS
- 280001-05 TEMPORARY EROSION CONTROL SYSTEMS
- 701001-02 OFF-RD OPERATIONS 2L, 2W, MORE THAN 15' AWAY
- 701006-03 OFF-RD OPERATIONS 2L, 2W, 15' TO 24" FROM PAVEMENT EDGE
- 701011-02 OFF-RD MOVING OPERATIONS, 2L, 2W, DAY ONLY
- 701201-03 LANE CLOSURE, 2L, 2W DAY ONLY, FOR SPEEDS ≥ 45 MPH
- 701301-03 OFF-RD OPERATIONS 2L, 2W SHORT TIME OPERATION
- 701901-01 TRAFFIC CONTROL DEVICES

The following rates have been used in calculating plan quantities:  
 1.0 Cubic Yard of A5 RipRap = 1.5 Ton A5 RipRap  
 1 Acre of disturbed land = 100 lbs Temporary Erosion Control Seeding

Members of J.U.L.I.E known to be within the limits of the improvement are:

Corn Belt Energy Corporation  
 Engineering Department  
 309-662-5330

Verizon North, Inc.  
 Mary Ruth Willis  
 309-827-1617

Mediacom

GENERAL NOTES

Where section or subsection monuments are encountered, the engineer shall be notified before such monuments are removed. The Contractor shall protect and carefully preserve all monuments until an authorized surveyor or an agent has witnessed or otherwise referenced their location. The contractor shall be responsible for having an authorized surveyor reestablish any section or subsection monuments destroyed by his operation

Seeding shall not be permitted at any time when the ground is frozen, wet, or in an unillable condition. locations to be seeded will be determined by the engineer.

All elevations refer to U.S.G.S mean sea level datum.

Abandoned underground utilities that conflict with construction shall be disposed of outside the limits of the right of way according to Article 202.03 of the standard specifications and directed by the engineer. This work will not be paid for separately but shall be included in the cost of earth excavation.

Any reference to a standard in these plans shall be interpreted to mean the edition as indicated by the subnumber listed on the index of sheets or the copy of the standard included in these plans.

The finished earthwork shall have a vegetation sustaining soil covering the top four inches in areas to be seeded or sodded. The vegetation sustaining soil required will not be paid for separately but shall be included in the cost of topsoil excavation and placement.

The Contractor shall contact JULIE at least 48 Hours prior to excavation to determine which utilities are in the project area.

SUMMARY OF QUANTITIES			100% STATE SFTY-2A
CODE NO.	ITEM	UNIT	TOTAL QUANTITY
20100500	TREE REMOVAL, ACRES	ACRE	0.20
20300100	CHANNEL EXCAVATION	CU YD	693
21101505	TOPSOIL EXCAVATION AND PLACEMENT	CU YD	31
25001000	SEEDING, CLASS 2 (SPECIAL)	ACRE	1.4
25100900	TURF REINFORCEMENT MAT	SQ YD	351
28000250	TEMPORARY EROSION CONTROL SEEDING	POUND	140
28000400	PERIMETER EROSION BARRIER	FOOT	2,301
28100209	STONE RIPRAP, CLASS A5	TON	1,518
28200200	FILTER FABRIC	SQ YD	1,737
67100100	MOBILIZATION	L SUM	1
70100450	TRAFFIC CONTROL PROTECTION, STANDARD 701201	L SUM	1
X0323265	REMOVE EXISTING RIPRAP	SQ YD	314

\* SPECIALTY ITEM

STATE OF ILLINOIS  
 DEPARTMENT OF TRANSPORTATION  
 DISTRICT THREE

REVIEWED BY: *Don Brant*  
 ACTING DISTRICT STUDIES & PLANS ENGINEER

DATE: \_\_\_\_\_

EXAMINED BY: *Herbert Brown*  
 DISTRICT CONSTRUCTION ENGINEER

*May 2. Phillips*  
 DISTRICT MATERIALS ENGINEER

*Bruce A. Huschman*  
 DISTRICT OPERATIONS ENGINEER



FILE NAME =	USER NAME = fergusonaa	DESIGNED - GAMBILL	REVISED -
ca:\pw\work\p\widot\ Fergusonaa\dms59009\066826-sht-Gen Notes.dgn		DRAWN - VERENSKI	REVISED -
	PLOT SCALE = 0:1.0000 1' / IN.	CHECKED - BOTT	REVISED -
G&B PROJECT:	PLOT DATE = Apr 09, 2010 - 11:04:15 AM	DATE - 02/23/10	REVISED -

STATE OF ILLINOIS  
 DEPARTMENT OF TRANSPORTATION

GENERAL NOTES, HIGHWAY STANDARDS, COMMENTS  
 AND SUMMARY QUANTITIES

SCALE: SHEET NO. 1 OF 1 SHEETS STA. TO STA.

F.A.P. RTE.	SECTION	COUNTY	TOTAL SHEETS	SHEET NO.
646	(122BR-1) I	BUREAU	16	2
FED. ROAD DIST. NO. [ILLINOIS] FED. AID PROJECT			CONTRACT NO. 66826	

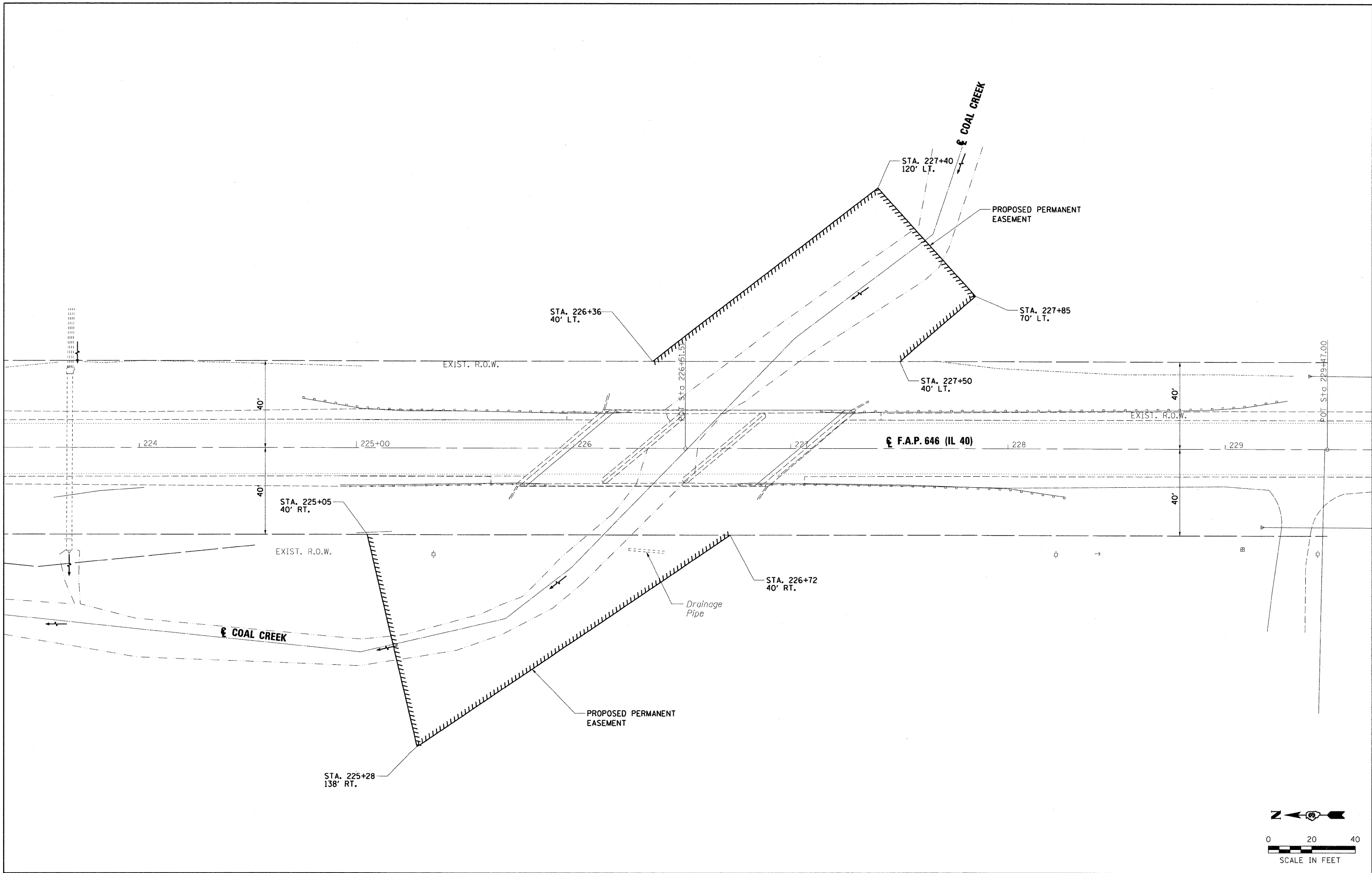

GREENE & BRADFORD, INC.  
 OF SPRINGFIELD  
 1001 SOUTH MAIN STREET  
 SPRINGFIELD, ILLINOIS 62761  
 PHONE: 217-223-1111  
 FAX: 217-223-1112  
 WWW: WWW.G&B.COM

FILE NAME = J:\00227\W05\CADD\CADsheets\0366826-sh-ROW.dgn  
 USER NAME = Frankv  
 DESIGNED - GAMBILL  
 DRAWN - VERENSKI  
 CHECKED - BOTT  
 DATE - 2/23/09  
 PLOT SCALE = 20.0000' / in.  
 PLOT DATE = 3/29/2010  
 G&B PROJECT:  
 PLOT DRIVER = Vb1\_TDS700\_P5\_22x34.pltcf

DESIGNED - GAMBILL	REVISED -
DRAWN - VERENSKI	REVISED -
CHECKED - BOTT	REVISED -
DATE - 2/23/09	REVISED -

STATE OF ILLINOIS  
 DEPARTMENT OF TRANSPORTATION

RIGHT OF WAY PLAN, ILL. ROUTE 40 OVER COAL CREEK  
 STATION 226 + 45.00

SCALE: SHEET NO. 1 OF 1 SHEETS STA. TO STA.

F.A.P. RTE. 646	SECTION (122BR-1) 1	COUNTY BUREAU	TOTAL SHEETS 16	SHEET NO. 3
FED. ROAD DIST. NO.		ILLINOIS FED. AID PROJECT		

CONTRACT NO. 66826

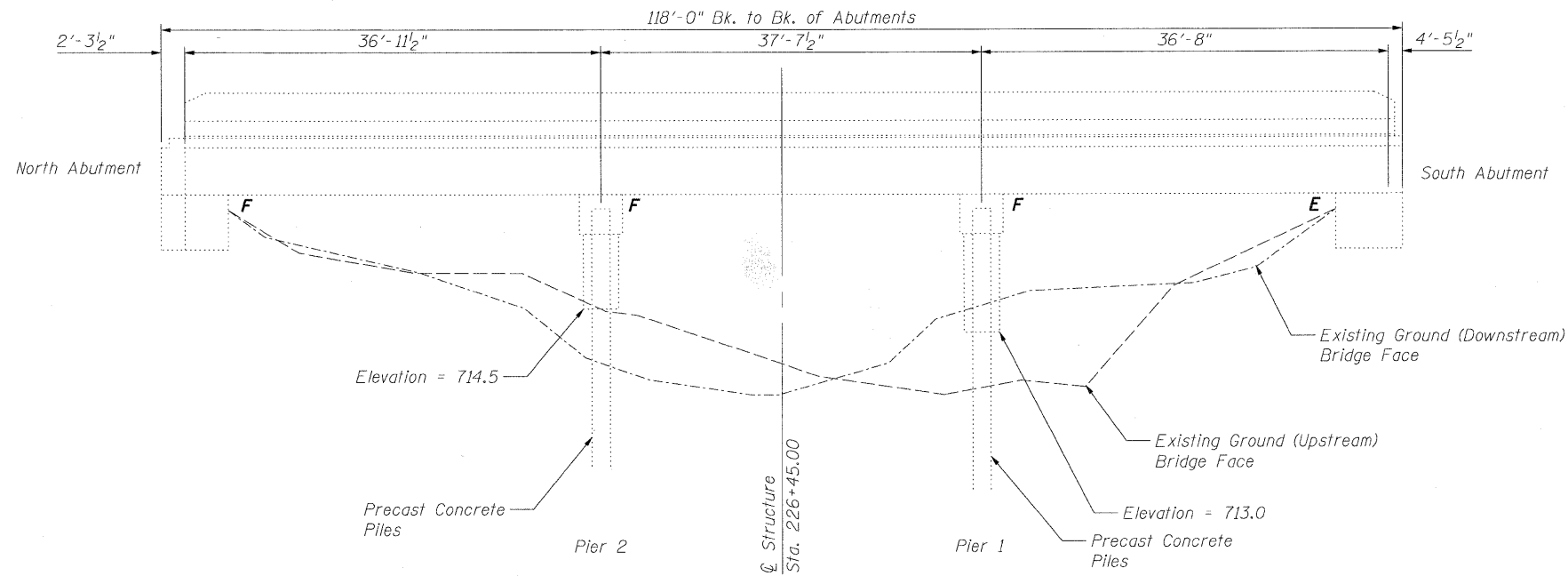

**ELEVATION**  
Looking Downstream

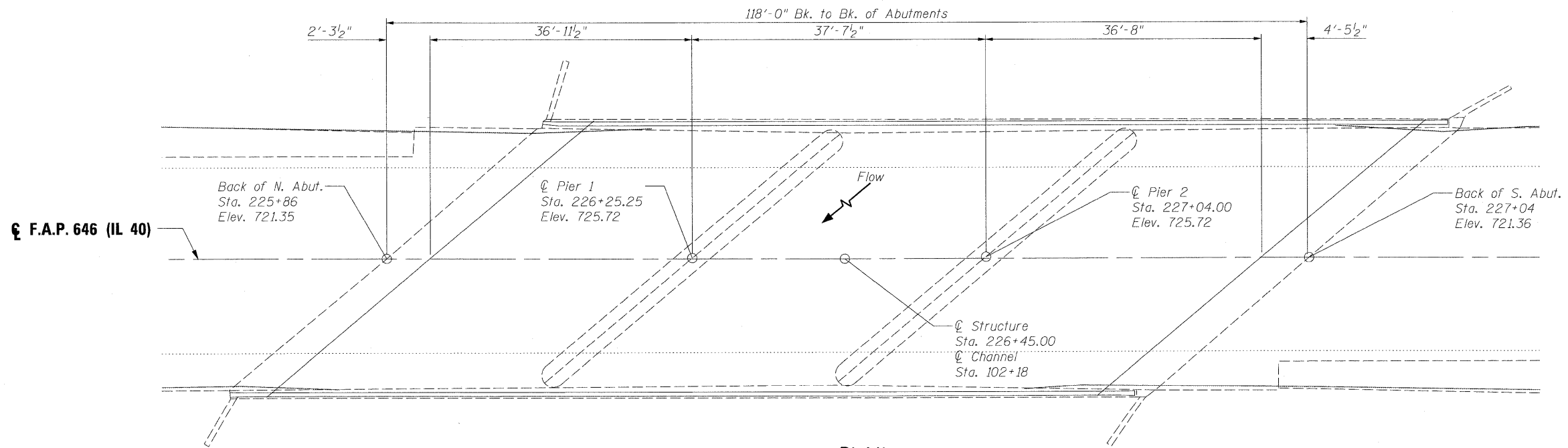

**PLAN**

GREENE & BRADFORD, INC.  
OF BRIDGEVILLE  
ENGINEERS AND ARCHITECTS  
INCORPORATED  
1000 W. 10TH ST.  
BRIDGEVILLE, OHIO 45130  
TEL: 513-835-1100  
FAX: 513-835-1101  
WWW.G&B.COM

FILE NAME = J:\08227\W05\CADD\CADsheets\0366826-sh-DPE.dgn  
PLOT SCALE = 8/16" = 1' / in.  
PLOT DATE = 3/29/2010  
G&B PROJECT: PLOT DRIVER = V8...TDS700.PS,22x34.plt to Pg

USER NAME = Frankv  
DESIGNED - GAMBILL  
DRAWN - VERENSKI  
CHECKED - BOTT  
DATE - 2/23/10

REVISED -  
REVISED -  
REVISED -  
REVISED -

STATE OF ILLINOIS  
DEPARTMENT OF TRANSPORTATION

GENERAL PLAN AND ELEVATION  
ILL. ROUTE 40 OVER COAL CREEK

SCALE: SHEET NO. 1 OF 1 SHEETS STA. TO STA.

F.A.P. RTE.	SECTION	COUNTY	TOTAL SHEETS	SHEET NO.
646	(122BR-1) I	BUREAU	16	4
CONTRACT NO. 66826				
FED. ROAD DIST. NO. ILLINOIS FED. AID PROJECT				

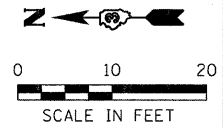
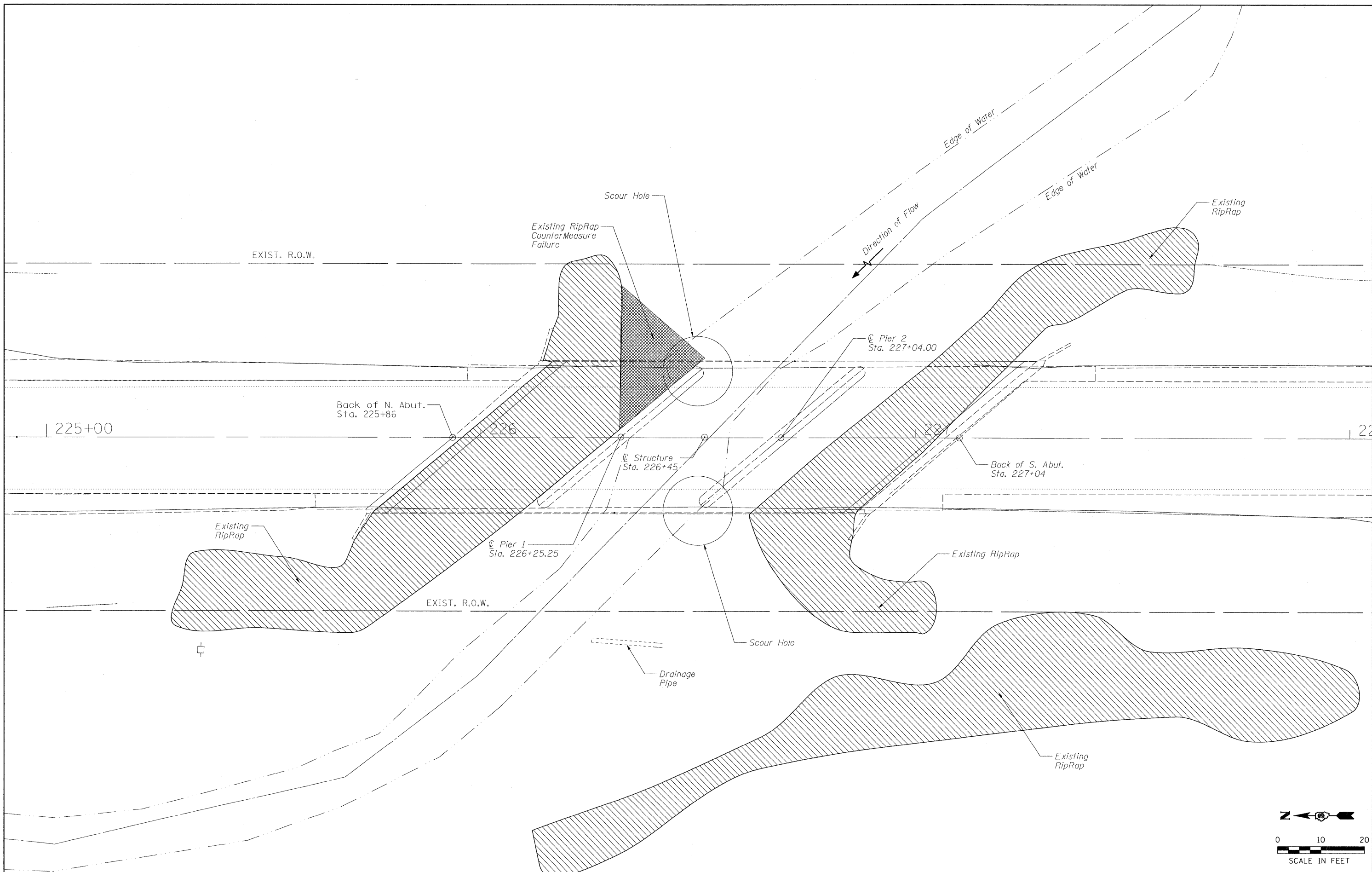

GREENE & BRAJFORD, INC.  
 OF SPRINGFIELD  
 CIVIL ENGINEERS  
 1001 W. WASHINGTON ST.  
 SPRINGFIELD, ILL. 62760  
 PHONE: 217/223-1111 FAX: 217/223-1112  
 WWW.GREENE-AND-BRAJFORD.COM

FILE NAME = J:\00227\W05\CADD\CADsheets\0366826-sh  
 USER NAME = frankv  
 -Ex.dgn  
 PLOT SCALE = 10.0000 1/4" = 1'-0"  
 PLOT DATE = 3/29/2010  
 G&B PROJECT:  
 PLOT DRIVER = Vbi\_T05700\_PS\_22x34.pltcfq

DESIGNED - GAMBILL	REVISED -
DRAWN - VERENSKI	REVISED -
CHECKED - BOTT	REVISED -
DATE - 2/23/10	REVISED -

**STATE OF ILLINOIS**  
**DEPARTMENT OF TRANSPORTATION**

**EXISTING SCOUR COUNTERMEASURES**  
**ILL. ROUTE 40 OVER COAL CREEK**

SCALE: SHEET NO. 1 OF 1 SHEETS STA. TO STA.

F.A.P. RTE. 646	SECTION (122BR-1) 1	COUNTY BUREAU	TOTAL SHEETS 16	SHEET NO. 5
CONTRACT NO. 66826				
FED. ROAD DIST. NO. ILLINOIS FED. AID PROJECT				

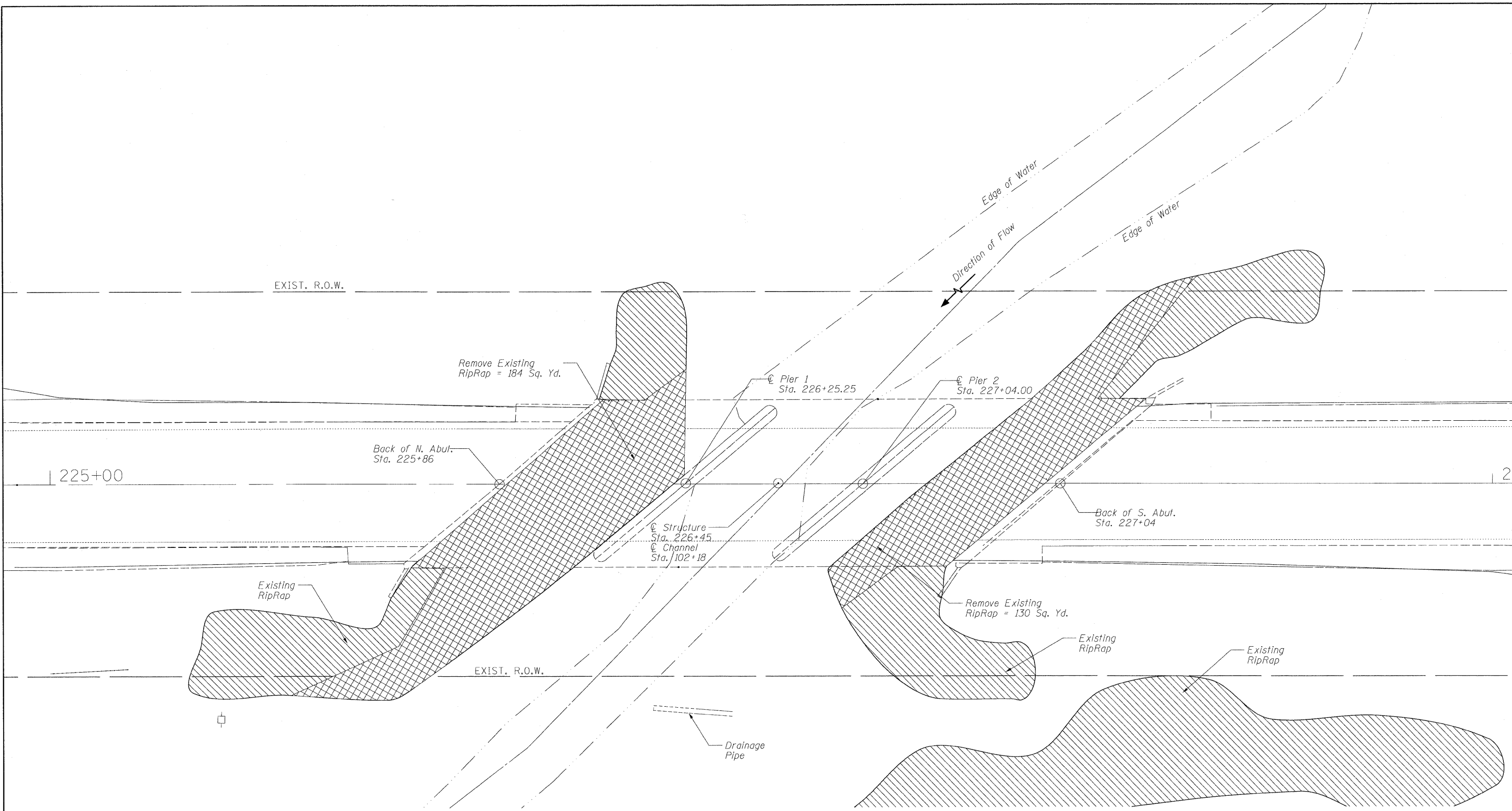

GREENE & BRADFORD, INC.  
 OF SPRINGFIELD  
 100 SOUTH MAIN STREET  
 SPRINGFIELD, ILLINOIS 62761  
 PHONE: (217) 223-1111 FAX: (217) 223-1112  
 WWW: WWW.GREENE-AND-BRADFORD.COM



FILE NAME = J:\08227\W05\CADD\CAD\sheets\0366826-sh-Removal.dgn  
 USER NAME = Frankv  
 DESIGNED - GAMBILL  
 DRAWN - VERENSKI  
 CHECKED - BOTT  
 PLOT DATE = 3/29/2010  
 DATE - 2/23/10  
 PLOT DRIVER = Vbl\_T05700\_PS\_22x34.pltcfgr

PLOT SCALE = 10.0000' / 1"

REVISED -  
 REVISED -  
 REVISED -  
 REVISED -

STATE OF ILLINOIS  
 DEPARTMENT OF TRANSPORTATION

EXISTING SCOUR COUNTERMEASURES REMOVAL  
 ILL. ROUTE 40 OVER COAL CREEK

SCALE: SHEET NO. 1 OF 1 SHEETS STA. TO STA.

F.A.P. RTE.	SECTION	COUNTY	TOTAL SHEETS	SHEET NO.
646	(122BR-1) I	BUREAU	16	6
CONTRACT NO. 66826				
FED. ROAD DIST. NO. ILLINOIS FED. AID PROJECT				

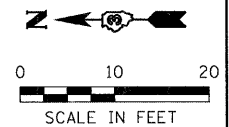

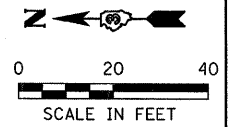
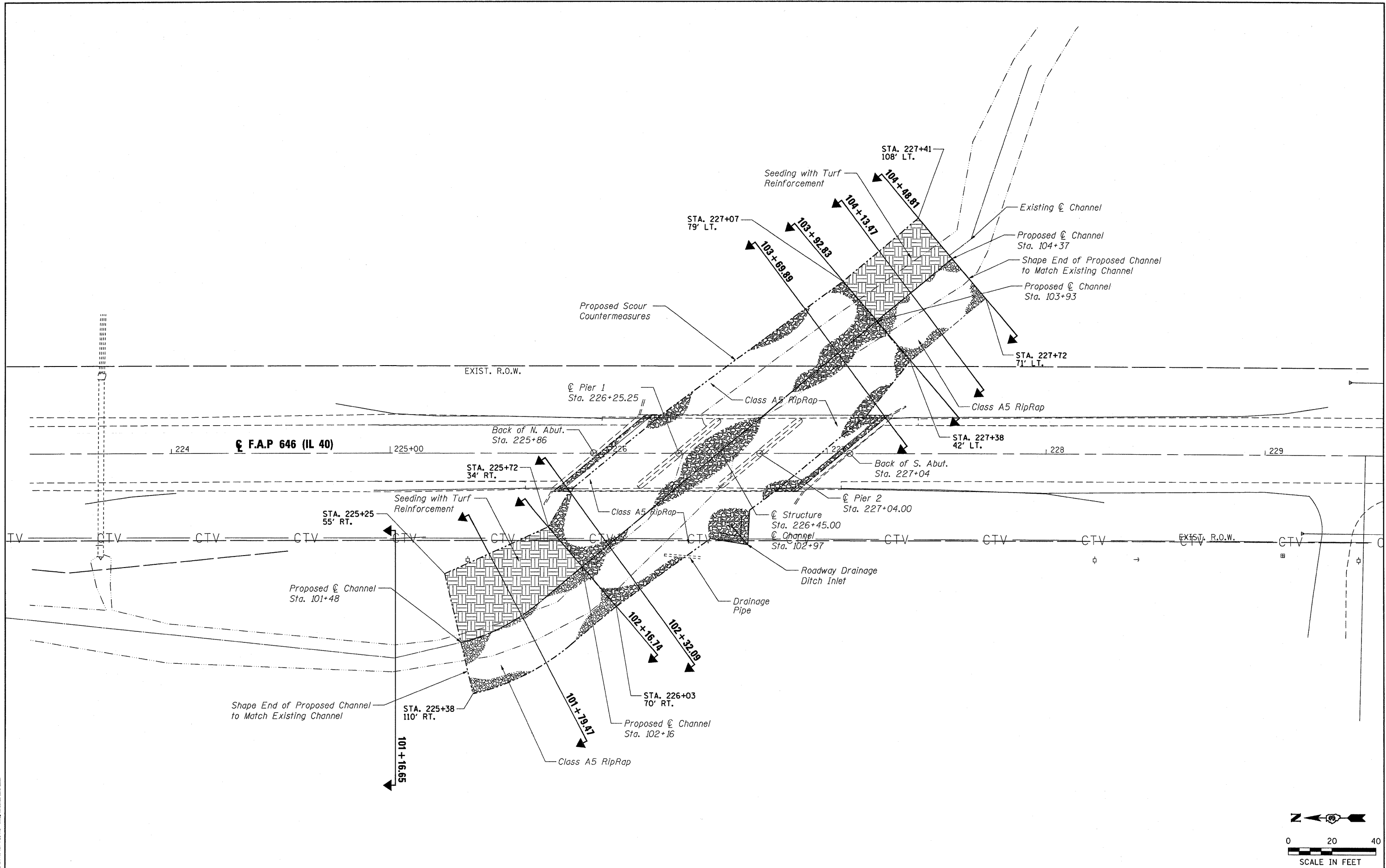

GREENE & BRADY, INC.  
 CONSULTING ENGINEERS  
 1000 W. WASHINGTON ST., SUITE 100  
 CHICAGO, ILLINOIS 60607  
 TEL: 312.467.1000 FAX: 312.467.1001  
 WWW.GREENE-AND-BRADY.COM

FILE NAME = G:\pwork\WIDOT\FERGUSONSA\dms59809\366826-sht-CM.Overview.dgn	USER NAME = fergusonsa	DESIGNED - GAMBILL	REVISED -	<b>STATE OF ILLINOIS</b> <b>DEPARTMENT OF TRANSPORTATION</b>	<b>PROPOSED SCOUR COUNTERMEASURES OVERVIEW</b> <b>ILL. ROUTE 40 OVER COAL CREEK</b>			F.A.P. RTE. 646	SECTION (122BR-1) I	COUNTY BUREAU	TOTAL SHEETS 16	SHEET NO. 7
	PLOT SCALE = 20,0000' / IN.	CHECKED - BOTT	DATE - 2/23/10		REVISED -	SCALE:	SHEET NO. 1 OF 1 SHEETS	STA. TO STA.	FED. ROAD DIST. NO. ILLINOIS FED. AID PROJECT			
G&B PROJECT: PLOT DRIVER = *PLOTTER*	PLOT DATE = Apr 09, 2010 - 10:58:26 AM	DATE - 2/23/10	REVISED -									CONTRACT NO. 66826

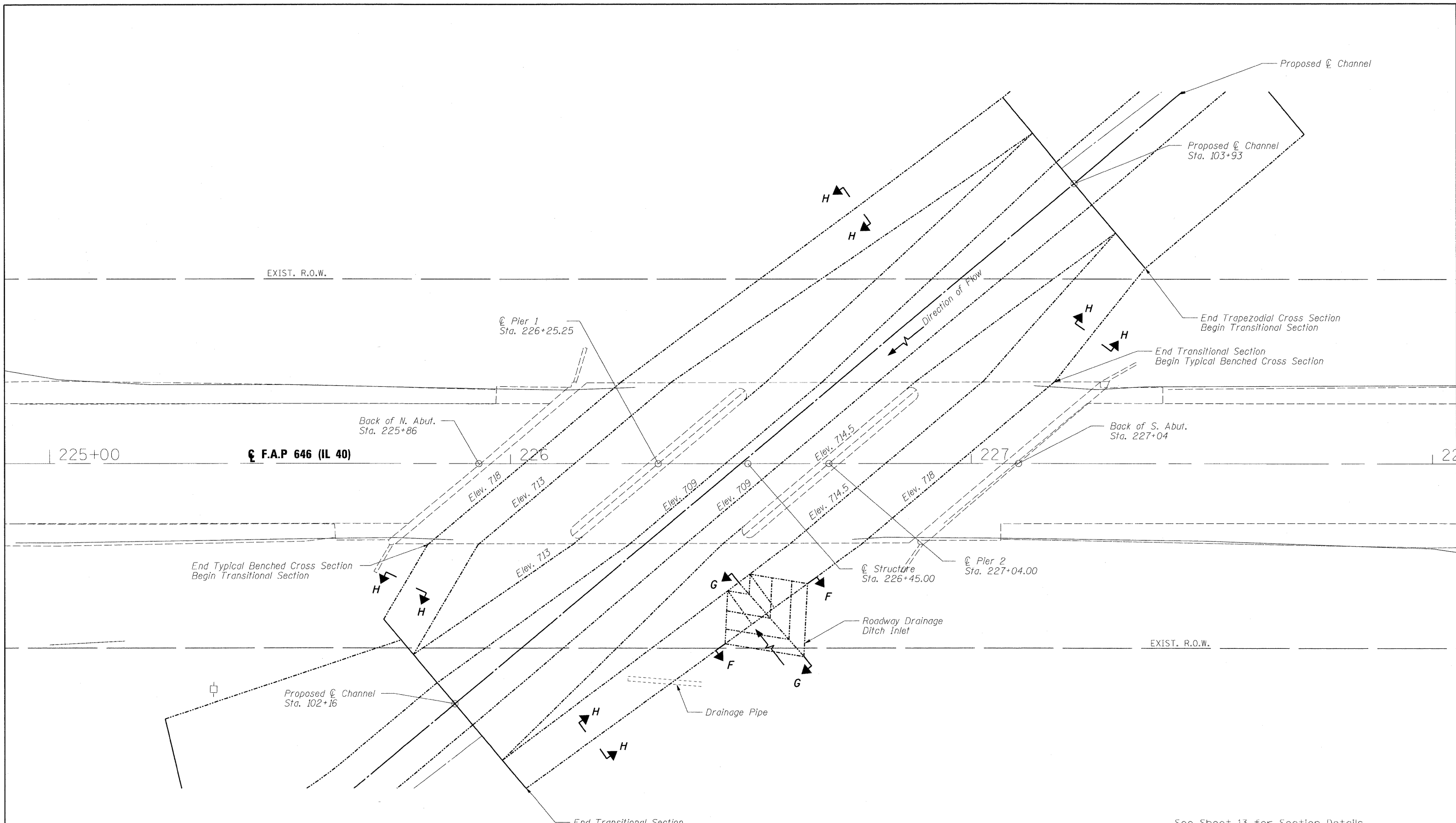

See Sheet 13 for Section Details

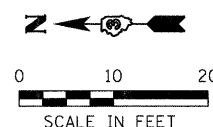

GREENE & BRADFORD, INC.  
 OF SPRINGFIELD  
 1000 N. WASHINGTON ST.  
 SPRINGFIELD, ILL. 62760  
 PHONE: (217) 223-1111  
 FAX: (217) 223-1112  
 WWW: WWW.GREENE-AND-BRADFORD.COM

FILE NAME = J:\08227\W05\CADD\CADsheets\0366826-sh  
 USER NAME = Frankv  
 CM\_Plan.dgn  
 PLOT SCALE = 10.0000' / 1" =  
 PLOT DATE = 3/29/2010  
 G&B PROJECT:  
 PLOT DRIVER = V81\_TDS700\_PS\_22x34.pltcf

DESIGNED - GAMBILL  
 DRAWN - VERENSKI  
 CHECKED - BOTT  
 DATE - 2/23/10

REVISED -  
 REVISED -  
 REVISED -  
 REVISED -

**STATE OF ILLINOIS**  
**DEPARTMENT OF TRANSPORTATION**

**PROPOSED SCOUR COUNTERMEASURES PARTIAL PLAN**  
**ILL. ROUTE 40 OVER COAL CREEK**

SCALE: SHEET NO. 1 OF 3 SHEETS STA. TO STA.

F.A.P. RTE. 646	SECTION (122BR-1) 1	COUNTY BUREAU	TOTAL SHEETS 16	SHEET NO. 8
CONTRACT NO. 66826				
FED. ROAD DIST. NO.		ILLINOIS FED. AID PROJECT		



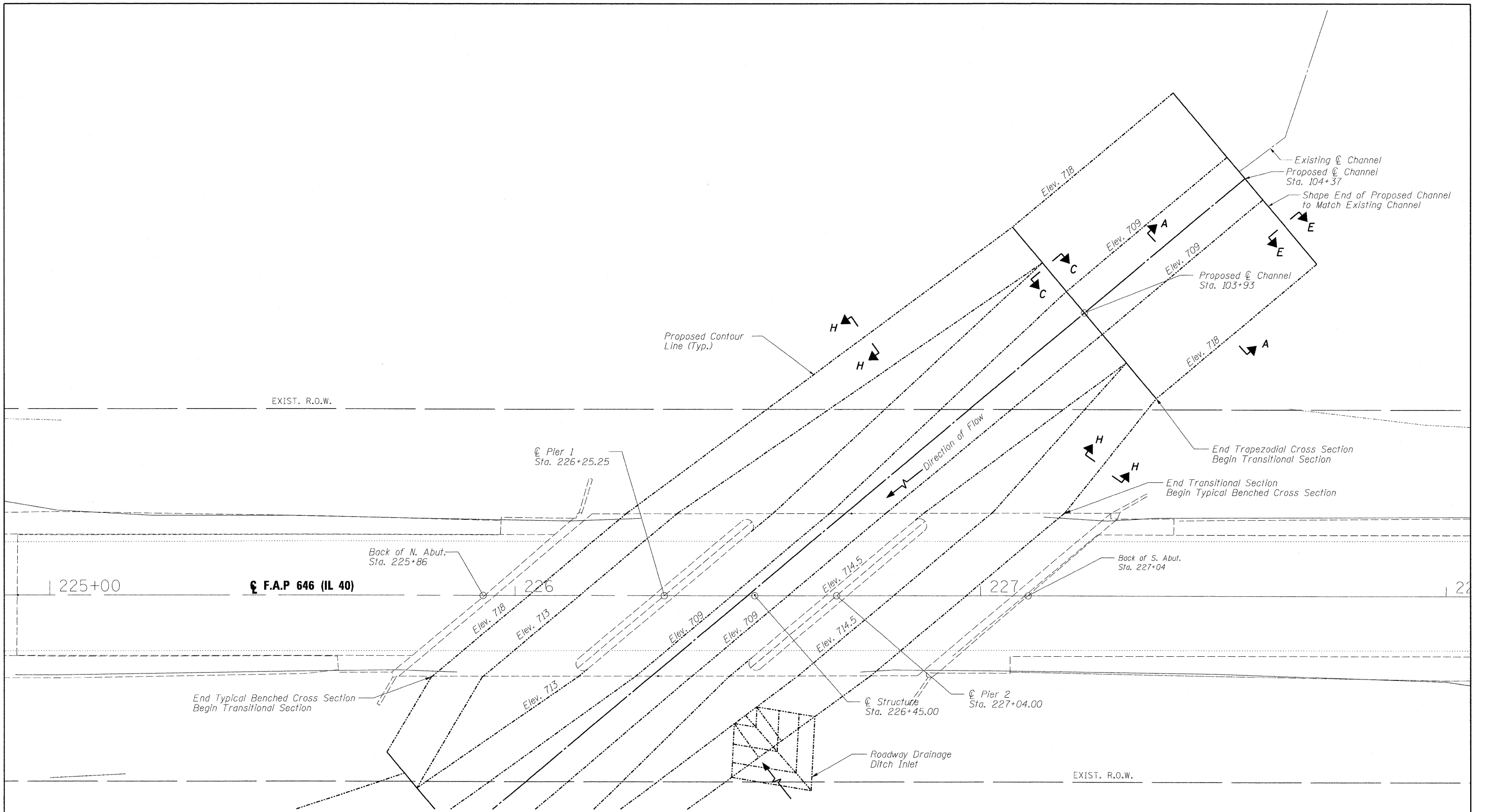

See Sheet 13 for Section Details

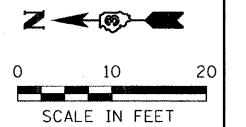

GREENE & BRADFORD, INC.  
 OF SPRINGFIELD  
 CIVIL ENGINEERS  
 1001 SOUTH MAIN STREET  
 SPRINGFIELD, ILLINOIS 62761  
 PHONE: 217/223-1111 FAX: 217/223-1112  
 WWW: WWW.GREENE-AND-BRADFORD.COM

FILE NAME =	USER NAME = Frankv	DESIGNED - GAMBILL	REVISED -
J:\08227\W05\CADD\CAD\shets\0366826-sh	CM.Plan.dgn	DRAWN - VERENSKI	REVISED -
	PLOT SCALE = 10.0000' / 1"	CHECKED - BOTT	REVISED -
G&B PROJECT:	PLOT DATE = 3/29/2010	DATE - 2/23/10	REVISED -
PLOT DRIVER = VB1_TDS700_PS_22x34.plt to f g			

**STATE OF ILLINOIS**  
**DEPARTMENT OF TRANSPORTATION**

**PROPOSED SCOUR COUNTERMEASURES PARTIAL PLAN**  
**ILL. ROUTE 40 OVER COAL CREEK**

SCALE:      SHEET NO. 2 OF 3 SHEETS      STA.      TO STA.

F.A.P. RTE.	SECTION	COUNTY	TOTAL SHEETS	SHEET NO.
646	(122BR-1) I	BUREAU	16	9
CONTRACT NO. 66826				
FED. ROAD DIST. NO.		ILLINOIS FED. AID PROJECT		

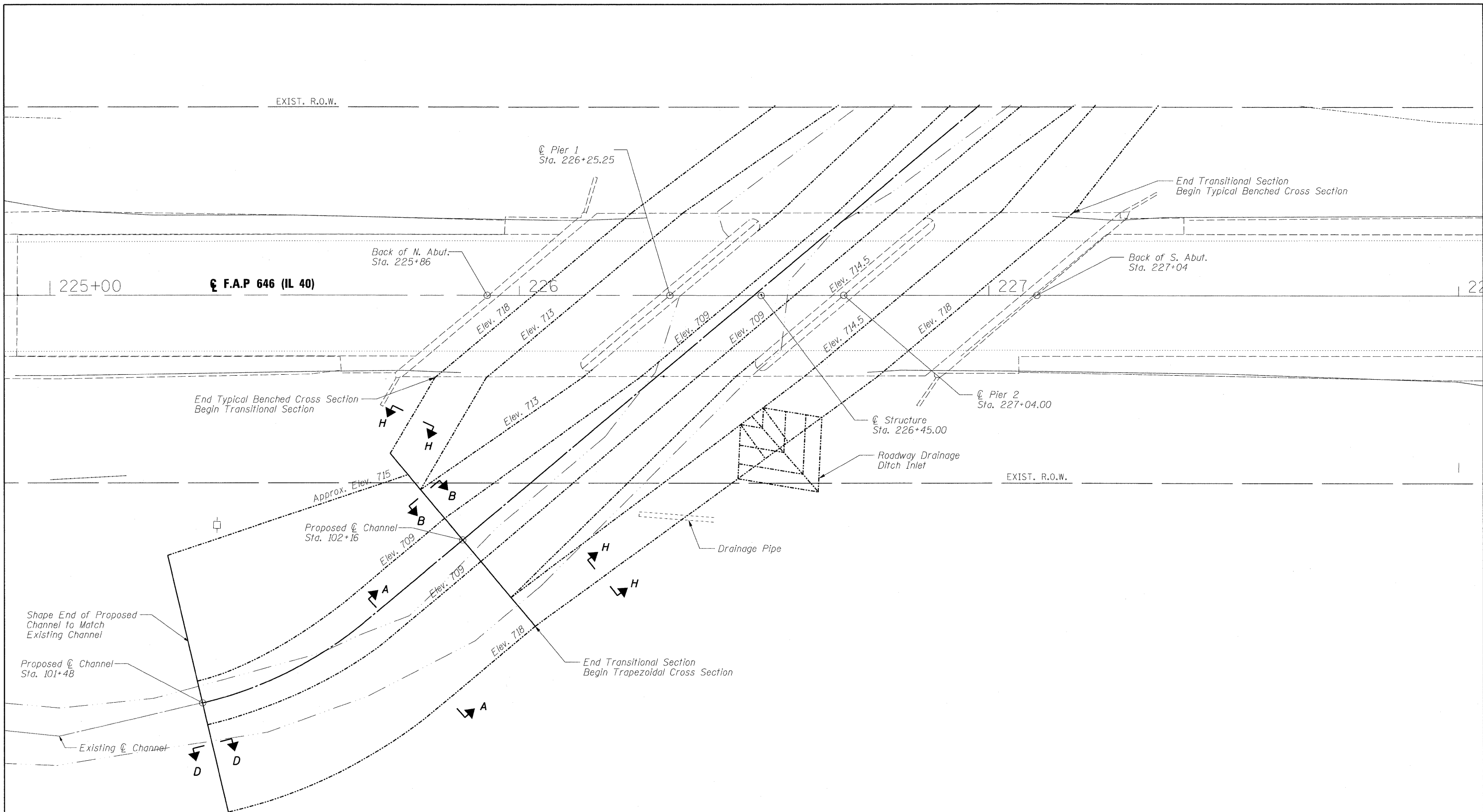

See Sheet 13 for Section Details

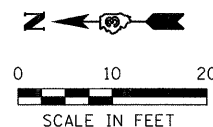

GREENE & BRAJFORD, INC.  
 OF SPRINGFIELD  
 CIVIL ENGINEERS  
 1001 N. UNIVERSITY AVENUE  
 SPRINGFIELD, ILLINOIS 62761  
 TEL: 217/223-1111 FAX: 217/223-1112  
 WWW.GRENEANDBRAJFORD.COM

FILE NAME = J:\00227\W05\CADD\CADsheets\0366826-sh-CM_Plan.dgn	USER NAME = Frankv	DESIGNED - GAMBILL	REVISED -
PLOT SCALE = 10.0000' / 1" =	CHECKED - BOTT	DRAWN - VERENSKI	REVISED -
PLOT DATE = 3/29/2010	DATE - 2/23/10		REVISED -

**STATE OF ILLINOIS**  
**DEPARTMENT OF TRANSPORTATION**

<b>PROPOSED SCOUR COUNTERMEASURES PARTIAL PLAN</b>			
<b>ILL. ROUTE 40 OVER COAL CREEK</b>			
SCALE:	SHEET NO. 3 OF 3 SHEETS	STA.	TO STA.

F.A.P. RTE. 646	SECTION (122BR-1) I	COUNTY BUREAU	TOTAL SHEETS 16	SHEET NO. 10
CONTRACT NO. 66826				
FED. ROAD DIST. NO. ILLINOIS FED. AID PROJECT				

PLOT DRIVER = V6L\_TDS700\_PS\_22x34.plt\Fg

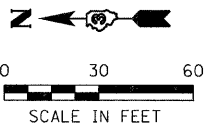
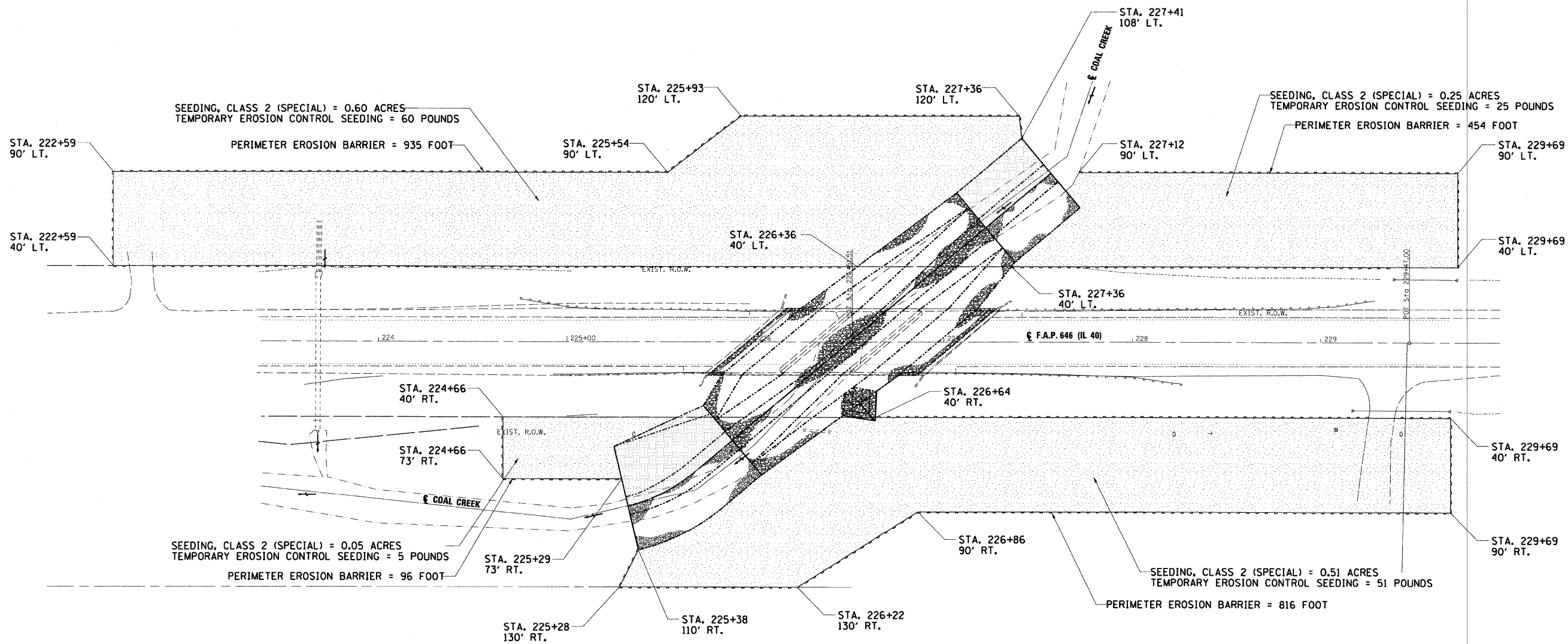

GREENE & BRADFORD, INC.  
 OF SPRINGFIELD  
 ENGINEERS, ARCHITECTS, PLANNERS  
 1000 W. WASHINGTON  
 SPRINGFIELD, ILLINOIS 62760  
 PHONE: 217/223-1100  
 FAX: 217/223-1101  
 WWW: WWW.GREENEANDBRADFORD.COM

FILE NAME = J:\0227\W05\CADD\CAD\sheets\0366826-sh-ECF.dgn  
 USER NAME = frankv  
 DESIGNED - GAMBILL  
 DRAWN - VERENSKI  
 CHECKED - BOTT  
 DATE - 2/23/09  
 PLOT SCALE = 30.0000' / 1" = 3000  
 PLOT DATE = 3/29/2010  
 G&B PROJECT:  
 PLOT DRIVER = V8i.TDS700.PS.22x34.plt of g

DESIGNED - GAMBILL	REVISED -
DRAWN - VERENSKI	REVISED -
CHECKED - BOTT	REVISED -
DATE - 2/23/09	REVISED -

**STATE OF ILLINOIS  
 DEPARTMENT OF TRANSPORTATION**

**EROSION CONTROL PLAN  
 ILL. ROUTE 40 OVER COAL CREEK**

SCALE: SHEET NO. 1 OF 1 SHEETS STA. TO STA.

F.A.P. RTE. 646	SECTION (122BR-1) 1	COUNTY BUREAU	TOTAL SHEETS 16	SHEET NO. 11
CONTRACT NO. 66826				
FED. ROAD DIST. NO. ILLINOIS FED. AID PROJECT				

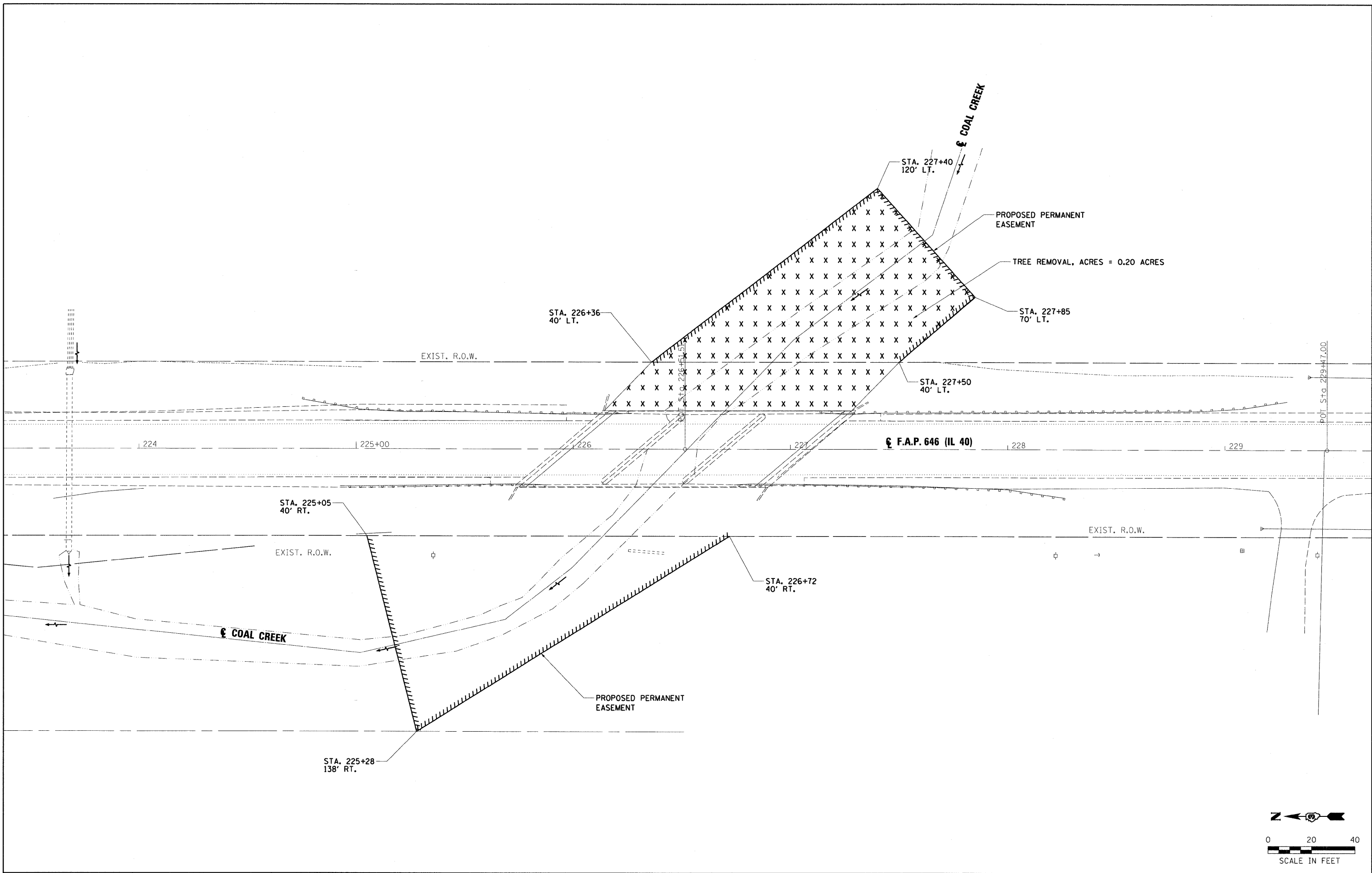

GREENE & BRADFORD, INC.  
 OF SPRINGFIELD  
 100 SOUTH MAIN STREET  
 SPRINGFIELD, ILLINOIS 62761  
 PHONE: 217-223-1111  
 FAX: 217-223-1112  
 WWW: WWW.G&B.COM

FILE NAME = J:\08227\W05\CADD\CADsheets\0366826-sh-TRP.dgn  
 G&B PROJECT: PLOT SCALE = 20.0000' / in.  
 PLOT DATE = 3/29/2010  
 PLOT DRIVER = VBi\_TDS700\_PS\_22x34.pltcf

USER NAME = Frankv	DESIGNED - GAMBILL	REVISED -
TRP.dgn	DRAWN - VERENSKI	REVISED -
PLOT SCALE = 20.0000' / in.	CHECKED - BOTT	REVISED -
PLOT DATE = 3/29/2010	DATE - 2/23/09	REVISED -

**STATE OF ILLINOIS  
 DEPARTMENT OF TRANSPORTATION**

<b>TREE REMOVAL PLAN</b>	
<b>ILL. ROUTE 40 OVER COAL CREEK</b>	
SCALE:	STATION TO STATION
SHEET NO. 1 OF 1 SHEETS	STA. TO STA.

F.A.P. RTE. 646	SECTION (122BR-1) 1	COUNTY BUREAU	TOTAL SHEETS 16	SHEET NO. 12
CONTRACT NO. 66826				
FED. ROAD DIST. NO. ILLINOIS FED. AID PROJECT				

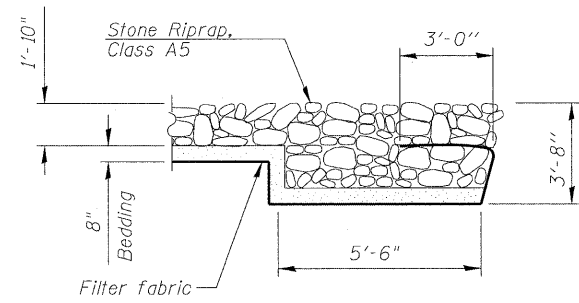

**SECTION B-B & D-D**

(Class A5 RipRap Downstream Flank)

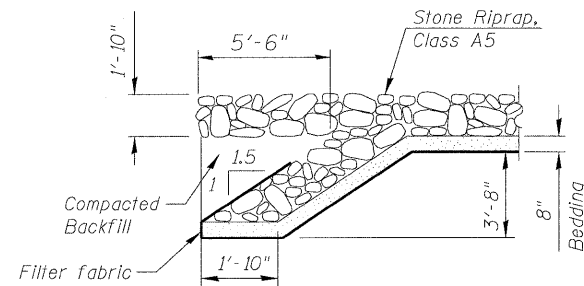

**SECTION C-C & E-E**

(Class A5 RipRap Upstream Flank)

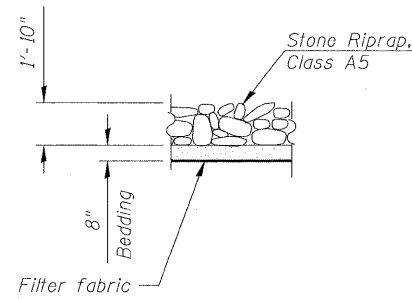

**SECTION G-G**

(Roadway Drainage Ditch Inlet)

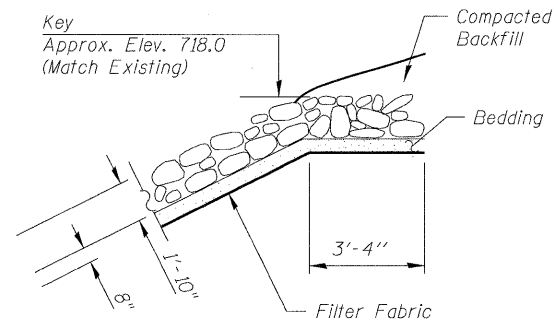

**SECTION H-H**

(Class A5 RipRap Key)

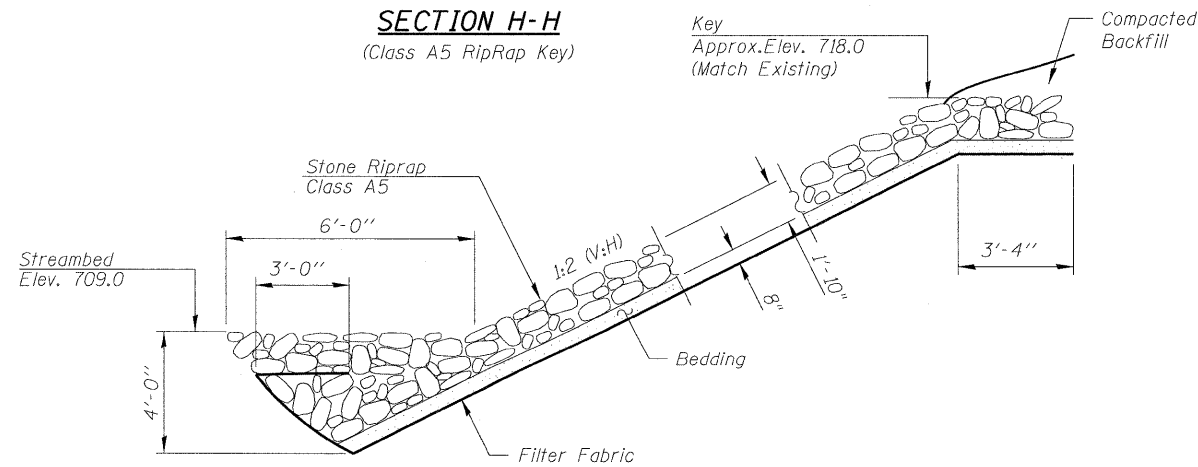

**SECTION A-A**

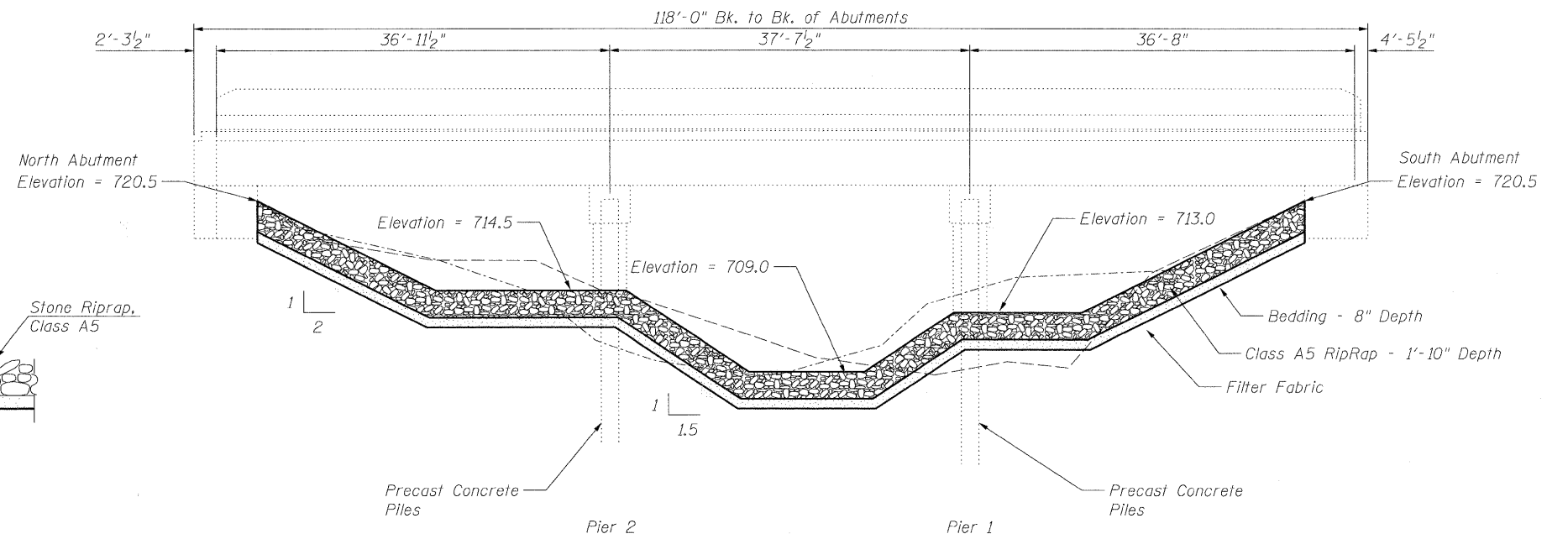

**SECTION**

(Typical Benched Cross Section within Structure)

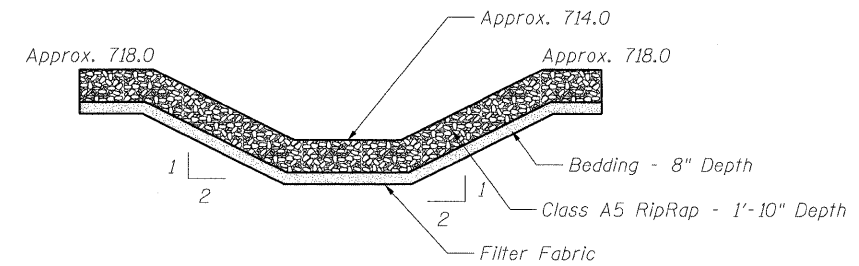

**SECTION F-F**

(Roadway Drainage Ditch Inlet)

GREENE & BRADFORD, INC.  
OF SPRINGFIELD

FILE NAME = J:\09227\W05\CADD\CADsheets\0366826-sh-1-1-Counter.dgn  
DRAWN - VERENSKI  
CHECKED - BOTT  
DATE - 2/23/10  
PLOT SCALE = 5/4,0000 1' = 1/4"  
PLOT DATE = 3/29/2010  
PLOT DRIVER = V81.T05700.PS.22x34.plt to f g

FILE NAME = J:\09227\W05\CADD\CADsheets\0366826-sh-1-1-Counter.dgn  
USER NAME = frankv  
DESIGNED - GAMBILL  
DRAWN - VERENSKI  
CHECKED - BOTT  
DATE - 2/23/10  
PLOT SCALE = 5/4,0000 1' = 1/4"  
PLOT DATE = 3/29/2010

DESIGNED - GAMBILL  
DRAWN - VERENSKI  
CHECKED - BOTT  
DATE - 2/23/10

REVISED -  
REVISED -  
REVISED -  
REVISED -

STATE OF ILLINOIS  
DEPARTMENT OF TRANSPORTATION

SCALE: SHEET NO. 1 OF 1 SHEETS STA. TO STA.

SCOUR COUNTERMEASURES DETAILS  
ILL. ROUTE 40 OVER COAL CREEK

F.A.P. RTE. 646 SECTION (122BR-1) I COUNTY BUREAU TOTAL SHEETS 16 SHEET NO. 13 CONTRACT NO. 66826

FED. ROAD DIST. NO. ILLINOIS FED. AID PROJECT

DATE \_\_\_\_\_  
 BY \_\_\_\_\_  
 SURVEYED \_\_\_\_\_  
 PLOTTED \_\_\_\_\_  
 NOTE BOOK \_\_\_\_\_  
 AREAS CHECKED \_\_\_\_\_  
 NO. \_\_\_\_\_

DATE \_\_\_\_\_  
 BY \_\_\_\_\_  
 SURVEYED \_\_\_\_\_  
 PLOTTED \_\_\_\_\_  
 NOTE BOOK \_\_\_\_\_  
 AREAS CHECKED \_\_\_\_\_  
 NO. \_\_\_\_\_

GREENE & BRADFORD, INC.  
 CONSULTING ENGINEERS  
 1000 N. WASHINGTON ST., SUITE 200  
 DECATUR, IL 62521  
 (618) 281-1111

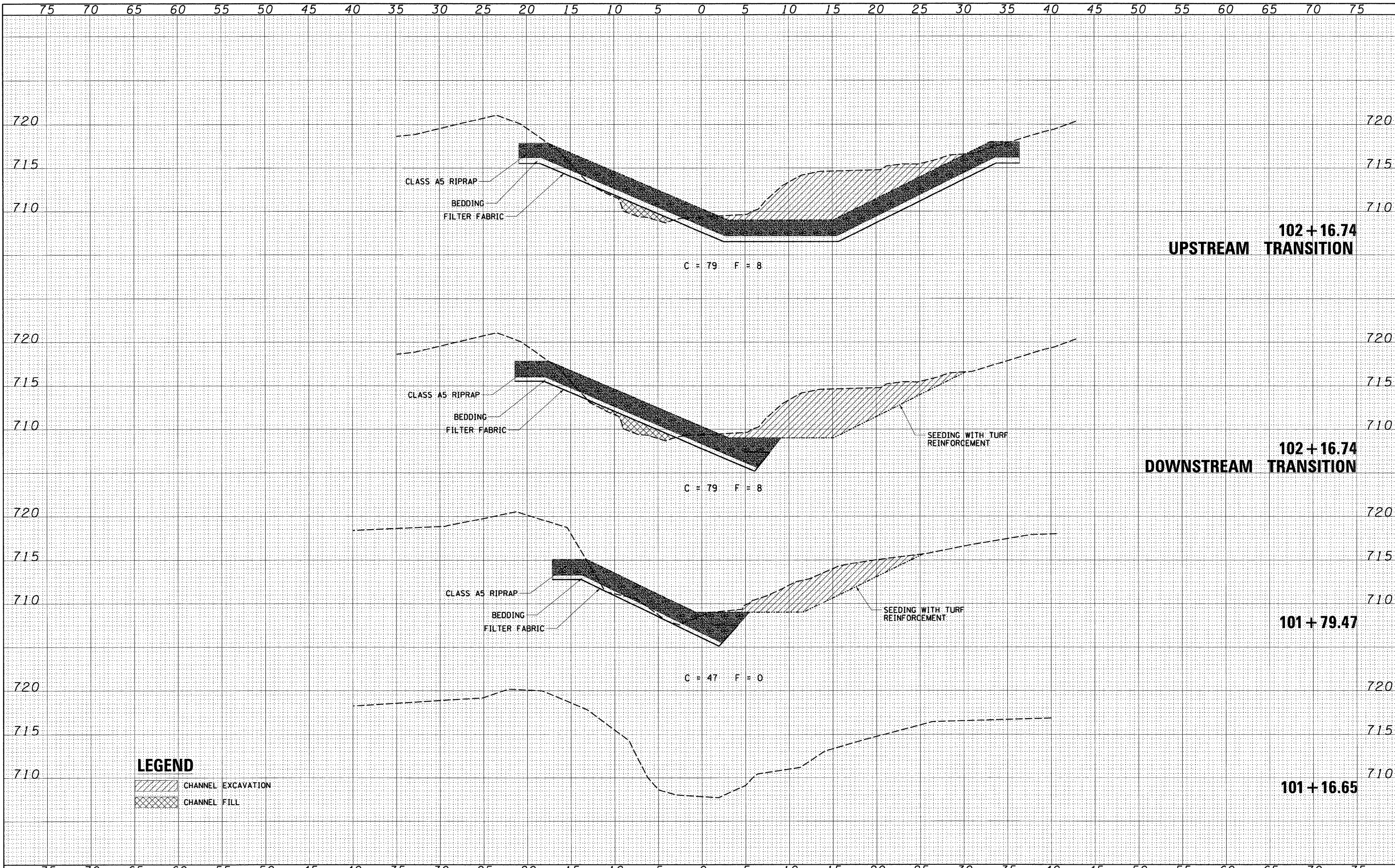

FILE NAME = J:\08227\W05\CADD\CAD\sheet\0366826-sht-xshyd.dgn	USER NAME = frankv	DESIGNED -	REVISED -	<b>STATE OF ILLINOIS DEPARTMENT OF TRANSPORTATION</b>	<b>HYDRAULIC CROSS SECTIONS</b>			F.A.P. RTE. 646	SECTION (122BR-1) I	COUNTY BUREAU	TOTAL SHEETS 16	SHEET NO. 14
G&B PROJECT:	PLOT SCALE = 5.0000' / in.	DRAWN -	REVISED -		SCALE: 5	SHEET NO. 1 OF 3 SHEETS	STA. 101+16.65 TO STA. 102+16.74	CONTRACT NO. 66826				
PLOT DRIVER = VB1.TDS700.PS.22x34.pltcfq	PLOT DATE = 3/29/2010	CHECKED -	REVISED -		FED. ROAD DIST. NO. [ILLINOIS] FED. AID PROJECT							
		DATE -	REVISED -									



DATE \_\_\_\_\_ BY \_\_\_\_\_  
 SURVEYED \_\_\_\_\_ PLOTTED \_\_\_\_\_  
 NOTE BOOK \_\_\_\_\_ DATE \_\_\_\_\_  
 AREAS CHECKED \_\_\_\_\_  
 NO. \_\_\_\_\_

DATE \_\_\_\_\_ BY \_\_\_\_\_  
 SURVEYED \_\_\_\_\_ PLOTTED \_\_\_\_\_  
 NOTE BOOK \_\_\_\_\_ DATE \_\_\_\_\_  
 AREAS CHECKED \_\_\_\_\_  
 NO. \_\_\_\_\_

GREENE & BRADFORD, INC.  
 OF SPRINGFIELD  
 1000 N. WASHINGTON ST.  
 SPRINGFIELD, IL 62760  
 (618) 261-1111 FAX (618) 261-1112  
 www.greenes.com

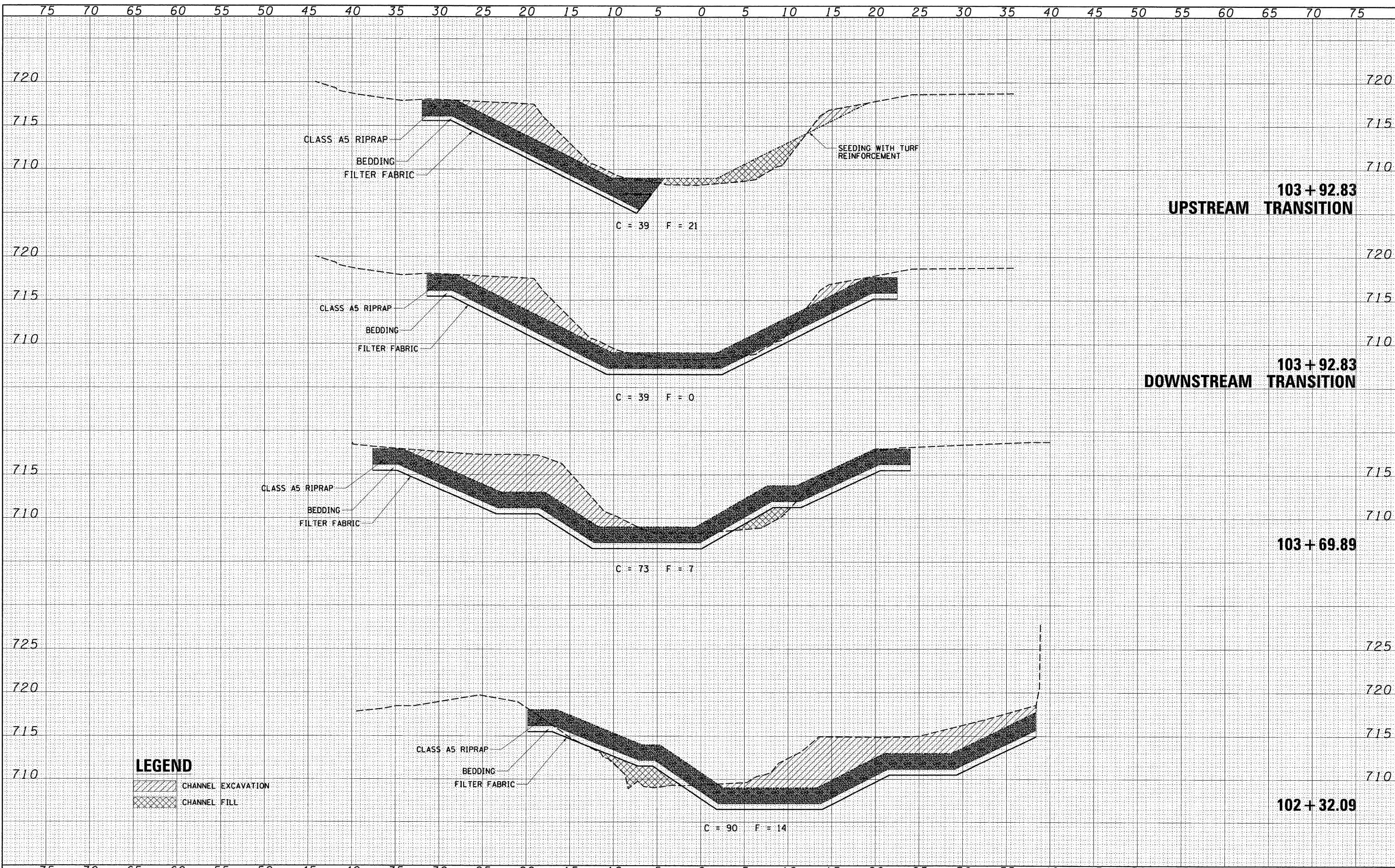

**LEGEND**  
 CHANNEL EXCAVATION  
 CHANNEL FILL

DATE \_\_\_\_\_ BY \_\_\_\_\_  
 SURVEYED \_\_\_\_\_ PLOTTED \_\_\_\_\_  
 ORIGINAL SURVEY NOTE BOOK NO. \_\_\_\_\_  
 AREAS CHECKED \_\_\_\_\_

DATE \_\_\_\_\_ BY \_\_\_\_\_  
 SURVEYED \_\_\_\_\_ PLOTTED \_\_\_\_\_  
 ORIGINAL SURVEY NOTE BOOK NO. \_\_\_\_\_  
 AREAS CHECKED \_\_\_\_\_

GREENE & BRADFORD, INC.  
 OF SPRINGFIELD  
 ENGINEERS AND ARCHITECTS  
 1001 N. WASHINGTON ST., SPRINGFIELD, ILL. 62761  
 TEL: 217/223-1111 FAX: 217/223-1112

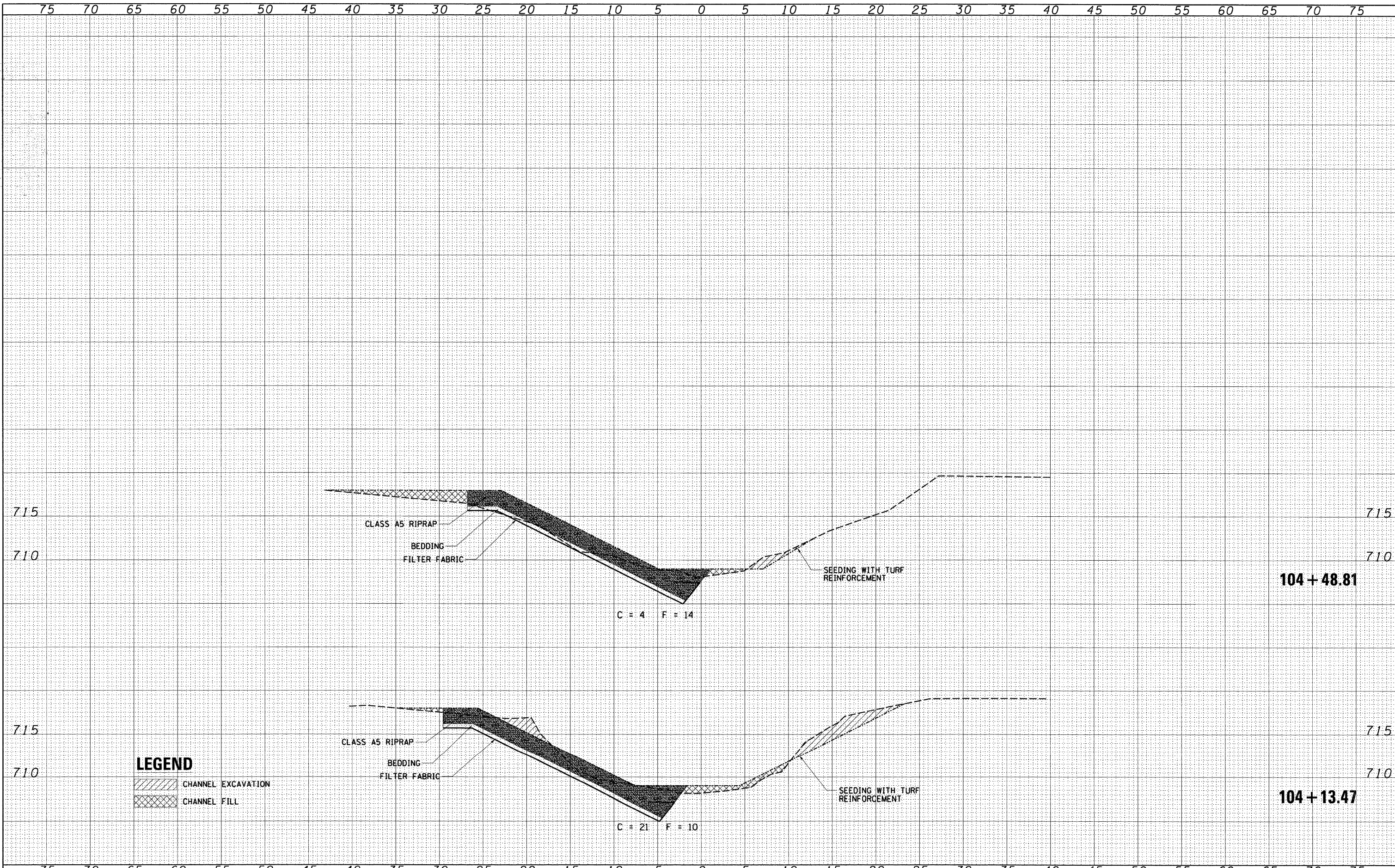

**LEGEND**  
 CHANNEL EXCAVATION  
 CHANNEL FILL

FILE NAME = J:\08227\W05\CADD\CAD\sheets\0366826-sht-xschydgn	USER NAME = frankv	DESIGNED -	REVISED -	<b>STATE OF ILLINOIS DEPARTMENT OF TRANSPORTATION</b>	<b>HYDRAULIC CROSS SECTIONS</b>			F.A.P. RTE. 646	SECTION (122BR-1) I	COUNTY BUREAU	TOTAL SHEETS 16	SHEET NO. 16
G&B PROJECT:	PLOT SCALE = 5,0000' / 1"	DRAWN -	REVISED -		SCALE: 5	SHEET NO. 3 OF 3 SHEETS	STA. 104+48.81 TO STA. 104+48.81	CONTRACT NO. 66826				
PLOT DRIVER = V81.TDS700.P5.22x34.plt\Fg	PLOT DATE = 3/29/2018	CHECKED -	REVISED -		FED. ROAD DIST. NO. ILLINOIS FED. AID PROJECT							
		DATE -	REVISED -									