

F.A.I. RTE.	SECTION	COUNTY	TOTAL SHEETS	SHEET NO.
80	*	BUREAU	12	1
		ILLINOIS	CONTRACT NO. 66A33	

*D3 PATCHING 2011-4 & INTERMITTENT RS 2011-1

D-93-054-10

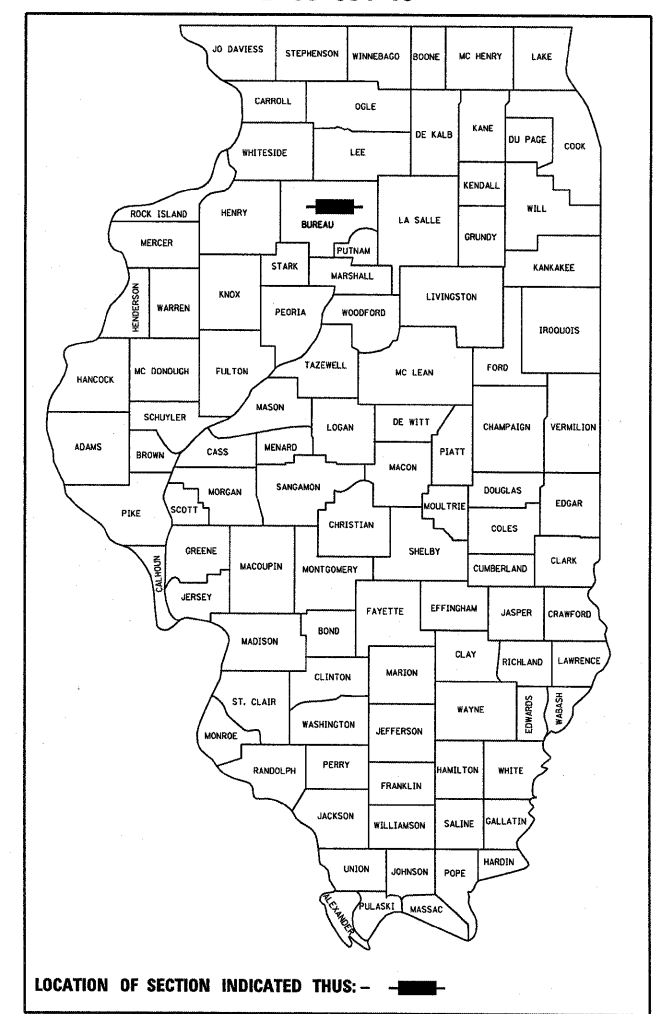

FUNCTIONAL CLASSIFICATION
 RURAL - INTERSTATE
 FAI RTE. 80 (I-80)
 2009 ADT 19,900
 P.V 58.8% M.U. 37.2% S.U. 4.0%

STATE OF ILLINOIS
 DEPARTMENT OF TRANSPORTATION
 DIVISION OF HIGHWAYS

SUBMITTED May 7 2010
George Raymond
 DEPUTY DIRECTOR OF HIGHWAYS, REGION ENGINEER

June 25 2010
Scott E. Stitt P.E. I.E.
 acting ENGINEER OF DESIGN AND ENVIRONMENT

June 25 2010
Christine M. Reed/ea
 DIRECTOR OF HIGHWAYS, CHIEF ENGINEER

PRINTED BY THE AUTHORITY
 OF THE STATE OF ILLINOIS

STATE OF ILLINOIS
 DEPARTMENT OF TRANSPORTATION
 DIVISION OF HIGHWAYS

**PROPOSED
 HIGHWAY PLANS**

FAI ROUTE 80 (I-80)
 SECTION D3 PATCHING 2011-4 &
 RS 2011-1

PROJECT
 PAVEMENT PATCHING & INTERMITTENT RESURFACING
 BUREAU COUNTY
 C-93-118-10

INDEX OF SHEETS

1. COVER SHEET
2. GENERAL NOTES
3. SUMMARY OF QUANTITIES
4. TYPICAL SECTION
- 5.-9. SCHEDULES
- 10.-12. DETAILS

STANDARDS

- | | |
|-----------|---|
| 000001-05 | STANDARD SYMBOLS, ABBREVIATIONS AND PATTERNS |
| 001001-02 | AREAS OF REINFORCEMENT BARS |
| 001006 | DECIMAL OF AN INCH AND OF A FOOT |
| 420001-07 | PAVEMENT JOINTS |
| 420601-05 | 24' (7.2 m) PCC PAVEMENT |
| 420701-02 | PAVEMENT FABRIC |
| 442101-07 | CLASS B PATCHES |
| 701101-02 | OFF-ROAD OPERATIONS MULTILANE, 15' (4.5 m) TO 24" (600 mm) FROM PAVEMENT EDGE |
| 701106-02 | OFF-ROAD OPERATIONS, MULTILANE, MORE THAN 15' (4.5 m) AWAY |
| 701401-05 | LANE CLOSURE, FREEWAY/EXPRESSWAY |
| 701411-06 | LANE CLOSURE, MULTILANE, AT ENTRANCE OR EXIT RAMP FOR SPEEDS **e** 45 MPH |
| 701426-03 | LANE CLOSURE, MULTILANE INTERMITTENT OR MOVING OPERATION, FOR SPEEDS **e** 45 MPH |
| 701901-01 | TRAFFIC CONTROL DEVICES |
| 780001-02 | TYPICAL PAVEMENT MARKINGS |

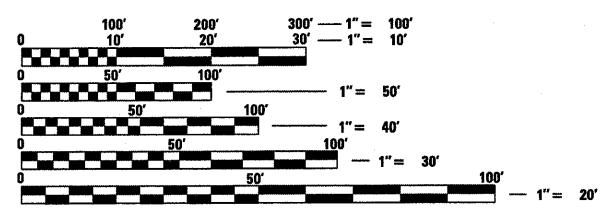
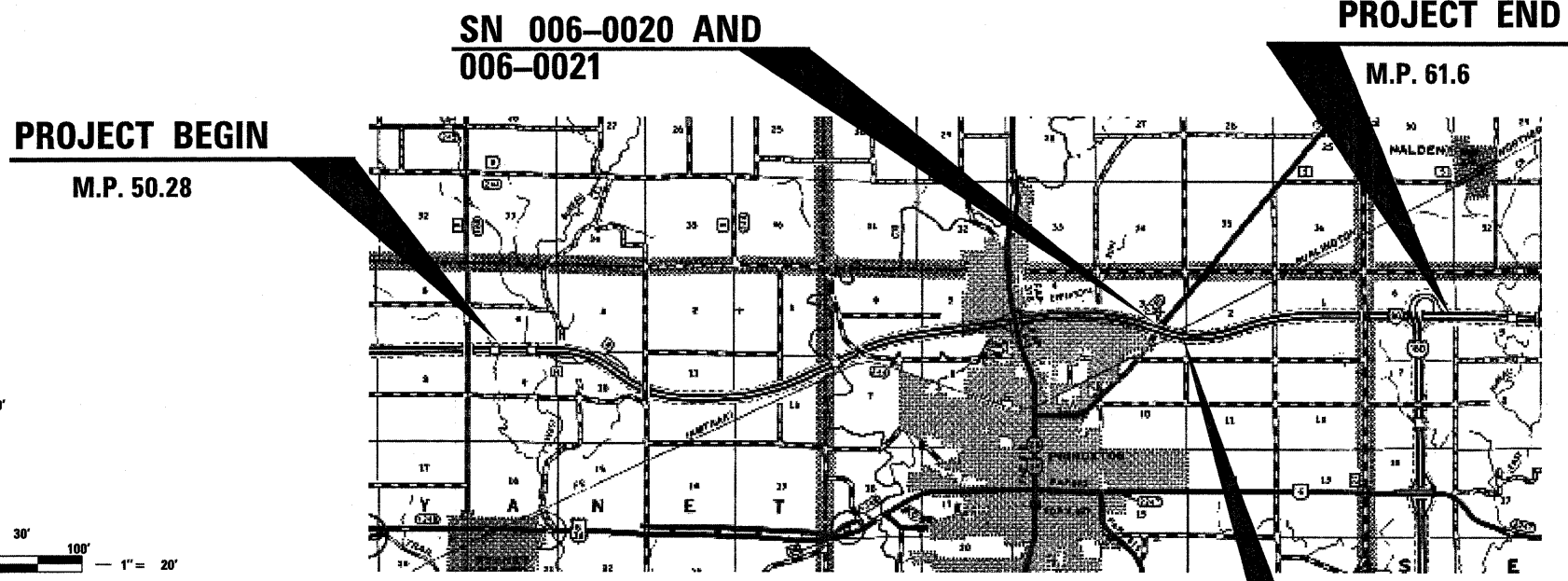

FULL SIZE PLANS HAVE BEEN PREPARED USING STANDARD ENGINEERING SCALES. REDUCED SIZED PLANS WILL NOT CONFORM TO STANDARD SCALES. IN MAKING MEASUREMENTS ON REDUCED PLANS, THE ABOVE SCALES MAY BE USED.

J.U.L.I.E.
 JOINT UTILITY LOCATION INFORMATION FOR EXCAVATION
 1-800-892-0123
 OR 811

PROJECT ENGINEER: JOE KANNEL
 UNIT CHIEF: PAT BRABOY/RON WOODSHANK
 TOWNSHIP: PRINCETON, SELBY
 CONTRACT NO. 66A33

GROSS LENGTH = 59,769.6 FT. = 11.32 MILE
 NET LENGTH = 19,324 FT. = 3.66 MILE

SN 006-0022 AND
 006-0023

GENERAL NOTES
(Revised October 5, 2006)

THE THICKNESS OF HMA SHOWN ON THE PLANS IS THE NOMINAL THICKNESS. DEVIATIONS FROM THE NOMINAL THICKNESS WILL BE PERMITTED WHEN SUCH DEVIATIONS OCCUR DUE TO IRREGULARITIES IN THE EXISTING SURFACE OR BASE ON WHICH THE HMA IS PLACED.

THE ENGINEER WILL BE THE SOLE JUDGE CONCERNING CURING TIME FOR THE VARIOUS HMA LIFTS.

SHORT TERM PAVEMENT MARKING SHALL BE USED TO OUTLINE EXIT AND ENTRANCE RAMPS FOR THE PRIME COAT APPLICATION AND EACH RESURFACING LIFT.

ON EXISTING PAVEMENT WHICH MAY BE SUPERELEVATED, THE NEW HMA PAVEMENT SHALL BE BUILT WITH THE SAME SUPERELEVATION UNLESS NEW SUPERELEVATION RATES ARE GIVEN ON THE PLANS.

ABANDONED UNDERGROUND UTILITIES THAT CONFLICT WITH CONSTRUCTION SHALL BE DISPOSED OF OUTSIDE THE LIMITS OF THE RIGHT OF WAY ACCORDING TO ARTICLE 202.03 OF THE STANDARD SPECIFICATIONS AND AS DIRECTED BY THE ENGINEER. THIS WORK WILL NOT BE PAID FOR SEPARATELY, BUT SHALL BE INCLUDED IN THE COST OF EARTH EXCAVATION.

ANY REFERENCE TO A STANDARD IN THESE PLANS SHALL BE INTERPRETED TO MEAN THE EDITION AS INDICATED BY THE SUBNUMBER SHOWN IN THE LIST OF STANDARDS OR THE COPY INCLUDED IN THESE PLANS.

THE FOLLOWING RATES OF APPLICATION HAVE BEEN USED IN CALCULATING PLAN QUANTITIES:

GRANULAR MATERIALS	2.05	TONS / CU YD
BIT MATERIALS (PRIME COAT) ON AGGREGATE BASES	0.375	GAL / SQ YD
BITUMINOUS MATERIALS (PRIME COAT)	0.08	GAL / SQ YD
FOR ADDITIONAL HMA LIFTS "FOG COAT"	0.05	GAL / SQ YD
AGGREGATE PRIME COAT	0.002	TONS / SQ YD
HMA RESURFACING	112	LBS / SQ YD / IN
SHORT TERM PAVEMENT MARKING	10	FT /100 FT OF APPLICATION
MIX FOR CRACKS, JTS & FLGWYS	0.0003	TONS / SQ YD
LEVEL BINDER (HAND METHOD)	0.0005	TONS / SQ YD

SATISFACTION OF THE DEPARTMENT AT THE CONTRACTOR'S EXPENSE. THIS SHALL INCLUDE ALL TEMPORARY REPAIRS REQUIRED TO KEEP THE FACILITY OPERATIONAL WHILE MATERIAL IS BEING OBTAINED TO MAKE PERMANENT REPAIRS. SPLICING OF ELECTRIC CABLE SHALL NOT BE ALLOWED. ELECTRIC CABLE SHALL BE REPLACED FROM POLE TO POLE OR CONTROLLER.

COMMITMENTS:

1. ENVIRONMENTAL COORDINATION
2. STRUCTURAL STATUS FORM

DATE: _____

PREPARED BY: David Bevil
ACTING DISTRICT STUDIES & PLANS ENGINEER

EXAMINED BY: Herb Jung
DISTRICT CONSTRUCTION ENGINEER

Wayne P. Billips
DISTRICT MATERIALS ENGINEER

James A. Hucker
DISTRICT OPERATIONS ENGINEER

FILE NAME =	USER NAME = bergantinoja	DESIGNED - RON WOODSHANK	REVISED -	STATE OF ILLINOIS DEPARTMENT OF TRANSPORTATION	GENERAL NOTES	F.A.I. RTE.	SECTION	COUNTY	TOTAL SHEETS	SHEET NO.	
es:\pw\work\PIWIDOT\BERGANTINOJA\0143178	D366A33-details.dgn	DRAWN - RON WOODSHANK	REVISED -			80	.	BUREAU	12	2	
	PLOT SCALE = 50.0000' / IN.	CHECKED -	REVISED -			CONTRACT NO. 66A33					
	PLOT DATE = May 04, 2010 - 02:47:15 PM	DATE -	REVISED -			SCALE: _____	SHEET NO. 1 OF 1 SHEETS	STA. _____	TO STA. _____	ILLINOIS	

SUMMARY OF QUANTITIES				100% STATE	100% STATE	100% STATE	
FUND CODE TYPE:				L01E	07A0	L01E	L01E
CONSTRUCTION CODE TYPE:				I000	I000	X271-2A	X171-2A
CODE NO.	ITEM	UNIT	TOTAL QUANTITY	ROADWAY	ROADWAY	BRIDGE SN 006-0020 SN 006-0021	BRIDGE SN 006-0022 SN 006-0023
40600100	BITUMINOUS MATERIALS (PRIME COAT)	GALLON	3853	3853			
40600400	MIXTURE FOR CRACKS, JOINTS, AND FLANGEWAYS	TON	9	9			
40600745	POLYMERIZED LEVELING BINDER (HAND METHOD), N90	TON	15	15			
40600895	CONSTRUCTING TEST STRIP	EACH	1	1			
40603240	POLYMERIZED HOT-MIX ASPHALT BINDER COURSE, IL-19.0, N90	TON	2514	2514			
40603545	POLYMERIZED HOT-MIX ASPHALT SURFACE COURSE, MIX "D", N90	TON	3083	2849		98	136
44000155	HOT-MIX ASPHALT SURFACE REMOVAL, 1 1/2"	SQ YD	2777			1164	1613
44000157	HOT-MIX ASPHALT SURFACE REMOVAL, 2"	SQ YD	7990	7990			
44000165	HOT-MIX ASPHALT SURFACE REMOVAL, 4"	SQ YD	19951	19951			
44000169	HOT-MIX ASPHALT SURFACE REMOVAL, 5"	SQ YD	600	600			
44201019	CLASS B PATCHES, TYPE II, 14 INCH	SQ YD	200		200		
44201023	CLASS B PATCHES, TYPE III, 14 INCH	SQ YD	52		52		
44201025	CLASS B PATCHES, TYPE IV, 14 INCH	SQ YD	473		473		
X4420114	CLASS B PATCHES, TYPE II, 14 INCH, SPECIAL	SQ YD	298		298		
X4421025	CLASS B PATCHES, TYPE IV, 14 INCH, SPECIAL	SQ YD	93		93		
44213100	PAVEMENT FABRIC	SQ YD	1235		1235		
44213200	SAW CUTS	FOOT	4340		4340		
48203017	HOT-MIX ASPHALT SHOULDERS, 5"	SQ YD	600	600			
67100100	MOBILIZATION	L SUM	1	1			
70100420	TRAFFIC CONTROL AND PROTECTION, STANDARD 701411	EACH	8	8			
70103815	TRAFFIC CONTROL SURVEILLANCE	CAL DA	14	14			
70300100	SHORT-TERM PAVEMENT MARKING	FOOT	1410	1410			
70301000	WORK ZONE PAVEMENT MARKING REMOVAL	SQ FT	465	465			
* 78005110	EPOXY PAVEMENT MARKING - LINE 4"	FOOT	183778	183058	720		
78300200	RAISED REFLECTIVE PAVEMENT MARKER REMOVAL	EACH	176	176			
X0326880	MESSAGE BOARD VEHICLE DRIVER	HOUR	25	25			
* X0326725	WET REFLECTIVE PREFORMED PLASTIC PAVEMENT MARKINGS-LINE 6"	FOOT	3728	3524	204		
X7010805	TRAFFIC CONTROL AND PROTECTION, STANDARD 701401 (SPECIAL)	LSUM	1	1			
Z0017202	DOWEL BARS 1 1/2"	EACH	1480		1480		
Z0016200	DECK SLAB REPAIR (PARTIAL)	SQ YD	80			40	40
Z0075310	TIE BARS 3/4"	EACH	212		212		
X0326867	RADAR SPEED TRAILER	CAL MO	1	1			
X0326907	PORTABLE, VEHICLE MOUNTED, CHANGEABLE MESSAGE SIGN	CAL MO	1	1			

* SPECIALTY ITEMS

DESIGNED - RON WOODSHANK	REVISED -	STATE OF ILLINOIS DEPARTMENT OF TRANSPORTATION	SUMMARY OF QUANTITIES	F.A.I. RTE. 80	SECTION •	COUNTY	TOTAL SHEETS 12	SHEET NO. 3
DRAWN - RON WOODSHANK	REVISED -			BUREAU		CONTRACT NO. 66A33		
CHECKED -	REVISED -			ILLINOIS				
DATE -	REVISED -	SCALE: _____	SHEET NO. 1 OF 1 SHEETS	STA. _____	TO STA. _____			

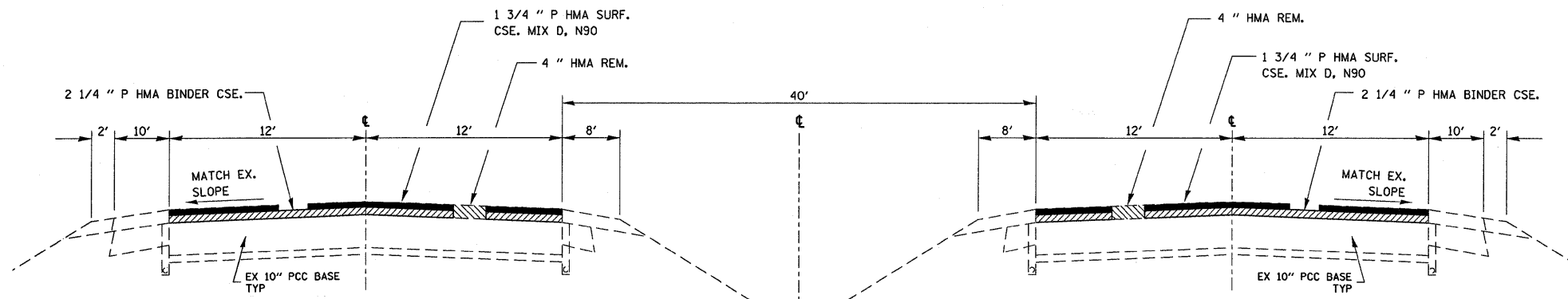

WEST BOUND

TYPICAL SECTION*

MILE MARKER 50.28 TO 50.81 EBL & WBL
 MILE MARKER 57.99 TO 58.73 EBL
 MILE MARKER 58.1 TO 58.7 WBL

EAST BOUND

*MILL AND RESURFACE THROUGH SN 006-0020,
 006-0021, 006-0022, AND 006-0023. MILL DEPTH
 AND RESURFACING THICKNESS SHALL BE 1 1/2"

MIX DESIGN					
MIX	PG GRADE	DESIGN AIR VOIDS	MIX COMPOSITION	FRICTION AGG	DENSITY CONTROL
POLYMERIZED HMA SURFACE	SBS/PG 70-22	4.0% @N90	IL 12.5 or IL 9.5	MIXTURE D	CORES
POLYMERIZED HMA BINDER	SBS/PG 70-22	4.0% @N90	IL 19.0		CORES

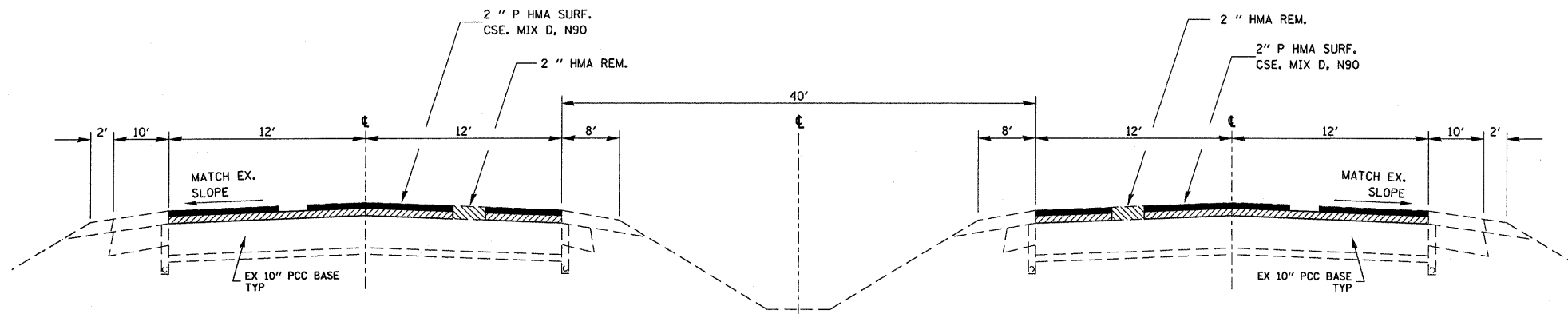

WEST BOUND

TYPICAL SECTION

MILE MARKER 50.81 TO 57.99 EBL
 MILE MARKER 58.73 TO 61.60 EBL
 MILE MARKER 50.81 TO 58.05 WBL
 MILE MARKER 58.70 TO 61.60 WBL

EAST BOUND

FILE NAME =	USER NAME = bergantino.ja	DESIGNED - RON WOODSHANK	REVISED -	STATE OF ILLINOIS DEPARTMENT OF TRANSPORTATION	TYPICAL SECTION	F.A.I. RTE.	SECTION	COUNTY	TOTAL SHEETS	SHEET NO.	
es:\pwwork\VPWIDOT\BERGANTINO.JA\d0143170	D366A33-details.dgn	DRAWN - RON WOODSHANK	REVISED -			80	.	BUREAU	12	4	
	PLOT SCALE = 50.0054' / IN.	CHECKED -	REVISED -			CONTRACT NO. 66A33					
	PLOT DATE = May 04, 2010 - 02:50:16 PM	DATE -	REVISED -			SCALE: _____	SHEET NO. 1 OF 1 SHEETS	STA. _____ TO STA. _____	ILLINOIS		

MAINLINE SCHEDULE												
LOCATION MILE MARKERS		LANE	HOT-MIX ASPH. SURF. REM 1 1/2"*	HOT-MIX ASPH. SURF. REM 2"	HOT-MIX ASPH. SURF. REM 4"(1)	POLY. HOT-MIX ASPH. SURF. MIX D N90**	POLY. HOT-MIX ASPH. BINDER IL-19.0 N90	BIT MATL PR CT	MIX FOR CR, JTS, & FLANGEWAYS	LEVEL BINDER (HM)		
		DL/PL	SQ YD	SQ YD	SQ YD	TON	TON	GAL	TON	TON		
EASTBOUND LANE												
50.28	TO	50.32	DL	211.2		282	28	35	36.6	0.08	0.14	
50.31	TO	50.32	PL	52.8		70	7	9	9.2	0.02	0.04	
50.35	TO	50.36	PL	52.8		70	7	9	9.2	0.02	0.04	
50.35	TO	50.39	DL	211.2		282	28	35	36.6	0.08	0.14	
50.67	TO	50.7	DL/PL	158.4		422	41	53	54.9	0.13	0.21	
50.78	TO	50.81	PL	158.4		211	21	27	27.5	0.06	0.11	
50.78	TO	51	DL & RAMP EXIT	1161.6	1936		217		201.3	0.46	0.77	
51.43	TO	51.52	DL	475.2	634		71		82.4	0.19	0.32	
54.3	TO	54.34	DL	211.2	282		32		36.6	0.08	0.14	
54.32	TO	54.34	PL	105.6	141		16		18.3	0.04	0.07	
54.38	TO	54.43	DL	264	352		39		45.8	0.11	0.18	
54.66	TO	54.69	DL	158.4	211		24		27.5	0.06	0.11	
55.47	TO	55.5	DL	158.4	211		24		27.5	0.06	0.11	
56.47	TO	56.51	DL/PL	211.2	563		63		73.2	0.17	0.28	
57.05	TO	57.06	DL	52.8	70		8		9.2	0.02	0.04	
57.99	TO	58.1	DL/PL	580.8		1549	152	195	201.3	0.46	0.77	
58.1	TO	58.127	DL/PL*(SN 006-0020)	142.56	582		49		49.4	0.11	0.19	
58.127	TO	58.3	DL/PL	913.44		2436	239	307	316.7	0.73	1.22	
58.3	TO	58.347	DL/PL*(SN 006-0022)	248.16	792		67		86.0	0.20	0.33	
58.347	TO	58.73	DL/PL	2022.24		5393	528	679	701.0	1.62	2.70	
59.05	TO	59.15	DL	528	704		79		91.5	0.21	0.35	
60.48	TO	60.53	DL	264	352		39		45.8	0.11	0.18	
60.98	TO	61.03	DL	264	352		39		45.8	0.11	0.18	
61.55	TO	61.6	DL	264	352		39		45.8	0.11	0.18	
WESTBOUND LANE												
50.31	TO	50.32	DL/PL	52.8		141	14	18	18.3	0.04	0.07	
50.35	TO	50.36	DL/PL	52.8		141	14	18	18.3	0.04	0.07	
50.67	TO	50.7	DL/PL	158.4		422	41	53	54.9	0.13	0.21	
50.78	TO	50.81	DL/PL	158.4		422	41	53	54.9	0.13	0.21	
51.07	TO	51.08	DL	52.8	70		8		9.2	0.02	0.04	
54.32	TO	54.34	DL	105.6	141		16		18.3	0.04	0.07	
54.38	TO	54.4	DL	105.6	141		16		18.3	0.04	0.07	
56.5	TO	56.53	DL	158.4	211		24		27.5	0.06	0.11	
58.05	TO	58.1	DL/PL*	264	704		69	89	91.5	0.21	0.35	
58.1	TO	58.127	DL/PL*(SN 006-0021)	142.56	582		49		49.4	0.11	0.19	
58.127	TO	58.3	DL/PL	913.44		2436	239	307	316.7	0.73	1.22	
58.3	TO	58.347	DL/PL*(SN 006-0023)	248.16	821		69		86.0	0.20	0.33	
58.347	TO	58.7	DL/PL	1863.84		4970	487	626	646.1	1.49	2.49	
60.5	TO	60.53	DL	158.4	211		24		27.5	0.06	0.11	
60.93	TO	60.98	DL	264	352		39		45.8	0.11	0.18	
61.5	TO	61.6	DL	528	704		79		91.5	0.21	0.35	
TOTAL				14097.6	2777	7990	19951	3083	2514	3853	9	15

LOOPS IN PAVEMENT IN AREA AROUND MM 55.80 ARE OBSOLETE. THEY MAY BE REMOVED IF IN CONFLICT WITH WORK.
 *MILL AND OVERLAY SN 006-0020,006,0021,006-0022, AND 006-0023 WITHIN THESE SECTIONS. THE MILL DEPTH AND THE OVERLAY THICKNESS SHALL BE 1 1/2". GAP ALL BRIDGE JOINTS.
 (1) FROM MILE MARKER 58.1 TO MILE MARKER 58.73 (EB& WB LANES), IT IS BELIEVED THAT THE EXISTING OVERLAY THINCKNESS IS LESS THAN 4", CARE SHALL BE TAKEN WHEN INITIALLY MILLING THIS AREA SO ITS NOT TO MILL THE EXISTING CONCRETE SLAB.
 ANY DAMAGE TO ANY OF THE JOINTS DURING THE MILLING OF THE EXISTING OVERLAY IS TO BE REPAIRED TO THE SATISFACTION OF THE ENGINEER AT THE CONTRACTOR'S EXPENSE.

SHOULDER REPAIR*		
LOCATION MILE MARKERS	HMA SURF. REM 5"	HMA SHLD 5"
	SQ YD	SQ YD
BUREAU COUNTY VARIOUS LOCATIONS	600	600
TOTAL	600	600

* THIS ITEM IS A CONTINGENCY ITEM TO REPAIR HMA SHOULDER DUE TO TRAFFIC DAMAGE TO SHOULDER DURING PAVING OF MAINLINE

FILE NAME =	USER NAME = bergantinoja	DESIGNED - ---	REVISED - ---	STATE OF ILLINOIS DEPARTMENT OF TRANSPORTATION	SCHEDULES			F.A.I. RTE.	SECTION	COUNTY	TOTAL SHEETS	SHEET NO.
cd:\pw_work\PWIDOT\BERGANTINOJA\0143170	D366A33-details.dgn	DRAWN - ---	REVISED - ---		SCALE: -----	SHEET NO. -- OF -- SHEETS	STA. ----- TO STA. -----	80	*	BUREAU	12	5
	PLOT SCALE = 50.0000' / IN.	CHECKED - ---	REVISED - ---					CONTRACT NO. 66A33				
	PLOT DATE = May 24, 2010 - 02:57:10 PM	DATE - -----	REVISED - ---									

PATCHING SCHEDULE - EASTBOUND LANES																				
LOCATION M.P.	PASSING LANE										DRIVING LANE									
	CLASS B PATCHING			CLASS B (SPECIAL)			DOWEL BARS EACH	SAW CUTS FOOT	PAVE'T FABRIC SQ YD	TIE BARS EACH	CLASS B PATCHING			CLASS B (SPECIAL)			DOWEL BARS	SAW CUTS FOOT	PAVE'T FABRIC SQ YD	TIE BARS EACH
	TYPE II SQ YD	TYPE III SQ YD	TYPE IV SQ YD	TYPE II SQ YD	TYPE III SQ YD	TYPE IV SQ YD					TYPE II SQ YD	TYPE III SQ YD	TYPE IV SQ YD	TYPE II SQ YD	TYPE III SQ YD	TYPE IV SQ YD				
55.85															8	20	48	16		
55.90															8	20	48	16		
56.40															8	20	48	16		
56.42															8	20	48	16		
56.44				13			20	56	13											
56.45															11	20	52	22		
56.40															8	20	48	16		
56.70															8	20	48	16		
56.80															8	20	48	16		
57.05																				
57.40														8	20	48				
57.80														8	20	48	16			
58.00														8	20	48				
58.05																				
58.10			27				20	76	53	10					20	116	53	20		
58.15															8	20	48	27	10	
58.17																				
58.18														13	20	60	16			
58.19														8	20	48				
58.20														8	20	48				
58.21	8						20	48	16											
58.30			27				20	76	53	10										
58.32														8	20	66	20			
58.60														8	20	48				
58.65														8	20	48				
58.70	8						20	48	16					8	20	48				
58.90				8			20	48												
58.90															8	20	48	16		
58.95															8	20	48	16		
58.97															8	20	48	16		
59.00															8	20	48	16		
59.07														8	20	48				
59.10														8	20	48				
59.11														8	20	48				
59.90																				
60.50															8	20	48	16		
60.90															53	20	116	53	20	
60.90															8	20	48	16		
60.95															8	20	48	16		
60.99															13	20	56	26		
61.10															8	20	48	16		
EB TOTALS	16		53	21			120	352	152	20				117	36	133	152			

FILE NAME =	USER NAME = bergantinoja	DESIGNED - RON WOODSHANK	REVISED - _____	STATE OF ILLINOIS DEPARTMENT OF TRANSPORTATION	SCHEDULE	F.A.I. RTE.	SECTION	COUNTY	TOTAL SHEETS	SHEET NO.	
0:\pw_work\VPWIDOT\BERGANTINOJA\0143170	D386A33-details.dgn	DRAWN - RON WOODSHANK	REVISED - _____			80	.		BUREAU	12	6
	PLOT SCALE = 50.0119' / IN.	CHECKED - _____	REVISED - _____			SCALE: _____ SHEET NO. 1 OF 1 SHEETS STA. _____ TO STA. _____		ILLINOIS		CONTRACT NO. 66A33	
	PLOT DATE = May 04, 2010 - 02:58:54 PM	DATE - _____	REVISED - _____								

PATCHING SCHEDULE - WESTBOUND LANES

LOCATION M.P.	PASSING LANE										DRIVING LANE																					
	CLASS B PATCHING			CLASS B (SPECIAL)			DOWEL BARS EACH	SAW CUTS FOOT	PAVE'T FABRIC SQ YD	TIE BARS EACH	CLASS B PATCHING			CLASS B (SPECIAL)			DOWEL BARS EACH	SAW CUTS FOOT	PAVE'T FABRIC SQ YD	TIE BARS EACH												
	TYPE II SQ YD	TYPE III SQ YD	TYPE IV SQ YD	TYPE II SQ YD	TYPE III SQ YD	TYPE IV SQ YD					TYPE II SQ YD	TYPE III SQ YD	TYPE IV SQ YD	TYPE II SQ YD	TYPE III SQ YD	TYPE IV SQ YD																
61.53											8						20	48														
61.30														8			20	48	16													
61.20														8			20	48	16													
61.10														8			20	48	16													
60.90				8			20	48								53	20	116	106	20												
60.85															40	20	96	80	15													
60.70														8			20	48	16													
60.60														13			20	56	26													
60.55														8			20	48	16													
60.50	8						20	48							53	20	116		20													
60.40														8			20	48	16													
59.50				8			20	48						8			20	48	16													
59.48				8			20	48						8			20	48	16													
59.10														8			20	48	16													
59.08														8			20	48	16													
59.05														8			20	48	16													
58.70															16		20	60	16													
58.68														8			20	48														
58.60														8			20	48														
58.50															53		20	116	53	20												
58.40														13			20	56														
58.20														13			20	56														
58.18														8			20	48														
58.16															40		20	96	40	15												
58.10						27			20						80		20	156	80	30												
56.50															33		20	86	33	12												
WB TOTALS	8			27		24			100					59		16		260		101				93		520		1730		610		132

DECK PATCHING*	
LOCATION	DECK SLAB REPAIR (PARTIAL) SQ YD
SN 006-0020 (OVER US 34)	20
SN 006-0021 (OVER US 34)	20
SN 006-0022 (OVER RAILROAD)	20
SN 006-0023 (OVER RAILROAD)	20
TOTAL	80

* THIS ITEM IS A ESTIMATED QUANTITY TO REPAIR THE INDICATED BRIDGE DECKS. ACTUAL QUANTITIES MAY VARY.

FILE NAME =	USER NAME = bergantinoje	DESIGNED - RON WOODSHANK	REVISED -	STATE OF ILLINOIS DEPARTMENT OF TRANSPORTATION	SCHEDULE	F.A.I. RTE.	SECTION	COUNTY	TOTAL SHEETS	SHEET NO.
ca\pwwork\PIWIDOT\BERGANTINOJA\0143170	D366A33-details.dgn	DRAWN - RON WOODSHANK	REVISED -			80	*	BUREAU	12	7
	PLOT SCALE = 50.0119' / IN.	CHECKED -	REVISED -			CONTRACT NO. 66A33				
	PLOT DATE = May 04, 2010 - 02:58:36 PM	DATE -	REVISED -			SCALE: _____	SHEET NO. 1 OF 1 SHEETS	STA. _____ TO STA. _____	ILLINOIS	

PAVEMENT MARKING SCHEDULE									
LOCATION STATION TO STATION	LANE DL/PL	LENGTH FOOT	EPOXY PVT MK- LINE 4"	FOOT	WET REFLECTIVE PREFORM. PLASTIC PVT MK-LINE 6"	FOOT	RAISED REFLEC PVT MK REMOVAL EACH	SHORT-TERM PVMT. MARK. FOOT	WORK-ZONE PVMT. MARK. REM. SQ FT
LASALLE COUNTY									
EASTBOUND LANE									
50.28 TO 50.32	DL	211.2	211		53		3	21	7
50.31 TO 50.32	PL	52.8	53		13		1	5	2
50.35 TO 50.36	PL	52.8	53		13		1	5	2
50.35 TO 50.39	DL	211.2	211		53		3	21	7
50.67 TO 50.7	DL/PL	158.4	158		40		2	16	5
50.78 TO 50.81	PL	158.4	158		40		2	16	5
50.78 TO 51	DL & RAMP EXIT	1161.6	1162		290		15	116	38
51.43 TO 51.52	DL	475.2	475		119		6	48	16
54.3 TO 54.34	DL	211.2	211		53		3	21	7
54.32 TO 54.34	PL	105.6	106		26		1	11	3
54.38 TO 54.43	DL	264	264		66		3	26	9
54.66 TO 54.69	DL	158.4	158		40		2	16	5
55.47 TO 55.5	DL	158.4	158		40		2	16	5
56.47 TO 56.51	DL/PL	211.2	211		53		3	21	7
57.05 TO 57.06	DL	52.8	53		13		1	5	2
57.99 TO 58.73	DL/PL	3907.2	3907		977		49	391	129
59.05 TO 59.15	DL	528	528		132		7	53	17
60.48 TO 60.53	DL	264	264		66		3	26	9
60.98 TO 61.03	DL	264	264		66		3	26	9
61.55 TO 61.6	DL	264	264		66		3	26	9
45.6 TO 61.6	LT EDGE LINE (4' SHLD)*	84480	84480						
WESTBOUND LANE									
50.31 TO 50.32	DL/PL	52.8	53		13		1	5	2
50.35 TO 50.36	DL/PL	52.8	53		13		1	5	2
50.67 TO 50.7	DL/PL	158.4	158		40		2	16	5
50.78 TO 50.81	DL/PL	158.4	158		40		2	16	5
51.07 TO 51.08	DL	52.8	53		13		1	5	2
54.32 TO 54.34	DL	105.6	106		26		1	11	3
54.38 TO 54.4	DL	105.6	106		26		1	11	3
56.5 TO 56.53	DL	158.4	158		40		2	16	5
58.05 TO 58.7	DL/PL	3432	3432		858		43	343	113
60.5 TO 60.53	DL	158.4	158		40		2	16	5
60.93 TO 60.98	DL	264	264		66		3	26	9
61.5 TO 61.6	DL	528	528		132		7	53	17
45.6 TO 61.6	LT EDGE LINE (4' SHLD)*	84480	84480						
TOTAL			84480	183058	3524		176	1410	465

* THE ENTIRE EDGE LINE ADJACENT TO THE 4' SHOULD SHALL BE PAINTED THROUGHOUT PROJECT

FILE NAME =	USER NAME = bergantinoja	DESIGNED -	REVISED -	STATE OF ILLINOIS DEPARTMENT OF TRANSPORTATION	SCHEDULES			F.A.I. RTE.	SECTION	COUNTY	TOTAL SHEETS	SHEET NO.
ca:\pw_work\PIWIDOT\BERGANTINOJA\0143170	D366A33-details.dgn	DRAWN -	REVISED -					80		BUREAU	12	8
PLOT SCALE = 50,0000' / IN.	CHECKED -	REVISED -	REVISED -		SCALE: _____	SHEET NO. ___ OF ___ SHEETS	STA. _____ TO STA. _____	CONTRACT NO. 66A33				
PLOT DATE = May 06, 2010 - 02:25:00 PM	DATE -	REVISED -	REVISED -					FED. ROAD DIST. NO. - ILLINOIS FED. AID PROJECT				

PAVEMENT MARKING SCHEDULE-EBL				
LOCATION MP.	EPOXY PVT MK, LINE 4"		WET REFLECTIVE PREFORM. PLASTIC PVT MK-LINE 6"	
	FEET			FOOT
	YELLOW	WHITE		WHITE
55.85		6	2	
55.90		6	2	
56.40		6	2	
56.42		6	2	
56.44	10	0	3	
56.45		8	2	
56.40		6	2	
56.70		6	2	
56.80		6	2	
57.05		6	2	
57.40		6	2	
57.80		6	2	
58.00		6	2	
58.05		40	10	
58.10	20	20	5	
58.15		6	2	
58.17		12	3	
58.18		10	3	
58.19		6	2	
58.20		6	2	
58.21	6	0	2	
58.30	20	15	5	
58.32		6	2	
58.60		6	2	
58.65		6	2	
58.70		6	2	
58.90		6	2	
58.95		6	2	
58.97		6	2	
59.00		6	2	
59.07		6	2	
59.10		6	2	
59.11		6	2	
59.90		6	2	
60.50		40	10	
60.90		6	2	
60.95		6	2	
60.99		10	3	
61.10		6	2	
SUBTOTAL	56	329	104	
EB TOTAL		385	104	

PAVEMENT MARKING SCHEDULE-WBL				
LOCATION MP.	EPOXY PVT MK, LINE 4"		WET REFLECTIVE PREFORM. PLASTIC PVT MK-LINE 6"	
	FEET			FOOT
	YELLOW	WHITE		WHITE
61.53		6	2	
61.30		6	2	
61.20		6	2	
61.10		6	2	
60.90	6	40	2	
60.85		30	8	
60.70		6	2	
60.60		10	3	
60.55		6	2	
60.50		40	10	
60.40		6	2	
59.50		6	2	
59.48		6	2	
59.10		6	2	
59.08	0	6	2	
59.05		6	2	
58.70		12	3	
58.68		6	2	
58.60		6	2	
58.50		40	10	
58.40	0	10	0	
58.20	0	10	0	
58.18		6	2	
58.16		30	8	
58.10		60	15	
56.50		25	7	
SUBTOTAL	6	397	96	
EB TOTAL		403	96	

FILE NAME =	USER NAME = bergantinoja	DESIGNED - RON WOODSHANK	REVISED -	STATE OF ILLINOIS DEPARTMENT OF TRANSPORTATION	SCHEDULE	F.A.I. RTE.	SECTION	COUNTY	TOTAL SHEETS	SHEET NO.
c:\pwork\PWIDOT\BERGANTINOJA\0143170	0366A33-details.dgn	DRAWN - RON WOODSHANK	REVISED -			80	.	BUREAU	12	9
	PLOT SCALE = 50.0119' / IN.	CHECKED -	REVISED -			CONTRACT NO. 66A33				
	PLOT DATE = May 04, 2010 - 02:58:08 PM	DATE -	REVISED -	SCALE: _____	SHEET NO. 1 OF 1 SHEETS	STA. _____	TO STA. _____	ILLINOIS		

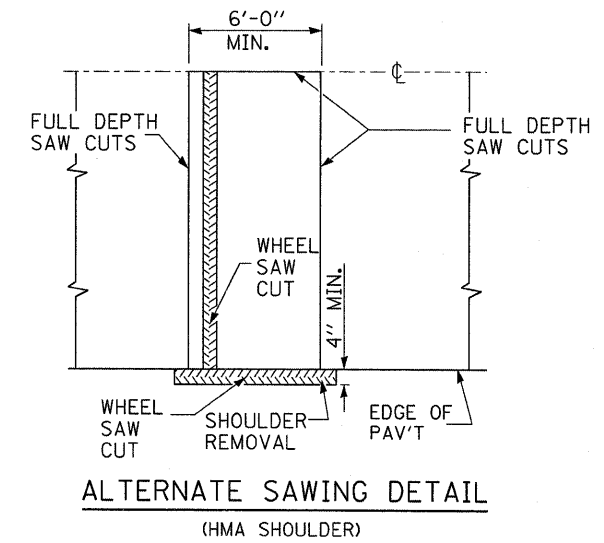
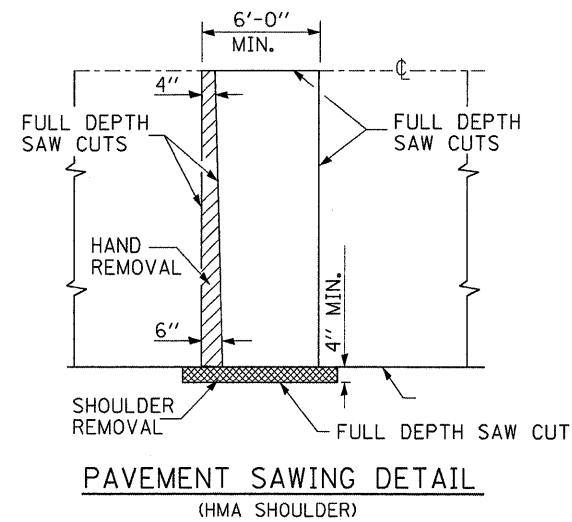
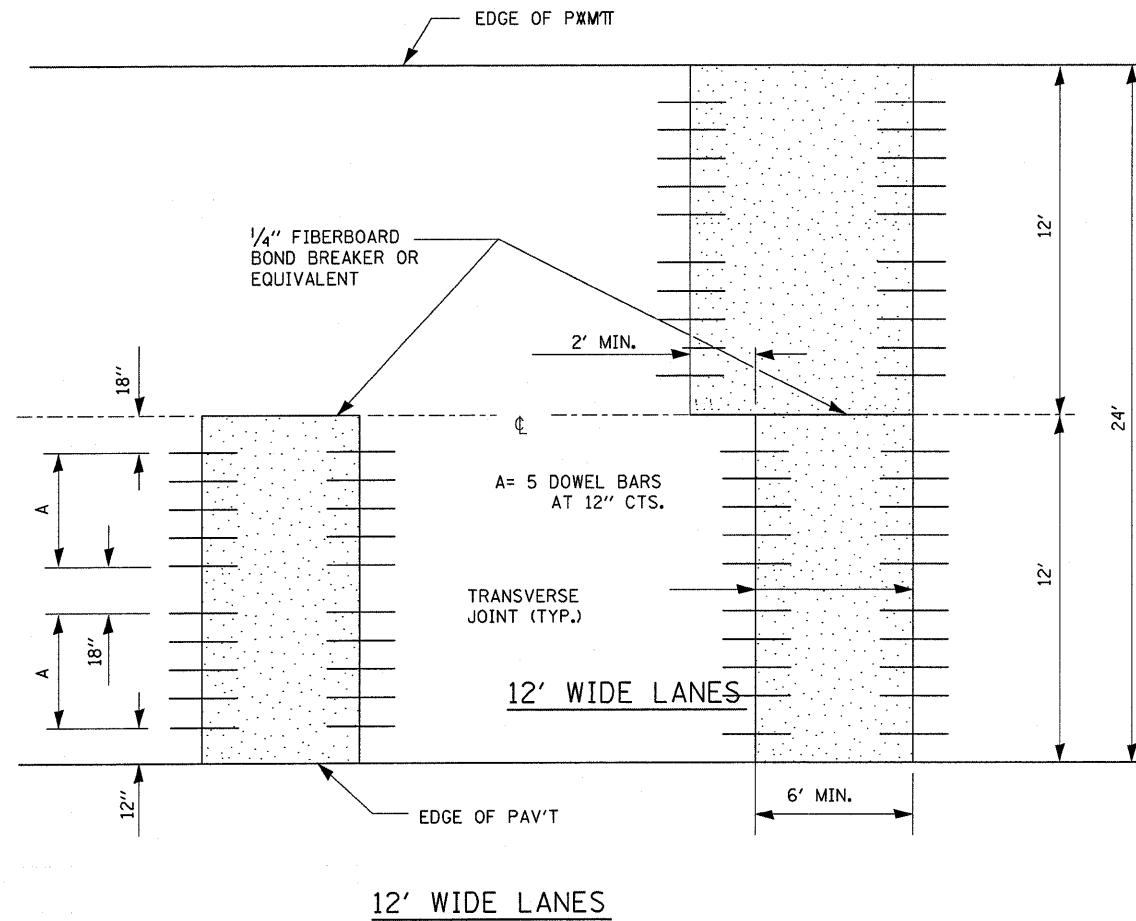

DOWEL BAR TABLE		
PAVEMENT THICKNESS	DOWEL BAR DIAMETER	HOLE DIAMETER
8" OR GREATER	1 1/2"	1 5/8"
7" THRU 7.99"	1 1/4"	1 3/8"
LESS THAN 7"	1"	1 1/8"

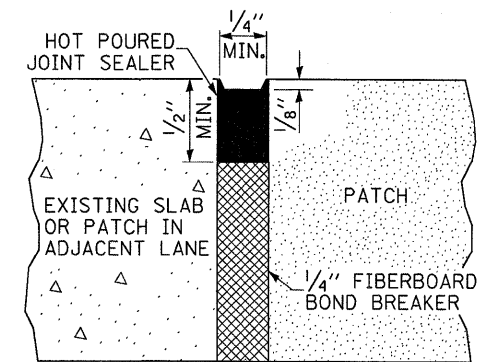

SEALING DETAIL
CENTERLINE JOINT

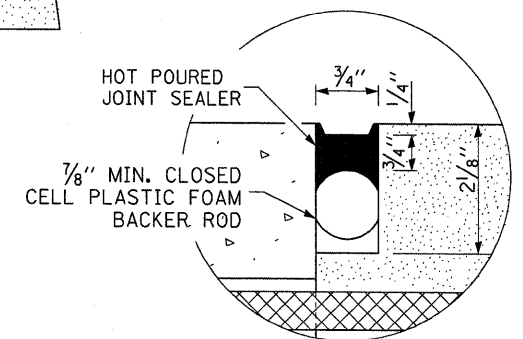

SEALING DETAIL
TRANSVERSE JOINT

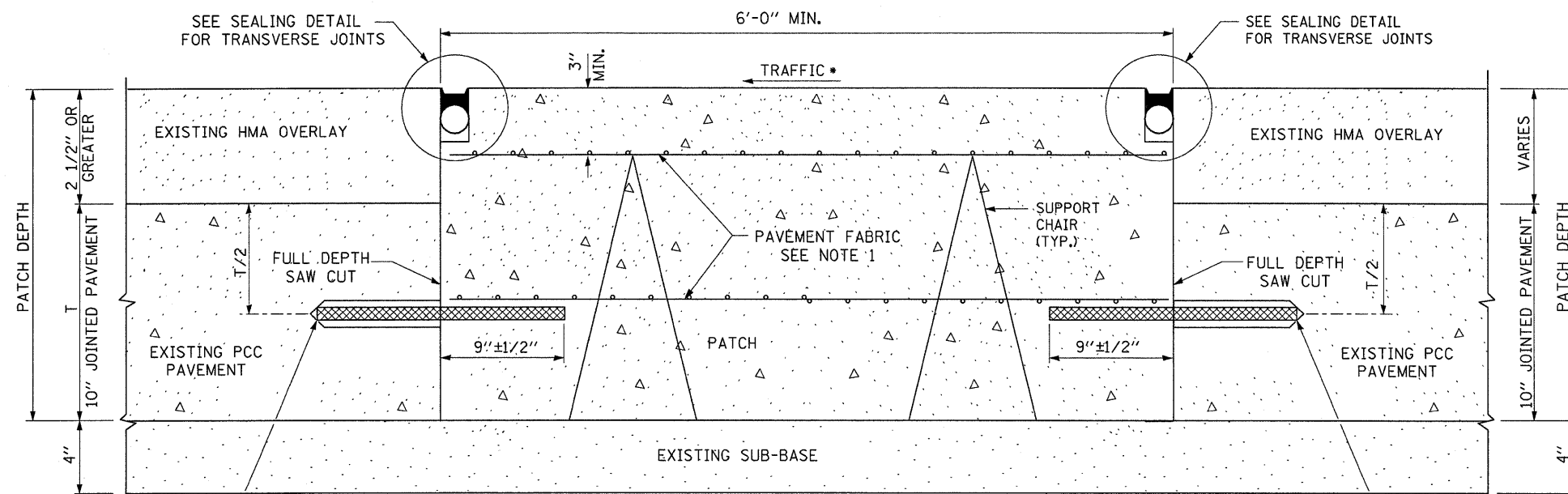

CLASS B PATCH
(With Resurfacing)

GENERAL NOTES

THE TRANSVERSE JOINTS FOR CLASS B PATCHES SHALL ALIGN WITH JOINTS OR CRACKS IN THE ADJACENT LANE WHENEVER POSSIBLE.
SEE STANDARD 420701 FOR DETAILS OF PAVEMENT FABRIC.

NOTE 1:
TWO LAYERS OF PAVEMENT FABRIC AS SHOWN SHALL BE REQUIRED FOR TYPE II, TYPE III AND TYPE IV CLASS B PATCHES

FILE NAME =	USER NAME = bergantunoje	DESIGNED <i>RON WOODSHANK</i>	REVISED -	STATE OF ILLINOIS DEPARTMENT OF TRANSPORTATION	CLASS B PATCHING (SPECIAL)	F.A.I. RTE. 80	SECTION	COUNTY	TOTAL SHEETS 12	SHEET NO. 10		
CONTRACT NO. 66A33	D366A33-details.dgn	DRAWN <i>RON WOODSHANK</i>	REVISED -			SCALE: _____	SHEET NO. 1 OF 1 SHEETS	STA. _____	TO STA. _____	ILLINOIS		
	PLOT SCALE = 50,0000' / IN.	CHECKED -	REVISED -									
	PLOT DATE = May 04, 2010 - 02:57:52 PM	DATE -	REVISED -									

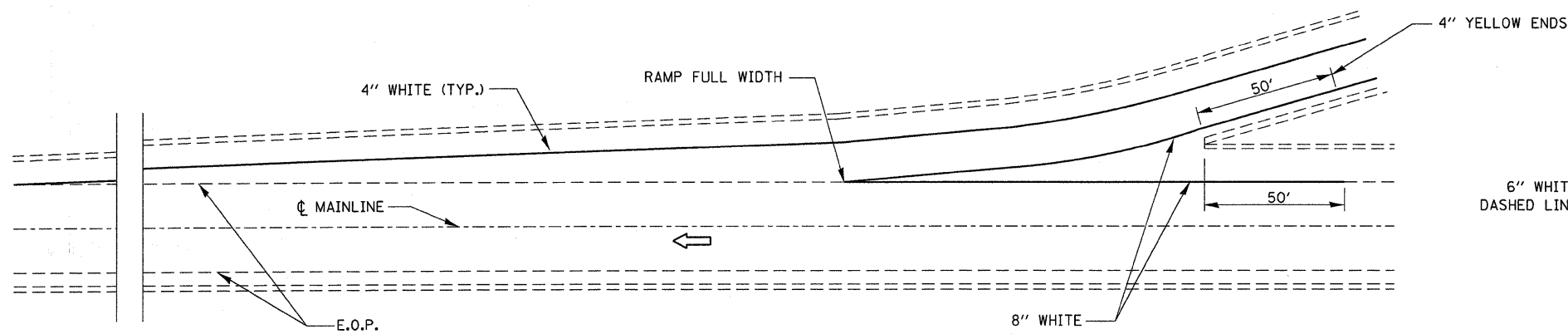

TYPICAL PAVEMENT MARKING FOR ENTRANCE RAMP TERMINALS

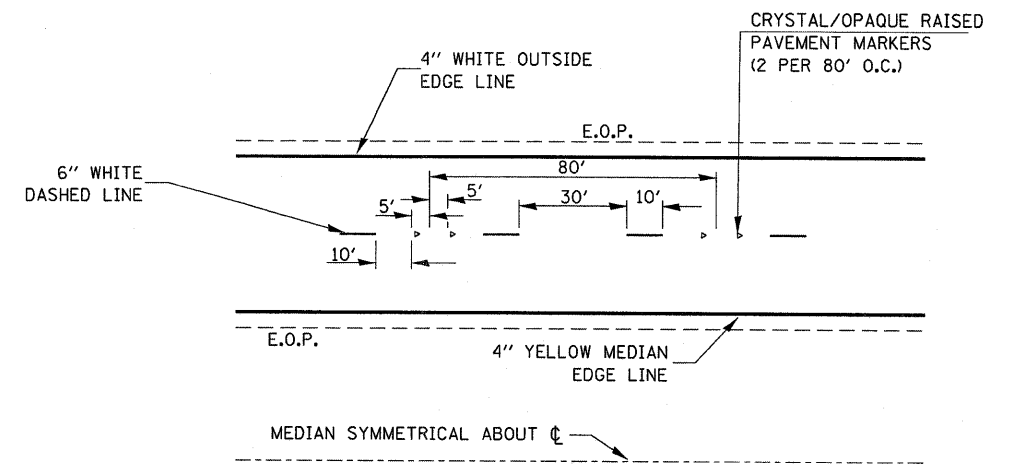

TYPICAL PAVEMENT MARKINGS

NOTE:
 WHEN PATCHING IS ADJACENT TO 8" PAVEMENT MARKING LINE
 THE 8" STRIP SHALL BE REPLACED WITH TWO 4" LINES.
 RAISED REFLECTIVE PAVEMENT MARKERS THAT FALL WITHIN
 PATCHED BOUNDARIES WILL NOT BE REPLACED.

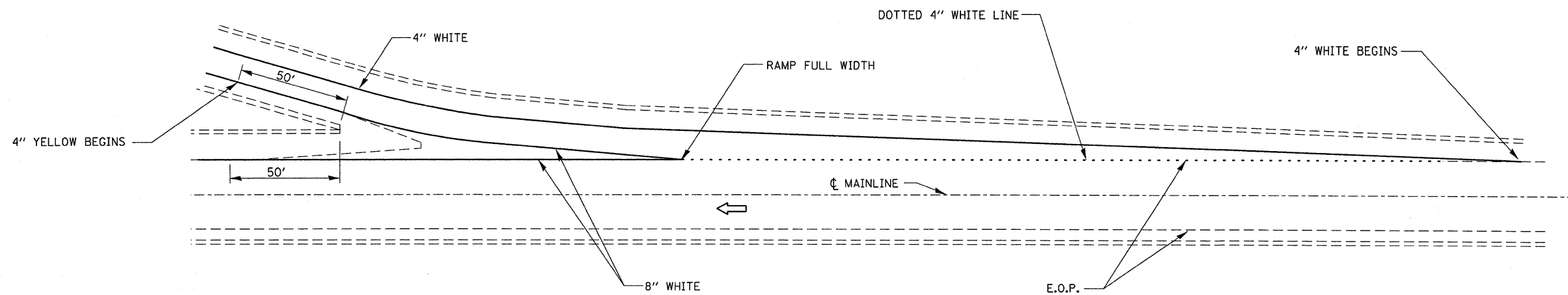

TYPICAL PAVEMENT MARKINGS FOR EXIT RAMP TERMINALS

FILE NAME =	USER NAME = bergantinoje	DESIGNED <i>RON WOODSHANK</i>	REVISED -	STATE OF ILLINOIS DEPARTMENT OF TRANSPORTATION	DETAILS	F.A.I. RTE.	SECTION	COUNTY	TOTAL SHEETS	SHEET NO.	
0:\pwork\WIDOT\BERGANTINOJA\0143178	D366A33-details.dgn	DRAWN <i>RON WOODSHANK</i>	REVISED -			80	.	BUREAU	12	11	
	PLOT SCALE = 50,0000' / IN.	CHECKED -	REVISED -			CONTRACT NO. 66A33					
	PLOT DATE = May 04, 2010 - 02:57:29 PM	DATE -	REVISED -			SCALE: _____	SHEET NO. 1 OF 1 SHEETS	STA. _____	TO STA. _____	ILLINOIS	

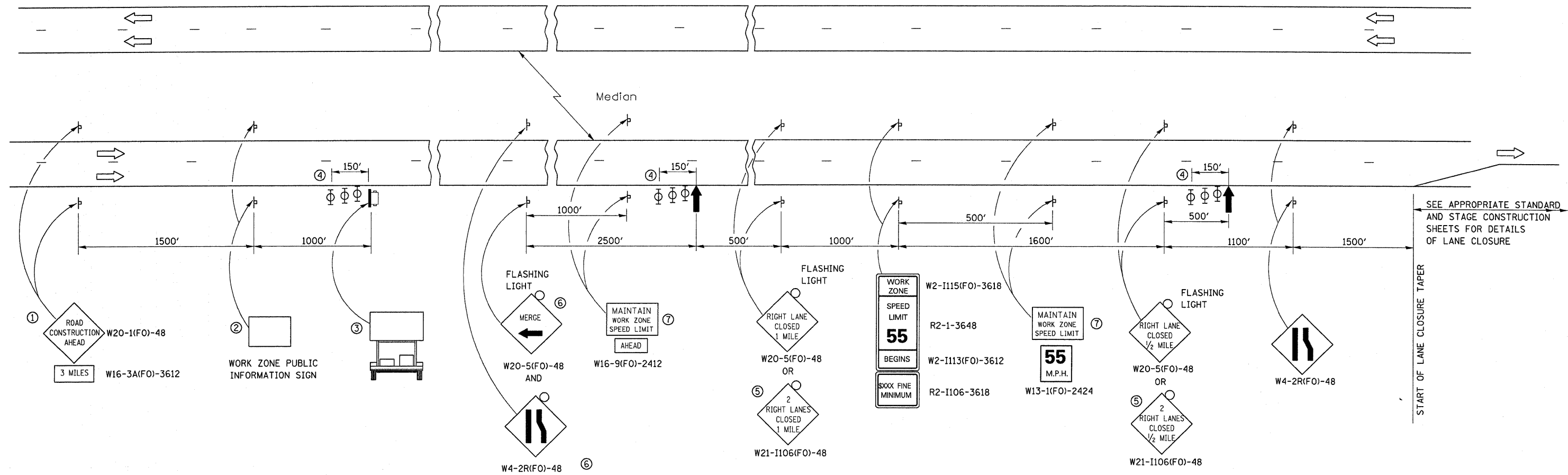

SEE APPROPRIATE STANDARD AND STAGE CONSTRUCTION SHEETS FOR DETAILS OF LANE CLOSURE

- ① THE ROAD CONSTRUCTION AHEAD SIGN SHALL BE LOCATED 3 MILES IN ADVANCE OF THE PROJECT LIMITS.
- ② THE MESSAGE AND SIZE OF THE WORK ZONE PUBLIC INFORMATION SIGN SHALL BE AS SPECIFIED BY THE DEPARTMENT.
- ③ TO BE PLACED IN THE MEDIAN WHEN FEASIBLE. THE MESSAGE BOARD SHALL BE USED TO DISPLAY STATUS OF LANES WITHIN THE PROJECT. THE PRIMARY MESSAGES SHALL BE:
"RIGHT LANE CLOSED" / " x MILES AHEAD"
"LEFT LANE CLOSED" / " x MILES AHEAD"
"ALL LANES OPEN"
- ④ THREE, TYPE II BARRICADES, DRUMS, OR VERTICAL BARRICADES AT 50' CENTERS.
- ⑤ THIS SIGN SHALL BE USED WHEN 2 LANES ARE CLOSED.
- ⑥ WHEN THE LEFT LANE IS CLOSED, SWITCH THESE TWO SIGNS AND THE DIRECTION OF THE MERGE ARROW.

⑦ 48"x36" FLUORESCENT ORANGE SIGN WITH BLACK LETTERS.
48"

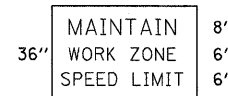

- ↑ ARROW BOARD
- ☐ PORTABLE CHANGEABLE MESSAGE SIGN
- ⊥ SIGN
- ⊕ TYPE II BARRICADE, DRUM, OR VERTICAL BARRICADE WITH MONODIRECTIONAL FLASHING LIGHT

GENERAL NOTE:

THIS STANDARD IS USED WHERE AT ANY TIME A LANE IS CLOSED ON A FREEWAY/EXPRESSWAY.

WHEN THE LEFT LANE IS CLOSED, LEFT LANE CLOSED SIGNS SHALL BE SUBSTITUTED FOR THE RIGHT LANE CLOSED SIGNS.

THE FIRST TWO SIGNS AND THE MESSAGE BOARD ARE STATIONARY. THE OTHER SIGNS AND ARROWBOARDS SHALL BE MOVED AS NECESSARY TO MAINTAIN THE REQUIRED DISTANCE FROM THE START OF THE LANE CLOSURE TAPER(S).

SEE SPECIAL PROVISIONS.

ALL DIMENSIONS ARE IN INCHES UNLESS OTHERWISE SHOWN.

FILE NAME =	USER NAME = bergantinoja	DESIGNED -	REVISD -	STATE OF ILLINOIS DEPARTMENT OF TRANSPORTATION	STANDARD 701400 (SPECIAL) DETAIL	F.A. RTE.	SECTION	COUNTY	TOTAL SHEETS	SHEET NO.
ca\pwwork\pwidot\BERGANTINOJA\0143170	D366A33-detail.dgn	DRAWN -	REVISD -			80	.	BUREAU	12	12
PLOT SCALE = 50,0000' / IN.	CHECKED -	REVISD -	REVISD -			CONTRACT NO. 66A33				
PLOT DATE = May 04, 2010 - 02:56:27 PM	DATE -	REVISD -	REVISD -			FED. ROAD DIST. NO. ILLINOIS FED. AID PROJECT				