

STATE OF ILLINOIS  
DEPARTMENT OF TRANSPORTATION  
DIVISION OF HIGHWAYS

**PROPOSED  
HIGHWAY PLANS**

FAS ROUTE 1279 (IL 178)  
SECTION (P6)DM-1

TYPE of IMPROVEMENT  
LASALLE COUNTY

C-93-146-10

F.A.S. RTE.	SECTION	COUNTY	TOTAL SHEETS	SHEET NO.
1279	(P6)DM-1	LASALLE	3	1
		ILLINOIS	CONTRACT NO. 66A52	

INDEX OF SHEETS

- COVER SHEET
- GENERAL NOTES & SUMMARY OF QUANTITIES
- PLAN VIEW

STANDARDS

- 000001-05 STANDARD SYMBOLS, ABBREVIATIONS AND PATTERNS  
701001-02 OFF-ROAD OPERATIONS 2L, 2W, MORE THAN 15' (4.5 m) AWAY  
701006-03 OFF-ROAD OPERATIONS 2L, 2W, 15' (4.5 m) TO 24" (600 mm) FROM PAVEMENT EDGE  
701301-03 LANE CLOSURE, 2L, 2W, SHORT TIME OPERATIONS  
701901-01 TRAFFIC CONTROL DEVICES

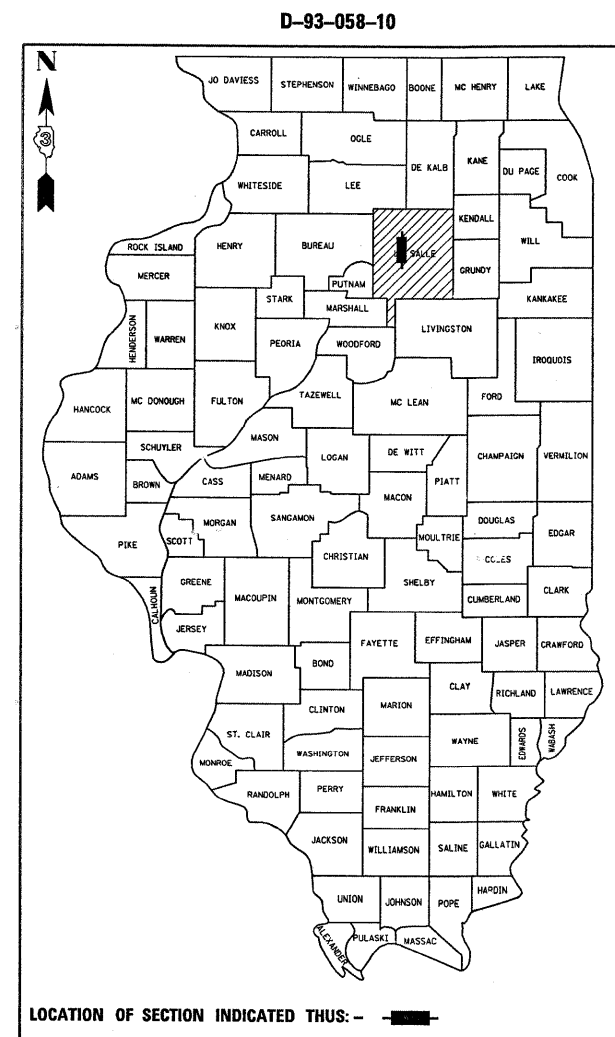

FUNCTION CLASSIFICATION  
MAJOR COLLECTOR - RURAL  
2005 ADT = 4250  
P.V. = 83.5% S.U. = 10.3% M.U. = 6.2%

STATE OF ILLINOIS  
DEPARTMENT OF TRANSPORTATION  
DIVISION OF HIGHWAYS

SUBMITTED May 17 2010  
George Ryan  
DEPUTY DIRECTOR OF HIGHWAYS, REGION ENGINEER

June 25 2010  
Scott E. Stitt, P.E.  
ACTING ENGINEER OF DESIGN AND ENVIRONMENT

June 25 2010  
Christine M. Reed  
DIRECTOR OF HIGHWAYS, CHIEF ENGINEER

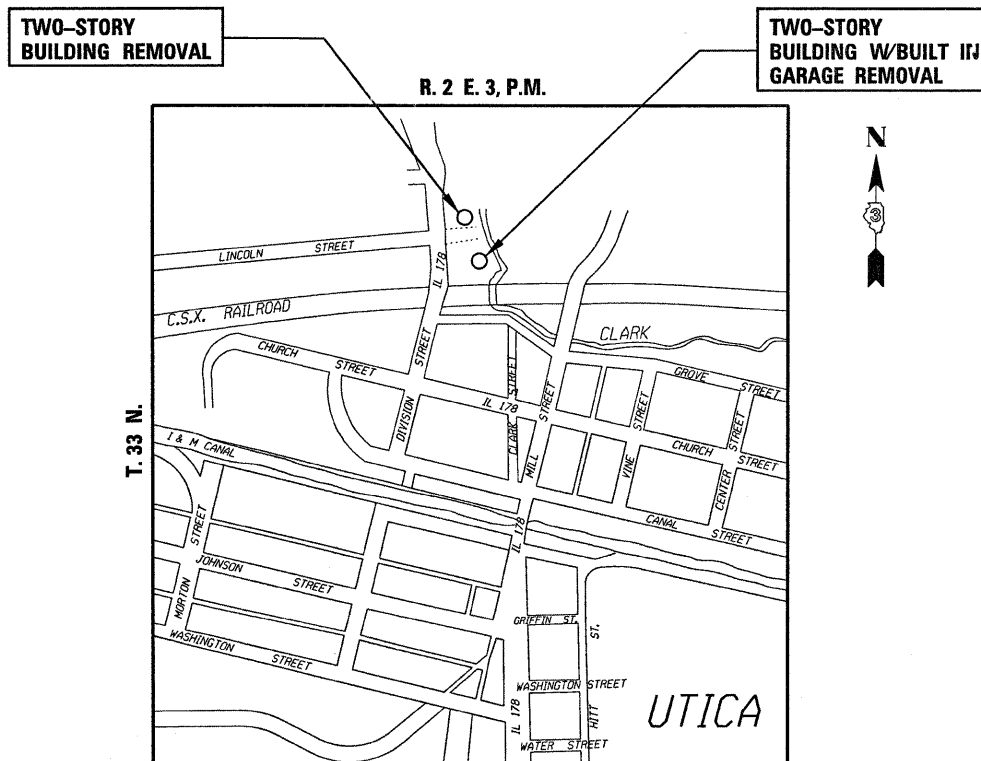

LOCATION MAP  
NOT TO SCALE

MICROFILMED \_\_\_\_\_  
REEL NUMBER \_\_\_\_\_  
AWARDED \_\_\_\_\_  
RESIDENT ENGINEER \_\_\_\_\_  
AS BUILT CHANGES WERE MADE  
ON THE FOLLOWING SHEETS \_\_\_\_\_

J.U.L.I.E.  
JOINT UTILITY LOCATION INFORMATION FOR EXCAVATION  
1-800-892-0123  
OR 811

PROJECT ENGINEER: CRAIG REED  
UNIT CHIEF: BRAD DUNCAN  
TOWNSHIP: UTICA

CONTRACT NO. 66A52

PRINTED BY THE AUTHORITY  
OF THE STATE OF ILLINOIS