

| | | | | |
|---------------------|-----------------------|--------------------|--------------|-----------|
| F.A.P. RTE. | SECTION | COUNTY | TOTAL SHEETS | SHEET NO. |
| 320 | (24Z)RS-4, N; 116RS-5 | LOGAN | 32 | 1 |
| FED. ROAD DIST. NO. | ILLINOIS | CONTRACT NO. 72998 | | |

INDEX OF SHEETS

| | |
|---------|--------------------------------------|
| 1 | TITLE SHEET |
| 2 | GENERAL NOTES & MIXTURE REQUIREMENTS |
| 3 | SUMMARY OF QUANTITIES |
| 4 - 7 | TYPICAL ROADWAY SECTIONS |
| 8 - 9 | SCHEDULE OF QUANTITIES |
| 10 - 16 | PAVEMENT REMOVAL PLAN |
| 17 | CONTROL POINT CROSS TIES |
| 18 - 20 | IL 121 & IL 10 INTERSECTION DETAILS |
| 21 - 27 | STRIPING & PAVEMENT MARKER PLAN |
| 28 - 32 | IL 10 CROSS SECTIONS |

STATE OF ILLINOIS
DEPARTMENT OF TRANSPORTATION
DIVISION OF HIGHWAYS
PROPOSED
HIGHWAY PLANS

FAP ROUTE 320 - (IL. 121) & FAP ROUTE 717 (IL. 10)
SECTION (24Z)RS-4, N; 116RS-5

D-96-530-05

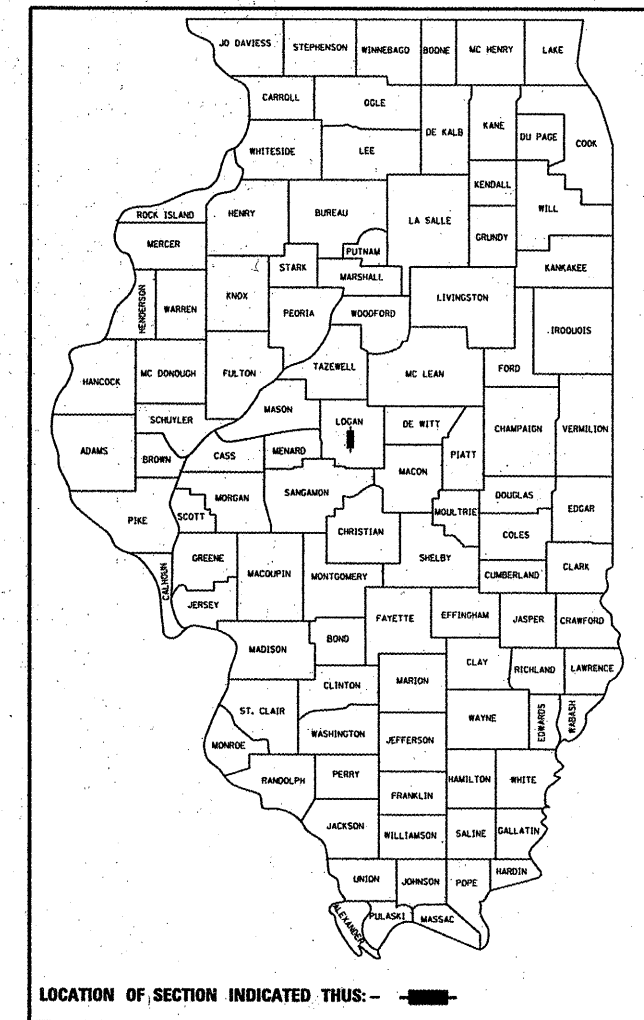

LOCATION OF SECTION INDICATED THUS: - - -

ADT = 5,628 (2003)
% SU = 8.0 (2003)
% MU = 5.0 (2003)
MUNICIPALITY: LINCOLN
FUNCTIONAL CLASSIFICATION: OTHER PRINCIPAL ARTERIAL

LIST OF ILLINOIS DOT HIGHWAY STANDARDS

| | |
|-----------|-----------|
| 000001-05 | 606201-02 |
| 001006 | 701201-03 |
| 280001-05 | 701306-02 |
| 353001-04 | 701311-03 |
| 482011-03 | 701326-03 |
| 542301-02 | 701501-05 |
| 542501-02 | 701601-06 |
| 602301-02 | 701602-04 |
| 602306-02 | 701606-06 |
| 602401-02 | 701701-06 |
| 604001-03 | 701801-04 |
| 604006-04 | 701901-01 |
| 604106-01 | 780001-02 |
| 606001-04 | 781001-03 |

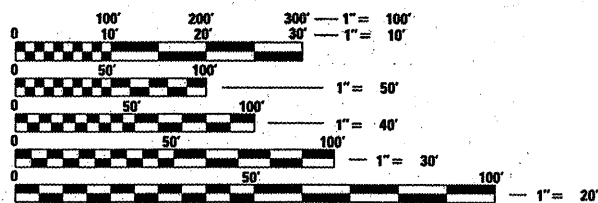

FULL SIZE PLANS HAVE BEEN PREPARED USING STANDARD ENGINEERING SCALES. REDUCED SIZED PLANS WILL NOT CONFORM TO STANDARD SCALES. IN MAKING MEASUREMENTS ON REDUCED PLANS, THE ABOVE SCALES MAY BE USED.

J.U.L.I.E.
JOINT UTILITY LOCATION INFORMATION FOR EXCAVATION
1-800-892-0123
OR 811

PROJECT ENGINEER: JOHN NEGANGARD 217-782-6990
SQUAD LEADER: VICTOR YOUNG 217-557-7897

CONTRACT NO. 72998

LOGAN COUNTY
C-96-502-10

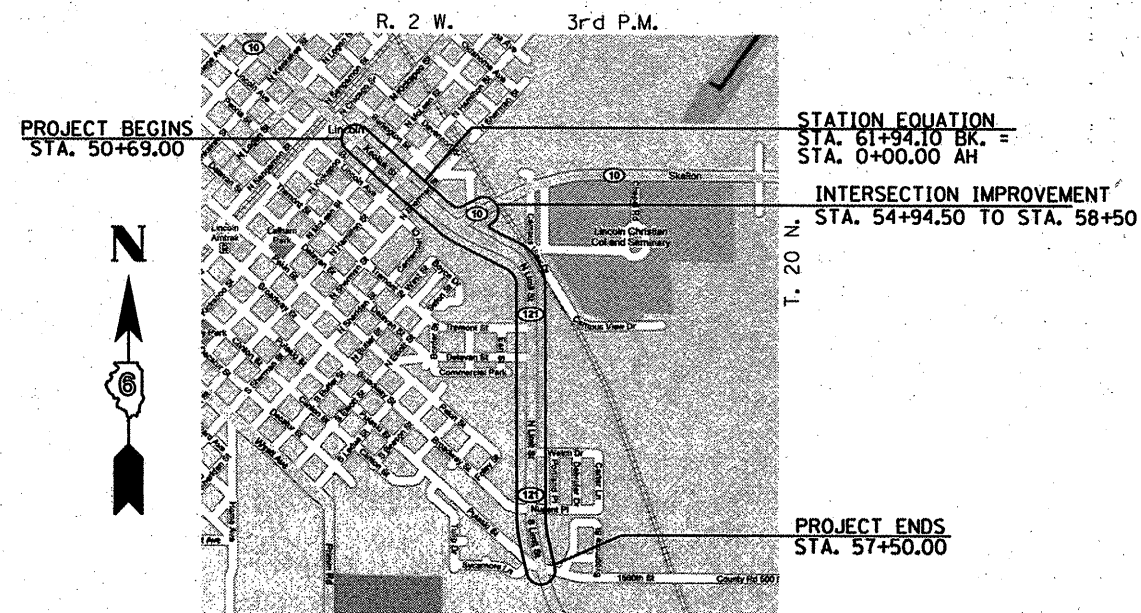

LOCATION MAP

LENGTH OF SECTION - 6875.10 FEET = 1.302 MILES



Christopher P. Koller 1/5/10
 EXPIRATION: 11/30/2011

STATE OF ILLINOIS
 DEPARTMENT OF TRANSPORTATION
 DIVISION OF HIGHWAYS

SUBMITTED March 17 2010
Raymond Z. Dombek
 DEPUTY DIRECTOR OF HIGHWAYS, REGION ENGINEER

May 7 2010
Scott E. Stitt, P.E.
 acting ENGINEER OF DESIGN AND ENVIRONMENT

May 7 2010
Christine M. Reedler
 DIRECTOR OF HIGHWAYS, CHIEF ENGINEER

PRINTED BY THE AUTHORITY
OF THE STATE OF ILLINOIS

 **Allen Henderson & Associates, Inc.**
 Civil and Structural Engineers Springfield, IL
 62703 Phone: (217)544-8033 IL Design Firm
 No. 184-001907