

EXIST. CURVE DATA  
 P.I. STA. = 225+44.12  
 $\Delta = 8^\circ 59' 18''$  (LT)  
 $D = 0^\circ 45' 00''$   
 $R = 7,639.52'$   
 $T = 600.46'$   
 $L = 1,198.46'$   
 $E = 23.56'$   
 $\theta = 3.47'$   
 P.C. STA. = 219+43.66  
 P.T. STA. = 231+42.12  
 ATTAIN SUPER  
 STA. 217+84 TO STA. 220+24  
 REMOVE SUPER  
 STA. 230+62 TO STA. 233+02

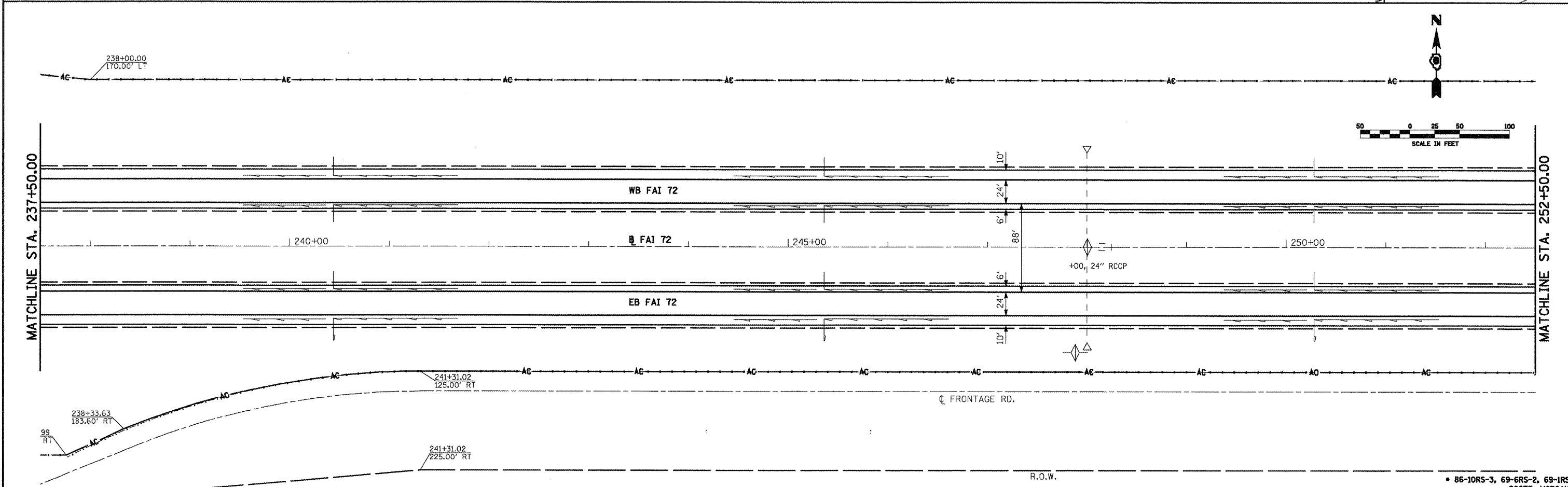

FILE NAME = e:\pwwork\pww007\LAUGHLIN\LD0196700\	USER NAME = laughlinl	DESIGNED -	REVISED -	<b>STATE OF ILLINOIS DEPARTMENT OF TRANSPORTATION</b>	<b>PLAN SHEET FAI 72</b>			F.A.I. RTE. 72	SECTION .	COUNTY .	TOTAL SHEETS 48	SHEET NO. 20
Johnson, Depp & Quisenberry CONSULTING ENGINEERS Springfield, Illinois	672A16-SHT-plan1.dgn	DRAWN -	REVISED -		SCALE:	SHEET NO. OF SHEETS	STA. TO STA.	CONTRACT NO. 72A16				
	PLOT SCALE = 1/8" = 100'-0"	CHECKED -	REVISED -					ILLINOIS FED. AID PROJECT				
	PLOT DATE = Apr-08-2010 10:26:10AM	DATE -	REVISED -					86-10RS-3, 69-6RS-2, 69-1RS ** SCOTT, MORGAN				