

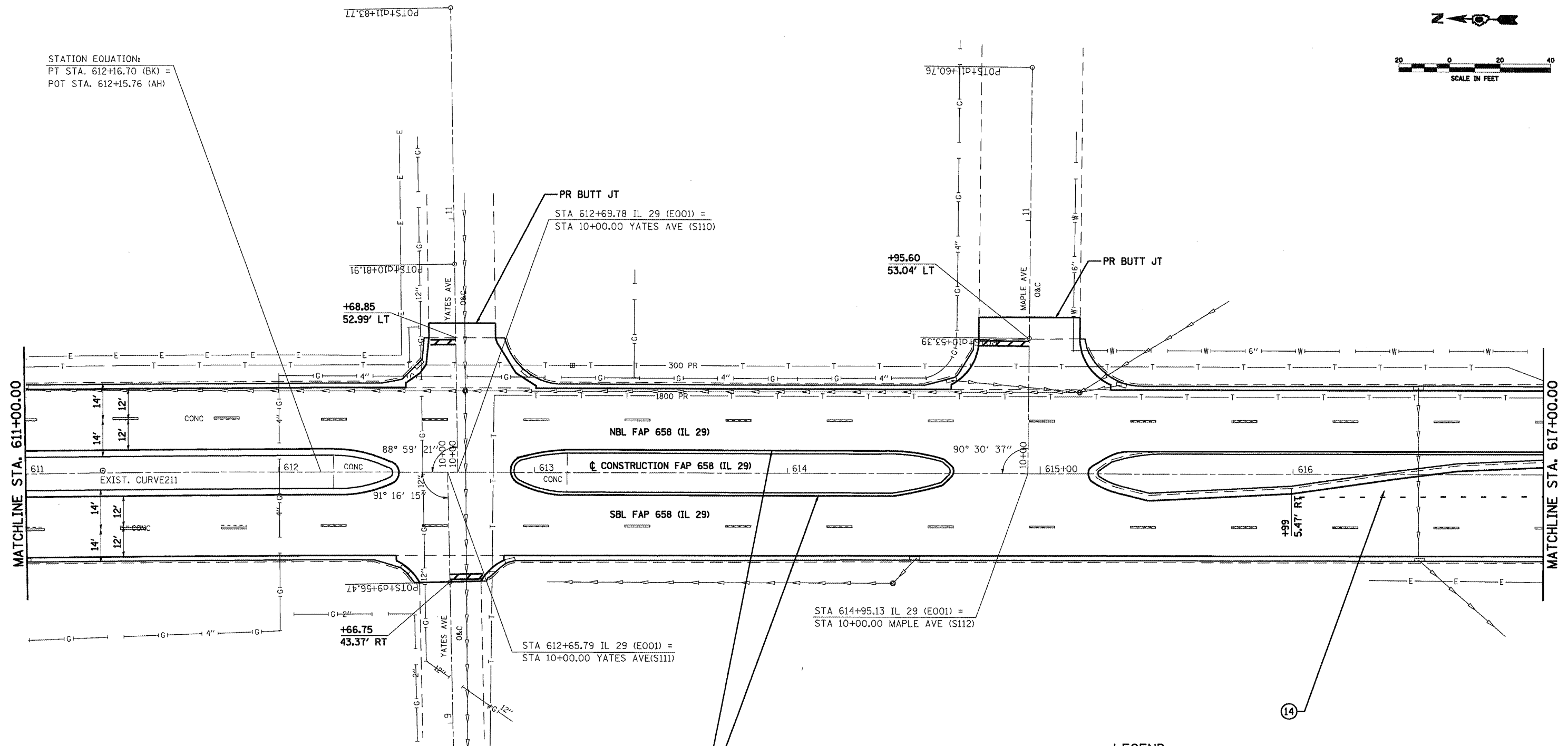

STATION EQUATION:  
 PT STA. 612+16.70 (BK) =  
 POT STA. 612+15.76 (AH)



EXIST. CURVE211  
 PI STA. =609+76.37  
 $\Delta = 3^\circ 57' 01''$  (RT)  
 $D = 0^\circ 49' 18''$   
 $R = 6,974.12'$   
 $T = 240.52'$   
 $L = 480.85'$   
 $E = 4.15'$   
 $e = NC$   
 T.R. = -----  
 S.E. RUN = -----  
 P.C. STA. =607+35.85  
 P.T. STA. =612+16.70

**LEGEND**

- ① URETHANE- 5" YELLOW
- ② URETHANE- 5" WHITE
- ③ URETHANE- 8" WHITE
- ④ URETHANE- 12" YELLOW
- ⑤ URETHANE-12" WHITE
- ⑥ THERMOPLASTIC- 5" YELLOW
- ⑦ THERMOPLASTIC- 5" WHITE
- ⑧ THERMOPLASTIC- 8" WHITE
- ⑨ THERMOPLASTIC- 12" YELLOW
- ⑩ THERMOPLASTIC- 12" WHITE
- ⑪ PREFORMED PLASTIC TYPE B- INLAID- LETTERS AND SYMBOLS
- ⑫ PREFORMED PLASTIC TYPE B- INLAID- 5" YELLOW
- ⑬ PREFORMED PLASTIC TYPE B- INLAID- 5" WHITE
- ⑭ PREFORMED PLASTIC TYPE B- INLAID- 6" WHITE
- ⑮ PREFORMED PLASTIC TYPE B- INLAID- 24" WHITE
- ⑯ PREFORMED PLASTIC TYPE B- INLAID- 8" WHITE

FILE NAME =	USER NAME = laughlinr1	DESIGNED -	REVISED -	<b>STATE OF ILLINOIS DEPARTMENT OF TRANSPORTATION</b>	<b>PLAN SHEET - SECTION "A" (OLD IL 29)</b>	F.A.P. RTE.	SECTION	COUNTY	TOTAL SHEETS	SHEET NO.	
ei:\pwwork\pwwid\ot\LAUGHLINR1\dms47710	672C35-SHT-plen-IL291.dgn	DRAWN -	REVISED -			658	.	SANGAMON	206	75	
	PLOT SCALE = 40.0000' / IN.	CHECKED -	REVISED -			SCALE: SHEET NO. 15 OF 24 SHEETS STA. TO STA.		ILLINOIS FED. AID PROJECT			
	PLOT DATE = Apr-30-2010 11:31:45AM	DATE -	REVISED -			CONTRACT NO. 72C35					