

EXIST. CURVE 23
 PI STA. = 410+98.40
 $\Delta = 2^\circ 25' 00''$ (RT)
 $D = 0^\circ 55' 00''$
 $R = 6,250.56'$
 $T = 131.84'$
 $L = 263.64'$
 $E = 1.39'$
 $e = 2.6\%$
 $T.R. = 39.81'$
 $S.E. RUN = 69'$
 $P.C. STA. = 409+66.56$
 $P.T. STA. = 412+30.20$

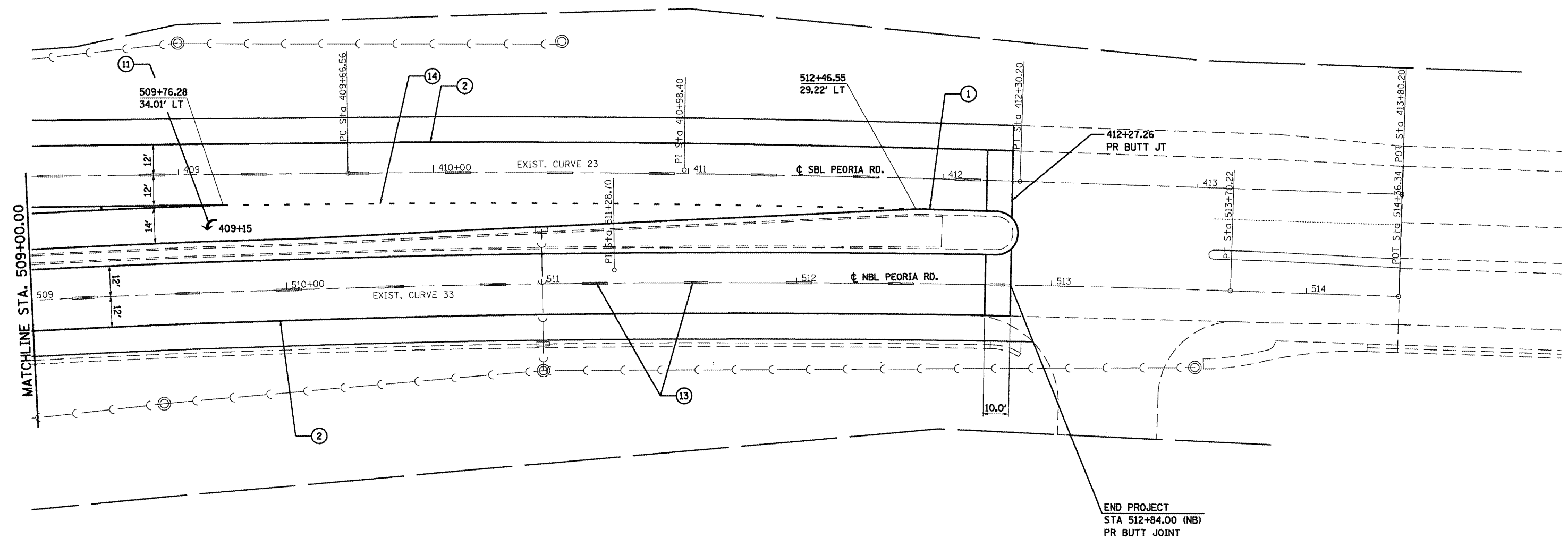
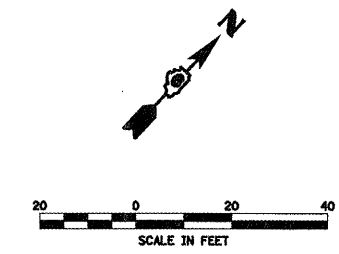

LEGEND

- | | |
|----------------------------|---|
| ① URETHANE- 5" YELLOW | ⑨ THERMOPLASTIC- 12" YELLOW |
| ② URETHANE- 5" WHITE | ⑩ THERMOPLASTIC- 12" WHITE |
| ③ URETHANE- 8" WHITE | ⑪ PREFORMED PLASTIC TYPE B- INLAID- LETTERS AND SYMBOLS |
| ④ URETHANE- 12" YELLOW | ⑫ PREFORMED PLASTIC TYPE B- INLAID - 5" YELLOW |
| ⑤ URETHANE-12" WHITE | ⑬ PREFORMED PLASTIC TYPE B- INLAID - 5" WHITE |
| ⑥ THERMOPLASTIC- 5" YELLOW | ⑭ PREFORMED PLASTIC TYPE B- INLAID - 6" WHITE |
| ⑦ THERMOPLASTIC- 5" WHITE | ⑮ PREFORMED PLASTIC TYPE B- INLAID - 24" WHITE |
| ⑧ THERMOPLASTIC- 8" WHITE | |

EXIST. CURVE 33
 PI STA. = 511+28.70
 $\Delta = 4^\circ 50' 00''$ (RT)
 $D = 1^\circ 00' 00''$
 $R = 5,729.58'$
 $T = 241.81'$
 $L = 483.33'$
 $E = 5.10'$
 $e = 2.6\%$
 $T.R. = 39.81'$
 $S.E. RUN = 69'$
 $P.C. STA. = 508+86.89$
 $P.T. STA. = 513+70.22$

FILE NAME =	USER NAME = leughlinr1	DESIGNED -	REVISED -	STATE OF ILLINOIS DEPARTMENT OF TRANSPORTATION	PLAN SHEET - SECTION "C" (PEORIA RD.)		F.A.P. RTE. 658	SECTION	COUNTY SANGAMON	TOTAL SHEETS 206	SHEET NO. 117	
ca:\pwwork\pwwid\ot\LAUGHLINR1\dms47718\6572C35-SHT-plan-peoria.dbl.dgn	PLLOT SCALE = 40.0000' / IN.	DRAWN -	REVISED -		SCALE:	SHEET NO. 13 OF 13 SHEETS	STA. TO STA.	ILLINOIS FED. AID PROJECT				
	PLLOT DATE = Apr-30-2010 02:35:03PM	CHECKED -	REVISED -		CONTRACT NO. 72C35							
		DATE -	REVISED -									