

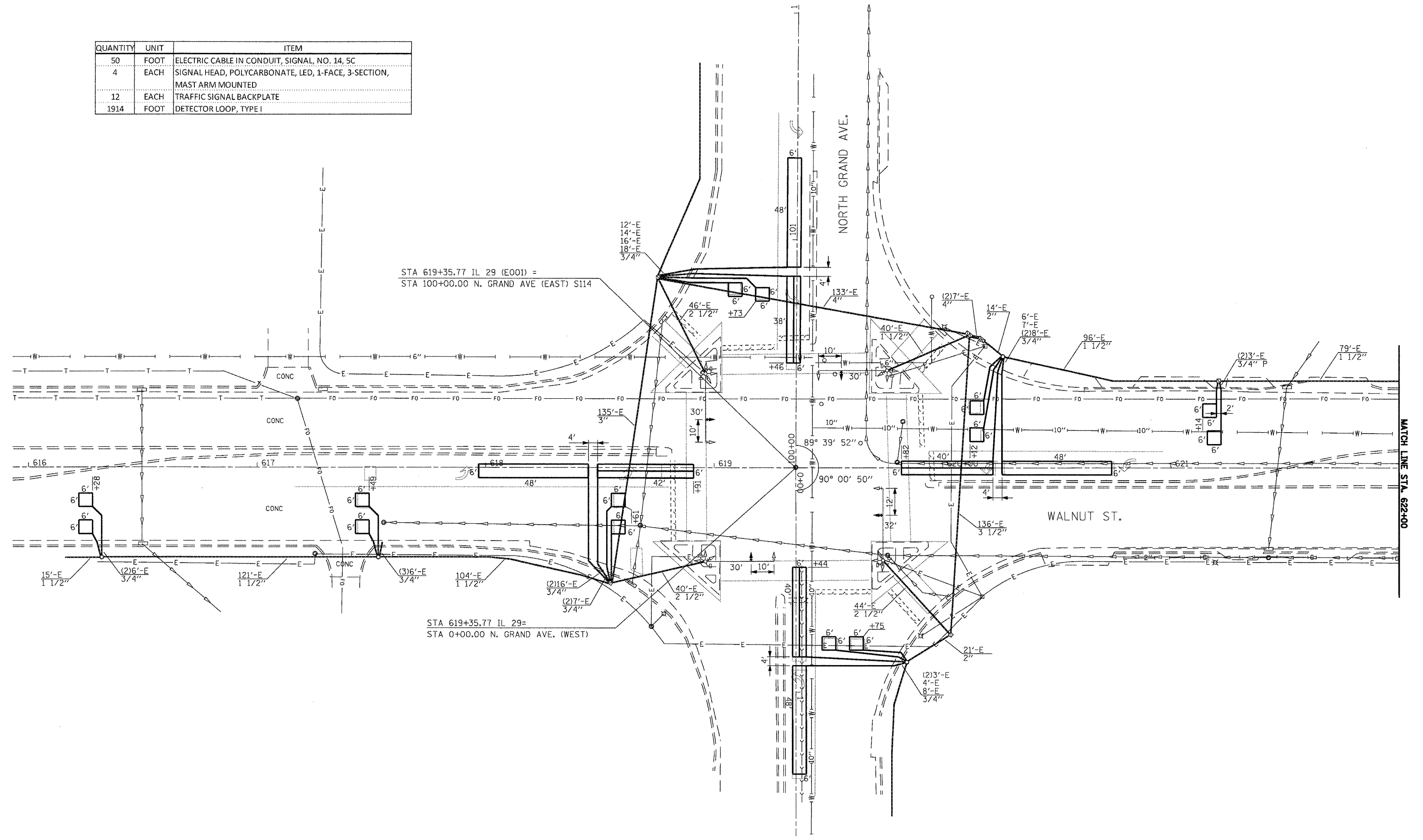

QUANTITY	UNIT	ITEM
50	FOOT	ELECTRIC CABLE IN CONDUIT, SIGNAL, NO. 14, 5C
4	EACH	SIGNAL HEAD, POLYCARBONATE, LED, 1-FACE, 3-SECTION, MAST ARM MOUNTED
12	EACH	TRAFFIC SIGNAL BACKPLATE
1914	FOOT	DETECTOR LOOP, TYPE I



FILE NAME =
 c:\pwwork\pwwid\LAUGHLIN\l\02203328\

USER NAME = laughlinr
 672C35_sht.ta_23.dgn
 PLOT SCALE = 40.0000' / IN.
 PLOT DATE = Apr-29-2010 03:08:27PM

DESIGNED -	REVISED -
DRAWN -	REVISED -
CHECKED -	REVISED -
DATE -	REVISED -

**STATE OF ILLINOIS
 DEPARTMENT OF TRANSPORTATION**

**PROPOSED PLAN
 WALNUT ST. & NORTH GRAND AVE.**

SCALE: SHEET NO. 19 OF 33 SHEETS STA. TO STA.

F.A.P. RTE.	SECTION	COUNTY	TOTAL SHEETS	SHEET NO.
* 1-1RS,TS-1, 27RS-6, 102RS-4		SANGAMON	206	189
* FAP 666 (IL-55), FAP 682 (IL 4)			CONTRACT NO. T2C35	
* FAP 658 (IL 29)			ILLINOIS FED. AID PROJECT	