

EXIST. NB FAI 57
ROADWAY D
EXIST. CURVE I57SRD1
PI STA. = 5009+54.47
Δ = 16° 56' 25" (RT)
D = 1° 43' 33"
R = 3,320.00'
T = 494.41'
L = 981.61'
E = 36.61'
P.C. STA. = 5004+60.06
P.T. STA. = 5014+41.67

EXIST. RAMP G
EXIST. CURVE I70STRG-1
PI STA. = 9+15.54
Δ = 101° 50' 25" (RT)
D = 8° 12' 35"
R = 697.91'
T = 859.40'
L = 854.57'
E = 154.90'
e = 8.00%
T.R. = N/A
S.E. RUN = N/A
P.C. STA. = 0+56.14
P.T. STA. = 12+96.64

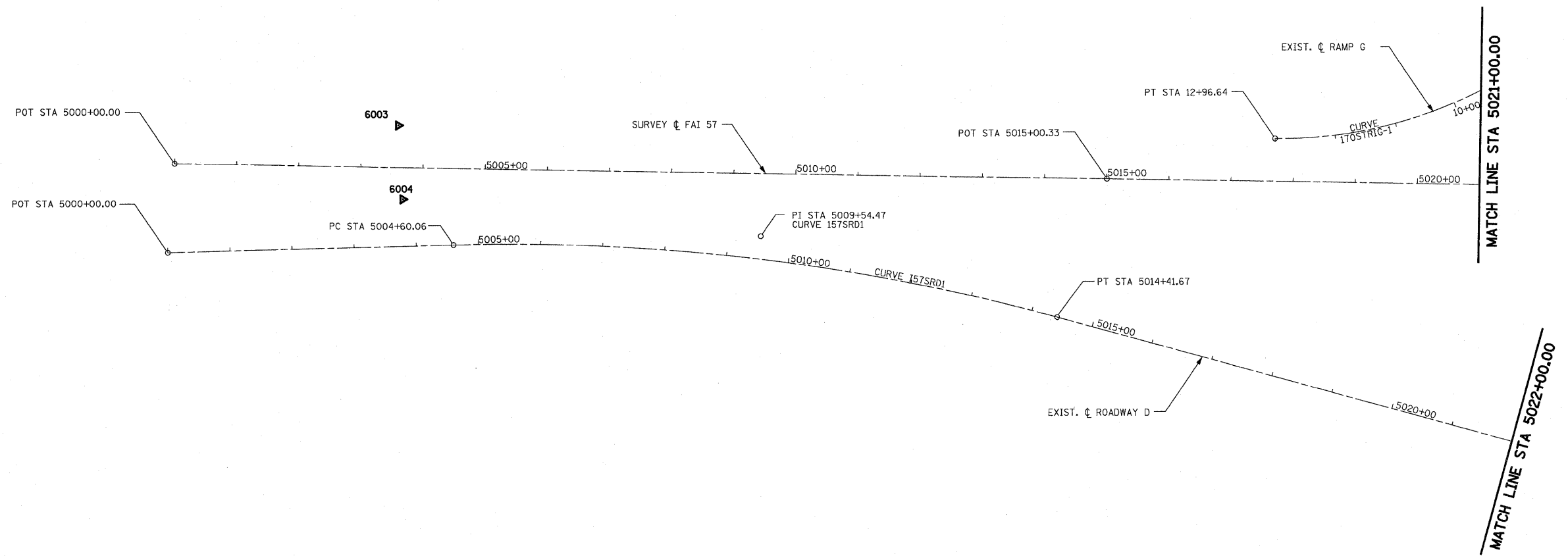

BENCHMARK 511:

CHISELED SQUARE ON EAST CONCRETE BASE OF OVERHEAD SIGN ON I-57/70 "I-70 WEST ST. LOUIS ARROW, CHICAGO & INDIANAPOLIS ARROWS" STA 5021+02 88.2' RT ELEV 574.56

BENCHMARK SS9:

MAG NAIL IN CHISELED SQUARE IN GORE AREA OF ENTRANCE RAMP TO I-57 SOUTHBOUND FROM I-70 EASTBOUND. I-57 STA. 5018+88, 67' LT ELEV 560.98

BENCHMARK SS11:

CHISELED SQUARE WEST CONCRETE FOUNDATION OF OVERHEAD SIGN SOUTH OF RAMP I-57 NORTHBOUND TO I-70 WESTBOUND I-57 NB STA. 5021+00, 60' LT ELEV 572.29

EXISTING SOUTH TRI LEVEL RAMP G

DESCRIPTION	COORDINATE	
	NORTHING	EASTING
PT STA 12+96.64	882951.48	913793.41

EXISTING NB FAI 57 ROADWAY D

DESCRIPTION	COORDINATE	
	NORTHING	EASTING
POT STA 5000+00.00	881160.82	913977.42
PC STA 5004+60.06	881620.70	913964.44
PI STA 5009+54.47	882114.92	913950.50
PT STA 5014+41.67	882591.75	914081.16

SURVEY S SOUTH TRI LEVEL FAI 57

DESCRIPTION	COORDINATE	
	NORTHING	EASTING
POT STA 5000+00.00	881171.80	913833.42
POT STA 5015+00.33	882671.93	913857.90
POT STA 5033+93.16	884564.51	913888.87

CONTROL POINTS

CONTROL POINT	COORDINATE	
	NORTHING	EASTING
6003	881532.52	913770.33
6004	881539.34	913889.36



PERMANENT SURVEY MARKER

FILE NAME =	USER NAME = paul	DESIGNED - JWS	REVISED -	STATE OF ILLINOIS DEPARTMENT OF TRANSPORTATION	HORIZONTAL CONTROL, FAI ROUTE 57			F.A.I. RTE.	SECTION	COUNTY	TOTAL SHEETS	SHEET NO.
S:\Projects\403-0007-57-70\dwg\15 Trk\Net_Lt.dwg		DRAWN - PDB	REVISED -		SCALE: 1"=100'	SHEET NO. 6 OF 10 SHEETS	STA. 5000+00.00 TO STA. 5022+00.00	57/70	(25-3)R	EFFINGHAM	1416	166
		CHECKED - BRM	REVISED -					CONTRACT NO. 74296				
		DATE - 3-04-08	REVISED -					FED. ROAD DIST. NO. [ILLINOIS] FED. AID PROJECT				