

PROPOSED FRONTAGE ROAD 2, CURVE FRO6

PI STA. = 25+80.81
 Δ = 1° 55' 19" (RT)
 D = 1° 41' 07"
 R = 3,400.00'
 T = 57.03'
 L = 114.04'
 E = 0.48'
 P.C. STA. = 25+23.78
 P.T. STA. = 26+37.83

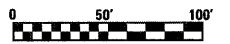

PROFILE SURVEYED BY DATE
 GRADES CHECKED
 NOTE BOOK NO.
 STRUCTURE NOTATIONS C/P/R

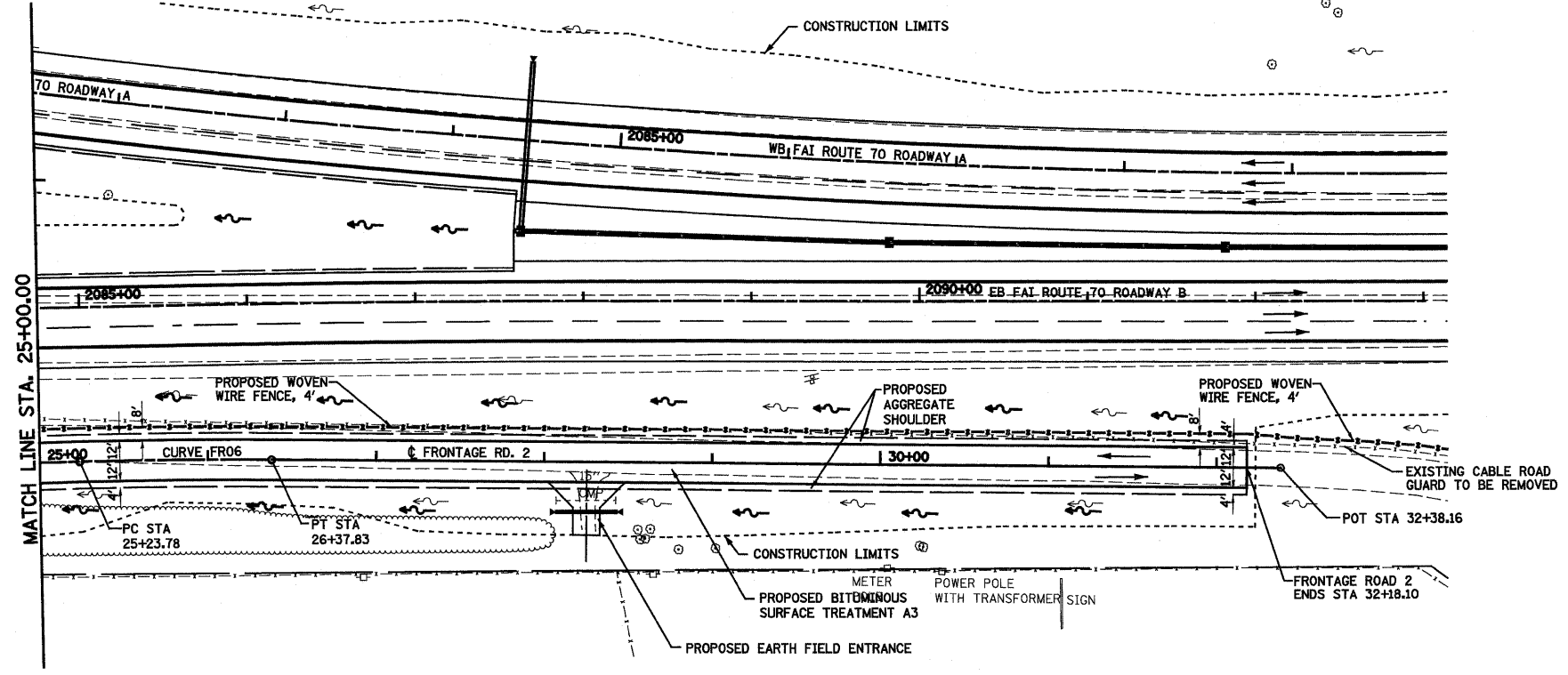
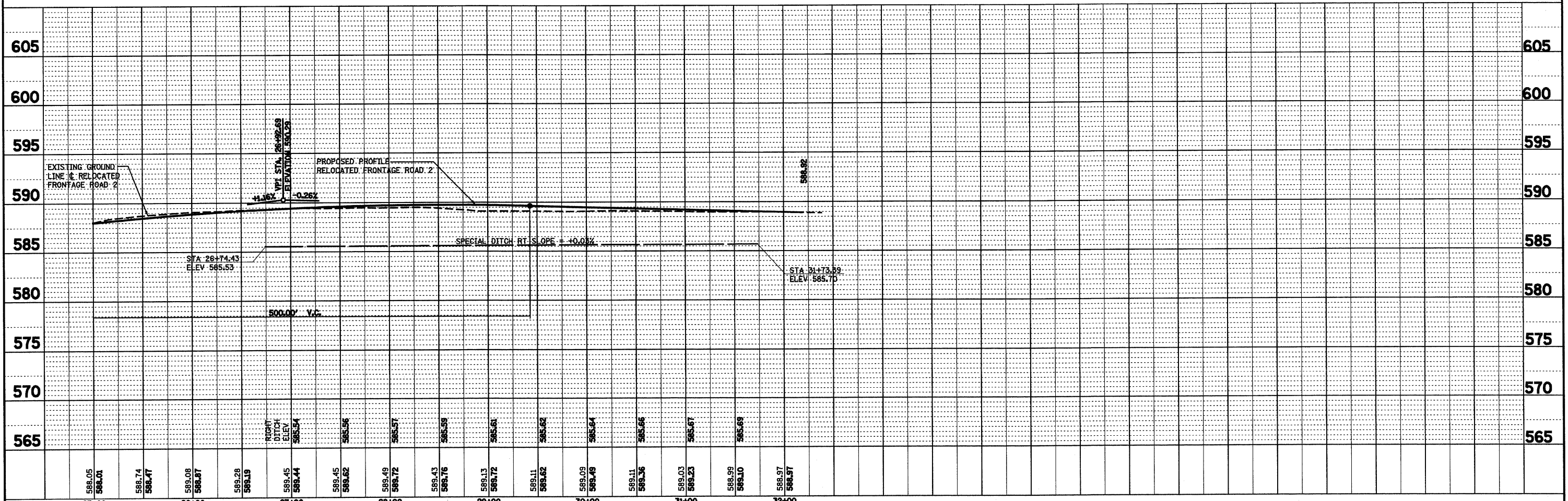

FILE NAME =	USER NAME = paul	DESIGNED - JWS	REVISED -
S:\Project\402\402\57-70\402\15 Trk\VP_Site\Frontage 2.rdp		DRAWN - PDB	REVISED -
		CHECKED - BRM	REVISED -
		DATE - 2-25-08	REVISED -

**STATE OF ILLINOIS
 DEPARTMENT OF TRANSPORTATION**

PLAN AND PROFILE, FRONTAGE ROAD 2

F.A.I. RTE.	SECTION	COUNTY	TOTAL SHEETS	SHEET NO.
57/70	(25-3)R	EFFINGHAM	1416	198
FED. ROAD DIST. NO.			ILLINOIS FED. AID PROJECT	
			CONTRACT NO. 74296	

SCALE: 1"=50' SHEET NO. 27 OF 27 SHEETS STA. 25+00.00 TO STA. 32+00.00