

DATE	
BY	
FINAL SURVEY	
NO. OF SHEETS	
NO. OF PAGES	
NO. OF FIGURES	
NO. OF PLATES	
NO. OF COPIES	
NO. OF REVISIONS	
NO. OF APPROVALS	
NO. OF COMMENTS	
NO. OF CHANGES	
NO. OF DELETIONS	
NO. OF ADDITIONS	
NO. OF CORRECTIONS	
NO. OF REVISIONS	
NO. OF APPROVALS	
NO. OF COMMENTS	
NO. OF CHANGES	
NO. OF DELETIONS	
NO. OF ADDITIONS	
NO. OF CORRECTIONS	

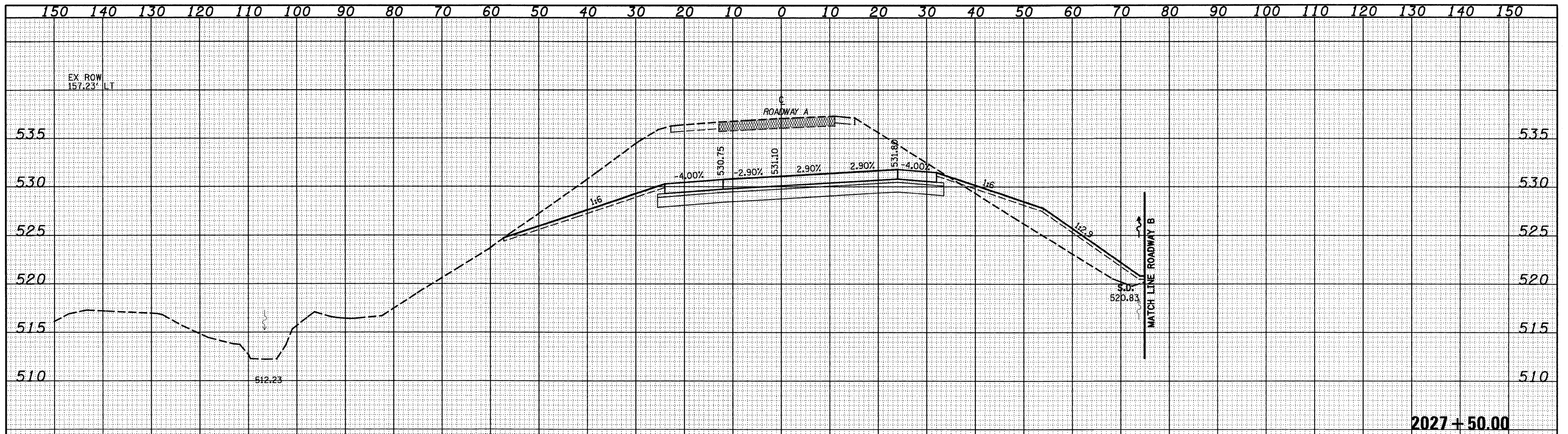

2027+50.00

DATE	
BY	
ORIGINAL SURVEY	
NO. OF SHEETS	
NO. OF PAGES	
NO. OF FIGURES	
NO. OF PLATES	
NO. OF COPIES	
NO. OF REVISIONS	
NO. OF APPROVALS	
NO. OF COMMENTS	
NO. OF CHANGES	
NO. OF DELETIONS	
NO. OF ADDITIONS	
NO. OF CORRECTIONS	
NO. OF REVISIONS	
NO. OF APPROVALS	
NO. OF COMMENTS	
NO. OF CHANGES	
NO. OF DELETIONS	
NO. OF ADDITIONS	
NO. OF CORRECTIONS	

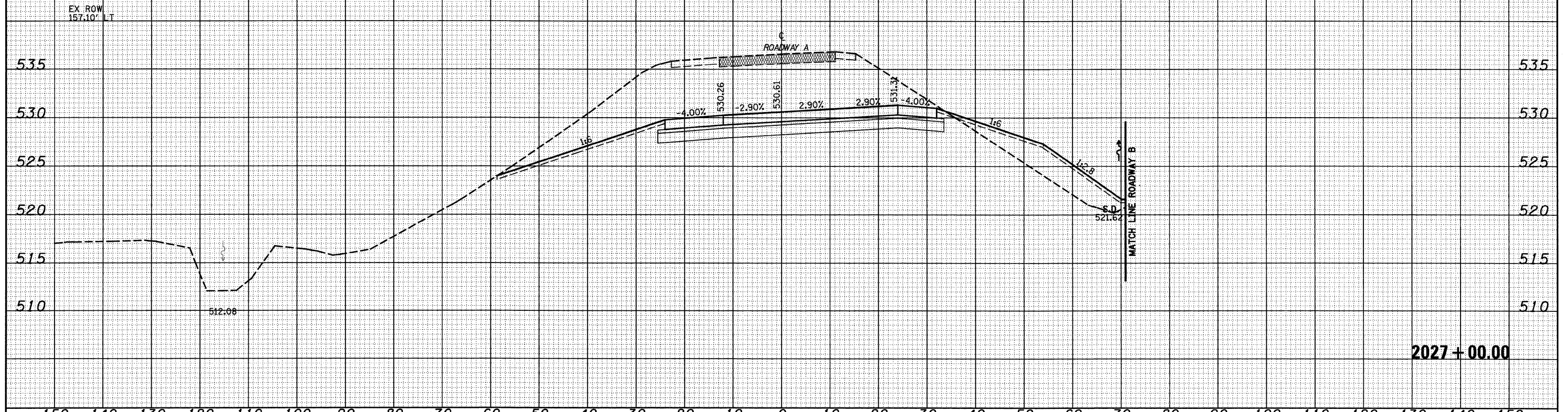

2027+00.00

FILE NAME -	USER NAME - lunda	DESIGNED - JWS	REVISED -	<b>STATE OF ILLINOIS</b> <b>DEPARTMENT OF TRANSPORTATION</b>	<b>CROSS SECTIONS SOUTH TRI LEVEL - ROADWAY A</b>		F.A.I. RTE.	SECTION	COUNTY	TOTAL SHEETS	SHEET NO.	
5:\Projects\103-0007-57-70\p15 Trk\Asst\JWS\08.dwg		DRAWN - LEC	REVISED -		57/70	(25-3)R	EFFINGHAM	1416	632			
PLOT SCALE = 20.00000 ' / IN.		CHECKED - BRM	REVISED -		SCALE: 1"=10'		SHEET NO. 16 OF 125 SHEETS		STA. 2027+00.00 TO STA. 2027+50.00		CONTRACT NO. 74296	
PLOT DATE = 2/9/2010		DATE - 2-25-08	REVISED -		FED. ROAD DIST. NO.		ILLINOIS FED. AID PROJECT					