

FAP ROUTE	SECTION	COUNTY	TOTAL SHEETS	SHEET NO
310	60-16-1&1B,42-1&1B	MADISON AND JERSEY	481	18
STA		TO STA		
EXISTING CONDITIONS:				

CONTRACT NO. 76318

DATE	
BY	
PLAN	
NO.	
NO. BOOK	
NO. SHEET	
NO. CHECKED	
NO. FILE NAME	

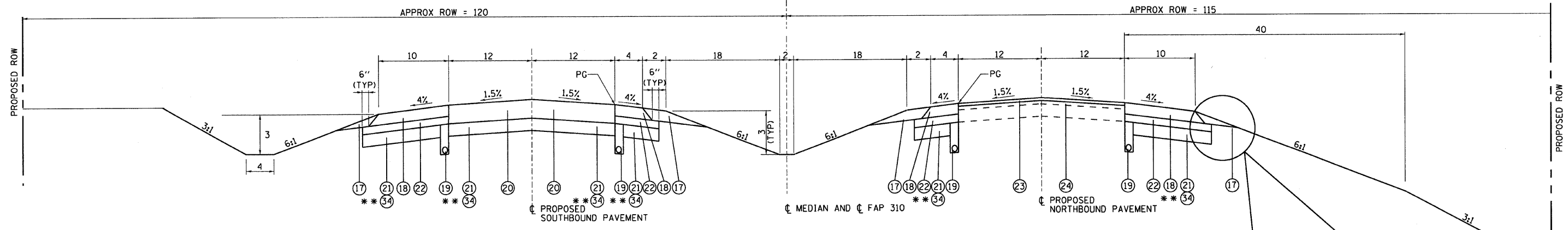

TYPICAL SECTION - FAP 310

STA 233+90 TO STA 243+00.49
 STA 253+60.49 TO STA 256+58.52
 ** STA 280+56.94 TO STA 282+42.53
 ** STA 293+57.47 TO STA 300+10

MATERIAL LEGEND:

- | | |
|--|--|
| ⑰ AGGREGATE SHOULDERS, TYPE B | ⑳ AGGREGATE BASE COURSE, TYPE B, 8" |
| ⑱ HOT-MIX ASPHALT SHOULDERS, 8" | ㉑ BITUMINOUS SURFACE TREATMENT, CLASS A-2 |
| ㉒ PIPE UNDERDRAIN 4" | ㉒ AGGREGATE BASE COURSE, TYPE A, 10 1/2" |
| ㉓ HOT-MIX ASPHALT PAVEMENT (FULL DEPTH) 14" | ㉓ AGGREGATE BASE COURSE, TYPE A, 10 3/4" |
| ㉔ LIME MODIFIED SOILS 12" | ㉔ AGGREGATE BASE COURSE, TYPE A, 17" |
| ㉕ SUBBASE GRANULAR MATERIAL, TYPE C 6" | ㉕ AGGREGATE SURFACE COURSE, TYPE A, 11" |
| ㉖ HOT-MIX ASPHALT SURFACE COURSE, MIX "D", N90, 1 1/2" | ㉖ AGGREGATE SURFACE COURSE, TYPE A, 11 1/2" |
| ㉗ HOT-MIX ASPHALT BINDER COURSE, IL-19.0, N90, 3 1/2" AND VARIES IN SUPERELEVATED SECTIONS | ㉗ SUBBASE GRANULAR MATERIAL TYPE B 12" |
| ㉘ HOT-MIX ASPHALT SURFACE COURSE, MIX "C", N70, 1 1/2" | ㉘ STRIP REFLECTIVE CRACK CONTROL TREATMENT |
| ㉙ LEVELING BINDER (MACHINE METHOD), N70, 1 1/2" | ㉙ HOT-MIX ASPHALT BINDER COURSE, IL-19.0, N90, 12" |
| | ㉚ AGGREGATE SURFACE COURSE, TYPE B, 6" |
| | ㉛ HOT-MIX ASPHALT BINDER COURSE, IL-19.0, N70, 12" |

ALL UNITS ARE IN FEET
UNLESS OTHERWISE SHOWN

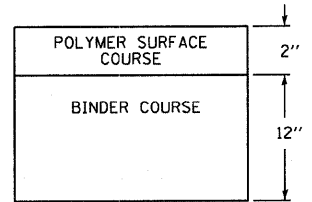

FULL DEPTH PAVEMENT DETAIL

NOTE:
SAW CUT AND REMOVE HMA WEDGE PRIOR TO INSTALLATION OF PIPE UNDERDRAINS, 4"

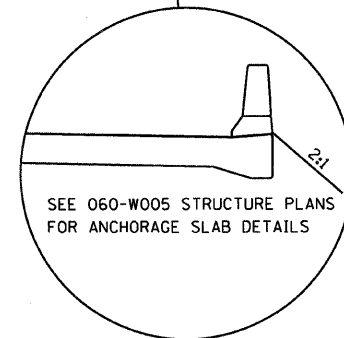

DETAIL OF ANCHORAGE SLAB

(NOT TO SCALE)

STA 228+68.75 TO STA 231+60 RT

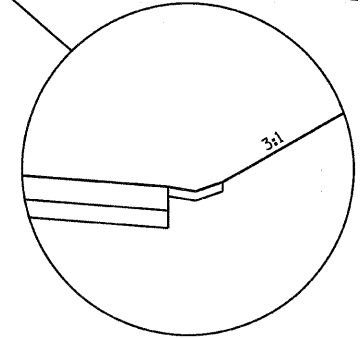

DETAIL OF TYPE B GUTTER

(NOT TO SCALE)

STA 271+44 TO STA 273+18 RT

STRUCTURAL DESIGN TRAFFIC:	Year <u>2014</u>
Pv= <u>14,811</u>	SU= <u>1,022</u> MU= <u>1,192</u>
ROAD/STREET CLASSIFICATION:	Class: <u>I</u>
PERCENT OF STRUCTURAL DESIGN TRAFFIC IN DESIGN LANE:	P= <u>32%</u> S= <u>45%</u> M= <u>45%</u>
TRAFFIC FACTOR:	Actual TF= <u>6.41</u> AC Type= <u>20</u>
	Minimum TF= <u>4.27</u>
PG GRADE: Binder= _____	Surface= _____
SUBGRADE SUPPORT RATING:	
SSR= <u>POOR</u> (Sta. _____ to _____)	
SSR= _____ (Sta. _____ to _____)	

REVISIONS	
NAME	DATE

ILLINOIS DEPARTMENT OF TRANSPORTATION
PROPOSED TYPICAL SECTIONS
 FAP ROUTE 310
 SECTION 60-16-1&1B,42-1&1B
 MADISON AND JERSEY COUNTIES
 DRAWN BY: DLB CHECKED BY: GLF