

FAP NO.	SECTION	COUNTY	TOTAL SHEETS	SHEET NO.
310	60-16-1&1B,42-1&1B	MADISON AND JERSEY	481	59

STA. TO STA.

EXISTING CONDITIONS:

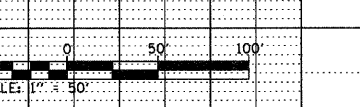

PLAN	SURVEYED	BY	DATE
	PLOTTED		
	NOTED		
	NOTE BOOK		
	NO.		

PROF FILE	SURVEYED	BY	DATE
	PLOTTED		
	NOTED		
	NOTE BOOK		
	NO.		

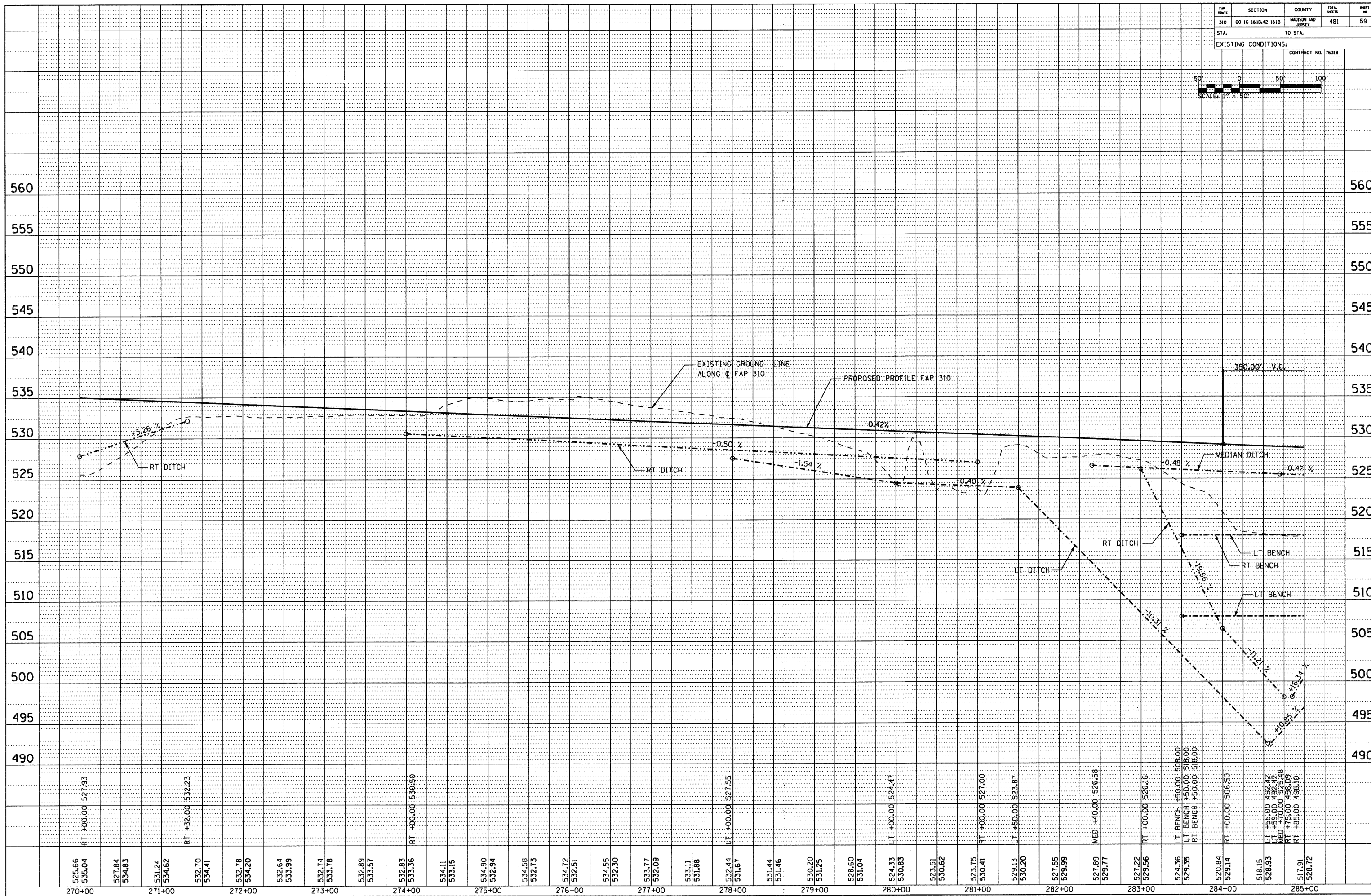

270+00 525.66 RT +00.00 527.93 271+00 531.24 534.62 532.70 534.41 272+00 532.78 534.20 273+00 532.64 533.99 532.74 533.78 532.89 533.57 274+00 532.83 533.36 RT +00.00 530.50 534.11 533.15 275+00 534.90 532.94 534.58 532.73 534.72 532.51 534.55 532.30 533.77 532.09 533.11 531.88 532.44 LT +00.00 527.55 531.67 531.44 531.46 530.20 531.25 528.60 531.04 524.33 LT +00.00 524.47 530.83 523.51 530.62 523.75 530.41 RT +00.00 527.00 529.13 LT +50.00 523.87 530.20 527.55 529.99 527.89 529.77 MED +40.00 526.58 527.22 529.56 RT +00.00 526.16 524.36 LT BENCH +50.00 506.00 529.35 LT BENCH +50.00 518.00 RT BENCH +50.00 518.00 520.84 529.14 RT +00.00 506.50 518.15 528.93 LT +55.00 492.42 LT +59.00 492.42 MED +70.00 492.48 RT +75.00 498.08 RT +85.00 498.10 517.91 528.72

STA 270+00 TO STA 285+00