

FAP ROUTE	SECTION	COUNTY	TOTAL SHEETS	SHEET NO.
60-16-1&1B, 42-1&1B	MADISON/JERSEY	481	60	
STA.	TO STA.	CONTRACT NO. 76318		

EXISTING CONDITIONS:

- ① MANHOLE, TYPE A, 5' DIA W/TY 1 CL LID STA 294+68.6, 151.0' LT RIM ELEV 498.85
- ② PIPE CULVERTS, CLASS A, TYPE 5, 24" STA 295+65 SKEW 31.8° RT AHD 24" X 40' USFL STA 294+67.9, 152.0' LT ELEV 484.5 DSFL STA 294+46.8, 185.7' LT ELEV 484.01 CIP RC END SEC 24, STANDARD 542201 30° DA = 6.6 ACRES O50 = 15.2 CFS HWE 505.3 O100 = 17.4 CFS HWE 505.6
- ③ PIPE CULVERTS, CLASS A, TYPE 6, 24" STA 295+65 SKEW 31.8° RT AHD 24" X 149' USFL STA 295+49.3, 22.0' LT, ELEV 497.84 DSFL STA 294+70.2, 148.3' LT, ELEV 493.65 DA = 6.6 ACRES O50 = 15.2 CFS HWE 505.3 O100 = 17.4 CFS HWE 505.6
- ④ PIPE CULVERTS, CLASS A, 24" (JACKED) STA 295+65 SKEW 31.8° RT AHD 24" X 138' USFL STA 296+22.1, 94.1' RT, ELEV 501.85 DSFL STA 295+49.3, 22.0' LT, ELEV 497.95 DA = 6.6 ACRES O50 = 15.2 CFS HWE 505.3 O100 = 17.4 CFS HWE 505.6
- ⑤ PIPE CULVERTS, CLASS A, TYPE 3, 24" STA 295+65 SKEW 31.8° RT AHD 24" X 39' USFL STA 296+42.6, 126.8' RT, ELEV 502.89 DSFL STA 296+22.1, 94.1' RT, ELEV 501.64 CIP RC END SEC 24, STANDARD 542201 30° DA = 6.6 ACRES O50 = 15.2 CFS HWE 505.3 O100 = 17.4 CFS HWE 505.6

DATE	
BY	
REVISIONS	
NOTED	
ALTERNATE CHECKED	
ADD FILE NAME	
PLAN	
NO.	

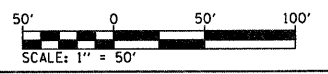
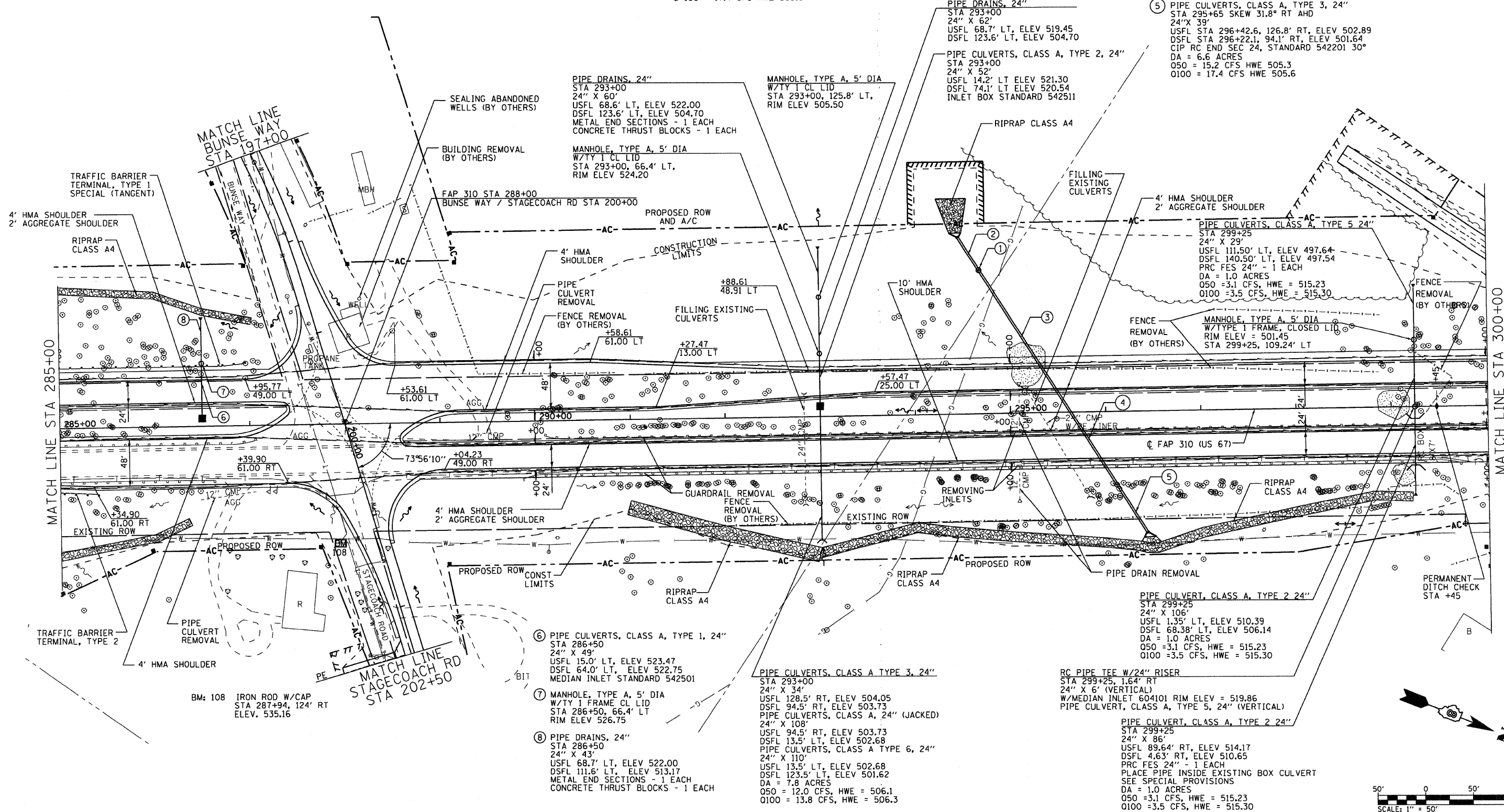

ILLINOIS DEPARTMENT OF TRANSPORTATION
ROADWAY PLAN STA 285+00 TO 300+00
 FAP ROUTE 310
 SECTION 60-16-1&1B, 42-1&1B
 MADISON/JERSEY COUNTY
 DRAWN BY: EMR
 CHECKED BY: GLF

REVISIONS	
NAME	DATE