

FAP ROUTE	SECTION	COUNTY	TOTAL SHEETS	SHEET NO.
310	60-16-1&1B,42-1&1B	MADISON AND JERSEY	481	80
STA	TO STA			
EXISTING CONDITIONS:				

CONTRACT NO. 76318



R1-1-3636

PLAN	SUBMITTED	DATE
NOTE BOOK	PLOTTED	
NO.	ALIGNED	
	CHECKED	
	CADD FILE NAME	

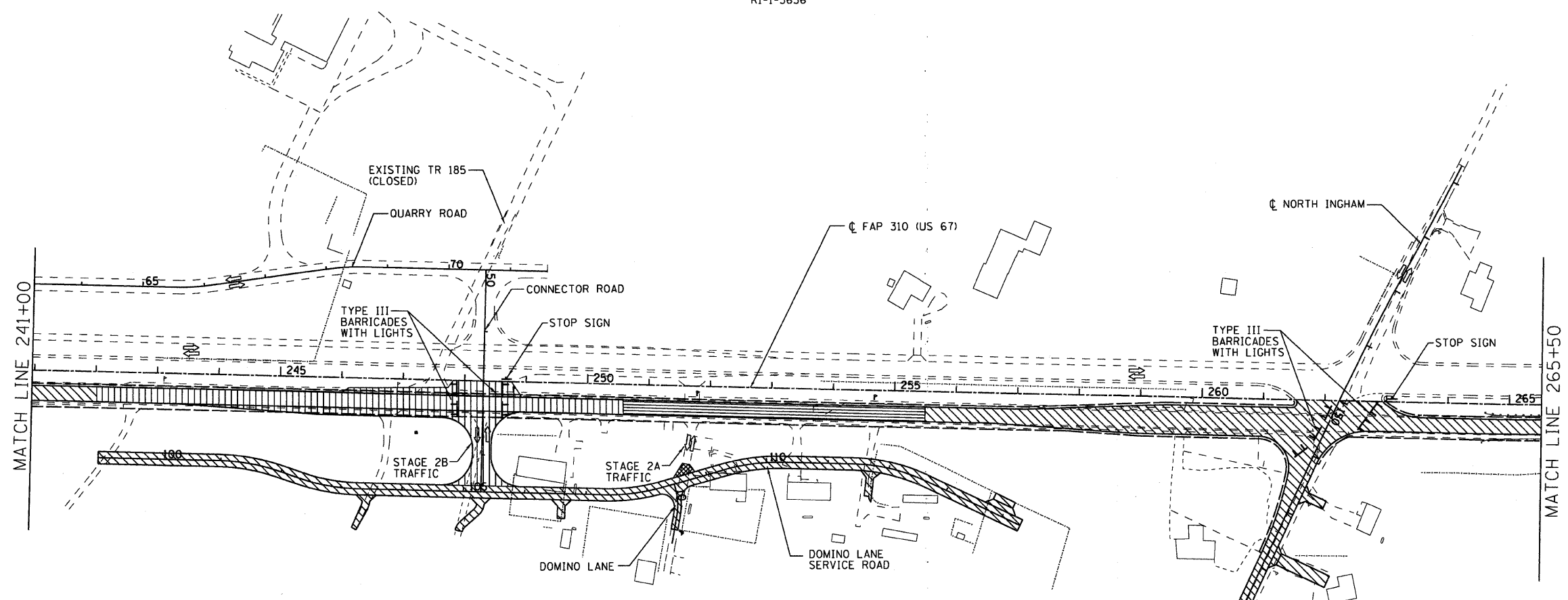

**CONSTRUCTION STAGING AND MAINTENANCE OF TRAFFIC**

**STAGE 2A**

MAINTAIN TRAFFIC ON THE NEWLY CONSTRUCTED SOUTHBOUND LANES OF FAP 310. CONSTRUCT THE PROPOSED FAP 310 NORTHBOUND LANES, EASTERN PORTION OF THE CONNECTOR ROAD, EASTERN PORTION OF NORTH INGHAM, DOMINO LANE SERVICE ROAD, DOMINO LANE, AND INGHAM ACCESS DRIVE AS SHOWN.

1. THE PROPOSED NORTHBOUND LANES OF FAP 310 PAVEMENT SHALL BE GAPPED FROM APPROXIMATELY STATION 242+00 TO STATION 255+50 UNTIL TRAFFIC HAS BEEN MOVED TO THE DOMINO LANE SERVICE ROAD. THE CONSTRUCTION OF THE INTERSECTION OF DOMINO LANE SERVICE ROAD WITH DOMINO LANE SHALL BE ACCOMPLISHED BY MEANS OF GAP PAVING AND STAGE CONSTRUCTION ONE LANE AT A TIME. DOMINO LANE SERVICE ROAD SHALL BE CONSTRUCTED IN SEQUENTIAL PHASES BEGINNING NORTH AND SOUTH FROM DOMINO LANE. DURING THE CONSTRUCTION OF DOMINO LANE SERVICE ROAD, ACCESS TO THE AFFECTED RESIDENCES SHALL BE MAINTAINED WITH TEMPORARY GRAVEL SURFACES CONNECTING THE DRIVEWAYS TO THE SEVERED ROADWAY ACROSS DOMINO LANE SERVICE ROAD. ACCESS FROM DOMINO LANE TO FAP 310 SHALL BE MAINTAINED UTILIZING TYPE III BARRICADES AS SHOWN.
2. NORTH INGHAM EAST OF FAP 310 SHALL BE CONSTRUCTED IN SEQUENTIAL PHASES TO MAXIMIZE ACCESS TO THE LOCAL RESIDENCES. ACCESS TO THE EAST AND TO THE WEST OF THE CONSTRUCTION PHASES SHALL BE ALLOWED. ACCESS THROUGH THE AREA BEING CONSTRUCTED SHALL NOT BE ALLOWED. DURING THIS TIME ACCESS TO FAP 310 FROM EAST OF THE CONSTRUCTION WILL BE VIA ALTERNATE ROADS TO THE NORTH AND SOUTH. DURING CONSTRUCTION OF NORTH INGHAM, TRAFFIC SHALL BE MAINTAINED ACROSS THE PROPOSED NORTHBOUND LANES OF FAP 310 UTILIZING TYPE III BARRICADES AS SHOWN. TRAFFIC SHALL BE MAINTAINED ON THE EASTERN PORTION OF NORTH INGHAM IN ACCORDANCE WITH THE APPLICABLE PORTIONS OF LOCAL ROAD STANDARD BLR-22.

**STAGE 2B**

MAINTAIN TRAFFIC ON THE NEWLY CONSTRUCTED SOUTHBOUND LANES OF FAP 310. MAINTAIN LOCAL TRAFFIC ON THE NEWLY CONSTRUCTED DOMINO LANE SERVICE ROAD. CONSTRUCT THE STAGE 2B PORTION OF THE PROPOSED FAP 310 NORTHBOUND LANES AND THE DOMINO LANE SERVICE ROAD CONNECTION TO FAP 310 AS SHOWN.

1. THE PROPOSED NORTHBOUND LANES OF FAP 310 PAVEMENT SHALL BE GAPPED FROM APPROXIMATELY STATION 250+50 TO STATION 255+50 UNTIL TRAFFIC HAS BEEN ESTABLISHED ON THE PROPOSED CONNECTOR ROAD. DURING CONSTRUCTION OF THE PROPOSED FAP 310 NORTHBOUND LANES, TRAFFIC SHALL BE MAINTAINED ACROSS THE PROPOSED NORTHBOUND LANES OF FAP 310 UTILIZING TYPE III BARRICADES AS SHOWN.

**STAGE 2C**

MAINTAIN TRAFFIC ON THE NEWLY CONSTRUCTED SOUTHBOUND LANES OF FAP 310. MAINTAIN TRAFFIC ACROSS THE PROPOSED NORTHBOUND LANES OF FAP 310 TO THE CONNECTOR ROAD UTILIZING TYPE III BARRICADES. CONSTRUCT THE REMAINING SEGMENT OF FAP 310 AS SHOWN.

**LEGEND**

- TEMPORARY PAVEMENT
- WORK ZONE STAGE 2A
- WORK ZONE STAGE 2B
- WORK ZONE STAGE 2C
- DIRECTION OF TRAFFIC
- TYPE III BARRICADES

REVISIONS	
NAME	DATE

ILLINOIS DEPARTMENT OF TRANSPORTATION  
**MAINTENANCE OF TRAFFIC**  
**STAGE 2**  
 FAP ROUTE 310  
 SECTION 60-16-1&1B,42-1&1B  
 MADISON AND JERSEY COUNTY  
 DESIGNED BY: WTS  
 CHECKED BY: GLF  
 DRAWN BY: EMR  
 CHECKED BY: WTS

