

FAP ROUTE	SECTION	COUNTY	TOTAL SHEETS	SHEET NO.
310	60-16-1&18,42-1&18	MADISON AND JERSEY	481	88
STA. _____		TO STA. _____		
EXISTING CONDITIONS:				

CONTRACT NO. 76318

PLAN	SURVEYED	BY	DATE
	PLOTTED		
	CHECKED		
	NO. OF DAYS CHECKED		
	CADD FILE NAME		

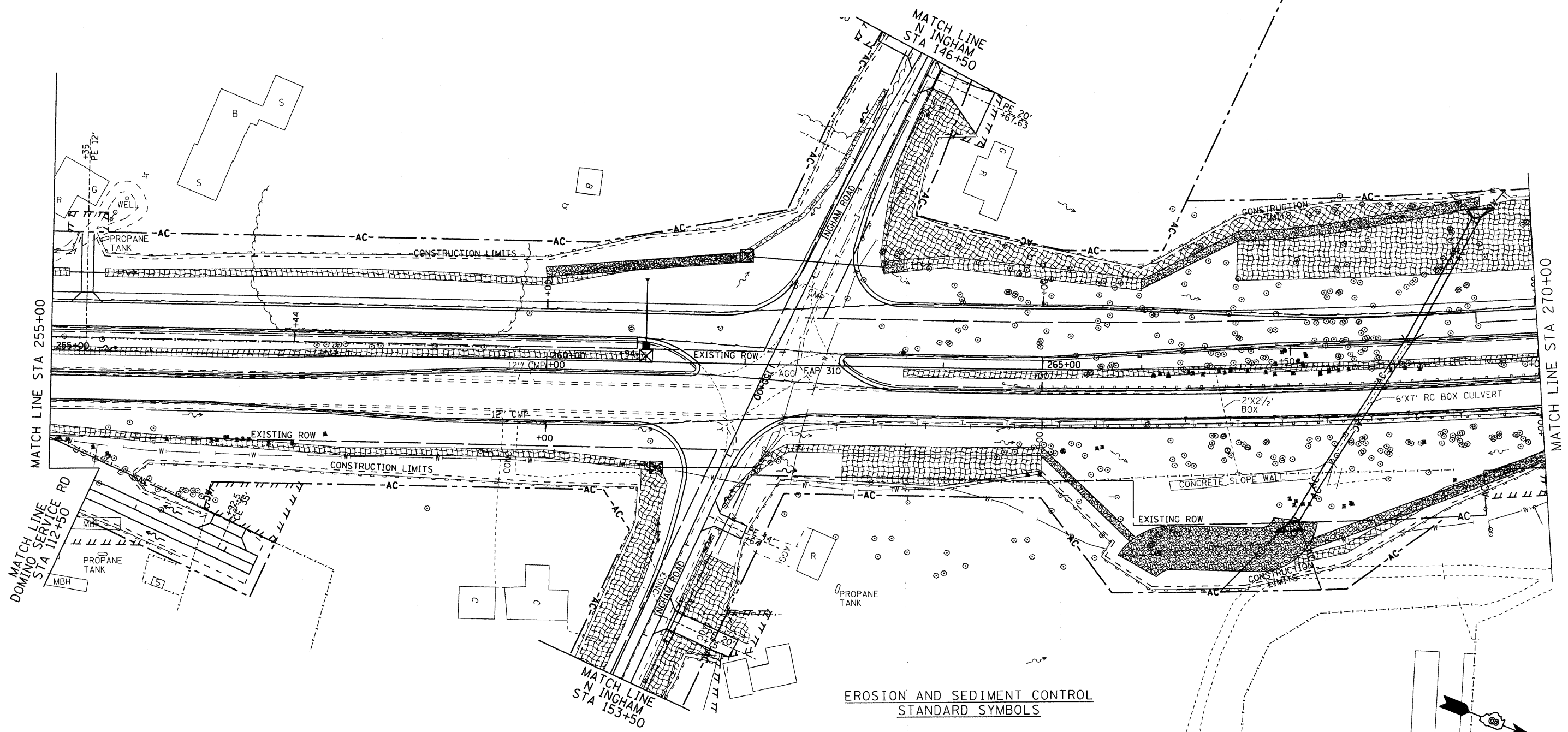

- EROSION AND SEDIMENT CONTROL STANDARD SYMBOLS**
- PERIMETER EROSION BARRIER - SILT FILTER FENCE, OR OTHER AS APPROVED BY THE ENGINEER
 - EROSION CONTROL BLANKET
 - FLOW LINES
 - INLET AND PIPE PROTECTION - STRAW BALES, FILTER FABRIC, AGGREGATES
 - PERMANENT EARTH BERM DITCH CHECK
 - RIPRAP

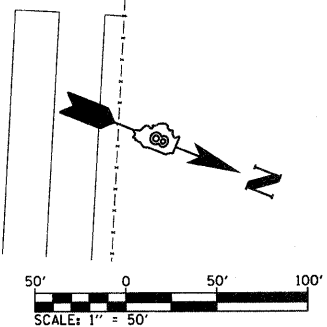

ILLINOIS DEPARTMENT OF TRANSPORTATION

EROSION CONTROL PLAN
STA 255+00 TO 270+00

FAP ROUTE 310
SECTION 60-16-1&18,42-1&18
MADISON/JERSEY COUNTY

DRAWN BY: EMR CHECKED BY: GLF

REVISIONS	
NAME	DATE