

CONTROL POINT #13

REBAR & CAP
N. 688965.70
E. 2315805.75
ELEV. 422.84

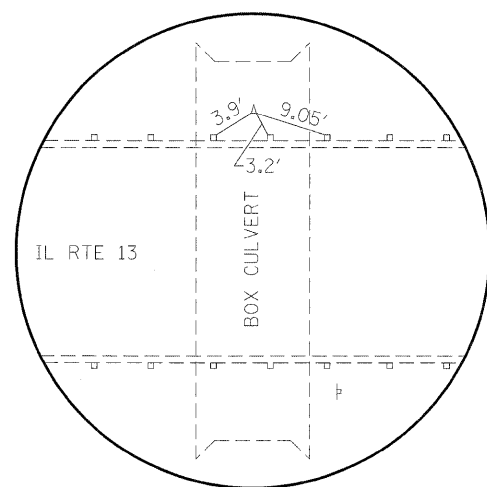

CONTROL POINT #14

REBAR & CAP
N. 689405.53
E. 2315429.83
ELEV. 422.32

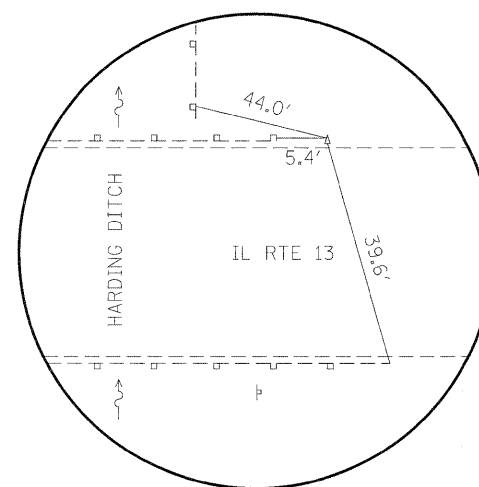

CONTROL POINT #15

REBAR & CAP
N. 689915.76
E. 2314957.81
ELEV. 414.23

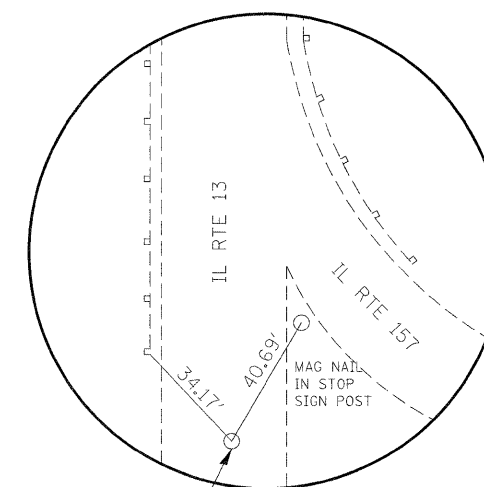

PCC STA 421+74.44

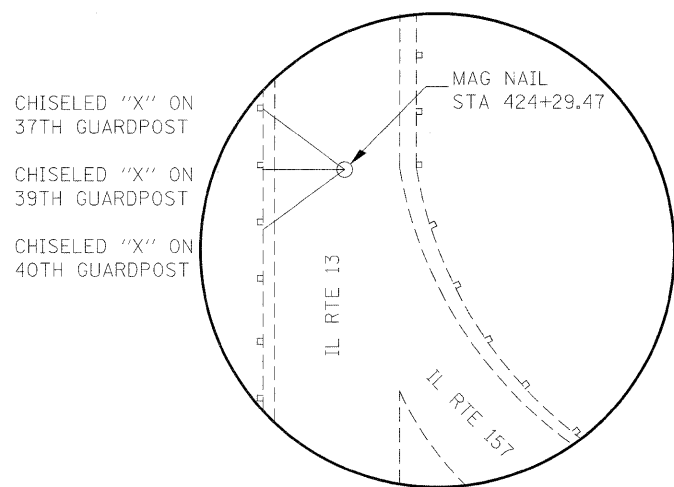

PT STA 424+29.47

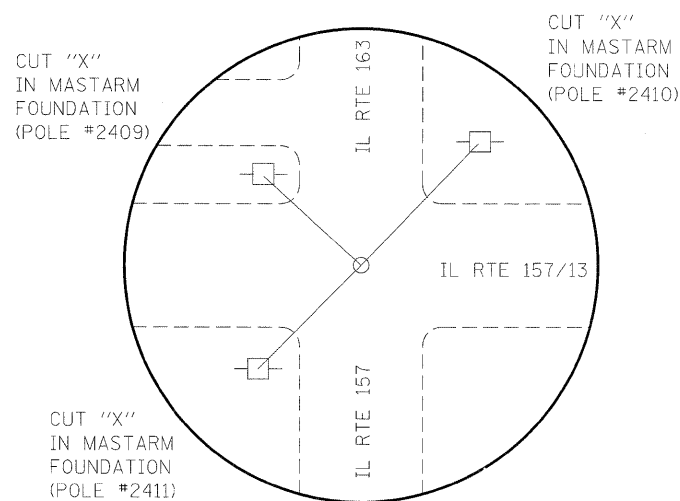

STA 441+11.84

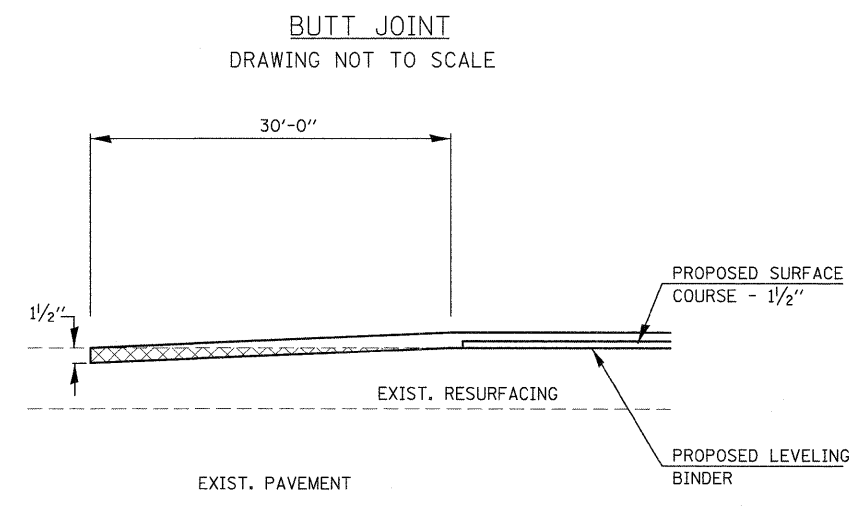

NOTES:
NOT TO SCALE.
ALL MEASUREMENTS ARE PULLED DIRECT, UNLESS OTHERWISE NOTED.

FILE NAME =	USER NAME = gelinh	DESIGNED -	REVISED -
ca:\pwork\pwork\GELINH\0146285\d8768-8-sh-t-plan.dgn		DRAWN -	REVISED -
PLOT SCALE = 50.0000' / IN.		CHECKED -	REVISED -
PLOT DATE = 3/18/2010		DATE -	REVISED -

STATE OF ILLINOIS
DEPARTMENT OF TRANSPORTATION

TIE POINT / BUTT JOINT DETAILS

SCALE: SHEET NO. 1 OF 1 SHEETS STA. TO STA.

F.A.P. RTE.	SECTION	COUNTY	TOTAL SHEETS	SHEET NO.
592	121-IRS-2	ST CLAIR	13	6
CONTRACT NO. 76D18				

FED. ROAD DIST. NO. ILLINOIS FED. AID PROJECT