

STATE OF ILLINOIS
DEPARTMENT OF TRANSPORTATION
DIVISION OF HIGHWAYS

**PROPOSED
HIGHWAY PLANS**

**FAU ROUTE 9257 (NORTHBELT WEST)
SECTION (28-1, 122-1)RS-1
PROJECT : *ACM-9257(005)*
3P - RESURFACING
ST. CLAIR COUNTY**

C-98-036-10

INDEX OF SHEETS

1. COVER SHEET
2. GENERAL NOTES, STANDARDS, COMMITMENTS
3. SUMMARY OF QUANTITIES
4. - 5. ROADWAY LAYOUT
6. - 9. SCHEDULES
10. - 17. TYPICAL SECTIONS
18. - 28. PLAN SHEET
29. - 39. PAVEMENT MARKING SHEETS
40. - 42. TRAFFIC SIGNAL SHEETS
43. DETAILS SHEET

F.A.U. R.T.E.	SECTION	COUNTY	TOTAL SHEETS	SHEET NO.
9257	122-1, 122-1RS-1	ST. CLAIR	43	3
		ILLINOIS	CONTRACT NO. 76D58	

D-98-023-10

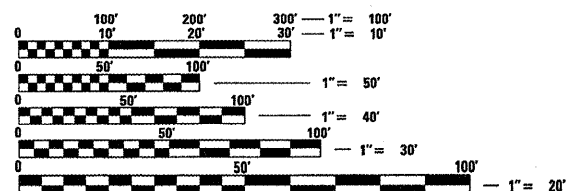
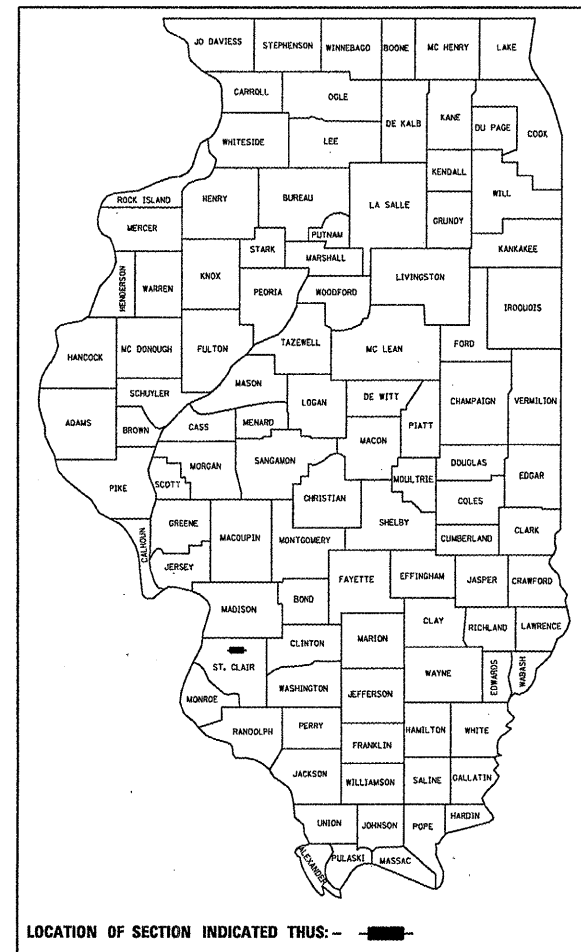

FULL SIZE PLANS HAVE BEEN PREPARED USING STANDARD ENGINEERING SCALES. REDUCED SIZED PLANS WILL NOT CONFORM TO STANDARD SCALES. IN MAKING MEASUREMENTS ON REDUCED PLANS, THE ABOVE SCALES MAY BE USED.

J.U.L.I.E.
JOINT UTILITY LOCATION INFORMATION FOR EXCAVATION
1-800-892-0123
OR 811

PROJECT ENGINEER: PATTI LEBEAU (618)-346-3179
PROJECT MANAGER: CHERYL KEPLAR (618)-346-3186

CONTRACT NO. 76D58

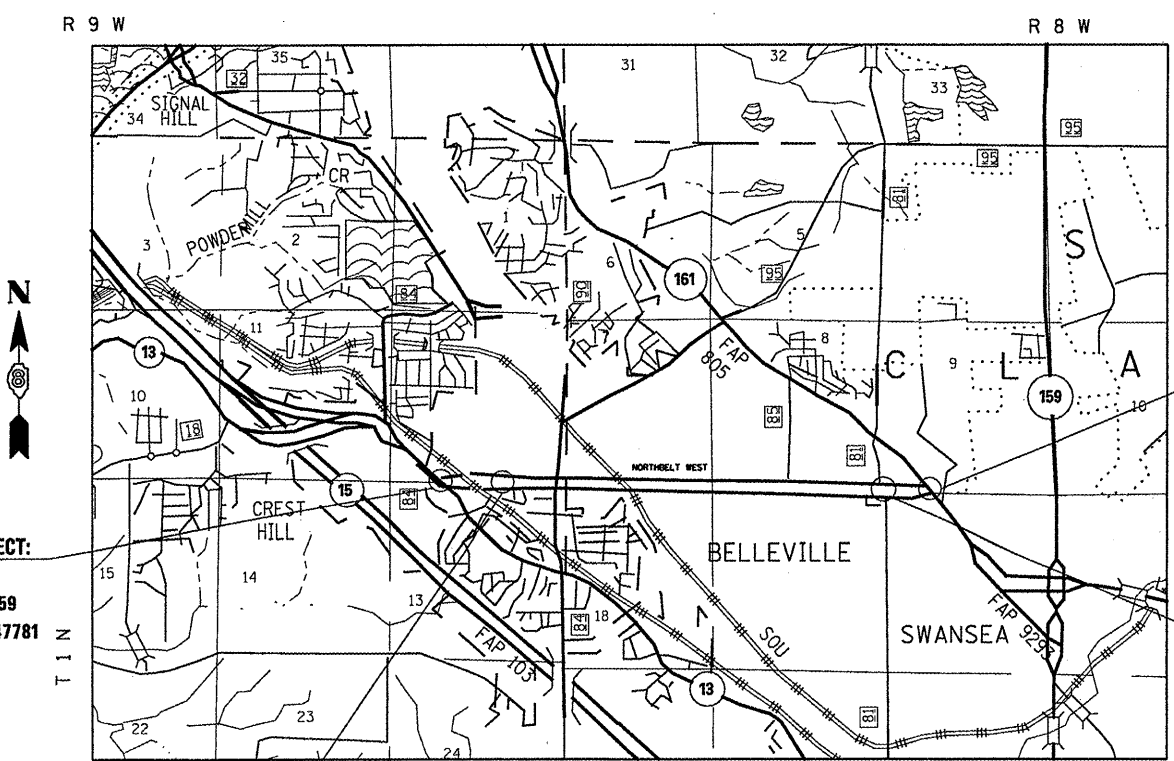

BEING PROJECT:
STA. 251+35
LAT: 38.542359
LONG: -90.047781

STATION EQUATION:
STA. 236+66.33 =
STA. 122+00.00

GROSS LENGTH = 15,177.33 FT. = 2.87 MILES
NET LENGTH = 15,114.33 FT. = 2.86 MILES

ADT	
2009	= 19500
2010	= 19700
2030	= 24000
S.U.	= 1.8%
M.U.	= 1.4%

END PROJECT:
STA. 261+46
(FULLERTON RD)
LAT: 38.541699
LONG: -89.996529

OMISSION:
IL 161
STA. 258+75 TO
STA. 259+74

STATE OF ILLINOIS
DEPARTMENT OF TRANSPORTATION
DIVISION OF HIGHWAYS

SUBMITTED *May 6* 2010

Mary C. Jamie
DEPUTY DIRECTOR OF HIGHWAYS, REGION 5 ENGINEER

June 25 2010
Scott E. Stitt, P.E.
ENGINEER OF DESIGN AND ENVIRONMENT

June 25 2010
Christine M. Reed
DIRECTOR OF HIGHWAYS, CHIEF ENGINEER

PRINTED BY THE AUTHORITY
OF THE STATE OF ILLINOIS