

PROPOSED TYPICAL SECTION
 STA. 237+50 TO STA. 236+66.63
 STA. 122+00 TO STA. 139+36
 STA. 166+57 TO STA. 174+57

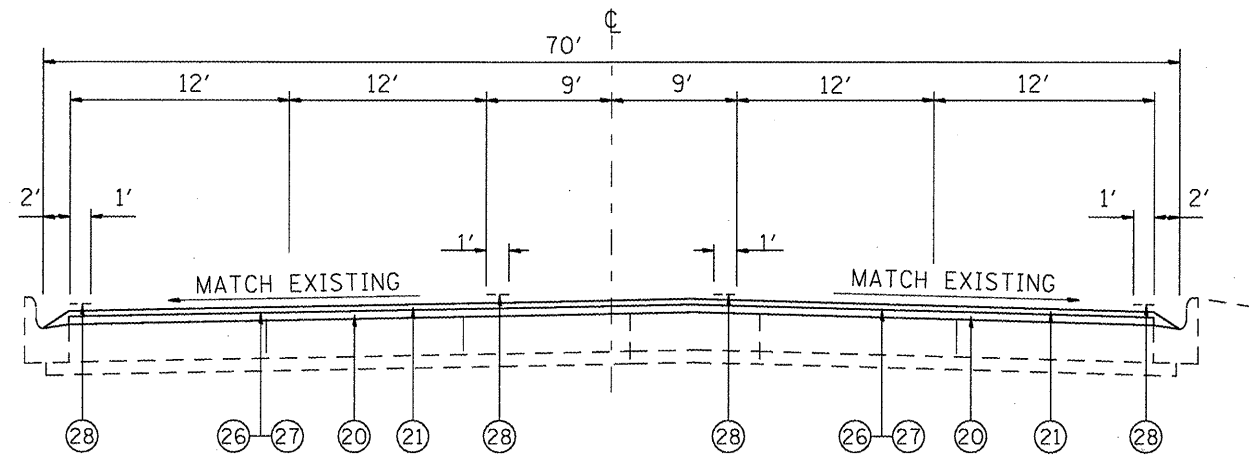

PROPOSED TYPICAL SECTION
 STA. 151+90 TO STA. 164+39
 STA. 179+77 TO STA. 197+95

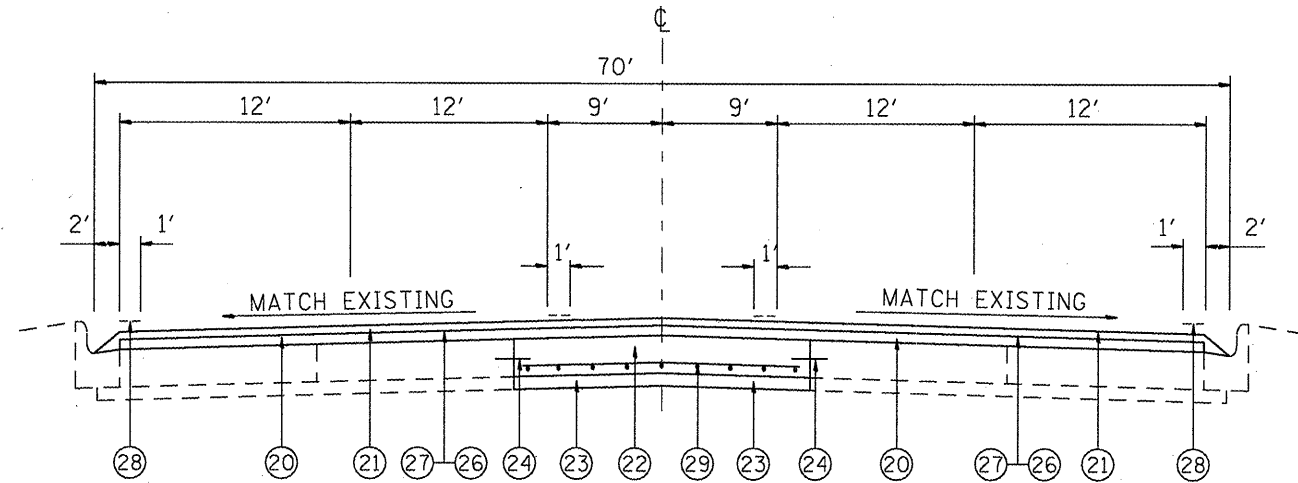

PROPOSED TYPICAL SECTION
 STA. 139+36 TO STA. 151+90
 STA. 164+39 TO STA. 166+57
 STA. 174+57 TO STA. 179+77
 STA. 197+95 TO STA. 202+19
 STA. 215+35 TO STA. 219+24
 STA. 229+00 TO STA. 231+67
 STA. 241+48 TO STA. 246+04
 STA. 252+73 TO STA. 256+28
 (END OF P.C.C. PAVEMENT)

- ①9 PROPOSED LEVELING BINDER 3/4"
- ②0 PROPOSED LEVELING BINDER 1"
- ②1 PROPOSED POLY-HMA SURFACE COURSE, MIX D, 1 1/2"
- ②2 PROPOSED CLASS "C", PATCHING 10"
- ②3 PROPOSED SUB-BASE GRANULAR MATERIAL, TYPE A., 4"
- ②4 PROPOSED 3/4" TIE BARS @ 2'-6" CTRS
- ②5 PROPOSED HMA BASE COURSE 9"
- ②6 PROPOSED BITUMINOUS MATERIAL (PRIME COAT)
- ②7 PROPOSED AGGREGATE (PRIME COAT)
- ②8 PROPOSED PAVEMENT MARKINGS
- ②9 PROPOSED PAVEMENT FABRIC

FILE NAME =	USER NAME = #USER#	DESIGNED -	REVISED -
#FILE#		DRAWN -	REVISED -
	PLOT SCALE = #SCALE#	CHECKED -	REVISED -
	PLOT DATE = #DATE#	DATE -	REVISED -

STATE OF ILLINOIS
 DEPARTMENT OF TRANSPORTATION

PROPOSED TYPICAL SECTION

SCALE: SHEET NO. OF SHEETS STA. TO STA.

F.A.U. RTE.	SECTION	COUNTY	TOTAL SHEETS	SHEET NO.
9257	(28-1.122-1)BS-1	ST. CLAIR	43	16
FED. ROAD DIST. NO. [ILLINOIS] FED. AID PROJECT			CONTRACT NO. 76058	