

F.A.P. RTE.	SECTION	COUNTY	TOTAL SHEETS	SHEET NO.
312	123RS-5;(130,131)RS-4	JACKSON	39	1
		ILLINOIS	CONTRACT NO. 78195	

STATE OF ILLINOIS
DEPARTMENT OF TRANSPORTATION
DIVISION OF HIGHWAYS

PROPOSED
HIGHWAY PLANS

EAP ROUTE 312 (IL 3)
SECTION 123RS-5;(130,131)RS-4
PROJECT: ACF-0312(031)
MILLING AND RESURFACING
JACKSON COUNTY

D-99-053-10

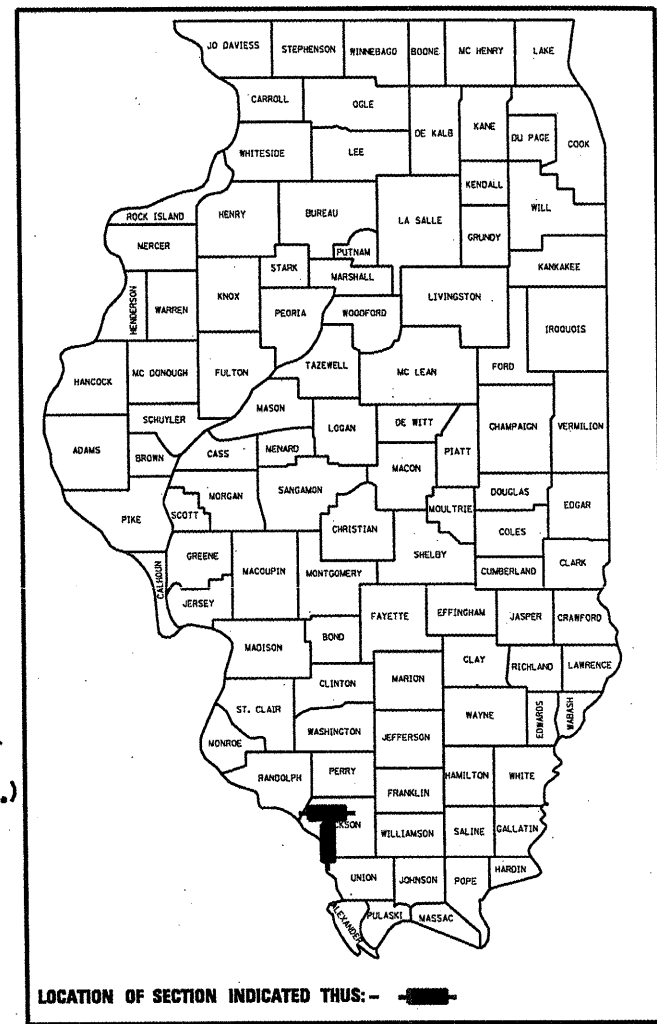

FOR INDEX OF SHEETS, SEE SHEET NO. TRAFFIC ADT 2472 (2010)
PV = 1957
MU = 335
SU = 180
TRUCKS = 20%

PROP. PROJECT FAP 312 LOC. 1 -
ENDS STA. 352+00 (BUTT JT.)

C-99-052-10

PROP. PROJECT FAP 312 LOC. 1 -
BEGINS STA. 396+14.34 (BUTT JT.)

EQUATION STATIONS:

LOCATION 1 -
EQ. STA. 424+32.12 (BK) = STA. 0+32.12 (AH)
EQ. STA. 195+00 (BK) = STA. 194+90.2 (AH)
EQ. STA. 225+85.96 (BK) = STA. 226+00 (AH)
EQ. STA. 271+72.54 (BK) = STA. 271+84.86 (AH)
LOCATION 2 -
EQ. STA. 266+69.60 (BK) = STA. 283+92.20 (AH)

TOWNSHIPS:
KINKAID, FOUNTAIN BLUFF, GRAND TOWER,
SAND ROCK

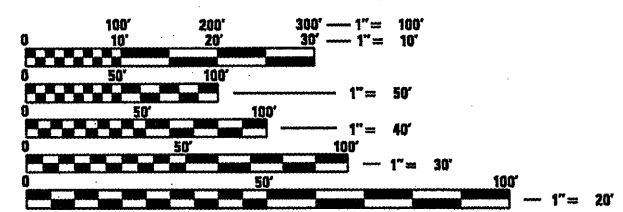

FULL SIZE PLANS HAVE BEEN PREPARED USING STANDARD ENGINEERING SCALES. REDUCED SIZED PLANS WILL NOT CONFORM TO STANDARD SCALES. IN MAKING MEASUREMENTS ON REDUCED PLANS, THE ABOVE SCALES MAY BE USED.

J.U.L.I.E.
JOINT UTILITY LOCATION INFORMATION FOR EXCAVATION
1-800-892-0123
OR 811

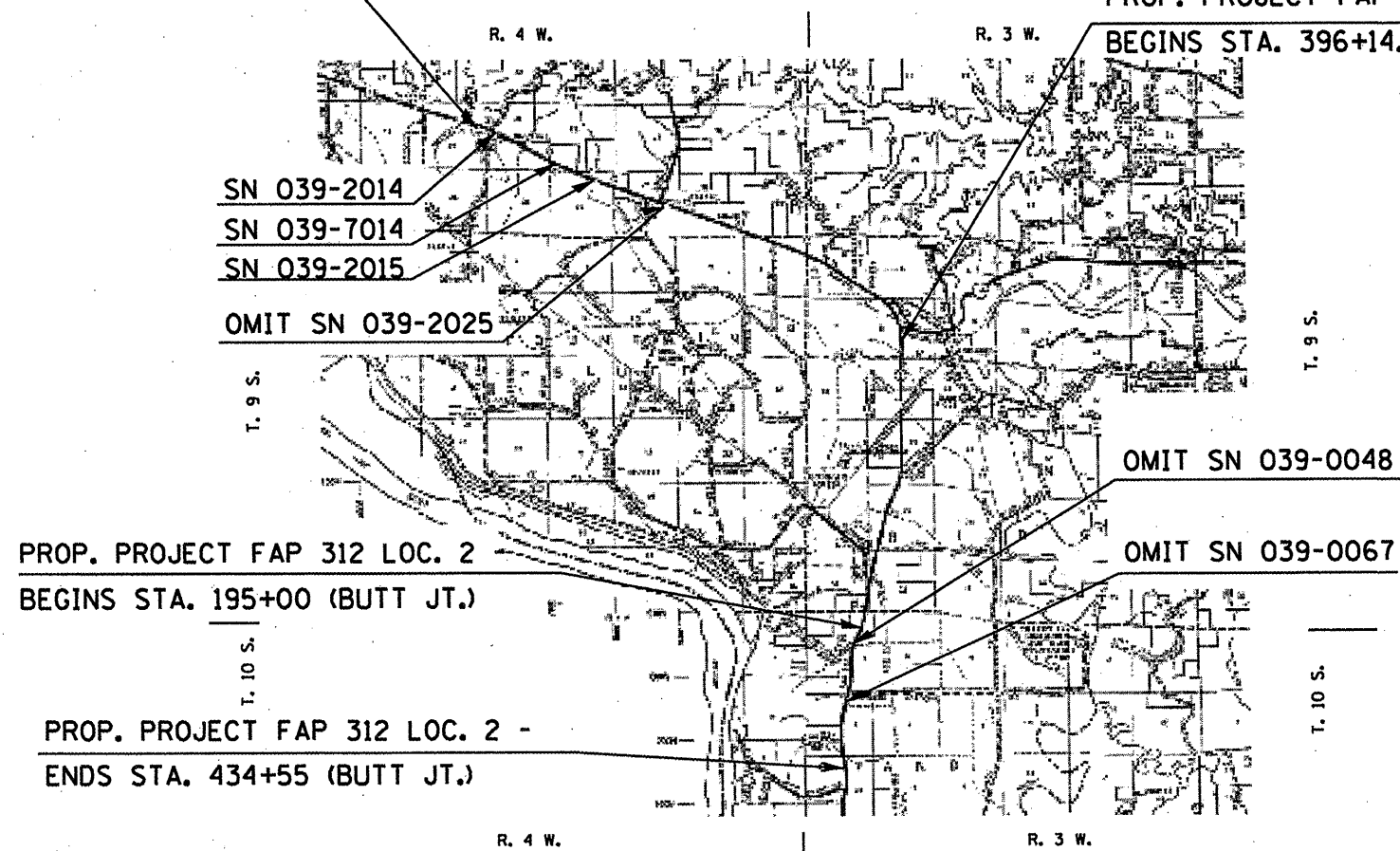

PROP. PROJECT FAP 312 LOC. 2
BEGINS STA. 195+00 (BUTT JT.)

PROP. PROJECT FAP 312 LOC. 2 -
ENDS STA. 434+55 (BUTT JT.)

NET LENGTH = 58934.51 FT. = 11.16 MILE
GROSS LENGTH = 60201.51 FT. = 11.40 MILE

PROJECT ENGINEER - CHARLES STEIN (618) 351-5210
PROJECT DESIGNER - KATHI MCCORD (618) 351-5216

CONTRACT NO. 78195

STATE OF ILLINOIS
DEPARTMENT OF TRANSPORTATION
DIVISION OF HIGHWAYS

SUBMITTED May 4 20 10
Russell L. Lamm
DEPUTY DIRECTOR OF HIGHWAYS, REGION ENGINEER

June 25 20 10
Scott E. Stitt, P.E. /bc
ENGINEER OF DESIGN AND ENVIRONMENT

June 25 20 10
Christine M. Reed /bc
DIRECTOR OF HIGHWAYS, CHIEF ENGINEER

**PRINTED BY THE AUTHORITY
OF THE STATE OF ILLINOIS**