

F.A.P. RTE.	SECTION	COUNTY	TOTAL SHEETS	SHEET NO.
312	123RS-5;(130,131)RS-4	JACKSON	35	1
		ILLINOIS	CONTRACT NO. 78195	

**STATE OF ILLINOIS**  
**DEPARTMENT OF TRANSPORTATION**  
**DIVISION OF HIGHWAYS**

**PROPOSED**  
**HIGHWAY PLANS**

EAP ROUTE 312 (IL 3)  
SECTION 123RS-5;(130,131)RS-4  
PROJECT: ACF-0312(031)  
MILLING AND RESURFACING  
JACKSON COUNTY

**D-99-053-10**

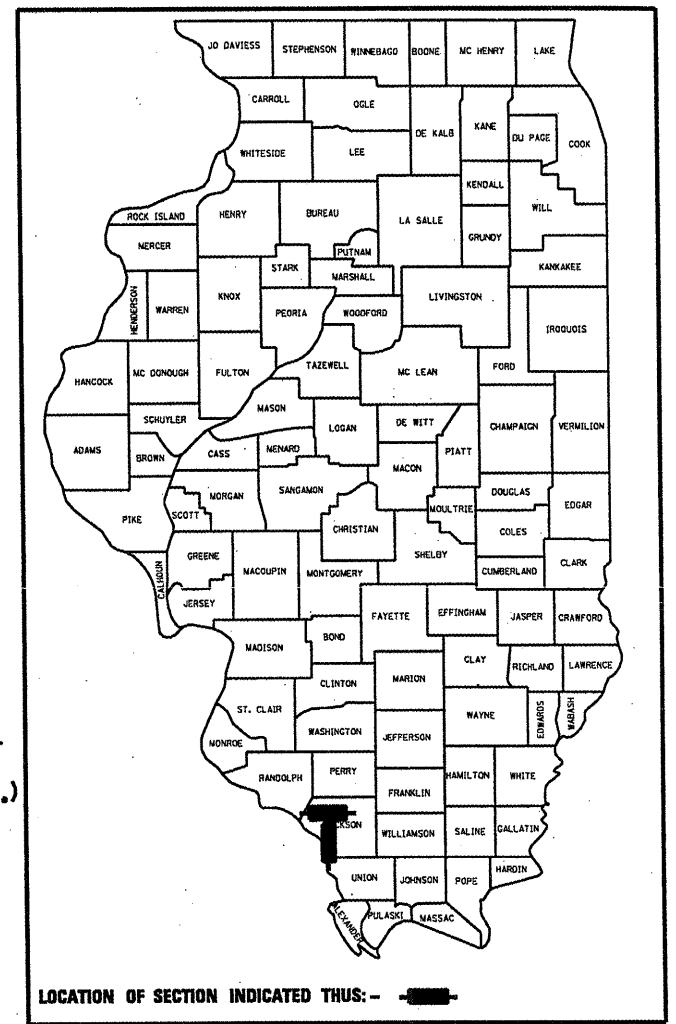

FOR INDEX OF SHEETS, SEE SHEET NO.       
**TRAFFIC ADT 2472 (2010)**  
**PV = 1957**  
**MU = 335**  
**SU = 180**  
**TRUCKS = 20%**

PROP. PROJECT FAP 312 LOC. 1 -  
ENDS STA. 352+00 (BUTT JT.)

C-99-052-10

PROP. PROJECT FAP 312 LOC. 1 -  
BEGINS STA. 396+14.34 (BUTT JT.)

EQUATION STATIONS:

LOCATION 1 -  
EQ. STA. 424+32.12 (BK) = STA. 0+32.12 (AH)  
EQ. STA. 195+00 (BK) = STA. 194+90.2 (AH)  
EQ. STA. 225+85.96 (BK) = STA. 226+00 (AH)  
EQ. STA. 271+72.54 (BK) = STA. 271+84.86 (AH)  
LOCATION 2 -  
EQ. STA. 266+69.60 (BK) = STA. 283+92.20 (AH)

TOWNSHIPS:  
KINKAID, FOUNTAIN BLUFF, GRAND TOWER,  
SAND ROCK

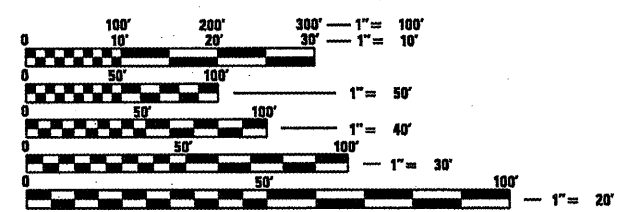

FULL SIZE PLANS HAVE BEEN PREPARED USING STANDARD  
ENGINEERING SCALES. REDUCED SIZED PLANS WILL NOT  
CONFORM TO STANDARD SCALES. IN MAKING MEASUREMENTS  
ON REDUCED PLANS, THE ABOVE SCALES MAY BE USED.

J.U.L.I.E.  
JOINT UTILITY LOCATION INFORMATION FOR EXCAVATION  
1-800-892-0123  
OR 811

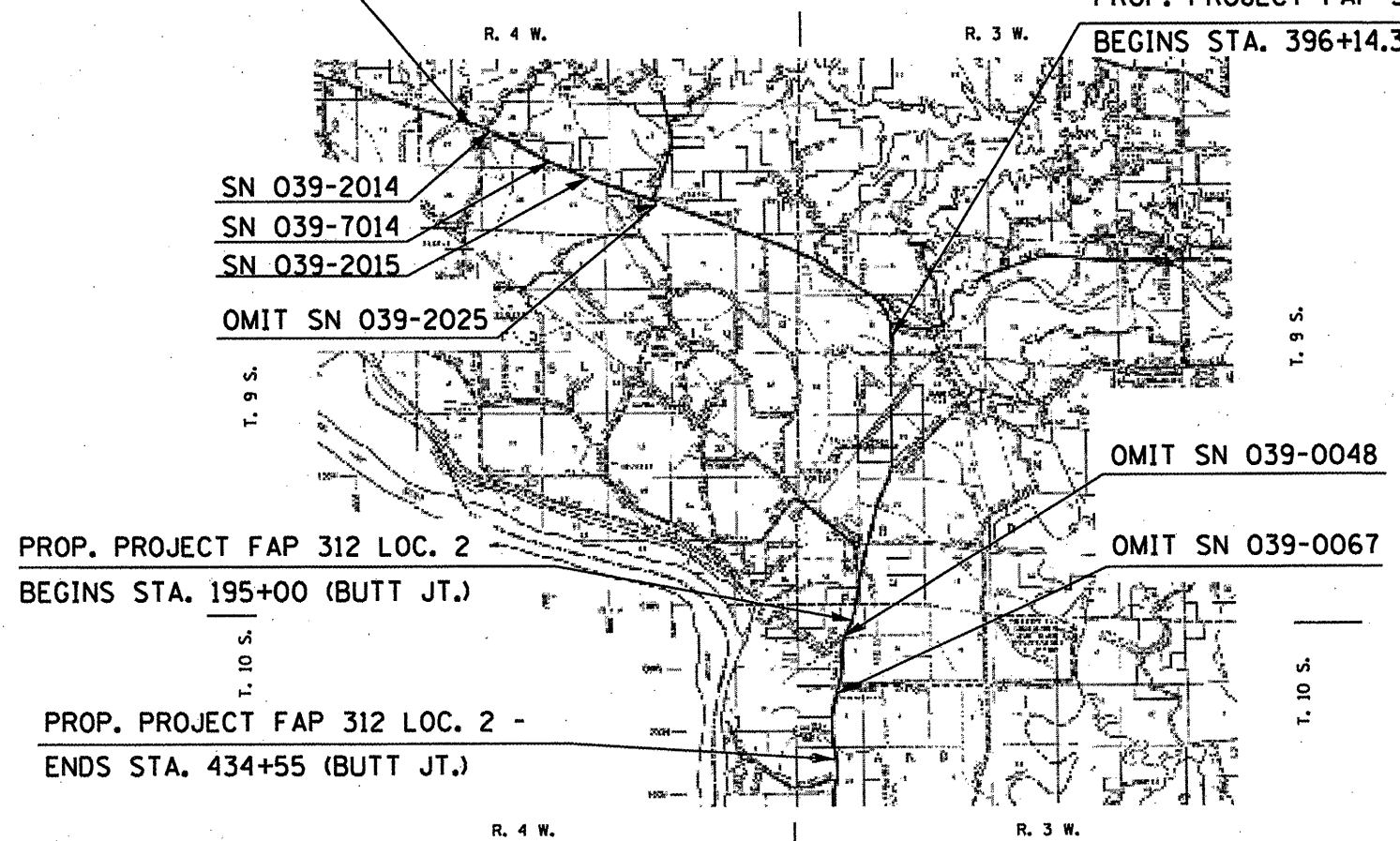

PROP. PROJECT FAP 312 LOC. 2  
BEGINS STA. 195+00 (BUTT JT.)

PROP. PROJECT FAP 312 LOC. 2 -  
ENDS STA. 434+55 (BUTT JT.)

NET LENGTH = 58934.51 FT. = 11.16 MILE  
GROSS LENGTH = 60201.51 FT. = 11.40 MILE

PROJECT ENGINEER - CHARLES STEIN (618) 351-5210  
PROJECT DESIGNER - KATHI MCCORD (618) 351-5216

CONTRACT NO. 78195

STATE OF ILLINOIS  
DEPARTMENT OF TRANSPORTATION  
DIVISION OF HIGHWAYS

SUBMITTED May 4 20 10  
Scott E. Stitt  
DEPUTY DIRECTOR OF HIGHWAYS, REGION ENGINEER  
June 25 20 10  
Scott E. Stitt, P.E.  
ENGINEER OF DESIGN AND ENVIRONMENT  
June 25 20 10  
Christine M. Reed  
DIRECTOR OF HIGHWAYS, CHIEF ENGINEER

**PRINTED BY THE AUTHORITY  
OF THE STATE OF ILLINOIS**

Prepared By: Joe Zankiewicz  
DISTRICT STUDIES & PLANS ENGINEER

Examined By: James Louis Emery  
DISTRICT LAND ACQUISITION ENGINEER

Examined By: Carrie Nelson  
DISTRICT PROGRAM DEVELOPMENT ENGINEER

Examined By: Ken Willy  
DISTRICT OPERATIONS ENGINEER

Examined By: Jim Smother  
DISTRICT CONSTRUCTION ENGINEER

Examined By: Bruce Peebles  
DISTRICT MATERIALS ENGINEER

Examined By: Jim Smother  
DISTRICT PROJECT IMPLEMENTATION ENGINEER

Examined By: Dannay Clayton  
ASSISTANT REGIONAL ENGINEER

Approved By: My C Komi  
DEPUTY DIRECTOR OF HIGHWAYS, REGION ENGINEER

DATE May 4 2010

STATE OF ILLINOIS  
DEPARTMENT OF TRANSPORTATION

SIGNATURE BLOCK

FILE NAME =	USER NAME = mcoordkr	DESIGNED -	REVISD -
cover.dgn		DRAWN -	REVISD -
PLOT SCALE = 100.0000 / IN.		CHECKED -	REVISD -
PLOT DATE = 4/26/2010		DATE -	REVISD -

F.A.P. RTE.	SECTION	COUNTY	TOTAL SHEETS	SHEET NO.
312	12385-5H130.13185-4	JACKSON	35	2
CONTRACT NO. 78195				
ILLINOIS FED. AID PROJECT				

SCALE: \_\_\_\_\_ SHEET NO. \_\_\_\_\_ OF \_\_\_\_\_ SHEETS STA. \_\_\_\_\_ TO STA. \_\_\_\_\_

INDEX OF SHEETS

SHEET NO.	DESCRIPTION
1	COVER SHEET
2	SIGNATURE SHEET
3	INDEX OF SHEETS, GENERAL NOTES, HIGHWAY STANDARDS
4	MIXTURE REQUIRMENTS, STRUCTURE INFORMATION
5	SUMMARY OF QUANTITIES
6 - 7	TYPICAL SECTION
8	SCHEDULE FOR MAINLINE RESURFACING - LOCATION 1 & 2
9	SCHEDULE SIDE ROADS AND ENTRANCES RESURFACING
10	SCHEDULE FOR SHOULDERS
11 - 12	SCHEDULE FOR PAVEMENT MARKING
13 - 19	PLAN LAYOUT FOR FAP 312 (IL 3) LOCATION 1 - STA. 396+14.34
20 - 23	PLAN LAYOUT FOR FAP 312 (IL 3) LOCATION 2 - STA. 195+00 TO STA. 434+55
24	DETAILS: LOCATON 1 BUTT JT AT BEGINNING WITH PAINTED MEDIAN TRANSITION
25	DETAIL: INLAY OF SN 039-2025 AT STA. 194+10
26 - 27	LOCATION 1 BUTT JOINTS AND TRANSITIONS DETAILS
28 - 30	LOCATION 2 BUTT JOINTS AND TRANSITIONS DETAILS
31 - 33	DETAILS: SIDE ROAD AND ENTRANCE DETAILS
34	STANDARD DETAILS - TEMP. HOT-MIX ASPHALT TRANSITIONS
35	STANDARD DETAILS - ROUGH GROOVED SURFACE SIGN; UNEVEN LANE SIGN

GENERAL NOTES

THE THICKNESS OF BITUMINOUS MIXTURE SHOWN ON THE PLANS IS THE NOMINAL THICKNESS. DEVIATIONS FROM THE NOMINAL THICKNESS WILL BE PERMITTED WHEN SUCH DEVIATIONS OCCUR DUE TO IRREGULARITIES IN THE EXISTING SURFACE OR BASE ON WHICH THE BITUMINOUS MIXTURE IS PLACED.

FACTORS USED FOR ESTIMATING PLAN QUANTITIES ARE AS FOLLOWS AND SHALL NOT BE USED FOR THE BASIS OF FINAL QUANTITIES EXCEPT FOR OC/QA OF BITUMINOUS MIXTURES:

ALL HOT-MIX ASPHALT.....2.016 TONS/CU.YD.  
 ALL AGGREGATE.....2.05 TONS/CU.YD.  
 BITUMINOUS MATERIALS (PRIME COAT)  
     ON PAVEMENT.....0.09 GALS./SQ. YD.  
     ON AGG. SURFACE.....0.32 GALS./SQ. YD.  
 AGGREGATE (PRIME COAT).....0.0015 TONS/SQ. YD.

THE QUANTITY OF SHORT TERM PAVEMENT MARKING SHOWN IN THE PLANS WAS BASED ON ONE APPLICATION EACH FOR THE PRIME COAT, SURFACE COURSE AND LEVELING BINDER.

PRIOR TO PLACEMENT OF THE FINAL PAVEMENT MARKINGS, THE RESIDENT ENGINEER SHOULD CONTACT THE BUREAU OF OPERATIONS AND ARRANGE FOR INSPECTION AND APPROVAL OF THE PAVEMENT MARKING LAYOUT.

THE CONTRACTOR SHALL STAMP STATIONING IN THE PROPOSED BITUMINOUS MATS AT 300 FT. INTERVALS ON ALTERNATING SIDES OF THE PAVEMENT AND AS DIRECTED BY THE ENGINEER. THE STATION SYMBOL STAMPS USED SHALL BE FURNISHED BY THE CONTRACTOR. THEY SHALL BE 5/2" TALL OF A DESIGN APPROVED BY THE ENGINEER AND SHALL REMAIN THE PROPERTY OF THE CONTRACTOR.

UNLESS OTHERWISE DIRECTED BY THE ENGINEER, HOT-MIX ASPHALT RESURFACING SHALL BE PLACED IN A SEQUENCE THAT WILL MINIMIZE THE TIME THAT A LANE EDGE IS EXPOSED TO TRAFFIC.

QUANTITIES SHOWN IN THE PLANS FOR PATCHING ARE ESTIMATES. THE ACTUAL AMOUNT OF PATCHING REQUIRED SHALL BE DETERMINED BY THE ENGINEER IN THE FIELD.

HIGHWAY STANDARDS

000001-05	701311-03
442101-07	701336-05
442201-03	701901-01
701301-03	780001-02
701306-02	781001-03

FILE NAME =	USER NAME = mccordkr	DESIGNED -	REVISED -	<b>STATE OF ILLINOIS DEPARTMENT OF TRANSPORTATION</b>	<b>INDEX OF SHEETS AND GENERAL NOTES</b>	F.A.P. RTE.	SECTION	COUNTY	TOTAL SHEETS	SHEET NO.	
cover.dgn	cover.dgn	DRAWN -	REVISED -			312	12385-5+130.13185-4	JACKSON	35	3	
PLOT SCALE = 1/8" = 1' IN.	CHECKED -	REVISED -	REVISED -			CONTRACT NO. 78195					
PLOT DATE = 4/26/2018	DATE -	REVISED -	REVISED -			ILLINOIS FED. AID PROJECT					
				SCALE: SHEET NO. OF SHEETS STA. TO STA.							

MIXTURE REQUIREMENTS SHALL BE PREPARED AS DIRECTED BELOW:

LOCATION 1 AND 2:  
FOR FAP 312 (IL 3) MAINLINE SURFACE COURSE, LEVELING BINDER AND INCIDENTAL HMA SURFACE:

Mixture Use(s):	Hot-Mix Asphalt Surface Course, Mixture C, N90
AC/PG:	PG64-22
RAP % (Max.):	10
Design Air Voids:	4.0%, 90 Gyration Design
Mixture Composition: (Gradation Mixture)	IL-9.5mm or IL-12.5 mm
Friction Aggregate:	C Surface

LOCATION 2:  
HOT-MIX ASPHALT SHOULDERS

Mixture Use(s):	Hot-Mix Asphalt Shoulders
AC/PG:	PG58-22
RAP % (Max.):	50
Design Air Voids:	2.0%, 30 Gyration Design
Mixture Composition: (Gradation Mixture)	HMA Shoulders
Friction Aggregate:	None

LOCATION 1 & 2:  
CLASS D PATCHING

Mixture Use(s):	Hot-Mix Asphalt Binder Course, N90, IL-19.0
AC/PG:	PG64-22
RAP % (Max.):	10
Design Air Voids:	4.0%, 90 Gyration Design
Mixture Composition: (Gradation Mixture)	IL-19.0 mm
Friction Aggregate:	None

STRUCTURE INFORMATION SCHEDULE

STRUCTURE NO.	STATION	INV. RATING	OPR. RATING	SUFF. RATING
SN 039-2025	194+10	27.9	46.5	93.4
SN 039-2015	252+73	11.7	19.4	61.2
SN 039-7014	286+07	0.0	0.0	100.0
SN 039-2014	345+42	14.4	21.1	69.5
SN 039-0048	247+02.81	22.6	37.6	91.4
SN 039-0067	330+66.3	24.8	41.3	95.9

- SN 039-2025 - An empty MTD will be allowed over this structure.
- SN 039-2015 - NO MTD will be allowed over this structure.
- SN 039-7014 - An empty MTD will be allowed over this structure.
- SN 039-2014 - An empty MTD will be allowed over this structure.
- SN 039-0048 - A loaded MTD will be allowed over this structure.
- SN 039-0067 - A loaded MTD will be allowed over this structure.

# SUMMARY OF QUANTITIES

FAP 312 ( IL 3 )  
 80% FED. / 20% STATE  
 RESURFACING  
 JACKSON COUNTY  
 CONSTRUCTION TYPE CODE 1000  
 LOCATION 1      LOCATION 2

CODE NUMBER	ITEM DESCRIPTION	UNIT	TOTAL QUANTITY	QUANTITY	QUANTITY
X0322729	MATERIAL TRANSFER DEVICE	TON	22127	14238	7889
Z0017100	DOWEL BARS	EACH	40		40
Z0075310	TIE BARS 3/4"	EACH	22		22
40600100	BITUMINOUS MATERIALS (PRIME COAT)	GALLON	29853.3	18335.6	11517.7
40600300	AGGREGATE (PRIME COAT)	TON	497.63	305.59	192.04
40600645	LEVELING BINDER (MACHINE METHOD), N90	TON	8825	5681	3144
40600982	HOT-MIX ASPHALT SURFACE REMOVAL - BUTT JOINT	SQ YD	1441	509	932
40600990	TEMPORARY RAMP	SQ YD	137	57	80
40603320	HOT-MIX ASPHALT SURFACE COURSE, MIXTURE C, N90	TON	13311	8566	4745
40800050	INCIDENTAL HOT-MIX ASPHALT SURFACING	TON	229	153	76
44000153	HOT-MIX ASPHALT SURFACE REMOVAL, 1"	SQ YD	139123	101267	37856
44200956	CLASS B PATCHES, TYPE II, 9 INCH	SQ YD	1133		1133
44200964	CLASS B PATCHES, TYPE IV, 9 INCH	SQ YD	64		64
44201789	CLASS D PATCHES, TYPE II, 12 INCH	SQ YD	2671	1506	1165
44201794	CLASS D PATCHES, TYPE III, 12 INCH	SQ YD	416	416	
44201796	CLASS D PATCHES, TYPE IV, 12 INCH	SQ YD	403	403	
44213100	PAVEMENT FABRIC	SQ YD	64		64
44213200	SAW CUTS	FOOT	2084		2084
48101200	AGGREGATE SHOULDERS, TYPE B	TON	99	99	
48102100	AGGREGATE WEDGE SHOULDER, TYPE B	TON	3885	2806	1079
48203100	HOT-MIX ASPHALT SHOULDERS	TON	2104		2104
67000400	ENGINEER'S FIELD OFFICE, TYPE A	CAL MO	4	2	2
67100100	MOBILIZATION	L SUM	1	0.5	0.5
70100460	TRAFFIC CONTROL AND PROTECTION, STANDARD 701306	L SUM	1	0.5	0.5
70100600	TRAFFIC CONTROL AND PROTECTION, STANDARD 701336	L SUM	1	0.5	0.5
70106800	CHANGEABLE MESSAGE SIGN	CAL MO	4	2	2
70300100	SHORT- TERM PAVEMENT MARKING	FOOT	6997	4545	2452
70300220	TEMPORARY PAVEMENT MARKING, LINE 4"	FOOT	152337	98090	54247
70300280	TEMPORARY PAVEMENT MARKING, LINE 24"	FOOT	184	108	76
70301000	WORK ZONE PAVEMENT MARKING REMOVAL	SQ FT	52581	33870	18711
* 78000650	THERMOPLASTIC PAVEMENT MARKING - LINE 24"	FOOT	184	108	76
* 78001110	PAINT PAVEMENT MARKING - LINE 4"	FOOT	152337	98090	54247
* 78100100	RAISED REFLECTIVE PAVEMENT MARKER	EACH	738	474	264
78300200	RAISED REFLECTIVE PAVEMENT MARKER REMOVAL	EACH	738	474	264

FILE NAME =  
 c:\pwwork\pwwork\mccardkr\d0181703\shh  
 paver.dgn

USER NAME = mcardkr  
 PLOT SCALE = 100.0000' / IN.  
 PLOT DATE = 5/3/2010

DESIGNED -	REVISD -
DRAWN -	REVISD -
CHECKED -	REVISD -
DATE -	REVISD -

**STATE OF ILLINOIS  
 DEPARTMENT OF TRANSPORTATION**

----- SUMMARY OF QUANTITIES -----  
 SCALE: \_\_\_\_\_ SHEET NO. \_\_\_\_ OF \_\_\_\_ SHEETS STA. \_\_\_\_\_ TO STA. \_\_\_\_\_

F.A.P. RTE. 312	SECTION 12385-5+130.13185-4	COUNTY JACKSON	TOTAL SHEETS 35	SHEET NO. 5
CONTRACT NO. 78199				
ILLINOIS FED. AID PROJECT				

**TYPICALS FOR IL 3  
LOCATION 1  
STA. 396+14.34 TO STA. 352+00**

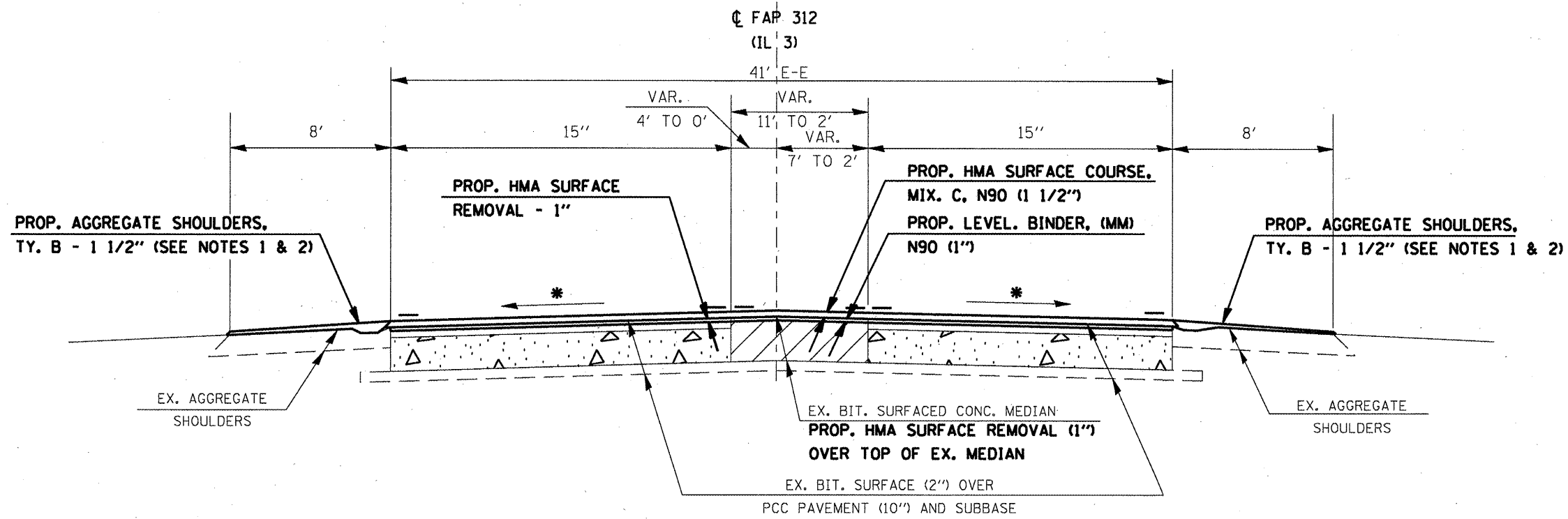

**EQUATION STATIONS:**

STA. 424+32.12 (BK) = STA. 0+32.12 (AH)  
 STA. 195+00 (BK) = STA. 194+90.2 (AH)  
 STA. 225+85.96 (BK) = STA. 226+00 (AH)  
 STA. 271+72.54 (BK) = STA. 271+84.86 (AH)

**TO BE USED:  
 STA. 396+14.34 (BUTT JT) TO STA. 397+64**

**NOTE 1: EXTRA QUANTITY FOR AGGREGATE SHOULDERS HAS BEEN CALCULATED IN FOR ANY EROSION ALONG EDGE OF PAVEMENT. SEE SCHEDULE ON SHT. 10.**

**NOTE 2: PROP. AGGREGATE SHOULDERS, TY. B ENDS AT LT. & RT. STA. 401+00. THE LAST 100' TAPER FROM 8' TO 2', AS SHOWN ON PLANS.**

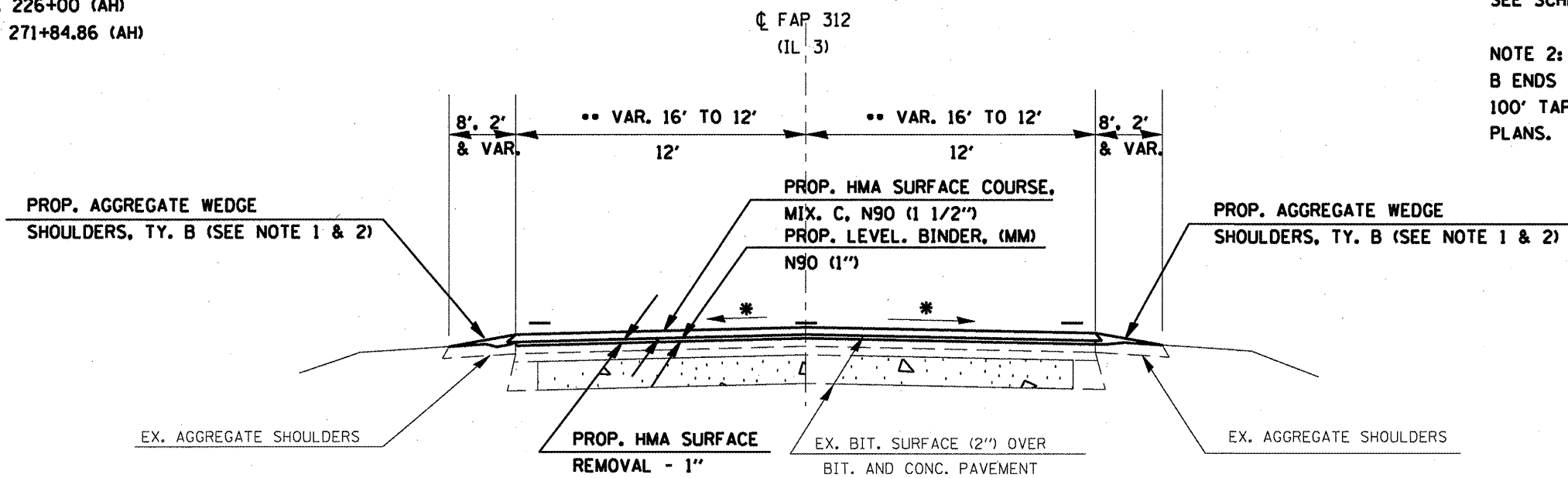

**TO BE USED:  
 STA. 397+64 TO STA. 401+00 (WIDTH VARIES FROM 32' TO 24' E-E)  
 STA. 401+00 TO STA. 193+56 (SN 039-2025 OMITTED)  
 STA. 194+51 TO STA. 352+00**

\* MATCH EX. SLOPE

FILE NAME =	USER NAME = mcoordkr	DESIGNED -	REVISED -	<b>STATE OF ILLINOIS DEPARTMENT OF TRANSPORTATION</b>	<b>TYPICAL SECTIONS LOCATION 1, NORTH OF IL 149</b>	F.A.P. RTE. =	SECTION =	COUNTY =	TOTAL SHEETS =	SHEET NO. =	
at\pwwork\pwwork\mcoordkr\d8181703\sh...over.dgn		DRAWN -	REVISED -			312	12385-S&I30.I31RS-4	JACKSON	35	6	
PLOT SCALE = 100.0000' / IN.		CHECKED -	REVISED -								
PLOT DATE = 5/3/2010		DATE -	REVISED -								
						SCALE: _____ SHEET NO. _____ OF _____ SHEETS STA. _____ TO STA. _____		CONTRACT NO. 78195 ILLINOIS FED. AID PROJECT			

TYPICALS FOR IL 3  
 LOCATION 2  
 STA. 195+00 TO STA. 434+55

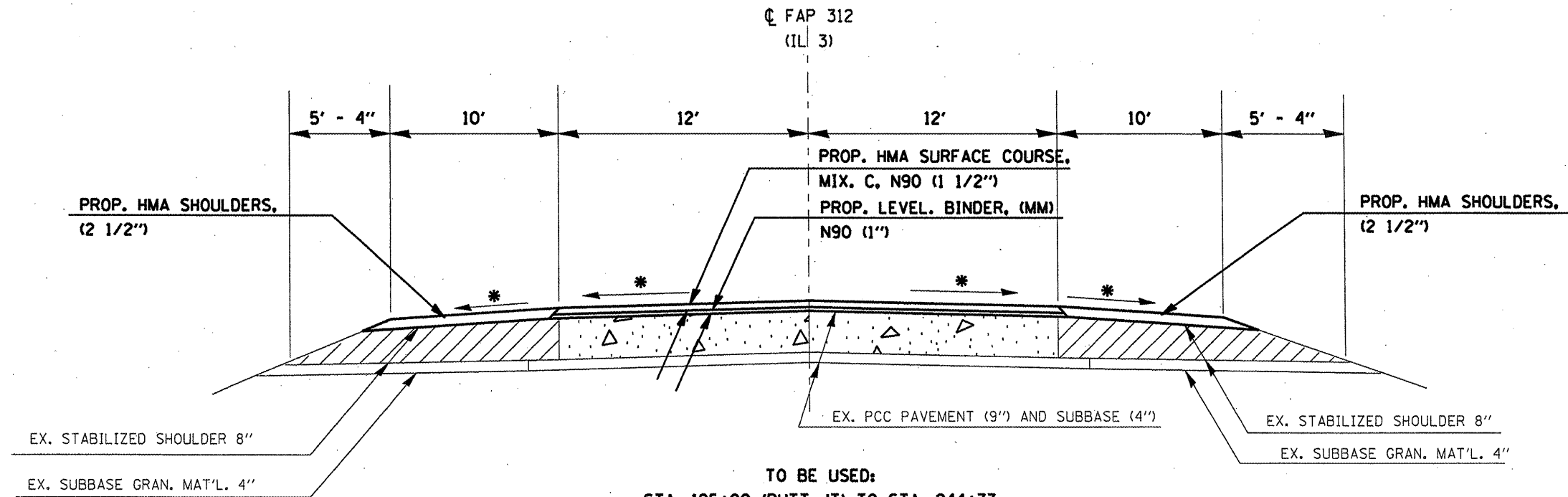

TO BE USED:  
 STA. 195+00 (BUTT JT) TO STA. 244+77  
 (OMIT S.N. 039-0048 - STA. 244+77 TO STA. 249+90)  
 STA. 249+90 TO STA. 286+00

EQUATION STATIONS:

STA. 266+69.60 (BK) = STA. 283+92.20 (AH)

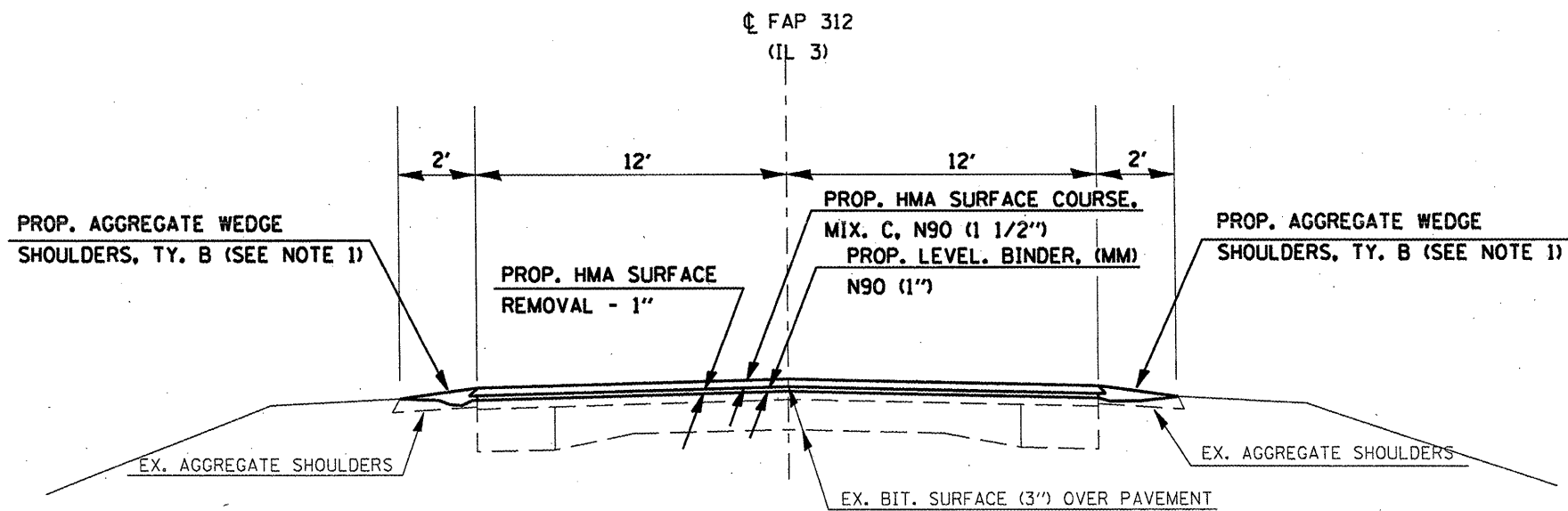

TO BE USED:  
 STA. 286+00 TO STA. 327+37  
 (OMIT S.N. 039-0067 - STA. 327+37 TO STA. 333+96)  
 STA. 333+96 TO STA. 434+55 (BUTT JT)

NOTE 1: EXTRA QUANTITY FOR AGGREGATE SHOULDERS HAS BEEN CALCULATED IN FOR ANY EROSION ALONG EDGE OF PAVEMENT. SEE SCHEDULE ON SHT. 10.

FILE NAME =	USER NAME = mcoordkr	DESIGNED -	REVISED -	<b>STATE OF ILLINOIS DEPARTMENT OF TRANSPORTATION</b>	<b>TYPICAL SECTIONS</b>		F.A.P. RTE.:	SECTION	COUNTY	TOTAL SHEETS	SHEET NO.
at:\pwork\work\WIDOT\MCCORDKR\d0181783\shd	cover.dgn	DRAWN -	REVISED -		<b>LOCATION 2, SOUTH OF IL 149</b>		312	12385-5(130.13)185-4	JACKSON	35	7
	PLOT SCALE = 1/8" = 1' IN.	CHECKED -	REVISED -		SCALE:	SHEET NO. OF SHEETS	STA.	TO STA.	ILLINOIS FED. AID PROJECT		
	PLOT DATE = 4/28/2010	DATE -	REVISED -								

**LOCATION 1 RESURFACING SCHEDULE**

LOCATION STATION TO STATION	LENGTH (FT)	ROADWAY WIDTH (FT)	SHOULDER WIDTH (FT)	ROADWAY OR SHLD. AREA (SQ YD)	HOT-MIX ASP. SURF. REMOV. - BUTT JT. (SQ YD)	HMA SURF. REMOVAL, 1" (SQ YD)	TEMP RAMP (SQ YD)	HOT-MIX ASP. SUR. CSE. MIX C. N 90 (1 1/2") (TON)	LEVELING BINDER (MM) N90 (1") (TON)	BIT. MAT. (PRIME COAT) (GAL)	AGG. (PRIME COAT) (TON)	NOTES												
													FOR INFORMATIONAL PURPOSE ONLY											
													(FT)	(FT)	(FT)	(SQ YD)	(SQ YD)	(SQ YD)	(SQ YD)	(TON)	(TON)	(GAL)	(TON)	
<b>FAP 312 (IL 3) STA. 396+14.34 TO STA. 352+00</b>																								
396+14.34 TO 397+64.00	150	2 - 15' Lns.	8.0	500	190	500	17	42	30	90	1.5													
396+14.34 TO 397+64.00	150	11' TO 2'	8.0					9	6			Center Median												
397+64.00 TO 401+00.00	336	33' to 24'	8.0	1064		1064		90	61	192	3.2													
401+00.00 TO 424+32.12	2332	24.0	2.0	6219		6219		526	348	1119	18.7													
<b>Eq. Sta. 424+32.12 (bk) = Sta. 0+32.12 (ah)</b>																								
+32.12 TO 193+56.00	19324	24.0		51530		51530	13	4353	2885	9275	154.6													
<b>SN 039-2025 Omission - Sta. 193+56 to Sta. 194+51</b>																								
194+51.00 TO 195+00.00	49.0	24.0		131		131	13	12	8	24	0.4													
<b>Eq. Sta. 195+00 (bk) = Sta. 194+90.20 (ah)</b>																								
194+90.20 TO 225+85.96	3,095.8	24.0	2.0	8,255		8255		698	463	1486	24.8													
<b>Eq. Sta. 225+85.96 (bk) = Sta. 226+00.00 (ah)</b>																								
226+00.00 TO 271+72.54	4,572.5	24.0	2.0	12,193		12,193		1030	683	2195	36.6													
<b>Eq. Sta. 271+72.54 (bk) = Sta. 271+84.86 (ah)</b>																								
271+84.85 TO 352+00.00	8,015.2	24.0	2.0	21,373.7	80	21,374	13	1806	1197	3847	64.1													
<b>LOCATION 1 TOTALS</b>					<b>270</b>	<b>101,267</b>	<b>57</b>	<b>8566</b>	<b>5681</b>	<b>18228</b>	<b>303.8</b>													

**LOCATION 2 RESURFACING SCHEDULE**

LOCATION STATION TO STATION	LENGTH (FT)	ROADWAY WIDTH (FT)	SHOULDER WIDTH (FT)	ROADWAY OR SHLD. AREA (SQ YD)	HOT-MIX ASP. SURF. REMOV. - BUTT JT. (SQ YD)	HMA SURF. REMOVAL, 1" (SQ YD)	TEMP RAMP (SQ YD)	HOT-MIX ASP. SUR. CSE. MIX D. N 90 (1 1/2") (TON)	LEVELING BINDER (MM) N90 (1") (TON)	BIT. MAT. (PRIME COAT) (GAL)	AGG. (PRIME COAT) (TON)	NOTES												
													FOR INFORMATIONAL PURPOSE ONLY											
													(FT)	(FT)	(FT)	(SQ YD)	(SQ YD)	(SQ YD)	(SQ YD)	(TON)	(TON)	(GAL)	(TON)	
<b>FAP 312 (IL 3) STA. 195+00 TO STA. 434+55</b>																								
195+00.00 TO 244+77.00	4977	24.0	10.0	13272	147		27	1121	747	2389	39.8													
244+77.00 TO 249+90.00					147																			
<b>SN 039-0048 Omission - Sta. 244+77 to Sta. 249+90</b>																								
249+90.00 TO 266+69.60	1680	24.0	10.0	4479	147		13	379	252	806	13.4													
<b>Eq. Sta. 266+69.6 (bk) = Sta. 283+92.2 (ah)</b>																								
283+92.20 TO 286+00.00	207.8	24.0	10.0	554				47	32	100	1.7													
<b>Ex. PCC Pvt ends/ Bit. Surfaced Pvt begins - Sta. 286+00</b>																								
286+00.00 TO 327+37.00	4,137.0	24.0	2.0	11,032	80	11032	13	932	616	1986	33.1													
<b>SN 039-0067 Omission - Sta. 327+37 to Sta. 333+96</b>																								
333+96.00 TO 434+55.00	10,059.0	24.0	2.0	26,824	80	26,824	27	2266	1497	4828	80.5													
434+55.00 TO 434+55.00					80																			
<b>LOCATION 2 TOTALS</b>					<b>681</b>	<b>37,856</b>	<b>80</b>	<b>4745</b>	<b>3144</b>	<b>10109</b>	<b>168.5</b>													



### SIDE ROAD SCHEDULE

NAME AND STATION			EXIST. SURFACE	EP WIDTH	WIDTH AT 15' OFFSET	ROADWAY AREA	HOT-MIX ASP. SURF. REMOV. - BUTT JT.	INCIDENTAL HMA SURFACING	BIT. MAT. (PRIME COAT)	AGG. (PRIME COAT)
			FOR INFORMATIONAL PURPOSE ONLY						(SO YD)	(TON)
			(FT)	(FT)	(FT)	(SQ YD)	(SO YD)	(TON)	(GAL)	(TON)
<b>FAP 312 (IL 3)</b>										
<b>LOCATION 1</b>										
Rt.	Eastman Rd.	398+35.00	Bit.	97	40	114	114	10	10.3	0.17
Rt.	Eastman Rd.	412+10.00	Bit.	103	47	125	125	11	11.3	0.19
Rt.	Sickler Rd.	3+14.00	Agg.	71	42	94		16	8.5	0.14
Lt.	Buttermilk Rd.	39+10.00	Oil & Chip	60	22	68		12	6.1	0.10
Lt.	White Lane	94+81.00	Oil & Chip	66	32	82		14	7.4	0.12
Rt.	Crain Rd.	122+27.00	Oil & Chip	40	18	48		8	4.3	0.07
Rt.	IL 151/Kent Keller Hwy.	195+63.50	Thru Inlay Section							
Lt.	Big Lake Rd.	205+67.00	Oil & Chip	90	48	115		19	10.4	0.17
Rt.	Logan Hollow Rd.	350+29.00	Oil & Chip	64	35	83		14	7.5	0.12
Lt.	Raddle Rd.	351+35.00	Oil & Chip	102	55	131		22	11.8	0.20
<b>LOCATION 1 Total</b>							<b>239</b>	<b>125</b>	<b>77.6</b>	<b>1.29</b>
<b>LOCATION 2</b>										
Lt.	Otter Slough Rd.	226+60.00	Oil & Chip	54.0	26.0	67		11	6.0	0.10
Rt.	Otter Slough Rd.	226+60.00	Agg.	54.0	26.0	67		11	6.0	0.10
Rt.	Gorham Rd.	253+00.00	PCC	200.0	109.0	251	251	21	22.6	0.38
Rt.	Oakwood Bottoms Rd	369+08.00	Agg.	116.0	58.0	145		24	13.1	0.22
<b>LOCATION 2 Total</b>							<b>251</b>	<b>68</b>	<b>47.7</b>	<b>0.80</b>
<b>PROJECT TOTALS</b>							<b>490</b>	<b>193</b>	<b>125.3</b>	<b>2.09</b>

### ENTRANCE SCHEDULE

ENTRANCE TYPE	NUMBER	EXIST. SURFACE	EP WIDTH	WIDTH AT 4' BK.	ROADWAY AREA	INCIDENTAL HMA SURFACING	BIT. MAT. (PRIME COAT)	AGG. (PRIME COAT)	AGG. WEDGE (See Note 1)
		FOR INFORMATIONAL PURPOSE ONLY					(TON)	(GAL)	(TON)
		(FT)	(FT)	(FT)	(SQ YD)	(TON)	(GAL)	(TON)	(TON)
<b>FAP 312 (IL 3)</b>									
<b>LOCATION 1</b>									
PE	35	Agg.	16.0	12.0	6	18	20	0.33	7
PE	1	PCC	16.0	12.0	6	1	1	0.01	
PE	2	Bit.	16.0	12.0	6	1	1	0.02	
CE	6	Agg.	39.0	35.0	16	8	9	0.15	1.2
<b>LOCATION 2</b>									
PE	3	Agg.	16.0	12.0	6	2	2	0.03	0.6
PE	1	Bit.	16.0	12.0	6	1	1	0.01	
CE	3	Agg.	39.0	35.0	16	4	4	0.07	0.6
CE	1	Bit.	39.0	35.0	16	1	1	0.02	
<b>PROJECT TOTAL</b>						<b>36</b>	<b>38</b>	<b>0.64</b>	<b>9.4</b>

NOTE 1: Amount of Aggregate Wedge shall be Included In Aggregate Wedge Shoulders, Type B.

**LOCATION 1 SHOULDER SCHEDULE**

LOCATION STATION TO STATION	LENGTH (FT)	SHOULDER WIDTH (FT)	AGG. SHLDRS., TY. A (1 1/2") (TON)	AGG. WEDGE SHLDRS., TY. B (See Note 1) (TON)
<b>FAP 312 (IL 3) STA. 396+14.34 TO STA. 352+00</b>				
396+14.34 TO 401+00.00	486	8.0	99	
401+00.00 TO 424+32.12	2332	2.0		177
<b>Eq. Sta. 424+32.12 (bk) = Sta. 0+32.12 (oh)</b>				
+32.12 TO 190+80.00	19048	2.0		1446
<b>SN 039-2025 Omission - Sta. 193+56 to Sta. 194+51</b>				
			See Note 1	
<b>Eq. Sta. 195+00 (bk) = Sta. 194+90.20 (oh)</b>				
197+00.00 TO 225+85.96	2,886.0	2.0		219
<b>Eq. Sta. 225+85.96 (bk) = Sta. 226+00.00 (oh)</b>				
226+00.00 TO 271+72.54	4,572.5	2.0		347
<b>Eq. Sta. 271+72.54 (bk) = Sta. 271+84.86 (oh)</b>				
271+84.85 TO 352+00.00	8,015.2	2.0		609
<b>LOCATION 1 TOTALS</b>			<b>99</b>	<b>2798</b>

Note 1: Aggregate Wedge Shoulder, Ty. B shall be omitted left and right from Sta. 190+80 to Sta. 197+00 near SN 039-2025.

**LOCATION 2 SHOULDER SCHEDULE**

LOCATION STATION TO STATION	LENGTH (FT)	SHOULDER WIDTH (FT)	BIT. MAT. (PRIME COAT) (GAL)	AGG. (PRIME COAT) (TON)	HMA SHOULDRS (2.5") (TON)	AGG. WEDGE SHLDRS., TY. B (See Note 1) (TON)	NOTES
<b>FAP 312 (IL 3) STA. 195+00 TO STA. 434+55</b>							
Lt & Rt 195+00.00 TO 244+77.00	4977	10.0	995	16.6	1548		
<b>SN 039-0048 Omission - Sta. 244+77 to Sta. 249+90</b>							
Lt 249+90.00 TO 266+69.60	1680	10.0	168	2.8	261		
Rt 249+90.00 TO 266+69.60	1480	10.0	148	2.5	230		200' SRR
<b>Eq. Sta. 266+69.6 (bk) = Sta. 283+92.2 (oh)</b>							
Lt & Rt 283+92.20 TO 286+00.00	207.8	10.0	42	0.7	65		
<b>Ex. PCC Pvt ends/ Bit. Surfaced Pvt begins - Sta. 286+00</b>							
286+00.00 TO 327+37.00	4,137.0	2.0				314	
<b>SN 039-0067 Omission - Sta. 327+37 to Sta. 333+96</b>							
333+96.00 TO 434+55.00	10,059.0	2.0				764	
<b>LOCATION 2 TOTALS</b>			<b>1353</b>	<b>22.6</b>	<b>2104</b>	<b>1078</b>	

Note 1: The AGGREGATE WEDGE SHOULDERS are calculated at 3" depth due to erosion along existing edge of pavement.

LOCATION 1 PAVEMENT MARKING SCHEDULE

STATION TO STATION				PAINT PAVEMENT MARKING			THERMOPLASTIC PAVEMENT MARKING	TEMPORARY		SHORT-TERM	NOTES
				4 INCH WHITE (EDGE LINE)	4 INCH YELLOW (NO PASS ZONE)	4 INCH (SKIP-DASH)	24 INCH (STOP BAR) (SEE NOTE 1)	4 INCH	24 INCH	4 INCH	
				FOOT	FOOT	FOOT	FOOT	FOOT	FOOT		
<b>MAINLINE: Sta. 396+14.34 to Sta. 352+00</b>											
LT	396+14.3	TO	424+32.1	2818				2818			
RT	396+14.3	TO	424+32.1	2618				2618			
	396+14.3	TO	399+85.0		1483			1483		44	
	399+85.0	TO	424+32.1			612		612		294	
LT	399+85.0	TO	405+12.0		527			527			
RT	398+35.0	Eastman Rd.					12		12		
RT	412+10.0	Eastman Rd.					12		12		
<b>EQ. Sta. 424+32.12 (bk.) = Sta. 0+32.12 (ah.)</b>											
LT	+32.1	TO	193+56.0	19187				19187			
RT	+32.1	TO	193+56.0	19224				19,224			
	+32.1	TO	169+92.0			4,240		4,240			
	+32.1	TO	193+56.0							2,319	
	171+19.0	TO	193+56.0			560		560			
RT	7+12.0	TO	13+41.0		629			629			
LT	18+96.0	TO	24+24.0		528			528			
RT	78+46.0	TO	83+74.0		528			528			
LT	89+17.0	TO	94+45.0		528			528			
RT	104+55.0	TO	109+88.0		533			533			
LT	115+12.0	TO	120+45.0		533			533			
RT	132+54.0	TO	138+03.0		549			549			
LT	145+42.0	TO	150+44.0		502			502			
RT	153+81.0	TO	161+47.0		766			766			
LT	164+38.0	TO	171+19.0		681			681			
RT	169+92.0	TO	179+11.0		919			919			
LT	181+22.0	TO	188+82.0		760			760			
LT	3+14.0	Stickler Rd.					12		12		
RT	38+84.0	Buttermilk Rd.					12		12		
LT	94+81.0	White Lane					12		12		
RT	122+27.0	Crain Rd.					12		12		
<b>SN 039-2025 Omission - Sta. 193+56 to Sta. 194+51</b>											
LT	194+51.0	TO	195+00.0	49				49			
RT	194+51.0	TO	195+00.0	49				49			
RT	194+51.0	TO	195+00.0		49	12		61		6	
		TO									
<b>EQ. Sta. 195+00 (bk.) = Sta. 194+90.2 (ah.)</b>											
LT	194+90.2	TO	225+86.0	3006				3,006			
RT	194+90.2	TO	225+86.0	3096				3,096			
RT	194+90.2	TO	206+43.0		1,153			1,153			
	194+90.2	TO	204+79.0			247		247			
	194+90.2	TO	225+86.0							371	
LT	204+79.0	TO	213+56.0		877			877			
	206+43.0	TO	225+86.0			486		486			
LT	205+67.0	Big Lake Rd.					12		12		
<b>EQ. Sta. 225+85.96 (bk.) = Sta. 226+00.0 (ah.)</b>											
RT	226+00.0	TO	271+72.5	4573				4,573			
LT	226+00.0	TO	271+72.5	4573		1,143		5,716		549	
RT	258+42.0	TO	269+24.0		1,082.0			1,082			
LT	269+24.0	TO	271+72.5		249			249			
<b>Eq. Sta. 271+72.54 (bk.) = Sta. 271+84.86 (ah.)</b>											
LT	271+84.9	TO	352+00.0	7,913				7,913			
RT	271+84.9	TO	352+00.0	7,951		2004		9,955		962	
LT	271+84.9	TO	280+40.0		855			855			
RT	350+29.0	Logan Hollow Rd.					12		12		
LT	351+35.0	Raddle Rd.					12		12		
<b>SUB-TOTALS</b>				<b>75,056</b>	<b>13,730</b>	<b>9,304</b>	<b>108</b>	<b>98,090</b>	<b>108</b>	<b>4,545</b>	
<b>TOTALS</b>				<b>98,090</b>	<b>98,090</b>	<b>108</b>	<b>108</b>	<b>98,090</b>	<b>108</b>	<b>4,545</b>	

NOTE 1 : STOP BARS SHALL BE PLACED 10 FEET BACK FROM EDGE OF PAVEMENT OR AS DIRECTED BY THE ENGINEER.

FILE NAME : c:\pwwork\pwwid\mccordkr\d0181703\sh	USER NAME : mcoordkr cover.dgn	DESIGNED - DRAWN - CHECKED - DATE -	REVISED - REVISED - REVISED - REVISED -	<b>STATE OF ILLINOIS DEPARTMENT OF TRANSPORTATION</b>		<b>PAVEMENT MARKING SCHEDULE LOCATION 1</b>		F.A.P. RTE. 312	SECTION 12385-5H130.13185-4	COUNTY JACKSON	TOTAL SHEETS 35	SHEET NO. 11
PLOT SCALE = 1/8" = 100'-0" / IN.				SCALE: _____ SHEET NO. _____ OF _____ SHEETS STA. _____ TO STA. _____				CONTRACT NO. 78195				
PLOT DATE = 4/26/2010								ILLINOIS FED. AID PROJECT				

LOCATION 2 PAVEMENT MARKING SCHEDULE

STATION TO STATION				PAINT PAVEMENT MARKING			ThERMOPLASTIC PAVEMENT MARKING	TEMPORARY		SHORT-TERM	NOTES
				4 INCH WHITE (EDGE LINE)	4 INCH YELLOW (NO PASS ZONE)	4 INCH (SKIP-DASH)	24 INCH (STOP BAR) (SEE NOTE 1)	4 INCH	24 INCH	4 INCH	
				FOOT	FOOT	FOOT	FOOT	FOOT	FOOT		
<b>MAINLINE: Sta. 195+00 to Sta. 434+55</b>											
LT	195+00.0	TO	244+77.0	4977				4977			
RT	195+00.0	TO	244+77.0	4977				4977			
	195+00.0	TO	244+77.0			1244		1244		597	
	249+90.0	TO	266+69.6			420		420		202	
RT	237+03.0	TO	244+77.0		774			774			
LT	226+60.0	Otter Slough Rd.					12		12		
RT	226+60.0	Otter Slough Rd.					12		12		
<b>SN 039-0048 Omission - Sta. 244+77 to Sta. 249+50</b>											
LT	249+50.0	TO	266+69.6	1720				1720			
RT	249+50.0	TO	266+69.6	1520				1,520			
	283+92.2	TO	327+37.0			1,086		1,086		521	
LT	249+90.0	TO	259+63.0		973			973			
RT	253+00.0	Gorham Rd.					40		40	Thru Ln & Turn Ln. - 20' Each	
<b>EQ. Sta. 266+69.6 (bk.) = Sta. 283+92.9 (ah.)</b>											
LT	283+92.9	TO	327+37.0	4344				4,344			
RT	283+92.9	TO	327+37.0	4344				4,344			
RT	322+35.0	TO	327+37.0		502			502			
		TO									
<b>SN 039-0067 Omission - Sta. 327+37 to Sta. 333+96</b>											
LT	333+96.0	TO	434+55.0	9943				9,943			
RT	333+96.0	TO	434+55.0	10059				10,059			
	333+96.0	TO	358+46.0			613		613		294	
	363+69.0	TO	373+40.0			243		243		117	
	374+46.0	TO	434+55.0			1,502		1,502		721	
LT	369+08.0	Oakwoods Bottoms Rd.					12		12		
LT	333+96.0	TO	338+71.0		475			475			
RT	347+37.0	TO	363+69.0		1,632			1,632			
LT	358+46.0	TO	374+46.0		1,600			1,600			
RT	373+40.0	TO	380+06.0		666			666			
LT	384+81.0	TO	390+36.0		555			555			
RT	433+76.0	TO	434+55.0		79			79			
<b>SUB-TOTALS</b>				<b>41,883</b>	<b>7,256</b>	<b>5,108</b>	<b>76</b>	<b>54,247</b>	<b>76</b>	<b>2,452</b>	
<b>TOTALS</b>					<b>54,247</b>		<b>76</b>	<b>54,247</b>	<b>76</b>	<b>2,452</b>	

NOTE 1 : STOP BARS SHALL BE PLACED 10 FEET BACK FROM EDGE OF PAVEMENT OR AS DIRECTED BY THE ENGINEER.

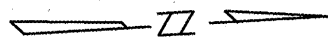
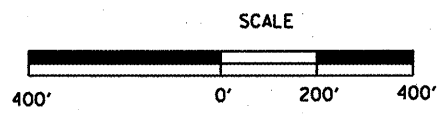

SICKLER RD.  
LT. STA. 3+14  
(SEE SIDE ROAD  
SCHEDULE, SHT. 9)

PT EQ STA 424+32.12 (BK) =  
STA. 0+32.12 (AP) PC STA 3+13.90

CURVE DATA  
 $\Delta = 63^\circ 19' 02''$   
 $D = 10^\circ 29' 56''$   
 $T = 2357.13'$   
 $R = 3822.69'$   
 $L = 4224.44'$   
 $E = 668.31'$

CL FAP 312 (IL 3)

PROP. PROJECT LOCATION 1 BEGINS  
STA. 396+14.34 (BUTT JOINT)  
SEE MEDIAN DETAIL, SHT'S 24 & 26.

PR. AGGREGATE WEDGE  
SHOULDERS - 2' WIDE  
BEGINS LT. & RT.  
STA. 401+00

EASTMAN RD.  
RT. STA. 412+10  
(SEE SIDE ROAD  
SCHEDULE, SHT. 9)

EQ STA 45+18.48 (BK) =  
PC STA 382+07.68 (AH)

EX. BIT. SURFACED  
PAVEMENT  
EX. PCC  
PAVEMENT

UNIFORM 24' PAVEMENT  
BEGINS STA. 401+00

EASTMAN RD.  
RT. STA. 398+35  
(SEE SIDE ROAD  
SCHEDULE, SHT. 9)

PR. AGGREGATE SHOULDERS  
TYPE B - 1 1/2"  
LT. & RT. STA. 396+15 TO  
LT. & RT. STA. 401+00 (SEE  
DETAIL, SHT. 24)

EQ. STA. 387+23.00 (IL 3) =  
STA. 386+90.03 (IL 149)

FILE NAME =  
ct:\pw\work\PIW1001\MCCORDKR\d0181783\sh

USER NAME = mcoordkr  
details.dgn  
PLOT SCALE = 400.0000' / IN.  
PLOT DATE = 5/3/2010

DESIGNED -  
DRAWN -  
CHECKED -  
DATE -

REVISED -  
REVISED -  
REVISED -  
REVISED -

STATE OF ILLINOIS  
DEPARTMENT OF TRANSPORTATION

PLAN LAYOUT - LOCATION 1  
STA. 396 ± 14.34 TO STA. 401 ± 50  
SCALE: SHEET NO. OF SHEETS STA. TO STA.

F.A.P. RTE.	SECTION	COUNTY	TOTAL SHEETS	SHEET NO.
312	12385-5+130.131BS-4	JACKSON	35	13
				CONTRACT NO. 10195
ILLINOIS FED. AID PROJECT				

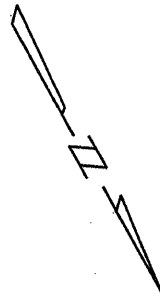
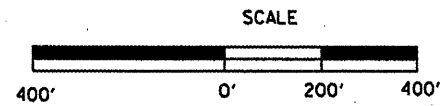

CURVE DATA

$\Delta = 15^\circ 35' 44''$   
 $D = 0^\circ 59' 47''$   
 $T = 787.37'$   
 $R = 5749.63'$   
 $L = 1565.00'$   
 $E = 53.66'$

CURVE DATA

$\Delta = 8^\circ 33' 33''$   
 $D = 0^\circ 29' 51''$   
 $T = 861.60'$   
 $R = 11513.97'$   
 $L = 1720.00'$   
 $E = 32.19'$

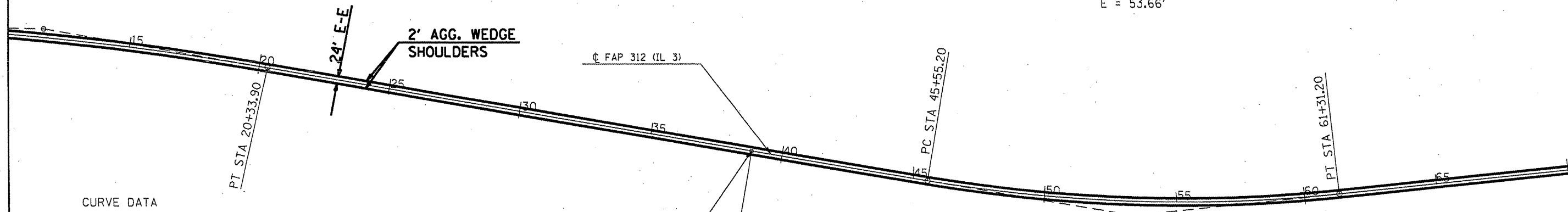

BUTTERMILK RD.  
 RT. STA. 38+84  
 (SEE SIDE ROAD  
 SCHEDULE, SHT. 9)

FILE NAME =  
 c:\pwork\pwork\WIDOT\MCCORDKR\d0181783\sh

USER NAME = mccordkr  
 details.dgn  
 PLOT SCALE = 400.0000 ' / IN.  
 PLOT DATE = 4/26/2010

DESIGNED -  
 DRAWN -  
 CHECKED -  
 DATE -

REVISED -  
 REVISED -  
 REVISED -  
 REVISED -

STATE OF ILLINOIS  
 DEPARTMENT OF TRANSPORTATION

PLAN LAYOUT - LOCATION 1  
 STA. 10 ± 50 TO STA. 70 ± 00

SCALE: SHEET NO. OF SHEETS STA. TO STA.

F.A.P. RTE.	SECTION	COUNTY	TOTAL SHEETS	SHEET NO.
312	12385-5H130,131HS-4	JACKSON	35	19
CONTRACT NO. 78195			ILLINOIS FED. AID PROJECT	

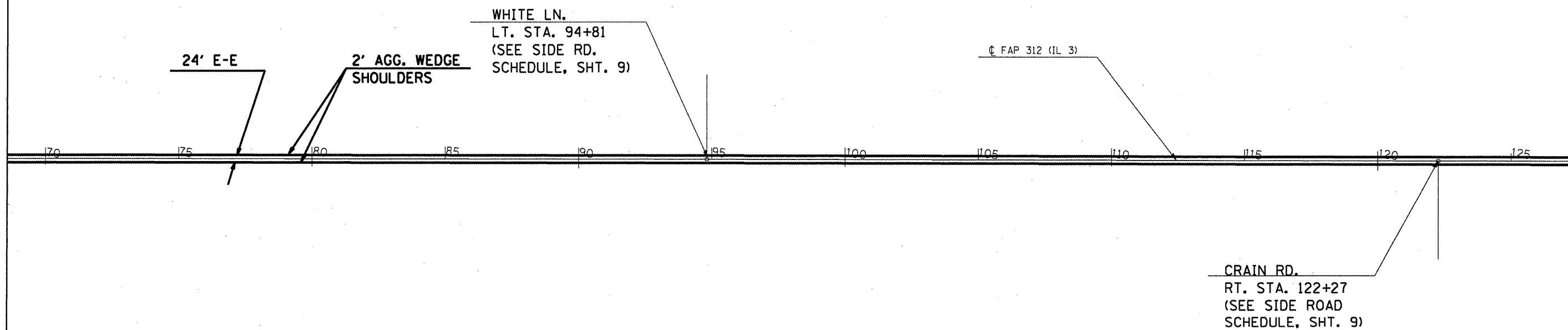
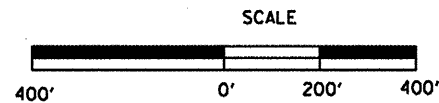

FILE NAME =  
 c:\pw\work\VPWIDOT\MCCORDKR\d0181783\ahs

USER NAME = mcoordkr  
 details.dgn  
 PLOT SCALE = 400.0000' / IN.  
 PLOT DATE = 5/5/2010

DESIGNED -  
 DRAWN -  
 CHECKED -  
 DATE -

REVISED -  
 REVISED -  
 REVISED -  
 REVISED -

**STATE OF ILLINOIS  
 DEPARTMENT OF TRANSPORTATION**

**--- PLAN LAYOUT -- LOCATION 1 ---  
 --- STA. 70 ± 00 TO STA. 127 ± 00 ---**

SCALE: \_\_\_\_\_ SHEET NO. \_\_\_\_ OF \_\_\_\_ SHEETS STA. \_\_\_\_\_ TO STA. \_\_\_\_\_

F.A.P. RTE.	SECTION	COUNTY	TOTAL SHEETS	SHEET NO.
312	1238S-5(130.1318S-4	JACKSON	35	15
				<b>CONTRACT NO. 78195</b>
ILLINOIS FED. AID PROJECT				

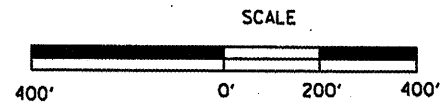

CURVE DATA

$\Delta = 2^{\circ} 8' 20''$   
 $D = 0^{\circ} 11' 56''$   
 $T = 537.5'$   
 $R = 28797.80'$   
 $L = 1075.00'$   
 $E = 5.02'$

Q FAP 312 (IL 3)

24' E-E

2' AGG. WEDGE SHOULDERS

PC STA 174+34.44

PT STA 185+09.44



FILE NAME *	USER NAME = mccordkr	DESIGNED -	REVISED -	<b>STATE OF ILLINOIS DEPARTMENT OF TRANSPORTATION</b>	<b>PLAN LAYOUT -- LOCATION 1 -- -- STA. 127 ± 00 TO STA. 185 ± 00 --</b>	F.A.P. RTE.	SECTION	COUNTY	TOTAL SHEETS	SHEET NO.	
ca:\pwwork\pwwid\mccordkr\d0181703\sh	details.dgn	DRAWN -	REVISED -			312	12389-54130.13185-4	JACKSON	35	16	
	PLOT SCALE = 400.0000' / IN.	CHECKED -	REVISED -			CONTRACT NO. 78195					
	PLOT DATE = 4/26/2010	DATE -	REVISED -			ILLINOIS FED. AID PROJECT					



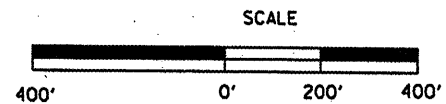

OMIT SN 039-2025  
STA. 193+56 TO  
STA. 194+51

EQ STA 195+00.0 (BK) =  
STA 194+90.2 (AH)

BIG LAKE RD.  
LT. STA. 205+67  
(SEE SIDE RD. SCHEDULE,  
SHT. 9)

24' E-E

2' AGG. WEDGE  
SHOULDERS

☉ FAP 312 (IL 3)

IL 151 (KENT KELLER HIGHWAY)  
RT. STA. 195+63.5

FOR DETAIL OF INTERSECTION  
AND STRUCTURE, SEE SHT'S 25 & 26.

PC STA 215+85.96

PT EQ STA 225+85.96 (BK) =  
STA. 226+00 (AH)

CURVE DATA

$\Delta = 2^{\circ} 30' 132''$   
D =  $0^{\circ} 15' 01''$   
T = 500.08'  
R = 22884.56'  
L = 1000.00'  
E = 5.46'

FILE NAME =	USER NAME = mccordkr	DESIGNED -	REVISD -
ca:\pwwork\PMIDOT\MCCORDKR\d8181783\sh	details.dgn	DRAWN -	REVISD -
	PLOT SCALE = 488.8888 / IN.	CHECKED -	REVISD -
	PLOT DATE = 4/26/2010	DATE -	REVISD -

STATE OF ILLINOIS  
DEPARTMENT OF TRANSPORTATION

--- PLAN LAYOUT --- LOCATION 1 ---  
--- STA. 186 ± 00 TO STA. 245 ± 00 ---

SCALE: \_\_\_\_\_ SHEET NO. \_\_\_\_\_ OF \_\_\_\_\_ SHEETS STA. \_\_\_\_\_ TO STA. \_\_\_\_\_

F.A.P. RTE.	SECTION	COUNTY	TOTAL SHEETS	SHEET NO.
312	12385-5(130.131)BS-4	JACKSON	35	17
CONTRACT NO. 70195				

ILLINOIS FED. AID PROJECT

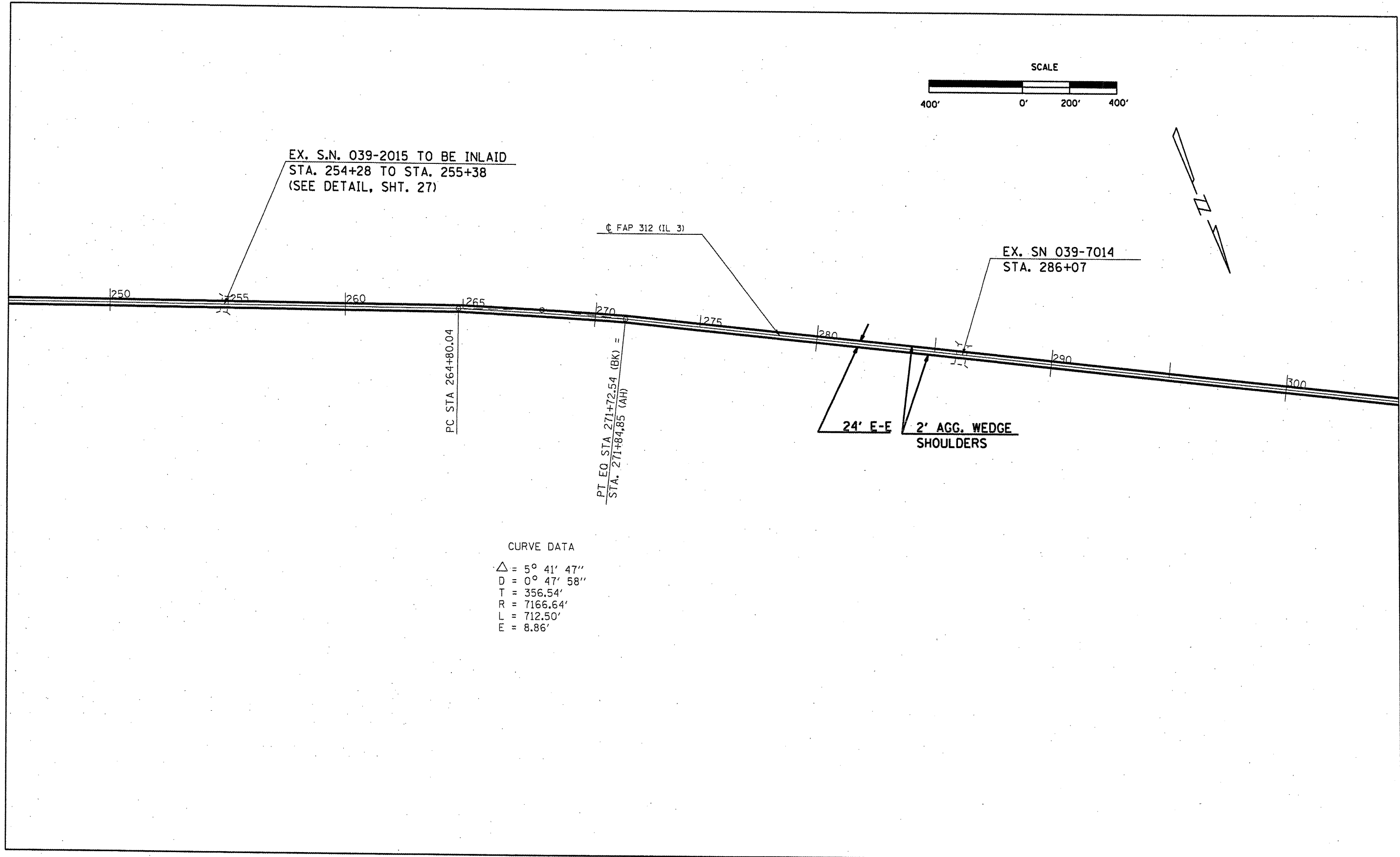

CURVE DATA  
 $\Delta = 5^\circ 41' 47''$   
 $D = 0^\circ 47' 58''$   
 $T = 356.54'$   
 $R = 7166.64'$   
 $L = 712.50'$   
 $E = 8.86'$

FILE NAME =	USER NAME = mcaardkr	DESIGNED -	REVISD -	<b>STATE OF ILLINOIS DEPARTMENT OF TRANSPORTATION</b>	<b>PLAN LAYOUT - LOCATION 1 - STA. 245 ± 00 TO STA. 305 ± 00</b>	F.A.P. RTE:	SECTION	COUNTY	TOTAL SHEETS	SHEET NO.	
c:\pwork\PW100T\MCCORDKR\d0181703\ah	details.dgn	DRAWN -	REVISD -			312	12385:5n130:131185:4	JACKSON	35	18	
	PLOT SCALE = 400.0000' / IN.	CHECKED -	REVISD -			<b>CONTRACT NO. 70195</b>					
	PLOT DATE = 4/26/2010	DATE -	REVISD -			(ILLINOIS) FED. AID PROJECT					

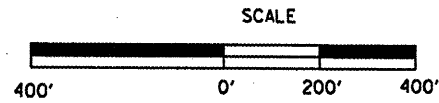

CURVE DATA  
 $\Delta = 10^{\circ} 05' 38''$   
 $D = 1^{\circ} 41' 55''$   
 $T = 297.88'$   
 $R = 3572.89'$   
 $L = 594.12'$   
 $E = 13.12'$

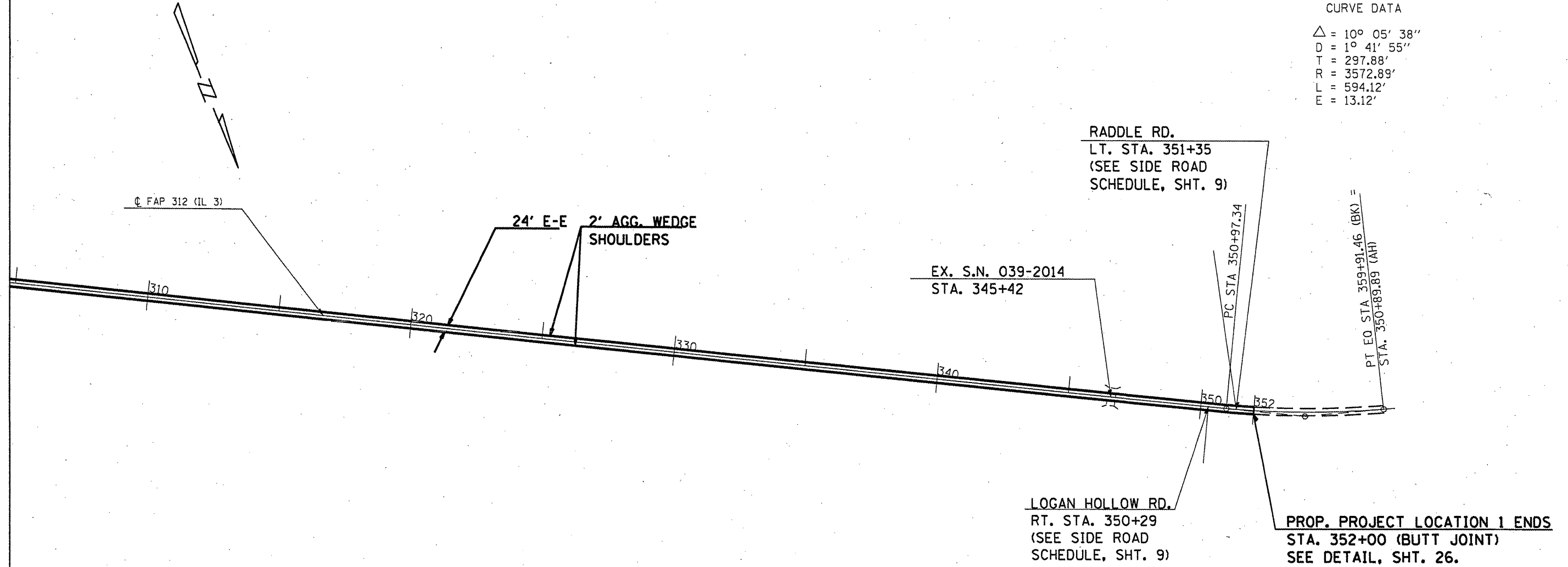

FILE NAME =	USER NAME = mcoordr	DESIGNED -	REVISED -
ca\pwork\PIWIDOT\MCCORDR\0181703\sh	details.dgn	DRAWN -	REVISED -
	PLOT SCALE = 400.0000' / IN.	CHECKED -	REVISED -
	PLOT DATE = 4/26/2010	DATE -	REVISED -

STATE OF ILLINOIS  
 DEPARTMENT OF TRANSPORTATION

--- PLAN LAYOUT --- LOCATION 1 ---  
 --- STA. 305 ± 00 TO STA. 352 ± 00 ---

SCALE: SHEET NO. OF SHEETS STA. TO STA.

F.A.P. RTE.	SECTION	COUNTY	TOTAL SHEETS	SHEET NO.
312	12385-5(130.13)185-4	JACKSON	35	19
CONTRACT NO. 78195				

ILLINOIS FED. AID PROJECT

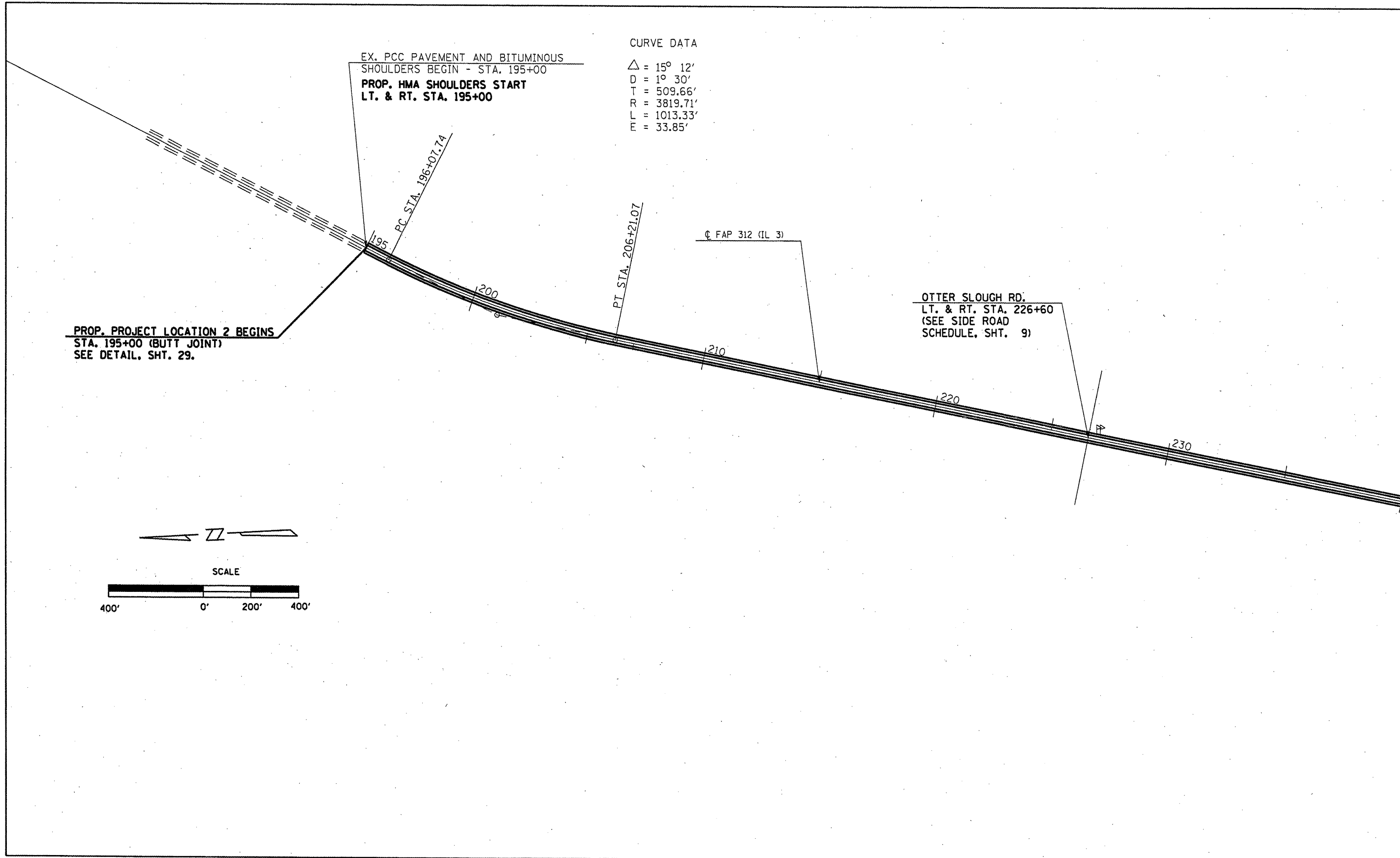

PROP. PROJECT LOCATION 2 BEGINS  
 STA. 195+00 (BUTT JOINT)  
 SEE DETAIL. SHT. 29.

EX. PCC PAVEMENT AND BITUMINOUS  
 SHOULDERS BEGIN - STA. 195+00  
 PROP. HMA SHOULDERS START  
 LT. & RT. STA. 195+00

CURVE DATA  
 $\Delta = 15^\circ 12'$   
 $D = 1^\circ 30'$   
 $T = 509.66'$   
 $R = 3819.71'$   
 $L = 1013.33'$   
 $E = 33.85'$

OTTER SLOUGH RD.  
 LT. & RT. STA. 226+60  
 (SEE SIDE ROAD  
 SCHEDULE, SHT. 9)

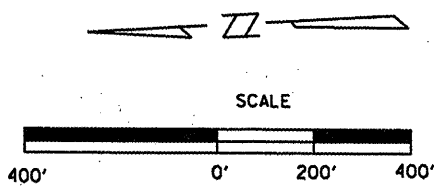

FILE NAME =	USER NAME = mcoordkr	DESIGNED -	REVISD -	<b>STATE OF ILLINOIS DEPARTMENT OF TRANSPORTATION</b>	<b>--- PLAN LAYOUT -- LOCATION 2 --- --- STA. 195 ± 00 TO STA. 240 ± 00 ---</b>	F.A.P. RTE. =	SECTION	COUNTY	TOTAL SHEETS	SHEET NO.	
ct:\p\work\PH1001\MCCORDKR\d0181783\shh	details.dgn	DRAWN -	REVISD -			312	12385-5(130-131)85-4	JACKSON	35	20	
PLOT SCALE = 400.0000' / IN.		CHECKED -	REVISD -			CONTRACT NO. 78195		ILLINOIS FED. AID PROJECT			
PLOT DATE = 4/26/2010		DATE -	REVISD -			SCALE: _____ SHEET NO. ___ OF ___ SHEETS STA. _____ TO STA. _____					

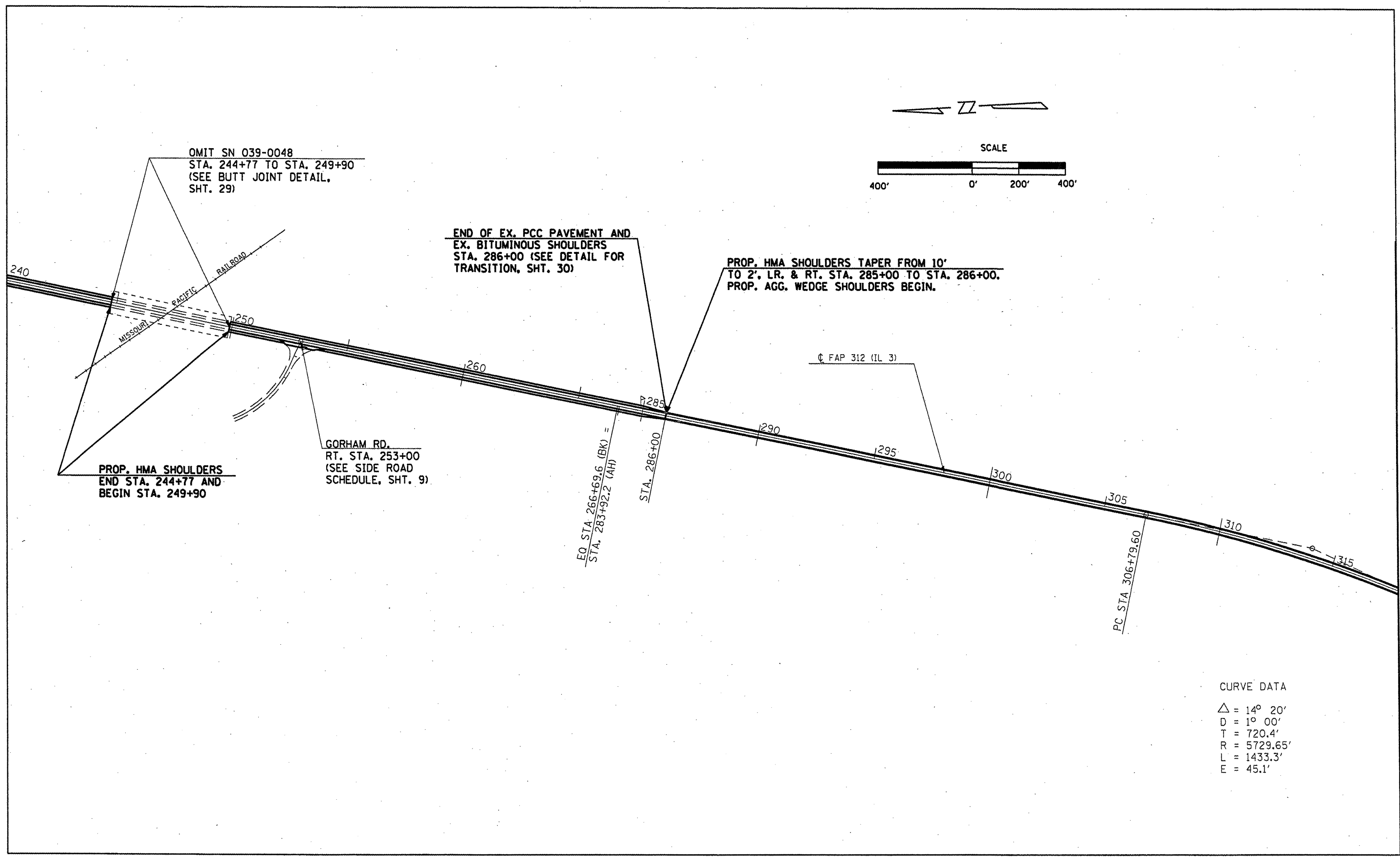

OMIT SN 039-0048  
 STA. 244+77 TO STA. 249+90  
 (SEE BUTT JOINT DETAIL,  
 SHT. 29)

END OF EX. PCC PAVEMENT AND  
 EX. BITUMINOUS SHOULDERS  
 STA. 286+00 (SEE DETAIL FOR  
 TRANSITION, SHT. 30)

PROP. HMA SHOULDERS TAPER FROM 10'  
 TO 2' LR. & RT. STA. 285+00 TO STA. 286+00.  
 PROP. AGG. WEDGE SHOULDERS BEGIN.

PROP. HMA SHOULDERS  
 END STA. 244+77 AND  
 BEGIN STA. 249+90

GORHAM RD.  
 RT. STA. 253+00  
 (SEE SIDE ROAD  
 SCHEDULE, SHT. 9)

EQ STA 266+69.6 (BK)  
 STA. 283+92.2 (AH)

PC STA 306+79.60

CURVE DATA  
 $\Delta = 14^\circ 20'$   
 $D = 1^\circ 00'$   
 $T = 720.4'$   
 $R = 5729.65'$   
 $L = 1433.3'$   
 $E = 45.1'$

FILE NAME = c:\pwwork\pwwork\MCCORDKR\d0181703\sh	USER NAME = mcoordkr details.dgn	DESIGNED - DRAWN -	REVISED - REVISED -	<b>STATE OF ILLINOIS DEPARTMENT OF TRANSPORTATION</b>	<b>--- PLAN LAYOUT -- LOCATION 2 --- --- STA. 240 ± 00 TO STA. 317 ± 00 ---</b>		F.A.P. RTE. 312	SECTION 1238S-5(130.131)BS-4	COUNTY JACKSON	TOTAL SHEETS 35	SHEET NO. 21	
PLOT SCALE = 400.0000' / IN.	CHECKED -	REVISED -	REVISED -		SCALE: _____	SHEET NO. _____ OF _____ SHEETS	STA. _____ TO STA. _____	CONTRACT NO. 78195				
PLOT DATE = 4/26/2010	DATE -	REVISED -	REVISED -		ILLINOIS FED. AID PROJECT							

CURVE DATA

Δ = 23° 56'  
 D = 3° 01' 24"  
 T = 401.69'  
 R = 1895.18'  
 L = 791.67'  
 E = 42.10'



SCALE

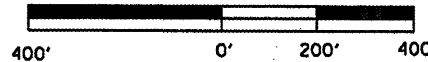

SN 039-0067 TO BE OMITTED  
 STA. 327+37 TO STA. 333+96  
 SEE BUTT JOINT DETAIL,  
 SHT. 29)

HAPPY HOLLOW RD.  
 RT. STA. 331+59

PROP. AGG. WEDGE SHOULDERS  
 END STA. 327+37 AND  
 BEGIN STA. 333+96

CL FAP 312 (IL 3)

OAKWOOD BOTTOMS RD.  
 LT. STA. 369+08  
 (SEE SIDE ROAD  
 SCHEDULE, SHT. 9)

CURVE DATA

Δ = 15° 08'  
 D = 1° 42'  
 T = 447.7'  
 R = 3370.46'  
 L = 890.2'  
 E = 29.6'

FILE NAME =  
 c:\p\work\p\WIDOT\MCCORDKR\d8181703\sh

USER NAME = mcoordkr  
 details.dgn  
 PLOT SCALE = 400.0000' / IN.  
 PLOT DATE = 4/26/2010

DESIGNED -	---	REVISED -	-----
DRAWN -	---	REVISED -	-----
CHECKED -	---	REVISED -	-----
DATE -	-----	REVISED -	-----

STATE OF ILLINOIS  
 DEPARTMENT OF TRANSPORTATION

--- PLAN LAYOUT - LOCATION 2 ---  
 --- STA. 317 ± 00 TO STA. 379 ± 00 ---

SCALE: \_\_\_\_\_ SHEET NO. \_\_\_\_ OF \_\_\_\_ SHEETS STA. \_\_\_\_\_ TO STA. \_\_\_\_\_

F.A.P. RTE.	SECTION	COUNTY	TOTAL SHEETS	SHEET NO.
312	12385-5(130.13)85-4	JACKSON	35	22

CONTRACT NO. 70195

ILLINOIS FED. AID PROJECT

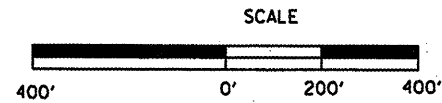

CURVE DATA

$\Delta = 15^\circ 12'$   
 $D = 1^\circ 30'$   
 $T = 509.66'$   
 $R = 3819.71'$   
 $L = 1013.33'$   
 $E = 33.85'$

**PROP. PROJECT LOCATION 2 ENDS**  
**STA. 434+55 (BUTT JOINT)**  
**SEE DETAIL, SHT. 28.**

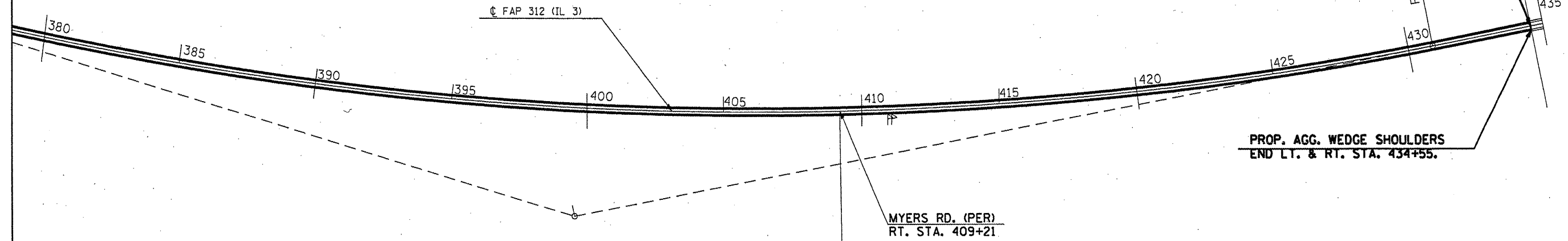

**PROP. AGG. WEDGE SHOULDERS**  
**END LT. & RT. STA. 434+55.**

**MYERS RD. (PER)**  
**RT. STA. 409+21**

FILE NAME =	USER NAME = mcoordkr	DESIGNED -	REVISD -
o:\p\work\PIWIDOT\MCCORDKR\d0181783\sh	details.dgn	DRAWN -	REVISD -
	PLOT SCALE = 400.0000' / IN.	CHECKED -	REVISD -
	PLOT DATE = 4/26/2010	DATE -	REVISD -

**STATE OF ILLINOIS**  
**DEPARTMENT OF TRANSPORTATION**

**PLAN LAYOUT - LOCATION 2...**  
**STA. 379 ± 00 TO STA. 434 ± 55**

SCALE: \_\_\_\_\_ SHEET NO. \_\_\_\_\_ OF \_\_\_\_\_ SHEETS STA. \_\_\_\_\_ TO STA. \_\_\_\_\_

F.A.P. RTE.	SECTION	COUNTY	TOTAL SHEETS	SHEET NO.
312	12385-5(130.131)B5-4	JACKSON	35	23
CONTRACT NO. 78195			ILLINOIS FED. AID PROJECT	

**BEGINNING OF PROJECT  
LOCATION 1  
STA. 396+14.34**

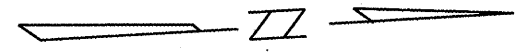
  
 NOT TO SCALE

PROP. AGG. SHOULDERS, TY. B ENDS  
 PROP. AGG. WEDGE SHOULDER - 2' BEGINS  
 LT. & RT. STA. 401+00  
 TAPER PROP. AGG. SHOULDERS, TY A  
 FROM 8' TO 2' IN LAST 100'.

EX. MEDIAN TO BE MILLED AND RESURFACED  
 FROM STA. 396+14.34 TO STA. 397+64,  
 AS SHOWN ON TYPICALS, SHT. 6.

☉ FAP 312 (IL 3)

PROP. AGG. SHOULDERS, TY. B BEGINS  
 LT. & RT. STA. 396+14.34

STA. 396+14.34  
 PR. BUTT JOINT

EASTMAN RD.  
 RT. STA. 398+35

30' TRANSITION  
 (SEE SHT. 26)

395

FILE NAME =	USER NAME = macordkr	DESIGNED -	REVISD -	<b>STATE OF ILLINOIS DEPARTMENT OF TRANSPORTATION</b>	<b>DETAIL OF MILLING AND STRIPING -- AT BEGINNING OF LOCATION 1 --</b>	F.A.P. RTE.	SECTION	COUNTY	TOTAL SHEETS	SHEET NO.	
ct:\pwwork\pwwid\DOT\MCCORDKR\d0181703\shht	details.dgn	DRAWN -	REVISD -			312	12385-5(130,131)BS:4	JACKSON	35	29	
PLOT SCALE = 200.0000' / IN.	CHECKED -	REVISD -	REVISD -			CONTRACT NO. 70195					
PLOT DATE = 5/3/2010	DATE -	REVISD -	REVISD -			ILLINOIS FED. AID PROJECT					
					SCALE: _____	SHEET NO. _____ OF _____ SHEETS		STA. _____ TO STA. _____			



STRUCTURE NO. 039-2025 OMISSION DETAIL

LOCATION 1  
STA. 194+10

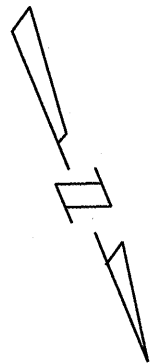

NOT TO SCALE

PROP. HMA SURFACE COURSE  
TO BE INLAID - STA.194+51  
TO STA. 197+00

30' TRANSITION  
(SEE DETAIL,  
SHT. 26)

OMIT SN 039-2025  
STA. 193+56 TO  
STA. 194+51

PROP. AGG. WEDGE  
SHOULDER, TYPE B  
BEGINS STA. 197+00

EQ STA 195+00.0 (BK)=  
STA 194+90.2 (AH)

EX. PCC SHOULDERS

PROP. AGG. WEDGE  
SHOULDER, TYPE B  
ENDS STA. 190+80

PROP. HMA SURFACE COURSE  
TO BE INLAID -  
STA. 190+80 TO STA. 193+56

30' TRANSITION  
(SEE DETAIL,  
SHT. 26)

IL. 151 (KENT KELLER HIGHWAY)  
RT. STA. 195+63.5

FILE NAME #	USER NAME = mccordkr	DESIGNED -	REVISED -	<b>STATE OF ILLINOIS DEPARTMENT OF TRANSPORTATION</b>	<b>SN 039-2025 OMISSION DETAIL LOC. 1 - STA. 194 ± 10</b>	F.A.P. RTE.	SECTION	COUNTY	TOTAL SHEETS	SHEET NO.	
ct\pw_work\PM1001\MCCORDKR\08181783\shh	details.dgn	DRAWN -	REVISED -			312	12385-50130.131185-4	JACKSON	39	25	
	PLOT SCALE = 200.0000' / IN.	CHECKED -	REVISED -			CONTRACT NO. 78195					
	PLOT DATE = 5/3/2010	DATE -	REVISED -			ILLINOIS FED. AID PROJECT					

DETAIL FOR HMA SURFACE REMOVAL - BUTT JOINT LOCATION 1

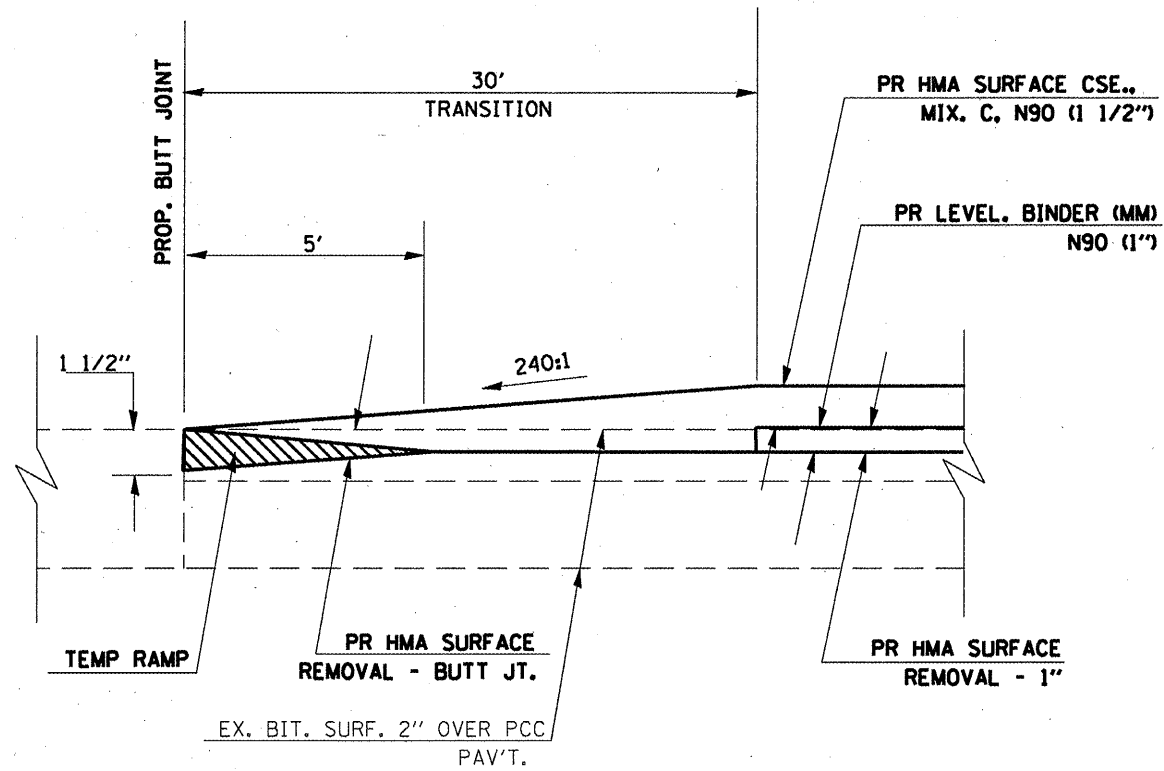

TO BE USED:  
 STA. 396+14.34 (BEGINNING OF PROJECT)  
 STA. 352+00 (END OF PROJECT)

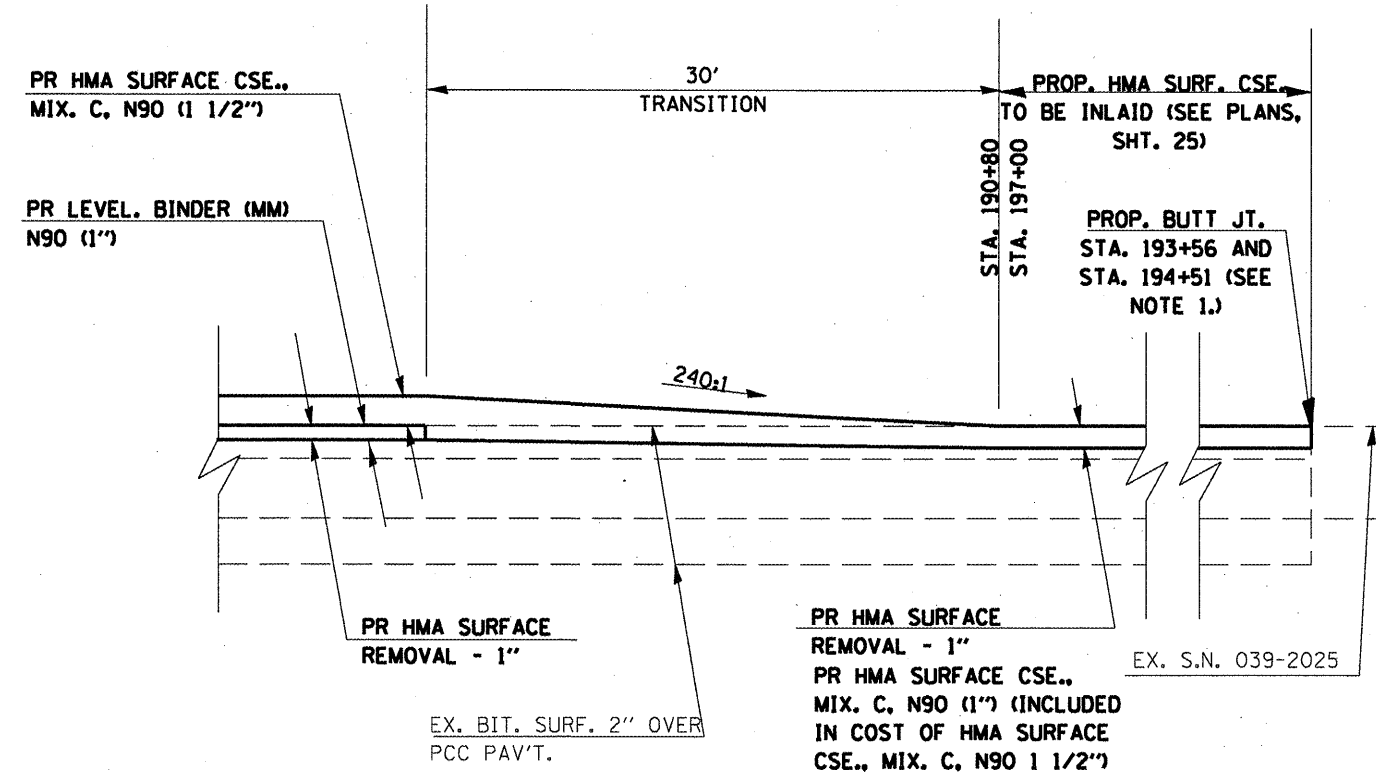

TO BE USED:  
 STA. 190+80 TO STA. 197+00  
 (OMISSION OF SN 039-2025)

NOTE 1: BUTT JOINT AND SAW CUT ARE INCLUDED IN COST OF HMA SURFACE REMOVAL - 1".

FILE NAME =	USER NAME = mcoordkr	DESIGNED -	REVISED -	<b>STATE OF ILLINOIS DEPARTMENT OF TRANSPORTATION</b>	<b>DETAIL: BUTT JOINT AT BEGINNING AND ENDING STATION</b>	F.A.P. RTE.	SECTION	COUNTY	TOTAL SHEETS	SHEET NO.	
cr:\prk_work\PWIDOT\MCCORDKR\d0181703\shh	details.dgn	DRAWN -	REVISED -			312	12385-5d130,131185-4	JACKSON	35	26	
PLOT SCALE = 200.0000' / IN.	CHECKED -	REVISED -	SCALE: _____			SHEET NO. _____ OF _____ SHEETS	STA. _____ TO STA. _____	ILLINOIS FED. AID PROJECT			
PLOT DATE = 5/3/2010	DATE -	REVISED -	CONTRACT NO. 78195								

DETAIL FOR HMA SURFACE COURSE INLAY  
LOCATION 1

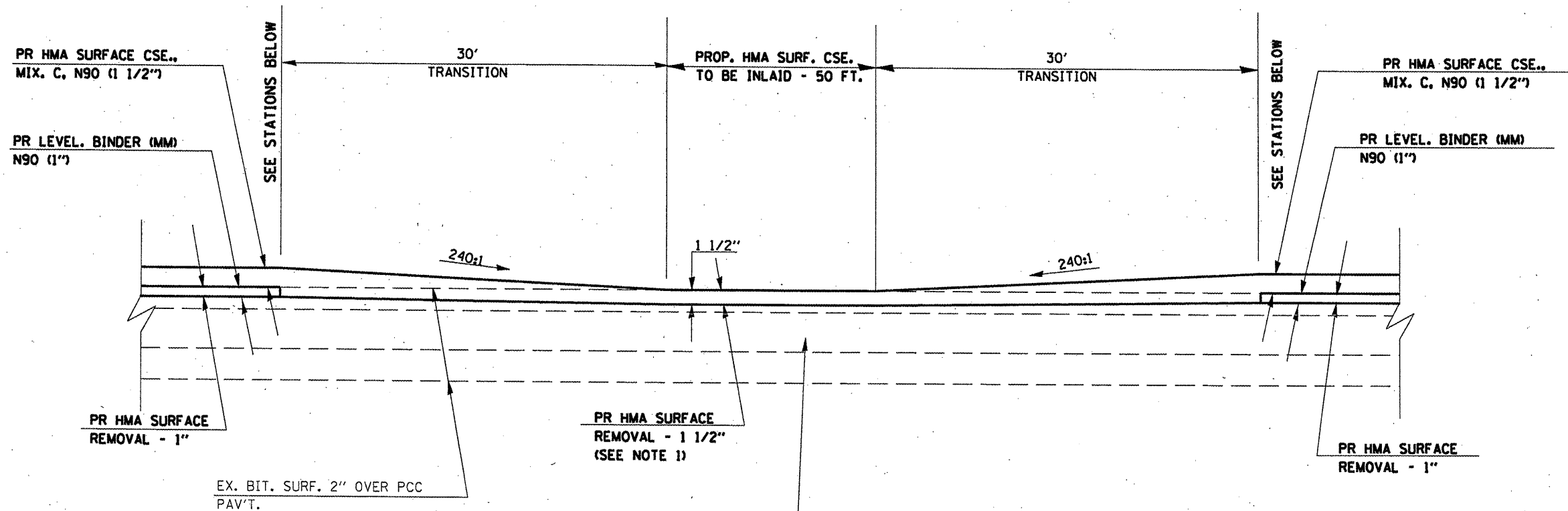

PR HMA SURFACE  
REMOVAL - 1 1/2"  
(SEE NOTE 1)

EX. SN 039-2014,  
EX. SN 039-7014 AND  
EX. SN 039-2015

NOTE 1: COST OF HMA SURFACE REMOVAL - 1 1/2" IS INCLUDED IN COST OF HMA SURFACE REMOVAL - 1".

TO BE USED:  
• STA. 254+28 TO STA. 255+38 (SN 039-2015)

FILE NAME =	USER NAME = mcoordkr	DESIGNED -	REVISED -
c:\pwork\p1001\MCCORDKR\0181783\sh	details.dgn	DRAWN -	REVISED -
PLOT SCALE = 200.0000' / IN.	CHECKED -	REVISIONS -	REVISIONS -
PLOT DATE = 4/27/2010	DATE -	REVISIONS -	REVISIONS -

STATE OF ILLINOIS  
DEPARTMENT OF TRANSPORTATION

SCALE: \_\_\_\_\_ SHEET NO. \_\_\_\_ OF \_\_\_\_ SHEETS | STA. \_\_\_\_\_ TO STA. \_\_\_\_\_

F.A.P. RTE.	SECTION	COUNTY	TOTAL SHEETS	SHEET NO.
312	12385-5(130.131)BS-4	JACKSON	35	27
CONTRACT NO. 78195				

ILLINOIS FPD. AIR PROJECT

DETAIL FOR HMA SURFACE REMOVAL - BUTT JOINT  
LOCATION 2

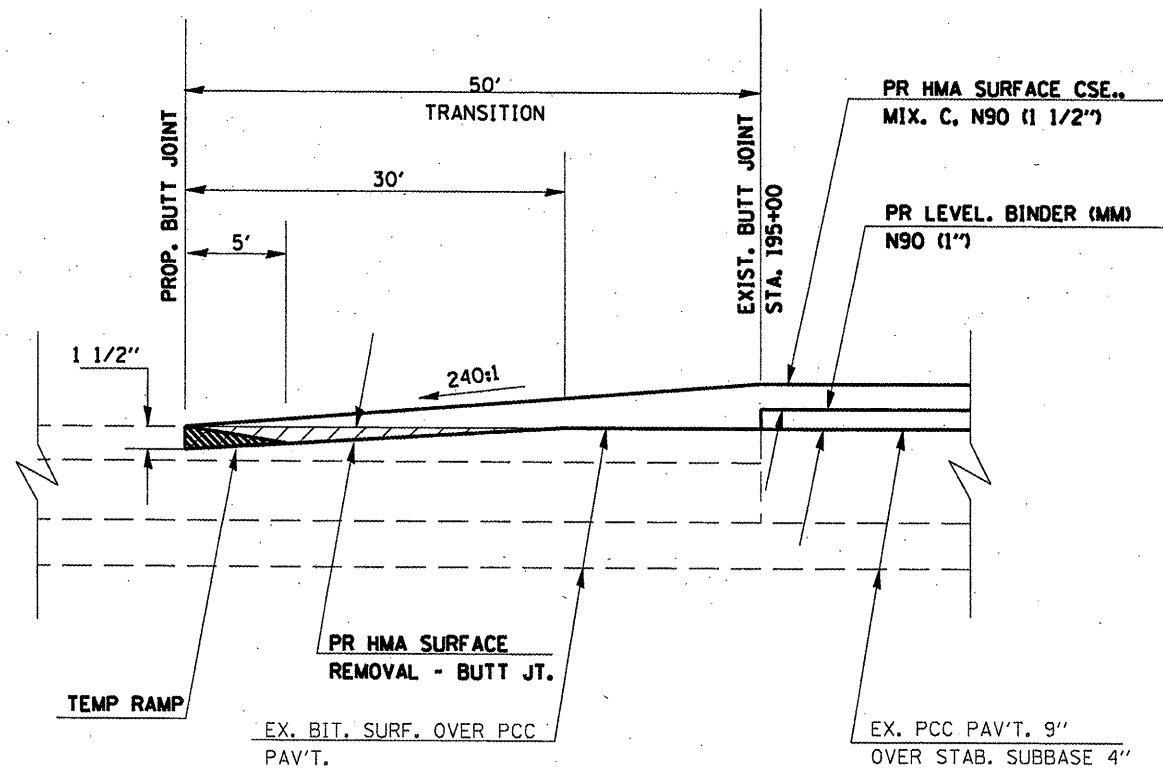

TO BE USED:  
STA. 195+00 (BEGINNING OF PROJECT)

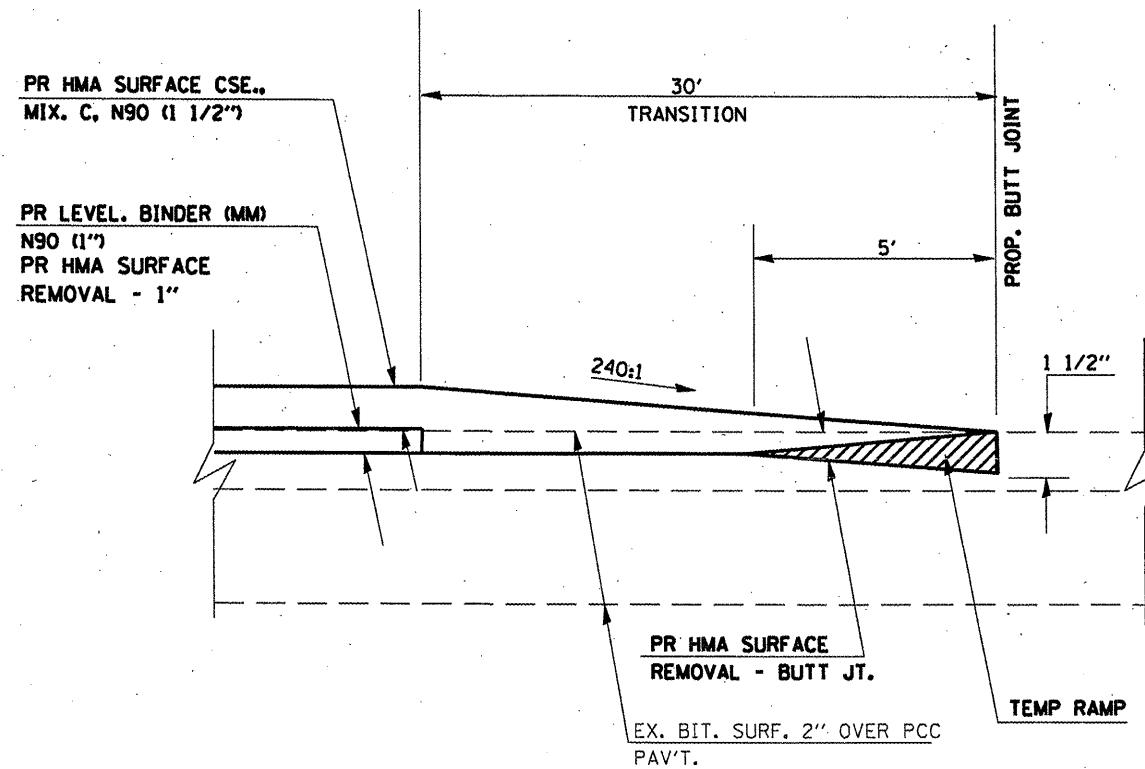

TO BE USED:  
STA. 434+55 (END OF PROJECT)

FILE NAME =	USER NAME = mcoordkr	DESIGNED -	REVISED -
ca:\pwork\p\WIDOT\MCCORDKR\d8181783\sh	details.dgn	DRAWN -	REVISED -
PLOT SCALE = 200.0000 ' / IN.	CHECKED -	REVIS	REVIS
PLOT DATE = 4/27/2010	DATE -	REVIS	REVIS

STATE OF ILLINOIS  
DEPARTMENT OF TRANSPORTATION

DETAIL: LOG. 2 BUTT JOINT  
BEGINNING AND ENDING STATION

SCALE: SHEET NO. OF SHEETS STA. TO STA.

F.A.P. RTE.	SECTION	COUNTY	TOTAL SHEETS	SHEET NO.
312	12385-5(130.131)BS-4	JACKSON	35	28
CONTRACT NO. 10195				

ILLINOIS FED. AID PROJECT

DETAIL FOR BUTT JOINTS AT  
SN 039-0048 AND SN 039-0067  
LOCATION 2

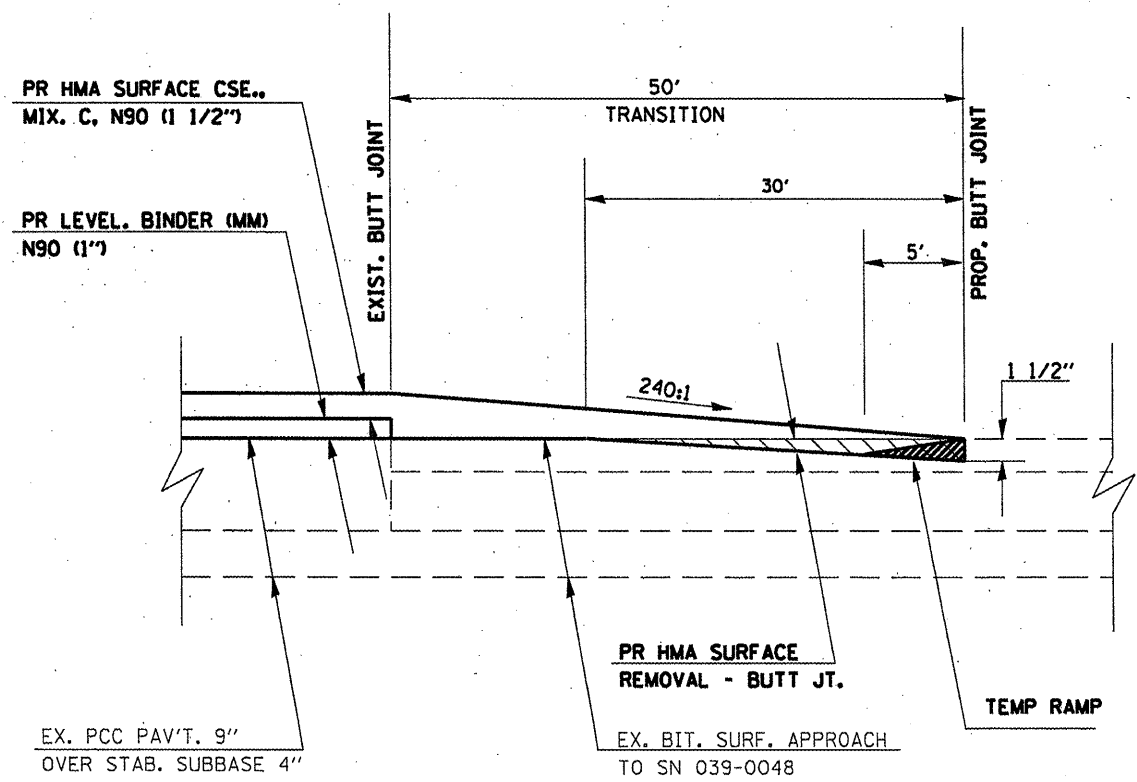

TO BE USED:  
STA. 244+77 AND STA. 249+90  
(OMIT SN 039-0048)

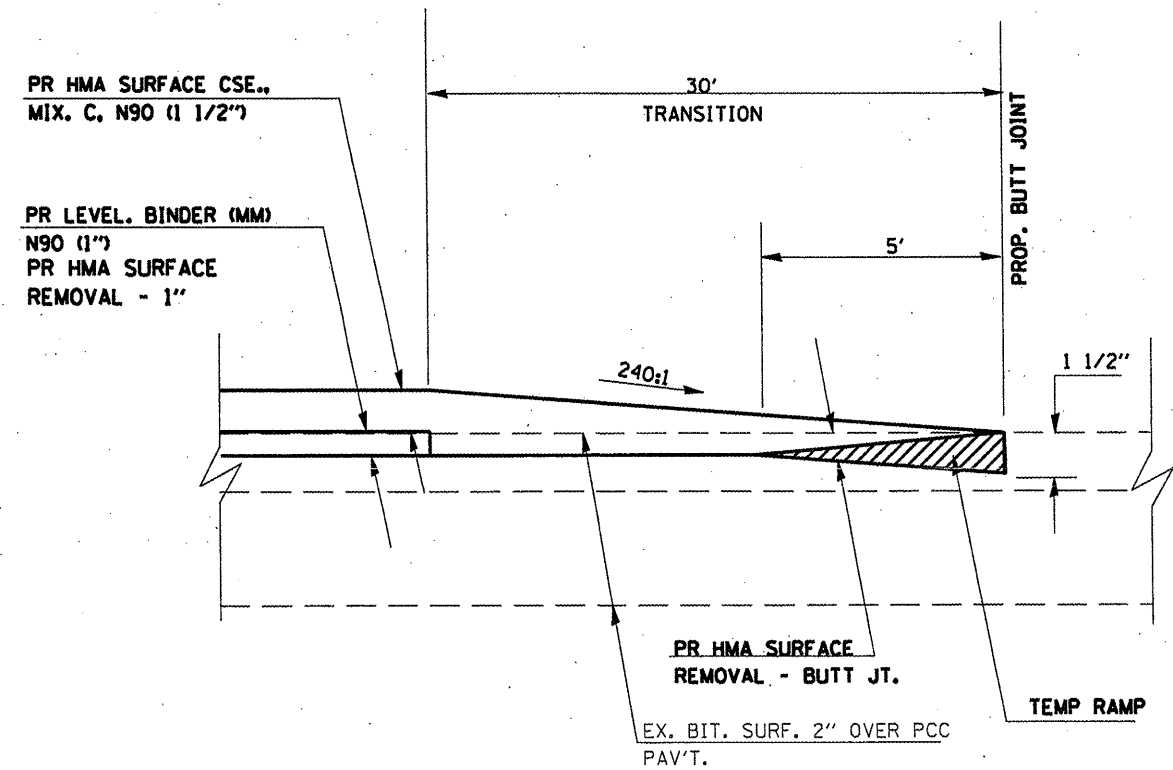

TO BE USED:  
STA. 327+37 AND STA. 333+96  
(OMIT SN 039-0067)

FILE NAME =	USER NAME = mccordkr	DESIGNED -	REVISED -	<b>STATE OF ILLINOIS DEPARTMENT OF TRANSPORTATION</b>	<b>--- DETAIL: LOC. 2 BUTT JOINTS --- --- AT EXISTING STRUCTURES ---</b>	F.A.P. RTE.	SECTION	COUNTY	TOTAL SHEETS	SHEET NO.
ca:\pwwork\pwwork\MCCORDKR\20181703\shb\details.dgn	DRAWN -	REVISED -	312			12385-5r(130.13)RS-4	JACKSON	35	29	
PLOT SCALE = 200.0000 ' / IN.	CHECKED -	REVISED -	CONTRACT NO. 70195							
PLOT DATE = 4/27/2018	DATE -	REVISED -	ILLINOIS FED. AID PROJECT							
				SCALE: _____	SHEET NO. _____ OF _____ SHEETS	STA. _____ TO STA. _____				

DETAIL FOR TRANSITION FROM  
EX. PCC PAVEMENT TO EX. BITUMINOUS PAVEMENT  
LOCATION 2

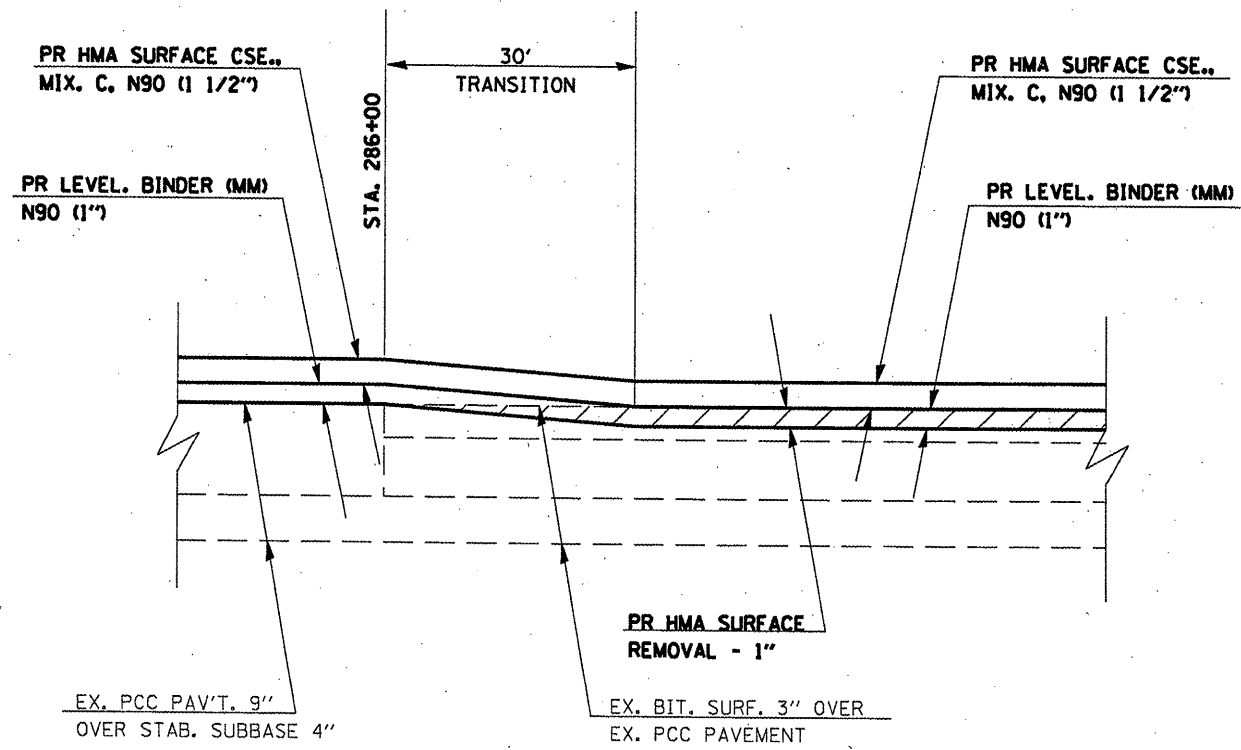

TO BE USED:  
STA. 286+00

FILE NAME =  
c:\pwwork\pwwid\DOT\MCCORDKR\d0181703\shh\details.dgn

USER NAME = macordkr  
PLOT SCALE = 200.0000' / IN.  
PLOT DATE = 4/27/2019

DESIGNED -  
DRAWN -  
CHECKED -  
DATE -

REVISED -  
REVISED -  
REVISED -  
REVISED -

STATE OF ILLINOIS  
DEPARTMENT OF TRANSPORTATION

DETAIL - TAPER OF SURFACE  
AT STATION 286 ± 00

SCALE: SHEET NO. OF SHEETS STA. TO STA.

F.A.P. RTE.	SECTION	COUNTY	TOTAL SHEETS	SHEET NO.
312	12385-5(130.131)RS:4	JACKSON	35	30
				CONTRACT NO. 78195

ILLINOIS FED. AID PROJECT

LOCATION | SIDEROAD AND ENTRANCE DETAILS

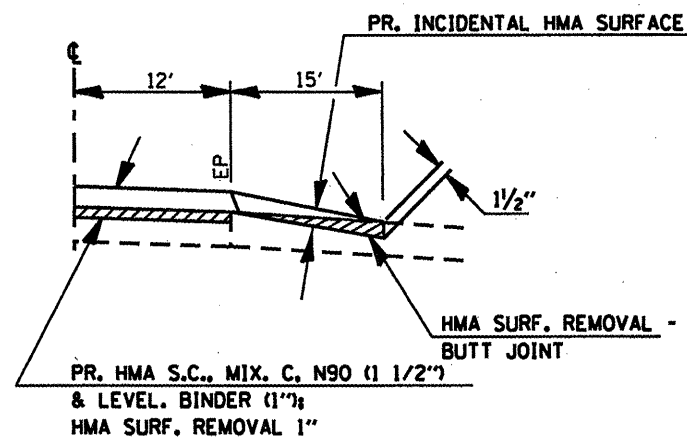

SIDE ROAD SEC. B-B  
EX. BIT. OR CONC. SURFACE

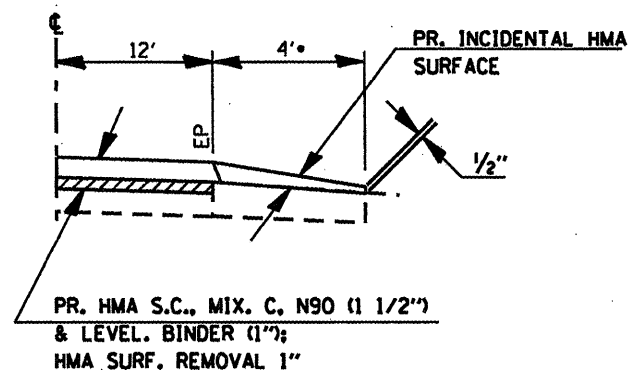

PE OR CE SEC. A-A  
EX. BIT. OR CONC. SURFACE  
•OR END OF BIT. APRON

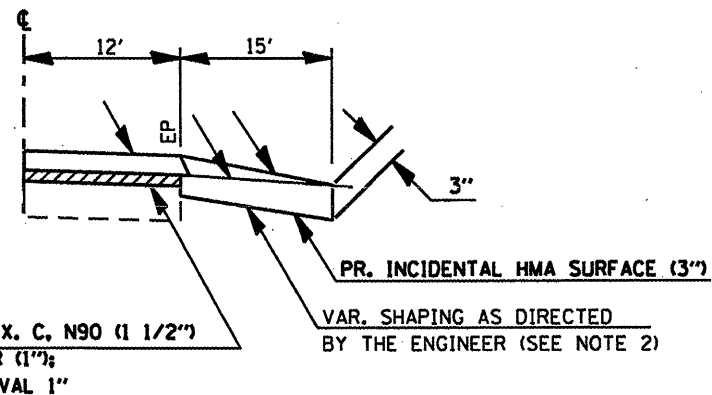

SIDE ROAD SEC. B-B  
EX. AGGREGATE SURFACE  
(SEE NOTE 1)

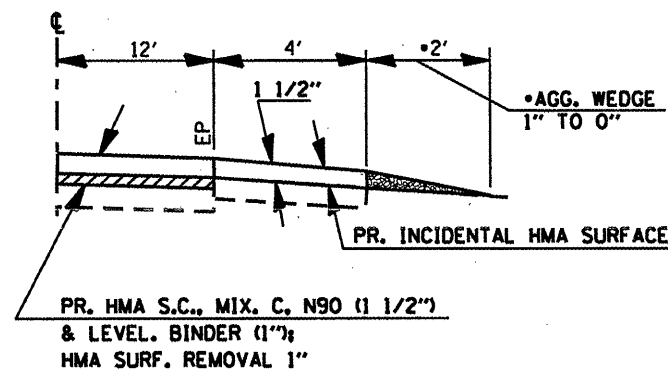

PE, CE OR FE SEC. A-A  
EX. AGGREGATE SURFACE WITH BIT. APRON  
•SEE ENTRANCE SCHEDULE FOR QUANTITY.

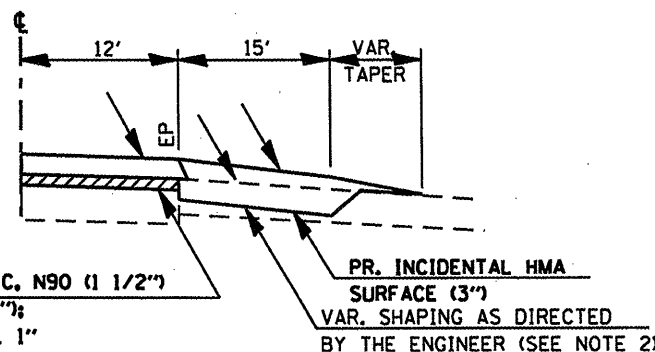

SIDE ROAD SEC. B-B  
EX. OIL & CHIP SURFACE  
(SEE NOTE 1)

NOTES

- IF EXISTING SUBBASE IS INADEQUATE, AS DETERMINED BY THE ENGINEER, THE SIDE ROADS SHALL BE CORING OUT AND AGGREGATE SUBBASE, TYPE B SHALL BE PLACED FOR BASE. THE COST OF CORING OUT THE SIDE ROAD AND ANY AGGREGATE BASE COURSE SHALL BE PAID FOR AS SPECIFIED IN ART. 109.04 OF THE STANDARD SPECIFICATIONS FOR ROAD AND BRIDGE CONSTRUCTION. IF EXISTING SUBBASE IS DETERMINED TO BE ADEQUATE, THE PREPARATION OF THE BASE SHALL BE CONSTRUCTED ACCORDING TO ARTICLE 406.19.
- VARIABLE SHAPING IS INCLUDED IN THE COST OF INCIDENTAL HOT-MIX ASPHALT SURFACE.

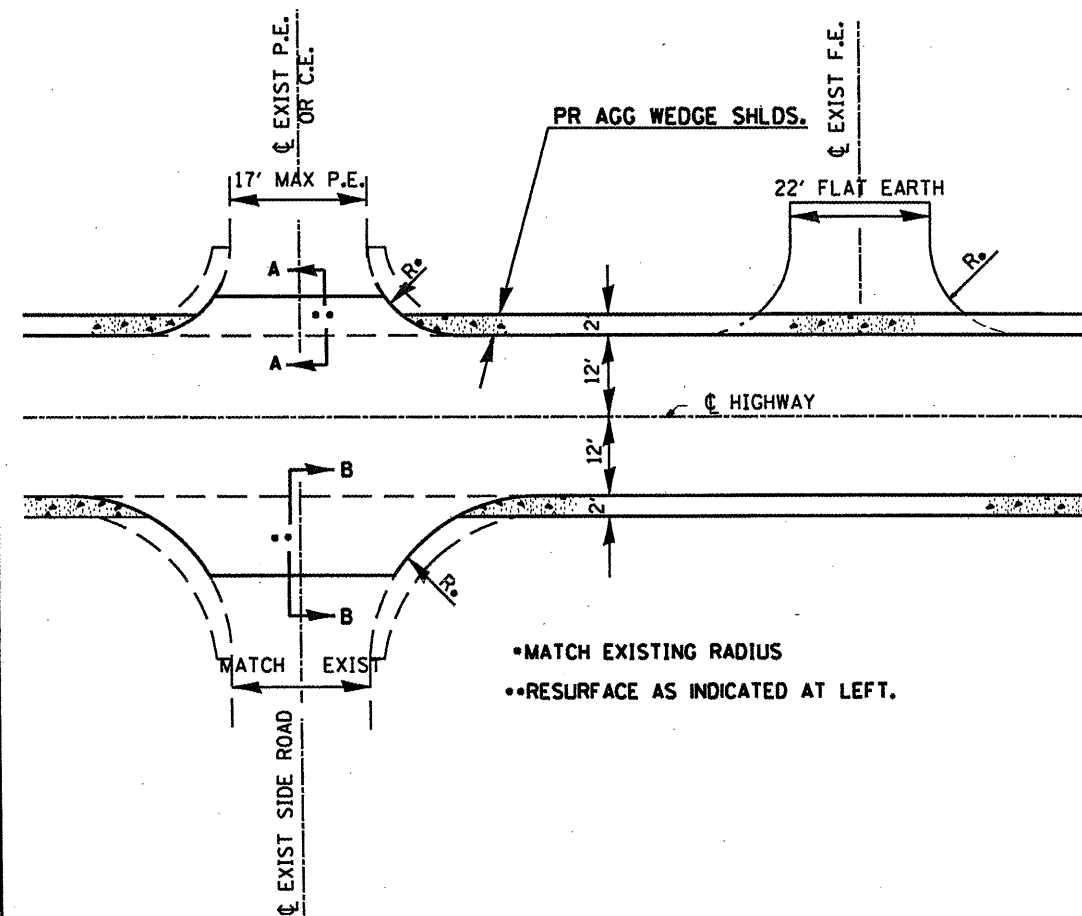

ENTRANCE SCHEDULE FOR LOCATION 1

TYPE	NUMBER OF ENTRANCES
P.E.	38
C.E.	6
F.E.	14

FILE NAME =	USER NAME = macordkr	DESIGNED -	REVISED -
at\pw_vork\p\WIDOT\MCCOROKR\d0181703\sh	details.dgn	DRAWN -	REVISED -
	PLOT SCALE = 200.0000' / IN.	CHECKED -	REVISED -
	PLOT DATE = 4/27/2010	DATE -	REVISED -

STATE OF ILLINOIS  
DEPARTMENT OF TRANSPORTATION

DETAIL - LOC. 1 SIDE ROADS AND ENTRANCES		F.A.P. RTE.	SECTION	COUNTY	TOTAL SHEETS	SHEET NO.
		312	123BS-5(130,131)BS-4	JACKSON	35	31
		CONTRACT NO. 78195				
SCALE: SHEET NO. OF SHEETS STA. TO STA.		FED. ROAD DIST. NO. ILLINOIS FED. AID PROJECT				

LOCATION 2 SIDEROAD AND ENTRANCE DETAILS

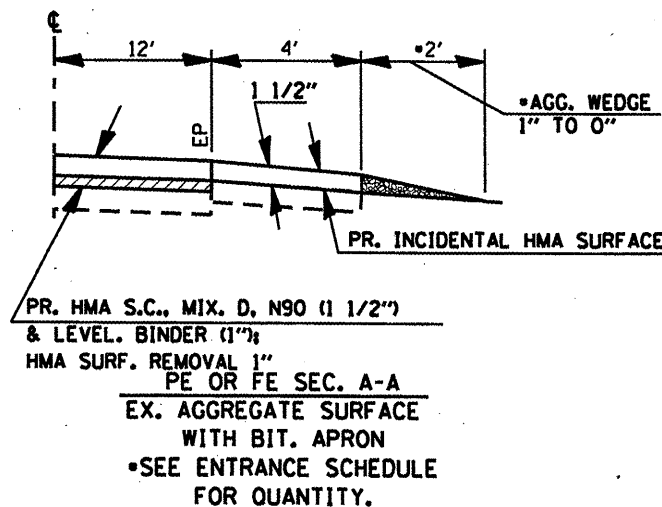
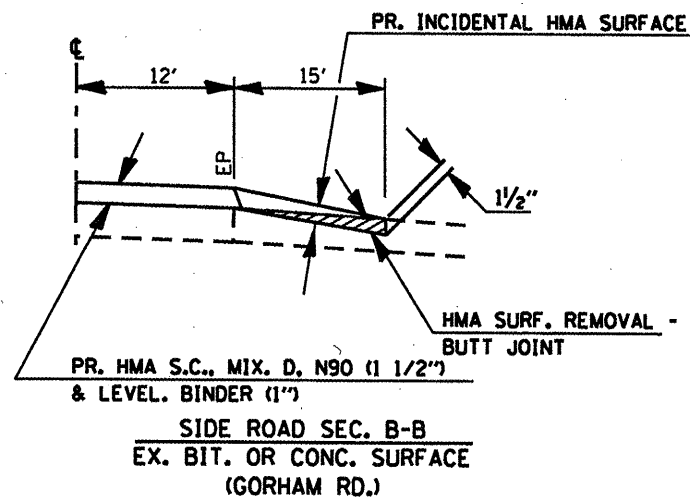

NOTES

- IF EXISTING SUBBASE IS INADEQUATE, AS DETERMINED BY THE ENGINEER, THE SIDE ROADS SHALL BE CORED OUT AND AGGREGATE SUBBASE, TYPE B SHALL BE PLACED FOR BASE. THE COST OF CORING OUT THE SIDE ROAD AND ANY AGGREGATE BASE COURSE SHALL BE PAID FOR AS SPECIFIED IN ART. 109.04 OF THE STANDARD SPECIFICATIONS FOR ROAD AND BRIDGE CONSTRUCTION. IF EXISTING SUBBASE IS DETERMINED TO BE ADEQUATE, THE PREPARATION OF THE BASE SHALL BE CONSTRUCTED ACCORDING TO ARTICLE 406.19.
- EXISTING 10' BITUMINOUS SHOULDER IS FIGURED INTO THIS MEASUREMENT.
- VARIABLE SHAPING IS INCLUDED IN THE COST OF INCIDENTAL HOT-MIX ASPHALT SURFACE.

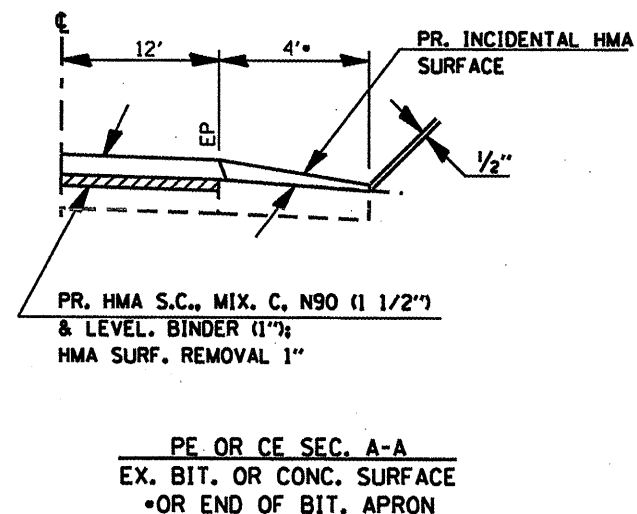
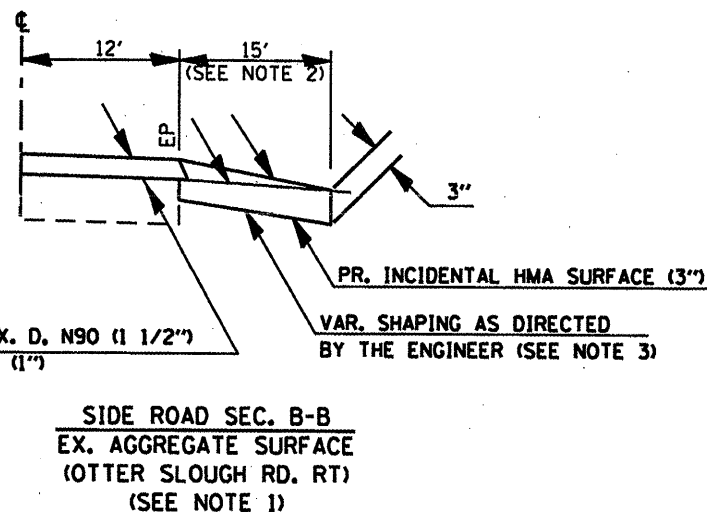

ENTRANCE SCHEDULE

TYPE	NUMBER OF ENTRANCES
P.E.	4
F.E.	11
C.E.	4

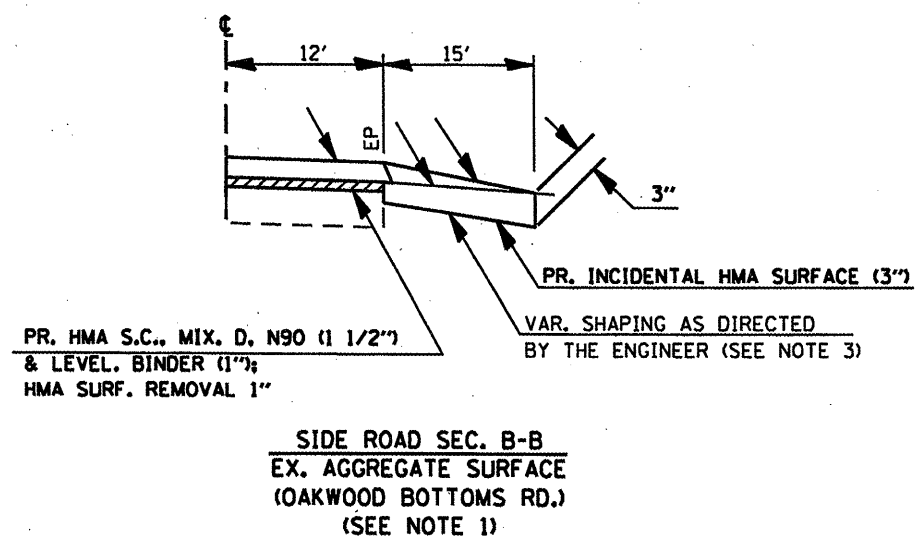
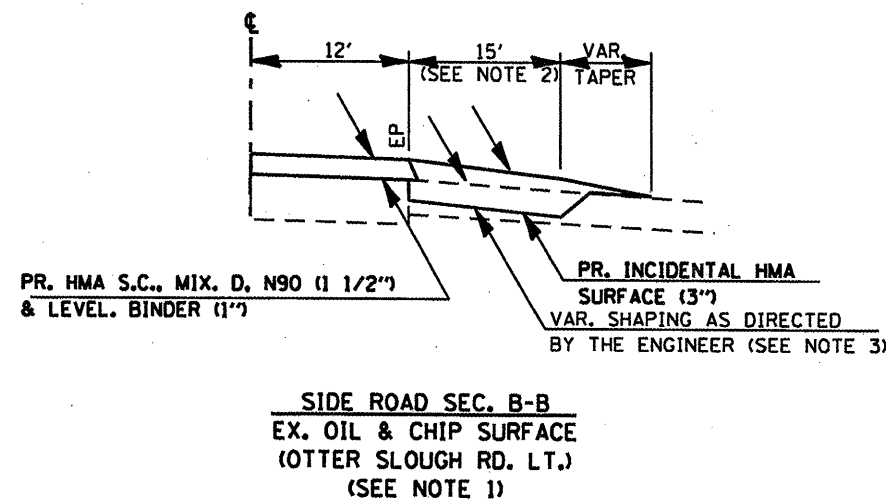

STATE OF ILLINOIS  
DEPARTMENT OF TRANSPORTATION

DETAIL - LOC. 2 SIDE ROADS  
AND ENTRANCES

F.A.P. RTE.	SECTION	COUNTY	TOTAL SHEETS	SHEET NO.
312	1238S-5(130.131)RS-4	JACKSON	35	32

CONTRACT NO. 78195

SCALE: SHEET NO. OF SHEETS STA. TO STA.

FED. ROAD DIST. NO. ILLINOIS FED. AID PROJECT

FILE NAME =	USER NAME = mcoordkr	DESIGNED -	REVISIONS -
ca:\pwwork\PHIDOT\MCCORDKR\d0181703\shd	detail.dgn	DRAWN -	REVISIONS -
PLOT SCALE = 200.0000 1/ IN.	CHECKED -	REVISIONS -	REVISIONS -
PLOT DATE = 4/27/2010	DATE -	REVISIONS -	REVISIONS -



LOCATION 2 SIDEROAD AND ENTRANCE DETAILS

SIDE ROAD AND ENTRANCE TREATMENTS  
FOR HMA SURFACE REMOVAL LOCATION  
STA. 286+00 TO STA. 434+55

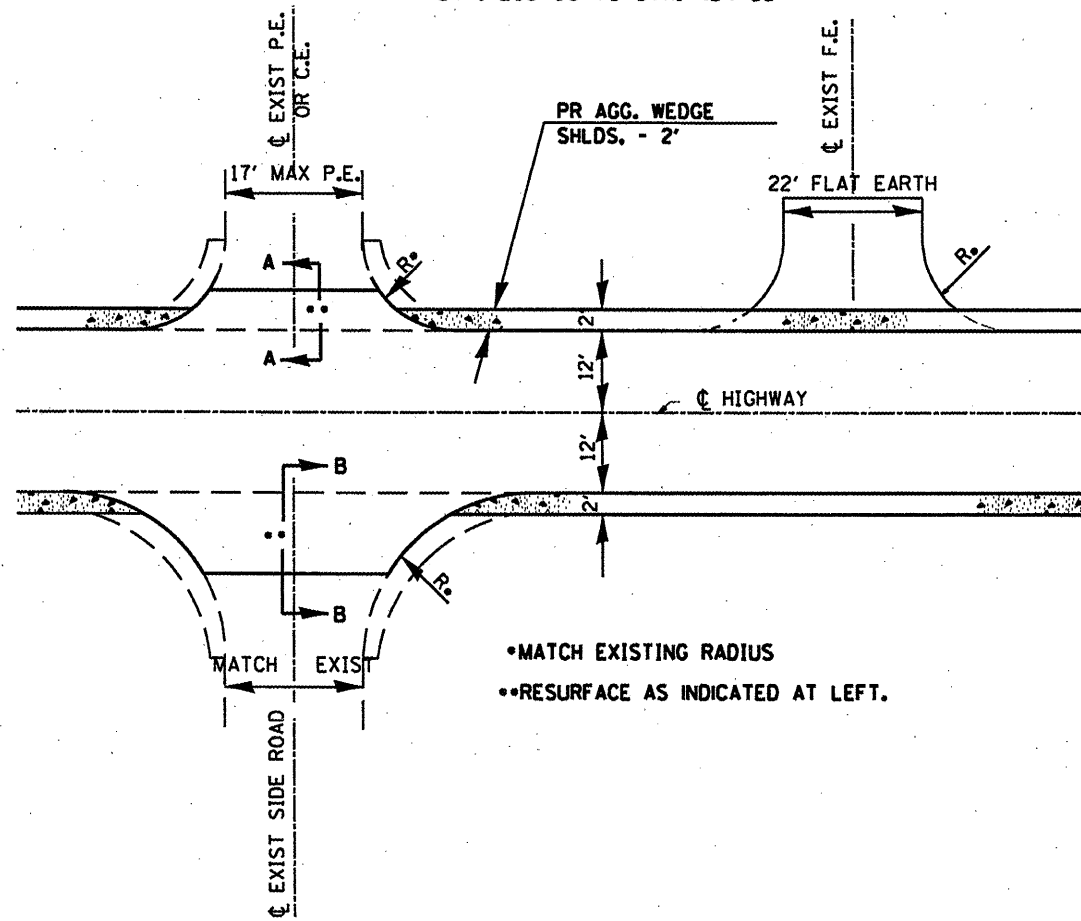

SIDE ROAD AND ENTRANCE TREATMENTS  
FOR SURFACING OF BARE PCC PAVEMENT LOCATION  
STA. 195+00 TO STA. 286+00

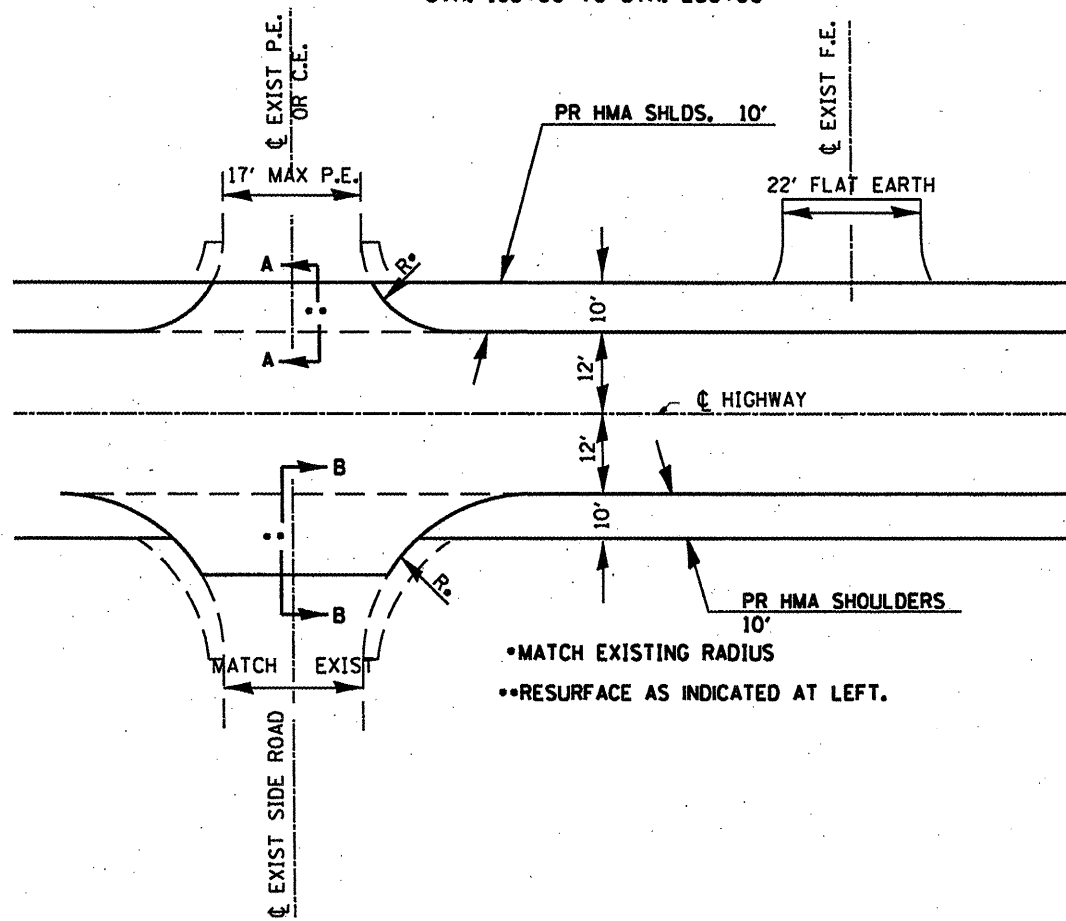

FILE NAME =  
c:\p\work\PIWIDOT\MCCOROKR\d0181783\ahb

USER NAME = mcaordkr  
details.dgn  
PLOT SCALE = 200.0000 / IN.  
PLOT DATE = 4/27/2010

DESIGNED -	---	REVISED -	-----
DRAWN -	---	REVISED -	-----
CHECKED -	---	REVISED -	-----
DATE -	---	REVISED -	-----

STATE OF ILLINOIS  
DEPARTMENT OF TRANSPORTATION

DETAIL - LOC. 2 SIDE ROADS  
AND ENTRANCES

SCALE: SHEET NO. OF SHEETS STA. TO STA.

F.A.P. RTE.	SECTION	COUNTY	TOTAL SHEETS	SHEET NO.
312	12385-5(130.131)85-4	JACKSON	35	33
ILLINOIS FED. AID PROJECT			CONTRACT NO. 78195	

# TEMPORARY HOT-MIX ASPHALT TRANSITIONS

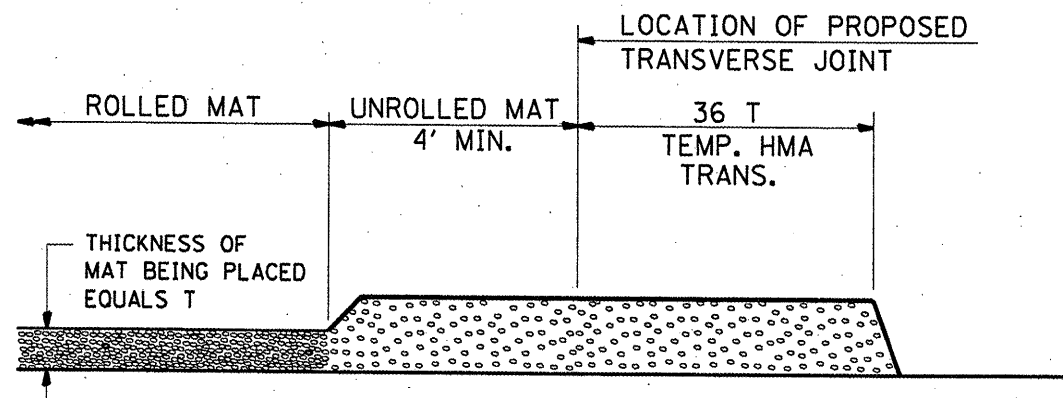

## STEP I

1. PLACE HOT-MIX ASPHALT MAT, LENGTH 36 TIMES THE THICKNESS OF THE MAT BEING PLACED PAST THE PROPOSED TRANSVERSE JOINT LOCATION USING NORMAL OPERATING PROCEDURES.
2. EXTREME CARE SHOULD BE TAKEN TO MAINTAIN ENOUGH MATERIAL IN FRONT OF THE SCREED TO MAINTAIN REQUIRED PAVING DEPTH.

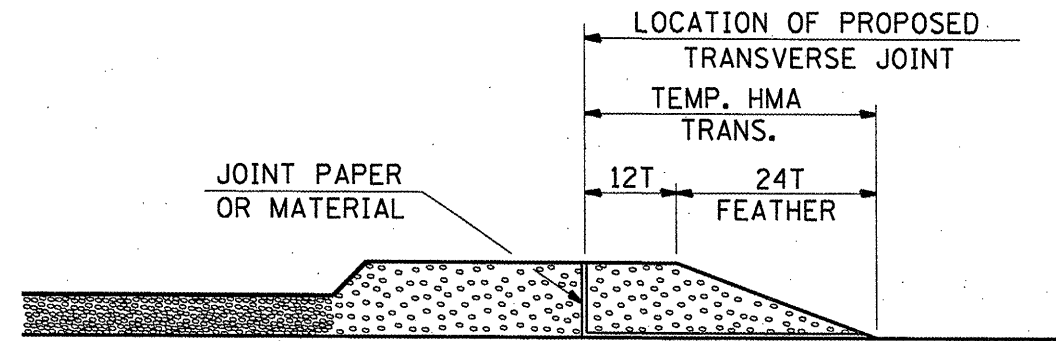

## STEP III

1. JOINT PAPER OR OTHER PRESELECTED JOINT MATERIAL IS THEN PLACED IN THE CLEARED AREA AND THE EXCESS ASPHALT USED TO HAND FORM A TRANSITION TO THE DIMENSIONS SHOWN ABOVE.
2. NOTE THAT IN CONSTRUCTING THE TRANSITION, THE MAT DEPTH IS CONTINUED AS PART OF THE TRANSITION BEFORE FORMING THE FEATHER.

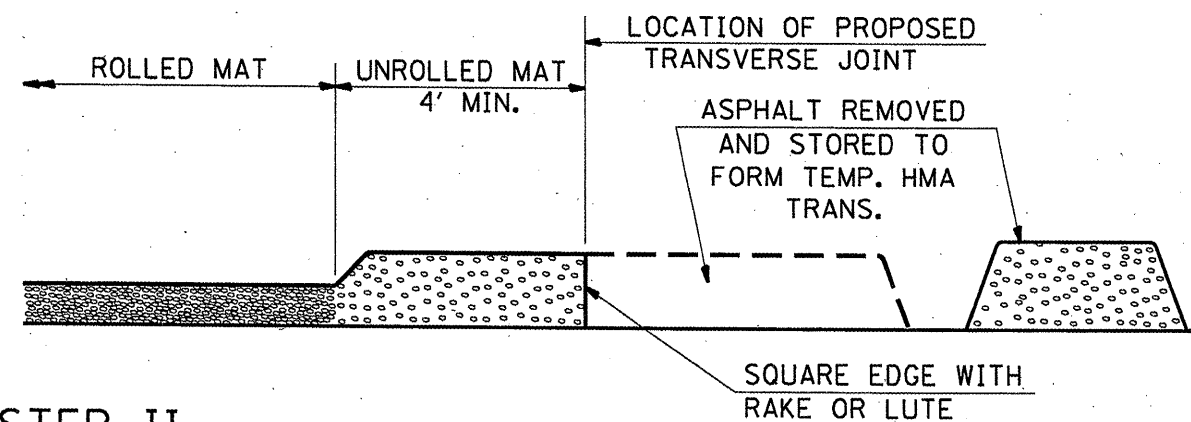

## STEP II

1. MOVE THE PAVER OUT OF THE WAY AND REMOVE THE ASPHALT FROM THE AREA OF THE PROPOSED TEMPORARY HOT-MIX ASPHALT TRANSITION.
2. SQUARE UP THE END OF THE MAT WITH A RAKE OR LUTE.
3. NOTE THAT THE MAT WITHIN 4' OF THE END OF JOINT IS NOT TO BE ROLLED AT THIS TIME.

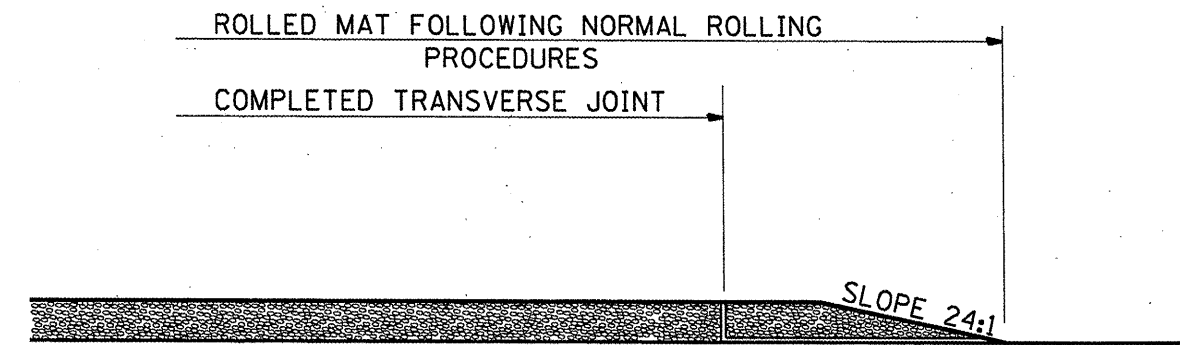

## STEP IV

1. COMPLETE TEMPORARY TRANSITION BY ROLLING.
2. TO RESUME PAVING, AT THE JOINT, REMOVE TEMPORARY TRANSITION AND DISPOSE OF THE MATERIAL ACCORDING TO ART. 202.03 OF THE STD. SPECS. (COST INCLUDED IN THE CONTRACT).
3. CONSTRUCTING THE TEMPORARY TRANSITIONS WILL NOT BE PAID FOR SEPARATELY IN ACCORDANCE WITH ARTICLE 406.14 OF THE STANDARD SPECIFICATIONS.

REVISIONS	
REDRAWN	2-15-89
REVISED	8-16-94
REVISED	01-09-07
REVISED	

STD. 9-26

FILE NAME =	USER NAME = mccordkr	DESIGNED -	REVISED -
ca:\pwork\VPWIDOT\MCCORDKR\0181783\shd	details.dgn	DRAWN -	REVISED -
	PLOT SCALE = 200.0000' / IN.	CHECKED -	REVISED -
	PLOT DATE = 4/27/2010	DATE -	REVISED -

STATE OF ILLINOIS  
DEPARTMENT OF TRANSPORTATION

TEMP. HOT-MIX ASPHALT  
TRANSITIONS

F.A.P. RTE.	SECTION	COUNTY	TOTAL SHEETS	SHEET NO.
312	12385-5(130,131)BS-4	JACKSON	35	34
CONTRACT NO. 78195				
ILLINOIS FED. AID PROJECT				

**ILLINOIS STANDARD**  
W8-I106

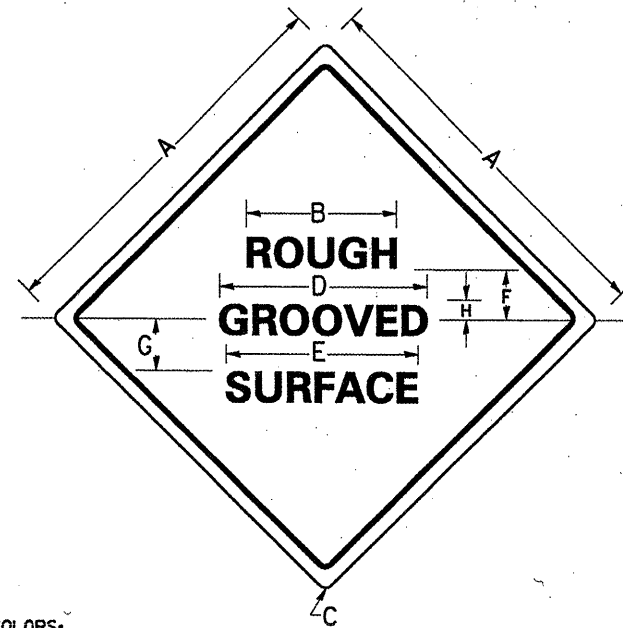

**COLORS:**  
LEGEND AND BORDER - BLACK NON-REFLECTORIZED  
BACKGROUND - ORANGE REFLECTORIZED

SIGN SIZE	DIMENSIONS							
	A	B	C	D	E	F	G	H
48x48	48.0	24.1	3.0	34.0	33.0	6.0	13.0	3.5

SIGN SIZE	SERIES			MAR-GIN	BOR-DER	BLANK STD.
	LINES					
	1	2	3			
48x48	7C	7C	7C	0.8	1.2	B4-48D

**NOTE:** PRIOR TO ALLOWING TRAFFIC ON ANY PORTION OF THE ROADWAY THAT HAS BEEN COLDMILLED, THE CONTRACTOR SHALL HAVE ERECTED "ROUGH GROOVED SURFACE" SIGNS THAT CONFORM TO THE ABOVE DETAILS. A MINIMUM OF ONE SIGN AT EACH END OF THE IMPROVEMENT WILL BE REQUIRED. THE CONTRACTOR SHALL MAINTAIN THE "ROUGH GROOVED SURFACE" SIGNS UNTIL THE COLDMILLED SURFACE IS COVERED WITH LEVELING BINDER OR SURFACE COARSE.

IF AT ANY TIME THE SIGNS ARE IN PLACE BUT NOT APPLICABLE, THEY SHALL BE TURNED FROM THE VIEW OF MOTORISTS OR COVERED AS DIRECTED BY THE ENGINEER.

THE COST OF FURNISHING, ERECTING, MAINTAINING, AND REMOVING THE REQUIRED SIGNS SHALL BE INCLUDED IN THE CONTRACT.

ALL DIMENSIONS ARE IN INCHES UNLESS OTHERWISE NOTED.

REVISIONS  
REDRAWN 10-23-01  
STD. 9-39

**UNEVEN LANES SIGN**  
W8-11 (48" x 48")

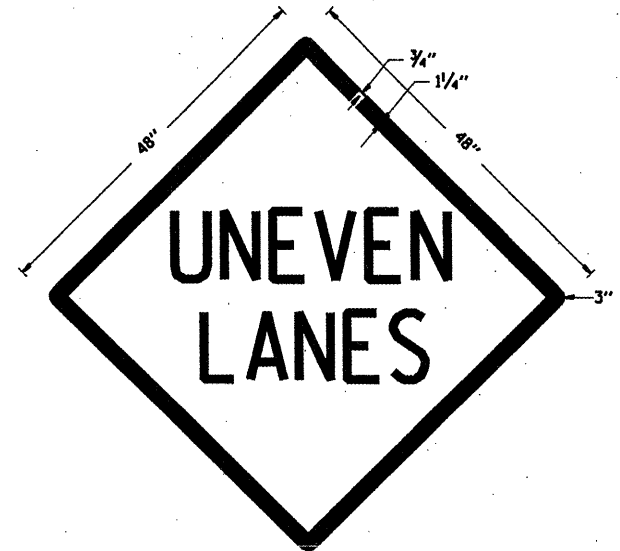

**COLORS:**  
LEGEND AND BORDER - BLACK NON-REFLECTORIZED  
BACKGROUND - ORANGE REFLECTORIZED

**NOTE:** PRIOR TO ALLOWING TRAFFIC ON ANY PORTION OF THE ROADWAY THAT HAS BEEN COLDMILLED OR BEFORE RESURFACING OPERATIONS BEGIN, THE CONTRACTOR SHALL HAVE ERECTED "UNEVEN PAVEMENT" SIGNS THAT CONFORM TO THE ABOVE DETAILS. A MINIMUM OF ONE SIGN AT EACH END OF THE IMPROVEMENT WILL BE REQUIRED. THE CONTRACTOR SHALL MAINTAIN THE "UNEVEN PAVEMENT" SIGNS UNTIL THE RESURFACING OPERATIONS ARE COMPLETED.

IF AT ANY TIME THE SIGNS ARE IN PLACE BUT NOT APPLICABLE, THEY SHALL BE TURNED FROM THE VIEW OF MOTORISTS OR COVERED AS DIRECTED BY THE ENGINEER.

THE COST OF FURNISHING, ERECTING, MAINTAINING, AND REMOVING THE REQUIRED SIGNS SHALL BE INCLUDED IN THE CONTRACT.

REVISIONS  
DRAWN 1-15-00  
REVISED 1-15-00  
DESIGNED 1-15-00  
REVISED 1-15-00  
STD. 9-41

STATE OF ILLINOIS  
DEPARTMENT OF TRANSPORTATION

DETAIL: UNEVEN LANES SIGN  
ROUGH GROOVED SURFACE SIGN

SCALE: \_\_\_\_\_ SHEET NO. \_\_\_\_\_ OF \_\_\_\_\_ SHEETS STA. \_\_\_\_\_ TO STA. \_\_\_\_\_

F.A.P. RTE.	SECTION	COUNTY	TOTAL SHEETS	SHEET NO.
312	12385-5+130.13185-4	JACKSON	35	35

CONTRACT NO. 78195  
ILLINOIS FED. AID PROJECT

FILE NAME =  
c:\p\work\p\1001\MCCORDKR\0181703\shd

USER NAME = mcoordkr  
details.dgn  
PLOT SCALE = 200.0000 / IN.  
PLOT DATE = 4/27/2010

DESIGNED -  
DRAWN -  
CHECKED -  
DATE -

REVISED -  
REVISED -  
REVISED -  
REVISED -