

**CURVE C-5**

P.I. STA. = 222+54.34  
 $\Delta = 01^\circ 10' 00''$   
 $D = 00^\circ 09' 08''$   
 $R = 37,623.339'$   
 $T = 383.060'$   
 $L = 766.093'$   
 $E = 1.95'$   
 P.C. STA. = 218+71.28  
 P.T. STA. = 226+37.37

POINT	NORTHING	EASTING
P.I.	1,289,384.743	1,188,093.381
P.C.	1,289,001.776	1,188,101.815
P.T.	1,289,767.803	1,188,092.747
C.C.	1,289,830.078	1,225,716.035

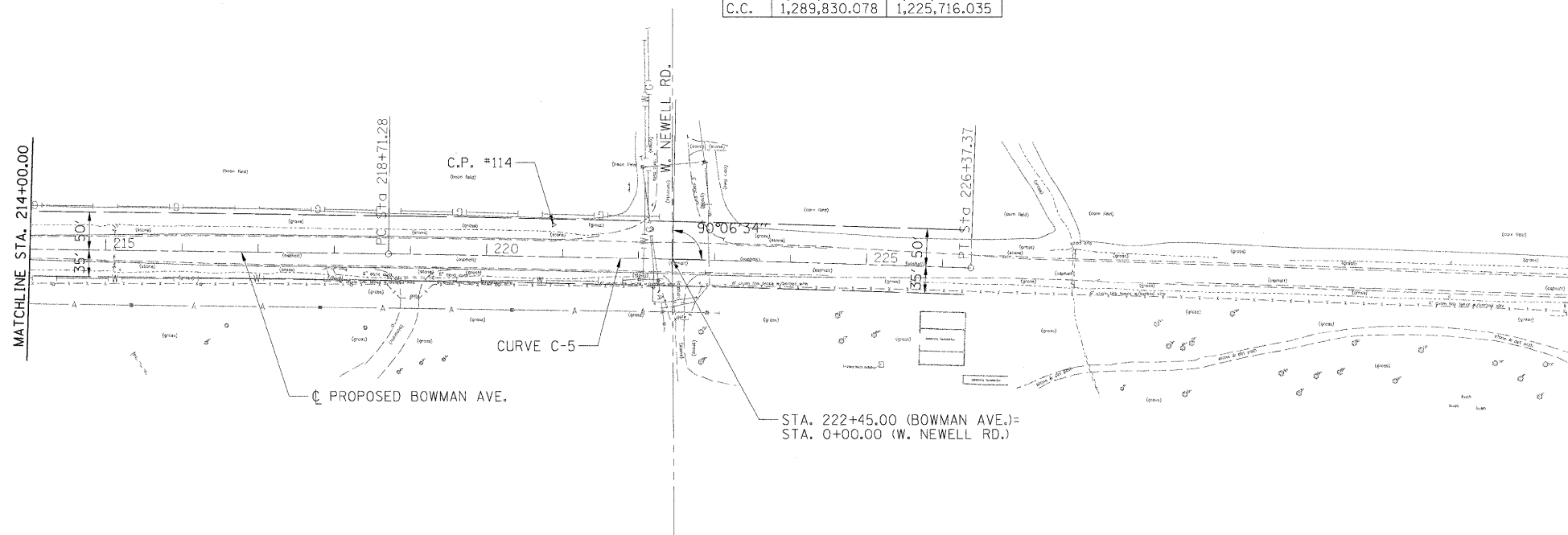

**CONTROL POINTS**

POINT	DESCRIPTION	STATION	OFFSET	ELEVATION	NORTHING	EASTING
C.P. #112	REBAR	195+83.78	19.25' LT	653.80	1,286,714.412	1,188,132.931
C.P. #113	REBAR	208+42.90	13.97' RT	659.21	1,287,973.953	1,188,138.418
C.P. #114	REBAR	220+87.49	42.37' LT	679.52	1,289,217.259	1,188,055.311



I:\08\jobs\08L0221\CAODV\Road\Sheet\090334\01PV\c-101_geometrics.dgn	USER NAME = Johns00944	DESIGNED - m.heyen	REVISED -
	PLOT SCALE = 100.0000' / in.	DRAWN - r.johnson	REVISED -
	PLOT DATE = 04\14\2010	CHECKED - m.heyen	REVISED -
		DATE - 3/26/2010	REVISED -

**STATE OF ILLINOIS  
DEPARTMENT OF TRANSPORTATION**

<b>GEOMETRIC CONTROL SHEET</b>			
SCALE: 1"=100'	SHEET NO.	OF SHEETS	STA. TO STA.

F.A.S. RTE. 500	SECTION 09-00334-01-PV	COUNTY VERMILION	TOTAL SHEETS 69	SHEET NO. 18
JOB NO. C-95-330-10		CONTRACT NO. 91440		
FED. ROAD DIST. NO. ILLINOIS FED. AID PROJECT				