

HHH OF DANVILLE
C/O MICHAEL HOLYCROSS

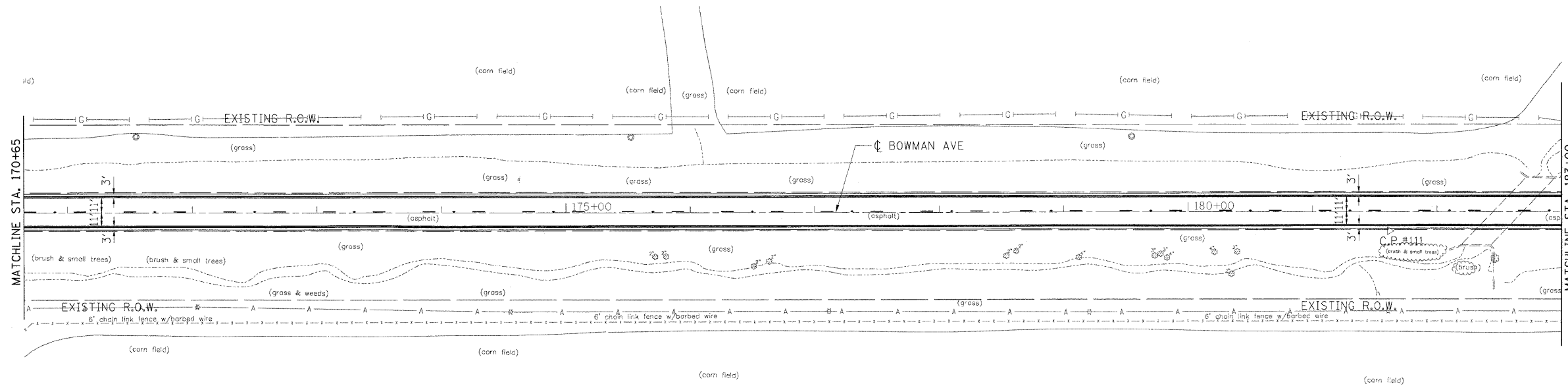

VERMILION COUNTY AIRPORT

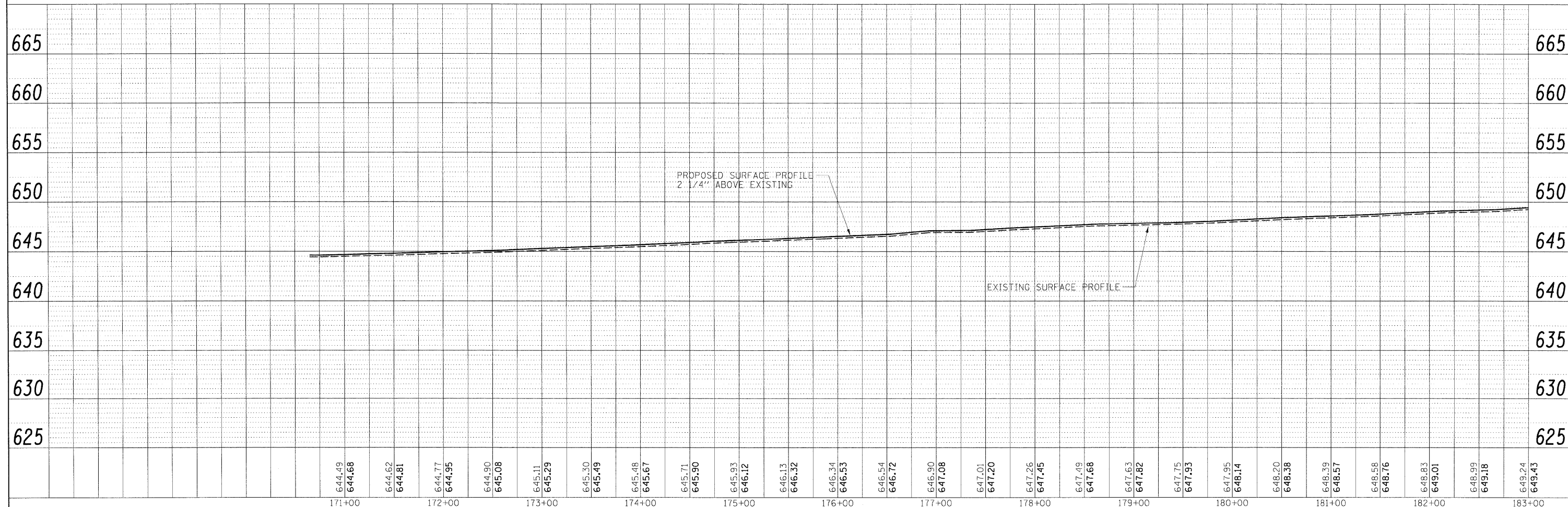

| | |
|------|----|
| DATE | BY |
| | |
| DATE | BY |
| | |
| DATE | BY |
| | |

© Copyright Hanson Professional Services Inc. 2010

| | |
|------|----|
| DATE | BY |
| | |
| DATE | BY |
| | |
| DATE | BY |
| | |

| | | | | | | | | | | |
|--|------------------------------|--------------------|-----------|---|--------------------------------------|--|------------------------|------------------|-----------------|--------------|
| FILE NAME = | USER NAME = Johns00944 | DESIGNED - m.heyen | REVISED - | STATE OF ILLINOIS DEPARTMENT OF TRANSPORTATION | BOWMAN AVE - PLAN AND PROFILE | F.A.S. RTE. 500 | SECTION 09-00334-01-PV | COUNTY VERMILION | TOTAL SHEETS 69 | SHEET NO. 27 |
| 1:\08\jobs\08L0221\CADD\Road\Sheet\09033401PV-700_bowman.dgn | PLOT SCALE = 50.0000' / 1in. | CHECKED - m.heyen | REVISED - | | | JOB NO. C-95-330-10 | CONTRACT NO. 91440 | | | |
| PLOT DATE = 04/14/2010 | DATE = 3/26/2010 | REVISED - | | | | ILLINOIS FED. AID PROJECT | | | | |
| | | | | | | SCALE: 1"=50' SHEET NO. OF SHEETS STA. 170+65.00 TO STA. 183+00.00 | | | | |