

BEGIN PROJECT STA. 69+00.00

MATCHLINE STA. 83+00

INTENDED SEQUENCE

1. PLACEMENT OF PERIMETER EROSION BARRIER PRIOR TO COMMENCEMENT OF ANY WORK. SEE STANDARD 280001.
2. PLACEMENT OF INLET AND PIPE PROTECTION ON EXISTING CULVERTS PRIOR TO COMMENCEMENT OF WORK. PLACEMENT OF INLET AND PIPE PROTECTION AFTER CONSTRUCTION OF PROPOSED STRUCTURES. SEE STANDARD 280001.
3. PLACEMENT OF TEMPORARY SEEDING ON GRADED SURFACES NOT HAVING PERMANENT SEEDING APPLIED.
4. PLACEMENT OF TEMPORARY DITCH CHECKS AFTER DITCH GRADING IS COMPLETE. SEE STANDARD 280001.
5. PLACEMENT OF EROSION CONTROL BLANKET AFTER FINAL GRADING AROUND CULVERTS.
6. ONGOING MAINTENANCE OF EROSION CONTROL ELEMENTS PER THE SWPPP.
7. REMOVE TEMPORARY EROSION CONTROL ELEMENTS AFTER FINAL GRADING AND PERMANENT SEEDING ESTABLISHED AS PER THE SWPPP AND APPROVED BY THE ENGINEER.

EROSION CONTROL LEGEND

- EROSION CONTROL BLANKET
- INLET AND PIPE PROTECTION
- TEMPORARY DITCH CHECK
- PERIMETER EROSION BARRIER
- DRAINAGE PATTERN DIRECTION

NOTE - SEE TEMPORARY EROSION CONTROL PLAN SHEET 4 OF 4 FOR DRAINAGE SCHEMATIC AND NOTES

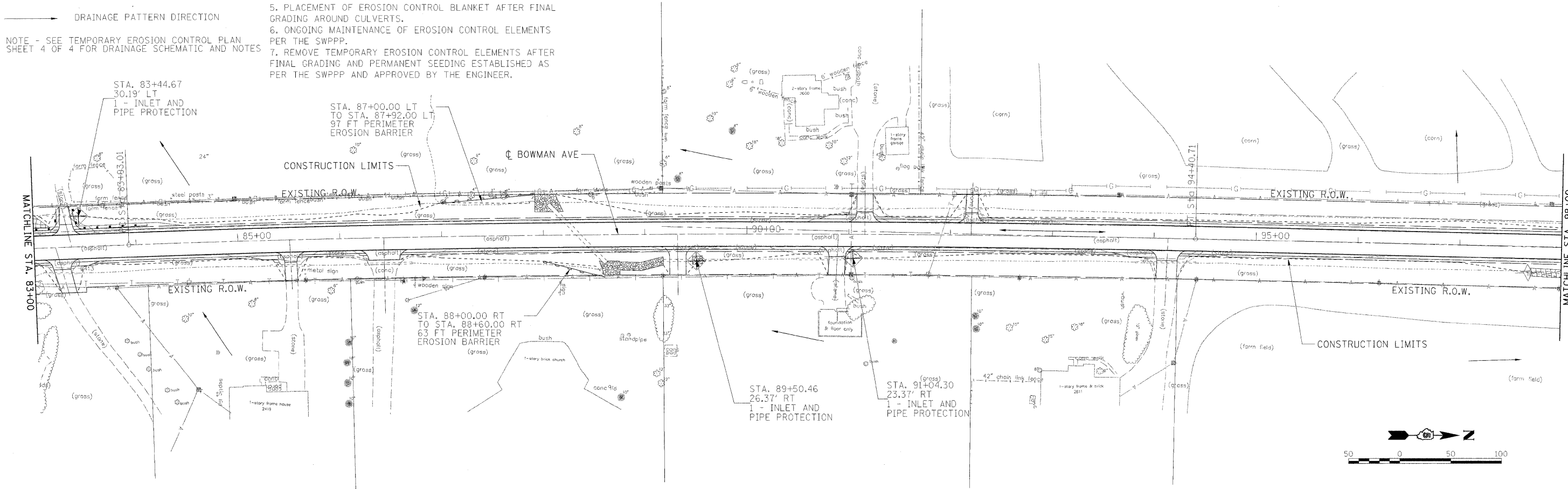

MATCHLINE STA. 83+00

MATCHLINE STA. 98+00

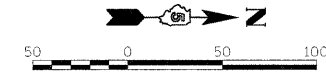

I:\09jobs\0810221\CADD\Road\Sheet\09083401PV\c-081_bowman.dgn USER NAME = Johns0944 PLOT SCALE = 50.0000' / in. PLOT DATE = 04/14/2010	DESIGNED - m.heyen	REVISED -	STATE OF ILLINOIS DEPARTMENT OF TRANSPORTATION	BOWMAN AVE - TEMPORARY EROSION CONTROL SHEET 1 OF 4	F.A.S. RTE. 500	SECTION 09-00334-01-PV	COUNTY VERMILION	TOTAL SHEETS 69	SHEET NO. 32
	DRAWN - J.rutledge	REVISED -			JOB NO. C-95-330-10	CONTRACT NO. 91440			
	CHECKED - m.heyen	REVISED -			FED. ROAD DIST. NO.	ILLINOIS FED. AID PROJECT			
	DATE - 3/26/2010	REVISED -			SCALE: 1"=50'	SHEET NO. OF SHEETS	STA. 68+00.00 TO STA. 98+00.00		