

- \* 4:1 < 10'
- 3:1 (MIN.) 1:6 (MAX.) > 10' OR AT GUARDRAIL LOCATIONS
- \*\* 3:1 < 10'
- 2:1 > 10' OR 2.5:1 AT SELECT LOCATIONS TO STAY WITHIN THE R.O.W.
- \*\*\* TRANSITION SHOULDER SLOPE  
4% AT STA. 17+91.5 LT. TO 1.5% AT STA. 18+16.5 LT.  
1.5% AT STA. 18+56 LT. TO 4% AT STA. 18+81 LT.

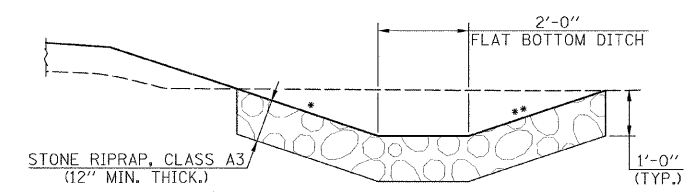

**STONE RIPRAP DITCH DETAIL**  
 (STA. 19+50 TO STA. 22+75 LT. STA. 19+50 TO STA. 23+25 RT. & STA. 28+25 TO STA. 30+75 LT. & RT.)

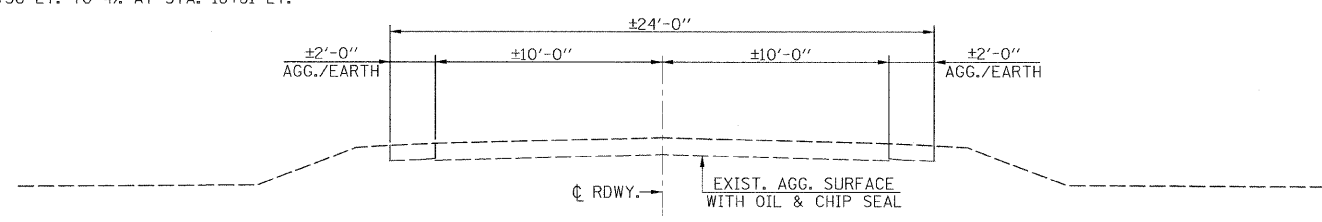

**EXISTING CROSS SECTION**

**PAVEMENT DESIGN - 80000# DESIGN LOAD**  
 STRUCTURAL DESIGN TRAFFIC (S.D.T.): YEAR 2020; P.V.=797  
 S.U.=106 M.U.=106  
 CLASS III ROAD  
 T.F. = 0.52 > 0.25 (USE MODIFIED AASHTO DESIGN)  
 I.B.V. = I.B.R. = 7  
 S.N.f = 3.06  
 TYPICAL PROPOSED ROADWAY SECTION:  
 PROPOSED HMA BINDER & SURFACE COURSE --- 4"  
 PROPOSED AGGREGATE BASE COURSE, TYPE A --- 12"

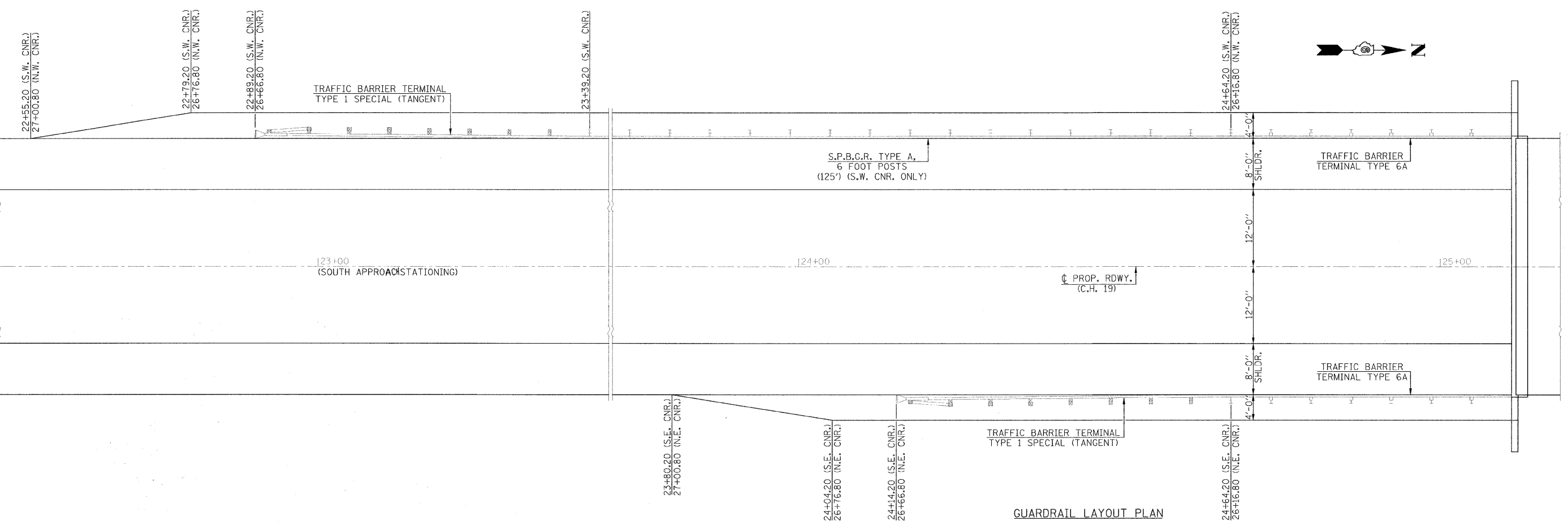

**GUARDRAIL LAYOUT PLAN**

FILE NAME = #FILE#	USER NAME = #USER#	DESIGNED - ---	REVISED - ---	<b>Allen Henderson &amp; Associates, Inc.</b> Civil and Structural Engineers Springfield, IL. 62703 Phone: (217)544-8033 IL Design Firm No. 184-001907	<b>DETAILS &amp; TYPICAL SECTIONS</b>			C.H. RTE.	SECTION	COUNTY	TOTAL SHEETS	SHEET NO.
	PLOT SCALE = #SCALE#	CHECKED - ---	REVISED - ---					19	07-00055-01-BR	SANGAMON	25	3
	PLOT DATE = #DATE#	DATE - ---	REVISED - ---		SCALE: NONE	SHEET NO. 3 OF 25 SHEETS	STA. 7+75.00 TO STA. 13+05.00	FED. ROAD DIST. NO. - ILLINOIS FED. AID PROJECT		CONTRACT NO. 93483		