

07-30-2021 LETTING ITEM 019

STATE OF ILLINOIS DEPARTMENT OF TRANSPORTATION PROPOSED HIGHWAY PLANS

F.A.P. RT. NO.	SECTION	COUNTY	TOTAL SHEETS	SHEET NO.
599	(48MFT, 62MFT)RS	ROCK ISLAND	45	1
		ILLINOIS	CONTRACT NO. 64N91	

FOR INDEX OF SHEETS, SEE SHEET NO. 2
FOR STATE STANDARDS, SEE SHEET NO. 2

HIGHWAY CLASSIFICATION
 F.A.P. ROUTE 599 (IL 92) ANDALUSIA RD
 CLASSIFICATION: MINOR ARTERIAL
 ADT: 10,900 (2015)
 P.V. = 9,625
 M.U. = 375
 S.U. = 900

**F.A.P. ROUTE 599 (ANDALUSIA ROAD)
 SECTION (48MFT, 62MFT)RS
 PROJECT STP-JYKM(462)
 COLD MILLING, PAVEMENT PATCHING,
 AND HMA RESURFACING
 FROM 0.4 MILE EAST OF IL 92(N) TO
 US 67 IN MILAN
 ROCK ISLAND COUNTY**

C-92-074-21
R 2 W

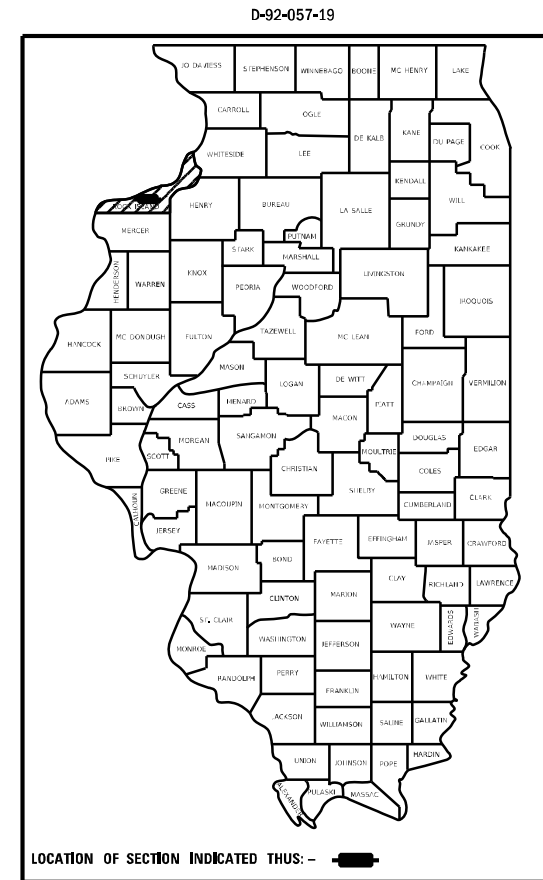

**PROJECT / SECTION BEGINS
 STA. 1335 + 30**
 BLACKHAWK TOWNSHIP: SECTIONS (21,22,23,26,27,28)

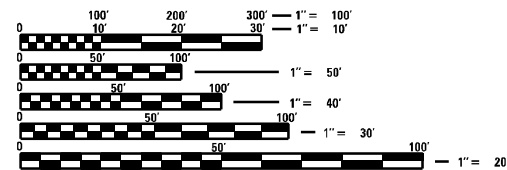

FULL SIZE PLANS HAVE BEEN PREPARED USING STANDARD ENGINEERING SCALES. REDUCED SIZED PLANS WILL NOT CONFORM TO STANDARD SCALES. IN MAKING MEASUREMENTS ON REDUCED PLANS, THE ABOVE SCALES MAY BE USED.

J.U.L.I.E.
 JOINT UTILITY LOCATION INFORMATION FOR EXCAVATORS
 1-800-892-0123
 OR 811

PROJECT ENGINEER: ANDREW LEE
PROJECT MANAGER: DENNISSE OTERO-LOPEZ (815)-284-5924
EMAIL: DENNISSE.OTERO-LOPEZ@ILLINOIS.GOV

CONTRACT NO. 64N91

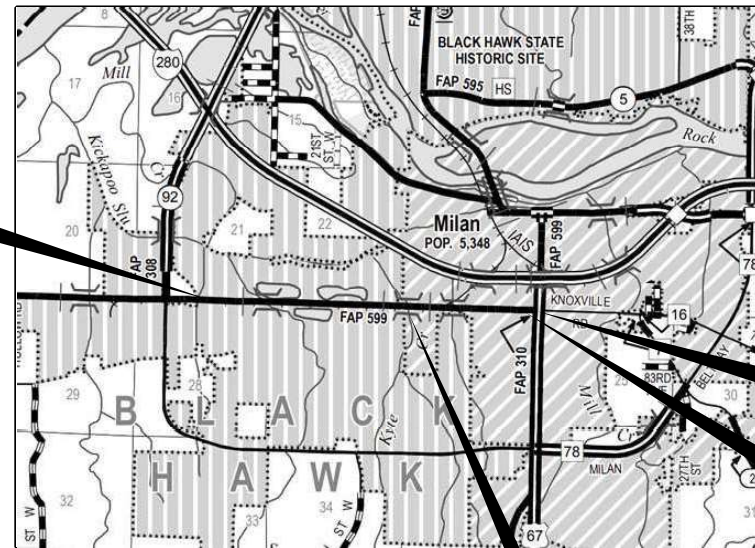

**IMPROVEMENT ENDS
 STA. 1460 + 14**

**PROJECT ENDS
 STA. 1459 + 10**

**PAVING GAP
 STA. 1408 + 85 TO STA 1409 + 68**

GROSS LENGTH = 12,380 FT. = 2.34 MILE
 NET LENGTH = 12,297 FT. = 2.33 MILE

STATE OF ILLINOIS
 DEPARTMENT OF TRANSPORTATION

SUBMITTED 04-29 2021

David Ahmed
 REGIONAL ENGINEER

June 25, 2021
Scott A. Elk
 ENGINEER OF DESIGN AND ENVIRONMENT

June 25, 2021
James J. Quinn
 DIRECTOR OF HIGHWAYS PROJECT IMPLEMENTATION 13

**PRINTED BY THE AUTHORITY
 OF THE STATE OF ILLINOIS**

GENERAL NOTES

Closed expansion joints on jointed pavements shall be re-established during the patching operations. Class B Patches - when the pavement requires patching at the location of the expansion joint, a new joint should be established using a dowelled expansion patch as shown on Highway Standard 442101. When the joint is closed, but does not require patching, an expansion joint may be formed by sawing the pavement and filling the saw cut with a preformed expansion joint filler meeting the requirements of Section 1051 of the Standard Specifications as shown on Standard 420001.

When laying out for patching, the minimum distance between new patches (saw cut to saw cut) shall be 15 feet. When patch spacing is less than 15 feet, the pavement between patches shall also be removed and replaced.

The existing hot-mix asphalt on private and commercial entrances shall be bladed off or milled and disposed of outside the project limits. This could be the entire entrance or tapered at the end depending on if the mainline is resurfaced or milled and resurfaced. The cost of the blading, milling, rolling, and disposal is included in the contract unit price for INCIDENTAL HOT-MIX ASPHALT SURFACING.

The drop off that occurs at entrance edges as a result of resurfacing of the entrance shall be corrected using aggregate shoulder material. This work shall be paid for by the TON for Aggregate Shoulders of the type specified in the plans.

Areas of slag mixture are expected to be milled on this project. RAP containing slag mixture must be stockpiled separately.

The following Mixture Requirements are applicable for this project:

Location and Mixture Use(s):	Resurfacing Surface
PG:	PG 58-28
Design Air Voids:	4.0 @ N50
Mixture Composition (Mixture Gradation):	IL 9.5
Friction Aggregate:	D
20 Year ESAL	0.0
Mixture Unit Weight:	112 lbs/sy/in
Quality Management Program to be used:	QCP
Sublot Tonnage	1000
Number of Roller Passes ¹⁾ :	N/A

1) When a number of roller passes is specified, the Contractor may opt to use intelligent compaction in lieu of density testing under the Quality Control for Performance (QCP) program.

The area to be tacked or primed shall be limited to that which can be covered with HMA on the next day's production, but no more than five days in advance of the placement of the HMA, unless approved by the Engineer.

The area to be tacked or primed shall be limited to that which can be covered with HMA on the next day's production, but no more than five days in advance of the placement of the HMA, unless approved by the Engineer.

To help avoid excess drop offs at the edge of pavement, aggregate shoulder material of the type specified in the plans shall be placed prior to any bituminous material. The aggregate material shall be placed flush with the existing pavement or at the elevation of any proposed milling. At no time shall the aggregate shoulder material be higher than the existing edge of pavement. This work shall be paid for by the ton for Aggregate Shoulders of type specified.

The Contractor shall be responsible for collecting and maintaining an electronic log of all stakeout survey that is performed on the job, either by him/her or any sub-contractor performing the stakeout. Upon request, all logs shall be submitted to the Department. No additional compensation will be allowed for this work, but shall be considered included in the cost for CONSTRUCTION LAYOUT.

Pavement Marking shall be done according to Standard 780001, except as follows:

- All words, such as ONLY, shall be 8 feet high.
- All non-freeway arrows shall be the large size.
- The distance between yellow no-passing lines shall be 8 inches, not 7 inches, as shown in the detail of Typical Lane and Edge Lines.
- Centerline Skip Dash Pavement Marking on multi-lane divided, multi-lane undivided, and one-way roadway shall be according to District Standard 41.1.

PERMANENT SURVEY MARKERS, TYPE II, shall be set at intervals of 1 mile or as directed by the Engineer. Bridge or culvert projects shall have one survey marker placed near the structure. Estimated: 2 Each.

Permanent Survey Markers, Type II placed in urban areas should be placed in sidewalk areas. The marker shall be placed as shown on District Standard 66.2. The sidewalk shall be placed around the marker and flush with the top.

Permanent Survey Markers, Type II shall be cast-in-place as shown on District Standard 66.2, or another option would be to install a vaulted style, monumented as described by NGS as a 3D monument (Top Security Sleeve Rod Monument), with installation instructions provided by the District Chief of Surveys. If poured in place, the bottom of the marker shall be 5'-0" below the ground surface.

The Permanent Survey Markers, if possible, shall be installed at the beginning of the job and protected throughout.

The Contractor shall submit to the Engineer a description of location, elevation, and coordinates for each permanent survey marker. The horizontal coordinates must be derived by GPS and the elevation derived using an electronic level. The meta data, such as the Geoid used, (NGS adjustment ie: 97 HARN, 03, 07), and the base point(s) name or number shall be submitted along with a complete collection log. If collected using RTK method, it will require either 3 collections (averaged) from 2 different bases, or a minimum of 3 collections (averaged), at least 2 hours apart, from the same base. If using a CORS type network, the collection procedure shall include localizing with check shots on at least 2 different HARN monuments both before and after collection. The level circuit shall be run from furnished mark to furnished mark and then adjusted. The error of closure shall be submitted with the electronic level notes in a recognized format approved by the Engineer and/or the Chief of Surveys. The Engineer shall submit this information to the District Chief of Surveys.

The Contractor shall be responsible for locating and protecting utility property during construction operations as outlined in Article 107.39 of the Standard Specifications. The following listed utilities located within the project limits or immediately adjacent to the project construction limits are members of JULIE:

Geneseo Telephone Co.	309/944-8025
MidAmerican Energy Co.	563/333-8706
Mediacom	309/743-4750
Windstream	414/313-9032
Village of Milan	309/787-8527
City of Rock Island	309/732-2238
AT&T	630/573-5465
Bluebird Network	847/650-1348
Metro Fibernet, LLC	317/599-1030

IDOT is not a member of JULIE. If you are near any overhead lighting, intersection lighting or traffic signals, contact the IDOT Traffic Office at 815/284-5469 at least 48 hours prior to work.

It shall be the Contractor's responsibility to contact the municipality to determine approved methods of utility structure adjustment. Utility structures may include, but are not limited to, manholes, water valves, handholes, etc. All materials and work necessary to complete adjustments per municipality requirements shall be considered included in the cost of the associated adjustment pay item.

FILE NAME = 64N91.GN.DOCX	USER NAME =	DESIGNED - Engineering Systems	REVISED -	STATE OF ILLINOIS DEPARTMENT OF TRANSPORTATION	GENERAL NOTES				ROUTE	SECTION	COUNTY	TOTAL SHEETS	SHEET NO.
	PLOT SCALE =	DRAWN -	REVISED -						FAP 599	(48MFT, 62MFT)RS	Rock Island	45	3
	PLOT DATE = 4/29/2021 2:36 PM	CHECKED -	REVISED -		CONTRACT NO. 64N91								
		DATE = 4/22/2021 11:56 AM	REVISED -		SCALE:	SHEET NO.	OF	SHEETS	STA.	TO STA.	ILLINOIS	FED. AID PROJECT	

GENERAL NOTES

It shall be the Contractor's responsibility to contact the municipality to determine approved methods of utility structure adjustment. Utility structures may include, but are not limited to, manholes, water valves, handholes, etc. All materials and work necessary to complete adjustments per municipality requirements shall be considered included in the cost of the associated adjustment pay item.

LONGITUDINAL JOINT SEALANT shall be placed on the milled HMA layer (prior to placement of Surface Course) at the following joints only:

- Centerline Joint
- Joints between thru lane and LTL/RTL
- Original widening joint at ~9' offset from Centerline

The following utility structures within pavement are anticipated to be adjusted by others:

UTILITY ADJUSTMENTS

<u>EACH</u>	<u>LOCATION</u>	<u>OFFSET</u>	<u>REMARKS</u>
1	1406+33	RT	HAND HOLE
1	1411+02	LT	HAND HOLE
1	1414+33	LT	GAS VALVE
1	1447+84	RT	HAND HOLE
1	1447+92	RT	HAND HOLE
1	1454+74	LT	HAND HOLE

The following are the number of estimated Class B Patches 13" per Type:

- Type II = 64 Class B Patches
- Type III = 12 Class B Patches
- Type IV = 24 Class B Patches

FILE NAME = 64N91.GN.DOCX	USER NAME =	DESIGNED - Engineering Systems	REVISED -	STATE OF ILLINOIS DEPARTMENT OF TRANSPORTATION	GENERAL NOTES	ROUTE	SECTION	COUNTY	TOTAL SHEETS	SHEET NO.		
	PLOT SCALE =	CHECKED -	REVISED -			FAP 599	(48MFT, 62MFT)RS	Rock Island	45	4		
	PLOT DATE = 4/30/2021 1:26 PM	DATE = 4/30/2021 11:32 AM	REVISED -			CONTRACT NO. 64N91			ILLINOIS	FED. AID PROJECT		
						SCALE: SHEET NO. OF SHEETS STA. TO STA.						

CODE NO.	ITEM	UNIT	TOTAL QUANTITY	CONSTRUCTION CODE				
				80% FEDERAL 20% STATE	80% FEDERAL 13% STATE / 7% ROCK ISLAND	80% FEDERAL 10% STATE 10% MILAN	100% ROCK ISLAND	100% MILAN
				ROADWAY	ROADWAY	ROADWAY	ROADWAY	ROADWAY
				0005 URBAN	0005 URBAN	0005 URBAN	0005 URBAN	0005 URBAN
30300001	AGGREGATE SUBGRADE IMPROVEMENT	CU YD	37	37				
40600290	BITUMINOUS MATERIALS (TACK COAT)	POUND	19,862	19,862				
40600900	HOT-MIX ASPHALT BINDER COURSE (HAND METHOD), N50	TON	74	74				
40604060	HOT-MIX ASPHALT SURFACE COURSE, IL-9.5, MIX "D", N50	TON	4,902	4,902				
40800050	INCIDENTAL HOT-MIX ASPHALT SURFACING	TON	640	640				
42000060	WELDED WIRE REINFORCEMENT	SQ YD	960	960				
44000157	HOT-MIX ASPHALT SURFACE REMOVAL, 2"	SQ YD	19,136	19,136				
44201007	CLASS B PATCHES, TYPE II, 13 INCH	SQ YD	683	683				
44201011	CLASS B PATCHES, TYPE III, 13 INCH	SQ YD	192	192				
44201013	CLASS B PATCHES, TYPE IV, 13 INCH	SQ YD	768	768				
44201294	CLASS B PATCH - EXPANSION JOINT	FOOT	500	500				
44201297	DOWEL BARS 1"	EACH	2,000	2,000				
44213200	SAW CUTS	FOOT	5,448	5,448				
44213204	TIE BARS 3/4"	EACH	132	132				

* SPECIALTY ITEMS

MOEFL - Default
 FILE NAME: p:\pub\arconson.dwg
 I:\projects\6491\Program Development\Studies & Plans\Drawings\CADD\CADDrawings\02_6491\ch15004EB.dwg

USER NAME = bartonw	DESIGNED -	REVISED -
	DRAWN -	REVISED -
PLOT SCALE = 100.0000' / in.	CHECKED -	REVISED -
PLOT DATE = May-06-2021 10:27:16 AM	DATE -	REVISED -

**STATE OF ILLINOIS
DEPARTMENT OF TRANSPORTATION**

SUMMARY OF QUANTITIES

SCALE: SHEET 1 OF 5 SHEETS STA. TO STA.

F.A.P. RTE.	SECTION	COUNTY	TOTAL SHEETS	SHEET NO.
599	(48MFT, 62MFT)RS	ROCK ISLAND	45	5
CONTRACT NO. 64N91				
ILLINOIS FED. AID PROJECT				

MOEFL - Default
 FILE NAME: p:\pub\baroncoron.dwg
 I:\projects\64191\Program Development\Studies & Plans\Design\CADD\CAD\Drawings\02_64191_eh1_S004RER.dwg

CODE NO.	ITEM	UNIT	TOTAL QUANTITY	CONSTRUCTION CODE				
				80% FEDERAL 20% STATE	80% FEDERAL 13% STATE 7% ROCK ISLAND	80% FEDERAL 10% STATE 10% MILAN	100% ROCK ISLAND	100% MILAN
				ROADWAY	ROADWAY	ROADWAY	ROADWAY	ROADWAY
				0005	0005	0005	0005	0005
				URBAN	URBAN	URBAN	URBAN	URBAN
48102100	AGGREGATE WEDGE SHOULDER, TYPE B	TON	1,175	1,175				
56109210	WATER VALVES TO BE ADJUSTED	EACH	25				2	23
60255500	MANHOLES TO BE ADJUSTED	EACH	15	3				12
60260100	INLETS TO BE ADJUSTED	EACH	1	1				
60406100	FRAMES AND LIDS, TYPE 1, CLOSED LID	EACH	4	1				3
* 66700305	PERMANENT SURVEY MARKERS, TYPE II	EACH	2	2				
67000400	ENGINEER'S FIELD OFFICE, TYPE A	CAL MO	2	2				
67100100	MOBILIZATION	L SUM	1	1				
70100450	TRAFFIC CONTROL AND PROTECTION, STANDARD 701201	L SUM	1	1				
70100460	TRAFFIC CONTROL AND PROTECTION, STANDARD 701306	L SUM	1	1				
70100600	TRAFFIC CONTROL AND PROTECTION, STANDARD 701336	L SUM	1	1				
70102620	TRAFFIC CONTROL AND PROTECTION, STANDARD 701501	L SUM	1	1				
70102622	TRAFFIC CONTROL AND PROTECTION, STANDARD 701502	L SUM	1	1				
70102635	TRAFFIC CONTROL AND PROTECTION, STANDARD 701701	L SUM	1	1				

* SPECIALTY ITEMS

USER NAME = bartonrw	DESIGNED -	REVISED -	STATE OF ILLINOIS DEPARTMENT OF TRANSPORTATION	SUMMARY OF QUANTITIES			F.A.P. RTE.	SECTION	COUNTY	TOTAL SHEETS	SHEET NO.
PLOT SCALE = 100.0000' / in.	DRAWN -	REVISED -					599	(48MFT, 62MFT)RS	ROCK ISLAND	45	6
PLOT DATE = May-06-2021 10:27:31 AM	CHECKED -	REVISED -		SCALE: SHEET 2 OF 5 SHEETS STA. TO STA.			CONTRACT NO. 64N91				
	DATE -	REVISED -					ILLINOIS FED. AID PROJECT				

MOBILE: Default
 FILE: \\mats-pc\pub\baronaw\dot\illinois\p\p\DOT\Documents\DOT\Office\District 2\Projects\6491\Program Development\Studies & Plans\Drawings\CADD\CAD\Drawings\02_6491\c115004R.R.dwg

CODE NO.	ITEM	UNIT	TOTAL QUANTITY	CONSTRUCTION CODE					
				80% FEDERAL 20% STATE	80% FEDERAL 13% STATE 7% ROCK ISLAND	80% FEDERAL 10% STATE 10% MILAN	100% ROCK ISLAND	100% MILAN	
				ROADWAY	ROADWAY	ROADWAY	ROADWAY	ROADWAY	
				0005	0005	0005	0005	0005	
				URBAN	URBAN	URBAN	URBAN	URBAN	
70106800	CHANGEABLE MESSAGE SIGN	CAL MO	1	1					
70300100	SHORT TERM PAVEMENT MARKING	FOOT	5,092	5,092					
70300150	SHORT TERM PAVEMENT MARKING REMOVAL	SQ FT	1,697	1,697					
70300210	TEMPORARY PAVEMENT MARKING LETTERS AND SYMBOLS	SQ FT	853	853					
70300220	TEMPORARY PAVEMENT MARKING - LINE 4"	FOOT	41,525	41,525					
70300240	TEMPORARY PAVEMENT MARKING - LINE 6"	FOOT	763	763					
70300250	TEMPORARY PAVEMENT MARKING - LINE 8"	FOOT	1,632	1,632					
70300260	TEMPORARY PAVEMENT MARKING - LINE 12"	FOOT	2,434	2,434					
70300280	TEMPORARY PAVEMENT MARKING - LINE 24"	FOOT	492	492					
* 72000100	SIGN PANEL - TYPE 1	SQ FT	63	63					
* 72000200	SIGN PANEL - TYPE 2	SQ FT	11	11					
* 72400310	REMOVE SIGN PANEL - TYPE 1	SQ FT	74	74					
* 72800100	TELESCOPING STEEL SIGN SUPPORT	FOOT	28	28					
* 73000100	WOOD SIGN SUPPORT	FOOT	44	44					

* SPECIALTY ITEMS

USER NAME = bartonw	DESIGNED -	REVISED -	STATE OF ILLINOIS DEPARTMENT OF TRANSPORTATION	SUMMARY OF QUANTITIES			F.A.P. RTE.	SECTION	COUNTY	TOTAL SHEETS	SHEET NO.
PLOT SCALE = 100,0000 ' / in.	DRAWN -	REVISED -					599	(48MFT, 62MFT)RS	ROCK ISLAND	45	7
PLOT DATE = May-06-2021 10:27:45 AM	CHECKED -	REVISED -		SCALE: SHEET 3 OF 5 SHEETS STA. TO STA.			CONTRACT NO. 64N91				
	DATE -	REVISED -					ILLINOIS FED. AID PROJECT				

MOE:\1 - Default
 FILE NAME: p:\pub\baronca\dot\illinois\p\DOT\Documents\DOT Office\District 2\Projects\6491\Program Development\Studies & Plans\Design\CADD\CAD\Drawings\02_6491_eht_S004RER.dwg

CODE NO.	ITEM	UNIT	TOTAL QUANTITY	CONSTRUCTION CODE					
				80% FEDERAL 20% STATE	80% FEDERAL 13% STATE 7% ROCK ISLAND	80% FEDERAL 10% STATE 10% MILAN	100% ROCK ISLAND	100% MILAN	
				ROADWAY	ROADWAY	ROADWAY	ROADWAY	ROADWAY	
				0005	0005	0005	0005	0005	
				URBAN	URBAN	URBAN	URBAN	URBAN	URBAN
* 78000100	THERMOPLASTIC PAVEMENT MARKING - LETTERS AND SYMBOLS	SQ FT	853	853					
* 78009000	MODIFIED URETHANE PAVEMENT MARKING - LETTERS AND SYMBOLS	SQ FT	868	868					
* 78009004	MODIFIED URETHANE PAVEMENT MARKING - LINE 4"	FOOT	41,845	41,845					
	78009006	MODIFIED URETHANE PAVEMENT MARKING - LINE 6"	FOOT	763	763				
* 78009008	MODIFIED URETHANE PAVEMENT MARKING - LINE 8"	FOOT	1,695	1,695					
* 78009012	MODIFIED URETHANE PAVEMENT MARKING - LINE 12"	FOOT	2,433	2,433					
* 78009024	MODIFIED URETHANE PAVEMENT MARKING - LINE 24"	FOOT	504	504					
* 78100100	RAISED REFLECTIVE PAVEMENT MARKER	EACH	333	333					
	78300200	RAISED REFLECTIVE PAVEMENT MARKER REMOVAL	EACH	239	239				
	78300202	PAVEMENT MARKING REMOVAL - WATER BLASTING	SQ FT	1,277	1,277				
* 85000200	MAINTENANCE OF EXISTING TRAFFIC SIGNAL INSTALLATION	EACH	3	1	1	1			
	X4401198	HOT-MIX ASPHALT SURFACE REMOVAL, VARIABLE DEPTH	SQ YD	19,768	19,768				
* X7830068	GROOVING FOR RECESSED PAVEMENT MARKING, LETTERS, NUMBERS AND SYMBOLS	SQ FT	2,882	2,882					
* X7830070	GROOVING FOR RECESSED PAVEMENT MARKING 5"	FOOT	41,525	41,525					

*** SPECIALTY ITEMS**

USER NAME = bartonw	DESIGNED -	REVISED -	STATE OF ILLINOIS DEPARTMENT OF TRANSPORTATION	SUMMARY OF QUANTITIES			F.A.P. RTE.	SECTION	COUNTY	TOTAL SHEETS	SHEET NO.
PLOT SCALE = 100,0000 ' / in.	DRAWN -	REVISED -					599	(48MFT, 62MFT)RS	ROCK ISLAND	45	8
PLOT DATE = May-06-2021 10:27:57 AM	CHECKED -	REVISED -		SCALE: SHEET 4 OF 5 SHEETS STA. TO STA.			CONTRACT NO. 64N91				
	DATE -	REVISED -					ILLINOIS FED. AID PROJECT				

ANDALUSIA ROAD
STA. 1335+30 TO STA. 1400+18

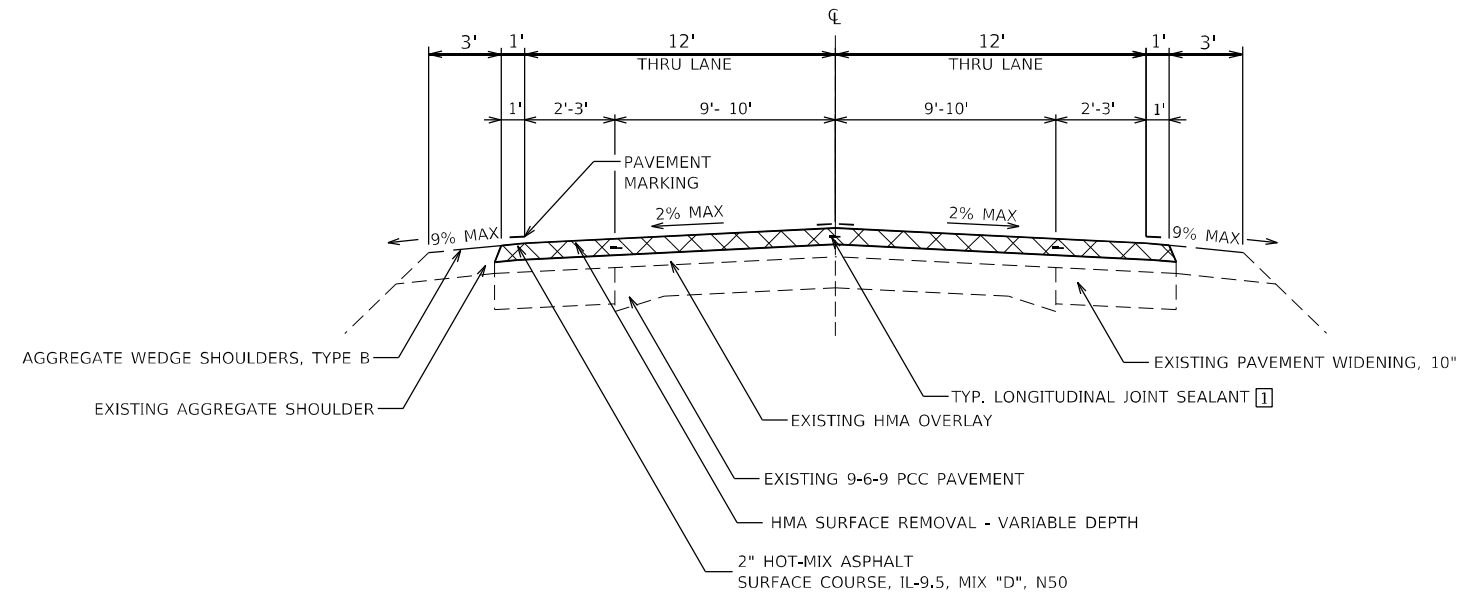

ANDALUSIA ROAD
STA. 1400+18 TO STA. 1406+18

1 IN ADDITION TO LONGITUDINAL JOINTS, LJS WILL ALSO BE USED ALONG THE WIDENING CRACKS.

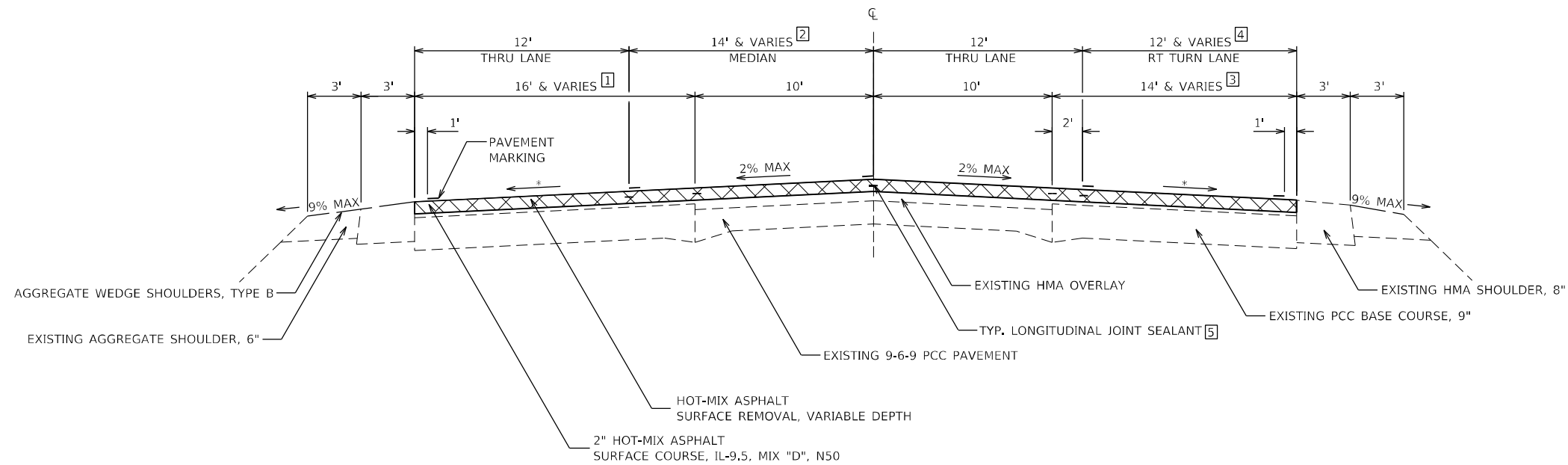

* MAINTAIN EXISTING X-SLOPE

AGGREGATE WEDGE SHOULDERS, TYPE B, MINIMUM WIDTH 3'

112#/IN/SQ YD

LONGITUDINAL JOINT SEALANT WILL BE PLACED ON THE MILLED SURFACE, PRIOR TO PLACEMENT OF SURFACE

- 1 VARIES FROM 3' AT STA. 1400+18 TO 16' AT STA. 1406+18
- 2 VARIES FROM 0' AT STA. 1400+18 TO 14' AT STA. 1406+18
- 3 VARIES FROM 3' AT STA. 1401+60 TO 14' AT STA. 1405+03
STA. 1406+18 BEGIN RADIUS RETURN
- 4 VARIES FROM 0' AT STA. 1401+60 TO 12' AT STA. 1405+03
STA. 1406+18 BEGIN RADIUS RETURN (RIDGE WOOD ROAD)
- 5 IN ADDITION TO LONGITUDINAL JOINTS, LJS WILL ALSO BE USED ALONG THE WIDENING CRACKS.

MODEL: D:\info\... FILE NAME: ...

USER NAME = romerore	DESIGNED -	REVISED -
	DRAWN -	REVISED -
PLOT SCALE = 100,0000' / in.	CHECKED -	REVISED -
PLOT DATE = Apr-27-2021 01:27:56 PM	DATE -	REVISED -

STATE OF ILLINOIS
DEPARTMENT OF TRANSPORTATION

TYPICAL SECTIONS

SCALE: SHEET 1 OF 7 SHEETS STA. TO STA.

F.A.P. RTE.	SECTION	COUNTY	TOTAL SHEETS	SHEET NO.
599	(48MFT, 62MFT)RS	ROCK ISLAND	45	10
CONTRACT NO. 64N91				
ILLINOIS FED. AID PROJECT				

ANDALUSIA ROAD
STA. 1423+39 TO STA. 1430+20

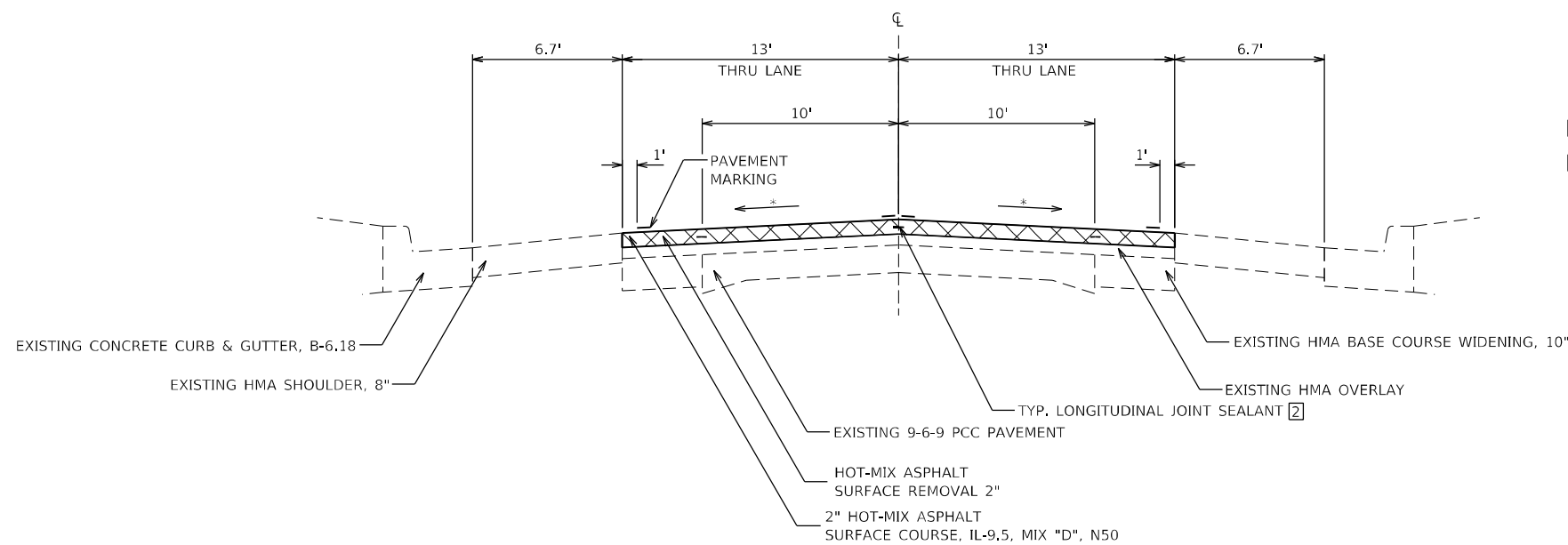

- 1 CURB & GUTTER LEFT ENDS STA. 1423+39
CURB & GUTTER RIGHT ENDS STA. 1430+20
- 2 IN ADDITION TO LONGITUDINAL JOINTS, LJS WILL ALSO BE USED ALONG THE WIDENING CRACKS.

ANDALUSIA ROAD
STA. 1440+12 TO STA. 1443+00

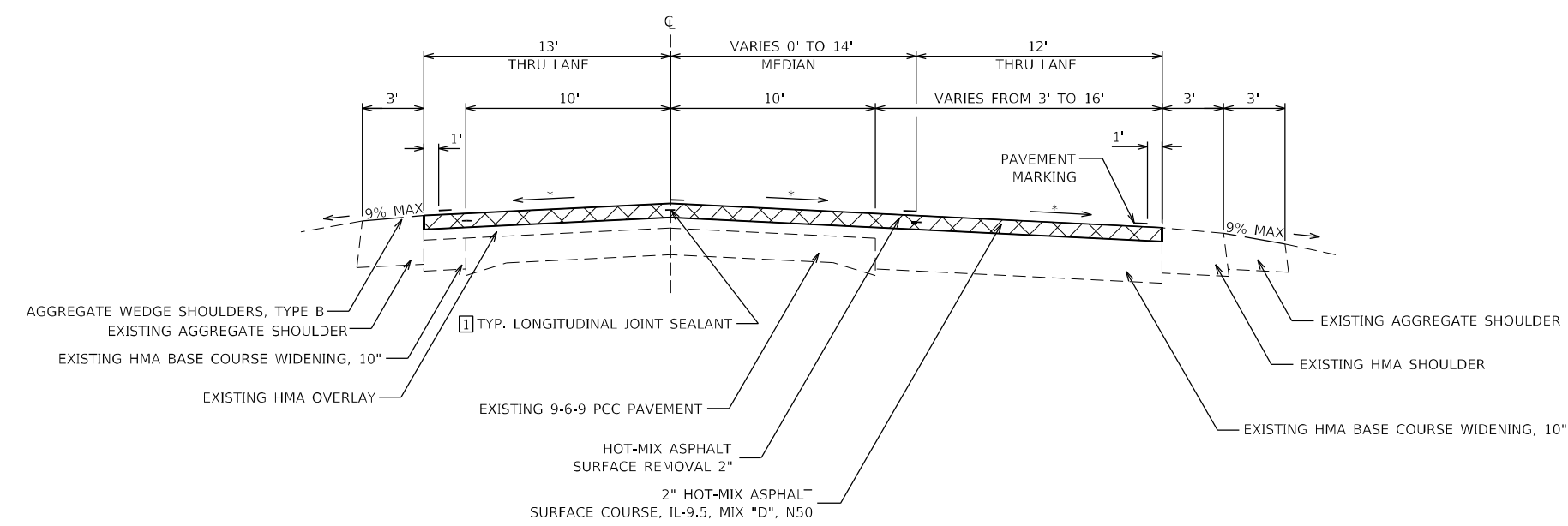

- 1 IN ADDITION TO LONGITUDINAL JOINTS, LJS WILL ALSO BE USED ALONG THE WIDENING CRACKS.

* MAINTAIN EXISTING X-SLOPE
AGGREGATE WEDGE SHOULDERS, TYPE B, MINIMUM WIDTH 3'
112#/IN/SQ YD
LONGITUDINAL JOINT SEALANT WILL BE PLACED ON THE MILLED SURFACE, PRIOR TO PLACEMENT OF SURFACE

MODEL: D:\Info\... FILE NAME: ...

USER NAME = romerore	DESIGNED -	REVISED -
PLOT SCALE = 100,0000' / in.	DRAWN -	REVISED -
PLOT DATE = Apr-27-2021 01:25:04 PM	CHECKED -	REVISED -
	DATE -	REVISED -

**STATE OF ILLINOIS
DEPARTMENT OF TRANSPORTATION**

TYPICAL SECTIONS			
SCALE:	SHEET 3	OF 7 SHEETS	STA. TO STA.

F.A.P. RTE.	SECTION	COUNTY	TOTAL SHEETS	SHEET NO.
599	(48MFT, 62MFT)RS	ROCK ISLAND	45	12
CONTRACT NO. 64N91				
ILLINOIS FED. AID PROJECT				

ANDALUSIA ROAD
STA. 1443+00 TO STA. 1446+56 ①

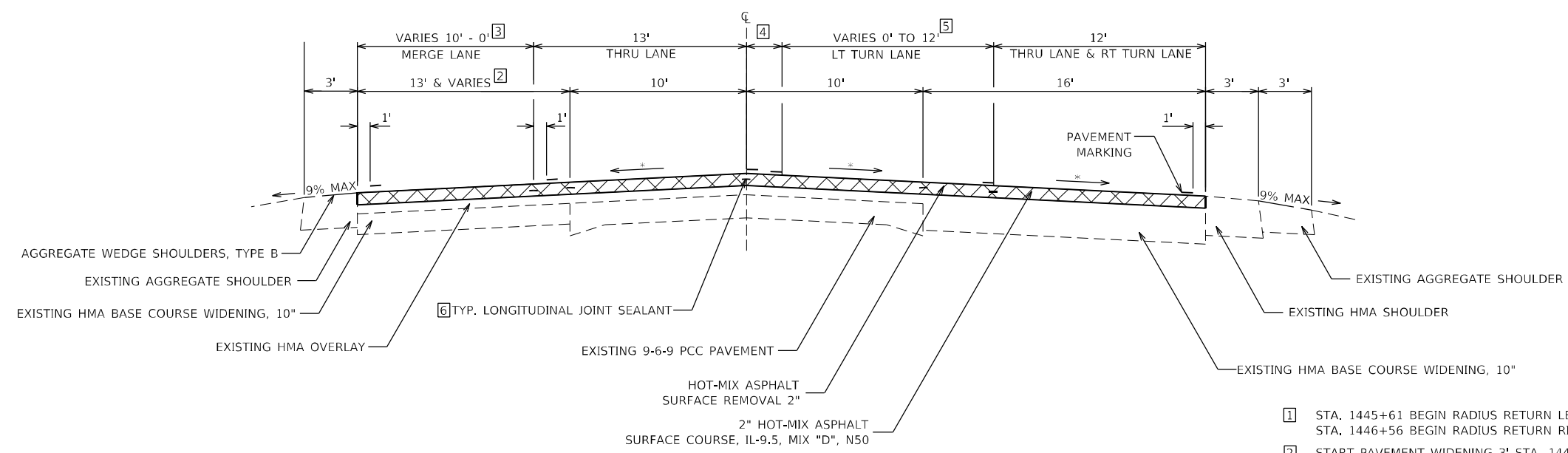

- ① STA. 1445+61 BEGIN RADIUS RETURN LEFT (4TH STREET)
STA. 1446+56 BEGIN RADIUS RETURN RIGHT (4TH STREET)
- ② START PAVEMENT WIDENING 3' STA. 1443+38 TO 13' STA. 1446+56
- ③ MERGE LANE - VARIES FROM 0' STA. 1443+38 TO 10' STA. 1446+56
- ④ MEDIAN - VARIES FROM 14' STA. 1443+00 TO 2' STA. 1445+12
MEDIAN - 2' FROM STA. 1445+12 TO STA. 1446+56
- ⑤ TURN LANE - VARIES FROM 0' STA. 1443+00 TO 12' STA. 1445+12
TURN LANE - 12' FROM STA. 1445+12 TO STA. 1446+56
- ⑥ IN ADDITION TO LONGITUDINAL JOINTS, LJS WILL ALSO BE USED ALONG THE WIDENING CRACKS.

ANDALUSIA ROAD
STA. 1446+56 TO STA. 1450+92 ①

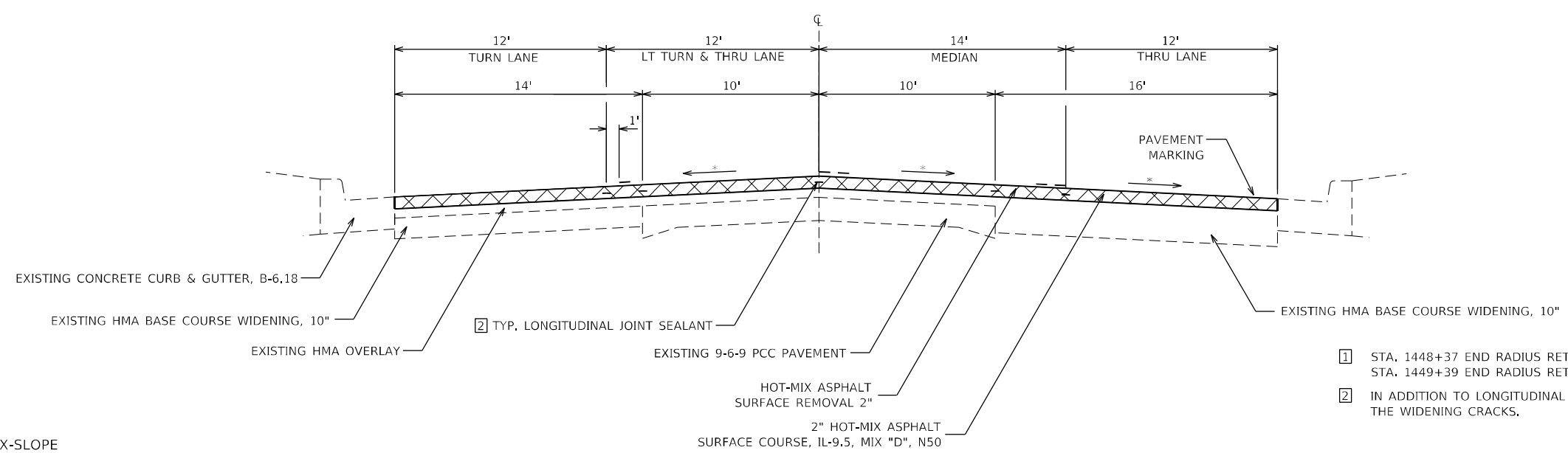

- ① STA. 1448+37 END RADIUS RETURN LEFT (4TH STREET)
STA. 1449+39 END RADIUS RETURN RIGHT (4TH STREET)
- ② IN ADDITION TO LONGITUDINAL JOINTS, LJS WILL ALSO BE USED ALONG THE WIDENING CRACKS.

* MAINTAIN EXISTING X-SLOPE
AGGREGATE WEDGE SHOULDERS, TYPE B, MINIMUM WIDTH 3'
112#/IN/SQ YD
LONGITUDINAL JOINT SEALANT WILL BE PLACED ON THE MILLED SURFACE, PRIOR TO PLACEMENT OF SURFACE

MODEL: Default
FILE NAME: p:\projects\64N91\Program Development\Studies & Plans\Design\CADD\CAD\Sheet\02_64N91.ctb\typical.dwg

USER NAME = romerore	DESIGNED -	REVISED -
	DRAWN -	REVISED -
PLOT SCALE = 100,0000' / in.	CHECKED -	REVISED -
PLOT DATE = Apr-27-2021 01:25:58 PM	DATE -	REVISED -

STATE OF ILLINOIS
DEPARTMENT OF TRANSPORTATION

SCALE:		SHEET 4 OF 7 SHEETS		STA.	TO STA.
--------	--	---------------------	--	------	---------

TYPICAL SECTIONS

F.A.P. RTE.	SECTION	COUNTY	TOTAL SHEETS	SHEET NO.
599	(48MFT, 62MFT)RS	ROCK ISLAND	45	13
CONTRACT NO. 64N91				
ILLINOIS FED. AID PROJECT				

ANDALUSIA ROAD
STA. 1450+92 TO STA. 1457+60

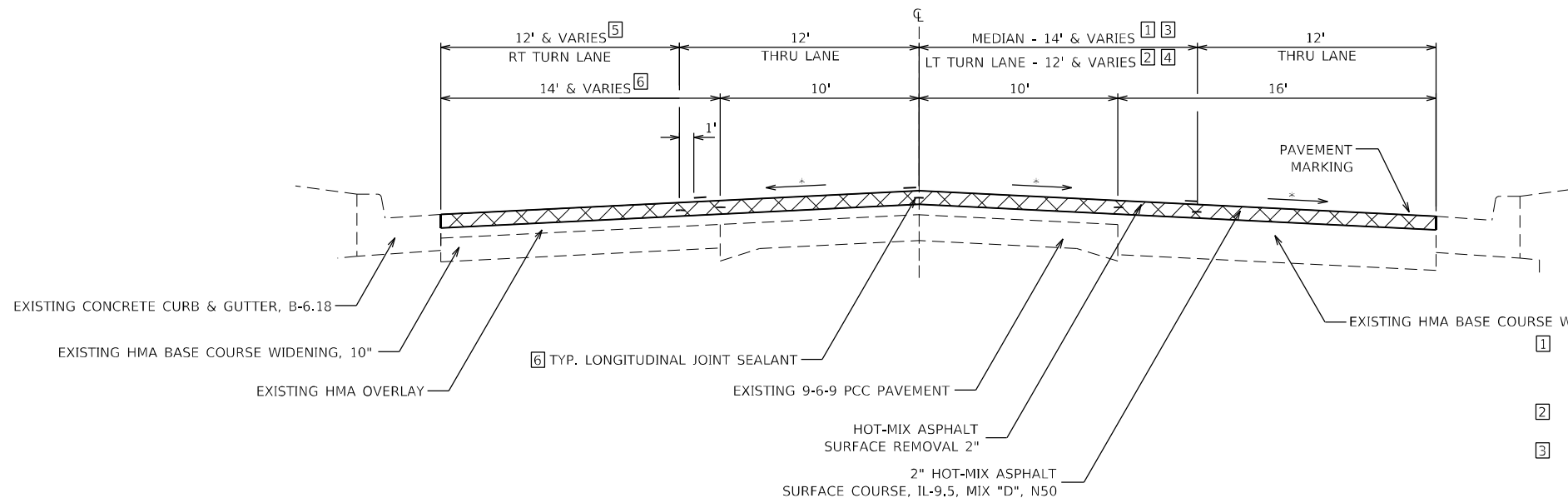

- 1 MEDIAN - VARIES FROM 4' STA. 1448+09 TO 14' STA. 1448+59
MEDIAN - 14' FROM STA. 1448+59 TO STA. 1450+92
MEDIAN - VARIES FROM 14' STA. 1450+92 TO 2' STA. 1452+58
- 2 TURN LANE - VARIES FROM 0' STA. 1450+92 TO 12' STA. 1452+58
TURN LANE - 12' FROM STA. 1452+58 TO STA. 1452+64
- 3 MEDIAN - VARIES FROM 14' STA. 1450+92 TO 2' STA. 1452+58
MEDIAN - VARIES FROM 4' STA. 1454+56 TO 14' STA. 1455+02
MEDIAN - 14' FROM STA. 1455+02 TO STA. 1457+06
MEDIAN - VARIES FROM 14' STA. 1457+06 TO 11.9' STA. 1457+60
- 4 TURN LANE - VARIES FROM 0 TO 12' FROM STA. 1450+92 TO 12' STA. 1452+58
TURN LANE - VARIES FROM 0' STA. 1457+06 TO 2.1' STA. 1457+60
- 5 TURN LANE - 12' FROM STA. 1454+80 TO STA. 1456+03
TURN LANE - VARIES FROM 12' STA. 1456+03 TO 0' STA. 1457+60
- 6 IN ADDITION TO LONGITUDINAL JOINTS, LJS WILL ALSO BE USED ALONG THE WIDENING CRACKS.

ANDALUSIA ROAD
STA. 1457+60 TO STA. 1459+10

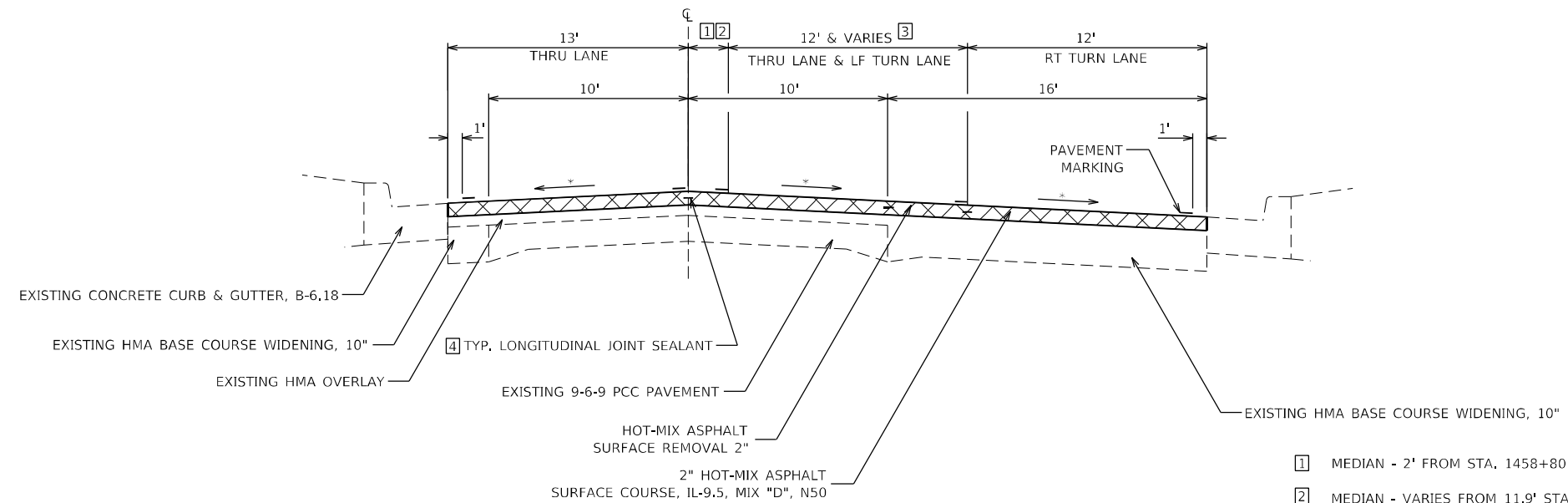

- 1 MEDIAN - 2' FROM STA. 1458+80 TO 1459+10
- 2 MEDIAN - VARIES FROM 11.9' STA. 1457+60 TO 2' STA. 1458+80
- 3 TURN LANE - VARIES FROM 2.1' STA. 1457+60 TO 12' STA. 1458+80
TURN LANE - 12' FROM STA. 1458 TO STA. 1459+10
- 4 IN ADDITION TO LONGITUDINAL JOINTS, LJS WILL ALSO BE USED ALONG THE WIDENING CRACKS.

* MAINTAIN EXISTING X-SLOPE
AGGREGATE WEDGE SHOULDERS, TYPE B, MINIMUM WIDTH 3'
112#/IN/SQ YD
LONGITUDINAL JOINT SEALANT WILL BE PLACED ON THE MILLED SURFACE, PRIOR TO PLACEMENT OF SURFACE

MODEL: D:\info\... FILE NAME: p:\work\... PROJECT: ...

USER NAME = romerore	DESIGNED -	REVISED -
	DRAWN -	REVISED -
PLOT SCALE = 100,0000' / in.	CHECKED -	REVISED -
PLOT DATE = Apr-27-2021 01:26:41 PM	DATE -	REVISED -

STATE OF ILLINOIS
DEPARTMENT OF TRANSPORTATION

TYPICAL SECTIONS			
SCALE:	SHEET 5	OF 7 SHEETS	STA. TO STA.

F.A.P. RTE.	SECTION	COUNTY	TOTAL SHEETS	SHEET NO.
599	(48MFT, 62MFT)RS	ROCK ISLAND	45	14
CONTRACT NO. 64N91				
ILLINOIS FED. AID PROJECT				

SIDEROADS TYPICAL

31st STREET W.
 29th STREET W.
 ESTATE DRIVE
 RIDGEWOOD ROAD
 12th STREET W.
 11th STREET W.
 10th STREET W.
 9th STREET W.
 7th STREET W.
 6th 1/2 STREET W.
 4th STREET W.
 FRONTAGE ROAD

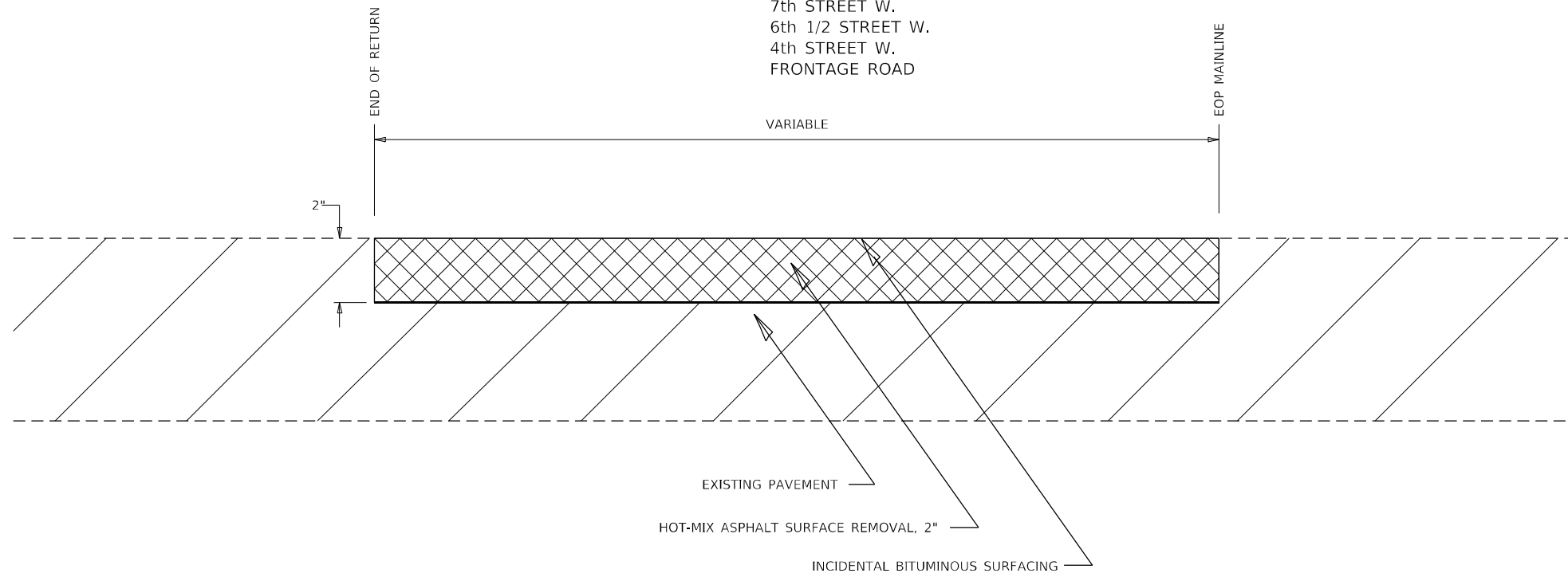

ENTRANCE TYPICAL

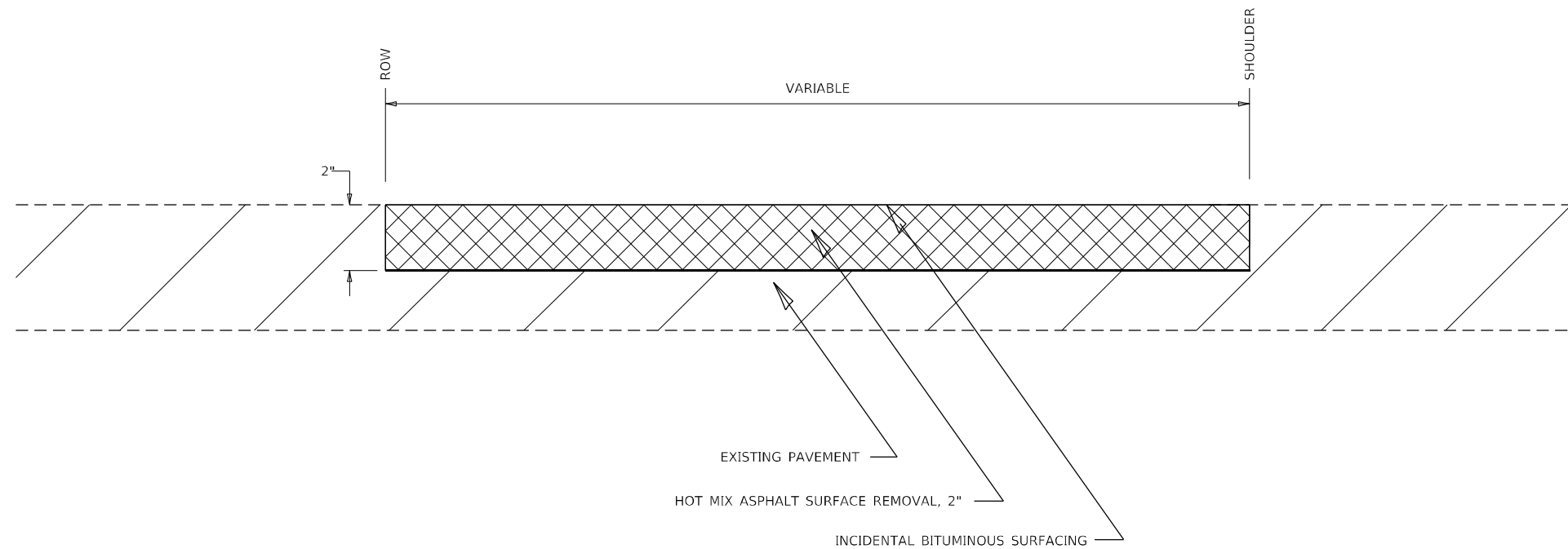

NOTE:

HMA UNIT WEIGHT= 112 LB/SY/IN

STATE OF ILLINOIS
 DEPARTMENT OF TRANSPORTATION

TYPICAL SECTIONS

SCALE: SHEET 7 OF 7 SHEETS STA. TO STA.

F.A.P. RTE.	SECTION	COUNTY	TOTAL SHEETS	SHEET NO.
599	(48MFT, 62MFT)RS	ROCK ISLAND	45	15
CONTRACT NO. 64N91				
ILLINOIS FED. AID PROJECT				

MODEL: D:\info\h...
 FILE NAME: p...
 PROJECT: ...
 DATE: ...

30300001	AGGREGATE SUBGRADE IMPROVEMENT		REMARKS
CU YD	LOCATION	OFFSET	
	ANDALUSIA ROAD		
37	1335+30 - 1459+10	LT/RT	AS DIRECTED BY THE ENGINEER
37	TOTAL		
42000060	WELDED WIRE REINFORCEMENT		REMARKS
SQ YD	LOCATION	OFFSET	
	ANDALUSIA ROAD		
960	1335+30 - 1459+10	LT/RT	AS DIRECTED BY THE ENGINEER
960	TOTAL		
44201007	CLASS B PATCHES, TYPE II, 13 INCH		REMARKS
SQ YD	LOCATION	OFFSET	
	ANDALUSIA ROAD		
683	1335+30 - 1459+10	LT/RT	AS DIRECTED BY THE ENGINEER
683	TOTAL		
44201011	CLASS B PATCHES, TYPE III, 13 INCH		REMARKS
SQ YD	LOCATION	OFFSET	
	ANDALUSIA ROAD		
192	1335+30 - 1459+10	LT/RT	AS DIRECTED BY THE ENGINEER
192	TOTAL		
44201013	CLASS B PATCHES, TYPE IV, 13 INCH		REMARKS
SQ YD	LOCATION	OFFSET	
	ANDALUSIA ROAD		
768	1335+30 - 1459+10	LT/RT	AS DIRECTED BY THE ENGINEER
768	TOTAL		
44201294	CLASS B PATCH - EXPANSION JOINT		REMARKS
FOOT	LOCATION	OFFSET	
	ANDALUSIA ROAD		
500	1335+30 - 1459+10	LT/RT	AS DIRECTED BY THE ENGINEER
500	TOTAL		
44201297	DOWEL BARS 1"		REMARKS
EACH	LOCATION	OFFSET	
	ANDALUSIA ROAD		
2000	1335+30 - 1459+10	LT/RT	AS DIRECTED BY THE ENGINEER
2,000	TOTAL		
44213200	SAW CUTS		REMARKS
FOOT	LOCATION	OFFSET	
	ANDALUSIA ROAD		
5448	1335+30 - 1459+10	LT/RT	AS DIRECTED BY THE ENGINEER
5,448	TOTAL		

EACH	LOCATION	OFFSET	REMARKS
132	ANDALUSIA ROAD		
	1335+30 - 1459+10	LT/RT	AS DIRECTED BY THE ENGINEER
132	TOTAL		

56109210	WATER VALVES TO BE ADJUSTED		REMARKS
EACH	LOCATION	OFFSET	
	ANDALUSIA ROAD		
1	1342+00	RT	ROCK ISLAND
1	1406+89	RT	ROCK ISLAND
1	1414+05	LT	MILAN
1	1414+09	LT	MILAN
1	1414+13	LT	MILAN
1	1414+33	LT	MILAN
1	1417+33	LT	MILAN
2	1417+35	LT	MILAN
1	1420+61	LT	MILAN
1	1420+64	LT	MILAN
2	1435+82	RT	MILAN
1	1435+83	RT	MILAN
1	1436+23	LT	MILAN
1	1447+25	LT	MILAN
1	1447+31	RT	MILAN
1	1447+34	LT	MILAN
1	1447+40	RT	MILAN
1	1447+42	LT	MILAN
1	1447+46	RT	MILAN
1	1453+56	LT	MILAN
1	1453+68	LT	MILAN
1	1453+72	LT	MILAN
1	1454+38	LT	MILAN
2	SUBTOTAL VILLAGE OF MILAN		
23	SUBTOTAL ROCK ISLAND CO.		
25	TOTAL		

60255500	MANHOLES TO BE ADJUSTED		REMARKS
EACH	LOCATION	OFFSET	
	ANDALUSIA ROAD		
1	1414+31	LT	SANITARY (MILAN)
1	1417+57	LT	SANITARY (MILAN)
1	1420+75	LT	SANITARY (MILAN)
1	1431+86	RT	SANITARY (MILAN)
1	1436+38	LT	SANITARY (MILAN)
1	1447+79	RT	SANITARY (MILAN)
1	1447+82	RT	SANITARY (MILAN)
1	1448+48	RT	STORM (IDOT)
1	1450+11	RT	SANITARY (MILAN)
1	1450+15	LT	STORM (IDOT)
1	1451+07	RT	STORM (IDOT)
1	1452+48	RT	SANITARY (MILAN)
1	1453+66	RT	SANITARY (MILAN)
1	1455+70	RT	SANITARY (MILAN)
1	1458+12	RT	SANITARY (MILAN)
13	SUBTOTAL VILLAGE OF MILAN		
2	SUBTOTAL IDOT		
15	TOTAL		

60260100	INLETS TO BE ADJUSTED		REMARKS
EACH	LOCATION	OFFSET	
	ANDALUSIA ROAD		
1	1432+08	RT	Grate inlet
1	TOTAL		

60406100	FRAMES AND LIDS, TYPE 1, CLOSED LID		REMARKS
EACH	LOCATION	OFFSET	
	ANDALUSIA ROAD		
4	1335+30 - 1459+10	RT/LT	AS DIRECTED BY THE ENGINEER
4	TOTAL		

MODEL: Default
 FILE NAME: p:\pub\mranon.dwg
 PROJECT: 64N91
 OFFICE: IDOT
 OFFICE: DISTRICT 2
 PROJECT: 64N91
 PROGRAM: DEVELOPMENT
 STUDIES & PLANS DESIGN
 CADD: CAD
 SHEETS: 02_64N91-LS-CH-SCHEDULE_REB.dwg

USER NAME = ROMERORE	DESIGNED - _____	REVISED - _____
	DRAWN - _____	REVISED - _____
PLOT SCALE = 100,0000' / in.	CHECKED - _____	REVISED - _____
PLOT DATE = Apr-30-2021 08:05:15 PM	DATE - _____	REVISED - _____

**STATE OF ILLINOIS
DEPARTMENT OF TRANSPORTATION**

SCHEDULE OF QUANTITIES

SCALE: _____ SHEET 1 OF 7 SHEETS STA. _____ TO STA. _____

F.A.P. RTE.	SECTION	COUNTY	TOTAL SHEETS	SHEET NO.
599	(48MFT, 62MFT)RS	ROCK ISLAND	45	16
CONTRACT NO. 64N91			ILLINOIS FED. AID PROJECT	

66700305 PERMANENT SURVEY MARKERS, TYPE II

EACH	LOCATION	OFFSET	REMARKS
	ANDALUSIA ROAD		
2	1335+30 - 1459+10	RT/LT	LOCATION DETERMINED BY DISTRICT CHIEF OF SURVEYS
2	TOTAL		

70300100 SHORT TERM PAVEMENT MARKING

FOOT	LOCATION	OFFSET	REMARKS
	2 APPLICATIONS		
359	1335+30 - 1355+02	CL	YELLOW SKIP DASH
509	1355+02 - 1369+02	CL	NO PASSING ZONE
402	1369+02 - 1391+11	CL	YELLOW SKIP DASH
330	1391+11 - 1400+19	CL	NO PASSING ZONE
767	1400+19 - 1410+74	MEDIAN	DOUBLE YELLOW
28	1405+18 - 1406+71	RT	WHITE TURN LANE LINES
31	1407+20	RT	WHITE PAINTED ISLAND
9	1407+51 - 1408+01	RT (34 ft)	
4	1407+63	RT (80 ft)	WHITE TURN LANE LINES (SIDE ROAD)
17	1407+90 - 1408+86	LT	WHITE TURN LANE LINES
208	1411+08 - 1413+95	MEDIAN	DOUBLE YELLOW
61	1414+56 - 1415+39	MEDIAN	DOUBLE YELLOW
292	1415+39 - 1423+42	CL	DOUBLE SOLID YELLOW LINE
190	1423+42 - 1433+87	CL	YELLOW SKIP DASH
193	1433+87 - 1439+18	CL	NO PASSING ZONE
34	1439+18 - 1440+12	CL	DOUBLE SOLID YELLOW LINE
495	1440+12 - 1446+92	MEDIAN	DOUBLE YELLOW
32	1445+12 - 1446+90	RT	WHITE TURN LANE LINES
19	1446+97	LT	WHITE PAINTED ISLAND
89	1447+41	RT	DOUBLE SOLID YELLOW LINE / SIDEROAD (BOTH DIRECTIONS)
113	1447+41	LT	DOUBLE SOLID YELLOW LINE / SIDEROAD (BOTH DIRECTIONS)
19	1447+52	RT (53 ft)	WHITE TURN LANE LINES (SIDE ROAD)
19	1447+62	RT (53 ft)	WHITE TURN LANE LINES (SIDE ROAD)
413	1448+07 - 1453+75	MEDIAN	DOUBLE YELLOW
24	1448+13 - 1449+43	LT	WHITE TURN LANE LINES
21	1452+58 - 1453+73	RT	WHITE TURN LANE LINES
9	1454+14	LT (38 ft)	WHITE TURN LANE LINES (SIDE ROAD)
39	1454+27	MEDIAN (34 ft)	DOUBLE SOLID YELLOW LINE / SIDEROAD (BOTH DIRECTIONS)
331	1454+56 - 1459+11	MEDIAN	DOUBLE YELLOW
22	1454+80 - 1456+03	LT	WHITE TURN LANE LINES
14	1458+80 - 1459+55	RT	WHITE TURN LANE LINES
5,092	TOTAL		

70300150 SHORT TERM PAVEMENT MARKING REMOVAL

SQ FT	LOCATION	OFFSET	REMARKS
	ANDALUSIA ROAD		
120	1335+30 - 1355+02	CL	YELLOW SKIP DASH
170	1355+02 - 1369+02	CL	NO PASSING ZONE
134	1369+02 - 1391+11	CL	YELLOW SKIP DASH
110	1391+11 - 1400+19	CL	NO PASSING ZONE
256	1400+19 - 1410+74	MEDIAN	DOUBLE YELLOW
9	1405+18 - 1406+71	RT	WHITE TURN LANE LINES
10	1407+20	RT	WHITE PAINTED ISLAND
3	1407+51 - 1408+01	RT (34 ft)	
1	1407+63	RT (80 ft)	WHITE TURN LANE LINES (SIDE ROAD)
6	1407+90 - 1408+86	LT	WHITE TURN LANE LINES
69	1411+08 - 1413+95	MEDIAN	DOUBLE YELLOW
20	1414+56 - 1415+39	MEDIAN	DOUBLE YELLOW
97	1415+39 - 1423+42	CL	DOUBLE SOLID YELLOW LINE
63	1423+42 - 1433+87	CL	YELLOW SKIP DASH
64	1433+87 - 1439+18	CL	NO PASSING ZONE
11	1439+18 - 1440+12	CL	DOUBLE SOLID YELLOW LINE
165	1440+12 - 1446+92	MEDIAN	DOUBLE YELLOW

11	1445+12 - 1446+90	RT	WHITE TURN LANE LINES
6	1446+97	LT	WHITE PAINTED ISLAND
30	1447+41	RT	DOUBLE SOLID YELLOW LINE / SIDEROAD (BOTH DIRECTIONS)
38	1447+41	LT	DOUBLE SOLID YELLOW LINE / SIDEROAD (BOTH DIRECTIONS)
6	1447+52	RT (53 ft)	WHITE TURN LANE LINES (SIDE ROAD)
6	1447+62	RT (53 ft)	WHITE TURN LANE LINES (SIDE ROAD)
138	1448+07 - 1453+75	MEDIAN	DOUBLE YELLOW
8	1448+13 - 1449+43	LT	WHITE TURN LANE LINES
7	1452+58 - 1453+73	RT	WHITE TURN LANE LINES
3	1454+14	LT (38 ft)	WHITE TURN LANE LINES (SIDE ROAD)
13	1454+27	MEDIAN (34 ft)	DOUBLE SOLID YELLOW LINE / SIDEROAD (BOTH DIRECTIONS)
110	1454+56 - 1459+11	MEDIAN	DOUBLE YELLOW
7	1454+80 - 1456+03	LT	WHITE TURN LANE LINES
5	1458+80 - 1459+55	RT	WHITE TURN LANE LINES
1,697	TOTAL		

70300210 TEMPORARY PAVEMENT MARKING - LETTER & SYMBOLS

SQ FT	LOCATION	OFFSET	REMARKS
	FOR WINTER SHUTDOWN		
16	1046+10 - 1046+18	RT	RIGHT TURN ARROW
54	1406+53 - 1406+73	RT	RAILROAD - HIGHWAY GRADE CROSSING
16	1408+05 - 1408+13	LT	LEFT TURN ARROW
54	1408+59 - 1408+79	LT	RAILROAD - HIGHWAY GRADE CROSSING
54	1414+95 - 1415+15	RT	RAILROAD - HIGHWAY GRADE CROSSING
54	1426+12 - 1426+32	LT	RAILROAD - HIGHWAY GRADE CROSSING
26	1445+13 - 1445+22	RT	DOUBLE ARROW
16	1445+16 - 1445+22	RT	LEFT TURN ARROW
26	1445+63 - 1445+72	RT	DOUBLE ARROW
16	1445+66 - 1445+72	RT	LEFT TURN ARROW
26	1446+13 - 1446+22	RT	DOUBLE ARROW
16	1446+16 - 1446+22	RT	LEFT TURN ARROW
26	1446+63 - 1446+72	RT	DOUBLE ARROW
16	1446+66 - 1446+72	RT	LEFT TURN ARROW
26	1447+50	RT(73ft)	DOUBLE ARROW (W 4TH STREET)
12	1447+58	RT(73ft)	SINGLE ARROW (W 4TH STREET)
16	1447+71	RT(73ft)	RIGHT TURN ARROW (W 4TH STREET)
26	1447+50	RT(123 ft)	DOUBLE ARROW (W 4TH STREET)
12	1447+58	RT(123 ft)	SINGLE ARROW (W 4TH STREET)
16	1447+71	RT(123 ft)	RIGHT TURN ARROW (W 4TH STREET)
26	1448+34 - 1448+43	LT	DOUBLE ARROW
16	1448+34 - 1448+40	LT	RIGHT TURN ARROW
26	1448+84 - 1448+93	LT	DOUBLE ARROW
16	1448+84 - 1448+90	LT	RIGHT TURN ARROW
26	1449+34 - 1449+43	LT	DOUBLE ARROW
16	1449+34 - 1449+40	LT	RIGHT TURN ARROW
16	1452+47 - 1452+53	RT	LEFT TURN ARROW
16	1452+97 - 1452+03	RT	LEFT TURN ARROW
16	1453+47 - 1453+53	RT	LEFT TURN ARROW
16	1454+05	LT (54 ft)	RIGHT TURN ARROW (SIDE STREET)
16	1454+19	LT (53 ft)	LEFT TURN ARROW (SIDE STREET)
16	1454+98 - 1455+04	LT	RIGHT TURN ARROW
16	1455+48 - 1455+54	LT	RIGHT TURN ARROW
16	1455+98 - 1456+04	LT	RIGHT TURN ARROW
26	1459+18 - 1459+27	RT	DOUBLE ARROW
16	1459+20 - 1459+26	RT	RIGHT TURN ARROW
26	1459+68 - 1459+77	RT	DOUBLE ARROW
16	1459+72 - 1459+76	RT	RIGHT TURN ARROW
853	TOTAL		

MODEL: D:\info\...
 FILE NAME: p:\u\hamronm\dot\illinois\gov\p\w\dot\Documents\DOT_Official\District_2\Projects\649N91\Program_Development\Studies_&_Plans\Design\CADD\CAD\Sheet\02_649N91_sch\sheet02_168.dgn

USER NAME = romerore	DESIGNED - _____	REVISED - _____
DRAWN - _____	REVISIONS - _____	
PLOT SCALE = 100,0000' / in.	CHECKED - _____	REVISED - _____
PLOT DATE = Apr-30-2021 01:24:29 PM	DATE - _____	REVISED - _____

**STATE OF ILLINOIS
DEPARTMENT OF TRANSPORTATION**

SCHEDULE OF QUANTITIES

SCALE: _____ SHEET 2 OF 7 SHEETS STA. _____ TO STA. _____

F.A.P. RTE.	SECTION	COUNTY	TOTAL SHEETS	SHEET NO.
599	(48MFT, 62MFT)RS	ROCK ISLAND	45	17
CONTRACT NO. 64N91				
ILLINOIS FED. AID PROJECT				

X7830090 GROOVING FOR RECESSED PAVEMENT MARKING 25"

FOOT	LOCATION	OFFSET	REMARKS
ANDALUSIA ROAD			
13	1406+39	RT	WHITE STOP BAR, RIGHT TURN, RAILROAD CROSSING
21	1406+88	RT	WHITE STOP BAR; RIGHT TURN, RAILROAD CROSSING
22	1407+02	RT (28 ft)	WHITE STOP BAR; RIGHT TURN
12	1407+18	RT	WHITE STOP BAR; RIDGEWOOD RD INTERSECTION
25	1407+51 - 1407+77	RT (77 ft)	WHITE STOP BAR; RIDGEWOOD RD SIDEROAD
24	1407+88	LT	WHITE STOP BAR; RIDGEWOOD RD INTERSECTION
12	1408+44	LT	WHITE STOP BAR, RAILROAD CROSSING
13	1410+78 - 1410+91	LT (61 ft)	WHITE STOP BAR; 12TH ST W
18	1414+06 - 1414+23	LT (45 ft)	WHITE STOP BAR; 11TH ST W
12	1414+79	RT	WHITE STOP BAR, RAILROAD CROSSING
12	1415+30	RT	WHITE STOP BAR, RAILROAD CROSSING
14	1417+41 - 1417+55	LT (35 ft)	WHITE STOP BAR; 10TH ST W
13	1419+05	RT	WHITE STOP BAR; RAILROAD APPROACH
13	1422+20	LT	WHITE STOP BAR; RAILROAD APPROACH
13	1425+97	LT	WHITE STOP BAR, RAILROAD CROSSING
13	1426+47	LT	WHITE STOP BAR, RAILROAD CROSSING
35	1446+91	RT	WHITE STOP BAR; 4TH ST W INTERSECTION
23	1447+26	LT	WHITE STOP BAR; 4TH ST W SIDEROAD
49	1447+43 - 1447+92	RT (57 ft)	WHITE STOP BAR; 4TH ST W SIDEROAD
29	1448+14	LT	WHITE STOP BAR; 4TH ST W INTERSECTION
23	1453+74	RT	WHITE STOP BAR; HYVEE INTERSECTION
40	1453+87 - 1454+23	LT (36 ft)	WHITE STOP BAR; HYVEE ENTRANCE INTERSECTION
33	1454+80	LT	WHITE STOP BAR; HYVEE INTERSECTION
11	1459+96	RT	WHITE STOP BAR; 1ST ST
492	TOTAL		

Z0028415 GEOTECHNICAL REINFORCEMENT

SQ YD	LOCATION	OFFSET	REMARKS
ANDALUSIA ROAD			
1,110	1335+30 - 1459+10	LT/RT	AS DIRECTED BY THE ENGINEER
1,110	TOTAL		

MODEL: D:\data\...
 FILE NAME: p:\w\hammon.dwg
 PROJECT: I:\projects\616191\program_development\studies & plans\design\CADD\CADDsheet\02_616191_sch\sheet\02_RER.dgn
 OFFICE: I:\projects\616191\program_development\studies & plans\design\CADD\CADDsheet\02_616191_sch\sheet\02_RER.dgn

USER NAME = romerore	DESIGNED - _____	REVISED - _____
	DRAWN - _____	REVISED - _____
PLOT SCALE = 100,0000' / in.	CHECKED - _____	REVISED - _____
PLOT DATE = Apr-27-2021 01:55:07 PM	DATE - _____	REVISED - _____

**STATE OF ILLINOIS
DEPARTMENT OF TRANSPORTATION**

SCHEDULE OF QUANTITIES

SCALE: _____ SHEET 7 OF 7 SHEETS STA. _____ TO STA. _____

F.A.P. RTE.	SECTION	COUNTY	TOTAL SHEETS	SHEET NO.
599	(48MFT, 62MFT)RS	ROCK ISLAND	45	22
CONTRACT NO. 64N91				
ILLINOIS FED. AID PROJECT				

ENTRANCES/SIDEROADS

											40600290	40800050
LOCATION				CENTERLINE TO ROW	WIDTH AT SHOULDER	SHOULDER TO THROAT	THROAT WIDTH	THROAT TO TERMINI	TERMINI WIDTH	AREA	BITUMINOUS MATERIALS (TACK COAT)	INCIDENTAL HMA SURFACING 2"
STA	STA	RT/LT	REMARKS	FOOT	FOOT	FOOT	FOOT	FOOT	FOOT	SQ YD	POUND	TONS
RURAL EB												
1341+83	- 1342+80	RT	31th ST	-	77.0	27.0	26.0	1.0	1.0	156.0	70.2	17.5
1358+99	- 1360+11	RT	PE / MB	-	70.0	19.0	28.0	1.0	1.0	105.1	47.3	11.8
1379+56	- 1379+98	RT	CE	-	42.0	19.0	28.0	1.0	1.0	75.5	34.0	8.5
1386+05	- 1387+36	RT	FE	-	63.0	18.0	37.0	1.0	1.0	102.1	46.0	-
1391+95	- 1394+41	RT	FE	-	112.0	42.0	57.0	1.0	1.0	397.6	178.9	-
1405+04	- 1406+16	LT	PE	-	42.0	14.0	35.0	1.0	1.0	61.9	27.9	6.9
1407+84	- 1408+99	LT	PE / MB	-	40.0	14.0	40.0	1.0	1.0	64.5	29.0	7.2
1406+85	- 1407+98	RT	RIDGEWOOD RD	-	177.0	37.0	90.0	45.0	46.0	888.8	400.0	99.5
1409+71	- 1410+22	LT	PE	-	65.0	17.0	34.0	1.0	1.0	95.4	43.0	10.7
1410+39	- 1411+41	LT	12th ST	-	80.0	42.0	26.0	1.0	1.0	248.8	112.0	27.9
1413+76	- 1414+81	LT	11th ST	-	72.0	44.0	27.0	1.0	1.0	243.6	109.6	27.3
1414+81	- 1415+58	LT	PE / MB	-	43.0	24.0	35.0	1.0	1.0	106.0	47.7	11.9
1415+82	- 1416+87	LT	PE / MB	-	41.0	27.0	26.0	1.0	1.0	102.0	45.9	11.4
1417+07	- 1418+01	LT	10th ST N	-	64.0	34.0	24.0	1.0	1.0	167.6	75.4	18.8
1417+05	- 1417+67	RT	10th ST S	-	36.0	8.0	35.0	1.0	1.0	32.6	14.7	3.6
1418+60	- 1419+70	LT	CE	-	43.0	20.0	28.0	1.0	1.0	80.5	36.2	9.0
1420+35	- 1421+26	LT	9th ST	-	88.0	39.0	30.0	1.0	1.0	257.4	115.8	28.8
1425+80	- 1426+29	LT	ROCK ISLAND CO. OFC	-	59.0	33.0	22.0	1.0	1.0	149.8	67.4	16.8
1427+75	- 1428+50	LT	PE	-	53.0	21.0	27.0	1.0	1.0	94.9	42.7	10.6
1427+63	- 1428+77	RT	8 1/2th ST	-	62.0	25.0	28.0	1.0	1.0	126.6	57.0	14.2
1430+45	- 1431+28	LT	CE	-	55.0	34.0	19.0	1.0	1.0	140.9	63.4	15.8
1431+46	- 1432+61	LT	CE	-	46.0	24.0	25.0	1.0	1.0	96.1	43.3	10.8
1432+94	- 1434+02	LT	CE	-	49.0	31.0	25.0	1.0	1.0	128.9	58.0	14.4
1433+34	- 1433+93	RT	PE	-	45.0	17.0	27.0	1.0	1.0	69.6	31.3	7.8
1435+34	- 1435+79	RT	PE	-	25.0	22.0	18.0	1.0	1.0	53.6	24.1	6.0
1435+79	- 1436+54	RT	6th ST N	-	61.0	32.0	32.0	1.0	1.0	167.2	75.2	18.7
1435+86	- 1436+88	LT	6th ST S	-	87.0	26.0	38.0	1.0	1.0	182.7	82.2	20.5
1438+14	- 1438+80	LT	PE	-	17.0	15.0	17.0	11.0	1.0	39.3	17.7	4.4
1438+66	- 1439+29	RT	CE	-	46.0	19.0	45.0	1.0	1.0	96.4	43.4	10.8
1439+48	- 1439+94	LT	PE	-	35.0	20.0	12.0	1.0	1.0	52.9	23.8	5.9
1440+62	- 1441+65	LT	CE	-	33.0	19.0	25.0	1.0	1.0	60.4	27.2	10.2
1442+02	- 1443+02	RT	CE	-	37.0	17.0	34.0	1.0	1.0	69.0	31.1	15.5
1442+08	- 1443+25	LT	CE	-	90.0	38.0	58.0	1.0	1.0	315.7	142.1	88.4
1443+43	- 1444+05	LT	CE	-	58.0	38.0	37.0	1.0	1.0	202.7	91.2	68.1
TOTAL											2,355	640

MODEL: D:\info\...
 FILE NAME: p:\u\l\m\room\dat\illinois\gov\p\w\dot\Documents\DOT_Official\Drawings\2\Projects\616\N91\Program_Development\Studies & Plans\Design\CADD\CAD\Drawings\02_64N91_sch\schedule_RER.dgn

USER NAME = romerore	DESIGNED - _____	REVISED - _____
DRAWN - _____	REVISIONS - _____	
PLOT SCALE = 100,0000' / in.	CHECKED - _____	REVISED - _____
PLOT DATE = Apr-27-2021 08:29:39 AM	DATE - _____	REVISED - _____

**STATE OF ILLINOIS
DEPARTMENT OF TRANSPORTATION**

ENTRANCE /SIDEROADS SCHEDULE

SCALE: _____ SHEET 1 OF 1 SHEETS STA. _____ TO STA. _____

F.A.P. RTE.	SECTION	COUNTY	TOTAL SHEETS	SHEET NO.
599	(48MFT, 62MFT)RS	ROCK ISLAND	45	24
CONTRACT NO. 64N91				
ILLINOIS FED. AID PROJECT				

SIGN SCHEDULE

LOCATION	MILEAGE	DIRECTION	DESCRIPTION	SIGN CODE	SIGN DIMENSIONS		72000100	72000200	72400310	72800100	73000100	REMARKS
					HORIZONTAL	VERTICAL	SIGN PANEL TYPE 1	SIGN PANEL TYPE 2	REMOVAL SIGN PANEL TYPE 1	TELESCOPING STEEL SIGN SUPPORT	WOOD SIGN SUPPORT	
					INCHES	INCHES	SQ FT	SQ FT	SQ FT	FOOT	FOOT	
1333+89	0.36	EB	Between Liberty and 31st	W8-8					9			Remove ROUGH ROAD
				W7-3AP					5			Remove NEXT 1.5 MILES plate
1336+53	0.41	EB	Near 31st W	W10-3R	3	3	9.00		9			Remove and replace sign
				W17-1100	36	9	2.25		2.25			Remove and replace sign 31ST ST. W.
1347+62	0.62	WB	Near 31st W	W10-3L	3	3	9.00		9			Remove and replace sign
				W17-1100	36	9	2.25		2.25			Remove and replace sign 31ST ST. W.
1355+01	0.76	EB	Between 29th & Hasselroth Park	W14-3	64	48		10.67	10.67			Remove and replace sign
1414+15	1.88		At 11th St	R1-1	36	36	9.00		6.25	14		Remove and replace sign
1423+12	2.05	WB	Near 10th	W8-8					9			Remove ROUGH ROAD
				W7-3AP					5			Remove NEXT 1.5 MILES plate
1429+99	2.18	WB	Between 8 1/2 St and 7th	R2-1(35)	30	36	7.50				16	
1432+50	2.21	EB	Between 7th and 6 1/2	R2-1(35)	30	36	7.50				14	
1435+27	2.28		At Shady Lane Trailer Park	R1-1	36	36	9.00		6.25	14		Remove and replace sign
1456+91	2.69	WB	300' west of US 67	R2-1(35)	30	36	7.50				14	
TOTAL							63	11	74	28	44	

MODEL: D:\info\h...
 FILE NAME: p:\u\h...

USER NAME = romerore	DESIGNED - _____	REVISED - _____
	DRAWN - _____	REVISED - _____
PLOT SCALE = 100,0000' / in.	CHECKED - _____	REVISED - _____
PLOT DATE = Apr-27-2021 08:30:04 AM	DATE - _____	REVISED - _____

**STATE OF ILLINOIS
DEPARTMENT OF TRANSPORTATION**

SIGN SCHEDULE

SCALE: _____ SHEET 1 OF 1 SHEETS STA. _____ TO STA. _____

F.A.P. RTE.	SECTION	COUNTY	TOTAL SHEETS	SHEET NO.
599	(48MFT, 62MFT)RS	ROCK ISLAND	45	25
CONTRACT NO. 64N91				
ILLINOIS FED. AID PROJECT				

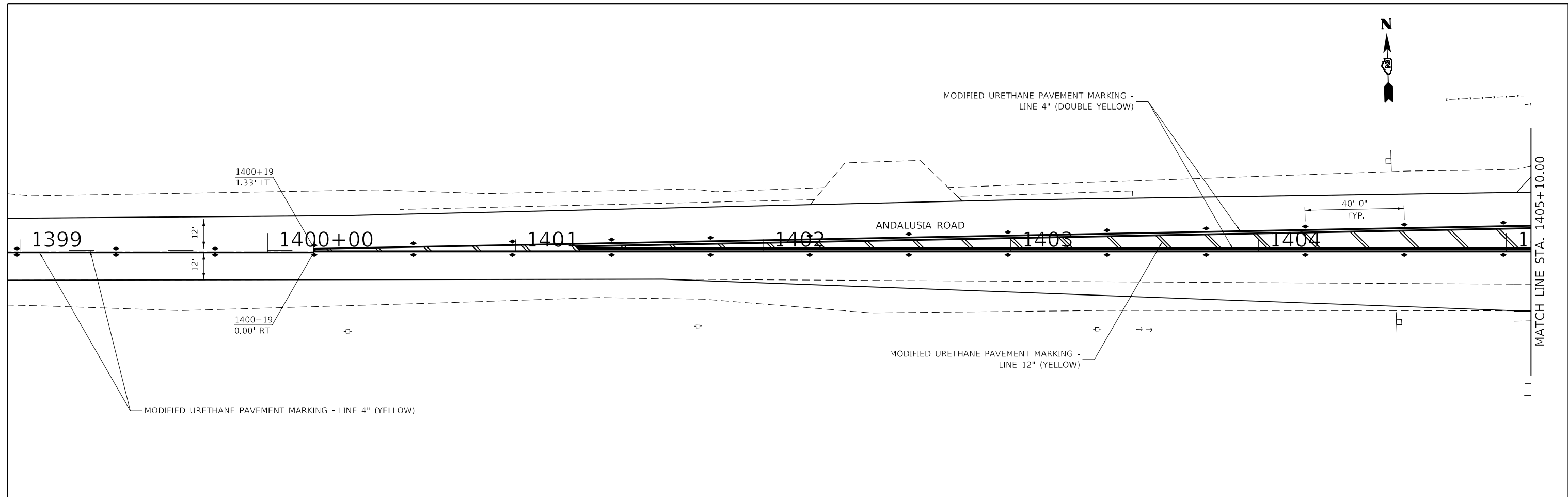

MODEL: Default
 FILE NAME: p:\work\64490000.dwg
 PROJECT: I:\Projects\64490000\Program Development\Studies & Plans\Design\CADD\CADDsheet102_644900.ctb
 USER: romerore

- ◆ TWO-WAY AMBER
- ◀ ONE-WAY AMBER
- ◁ ONE-WAY CRYSTAL

USER NAME = romerore	DESIGNED -	REVISED -	
	DRAWN -	REVISED -	
PLOT SCALE = 40,0000 * / in.	CHECKED -	REVISED -	
PLOT DATE = Apr-28-2021 01:02:57 PM	DATE -	REVISED -	

STATE OF ILLINOIS
 DEPARTMENT OF TRANSPORTATION

IL ROUTE 92 AND ANDALUSIA ROAD
 PAVEMENT MARKING DETAILS

F.A.P. RTE.	SECTION	COUNTY	TOTAL SHEETS	SHEET NO.
599	(48MFT, 62MFT)RS	ROCK ISLAND	45	26
CONTRACT NO. 64N91				
ILLINOIS FED. AID PROJECT				

SCALE: SHEET 1 OF 6 SHEETS STA. 1399+00 TO STA. 1405+10

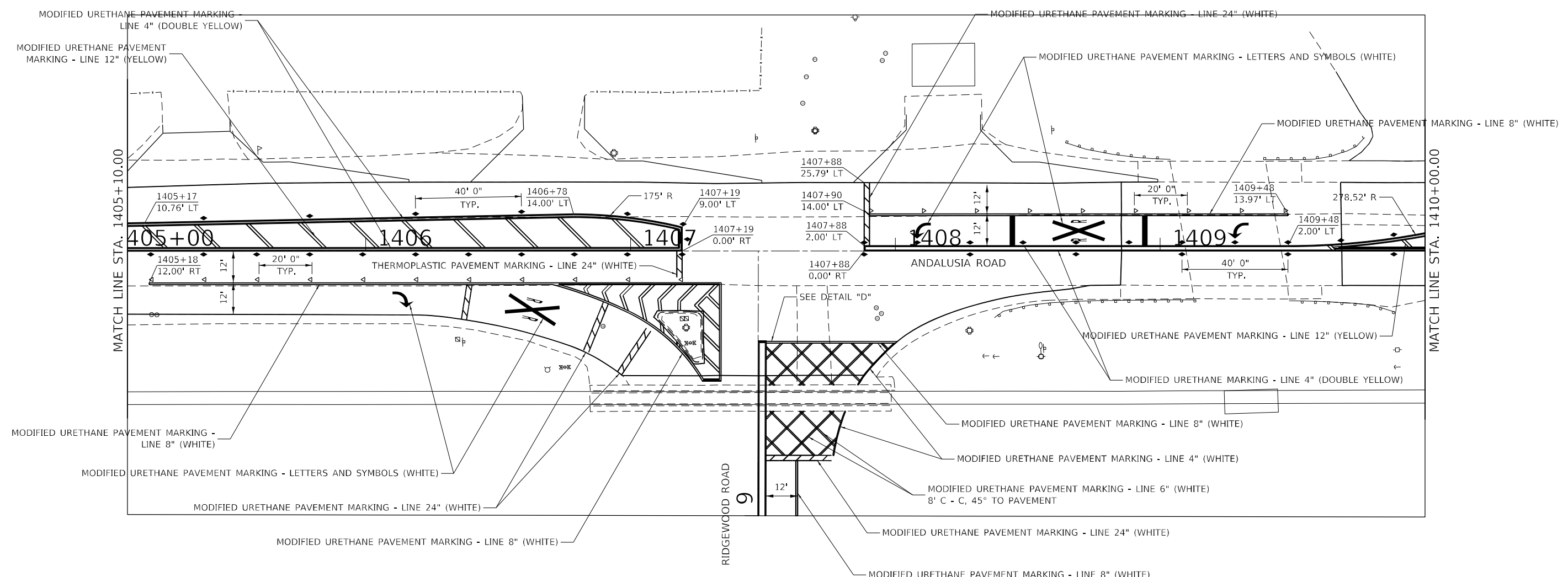

DETAIL D

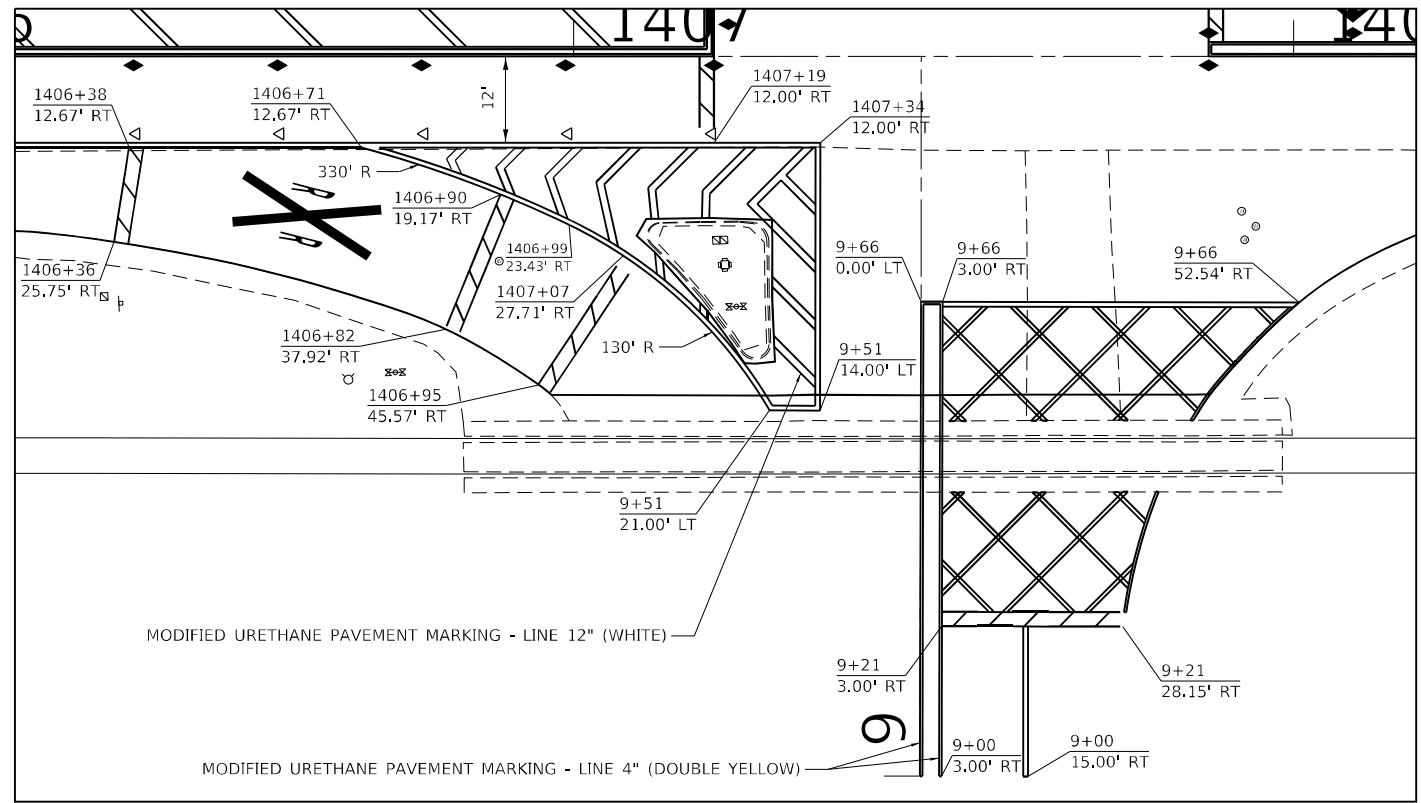

- ◆ TWO-WAY AMBER
- ◀ ONE-WAY AMBER
- ◁ ONE-WAY CRYSTAL

MODEL: Default
 FILE NAME: p:\pub\lhammon.dwg
 PROJECT: I:\Projects\616\191\Program Development\Studies & Plans\Design\CADD\CADDsheet102_64N91.ctb
 DATE: Apr-28-2021 01:03:08 PM

USER NAME = romerore	DESIGNED -	REVISED -
	DRAWN -	REVISED -
PLOT SCALE = 40,0000 * / in.	CHECKED -	REVISED -
PLOT DATE = Apr-28-2021 01:03:08 PM	DATE -	REVISED -

STATE OF ILLINOIS
DEPARTMENT OF TRANSPORTATION

IL ROUTE 92 AND ANDALUSIA ROAD
PAVEMENT MARKING DETAILS

SCALE: SHEET 2 OF 6 SHEETS STA. 1405+10 TO STA. 1410+00

F.A.P. RTE.	SECTION	COUNTY	TOTAL SHEETS	SHEET NO.
599	(48MFT, 62MFT)RS	ROCK ISLAND	45	27
CONTRACT NO. 64N91				
ILLINOIS FED. AID PROJECT				

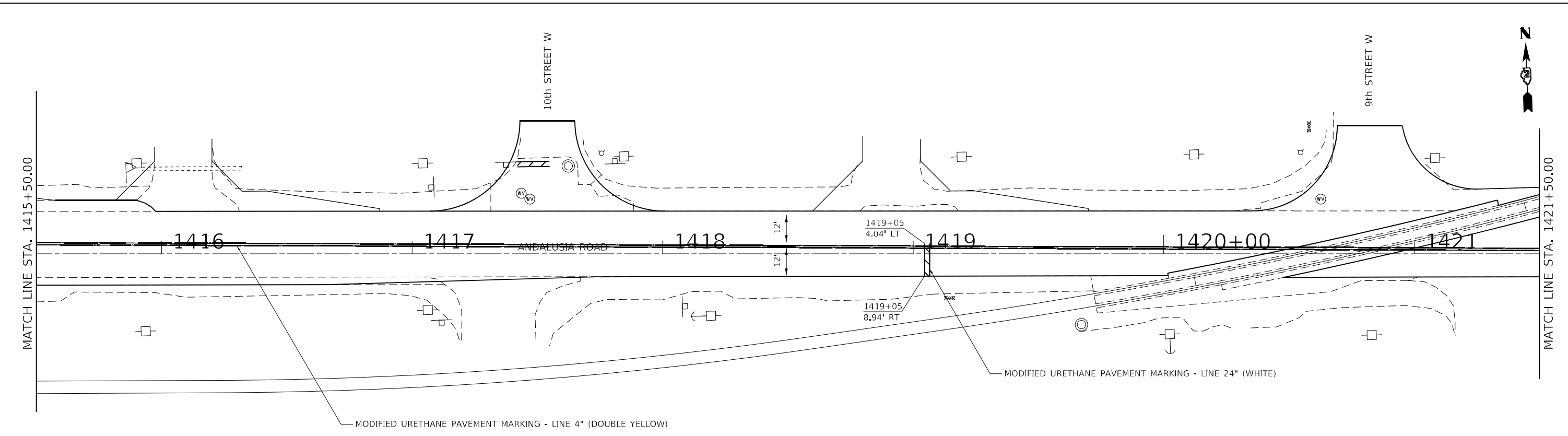
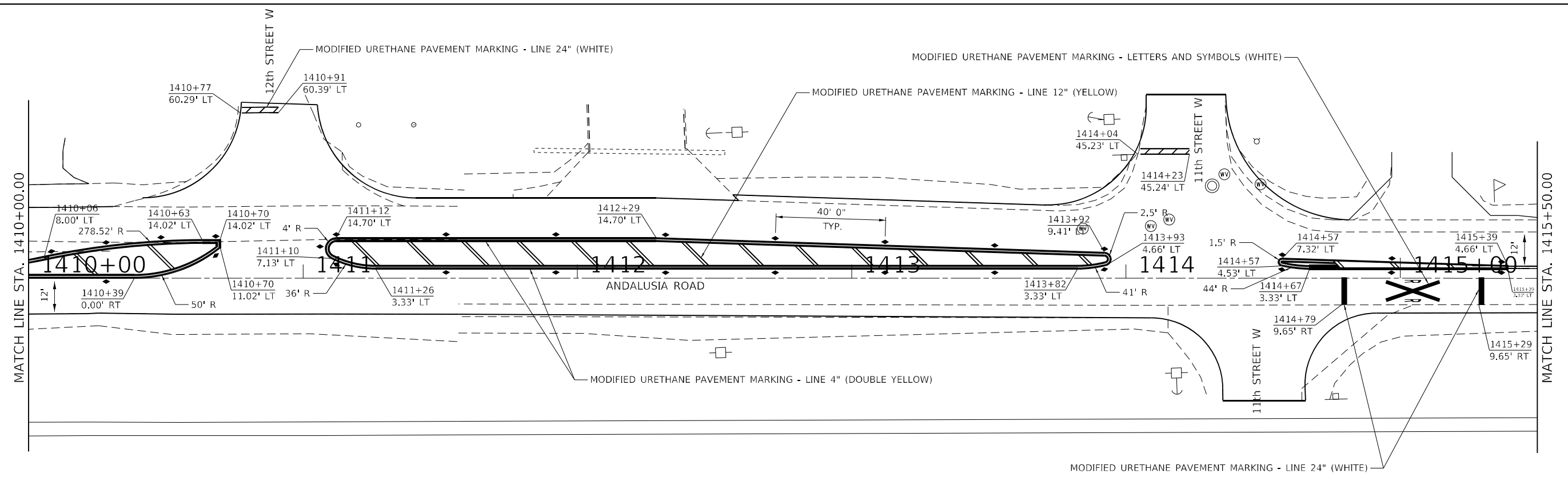

MODEL: Default
 FILE NAME: p:\data\baronon.dwg
 PROJECT: I:\Projects\649N91\Program_Development\Studies & Plans\Design\CADD\CADSheet\02_649N91_schpkm.dwg
 USER: romerore

USER NAME = romerore	DESIGNED -	REVISED -
DRAWN -	REVISOR -	REVISOR -
PLOT SCALE = 40,0000 * / in.	CHECKED -	REVISOR -
PLOT DATE = Apr-28-2021 01:03:35 PM	DATE -	REVISOR -

STATE OF ILLINOIS
DEPARTMENT OF TRANSPORTATION

IL ROUTE 92 AND ANDALUSIA ROAD
PAVEMENT MARKING DETAILS

SCALE: SHEET 3 OF 6 SHEETS STA. 1410+00 TO STA. 1421+50

F.A.P. RTE.	SECTION	COUNTY	TOTAL SHEETS	SHEET NO.
599	(48MFT, 62MFT)RS	ROCK ISLAND	45	28
CONTRACT NO. 64N91				
ILLINOIS FED. AID PROJECT				

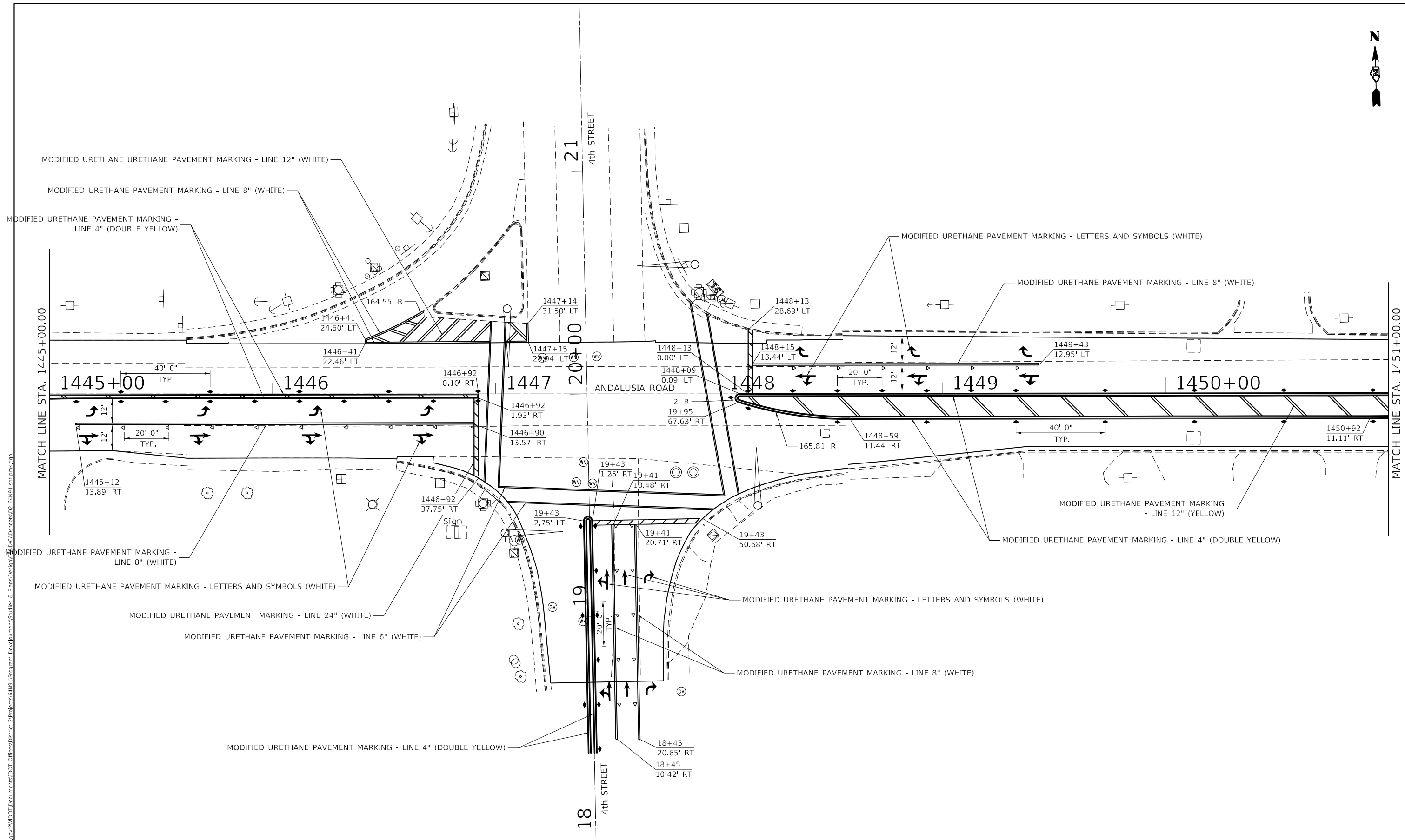

MODEL: D:\p1\...
 FILE NAME: p1\...
 PROJECT: ...
 DATE: ...

- ◆ TWO-WAY AMBER
- ◀ ONE-WAY AMBER
- ◁ ONE-WAY CRYSTAL

USER NAME = romerore	DESIGNED -	REVISED -
	DRAWN -	REVISED -
PLOT SCALE = 40,0000 * / in.	CHECKED -	REVISED -
PLOT DATE = Apr-28-2021 01:04:02 PM	DATE -	REVISED -

STATE OF ILLINOIS
DEPARTMENT OF TRANSPORTATION

IL ROUTE 92 AND ANDALUSIA ROAD
PAVEMENT MARKING DETAILS

SCALE: SHEET 5 OF 6 SHEETS STA. 1445+00 TO STA. 1451+00

F.A.P. RTE.	SECTION	COUNTY	TOTAL SHEETS	SHEET NO.
599	(48MFT, 62MFT)RS	ROCK ISLAND	45	30
CONTRACT NO. 64N91				
ILLINOIS FED. AID PROJECT				

MODEL: Default
 FILE NAME: p:\projects\644901\Roadway\Drawings\644901\Roadway\Development\Studies & Plans\Design\CADD\CADDsheet\02_64491_sch-smk.dwg
 PROJECT: ILLINOIS STATE ROADWAY PROJECTS
 OFFICE: DISTRICT 2 PROJECTS
 DATE: 4/28/2021 01:04:21 PM

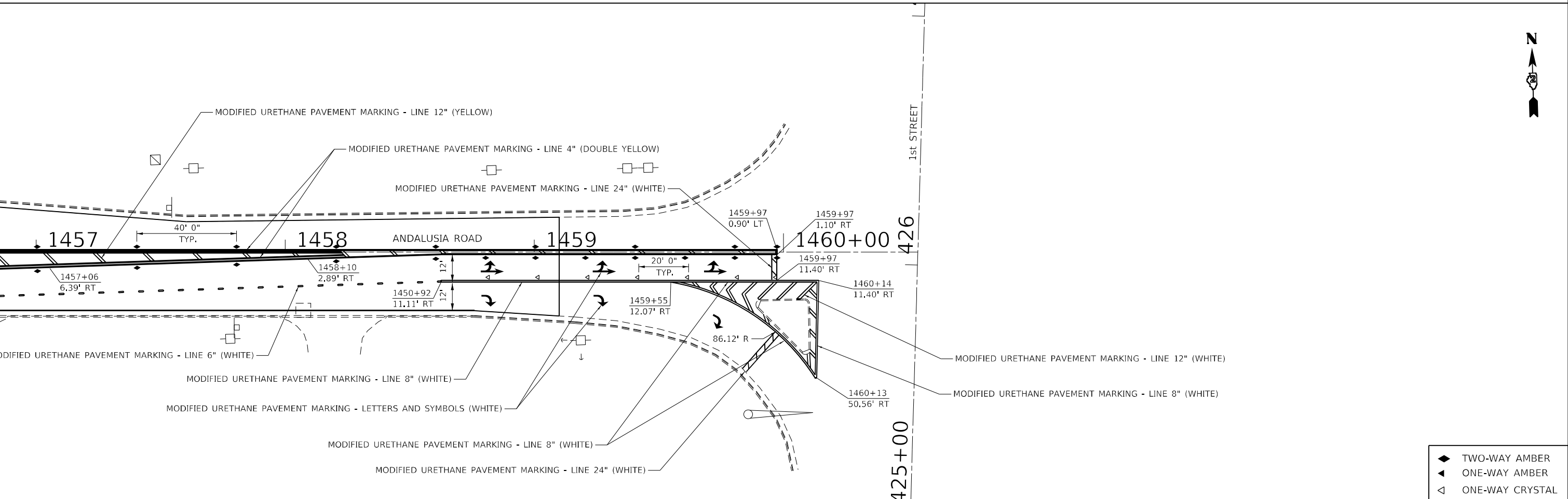
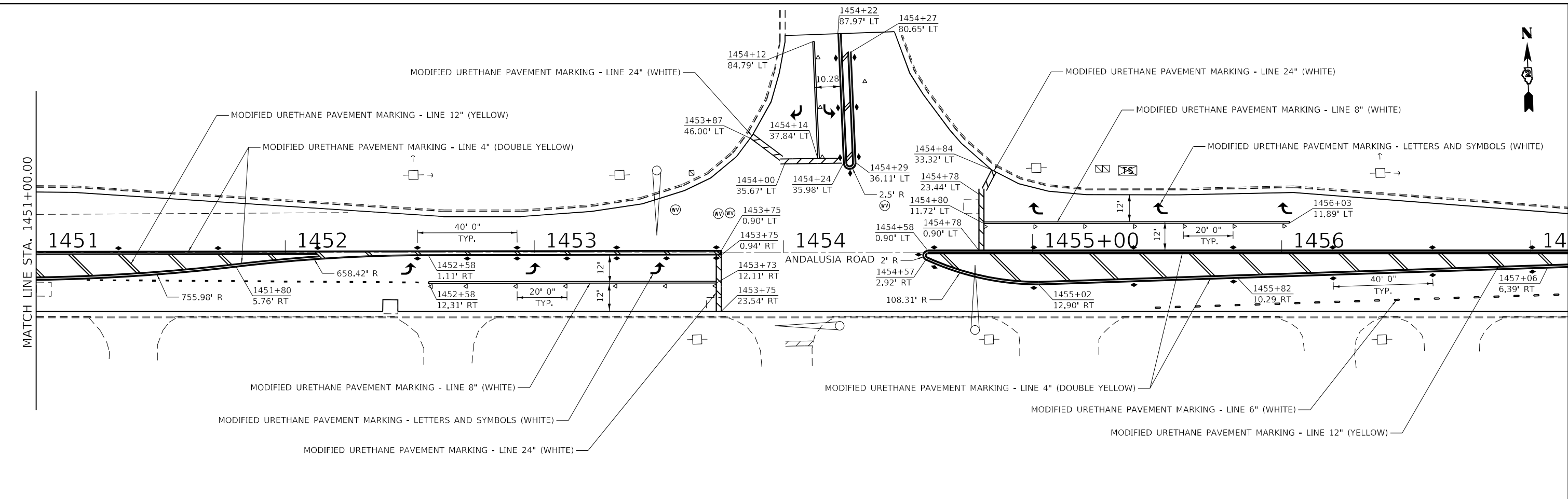

- ◀ TWO-WAY AMBER
- ◀ ONE-WAY AMBER
- ◀ ONE-WAY CRYSTAL

USER NAME = romerore	DESIGNED -	REVISED -
	DRAWN -	REVISED -
PLOT SCALE = 40,0000 * / in.	CHECKED -	REVISED -
PLOT DATE = Apr-28-2021 01:04:21 PM	DATE -	REVISED -

STATE OF ILLINOIS
DEPARTMENT OF TRANSPORTATION

IL ROUTE 92 AND ANDALUSIA ROAD
PAVEMENT MARKING DETAILS

SCALE: SHEET 6 OF 6 SHEETS STA. 1451+00 TO STA. 1460+50

F.A.P. RTE.	SECTION	COUNTY	TOTAL SHEETS	SHEET NO.
599	(48MFT, 62MFT)RS	ROCK ISLAND	45	31
CONTRACT NO. 64N91				
ILLINOIS FED. AID PROJECT				



MATCH LINE STA. 1330+00.00

MATCH LINE STA. 1345+00.00

1330+00 1331 1332 1333 1334 1335+00 1336 1337 1338 1339 1340+00 1341 1342 1343 1344

ANDALUSIA ROAD

31st STREET W



STA. 1333+89
EASTBOUND
W8-8 AND W7-3AP

REMOVE ROUGH ROAD SIGN AND NEXT 1.5 MILE SIGN
SIGN PANEL REMOVAL - 9 SF + 5 SF = 14 SF



STA. 1336+53
EASTBOUND
W10-3R AND W17-I100

REMOVE AND REPLACE SIGN
SIGN PANEL TYPE I - 9 SF + 2.25 SF = 11.25 SF
SIGN PANEL REMOVAL - 9 SF + 2.25 SF = 11.25 SF



MATCH LINE STA. 1345+00.00

MATCH LINE STA. 1360+00.00

1345+00 1346 1347 1348 1349 1350+00 1351 1352 1353 1354 1355+00 1356 1357 1358 1359

ANDALUSIA ROAD

29TH STREET W



STA. 1347+62
WESTBOUND
W10-3L AND W17-I100

REMOVE AND REPLACE SIGN
SIGN PANEL TYPE I - 9 SF + 2.25 SF = 11.25 SF
SIGN PANEL REMOVAL - 9 SF + 2.25 SF = 11.25 SF



STA. 1355+01
EASTBOUND (WB LANE PLACEMENT)
W14-3

REMOVE AND REPLACE SIGN
SIGN PANEL TYPE II - 10.67 SF
SIGN PANEL REMOVAL - 10.67 SF

MODEL: Default
FILE NAME: p:\work\64991\64991\DOT Documents\DOT Office\Drawings\64991\Program Development\Studies & Plans\Design\CADD\CAD\Sheet\02_64991_sch_Sign_details.dwg

USER NAME = romerore	DESIGNED -	REVISED -
DRAWN -	REVISED -	
PLOT SCALE = 100,0000' / in.	CHECKED -	REVISED -
PLOT DATE = Apr-27-2021 09:12:45 AM	DATE -	REVISED -

STATE OF ILLINOIS
DEPARTMENT OF TRANSPORTATION

SIGN DETAILS

SCALE: SHEET 1 OF 4 SHEETS STA. 1330+00 TO STA. 1360+00

F.A.P. RTE.	SECTION	COUNTY	TOTAL SHEETS	SHEET NO.
599	(48MFT, 62MFT)RS	ROCK ISLAND	45	33
CONTRACT NO. 64N91				
ILLINOIS FED. AID PROJECT				



MATCH LINE STA. 1390+00.00

MATCH LINE STA. 1405+00.00

1390+00 1391 1392 1393 1394 1395+00 1396 1397 1398 1399 1400+00 1401 1402 1403 1404

ANDALUSIA ROAD

MATCH LINE STA. 1405+00.00

MATCH LINE STA. 1420+00.00

1405+00 1406 1407 1408 1409 1410+00 1411 1412 1413 1414 1415+00 1416 1417 1418 1419

ANDALUSIA ROAD

RIDGEWOOD ROAD

12th STREET W

11th STREET W

10th STREET W



STA. 1414+15
SB 11TH ST
R1-1

REMOVE AND REPLACE SIGN
SIGN PANEL TYPE 1 - 9 SF
SIGN PANEL REMOVAL - 6.25 SF
TELESCOPING SIGN SUPPORT - 14 FT



MODEL: Default
FILE NAME: p:\work\64991\64991\DOT Documents\DOT Office\Drawings\Projects\64991\Program Development\Studies & Plans\Design\CADD\CADD\Sheet\02_64991_sch_Sign_details.dwg

USER NAME = romerore	DESIGNED -	REVISED -
DRAWN -	REVISED -	
PLOT SCALE = 100,0000' / in.	CHECKED -	REVISED -
PLOT DATE = Apr-27-2021 09:12:59 AM	DATE -	REVISED -

STATE OF ILLINOIS
DEPARTMENT OF TRANSPORTATION

SIGN DETAILS

SCALE: SHEET 2 OF 4 SHEETS STA. 1390+00 TO STA. 1420+00

F.A.P. RTE.	SECTION	COUNTY	TOTAL SHEETS	SHEET NO.
599	(48MFT, 62MFT)RS	ROCK ISLAND	45	34
CONTRACT NO. 64N91				
ILLINOIS FED. AID PROJECT				

MODEL Path: \\lanonm.dot.illinois.gov\PI\DOT\Documents\IDOT_Offices\District_2\Projects\64N91\Program_Development\Studies & Plans\Design\CADD\CAD\Sheet\02_64N91_sht_Sign_details.dwg
 FILE NAME: \\lanonm.dot.illinois.gov\PI\DOT\Documents\IDOT_Offices\District_2\Projects\64N91\Program_Development\Studies & Plans\Design\CADD\CAD\Sheet\02_64N91_sht_Sign_details.dwg

MATCH LINE STA. 1450+00.00

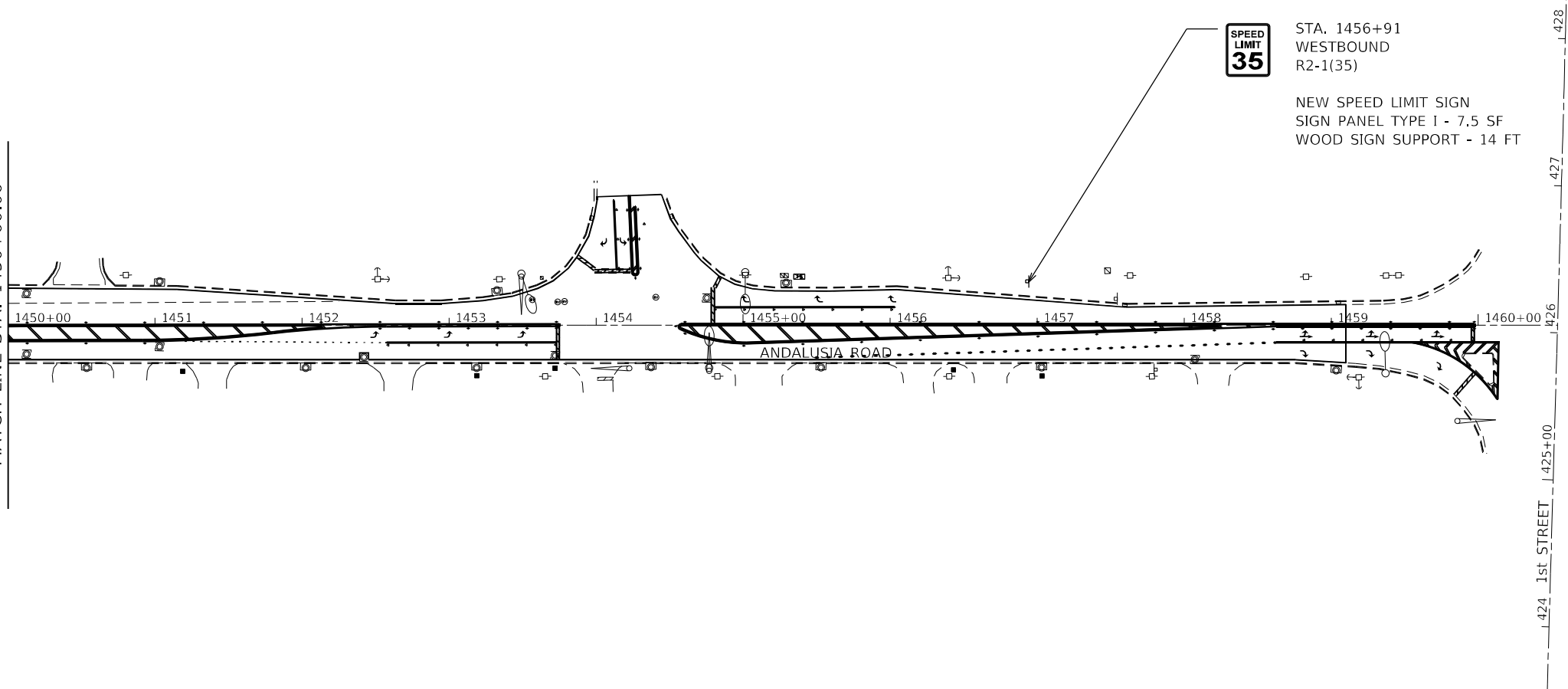

**SPEED
LIMIT
35**

STA. 1456+91
WESTBOUND
R2-1(35)

NEW SPEED LIMIT SIGN
SIGN PANEL TYPE 1 - 7.5 SF
WOOD SIGN SUPPORT - 14 FT

428
427
426
425+00
1st STREET



MATCH LINE STA. 1460+53.94 Ext. 446.06

USER NAME = romerore	DESIGNED -	REVISED -
	DRAWN -	REVISED -
PLOT SCALE = 100,0000' / in.	CHECKED -	REVISED -
PLOT DATE = Apr-27-2021 09:13:41 AM	DATE -	REVISED -

**STATE OF ILLINOIS
DEPARTMENT OF TRANSPORTATION**

SIGN DETAILS

SCALE: SHEET 4 OF 4 SHEETS STA. 1450+00 TO STA. 1460+53.94

F.A.P. RTE.	SECTION	COUNTY	TOTAL SHEETS	SHEET NO.
599	(48MFT, 62MFT)RS	ROCK ISLAND	45	36
CONTRACT NO. 64N91				
ILLINOIS FED. AID PROJECT				

PERMANENT SURVEY MARKERS, TYPE II

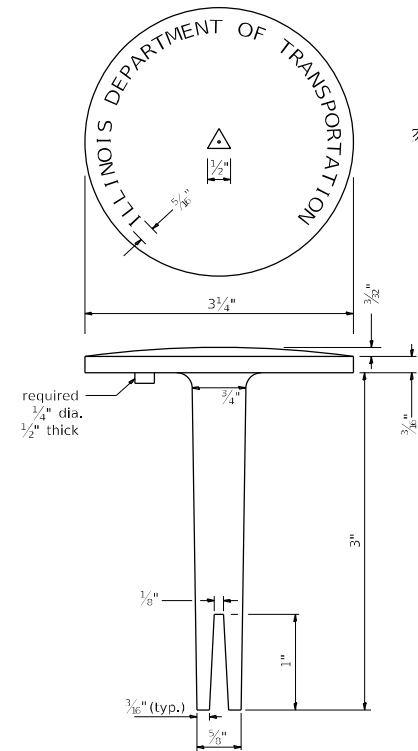

BRASS OR ALUMINUM TABLET

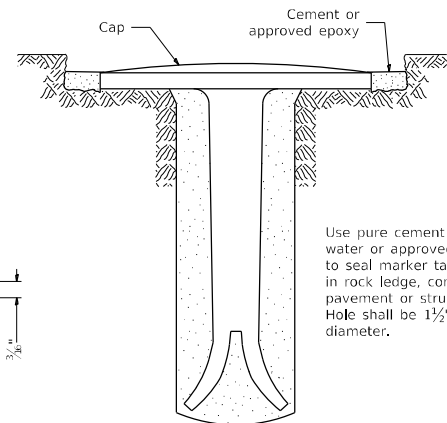

Tablet constructed in rock ledge or concrete.

TYPE II

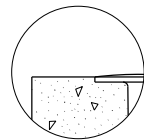

DETAIL A

Use pure cement and water or approved epoxy to seal marker tablet in rock ledge, concrete pavement or structure. Hole shall be 1 1/2" diameter.

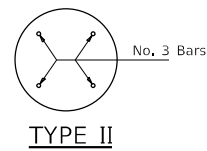
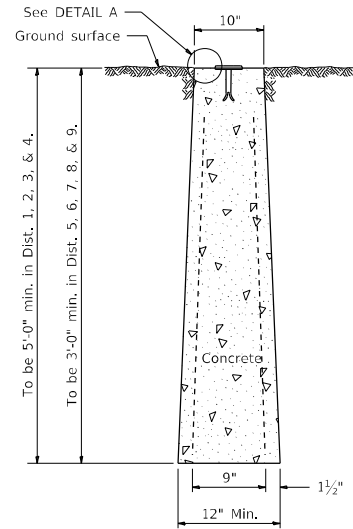

CAST-IN-PLACE MARKER

ALL DIMENSIONS ARE IN INCHES UNLESS OTHERWISE NOTED.

WITNESS MARKER FOR PERMANENT SURVEY MARKERS, TYPE II

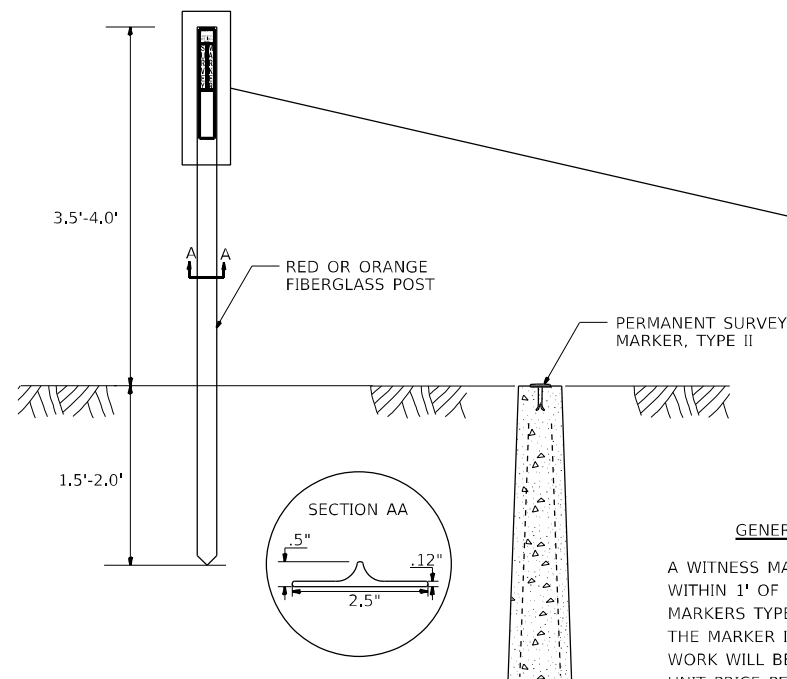

GENERAL NOTES

A WITNESS MARKER SHALL BE INSTALLED WITHIN 1' OF ALL PERMANENT SURVEY MARKERS TYPE II EXCEPT IN AREAS WHERE THE MARKER IS IN THE SIDEWALK. THIS WORK WILL BE INCLUDED TO THE CONTRACT UNIT PRICE PER EACH FOR PERMANENT SURVEY MARKERS, TYPE II.

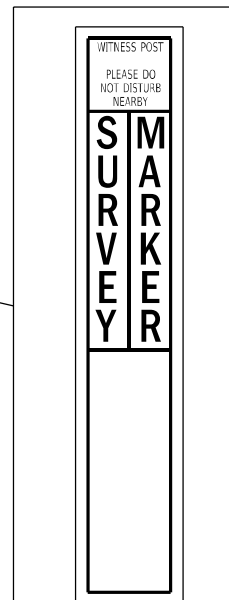

REVISED - 6-27-14
REVISED - 10-14-11

FILE NAME: p:\work\projects\6491\Program Development\Studies & Plans\Design\CADD\CADDsheets\02_6491-sh-detailed.dgn
PLOT DATE: 2/22/2021 9:22:30 AM

REVISED -	REGION 2 / DISTRICT 2 STANDARD SCALE: 1" = 50' SHEET 1 OF 1 SHEETS STA. TO STA.	F.A.P. RTE.	SECTION	COUNTY	TOTAL SHEETS	SHEET NO.	
REVISED -		599	(48MFT,62MFT)RS	Rock Island	45	38	
REVISED -						CONTRACT NO. 64N91	
REVISED -						ILLINOIS FED. AID PROJECT	

WORK ZONE SIGN DETAILS

ILLINOIS STANDARD G20-I100

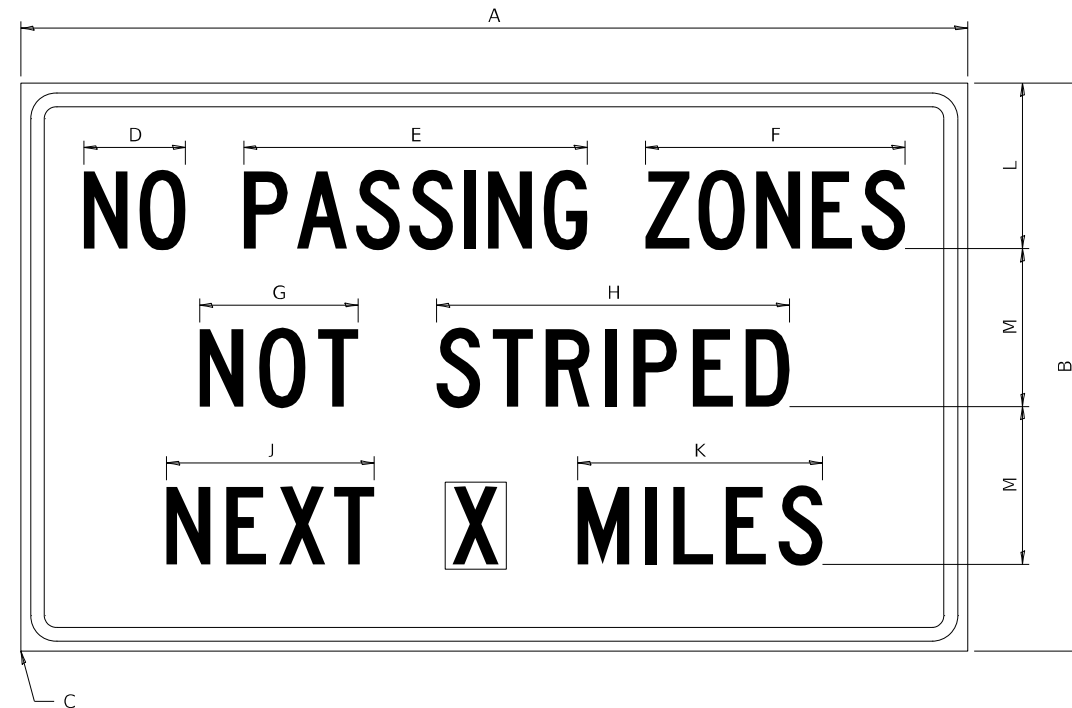

COLOR LEGEND AND BORDER BLACK NON-REFLECTORIZED
 BACKGROUND ORANGE REFLECTORIZED

SIGN SIZE	DIMENSIONS											
	A	B	C	D	E	F	G	H	J	K	L	M
60 x 36	60.00	36.00	2.25	6.4	21.80	16.40	10.00	22.40	13.20	15.50	10.50	10.00

SIGN SIZE	SERIES BY LINE			MARGIN	BORDER
	1	2	3		
60 x 36	5C	5C	5C	0.625	0.875

Sign not to scale

ILLINOIS STANDARD W8-I107

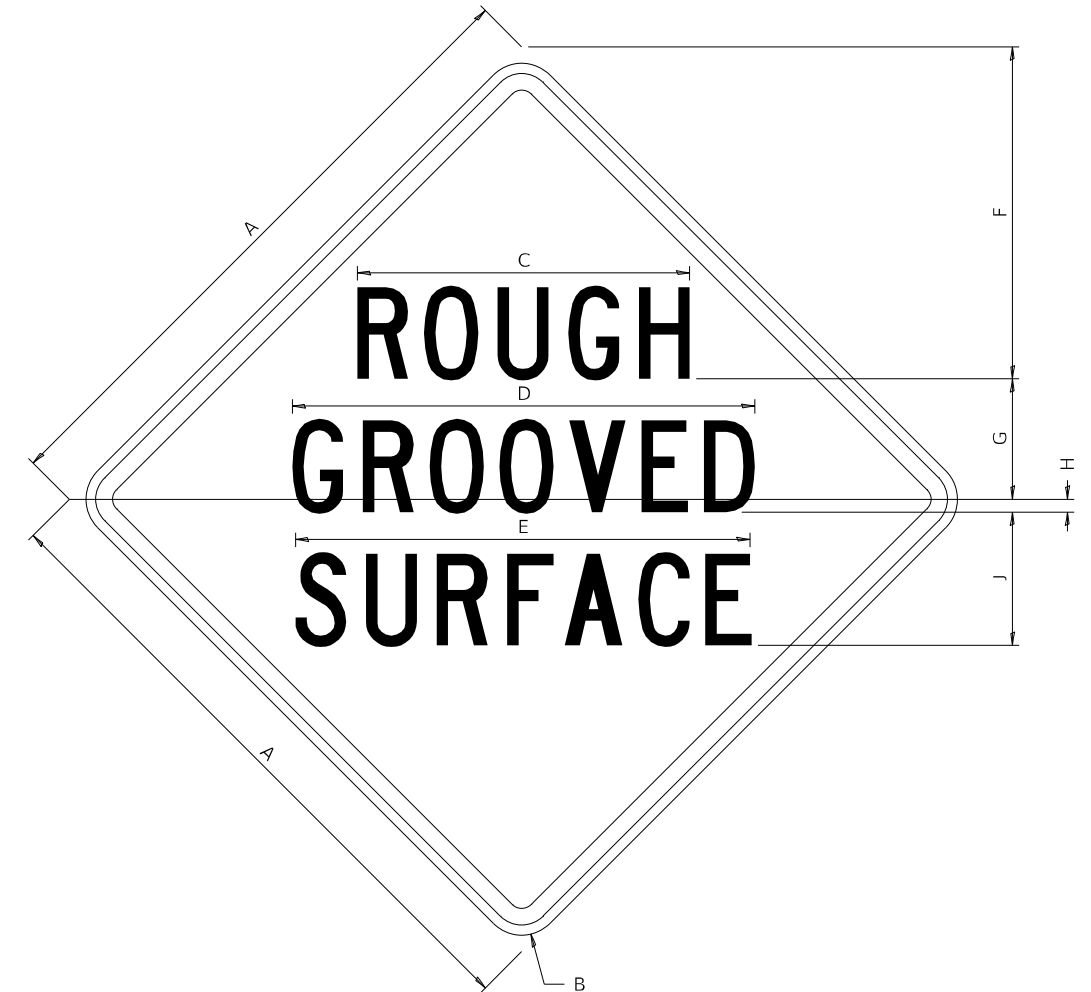

COLOR LEGEND AND BORDER BLACK NON-REFLECTORIZED
 BACKGROUND ORANGE REFLECTORIZED

SIGN SIZE	DIMENSIONS								
	A	B	C	D	E	F	G	H	J
48 x 48	48.00	3.00	25.00	34.80	34.20	24.94	9.00	1.00	10.00

SIGN SIZE	SERIES BY LINE			MARGIN	BORDER
	1	2	3		
48 x 48	7C	7C	7C	1.250	0.750

Sign not to scale

GENERAL NOTES

All work to furnish and install these signs shall be included in the cost of the specified traffic control standards and shall not be paid separately.

All Illinois Standard signs shall conform to the latest edition of the "Illinois Standard Highway Signs Book" in effect on the date of invitation for bids.

Signs shall meet the applicable portions of Sections 701 and 720 of the Standard Specifications.

All dimensions are in inches unless otherwise noted.

FILE NAME: p:\planroom\dot\illinois.gov\PWIDOT	USER NAME = romerore	DESIGNED -	REVISED - 3-02-16	STATE OF ILLINOIS DEPARTMENT OF TRANSPORTATION	REGION 2 / DISTRICT 2 STANDARD	F.A.P. RTE.	SECTION	COUNTY	TOTAL SHEETS	SHEET NO.
	Documents\DOT Offices\District 2\Projects\64N91\Program\Drawings\Studies & Plans\Design\CADD\CAD\64N91-sht-details.dgn	DRAWN	REVISED			599	(48MFT,62MFT)RS	Rock Island	45	39
	PLOT SCALE = 100,0000' / in.	CHECKED -	REVISED -			CONTRACT NO. 64N91				
	PLOT DATE = Apr-27-2021 09:22:32 AM	DATE -	REVISED -	SCALE: 1" = 50'	SHEET 1 OF 4 SHEETS	STA. TO STA.	ILLINOIS FED. AID PROJECT			

WORK ZONE SIGN DETAILS

ILLINOIS STANDARD W12-I102

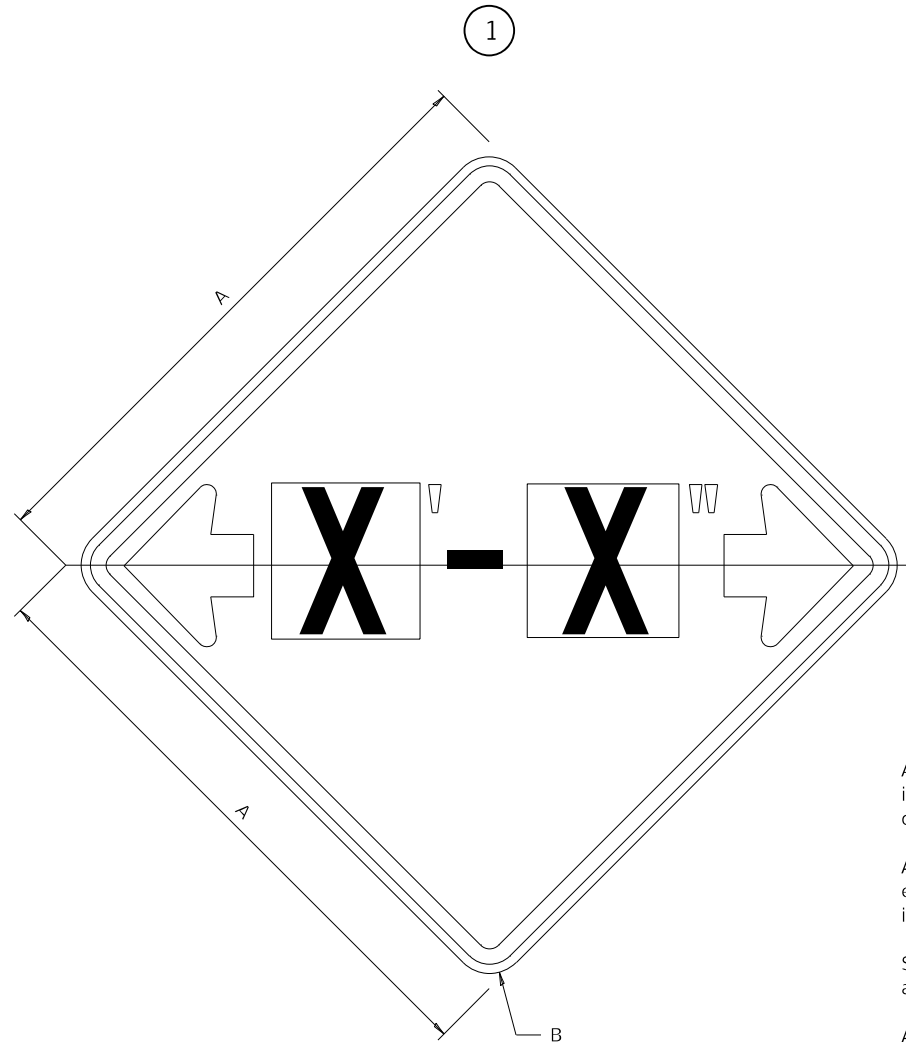

GENERAL NOTES

All work to furnish and install these signs shall be included in the cost of the specified traffic control standards and shall not be paid separately.

All Illinois Standard signs shall conform to the latest edition of the "Illinois Standard Highway Signs Book" in effect on the date of invitation for bids.

Signs shall meet the applicable portions of Sections 701 and 720 of the Standard Specifications.

All dimensions are in inches unless otherwise noted.

COLOR LEGEND AND BORDER BLACK NON-REFLECTORIZED
 BACKGROUND FL ORANGE REFLECTORIZED

SIGN SIZE	DIMENSIONS	
	A	B
48 x 48	48.00	3.00

① Illinois Standard signs W12-I102 and W12-I103 shall be used as described in the special provisions.

SIGN SIZE	SERIES BY LINE	MARGIN	BORDER
	1		
48 x 48	12C	0.750	1.250

Sign not to scale

ILLINOIS STANDARD W12-I103

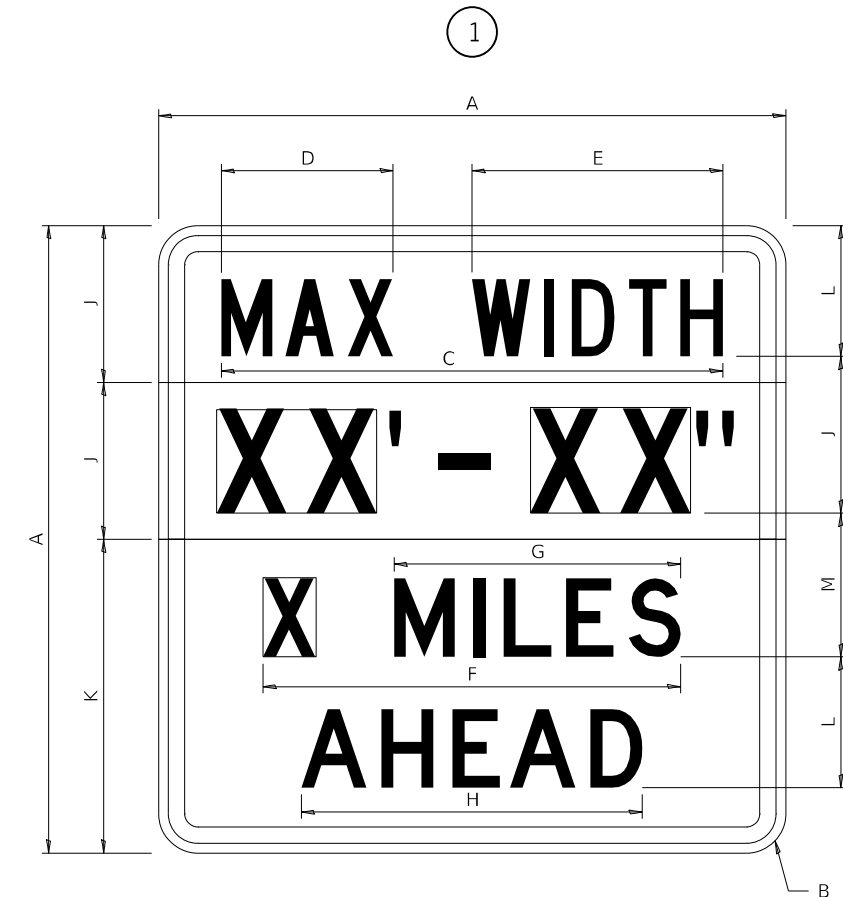

COLOR LEGEND AND BORDER BLACK NON-REFLECTORIZED
 BACKGROUND BACKGROUND (WIDTH) WHITE REFLECTORIZED
 FL ORANGE REFLECTORIZED

SIGN SIZE	DIMENSIONS											
	A	B	C	D	E	F	G	H	J	K	L	M
48 x 48	48.00	3.00	38.40	13.20	19.20	32.00	22.00	26.20	12.00	24.00	10.00	11.00

SIGN SIZE	SERIES BY LINE				MARGIN	BORDER
	1	2	3	4		
48 x 48	6C	8D	6D	6D	0.750	1.250

Sign not to scale

XX'-XX" WIDTH AND X MILES ARE VARIABLE TOP AND BOTTOM OF BACKGROUND WHITE

FILE NAME: pwc\planroom\dot.illinois.gov\PWIDOT	USER NAME = romerore	DESIGNED -	REVISED - 3-02-16	STATE OF ILLINOIS DEPARTMENT OF TRANSPORTATION	REGION 2 / DISTRICT 2 STANDARD				F.A.P. RTE. 599	SECTION (48MFT,62MFT)RS	COUNTY Rock Island	TOTAL SHEETS 45	SHEET NO. 40
	Documents\DOT Offices\District 2\Projects\64N91\Program\Drawings\Studies & Plans\Design\CADD\CAD\64N91-shi-details.dgn	DRAWN	REVISED		SCALE: 1" = 50'	SHEET 2	OF 4	SHEETS	STA.	TO STA.	ILLINOIS FED. AID PROJECT CONTRACT NO. 64N91		
	PLOT SCALE = 100,0000 ' / in.	CHECKED -	REVISED -		WORK ZONE SIGN DETAILS SHEET 2 OF 4 34.1								

WORK ZONE SIGN DETAILS

ROAD CLOSED TO OVERSIZED LOADS



STOP LINE SIGN FOR TEMPORARY SIGNALS

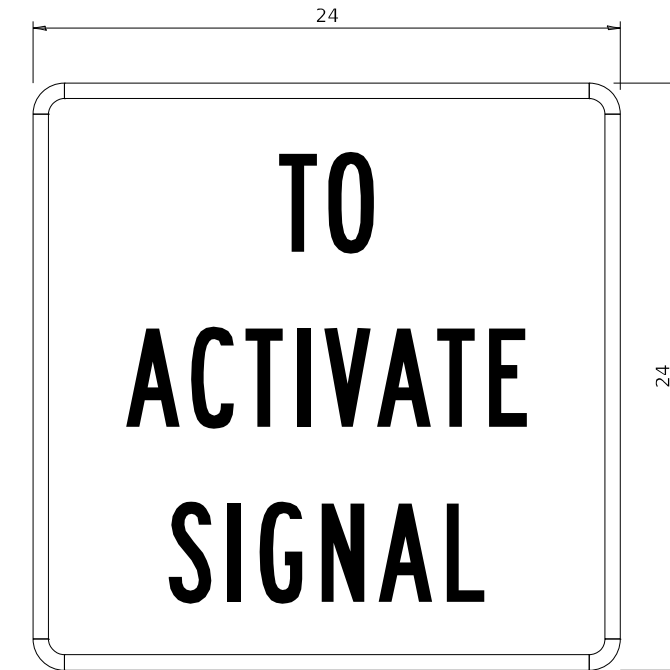

COLOR	LEGEND AND BORDER BACKGROUND	BLACK ORANGE	NON-REFLECTORIZED REFLECTORIZED
-------	------------------------------	--------------	---------------------------------

Permit Loads - Loads Over 13 Feet; 3.0" Radius, 1.3" Border;
 [NO OVERSIZE -] D; [OVERWEIGHT LOADS] D 85% spacing; [XX MILES AHEAD] D;
 Table of letter and object lefts.

N	O	O	V	E	R	S	I	Z	E	-
11.7	18.1	30.0	36.2	42.8	48.4	54.4	60.7	63.5	69.5	80.8

O	V	E	R	W	E	I	G	H	T	L	O	A	D	S
2.6	8.6	15.0	20.4	26.2	33.4	38.8	41.3	47.4	53.2	64.5	69.9	75.9	82.9	88.7

X	X	M	I	L	E	S	A	H	E	A	D
7.6	13.6	25.3	32.3	35.1	40.6	46.2	57.9	65.1	71.4	76.6	83.7

Sign not to scale

COLOR	LEGEND AND BORDER BACKGROUND	BLACK WHITE	NON-REFLECTORIZED REFLECTORIZED
-------	------------------------------	-------------	---------------------------------

SIGN SIZE	SERIES BY LINE		
	1	2	3
24 x 24	4C	4C	4C

Sign not to scale

GENERAL NOTES

All work to furnish and install these signs shall be included in the cost of the specified traffic control standards and shall not be paid separately.

All Illinois Standard signs shall conform to the latest edition of the "Illinois Standard Highway Signs Book" in effect on the date of invitation for bids.

Signs shall meet the applicable portions of Sections 701 and 720 of the Standard Specifications.

All dimensions are in inches unless otherwise noted.

FILE NAME: pwc\planroom\dot\illinois.gov\PWIDOT\Documents\DOT Offices\District 2\Projects\64N91\Program\Drawings\Studies & Plans\Design\CADD\CAD\64N91-sht-details.dgn	USER NAME = romerore	DESIGNED -	REVISED - 3-02-16	STATE OF ILLINOIS DEPARTMENT OF TRANSPORTATION	REGION 2 / DISTRICT 2 STANDARD	F.A.P. RTE.	SECTION	COUNTY	TOTAL SHEETS	SHEET NO.
	PLOT SCALE = 100,0000 ' / in.	CHECKED -	REVISED -			599	(48MFT,62MFT)RS	Rock Island	45	41
PLOT DATE = Apr-27-2021 09:23:01 AM	DATE -	REVISED -		SCALE: 1" = 50'	SHEET 3 OF 4 SHEETS	STA.	TO STA.	ILLINOIS FED. AID PROJECT CONTRACT NO. 64N91		

**ENTRANCE SIGN FOR USE
WITH TEMPORARY SIGNALS**

②

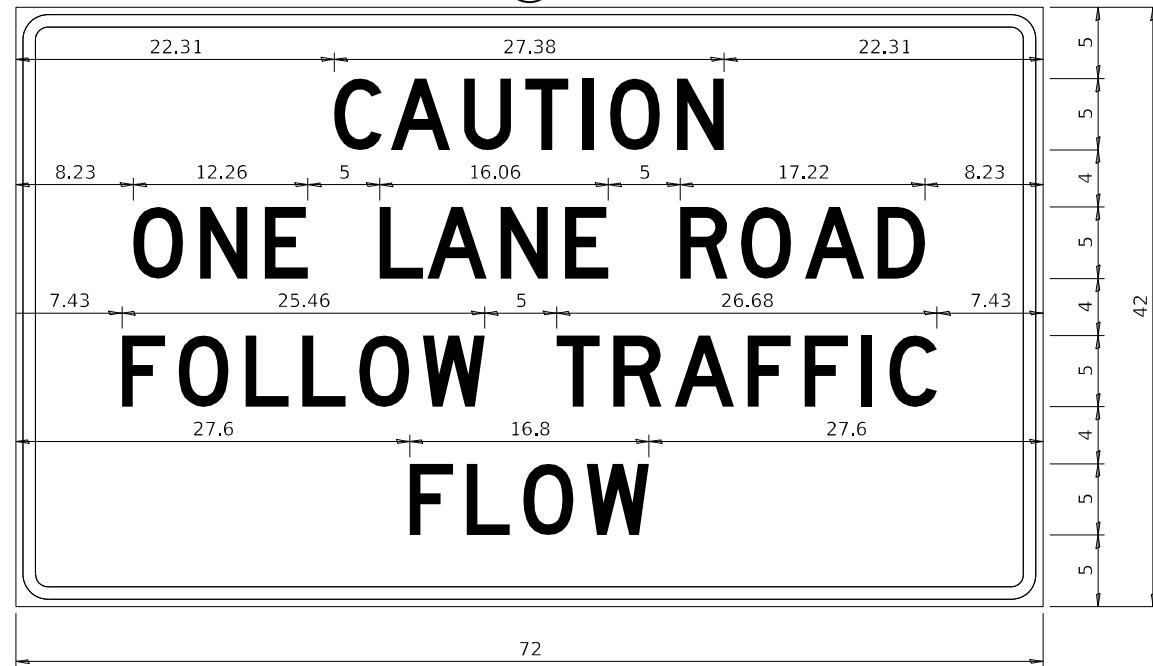

COLOR LEGEND AND BORDER BACKGROUND BLACK ORANGE NON-REFLECTORIZED REFLECTORIZED

2.25" Radius, 0.88" Border, 0.50" Indent;
[CAUTION] D; [ONE LANE ROAD] D;
[FOLLOW TRAFFIC] D; [FLOW] D

② This sign shall be installed at entrances located between the temporary signals as shown in the staging plans.

Table Of Widths And Spaces

22.31	C	3.36	0.62	A	4.18	0.94	U	3.36	0.94	T	3.04	0.94	I	0.78	1.17	O	3.52	1.17	N	3.36	22.31
-------	---	------	------	---	------	------	---	------	------	---	------	------	---	------	------	---	------	------	---	------	-------

8.23	O	3.51	1.17	N	3.36	1.18	E	3.04
------	---	------	------	---	------	------	---	------

5.00	L	3.05	0.31	A	4.18	0.94	N	3.36	1.17	E	3.05
------	---	------	------	---	------	------	---	------	------	---	------

5.00	R	3.36	0.93	O	3.52	0.94	A	4.18	0.93	D	3.36	8.23
------	---	------	------	---	------	------	---	------	------	---	------	------

7.43	F	3.04	0.94	O	3.52	1.17	L	3.04	0.94	L	3.05	0.94	O	3.51	0.94	W	4.37
------	---	------	------	---	------	------	---	------	------	---	------	------	---	------	------	---	------

5.00	T	3.05	0.94	R	3.36	0.94	A	4.18	0.93	F	3.05	0.94	F	3.04	0.94	I	0.78	1.18	C	3.35	7.43
------	---	------	------	---	------	------	---	------	------	---	------	------	---	------	------	---	------	------	---	------	------

27.60	F	3.05	0.94	L	3.04	0.94	O	3.52	0.93	W	4.38	27.60
-------	---	------	------	---	------	------	---	------	------	---	------	-------

Sign not to scale

WORK ZONE SIGN DETAILS

STAY IN YOUR LANE

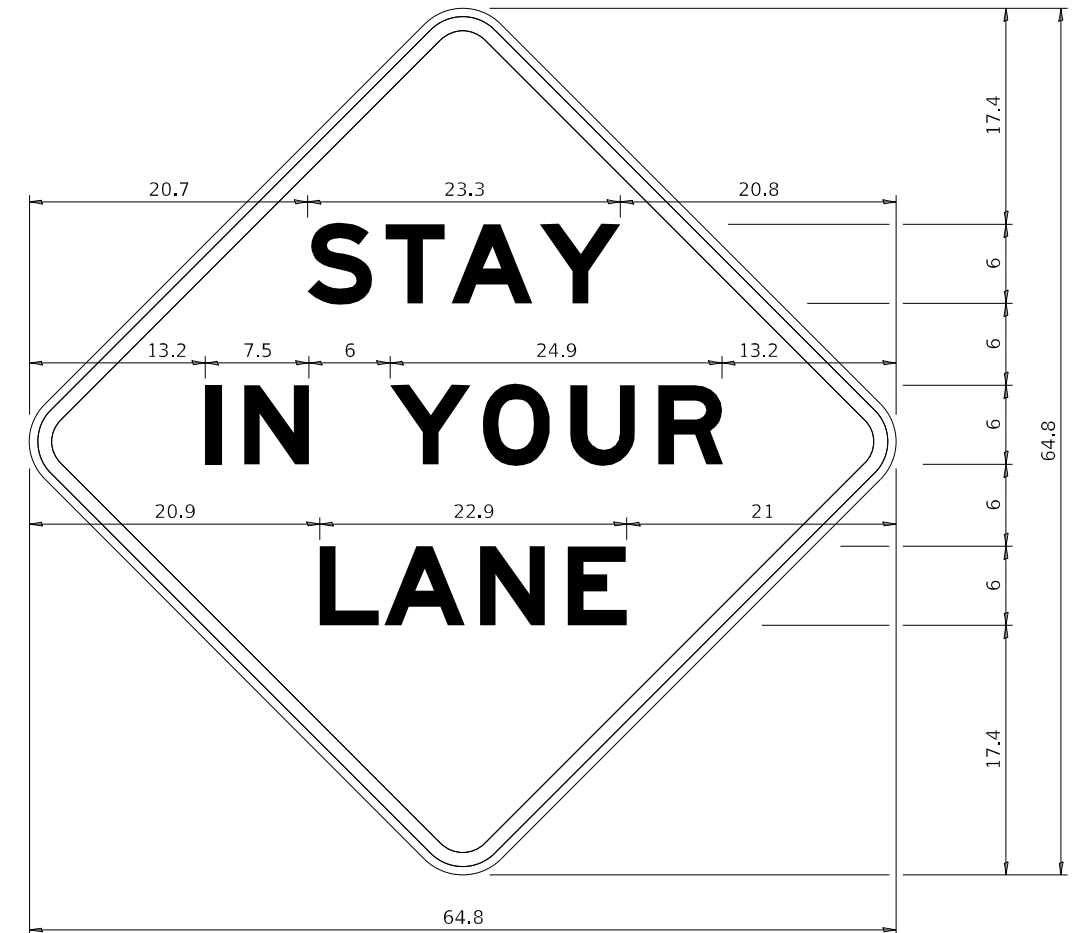

COLOR LEGEND AND BORDER BACKGROUND BLACK ORANGE NON-REFLECTORIZED REFLECTORIZED

48.0" across sides 3.8" Radius, 1.0" Border, 0.6" Indent;
"STAY" E Mod; "IN YOUR" E Mod; "LANE" E Mod;

Table of Letter and Object Lefts

S	T	A	Y
20.7	26.8	31.6	38.0

I	N	Y	O	U	R
13.2	15.9	26.7	33.9	40.5	46.8

L	A	N	E
20.9	25.8	33.1	39.4

Sign not to scale

GENERAL NOTES

All work to furnish and install these signs shall be included in the cost of the specified traffic control standards and shall not be paid separately.

All Illinois Standard signs shall conform to the latest edition of the "Illinois Standard Highway Signs Book" in effect on the date of invitation for bids.

Signs shall meet the applicable portions of Sections 701 and 720 of the Standard Specifications.

All dimensions are in inches unless otherwise noted.

USER NAME = romerore	DESIGNED -	REVISED - 3-02-16
FILE NAME: p:\planroom\dot\illinois.gov\PWIDOT Documents\DOT Offices\District 2\Projects\64N91\Program Development\Studies & Plans\Design\CADD\CAD\64N91-shi-details.dgn	DRAWN -	REVISED -
PLOT SCALE = 100,0000 ' / in.	CHECKED -	REVISED -
PLOT DATE = Apr-27-2021 09:23:45 AM	DATE -	REVISED -

**STATE OF ILLINOIS
DEPARTMENT OF TRANSPORTATION**

REGION 2 / DISTRICT 2 STANDARD

SCALE: 1" = 50' SHEET 4 OF 4 SHEETS STA. TO STA.

F.A.P. RTE.	SECTION	COUNTY	TOTAL SHEETS	SHEET NO.
599	(48MFT,62MFT)RS	Rock Island	45	42
CONTRACT NO. 64N91				
ILLINOIS FED. AID PROJECT				

TYPICAL PAVEMENT MARKINGS

TYPICAL PAVEMENT MARKING FOR FLUSH MEDIAN AT LEFT TURN LANE

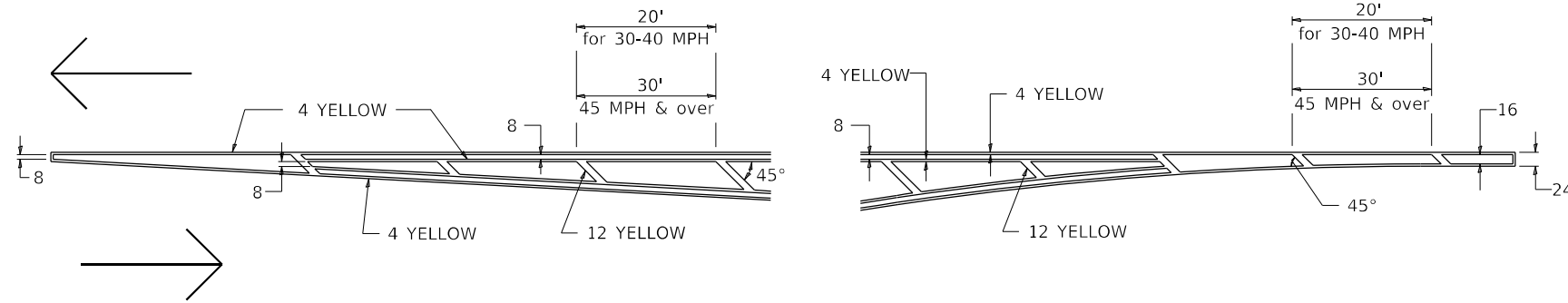

MEDIAN PAVEMENT MARKING

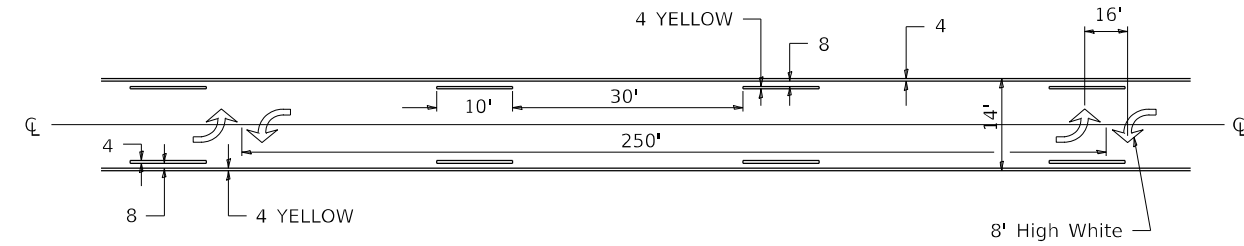

** ALL DIMENSIONS ARE IN INCHES UNLESS OTHERWISE NOTED.

TYPICAL ISLAND OFFSET SHOULDER WIDTH

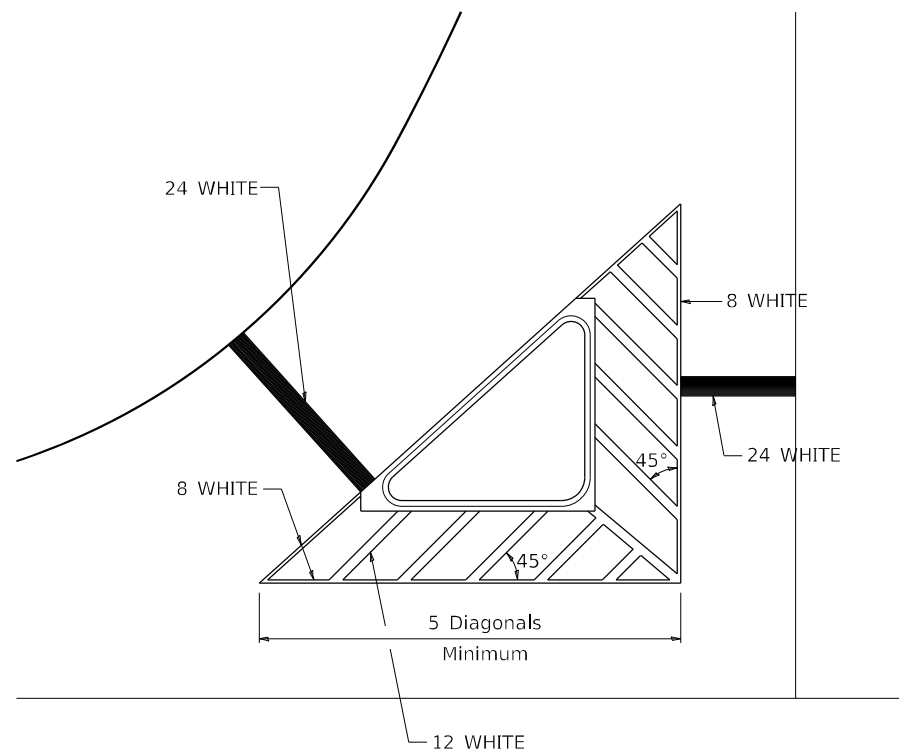

TYPICAL MARKING FOR PAINTED ISLANDS

NOTE:
* 45° TO LOCAL TAN.

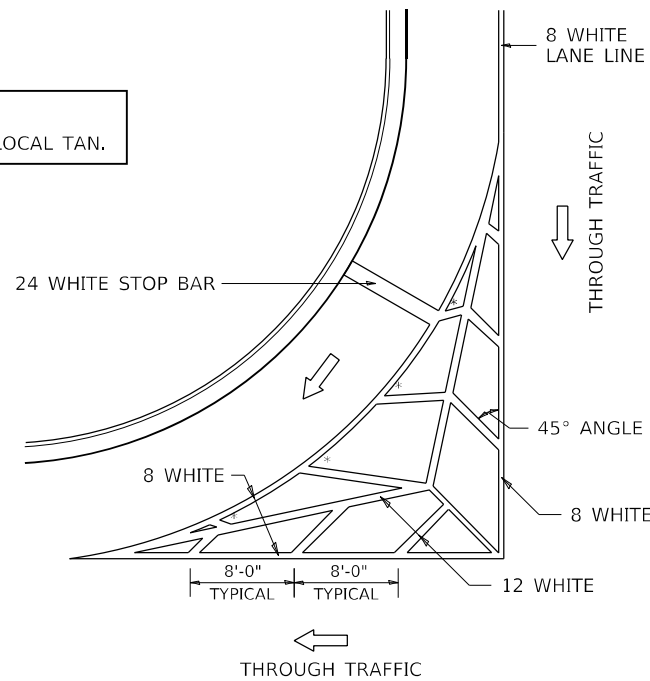

STANDARD CROSSWALK MARKING

See Schedules for Locations

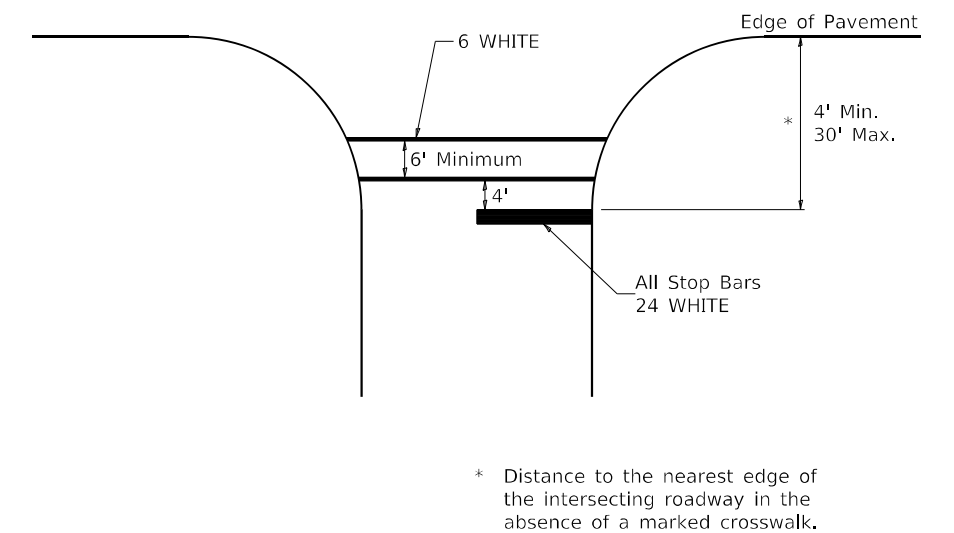

* Distance to the nearest edge of the intersecting roadway in the absence of a marked crosswalk.

FILE NAME: p:\planroom\dot\illinois.gov\PWIDOT	USER NAME = romerore	DESIGNED -	REVISED - 6-27-14	STATE OF ILLINOIS DEPARTMENT OF TRANSPORTATION	REGION 2 / DISTRICT 2 STANDARD			F.A.P. RTE.	SECTION	COUNTY	TOTAL SHEETS	SHEET NO.
	Documents\DOT Offices\District 2\Projects\64N91\Program Development\Studies & Plans\Design\CADD\CAD	DRAWN	REVISED - 6-27-14		599	(48MFT,62MFT)RS	Rock Island	45	43			
	PLOT SCALE = 100,0000 ' / in.	CHECKED -	REVISED -		SCALE: 1" = 50'			CONTRACT NO. 64N91				
	PLOT DATE = Apr-27-2021 09:23:56 AM	DATE -	REVISED -		SHEET 1 OF 3 SHEETS			ILLINOIS FED. AID PROJECT				

TYPICAL PAVEMENT MARKINGS

ARROW LAYOUT

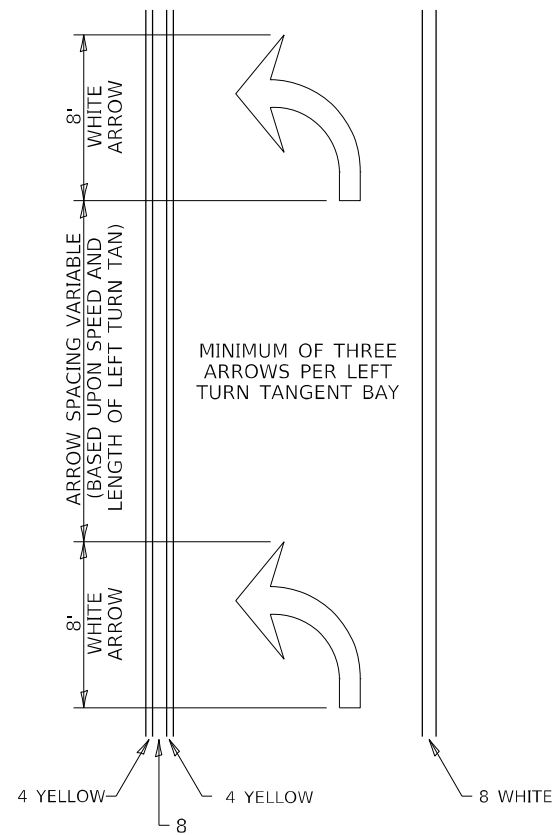

- ◁ ONE-WAY AMBER MARKER
- ◁ ONE-WAY CRYSTAL MARKER
- ◇ TWO-WAY AMBER MARKER

ALL DIMENSIONS ARE IN INCHES UNLESS OTHERWISE NOTED.

6 at 40' O.C. APPROACH SIDE ONLY

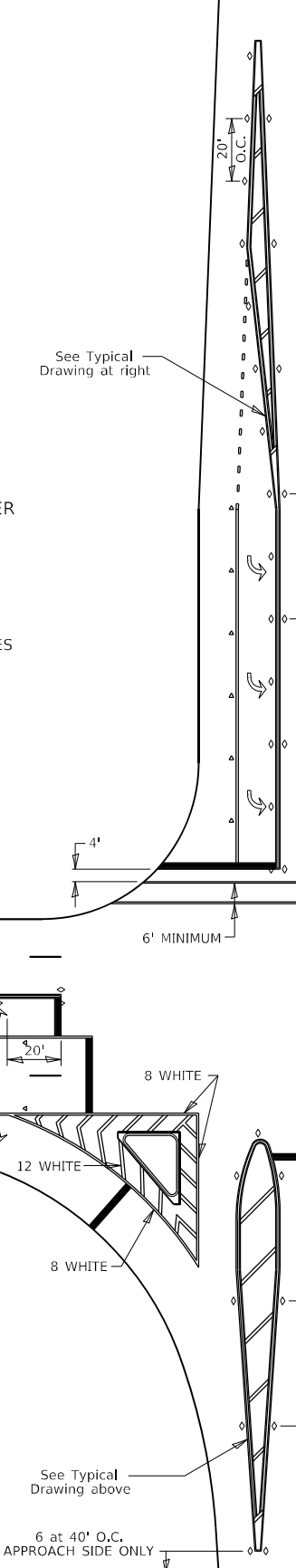

TYPICAL PAVEMENT MARKING FOR FLUSH MEDIAN

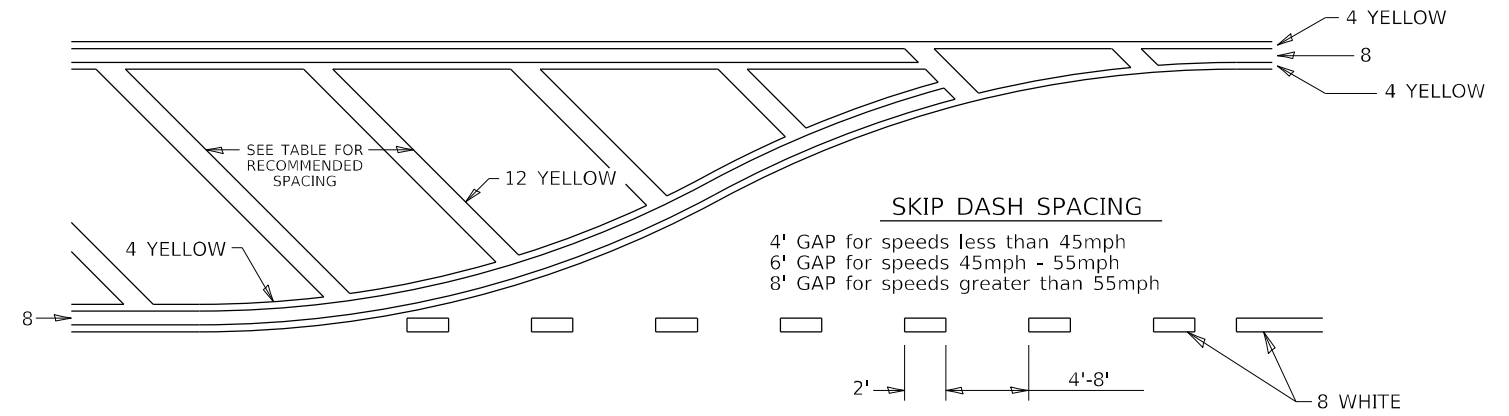

RECOMMENDED SPACING BETWEEN DIAGONALS (IN FEET)

Speed Limit Range	Continuous Median Area	Intersection Channelization	Objects (Islands)
less than 30MPH	50'	15'	10'
30-40MPH	75'	20'	15'
45MPH & over	75'	30'	20'

NOTE: if the spacing recommended in the Table does not permit at least five diagonal lines in the area being marked, the spacing from the next lowest speed range should be used. The recommended spacing is measured parallel to the pavement center line.

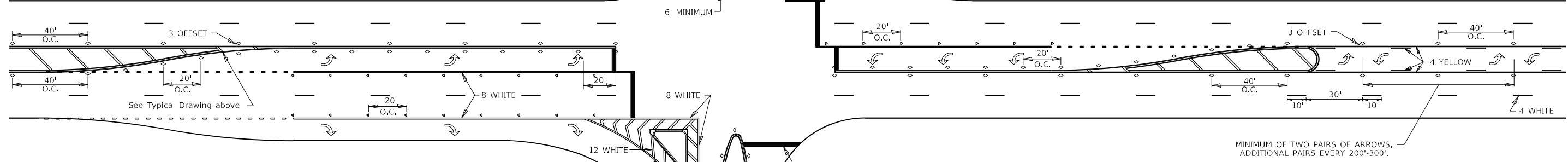

TYPICAL PAVEMENT MARKINGS

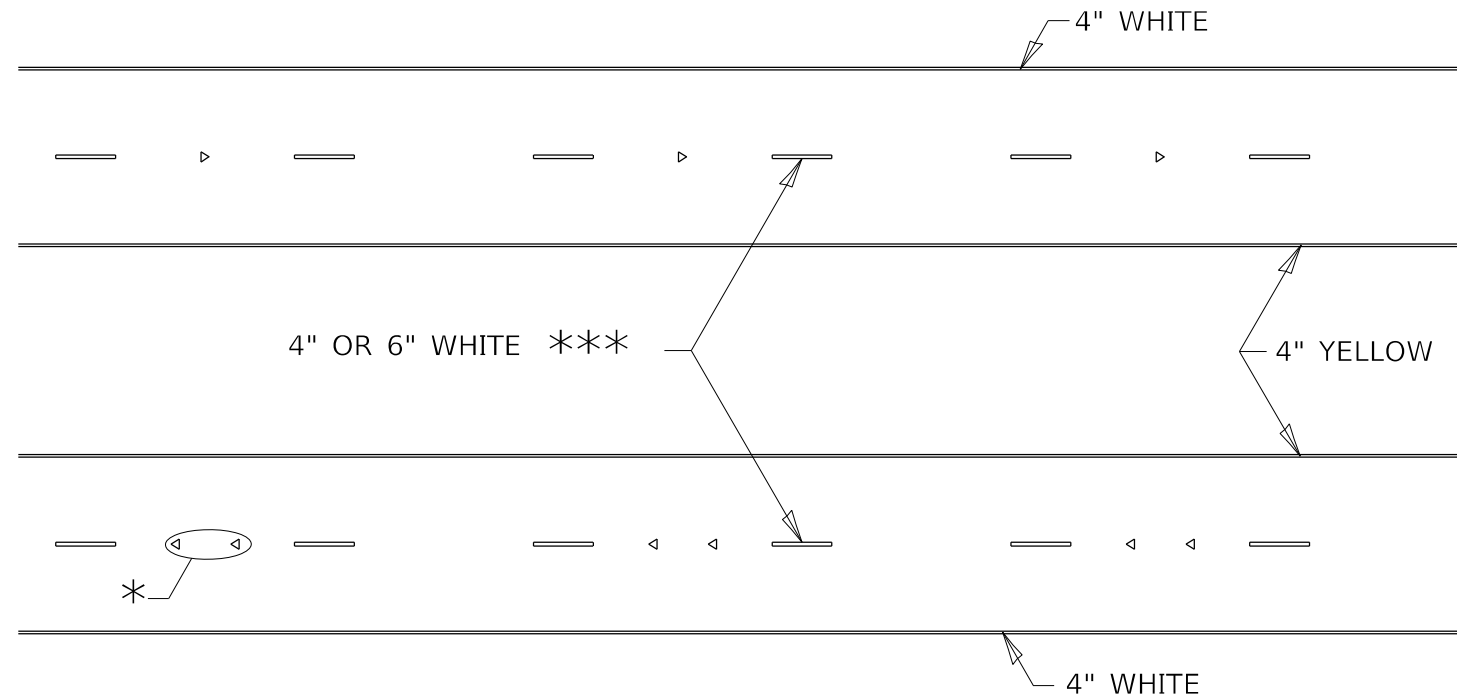

* SEE HIGHWAY STANDARD 781001 FOR SPACING DETAILS.
USE DOUBLE MARKERS WHEN ADT ≥ 20,000.

MULTI-LANE / DIVIDED

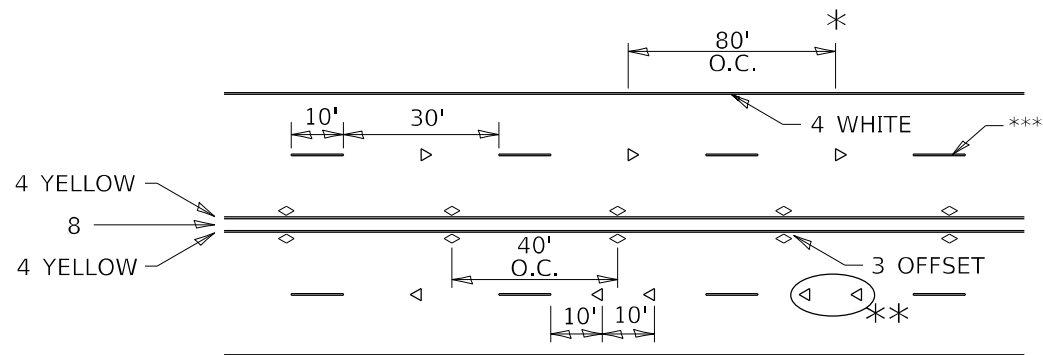

* REDUCE TO 40' O.C. ON CURVES WHERE ADVISORY SPEEDS ARE 10 MPH LOWER THAN POSTED SPEEDS.

** USE DOUBLE MARKERS WHEN ADT ≥ 20,000

*** CENTERLINE SKIP DASH PAVEMENT MARKING SPEED LIMIT LESS THAN 40 MPH USE 4" LINE. SPEED LIMIT 40 MPH AND OVER USE 6" LINE.

MULTI-LANE / UNDIVIDED & ONE WAY

(FOR MULTI-LANE UNDIVIDED HIGHWAYS USE THIS DETAIL NOT HIGHWAY STANDARD 781001)

TYPICAL PARKING SPACING

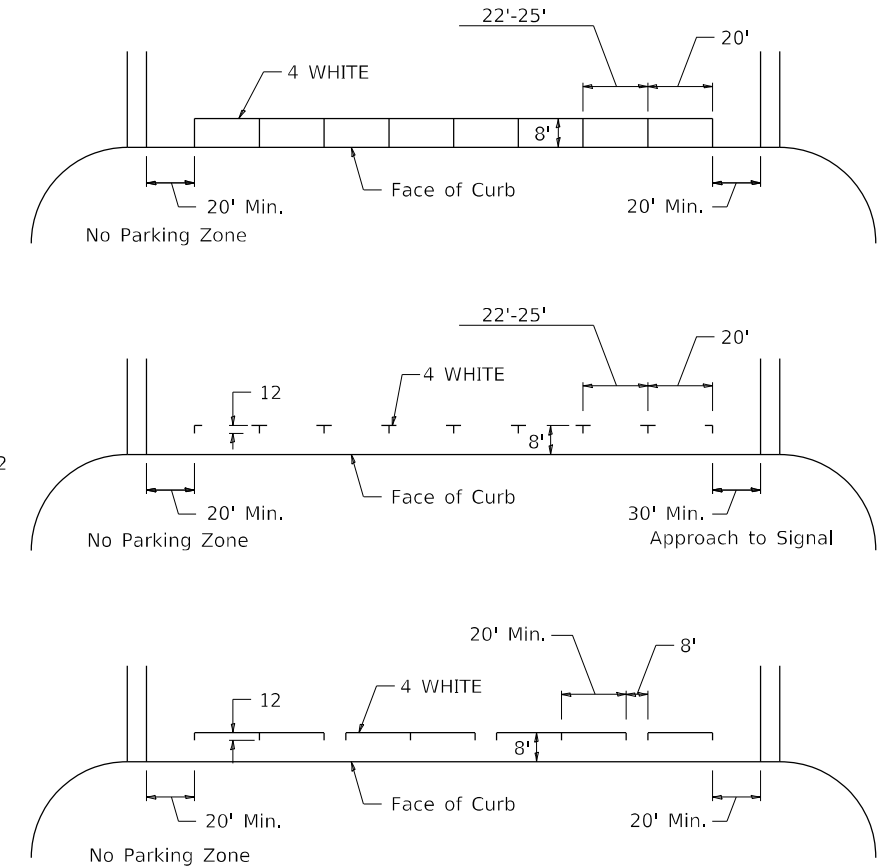

TYPICAL PAVEMENT MARKING FOR TWO LANE SECTION - NO PASSING ZONES

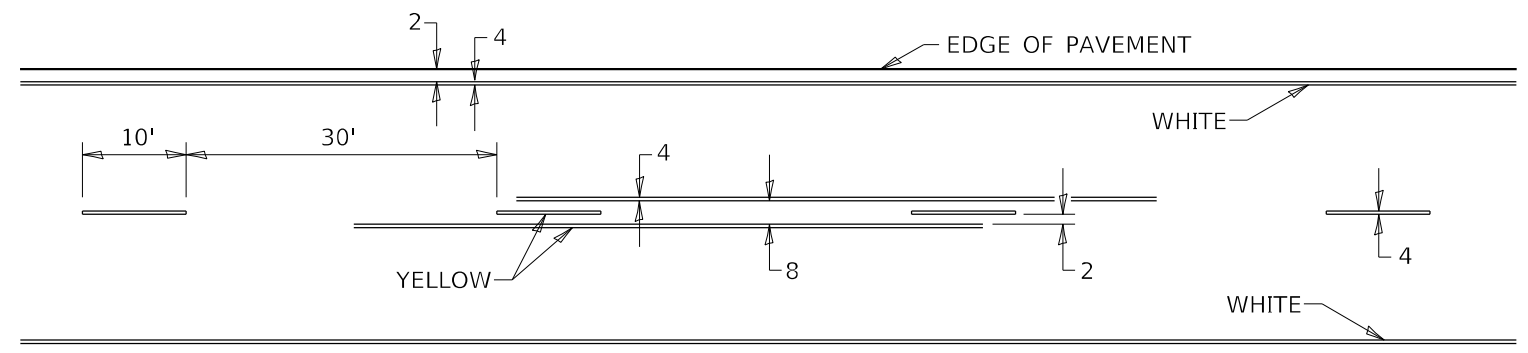

SYMBOLS

FILE NAME: p:\planroom\dot\illinois.gov\PWIDOT	USER NAME = romerore	DESIGNED -	REVISED - 6-27-14	STATE OF ILLINOIS DEPARTMENT OF TRANSPORTATION	REGION 2 / DISTRICT 2 STANDARD			F.A.P. RTE.	SECTION	COUNTY	TOTAL SHEETS	SHEET NO.
	Documents\DOT Offices\District 2\Projects\64N91\Program\Drawings\Studies & Plans\Design\CADD\CAD\REVISED\64N91-shi-de-0423	DRAWN -	REVISED - 11-28-12					599	(48MFT,62MFT)RS	Rock Island	45	45
	PLOT SCALE = 100,0000' / in.	CHECKED -	REVISED -		SCALE: 1" = 50'	SHEET 3 OF 3 SHEETS	STA. TO STA.	ILLINOIS FED. AID PROJECT				
	PLOT DATE = Apr-27-2021 09:24:27 AM	DATE -	REVISED -		CONTRACT NO. 64N91							