

STATE OF ILLINOIS
DEPARTMENT OF TRANSPORTATION

F.A.S. RTE.	SECTION	COUNTY	TOTAL SHEETS	SHEET NO.
1610	MG - RIGGSTON	SCOTT	7	1
		ILLINOIS	CONTRACT NO. 72M99	

FOR INDEX OF SHEETS, SEE SHEET NO. 2

PROPOSED CAPITAL IMPROVEMENT PLANS

FAS 1610 (OLD US 36)
SECTION MG - RIGGSTON
PARKING IMPROVEMENTS
SCOTT COUNTY

C-96-124-21

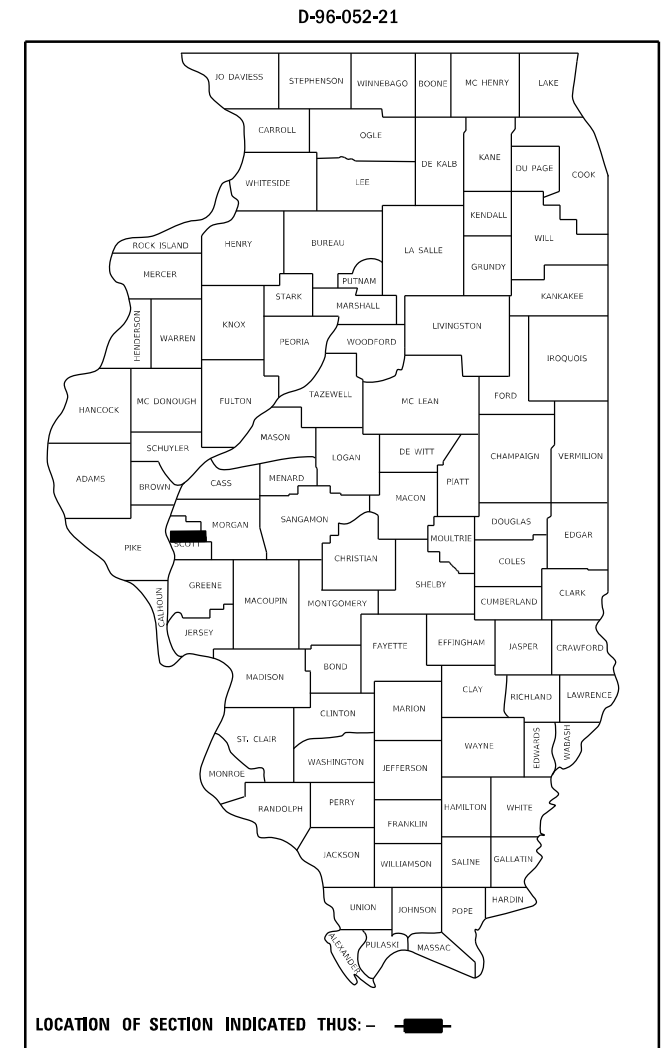

PROJECT
LOCATION

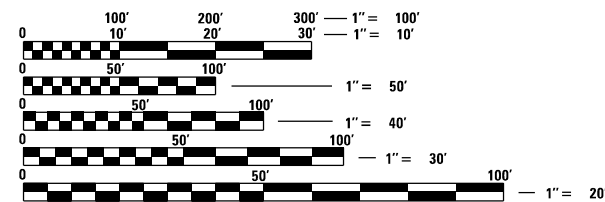
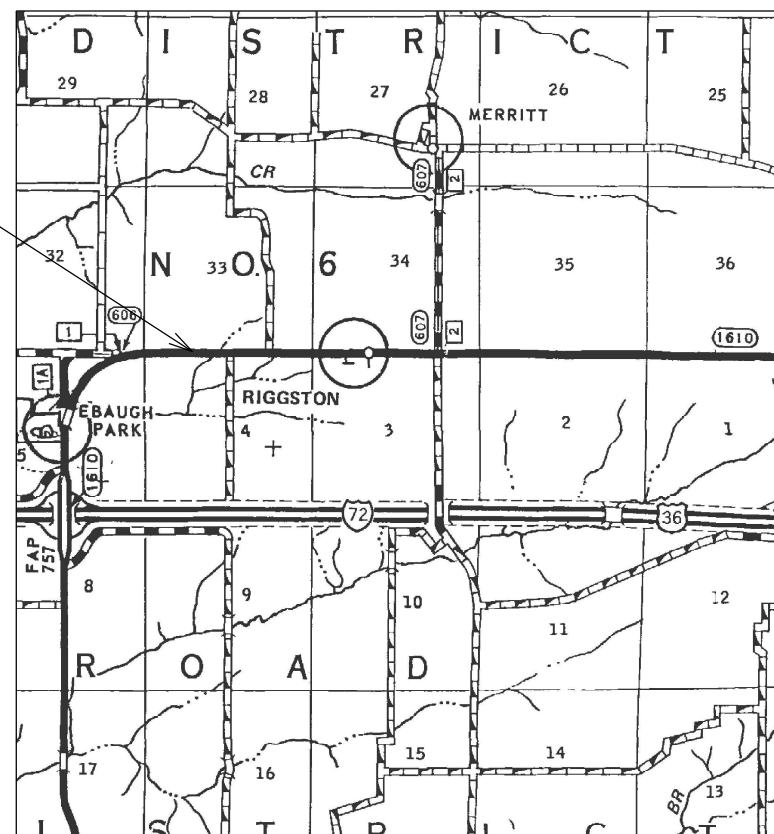

FULL SIZE PLANS HAVE BEEN PREPARED USING STANDARD ENGINEERING SCALES. REDUCED SIZED PLANS WILL NOT CONFORM TO STANDARD SCALES. IN MAKING MEASUREMENTS ON REDUCED PLANS, THE ABOVE SCALES MAY BE USED.

J.U.L.I.E.
JOINT UTILITY LOCATION INFORMATION FOR EXCAVATORS
1-800-892-0123
OR 811

PROJECT ENGINEER: STEVE BERAN - (217)527-5207
PROJECT MANAGER: TIM SHARP - (217)527-9160

CONTRACT NO. 72M99

STATE OF ILLINOIS
DEPARTMENT OF TRANSPORTATION

SUBMITTED May 13 2021

Jeff P. Meyer
REGIONAL ENGINEER

June 25, 2021
Scott A. Clark
ENGINEER OF DESIGN AND ENVIRONMENT

June 25, 2021
James J. Quinn
DIRECTOR OF HIGHWAYS PROJECT IMPLEMENTATION 13

PRINTED BY THE AUTHORITY
OF THE STATE OF ILLINOIS

INDEX OF SHEETS

SHEET NO.	DESCRIPTION
1.	COVER SHEET
2.	INDEX OF SHEETS, STANDARDS, GENERAL NOTES & SIGNATURE
3.	SUMMARY OF QUANTITIES
4.	SCHEDULE OF QUANTITIES
5.	PROJECT LOCATION MAP
6.	PLAN
7.	JOINTING DETAIL



STANDARDS

STANDARD NO.	DESCRIPTION
701001-02	OFF-ROAD OPERATIONS, 2L, 2W, MORE THAN 15' (4.5m) AWAY
701006-05	OFF-ROAD OPERATIONS, 2L, 2W, 15' (4.5m) TO 24" (600mm) FROM EDGE OF PAVEMENT
701301-04	LANE CLOSURE, 2L, 2W, SHORT TIME OPERATIONS
701901-08	TRAFFIC CONTROL DEVICES
000001-08	STANDARD SYMBOLS, PATTERNS AND ABBREVIATIONS
001006	DECIMAL OF AN INCH AND OF A FOOT
420001-09	PAVEMENT JOINTS
420701-03	PAVEMENT WELDED WIRE REINFORCEMENT

NOTES:

COVER COAT AND SEAL COAT AGGREGATE SHALL BE CRUSHED LIMESTONE

UP TO 3 SWEEPINGS MAY BE REQUIRED BY A ROTARY TYPE BROOM TO REMOVE EXCESS AGGREGATE.

STATE OF ILLINOIS DEPARTMENT OF TRANSPORTATION DIVISION OF HIGHWAYS DISTRICT 6	
EXAMINED	May 14 20 21
 ENGINEER OF OPERATIONS	
EXAMINED	May 14 20 21
 ENGINEER OF PROJECT IMPLEMENTATION	
EXAMINED	May 14 20 21
 ENGINEER OF PROGRAM DEVELOPMENT	

REV. - MS

FILE NAME =	USER NAME = sharptd	DESIGNED -	REVISED -	STATE OF ILLINOIS DEPARTMENT OF TRANSPORTATION	INDEX OF SHEETS, STANDARDS GENERAL NOTES, SIGNATURES	F.A.S. RTE.	SECTION	COUNTY	TOTAL SHEETS	SHEET NO.
S:\CONTRMAINT_CAD\72M99-RIGGSTON YARD	PLANS\72M99-sht-2-gennote.dgn	DRAWN - DMS	REVISED -			1610	MG - RIGGSTON	SCOTT	7	2
Default	PLOT SCALE = 40.0000' / in.	CHECKED -	REVISED -							
	PLOT DATE = 5/13/2021	DATE -	REVISED -		SCALE: _____ SHEET _____ OF _____ SHEETS STA. _____ TO STA. _____					ILLINOIS FED. AID PROJECT

100%
STATE

CODE NO.	ITEM	UNIT	TOTAL QUANTITY	CONSTR. CODE
				6-01165-9980 SCOTT 0005 RURAL
20200100	EARTH EXCAVATION	CU YD	89	89
31101600	SUBBASE GRANULAR MATERIAL, TYPE B 8"	SQ YD	188	188
40300400	BITUMINOUS MATERIALS (COVER AND SEAL COATS)	TON	15	15
40300500	COVER COAT AGGREGATE	TON	60	60
40300600	SEAL COAT AGGREGATE	TON	48	48
42000060	WELDED WIRE REINFORCEMENT	SQ YD	188	188
42000401	PORTLAND CEMENT CONCRETE PAVEMENT 9" (JOINTED)	SQ YD	188	188
42001300	PROTECTIVE COAT	SQ YD	188	188
67100100	MOBILIZATION	L SUM	1	1

APPLICATION RATES		
	AGGREGATE	BITUMINOUS MATERIAL
SEAL COAT	20 lb/sq yd	0.40 gal/sq yd
COVER COAT	25 lb/sq yd	0.32 gal/sq yd
THE APPLICATION RATES SHOWN ABOVE MAY BE ADJUSTED BY THE ENGINEER BASED ON FIELD CONDITIONS		

REV. - MS

FILE NAME = S:\CONTRMAINT_CAD\72M99-RIGGSTON YARD	USER NAME = sharptd	DESIGNED - _____	REVISED - _____	STATE OF ILLINOIS DEPARTMENT OF TRANSPORTATION	SUMMARY OF QUANTITIES	F.A.S. RTE.	SECTION	COUNTY	TOTAL SHEETS	SHEET NO.	
Default	PLANS\72M99-shr-3-500.dgn	DRAWN - DMS	REVISED - _____			1610	MG - RIGGSTON	SCOTT	7	3	
	PLOT SCALE = 40.0000' / in.	CHECKED - _____	REVISED - _____			CONTRACT NO. 72M99					
	PLOT DATE = 5/13/2021	DATE - _____	REVISED - _____			ILLINOIS FED. AID PROJECT					
				SCALE: _____ SHEET ____ OF ____ SHEETS STA. _____ TO STA. _____							

LOCATION	AREA (SQ YD)	COVER COAT AGGREGATE (TONS)	COVER COAT BIT MATERIAL (TONS)	SEAL COAT AGGREGATE (TONS)	SEAL COAT BIT MATERIAL (TONS)
RIGGSTON YARD	4800	60.00	6.62	48.00	8.28
TOTAL =		60	7	48	8

FILE NAME =	USER NAME = sharptd	DESIGNED - _____	REVISED - _____
S:\CONTRMAINT_CAD\72M99-RIGGSTON YARD\PLANS\72M99-sh1-4-schedule.dgn		DRAWN - DMS	REVISED - _____
Default	PLOT SCALE = 40.0000' / in.	CHECKED - _____	REVISED - _____
	PLOT DATE = 5/13/2021	DATE - _____	REVISED - _____

**STATE OF ILLINOIS
DEPARTMENT OF TRANSPORTATION**

SCHEDULE OF QUANTITIES

SCALE: _____ SHEET ____ OF ____ SHEETS STA. _____ TO STA. _____

F.A.S. RTE.	SECTION	COUNTY	TOTAL SHEETS	SHEET NO.
1610	MG - RIGGSTON	SCOTT	7	4
CONTRACT NO. 72M99			ILLINOIS FED. AID PROJECT	

RIGGSTON YARD



MODEL: D:\m\h\...
 FILE NAME: S:\CONTRACT\CA072M99-RIGGSTON YARD\PLANS\72M99-PL-5-1-10-10.dwg

USER NAME = sharptd	DESIGNED - _____	REVISED - _____
	DRAWN - _____	REVISED - _____
PLOT SCALE = 2.0000' / in.	CHECKED - _____	REVISED - _____
PLOT DATE = 5/13/2021	DATE - _____	REVISED - _____

**STATE OF ILLINOIS
DEPARTMENT OF TRANSPORTATION**

LOCATION MAP

SCALE: _____ SHEET 1 OF 7 SHEETS STA. _____ TO STA. _____

F.A.S. RTE.	SECTION	COUNTY	TOTAL SHEETS	SHEET NO.
1610	MG - RIGGSTON	SCOTT	7	5
CONTRACT NO. 72M99				
ILLINOIS FED. AID PROJECT				

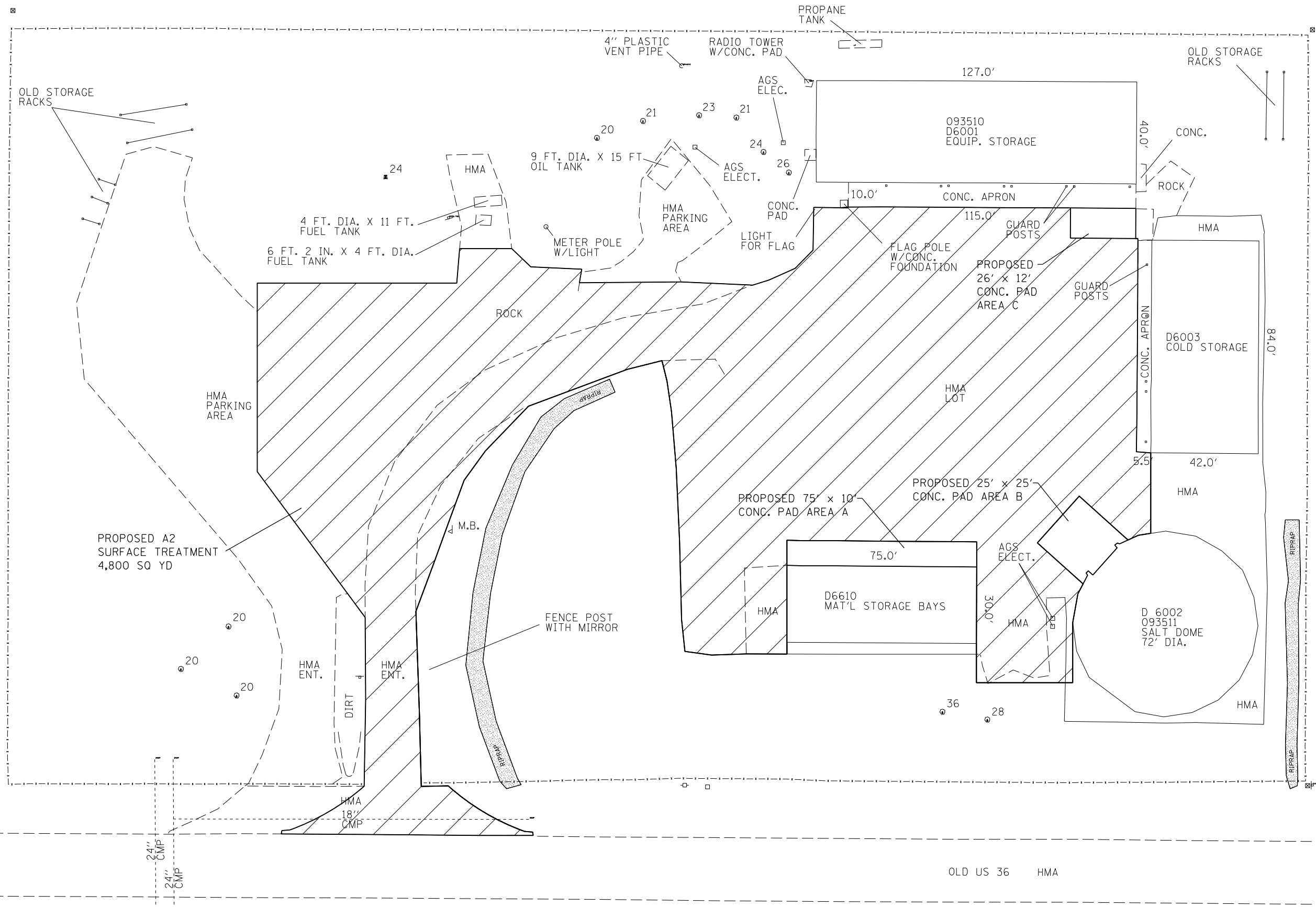

MODEL: D:\dtp\h...
 FILE NAME: S:\CONTRACT\MAINT_CAD\72M99-RIGGSTON YARD\PLANS\72M99-shl-6-riggsston.dwg deposit: topes.dwg

USER NAME = sharptd	DESIGNED - _____	REVISED - _____
DRAWN - _____	REVISIONS - _____	
PLOT SCALE = 40.0000 ' / in.	CHECKED - _____	REVISED - _____
PLOT DATE = 5/13/2021	DATE - _____	REVISED - _____

**STATE OF ILLINOIS
DEPARTMENT OF TRANSPORTATION**

PLAN

SCALE: _____ SHEET ____ OF ____ SHEETS STA. _____ TO STA. _____

F.A.S. RTE.	SECTION	COUNTY	TOTAL SHEETS	SHEET NO.
1610	MG - RIGGSTON	SCOTT	7	6
CONTRACT NO. 72M99				
ILLINOIS FED. AID PROJECT				

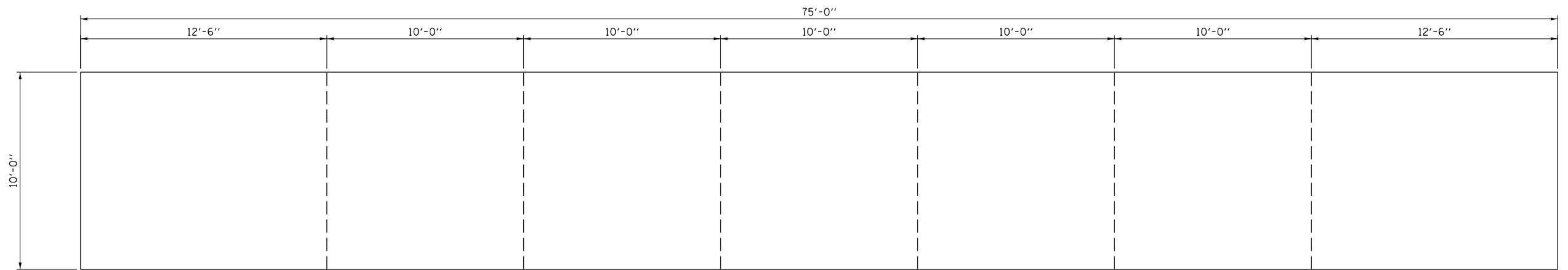

AREA A
FACE OF MATERIAL STORAGE BAYS

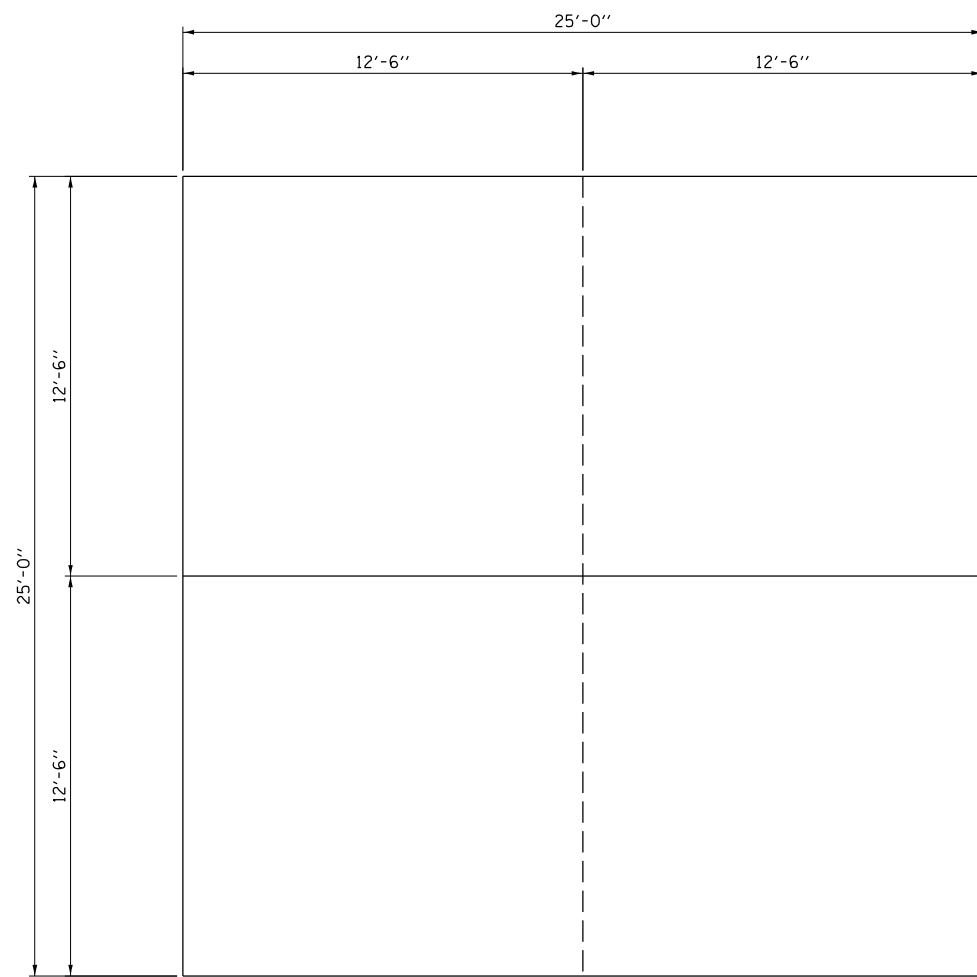

AREA B
FACE OF SALT DOME

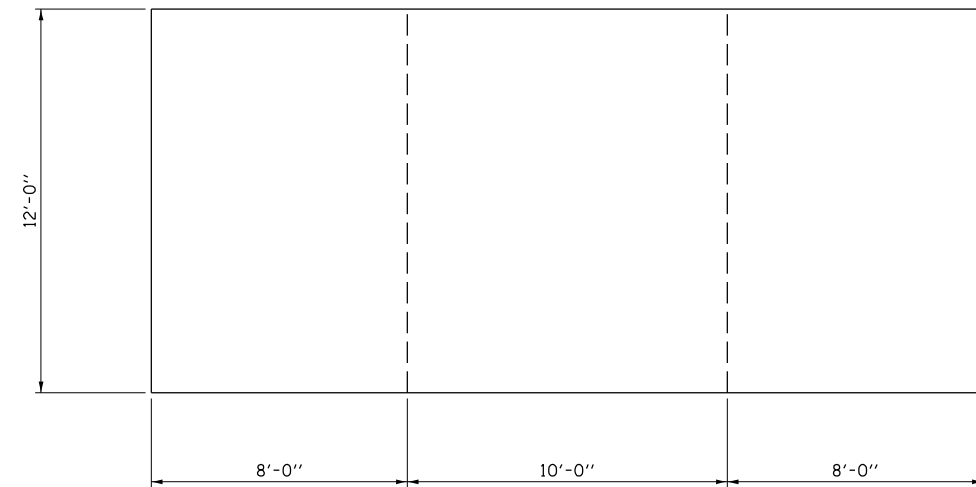

AREA C
FACE CONCRETE APRON EQUIPMENT STORAGE

TIED JOINT _____
SAWED JOINT - - - - -

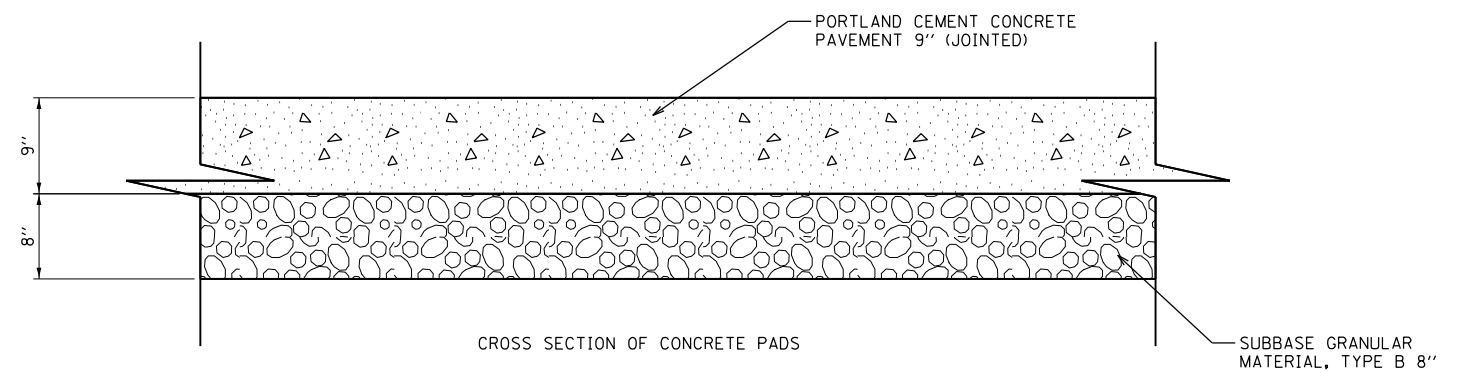

CROSS SECTION OF CONCRETE PADS

MODEL: D:\m\h\... FILE NAME: S:\CONTRACT\... RIGGS STON... CAD: 72M99... RIGGS STON... 72M99.dgn

USER NAME = sharptd	DESIGNED - _____	REVISED - _____
	DRAWN - _____	REVISED - _____
PLOT SCALE = 6.0000' / in.	CHECKED - _____	REVISED - _____
PLOT DATE = 6/14/2021	DATE - _____	REVISED - _____

**STATE OF ILLINOIS
DEPARTMENT OF TRANSPORTATION**

JOINTING DETAILS

SCALE: _____ SHEET 1 OF 7 SHEETS STA. _____ TO STA. _____

F.A.S. RTE.	SECTION	COUNTY	TOTAL SHEETS	SHEET NO.
1610	MG - RIGGSTON	SCOTT	7	7
CONTRACT NO. 72M99				
ILLINOIS FED. AID PROJECT				