

F.A.I. RTE.	SECTION	COUNTY	TOTAL SHEETS	SHEET NO.
94	2005-030 I	COOK	29	6
STA. 2212+06.2		TO STA. 2338+58.7		
FED. ROAD DIST. NO.	ILLINOIS	FED. AID PROJECT		

60A01

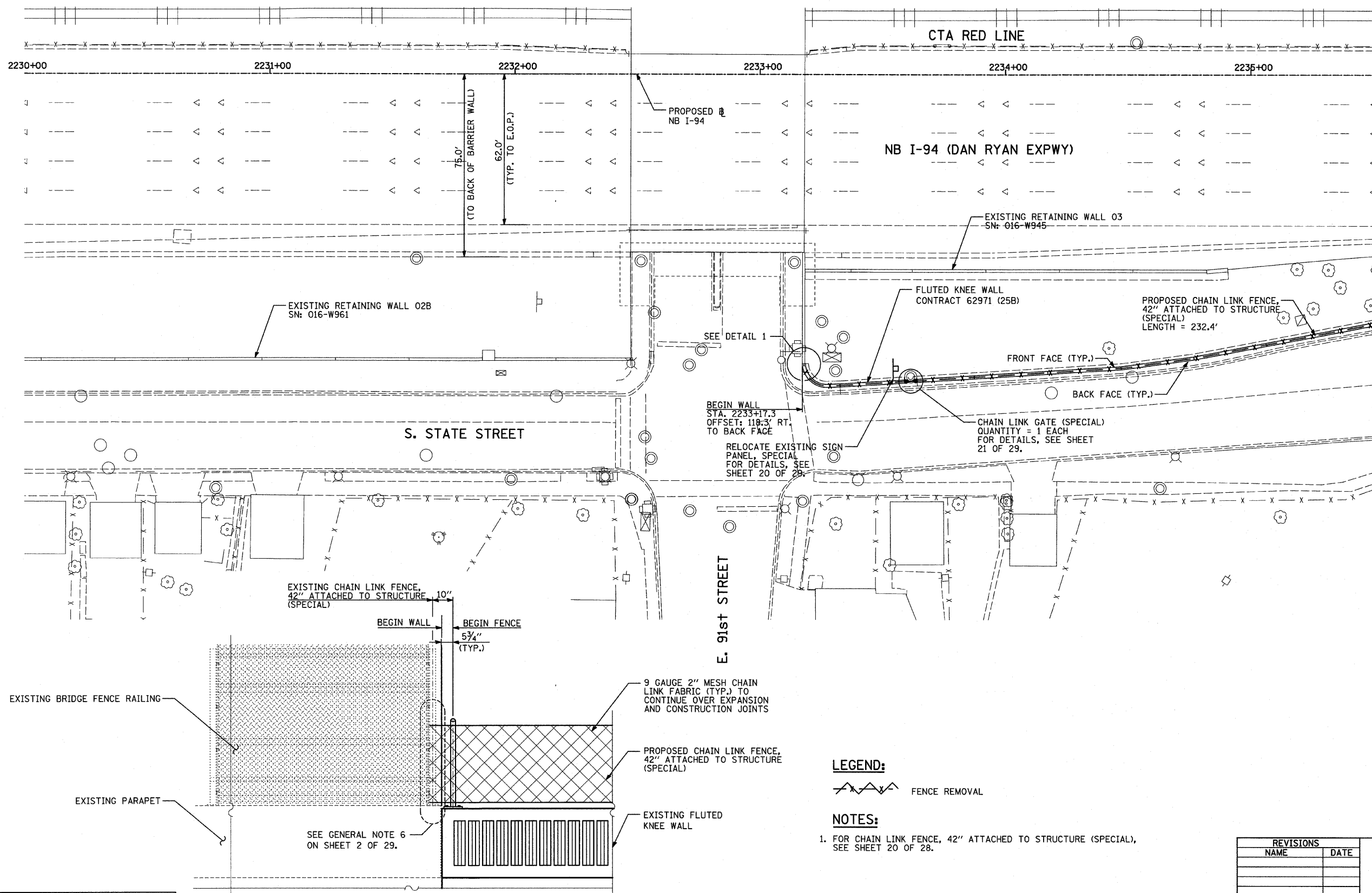

MATCHLINE NB STA. 2235+50.00

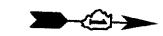
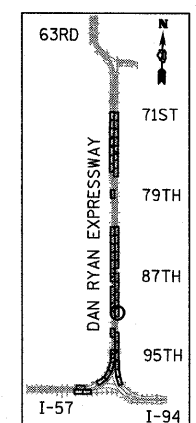

LOCATION MAP

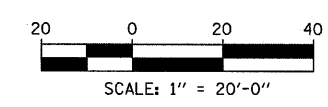

LEGEND:

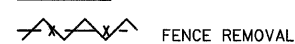

NOTES:

1. FOR CHAIN LINK FENCE, 42" ATTACHED TO STRUCTURE (SPECIAL), SEE SHEET 20 OF 28.

REVISIONS	
NAME	DATE

ILLINOIS DEPARTMENT OF TRANSPORTATION
 F.A.I. 94 (DAN RYAN EXPRESSWAY)
 PROPOSED PLAN
 NB I-94 (DAN RYAN EXPRESSWAY)
 STA. 2230+00.00 TO STA. 2235+50.00
 CONTRACT 25B LOCATION

SCALE: 1"=20'
 DATE: FEBRUARY 13, 2009

DRAWN BY: MAF
 CHECKED BY: TGB, MI

TYLIN INTERNATIONAL

DETAIL 1
(LOOKING NORTH)

3/19/2009 10:51:20 AM