

F.A.I. RTE.	SECTION	COUNTY	TOTAL SHEETS	SHEET NO.
94	2005-030 I	COOK	29	11
STA. 2212+06.2		TO STA. 2338+58.7		
FED. ROAD DIST. NO.	ILLINOIS	FED. AID PROJECT		

60A01

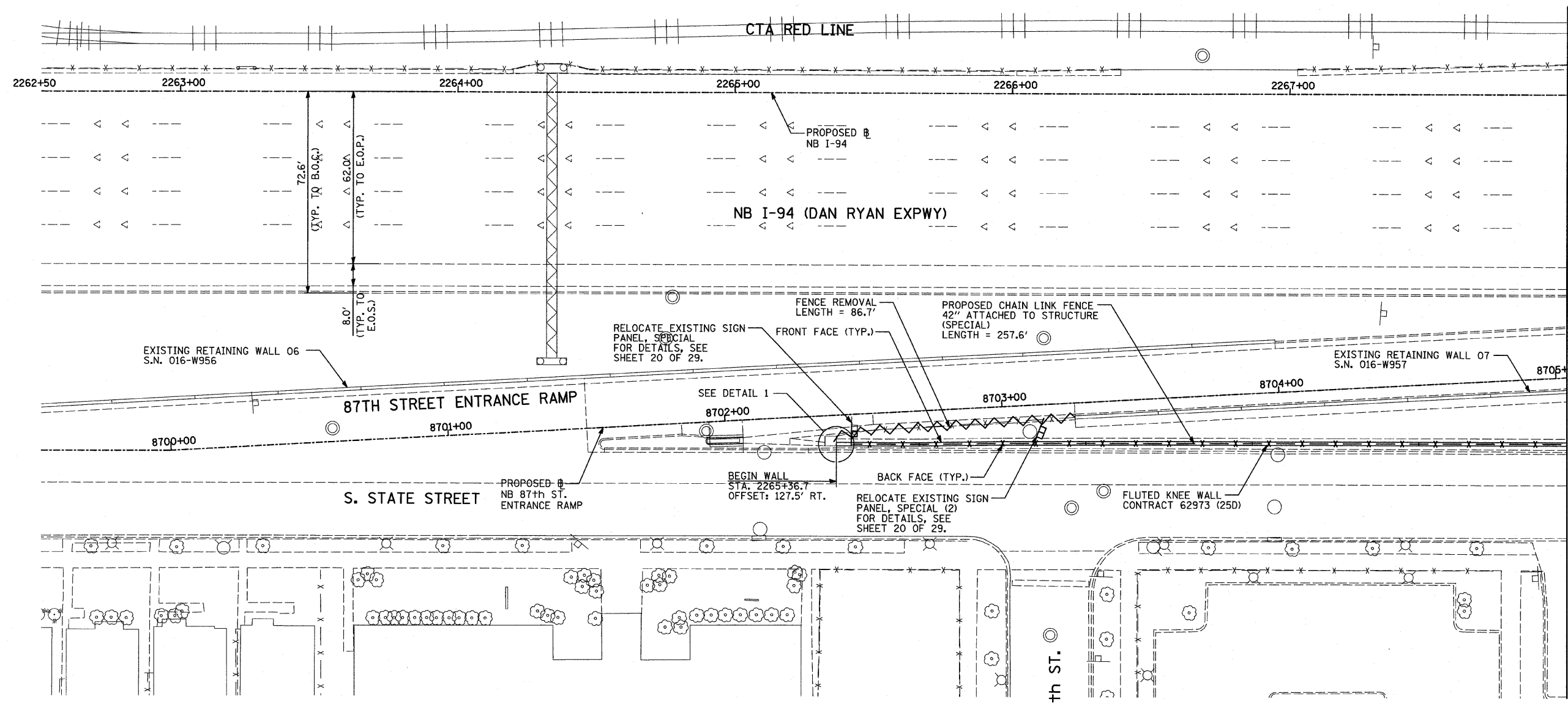

MATCHLINE NB STA. 2268+00.00

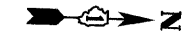
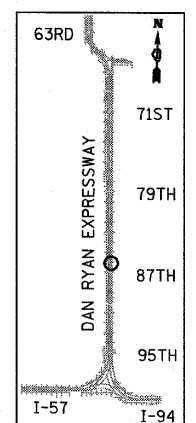

LOCATION MAP

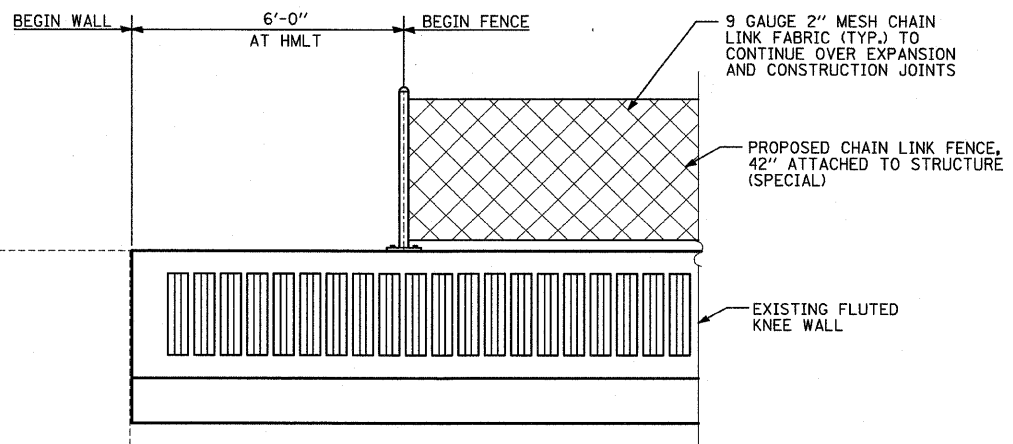
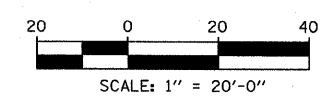

**DETAIL 1**  
(LOOKING WEST)

**LEGEND:**

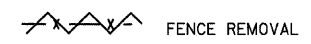

**NOTES:**

1. FOR CHAIN LINK FENCE, 42" ATTACHED TO STRUCTURE (SPECIAL), SEE SHEET 19 OF 29.

REVISIONS	
NAME	DATE

ILLINOIS DEPARTMENT OF TRANSPORTATION  
**F.A.I. 94 (DAN RYAN EXPRESSWAY)**  
**PROPOSED PLAN**  
**NB I-94 (DAN RYAN EXPRESSWAY)**  
**STA. 2262+50.00 TO STA. 2268+00.00**  
**CONTRACT 25D LOCATION**

SCALE: 1"=20'  
 DATE: FEBRUARY 13, 2009  
 DRAWN BY: MAF  
 CHECKED BY: TGB, MI

**TYLIN** INTERNATIONAL

PA0237 3/road/c33/ops/25d/13a.dwg 3/19/2009 10:52:00 AM