

F.A.I. RTE.	SECTION	COUNTY	TOTAL SHEETS	SHEET NO.
94	2005-030 I	COOK	29	12
STA. 2212+06.2		TO STA. 2338+58.7		
FED. ROAD DIST. NO.	ILLINOIS	FED. AID PROJECT		

60A01

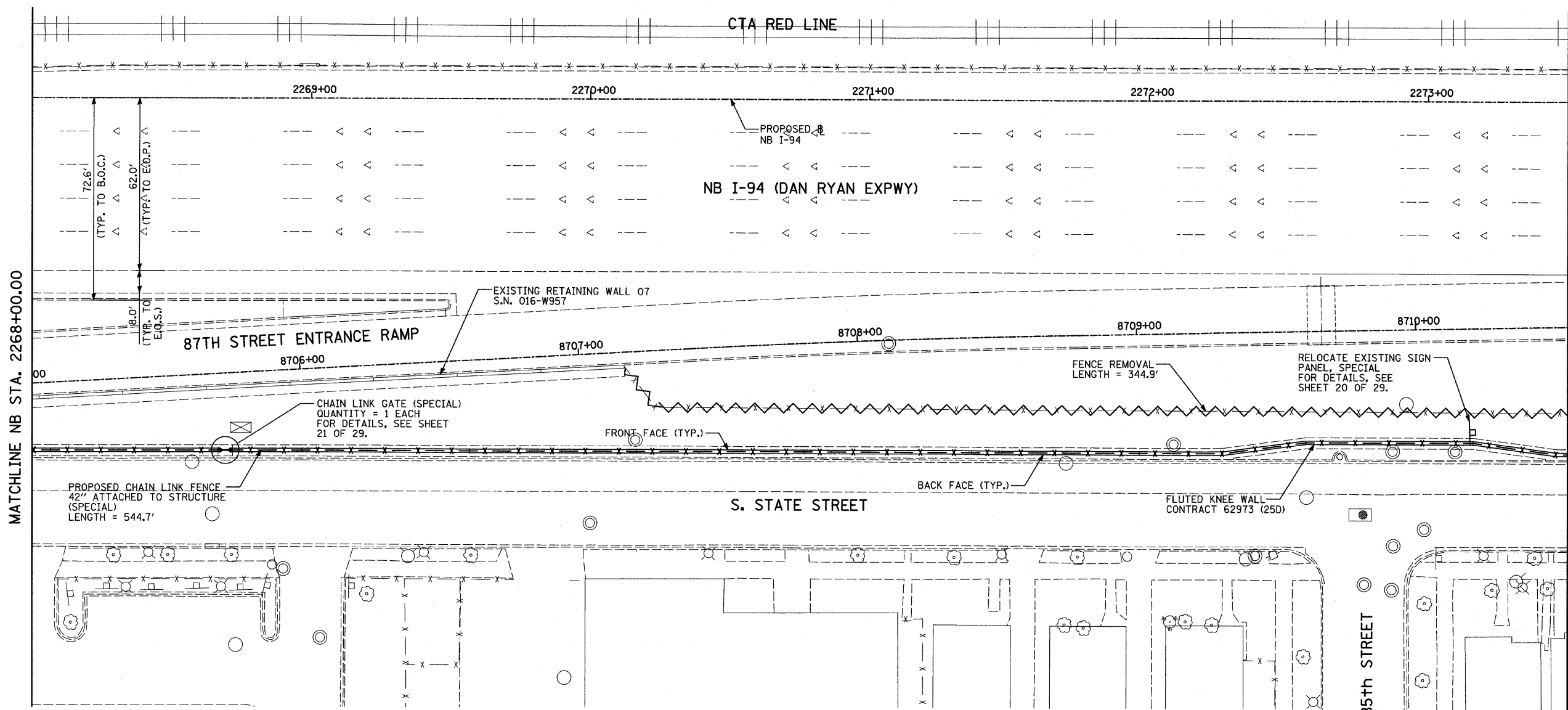
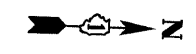

MATCHLINE NB STA. 2273+50.00

MATCHLINE NB STA. 2268+00.00

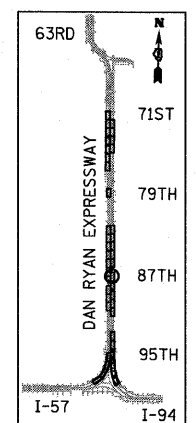

LOCATION MAP

LEGEND:

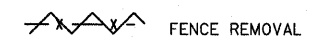

NOTES:

- FOR CHAIN LINK FENCE, 42" ATTACHED TO STRUCTURE (SPECIAL), SEE SHEET 19 OF 29.

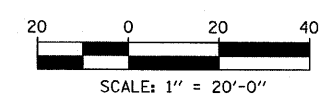

REVISIONS	
NAME	DATE

ILLINOIS DEPARTMENT OF TRANSPORTATION
 F.A.I. 94 (DAN RYAN EXPRESSWAY)
 PROPOSED PLAN
 NB I-94 (DAN RYAN EXPRESSWAY)
 STA. 2268+00.00 TO STA. 2273+50.00
 CONTRACT 25D LOCATION

SCALE: 1"=20'
 DATE: FEBRUARY 13, 2009
 DRAWN BY: MAF
 CHECKED BY: TGB, MI

TYLIN INTERNATIONAL

3/19/2009 10:51:23 AM