

F.A.I. RTE.	SECTION	COUNTY	TOTAL SHEETS	SHEET NO.
94	2005-030 I	COOK	29	16
STA. 2212+06.2		TO STA. 2338+58.7		
FED. ROAD DIST. NO.	ILLINOIS FED. AID PROJECT			

60A01

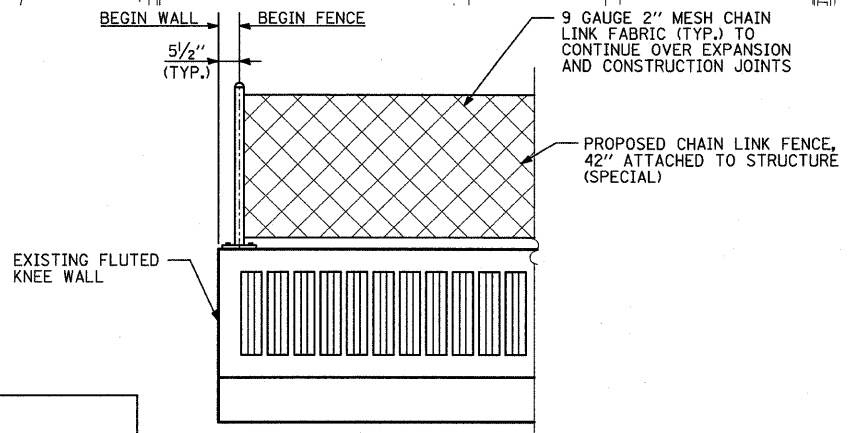

**LEGEND:**

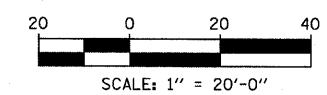
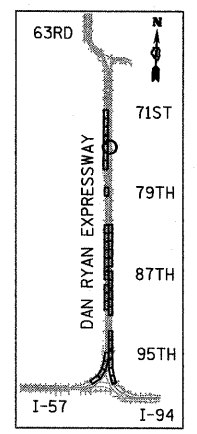
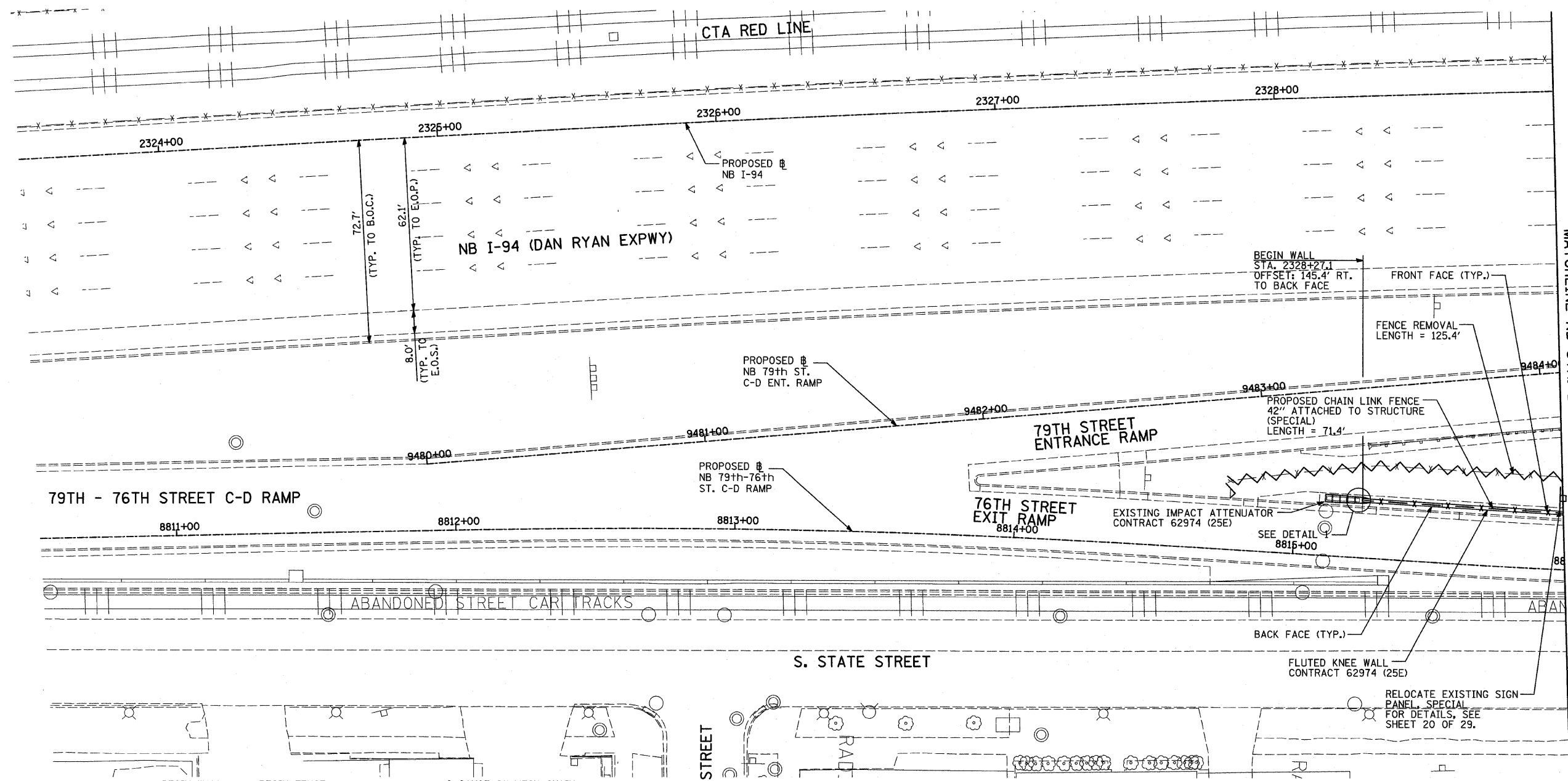
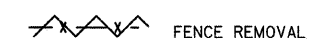

**NOTES:**

- FOR CHAIN LINK FENCE, 42" ATTACHED TO STRUCTURE (SPECIAL), SEE SHEET 19 OF 29.

REVISIONS	
NAME	DATE

ILLINOIS DEPARTMENT OF TRANSPORTATION  
 F.A.I. 94 (DAN RYAN EXPRESSWAY)  
 PROPOSED PLAN  
 NB I-94 (DAN RYAN EXPRESSWAY)  
 STA. 2323+50.00 TO STA. 2329+00.00  
 CONTRACT 25E LOCATION

SCALE: 1"=20'  
 DATE: FEBRUARY 13, 2009

DRAWN BY: MAF  
 CHECKED BY: TGB, MI

TYLIN INTERNATIONAL